

WOODLOT LANE Lot 143  
(Pending)



NOV 23 1987

No. ....

THE COMMONWEALTH OF MASSACHUSETTS  
BOARD OF HEALTH

TOWN OF AMHERST

Application for Disposal Works Construction Permit

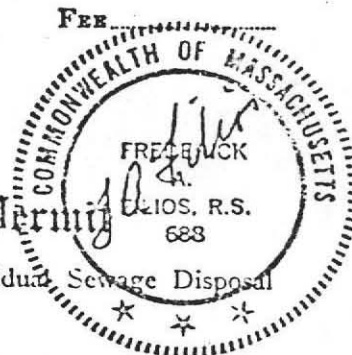

Application is hereby made for a Permit to Construct (✓) or Repair ( ) an Individual Sewage Disposal System at:

WOODLOT LANE LOT 143  
Henry Whitlock Location - Address or Lot No.  
181 North Street Belchertown, MA, Address  
Owner Address

Type of Building Dwelling - No. of Bedrooms 4 Expansion Attic ( ) Garbage Grinder (✓)  
Other - Type of Building No. of persons Showers ( ) - Cafeteria ( )  
Other fixtures

Design Flow 82.5 gallons per person per day. Total daily flow 660 x 1.25 = 825 gallons.  
Septic Tank - Liquid capacity 1500 gallons Length 10.5' Width 5' Diameter Depth 5'  
Disposal Trench No. Width 7' Total Length 33' Total leaching area 244.4 sq. ft. Sides  
Seepage Pit No. 2 Diameter Depth below inlet 2.6' Total leaching area 231 sq. ft. Bottom  
Other Distribution box ( ) Dosing tank ( )  
Percolation Test Results Performed by F.A. Filios Date 3/5/86  
Test Pit No. 1 2 minutes per inch Depth of Test Pit 10' Depth to ground water NONE  
Test Pit No. 2 minutes per inch Depth of Test Pit Depth to ground water

Description of Soil Enclosed  
Nature of Repairs or Alterations - Answer when applicable

Agreement:  
The undersigned agrees to install the aforescribed Individual Sewage Disposal System in accordance with the provisions of TITLE 5 of the State Sanitary Code - The undersigned further agrees not to place the system in operation until a Certificate of Compliance has been issued by the board of health.

Signed \_\_\_\_\_ Date \_\_\_\_\_  
Application Approved By \_\_\_\_\_ Date \_\_\_\_\_  
Application Disapproved for the following reasons: \_\_\_\_\_ Date \_\_\_\_\_  
Permit No. \_\_\_\_\_ Issued \_\_\_\_\_ Date \_\_\_\_\_

THE COMMONWEALTH OF MASSACHUSETTS  
BOARD OF HEALTH

TOWN OF AMHERST

Certificate of Compliance

THIS IS TO CERTIFY, That the Individual Sewage Disposal System constructed (✓) or Repaired ( ) by \_\_\_\_\_ Installer  
at Lot 143 Woodlot Lane  
has been installed in accordance with the provisions of TITLE 5 of The State Sanitary Code as described in the application for Disposal Works Construction Permit No. \_\_\_\_\_ dated \_\_\_\_\_

THE ISSUANCE OF THIS CERTIFICATE SHALL NOT BE CONSTRUED AS A GUARANTEE THAT THE SYSTEM WILL FUNCTION SATISFACTORY.  
DATE \_\_\_\_\_ Inspector \_\_\_\_\_

CHECK OR FILL IN WHERE APPLICABLE

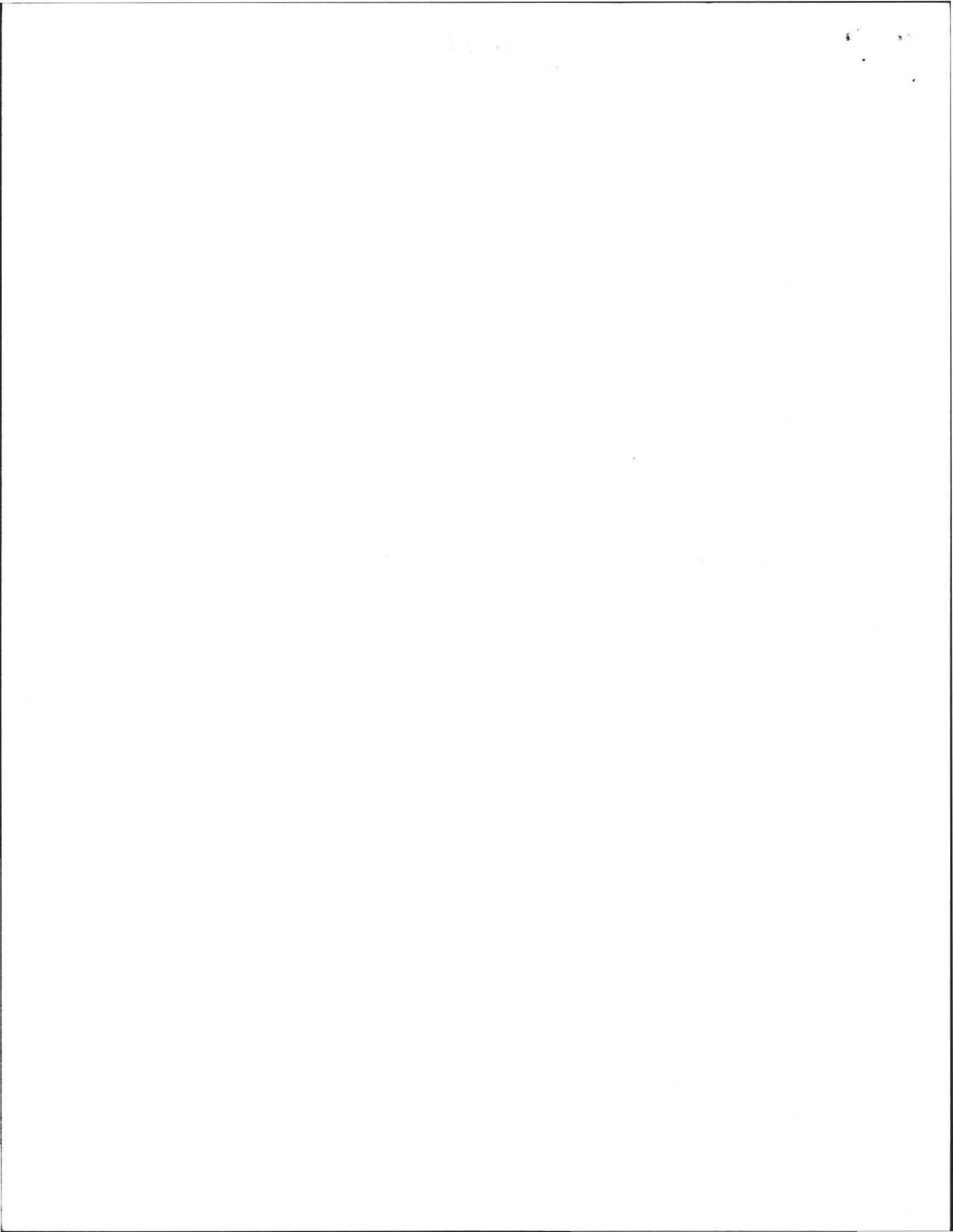

DEEP SOIL LOGS

OWNER Jeffrey W. Flower

DATE March 5, 1986

LOCATION Lot 143 Amherst Woods  
Amherst, MA.

OBSERVER F.A. Filios

B of H C. Drake

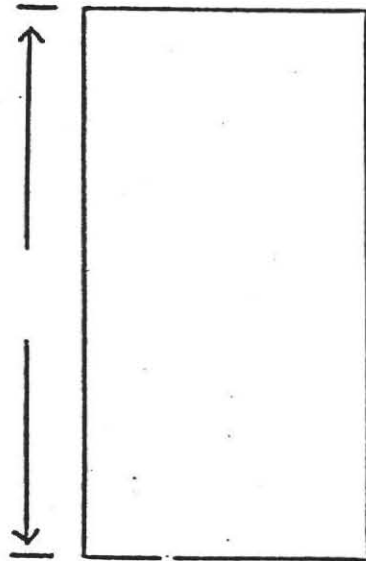
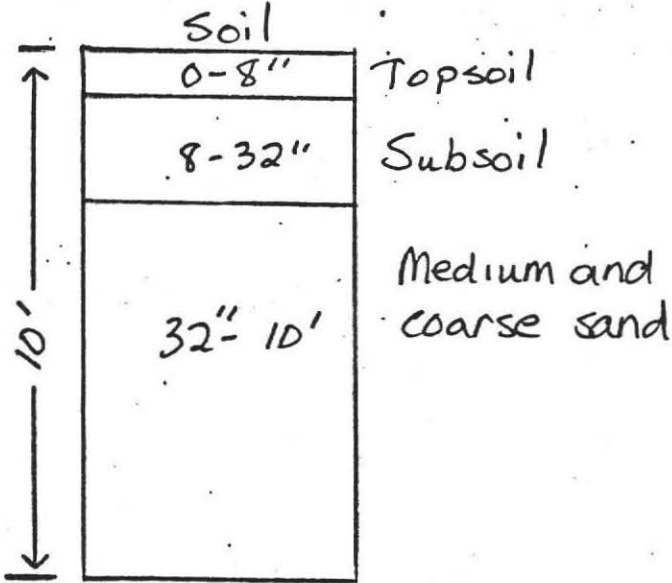

GROUND WATER none oxides at 66"  
5.5'

GROUND WATER \_\_\_\_\_

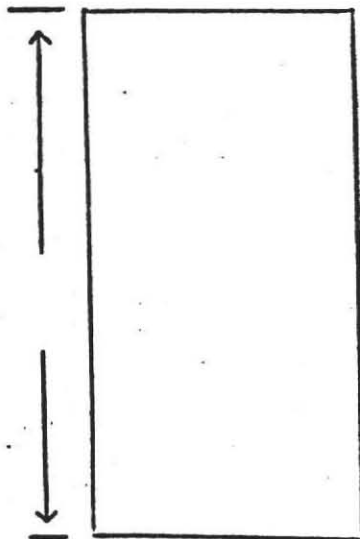

GROUND WATER \_\_\_\_\_

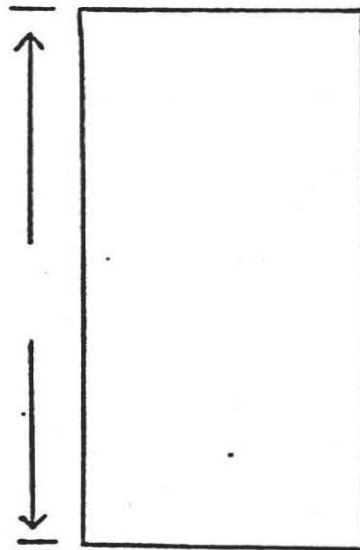

GROUND WATER \_\_\_\_\_

PERCOLATION RATE AT 42 :

< 2 min./inch



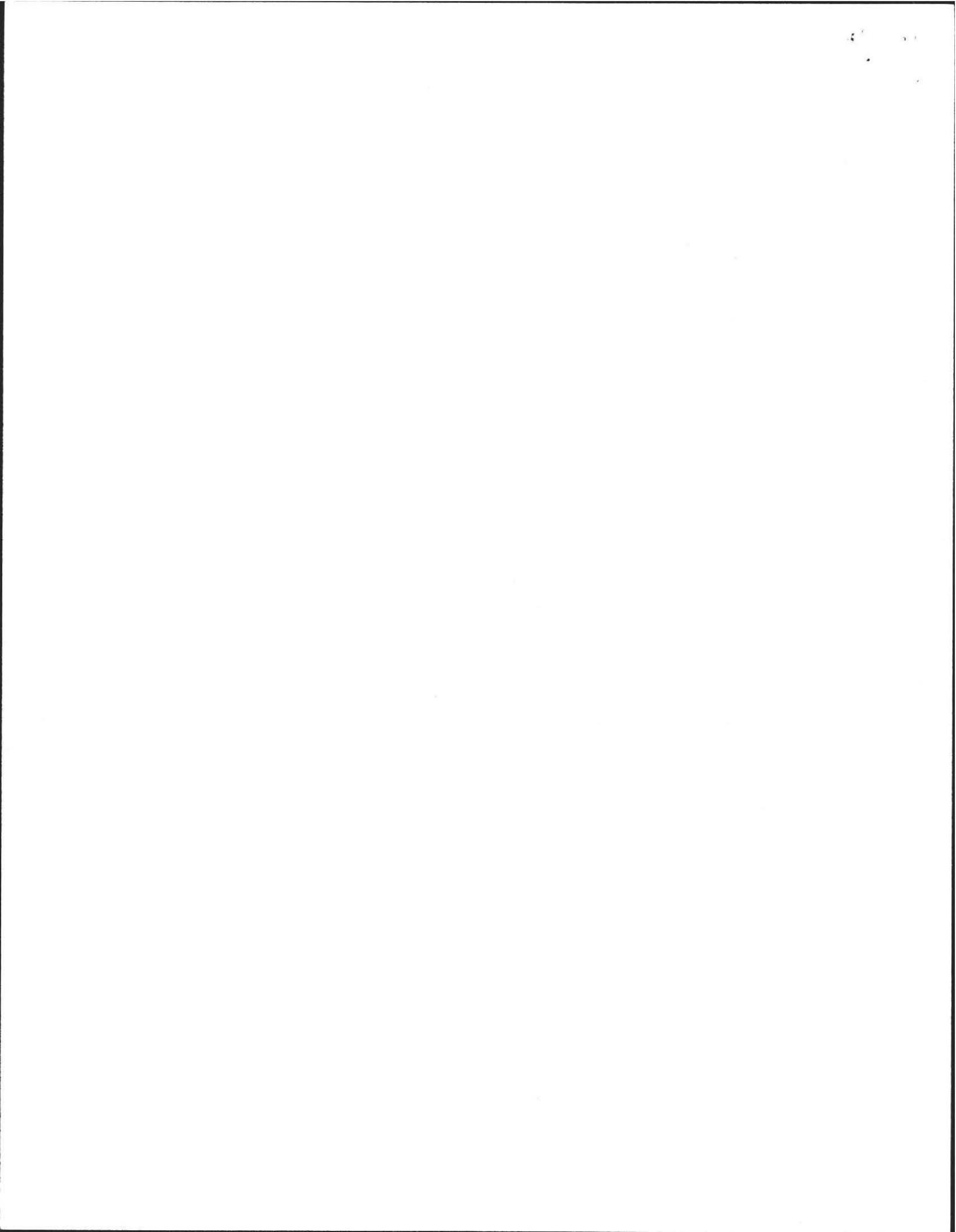

# PLAN SHOWING SEWAGE DISPOSAL SYSTEM

FOR: Henry Whitlock  
181 North Street  
Belchertown, MA

BY: Filios Enterprises, Inc.  
69 Pelham Road  
Amherst, MA

AT: Lot 143  
Woodlot Lane  
Amherst Woods  
Amherst, MA.

SCALE: 1"=40'

DATE: Nov. 16, 1987

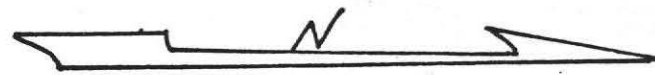
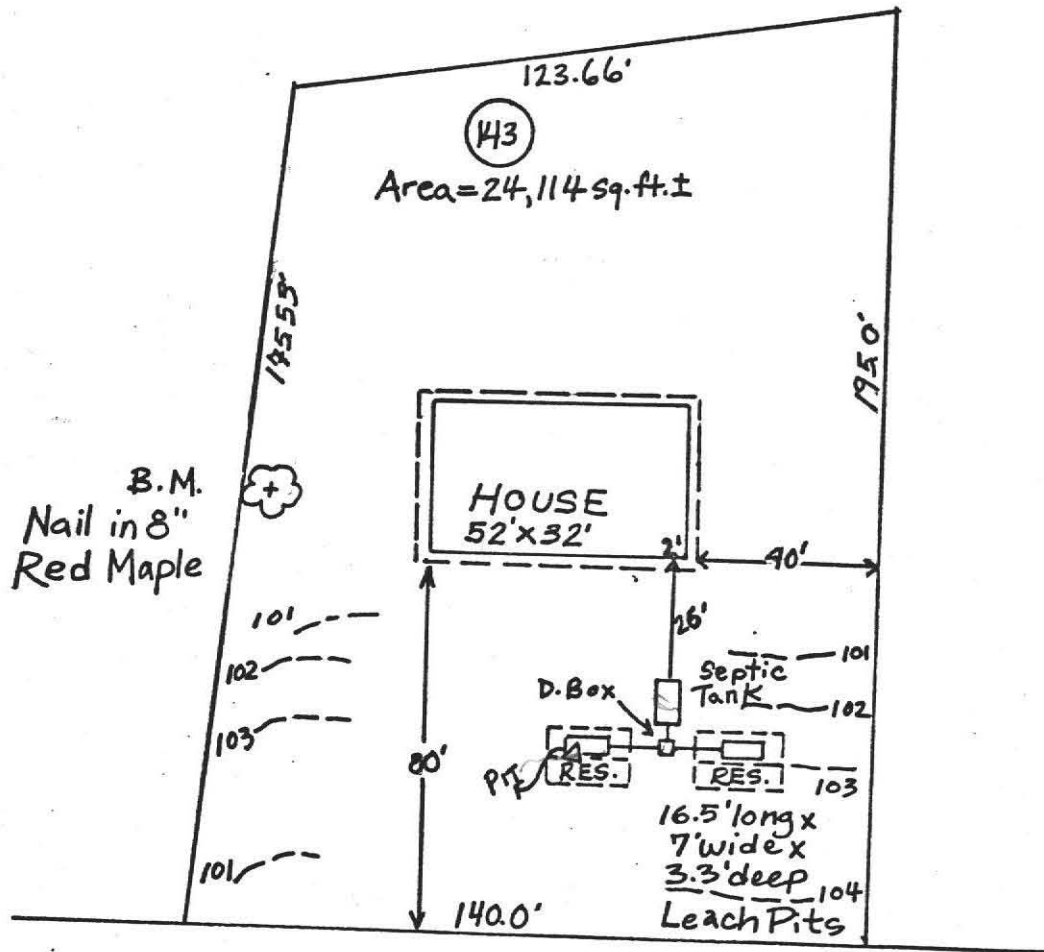





# PROFILE OF SEPTIC SYSTEM

FOR: HENRY WHITLOCK  
181 NORTH STREET  
BELCHERTOWN, MA.

BY: FILIOS ENTERPRISES, INC.  
69 PELHAM RD.  
AMHERST, MA.

AT: LOT 143 WOODLOT LANE  
AMHERST, MA. 01002

SCALE: HORIZONTAL: 1" = 10'  
VERTICAL: 1" = 3'

## CROSS-SECTION AT A-A'

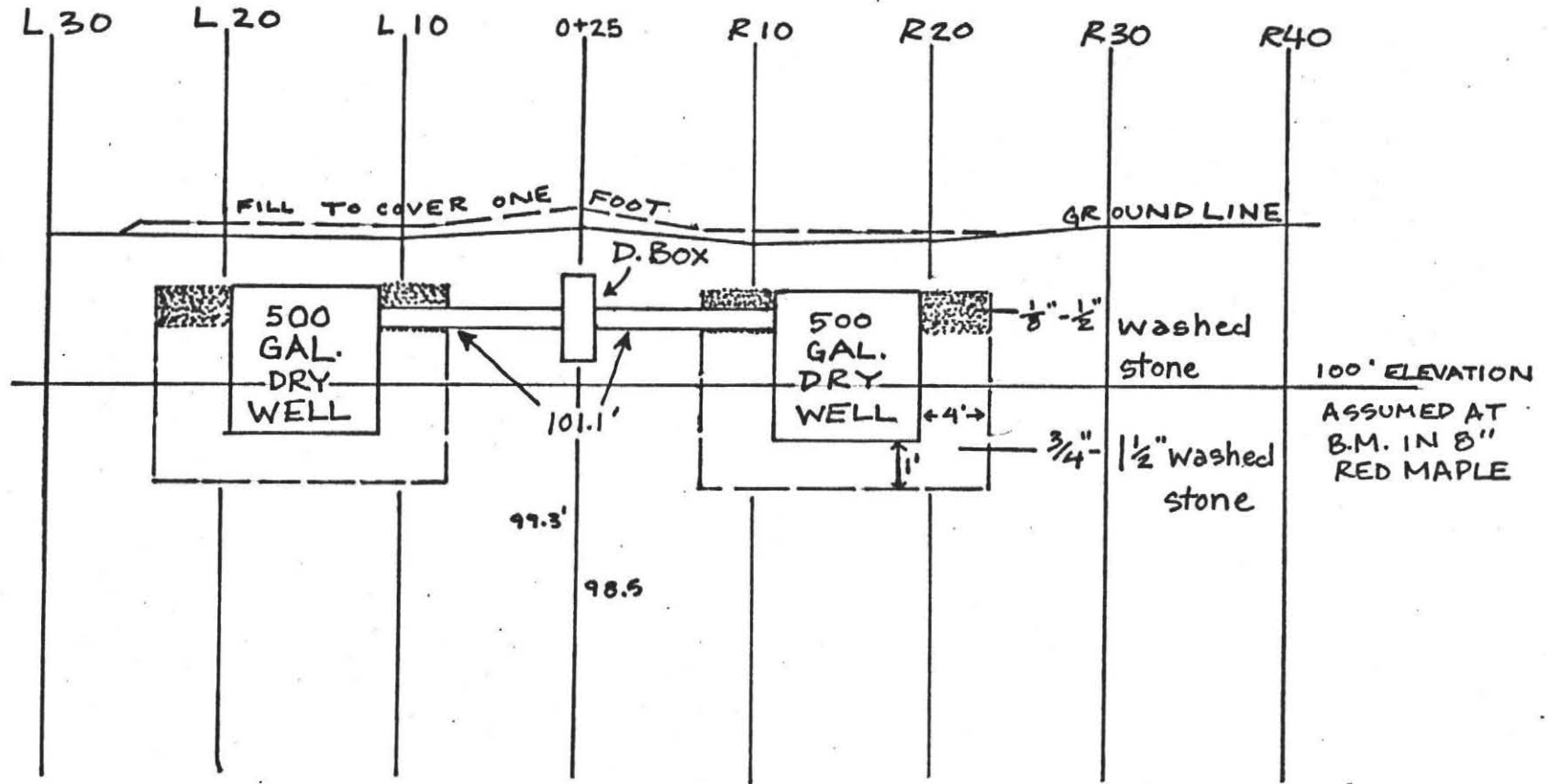



# PROFILE OF SEPTIC SYSTEM

FOR: Henry Whitlock  
181 North Street, Belchertown, MA.

DATE: Nov. 18, 1987

BY: FREDERICK A. FILIOS

SITE: Lot 143, Woodlot Lane, Amherst, MA.

SCALE: HORIZONTAL: 1" = 10'  
VERTICAL: 1" = 3'

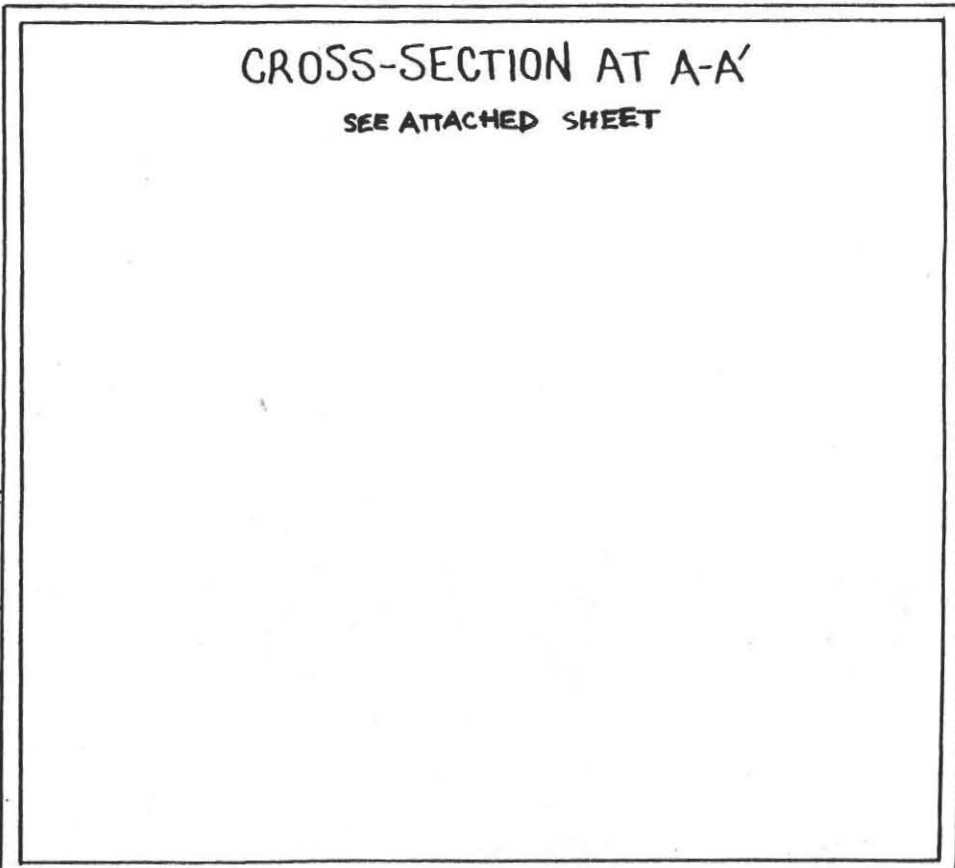
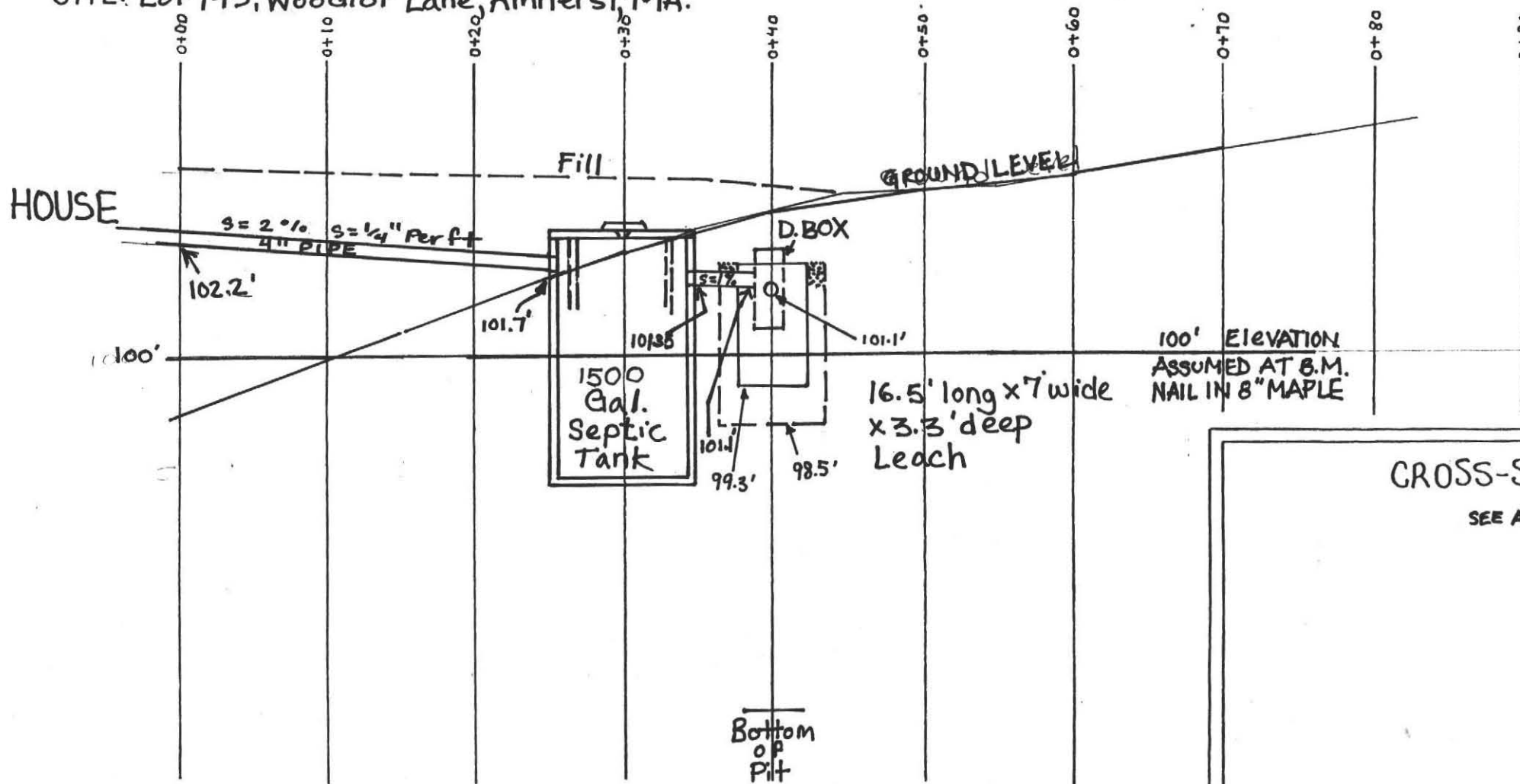

## SPECIFICATIONS

ALL MATERIALS AND CONSTRUCTION WILL BE IN ACCORDANCE WITH COMM. OF MASS. D.E.Q.E. STATE ENVIRONMENTAL CODE TITLE 5.

## CALCULATIONS

$4\text{Bdm} \times 110 = 440 + 50\% \text{ for GG} = 660 \times 125 = 825 \text{ gallons}$   
 Perc. Rate = 2 min/inch Sides = 2.5 gal/sq.ft. Bottom = 1.0 gal/sq.ft.  
 2 Leach Pits 16.5' long x 7' wide x 3.3' deep  
 Sides:  $16.5 \times 2.6' \times 2 = 85.8 \text{ sq.ft.} \times 2.5 \text{ gal/sq.ft.} = 214.5 \text{ gal.}$   
 $7' \times 2.6' \times 2 = 36.4 \text{ sq.ft.} \times 2.5 \text{ gal/sq.ft.} = 91.0 \text{ gal.}$   
 Bottom:  $16.5' \times 7' = 115.5 \text{ sq.ft.} \times 1.0 \text{ gal/sq.ft.} = 115.5 \text{ gal.}$   
 $421 \times 2 \text{ pits} = 842 \text{ gallons Total} \quad \underline{421.0 \text{ gal.}}$

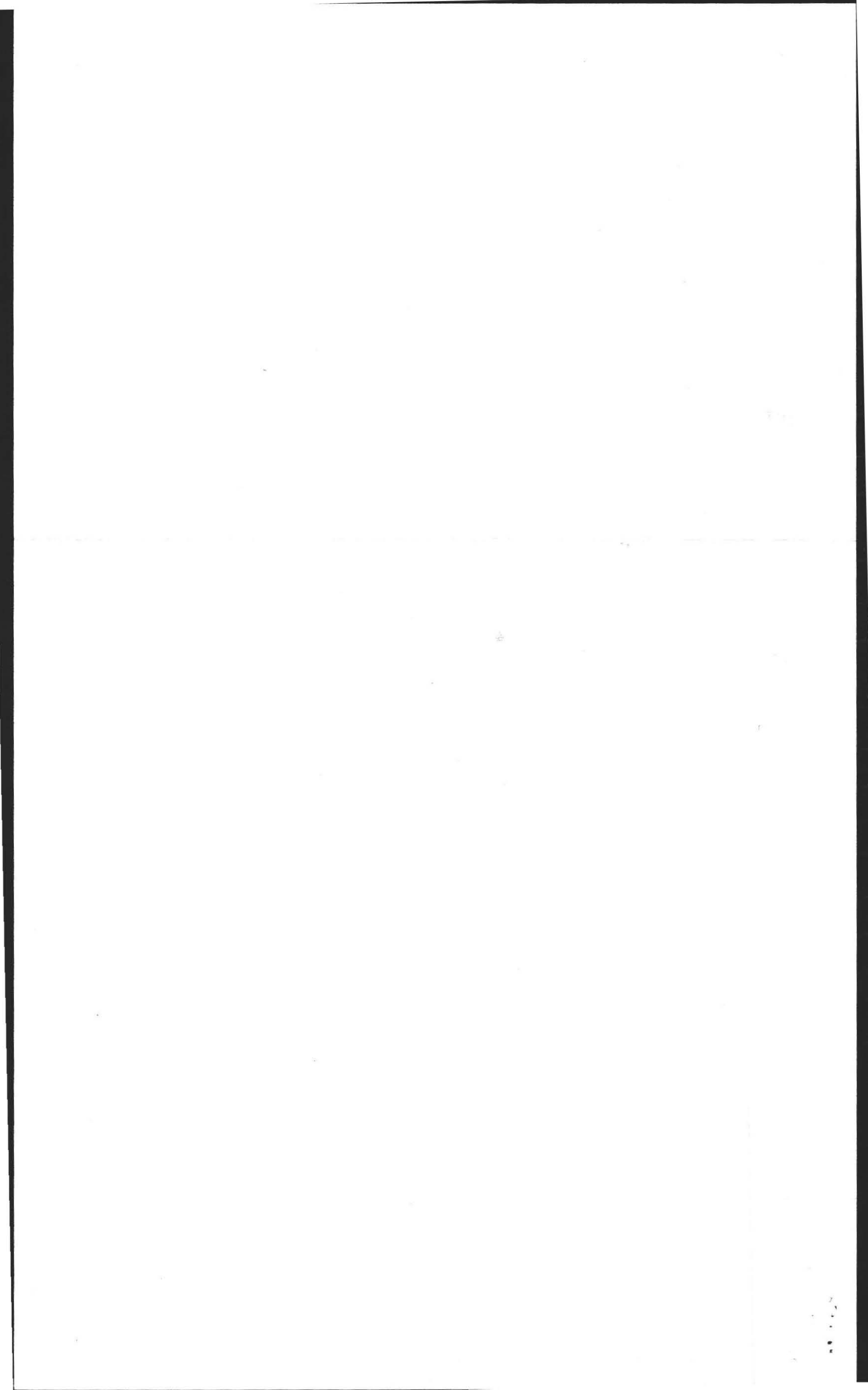

Betty / Dennis I did inform Designer that plans were still  
Problems still not corrected 142 + 143 deficient  
Whitlock Woodlot lane

(latest revisions)

310 CMR 15.02 (5)

- 1) location of percolation test not shown
  - 2) location of proposed water line
  - 3) plans should indicate there are no streams, surface, subsurface drains or wetlands within 100 feet If there are then locations should be specified on plan
- 15.03 (3) only one test pit shown minimum of 2 test pits required
- 15.06 (8) (9) Septic tank inlet and outlet tees required not shown
- 15.11 (10) plans do not indicate minimum 2 percent slope above and adjacent to leaching pit system to prevent accumulation of surface water

Also as previously recommended additional test pits should be conducted now to confirm consistent soils in septic area and confirm compliance with ground water requirements.

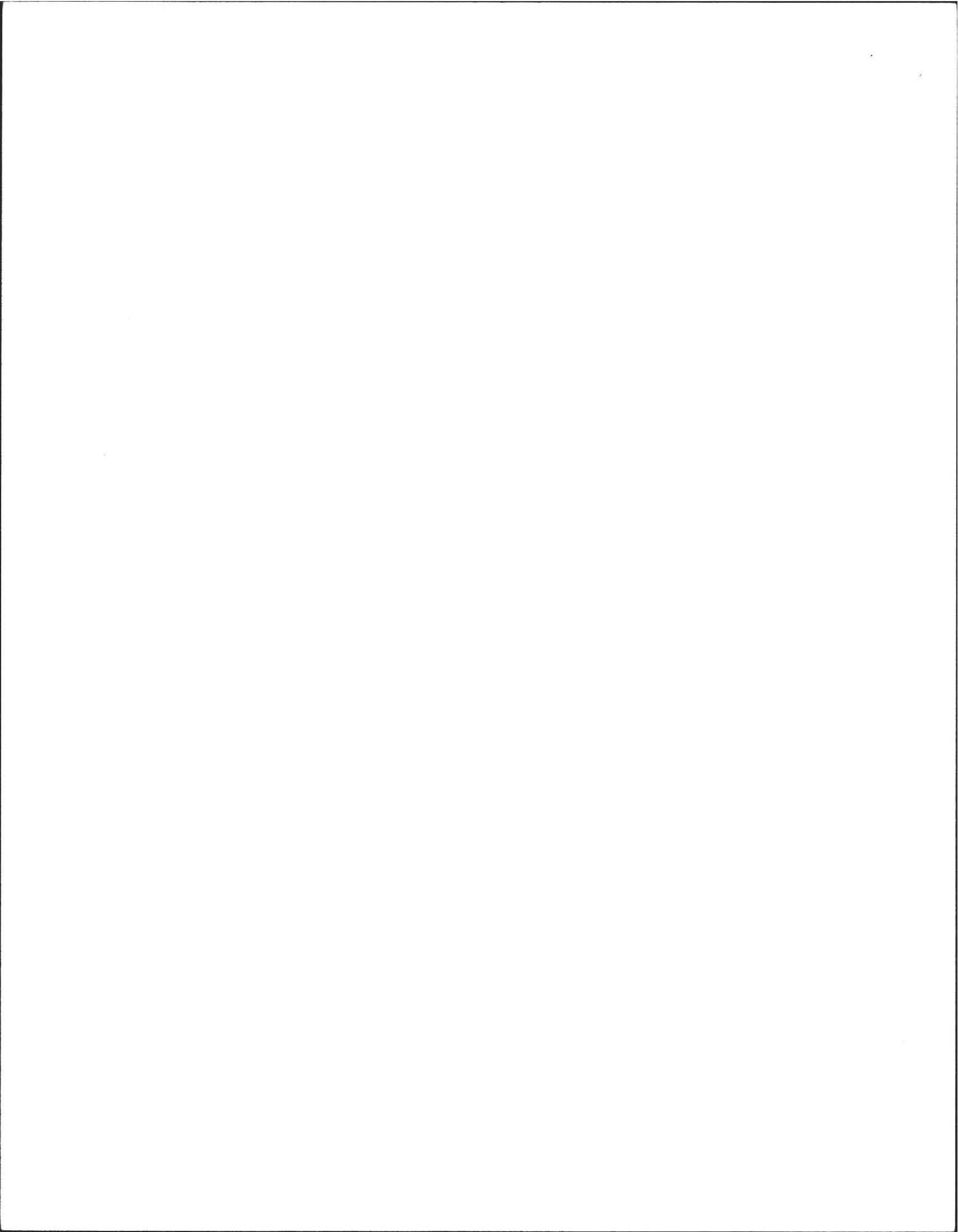

Henry Whitlock

DEEP SOIL LOGS

NOTE: Plan originally reviewed and rejected by P.K.

OWNER Jeffrey W. Flower

DATE March 5, 1986

LOCATION Lot 143 Amherst Woods  
Amherst, MA.

OBSERVER F.A. Filios

File copy

B of H C. Drake

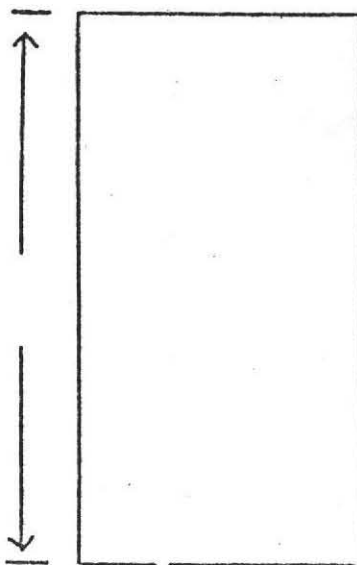
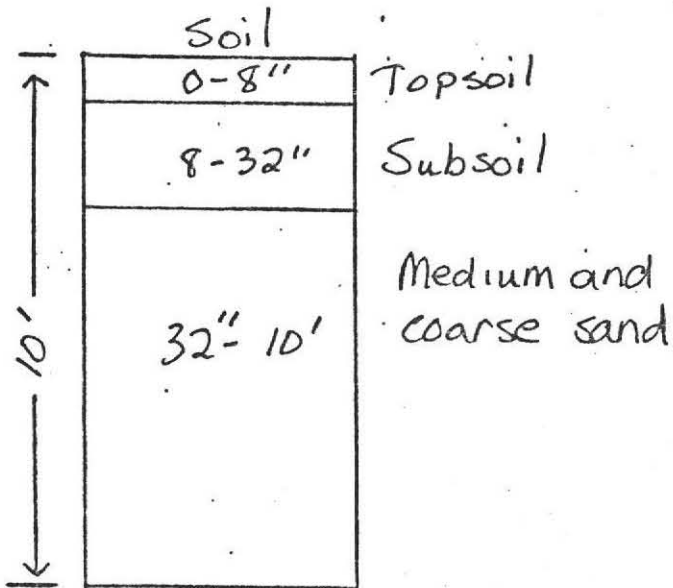

GROUND WATER none oxides at 66"  
5.5'

GROUND WATER \_\_\_\_\_

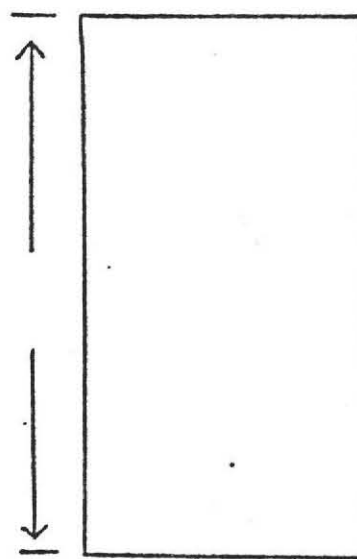
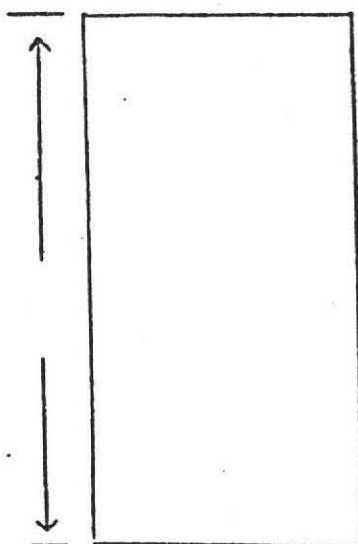

GROUND WATER \_\_\_\_\_

GROUND WATER \_\_\_\_\_

PERCOLATION RATE AT 42 :

< 2 min./inch







# PLAN SHOWING SEWAGE DISPOSAL SYSTEM

FOR: Henry Whitlock  
181 North Street  
Belchertown, MA.

BY: F.A. Filios w.t.  
69 Pelham Road  
Amherst, MA.

AT: Lot 143  
Woodlot Lane  
Amherst Woods  
Amherst, MA.

SCALE: 1"=40'

DATE: May 22, 1987

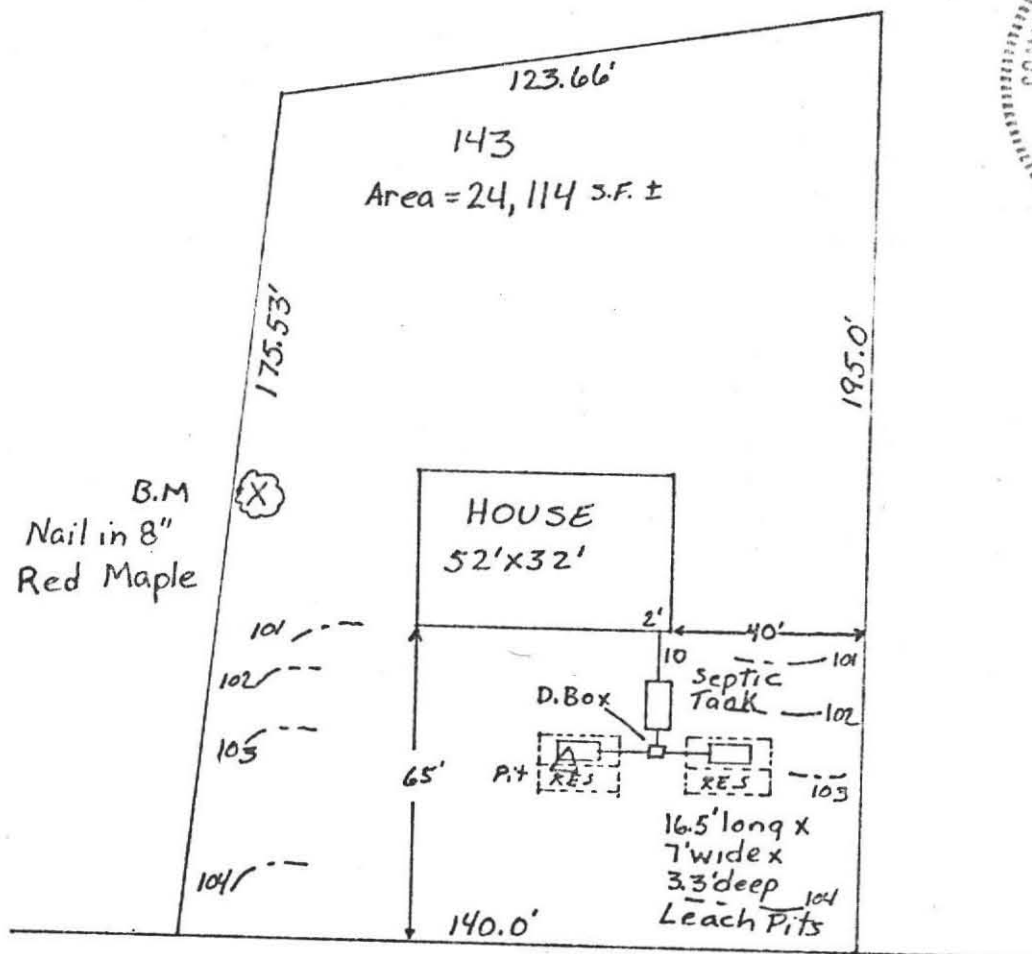

WOODLOT LANE

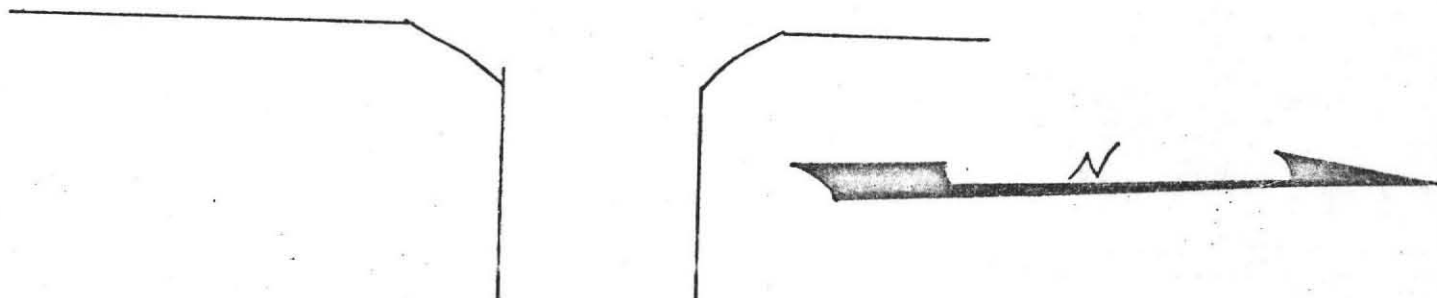



# PROFILE OF SEPTIC SYSTEM

FOR: Henry Whitlock  
181 North Street, Belchertown, MA.

BY: FREDERICK A. FILIOS w.t.  
DATE: May 21, 1987  
SCALE: HORIZONTAL: 1" = 10'  
VERTICAL: 1" = 3'

SITE: Lot 143, Woodlot Lane, Amherst, MA.

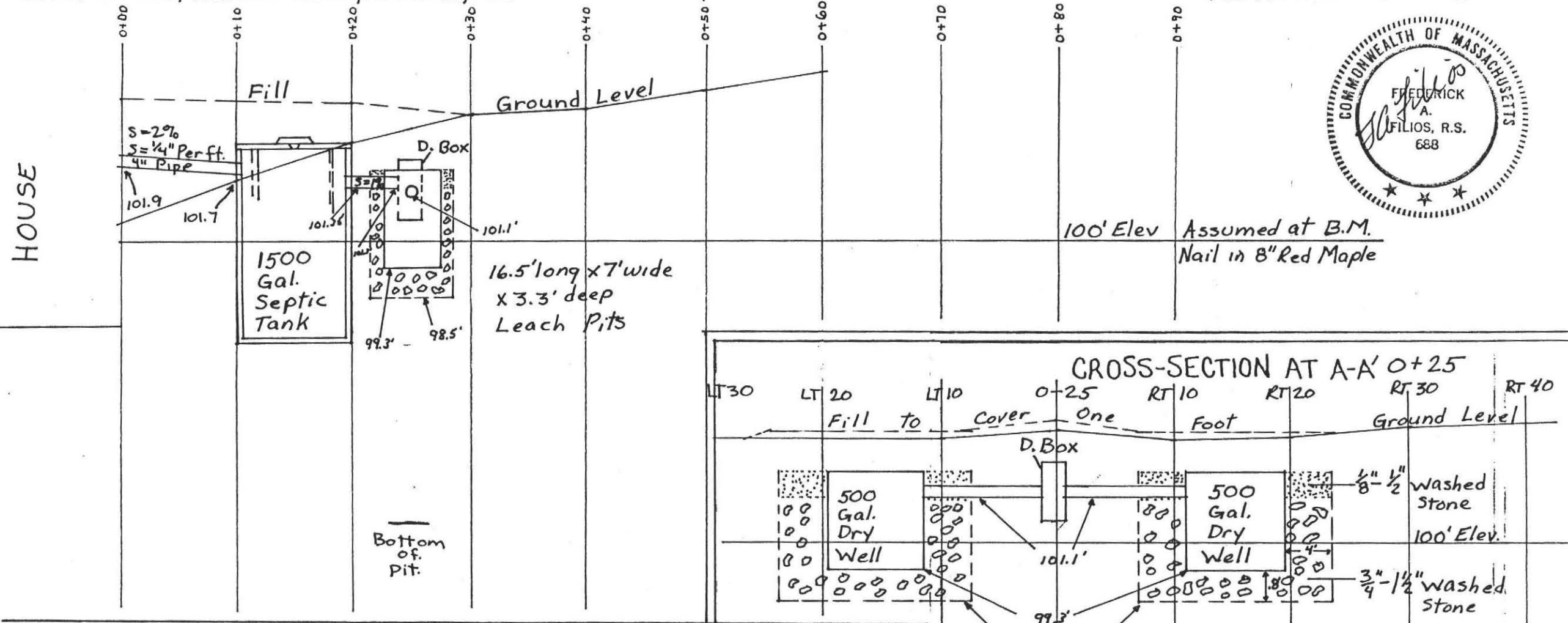

100' Elev Assumed at B.M.  
Nail in 8" Red Maple

## SPECIFICATIONS

ALL MATERIALS AND CONSTRUCTION WILL BE IN ACCORDANCE WITH COMM. OF MASS. D.E.Q.E. STATE ENVIRONMENTAL CODE TITLE 5.

## CALCULATIONS

$4Bdm \times 110 = 440 + 50\% \text{ for G.G.} = 660 \times 1.25 = 825 \text{ gallons}$   
 Perc Rate = 2 min/inch Sides =  $2.5 \text{ gal./s.f.}$  Bottom =  $1.0 \text{ gal./s.f.}$   
 2 Leach Pits 16.5' long x 7' wide x 3.3' deep  
 Sides:  $16.5' \times 2.6' \times 2 = 85.8 \text{ s.f.} \times 2.5 \text{ gal./s.f.} = 214.5 \text{ gal.}$   
 $7' \times 2.6' \times 2 = 36.4 \text{ s.f.} \times 2.5 \text{ gal./s.f.} = 91.0 \text{ gal.}$   
 Bottom:  $16.5' \times 7' = 115.5 \text{ s.f.} \times 1.0 \text{ gal./s.f.} = 115.5 \text{ gal.}$   
 $214.5 + 91.0 + 115.5 = 421.0 \text{ gal.}$

