

No. 86-63

#36

THE COMMONWEALTH OF MASSACHUSETTS

BOARD OF HEALTH

Town of Amherst

Application for Disposal Works Construction Permit



Application is hereby made for a Permit to Construct ( ) or Repair ( ) an Individual Sewage Disposal System at:

36 Trillium Way, Amherst Woods, 65  
Therese Maguire, 106 North Street, Belchertown, MA  
Dean Bennett

Type of Building Dwelling - No. of Bedrooms 4 Expansion Attic ( ) Garbage Grinder (NO)  
Other - Type of Building No. of persons Showers ( ) - Cafeteria ( )  
Other fixtures

Design Flow 55 gallons per person per day. Total daily flow 440 gallons.  
Septic Tank - Liquid capacity 1000 gallons Length 8 1/2' Width 5' Diameter 5' Depth 5'  
Disposal Trench - No. 3, 40' Width 2' Total Length 120' Total leaching area 360 sq. ft. sides  
Seepage Pit No. Diameter Depth below inlet Total leaching area 240 sq. ft. Bottom  
Other Distribution box ( ) Dosing tank ( )  
Percolation Test Results Performed by F.A. Elias Date 4/23/85  
Test Pit No. 1 10 minutes per inch Depth of Test Pit 8' Depth to ground water NONE  
Test Pit No. 2 minutes per inch Depth of Test Pit Depth to ground water

Description of Soil Enclosed SUGGEST TRENCHES BE WIDENED TO 3' RATHER THAN 2'

Nature of Repairs or Alterations - Answer when applicable

Agreement: The undersigned agrees to install the aforescribed Individual Sewage Disposal System in accordance with the provisions of TITLE 5 of the State Sanitary Code - The undersigned further agrees not to place the system in operation until a Certificate of Compliance has been issued by the board of health.

Signed Therese Parquale Maguire Oct 22, 1986  
CED

Application Approved By Date 10-23-86

Application Disapproved for the following reasons:

Permit No. 86-63 Issued 10-23-86 Date

9/3/87 Checked installation during construction - septic tank set.

THE COMMONWEALTH OF MASSACHUSETTS

BOARD OF HEALTH

Town of Amherst

Certificate of Compliance

THIS IS TO CERTIFY, That the Individual Sewage Disposal System constructed (X) or Repaired ( ) by Dean Bennett Installer at Lot # 65 Trillium Way - Amherst Woods has been installed in accordance with the provisions of TITLE 5 of The State Sanitary Code as described in the application for Disposal Works Construction Permit No. 86-63 dated 10/23/86

THE ISSUANCE OF THIS CERTIFICATE SHALL NOT BE CONSTRUED AS A GUARANTEE THAT THE SYSTEM WILL FUNCTION SATISFACTORY.

DATE 9/8/87 Inspector for Amherst Bd of Hth. D. Pinkie

THE COMMONWEALTH OF MASSACHUSETTS

BOARD OF HEALTH

Town of Amherst

No. 86-63

Fee \$90

Disposal Works Construction Permit

Permission is hereby granted T.B. Maguire to Construct (X) or Repair ( ) an Individual Sewage Disposal System at No. Lot 65 Trillium Way

as shown on the application for Disposal Works Construction Permit No. 86-63 Dated 10-23-86

DATE 10-23-86 Board of Health

CHECK OR FILL IN WHERE APPLICABLE

Because present digging ~~work~~ of trenches would cause destruction of a number of attractive trees would simply like to start trenches ~ 15'-20' south (but on same exact line) and therefore run them 15'-20' further south. The whole area in question is open graded. Nothing else would change.

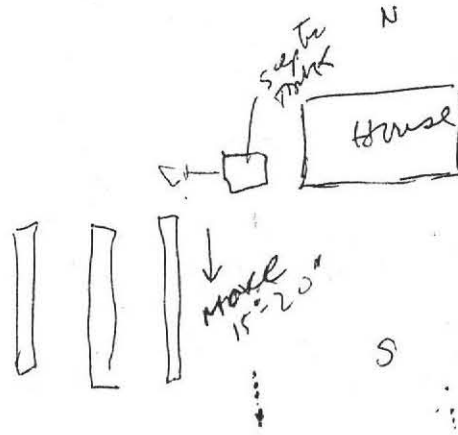

Please check out the Kinderhook town  
and also Helen Mitchell  
House on Monday

Thanks

Re:

CD

KC

No. \_\_\_\_\_

THE COMMONWEALTH OF MASSACHUSETTS  
BOARD OF HEALTH

Town of Amherst

Application for Disposal Works Construction Permit

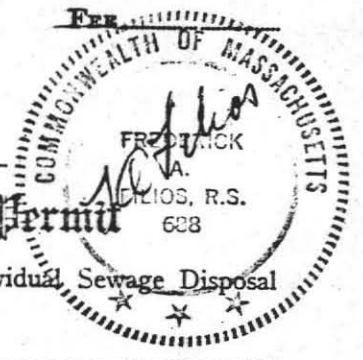

Application is hereby made for a Permit to Construct ( ) or Repair ( ) an Individual Sewage Disposal System at:

Location - Address: Trillium Way, Amherst Woods, Lot No. 65  
Therese Maguire Owned 106 North Street, Belchertown, MA. Address

Installer \_\_\_\_\_ Address \_\_\_\_\_  
Type of Building \_\_\_\_\_ Size Lot 1006 Acres \_\_\_\_\_  
Dwelling — No. of Bedrooms 4 Expansion Attic ( ) \_\_\_\_\_ Garbage Grinder ( NO )  
Other — Type of Building \_\_\_\_\_ No. of persons \_\_\_\_\_ Showers ( ) — Cafeteria ( )  
Other fixtures \_\_\_\_\_

Design Flow 55 gallons per person per day. Total daily flow 440 gallons.  
Septic Tank — Liquid capacity 1000 gallons Length 8 1/2' Width 5' Diameter 7' Depth 5'  
Disposal Trench — No. 3, 40' Width 2' Total Length 120' Total leaching area 360 sq. ft. Sides  
Seepage Pit No. \_\_\_\_\_ Diameter \_\_\_\_\_ Depth below inlet \_\_\_\_\_ Total leaching area 240 sq. ft. Bottom  
Other Distribution box ( ) \_\_\_\_\_ Dosing tank ( ) \_\_\_\_\_  
Percolation Test Results Performed by F.A. Felios Date 4/23/85  
Test Pit No. 1. 10 minutes per inch Depth of Test Pit 8' Depth to ground water NONE  
Test Pit No. 2. \_\_\_\_\_ minutes per inch Depth of Test Pit \_\_\_\_\_ Depth to ground water \_\_\_\_\_

Description of Soil ENCLOSED

Nature of Repairs or Alterations — Answer when applicable \_\_\_\_\_

Agreement:  
The undersigned agrees to install the aforescribed Individual Sewage Disposal System in accordance with the provisions of TITLE 5 of the State Sanitary Code — The undersigned further agrees not to place the system in operation until a Certificate of Compliance has been issued by the board of health.

Signed Therese Maguire Date Oct 22, 1986

Application Approved By \_\_\_\_\_ Date \_\_\_\_\_

Application Disapproved for the following reasons: \_\_\_\_\_  
Date \_\_\_\_\_

Permit No. \_\_\_\_\_ Issued \_\_\_\_\_ Date \_\_\_\_\_

THE COMMONWEALTH OF MASSACHUSETTS  
BOARD OF HEALTH

OF \_\_\_\_\_  
Certificate of Compliance

THIS IS TO CERTIFY, That the Individual Sewage Disposal System constructed ( ) or Repaired ( ) by \_\_\_\_\_ Installer \_\_\_\_\_

at \_\_\_\_\_ has been installed in accordance with the provisions of TITLE 5 of The State Sanitary Code as described in the application for Disposal Works Construction Permit No. \_\_\_\_\_ dated \_\_\_\_\_

THE ISSUANCE OF THIS CERTIFICATE SHALL NOT BE CONSTRUED AS A GUARANTEE THAT THE SYSTEM WILL FUNCTION SATISFACTORY.

DATE \_\_\_\_\_ Inspector \_\_\_\_\_

CHECK OR FILL IN WHERE APPLICABLE

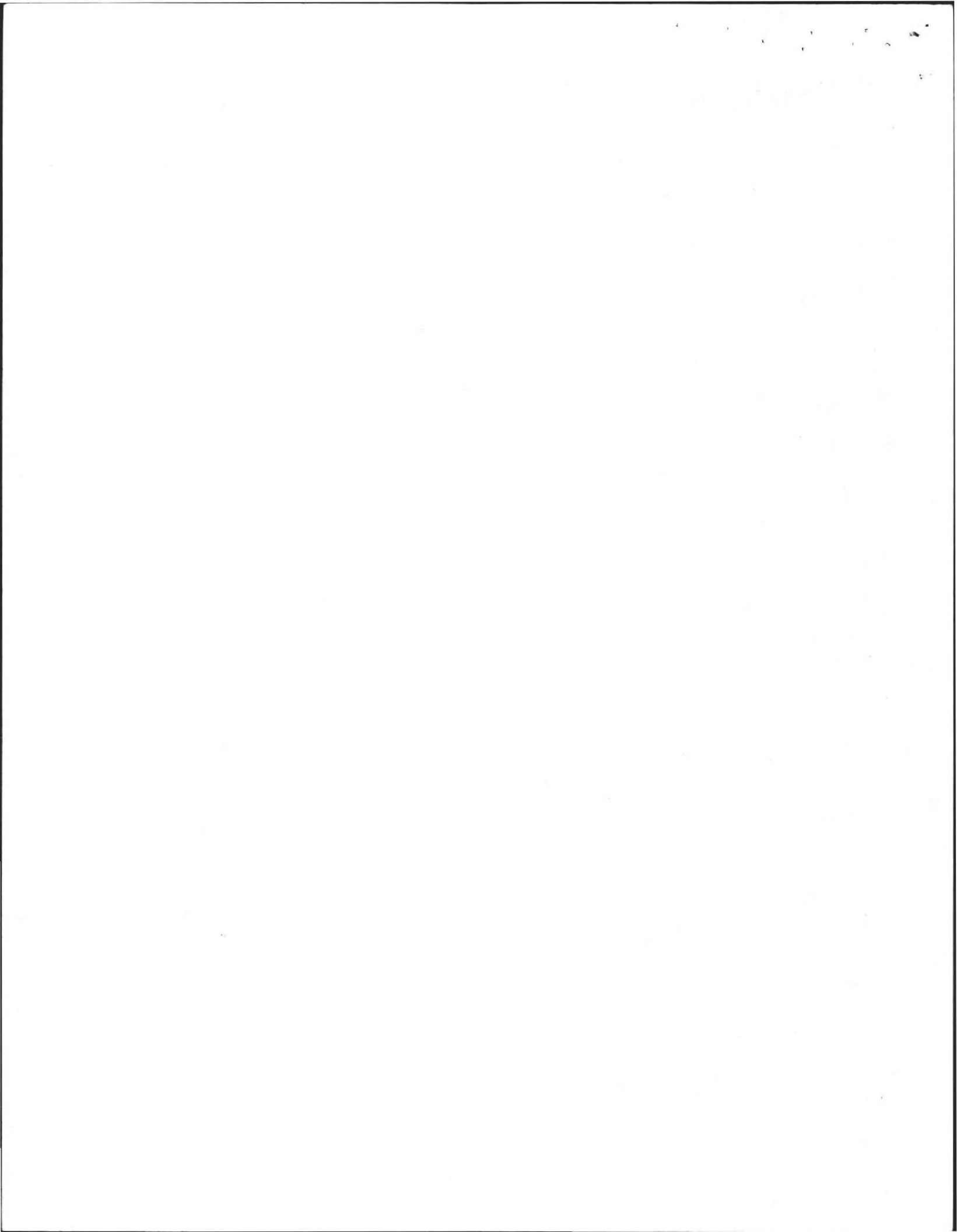

DEEP SOIL LOGS

OWNER Amherst Woods Inc.

DATE April 23, 1985

LOCATION Amherst Woods  
Lot # 65

OBSERVER F.A. Filios

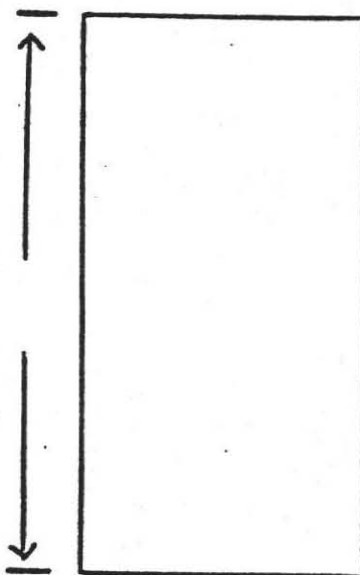
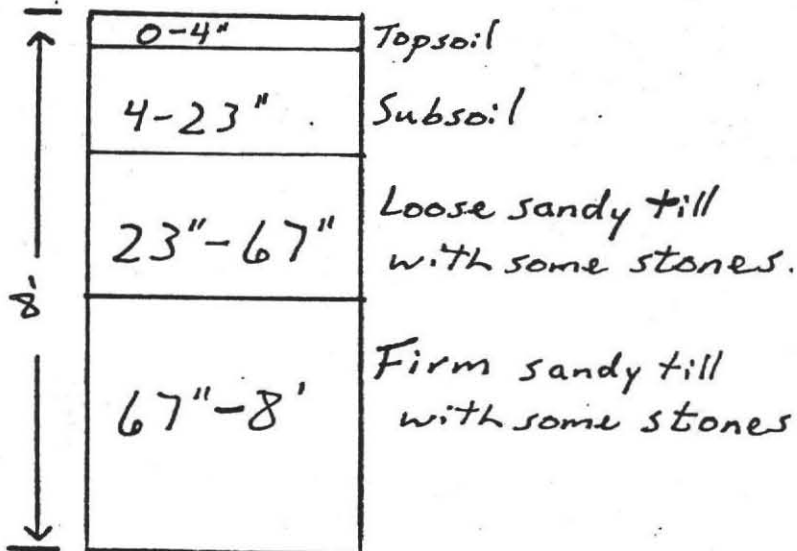

GROUND WATER None

GROUND WATER \_\_\_\_\_

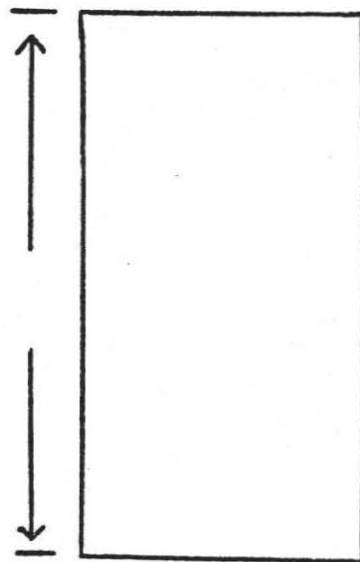
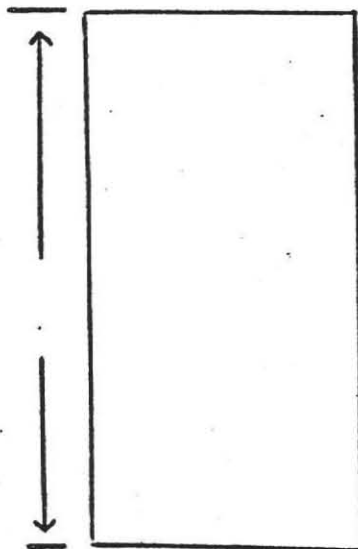

GROUND WATER \_\_\_\_\_

GROUND WATER \_\_\_\_\_

Percolation Rate at 30":

10min/inch

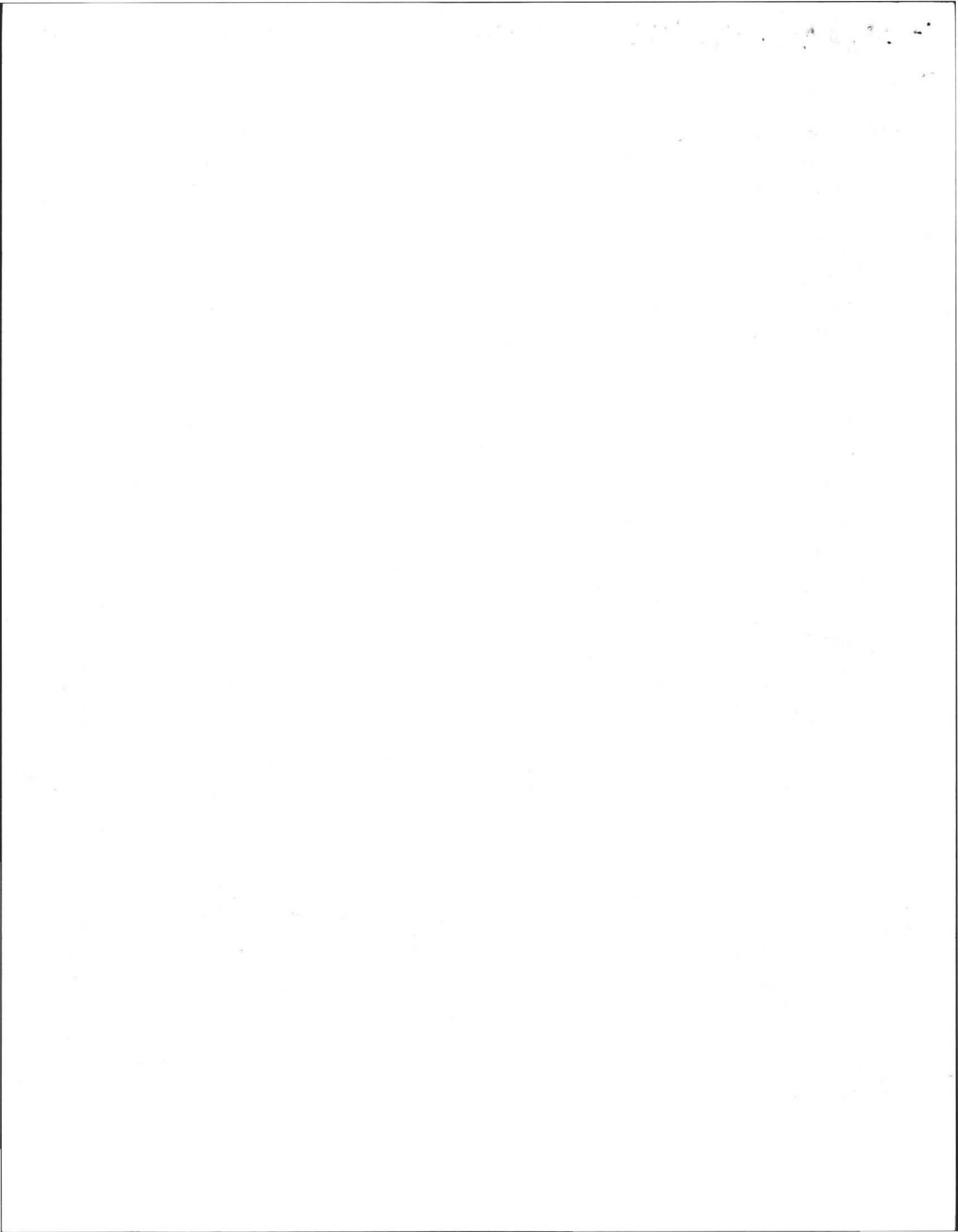

# PLAN SHOWING SEWAGE DISPOSAL SYSTEM

FOR: Therese Maguire  
106 North Street  
Belchertown, MA. 01007

BY: F.A. Filios  
69 Pelham Road  
Amherst, MA.

SITE: Lot 65  
Trillium Way  
Amherst Woods  
Amherst, MA.

SCALE: 1"=40'

DATE: October 21, 1986

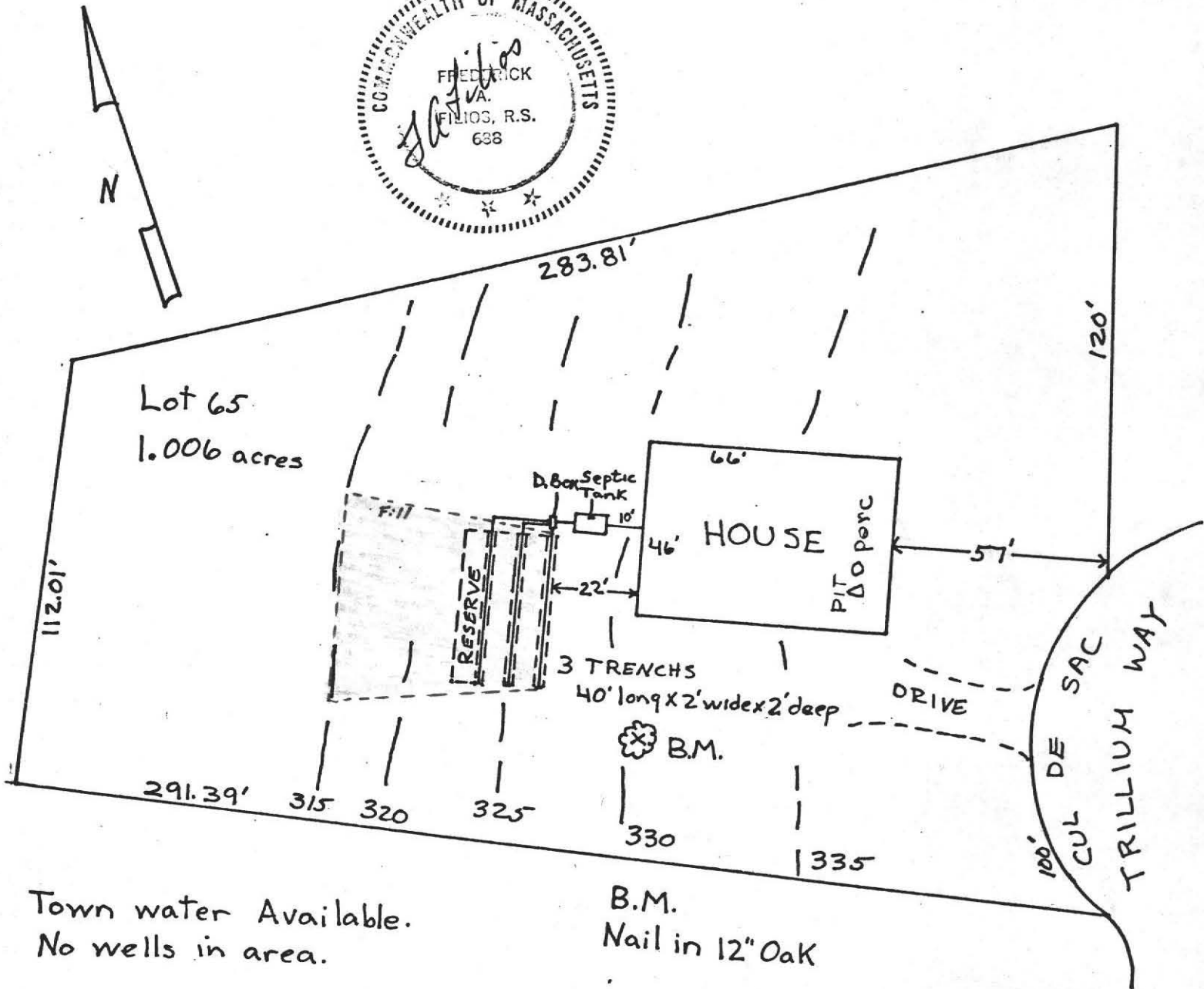

Town water Available.  
No wells in area.

B.M.  
Nail in 12" Oak

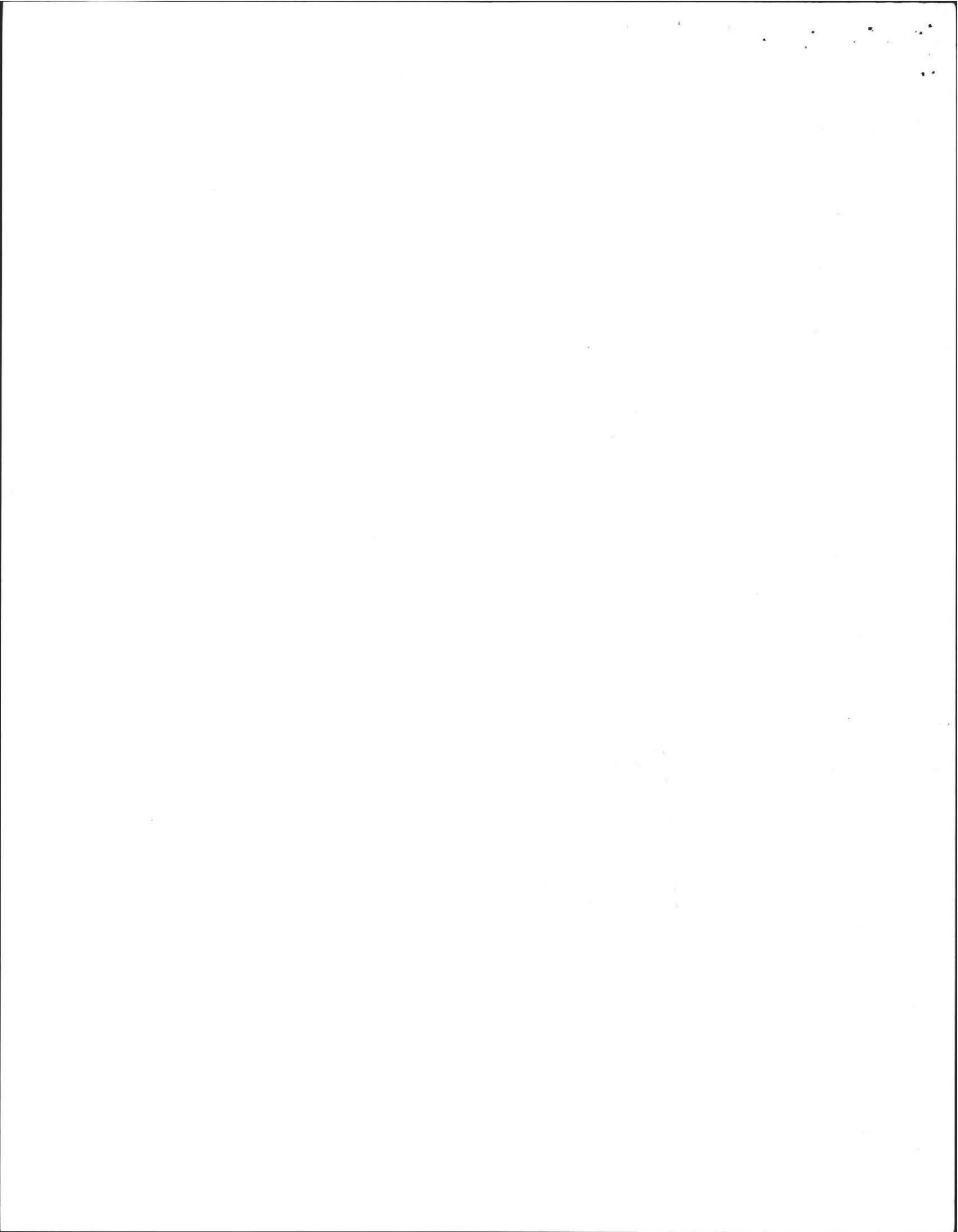



# PROFILE OF SEPTIC SYSTEM

FOR: Therese Maguire  
106 North Street, Belchertown, MA.  
 SITE: Lot 65, Trillium Way  
Amherst Woods, Amherst

BY: Frederick A. Filios  
69 Pelham Road  
Amherst, MA  
01002

DATE: October 21, 1986  
 SCALE: Horizontal: 1" = 10'  
 Vertical: 1" = 3'

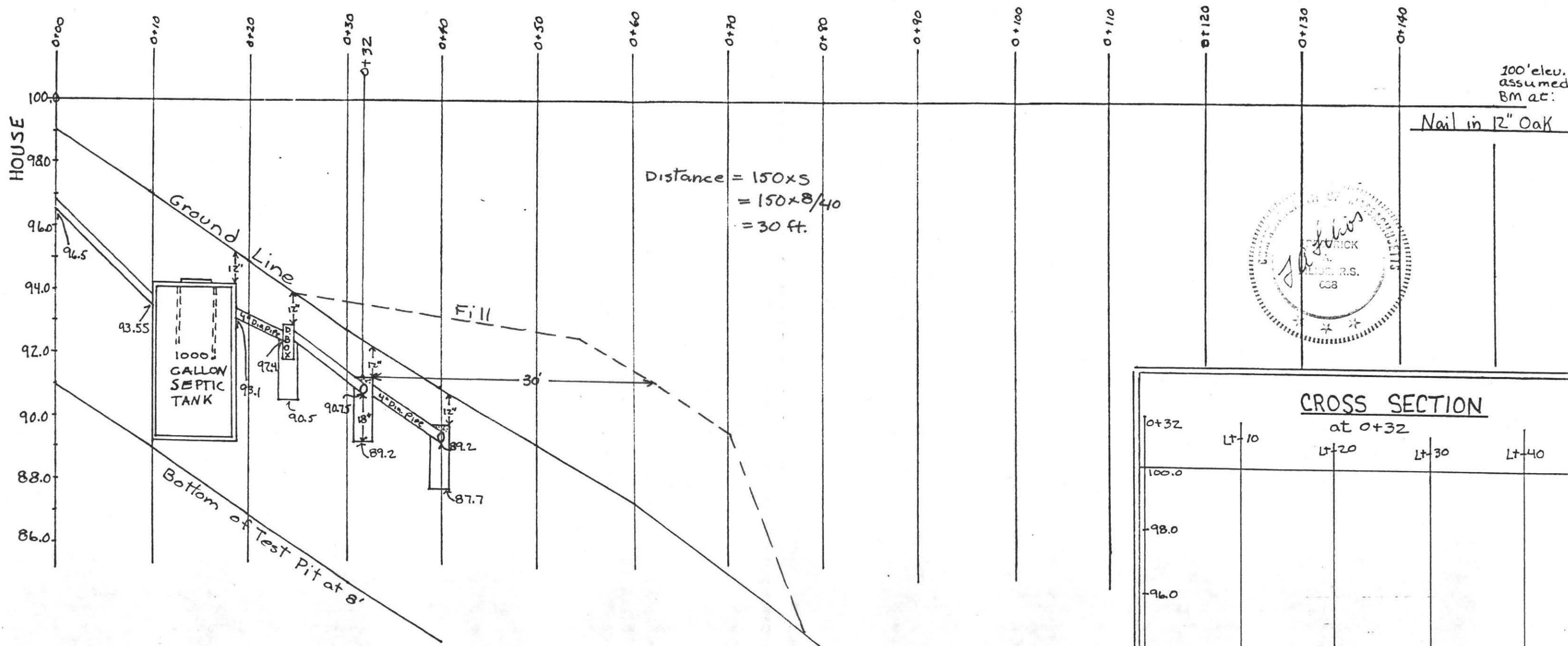

## SPECIFICATIONS

ALL MATERIALS AND CONSTRUCTION WILL BE IN ACCORDANCE WITH COMM. OF MASS. D.E.Q.E. STATE ENVIRONMENTAL CODE TITLE 5.

## CALCULATIONS

4 Bdms x 110 = 440 gallons required  
 Perc Rate = 10 min./inch sides: 1.00 gal./s.F.  
 Bottom = .55 gal./s.F.  
 Leach Trenches: 3, 40' long x 2' wide x 2' deep  
 Sides: 3 x 40 x 1.5 x 2 = 360 s.F. x 1.0 gal./s.F. = 360 gal.  
 Bottom: 3 x 40 x 2 = 240 s.F. x 0.55 gal./s.F. = 132 gal.  
 Proposed Available = 492 gallons

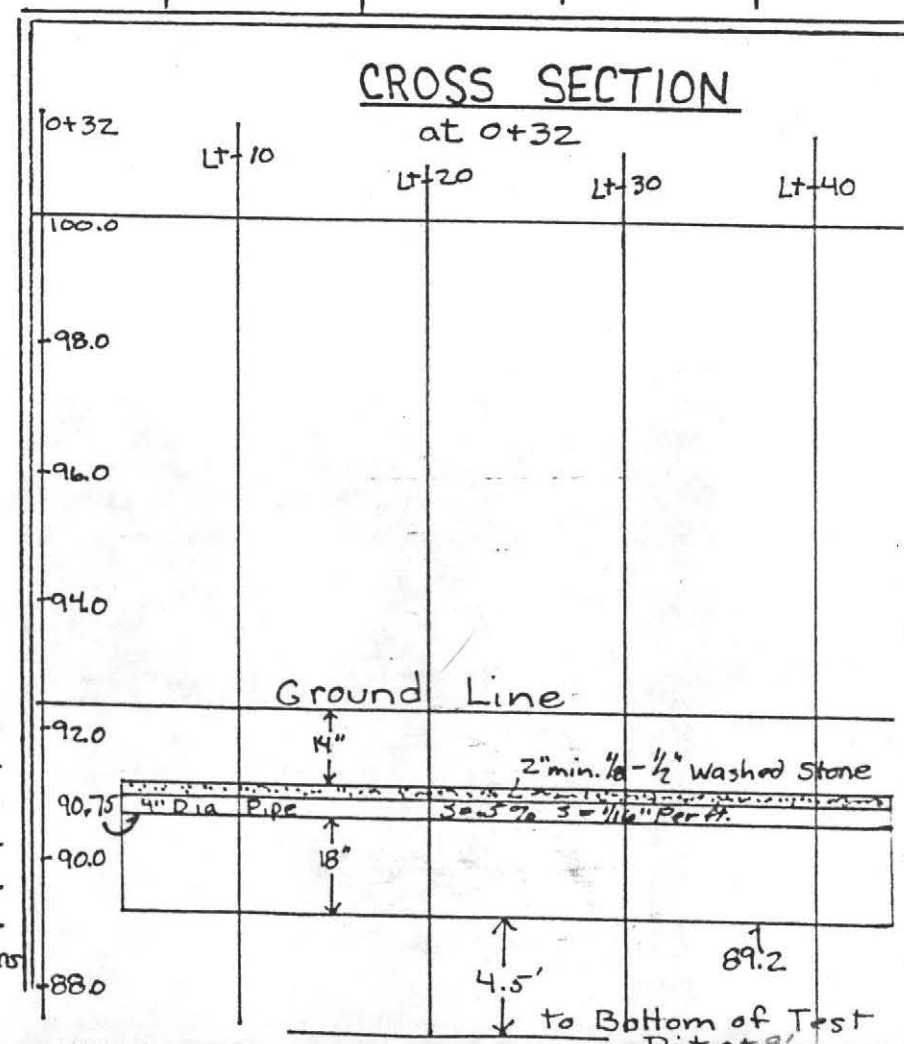

Because present ~~drawing~~ of structure  
 would cause destruction of a number of  
 mature trees would simply like to start  
 trench n 15'-20' south (but on same exact  
 line) and regrade run from 15'-20' further  
 south. The whole area in question is open  
 graded. Nothing else would change.

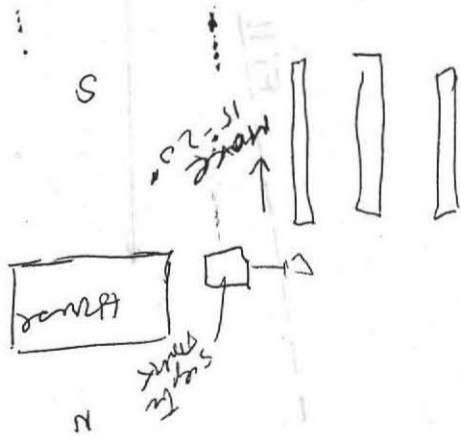

any: Please check out the Kuitigaon  
 Ave close Helen Mitchell  
 on Monday

Shanta

cap

Re: Helen Mitchell

Kathly Blutche

Kathly Ben

Thanks the

head

can done

head

Any school as  
involved?

# PLAN SHOWING SEWAGE DISPOSAL SYSTEM

FOR: Therese Maguire  
 106 North Street  
 Belchertown, MA. 01007

BY: F.A. Filios  
 69 Pelham Road  
 Amherst, MA.

SITE: Lot 65  
 Trillium Way  
 Amherst Woods  
 Amherst, MA.

SCALE: 1"=40'

DATE: October 21, 1986

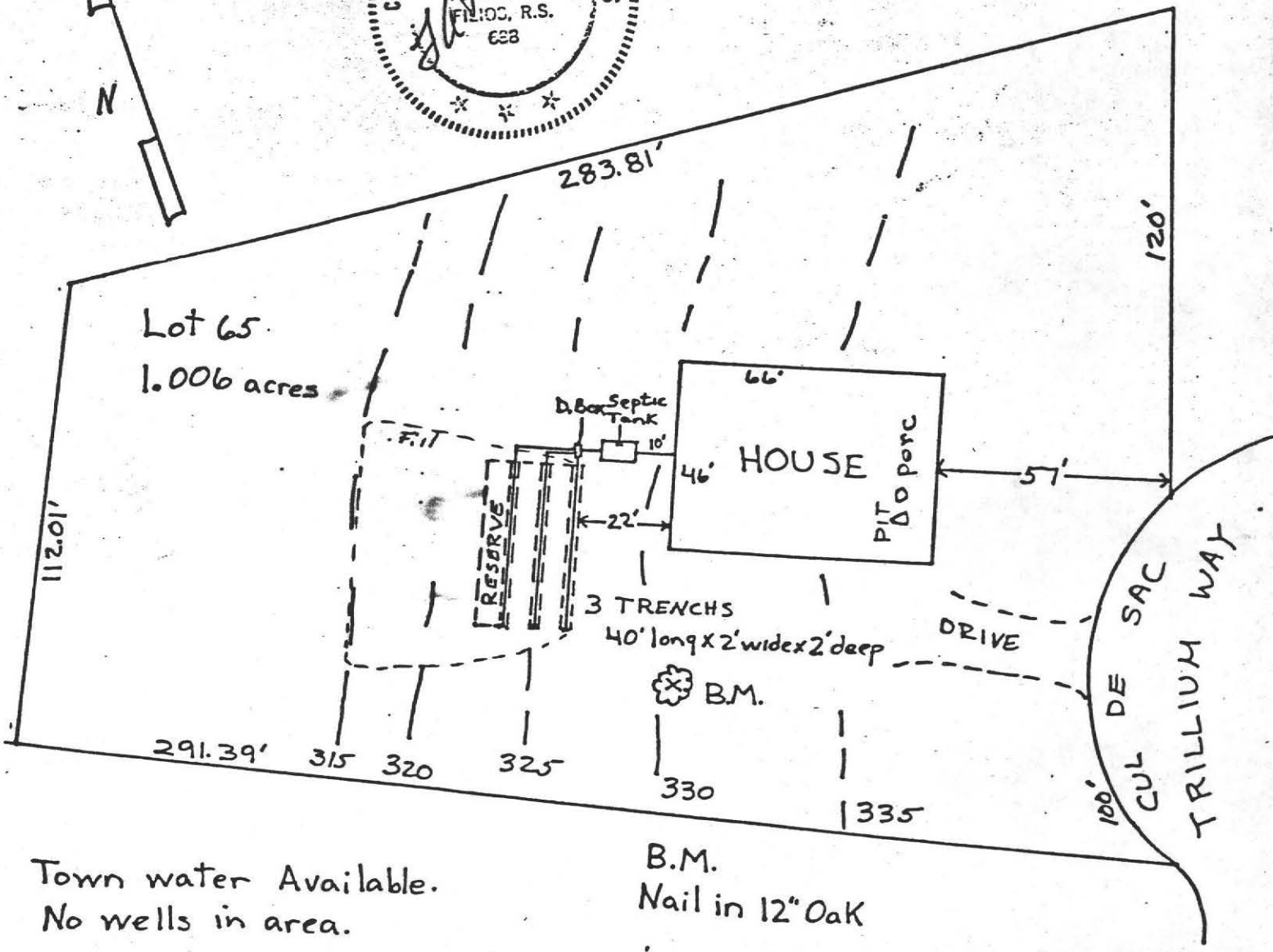

Town water Available.  
 No wells in area.

B.M.  
 Nail in 12" Oak

Because present digging ~~work~~ of trenches would cause destruction of a number of attractive trees would simply like to start trenches ~ 15'-20' south (but on same exact line) and therefore run them 15'-20' further south. The whole area in question is open graded. Nothing else would change.

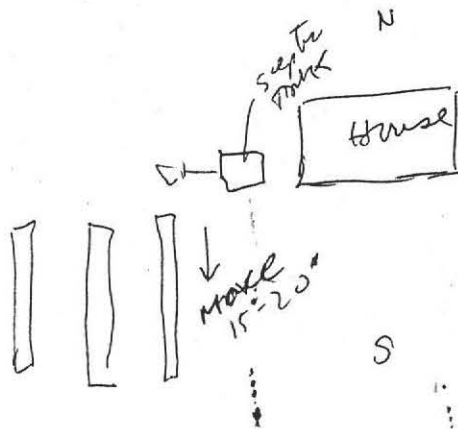

No. \_\_\_\_\_

THE COMMONWEALTH OF MASSACHUSETTS

BOARD OF HEALTH

Town of Amherst

Application for Disposal Works Construction Permit

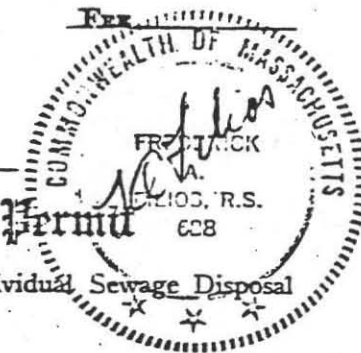

Application is hereby made for a Permit to Construct ( ) or Repair ( ) an Individual Sewage Disposal System at:

Trillium Way, Amherst Woods, 65

Location - Address

Therese Maguire

Owner

or Lot No.

106 North Street, Belchertown, MA

Address

Type of Building

Address Size Lot 1.006 Acres

Dwelling - No. of Bedrooms 4 Expansion Attic ( ) Garbage Grinder (NO)

Other - Type of Building \_\_\_\_\_ No. of persons \_\_\_\_\_ Showers ( ) - Cafeteria ( )

Other fixtures \_\_\_\_\_

Design Flow 5.5 gallons per person per day. Total daily flow 440 gallons.

Septic Tank - Liquid capacity 1000 gallons Length 8 1/2' Width 5' Diameter 2' Depth 5'

Disposal Trench - No. 3, 40' Width 2' Total Length 120' Total leaching area 360 sq. ft. sides

Seepage Pit No. \_\_\_\_\_ Diameter \_\_\_\_\_ Depth below inler \_\_\_\_\_ Total leaching area 240 sq. ft. Bottom

Other Distribution box ( ) Dosing tank ( )

Percolation Test Results Performed by F.A. Elias Date 4/23/85

Test Pit No. 1 10 minutes per inch Depth of Test Pit 8' Depth to ground water NONE

Test Pit No. 2 \_\_\_\_\_ minutes per inch Depth of Test Pit \_\_\_\_\_ Depth to ground water \_\_\_\_\_

Description of Soil Enclosed

Nature of Repairs or Alterations - Answer when applicable

Agreement:

The undersigned agrees to install the aforescribed Individual Sewage Disposal System in accordance with the provisions of TITLE 5 of the State Sanitary Code - The undersigned further agrees not to place the system in operation until a Certificate of Compliance has been issued by the board of health.

Signed Therese Maguire Date 4/23/85

Application Approved By \_\_\_\_\_ Date \_\_\_\_\_

Application Disapproved for the following reasons: \_\_\_\_\_ Date \_\_\_\_\_

Permit No. \_\_\_\_\_

Issued \_\_\_\_\_ Date \_\_\_\_\_

THE COMMONWEALTH OF MASSACHUSETTS

BOARD OF HEALTH

OF \_\_\_\_\_

Certificate of Compliance

THIS IS TO CERTIFY, That the Individual Sewage Disposal System constructed ( ) or Repaired ( ) by \_\_\_\_\_

at \_\_\_\_\_ Installer \_\_\_\_\_

has been installed in accordance with the provisions of TITLE 5 of The State Sanitary Code as described in the application for Disposal Works Construction Permit No. \_\_\_\_\_ dated \_\_\_\_\_

THE ISSUANCE OF THIS CERTIFICATE SHALL NOT BE CONSTRUED AS A GUARANTEE THAT THE

CHECK OR FILL IN WHERE APPLICABLE

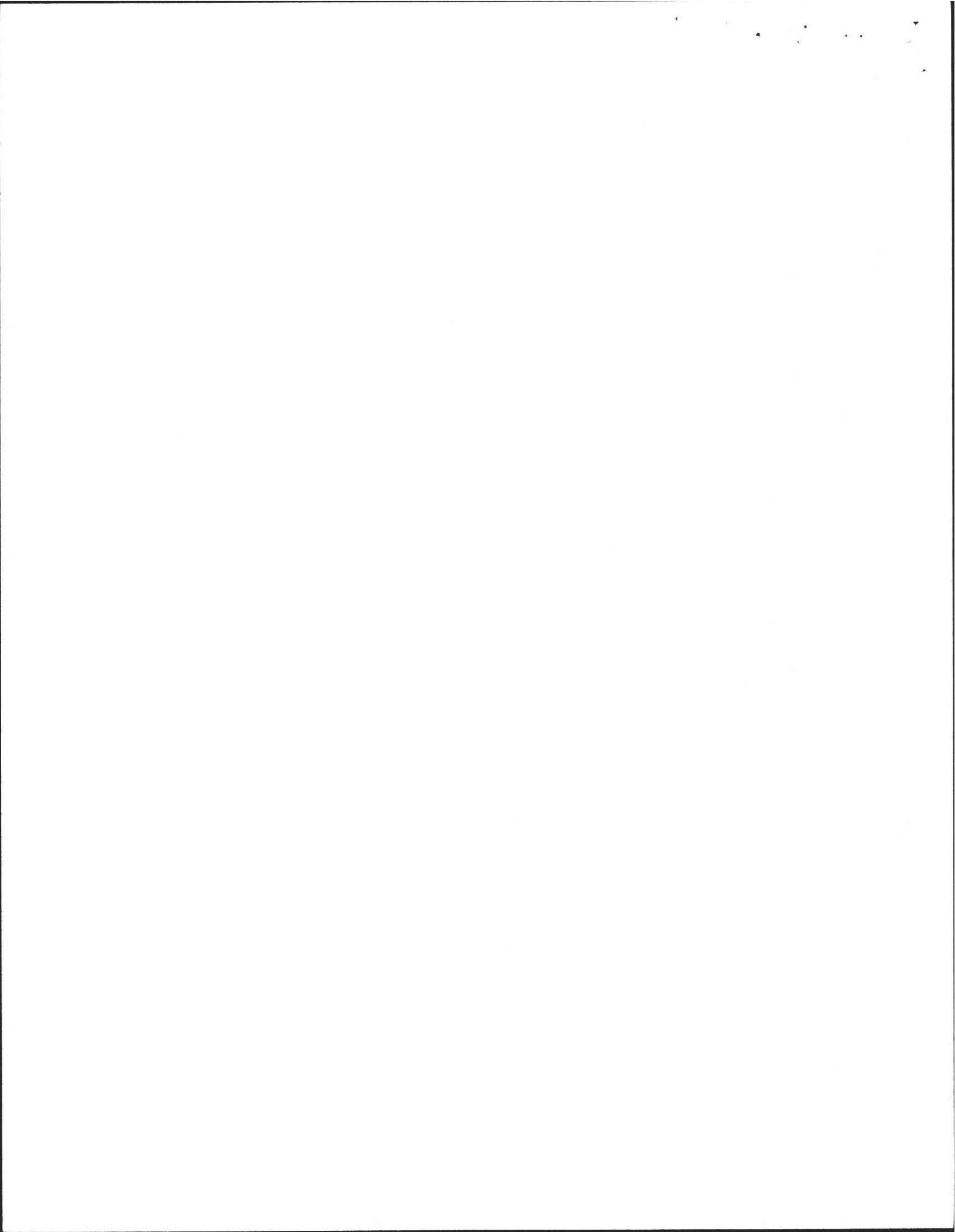



DEEP SOIL LOGS

OWNER Amherst Woods Inc.

DATE April 23, 1985

LOCATION Amherst Woods

OBSERVER F.A. Filios

Lot # 65

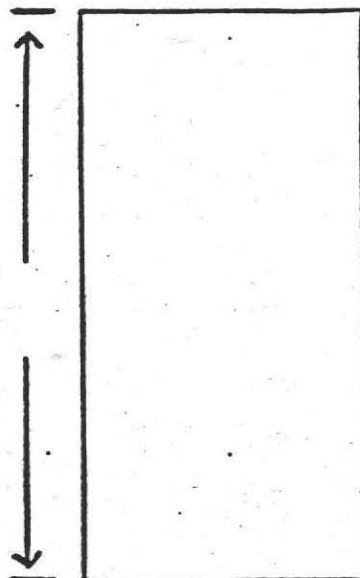
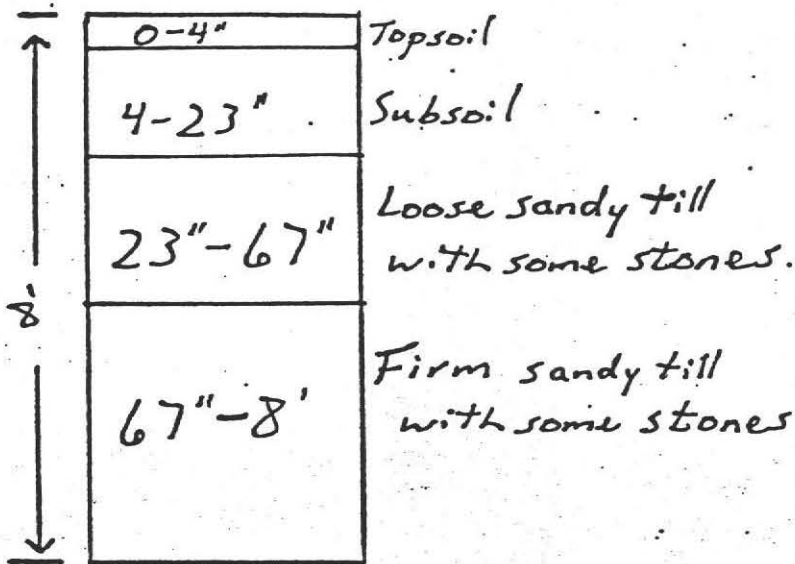

GROUND WATER None

GROUND WATER \_\_\_\_\_

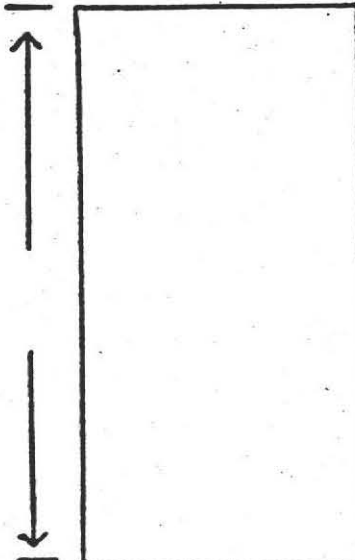
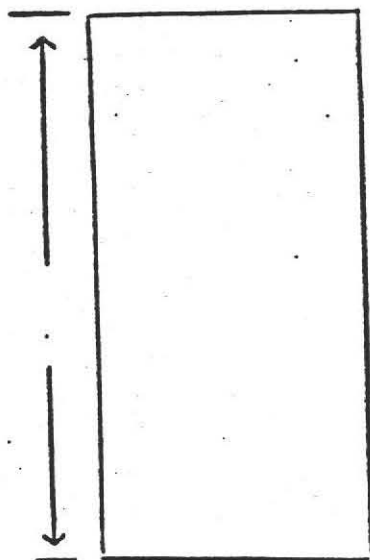

GROUND WATER \_\_\_\_\_

GROUND WATER \_\_\_\_\_

Percolation Rate at 30":

10min/inch

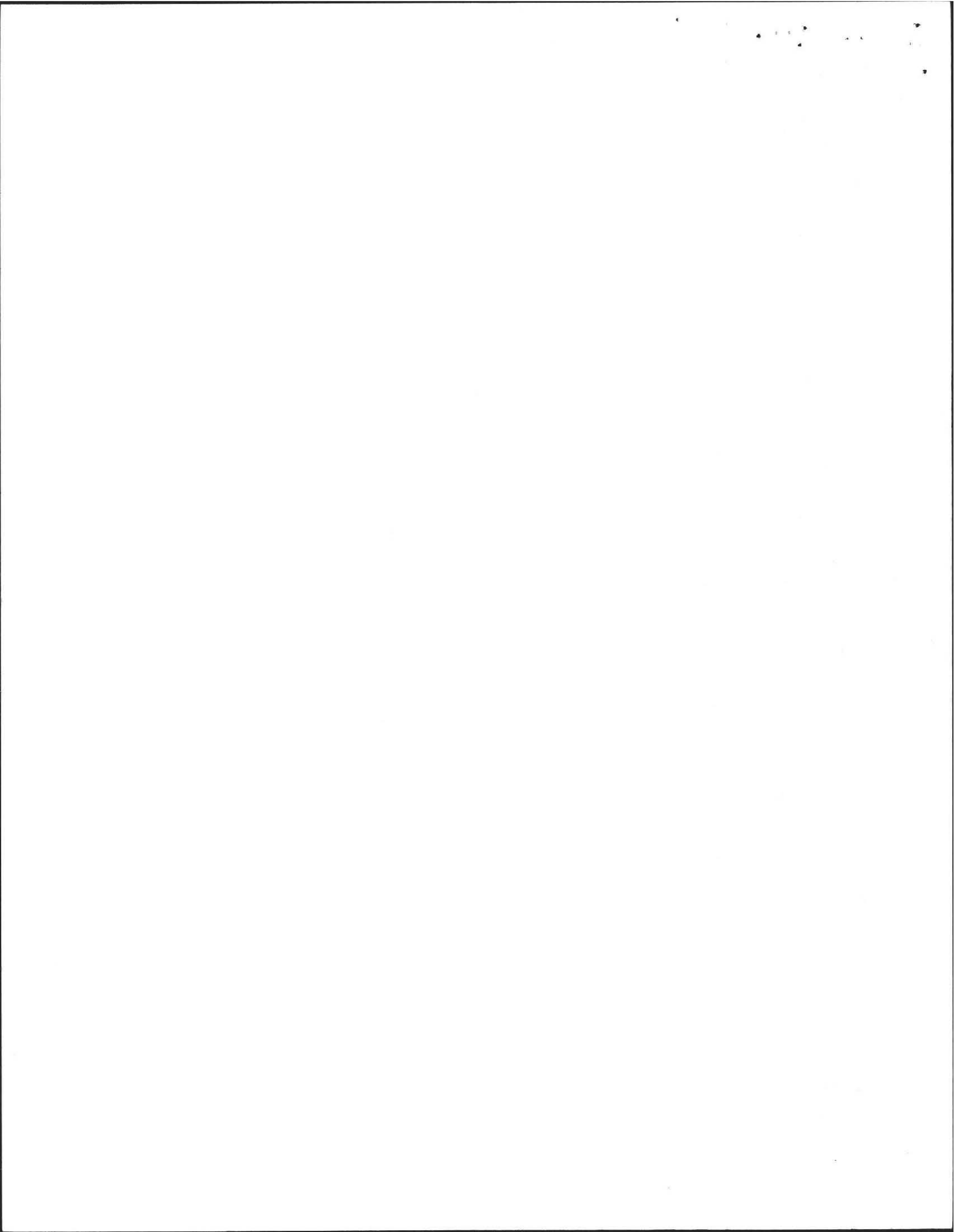



# PROFILE OF SEPTIC SYSTEM

Theresa Maguire  
 106 North Street, Belchertown, MA.  
 Lot 65, Trillium Way  
 Amherst Woods, Amherst

BY: Frederick A. Filios  
 69 Pelham Road  
 Amherst, MA  
 01002

DATE: October 21, 1986  
 SCALE: Horizontal: 1" = 10'  
 Vertical: 1" = 3'

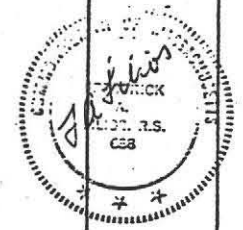
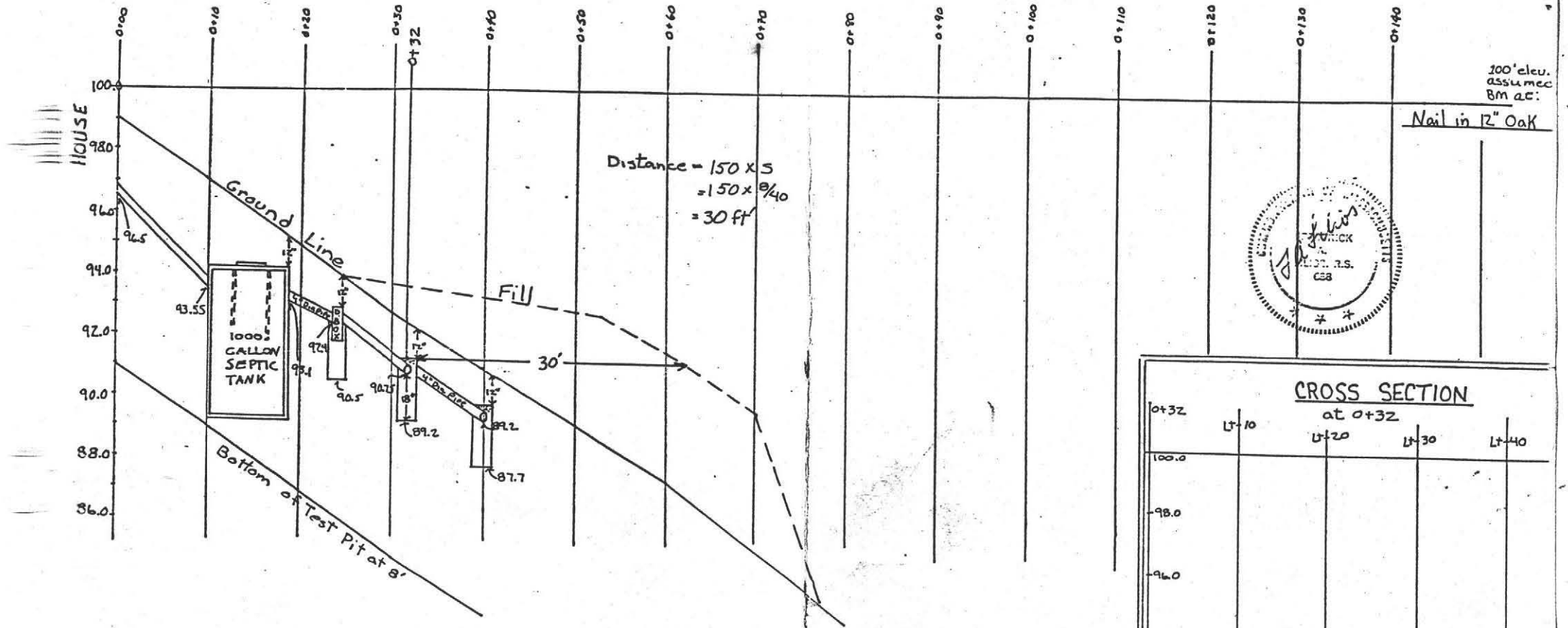

## SPECIFICATIONS

ALL MATERIALS AND CONSTRUCTION WILL BE IN ACCORDANCE WITH COMM. OF MASS. D.E.Q.E. STATE ENVIRONMENTAL CODE TITLE 5.

## CALCULATIONS

4 Bdms x 110 = 440 gallons required  
 Perc Rate = 10 min/inch sides: 1.00 gal/sf  
 Bottom = .55 gal/sf  
 Leach Trenches: 3, 40' long x 2' wide x 2' deep  
 Sides: 3 x 40 x 1.5 x 2 = 360 sf x 1.0 gal/sf = 360 gal.  
 Bottom: 3 x 40 x 2 = 240 sf x 0.55 gal/sf = 132 gal.  
 Proposed Available = 492 gallons

