

No. 85-23

#23



THE COMMONWEALTH OF MASSACHUSETTS

BOARD OF HEALTH

Town OF Amherst

Application for Disposal Works Construction Permit

Application is hereby made for a Permit to Construct (X) or Repair ( ) an Individual Sewage Disposal System at:

#23 Lot #59 Amherst Woods, Phase 3 59

Wm. V. Fanslow Location - Address or Lot No. Cushman Rd. Shutesbury, Mass.

\* W. W. Clark Owner Address PRATT CORNER RD SHUTESBURY

Type of Building Size Lot 33,554 Sq. feet

Dwelling - No. of Bedrooms 4 Expansion Attic ( ) Garbage Grinder (X)

Other - Type of Building No. of persons Showers ( ) - Cafeteria ( )

Other fixtures

Design Flow 55 gallons per person per day. Total daily flow 660 gallons.

Septic Tank - Liquid capacity 1500 gallons Length 10.5 Width 5 Diameter Depth 5

\* Disposal Trench - No. 4 Width 3 ft Total Length 144 ft Total leaching area 432 sq. ft.

Seepage Pit No. Diameter Depth below inlet Total leaching area sq. ft.

Other Distribution box (X) Dosing tank ( )

Percolation Test Results Performed by Frederick Filios Date Apr. 23, 1984

Test Pit No. 1 10 minutes per inch Depth of Test Pit 8 ft Depth to ground water none @ 8 ft.

Test Pit No. 2 minutes per inch Depth of Test Pit Depth to ground water

Description of Soil enclosed -

\* NOTE: MAY SUBSTITUTE 1200' LEACH BED

Nature of Repairs or Alterations - Answer when applicable

Agreement:

The undersigned agrees to install the aforescribed Individual Sewage Disposal System in accordance with the provisions of TITLE 5 of the State Sanitary Code - The undersigned further agrees not to place the system in operation until a Certificate of Compliance has been issued by the board of health.

\* Signed W. V. Fanslow

Application Approved By C. E. Drake Jr Date 7-9-85

Application Disapproved for the following reasons:

Permit No. 85-23 Issued Date

THE COMMONWEALTH OF MASSACHUSETTS

BOARD OF HEALTH

OF

Certificate of Compliance

THIS IS TO CERTIFY, That the Individual Sewage Disposal System constructed ( ) or Repaired ( ) by

Installer

at

has been installed in accordance with the provisions of TITLE 5 of The State Sanitary Code as described in the application for Disposal Works Construction Permit No. dated

THE ISSUANCE OF THIS CERTIFICATE SHALL NOT BE CONSTRUED AS A GUARANTEE THAT THE SYSTEM WILL FUNCTION SATISFACTORY.

DATE Inspector

THE COMMONWEALTH OF MASSACHUSETTS

BOARD OF HEALTH

No. 85-23 TOWN OF Amherst FEE #90

Disposal Works Construction Permit

Permission is hereby granted Wm. V. Fanslow by W. W. Clark to Construct (X) or Repair ( ) an Individual Sewage Disposal System

at No. Lot 59 Amherst Woods Street

as shown on the application for Disposal Works Construction Permit No. 85-23 Dated 7-9-85

DATE 7-9-85 Board of Health

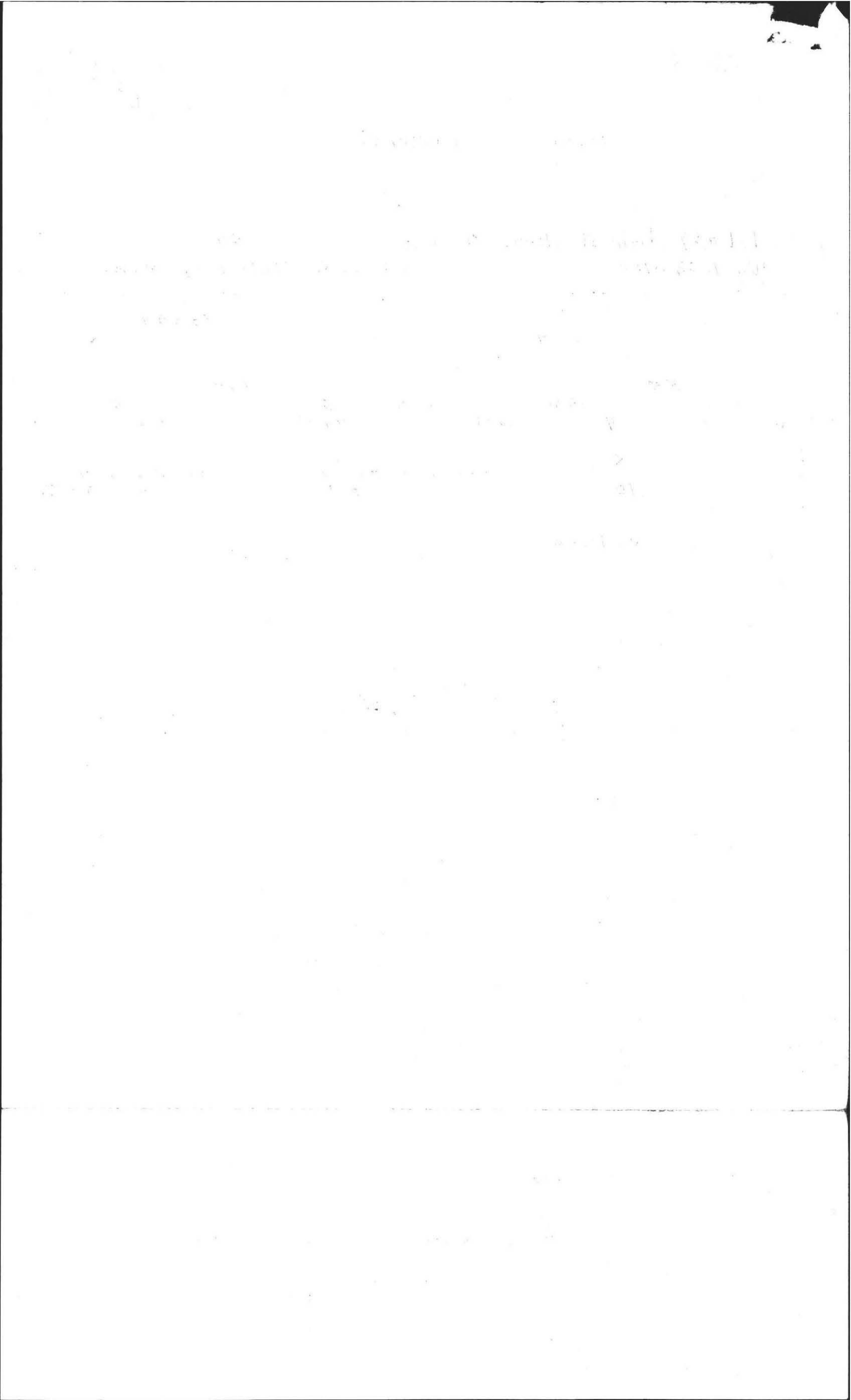

No. 85-23

THE COMMONWEALTH OF MASSACHUSETTS

BOARD OF HEALTH

Town of Amherst



Application for Disposal Works Construction Permit

Application is hereby made for a Permit to Construct (X) or Repair ( ) an Individual Sewage Disposal System at:

Lot #59 Amherst Woods, Phase 3 59

Wm. V. Fanslow Location - Address Cushman Rd. Shutesbury, Mass. or Lot No. Address

Owner Wm. V. Fanslow Installer Frederick Filios Address 33,554 Sq. feet

Type of Building Dwelling — No. of Bedrooms 4 Expansion Attic ( ) Garbage Grinder (X)

Other — Type of Building \_\_\_\_\_ No. of persons \_\_\_\_\_ Showers ( ) — Cafeteria ( )

Other fixtures \_\_\_\_\_ Design Flow 55 gallons per person per day. Total daily flow 660 gallons.

Septic Tank — Liquid capacity 1500 gallons Length 10.5 Width 5 Diameter \_\_\_\_\_ Depth 5

Disposal Trench — No. 4 Width 3 ft. Total Length 144 ft. Total leaching area 432 sq. ft.

Seepage Pit No. \_\_\_\_\_ Diameter \_\_\_\_\_ Depth below inlet \_\_\_\_\_ Total leaching area \_\_\_\_\_ sq. ft.

Other Distribution box (X) \_\_\_\_\_ Dosing tank ( ) \_\_\_\_\_

Percolation Test Results Performed by Frederick Filios Date Apr 23, 1984

Test Pit No. 1 10 minutes per inch Depth of Test Pit 8 ft. Depth to ground water none @ 8 ft.

Test Pit No. 2 \_\_\_\_\_ minutes per inch Depth of Test Pit \_\_\_\_\_ Depth to ground water \_\_\_\_\_

Description of Soil enclosed MAY SUBSTITUTE 1200 # LIME BED

Nature of Repairs or Alterations — Answer when applicable \_\_\_\_\_

Agreement: The undersigned agrees to install the aforescribed Individual Sewage Disposal System in accordance with the provisions of TITLE 5 of the State Sanitary Code — The undersigned further agrees not to place the system in operation until a Certificate of Compliance has been issued by the board of health.

Application Approved By [Signature] Signed \_\_\_\_\_ Date 7-7-85

Application Disapproved for the following reasons: \_\_\_\_\_ Date \_\_\_\_\_

Permit No. 85-23 Issued \_\_\_\_\_ Date \_\_\_\_\_

THE COMMONWEALTH OF MASSACHUSETTS

BOARD OF HEALTH

OF \_\_\_\_\_

Certificate of Compliance

THIS IS TO CERTIFY, That the Individual Sewage Disposal System constructed ( ) or Repaired ( ) by \_\_\_\_\_

at \_\_\_\_\_ Installer \_\_\_\_\_

has been installed in accordance with the provisions of TITLE 5 of The State Sanitary Code as described in the application for Disposal Works Construction Permit No. \_\_\_\_\_ dated \_\_\_\_\_

THE ISSUANCE OF THIS CERTIFICATE SHALL NOT BE CONSTRUED AS A GUARANTEE THAT THE SYSTEM WILL FUNCTION SATISFACTORY.

DATE \_\_\_\_\_ Inspector \_\_\_\_\_

CHECK OR FILL IN WHERE APPLICABLE

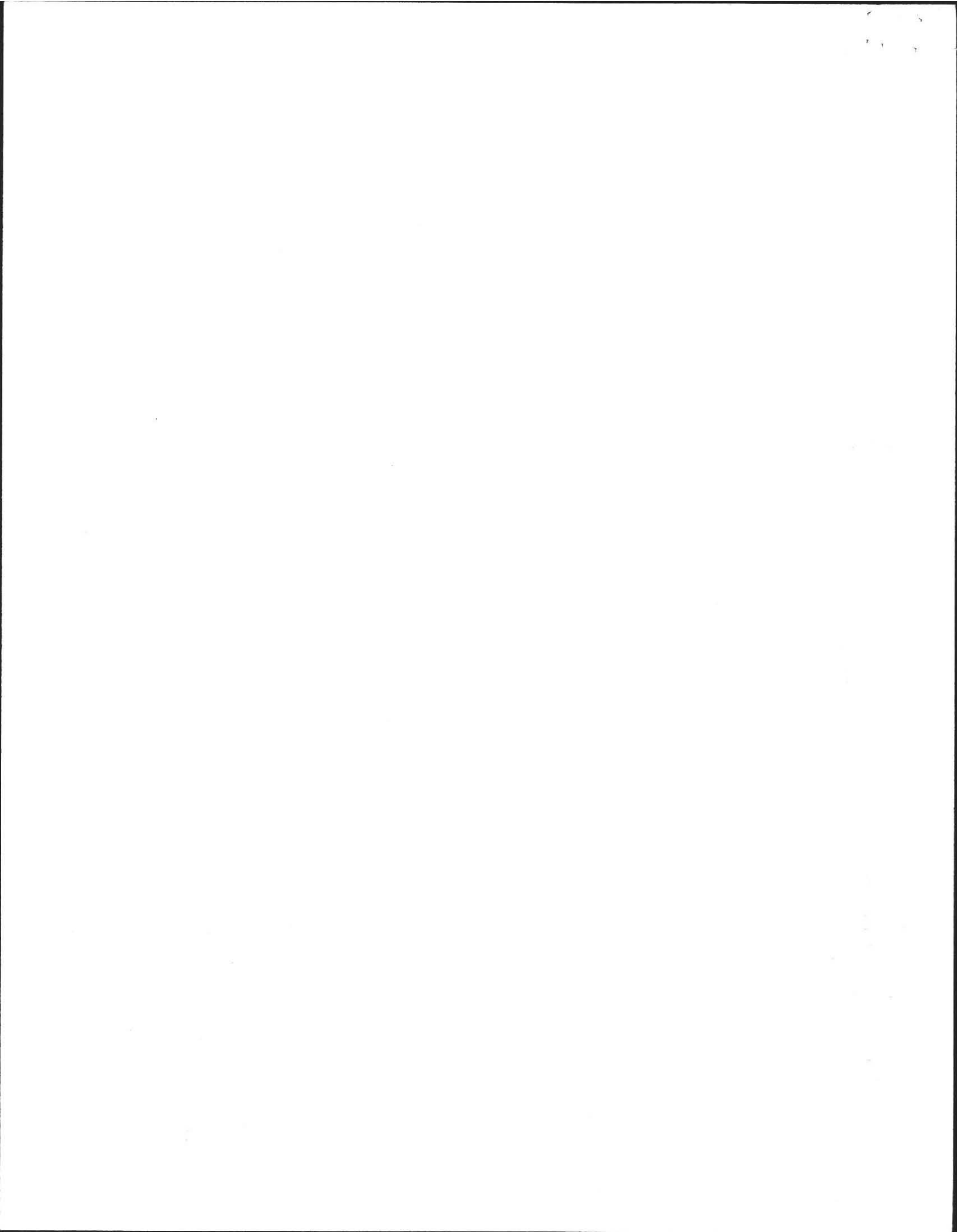

DEEP SOIL LOGS

OWNER Amherst Woods Inc.

DATE April 23, 1984

LOCATION Amherst Woods  
Lot # 59

OBSERVER F.A. Filios

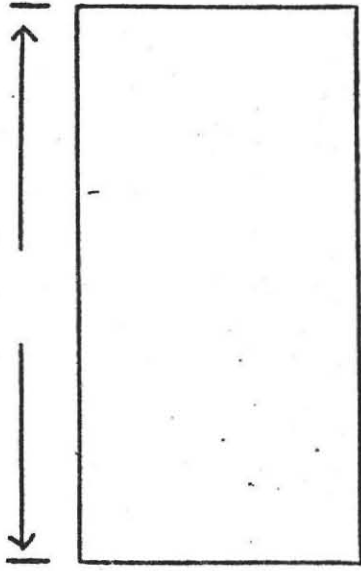
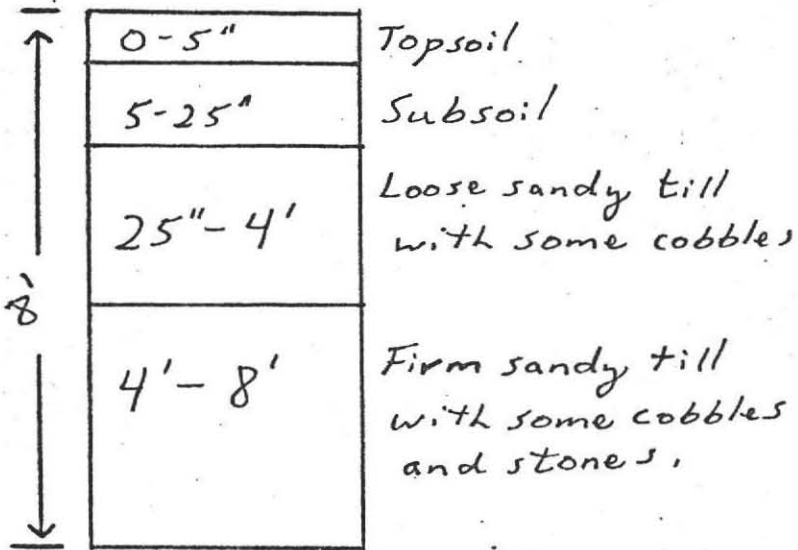

GROUND WATER None

GROUND WATER \_\_\_\_\_

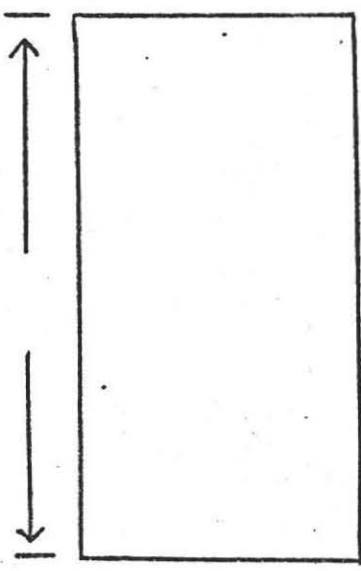
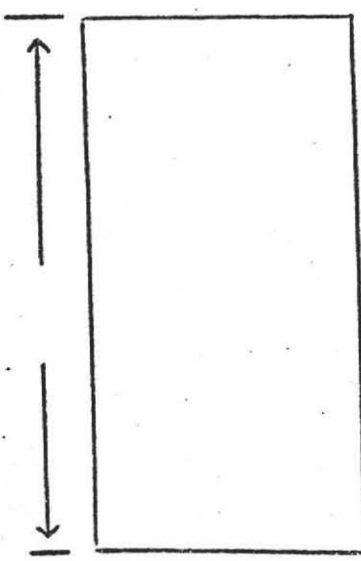

GROUND WATER \_\_\_\_\_

GROUND WATER \_\_\_\_\_

Percolation Rate at 33" :

10 min/inch

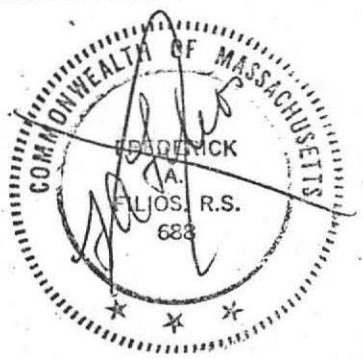

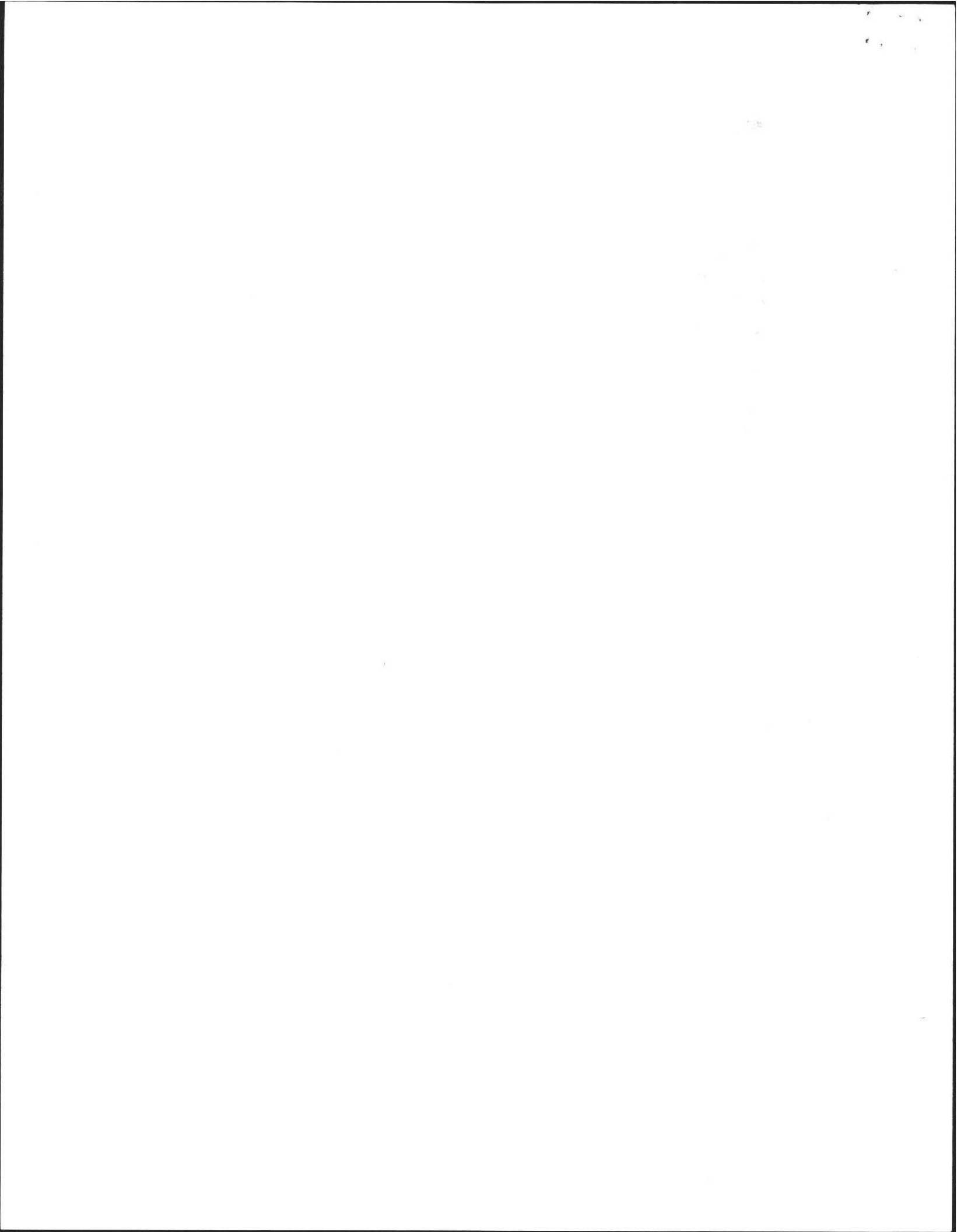

PLAN OF SEPTIC SYSTEM  
 W. V. FANLOW, CUSHMAN RD. SHUTESBURY, MA.  
 SITE AT: LOT #59, AMHERST WOODS, PHASE 3.  
 AMHERST, MASS.  
 BY: Frederick Filios, JULY 1, 1985  
 Scale 1"=30'

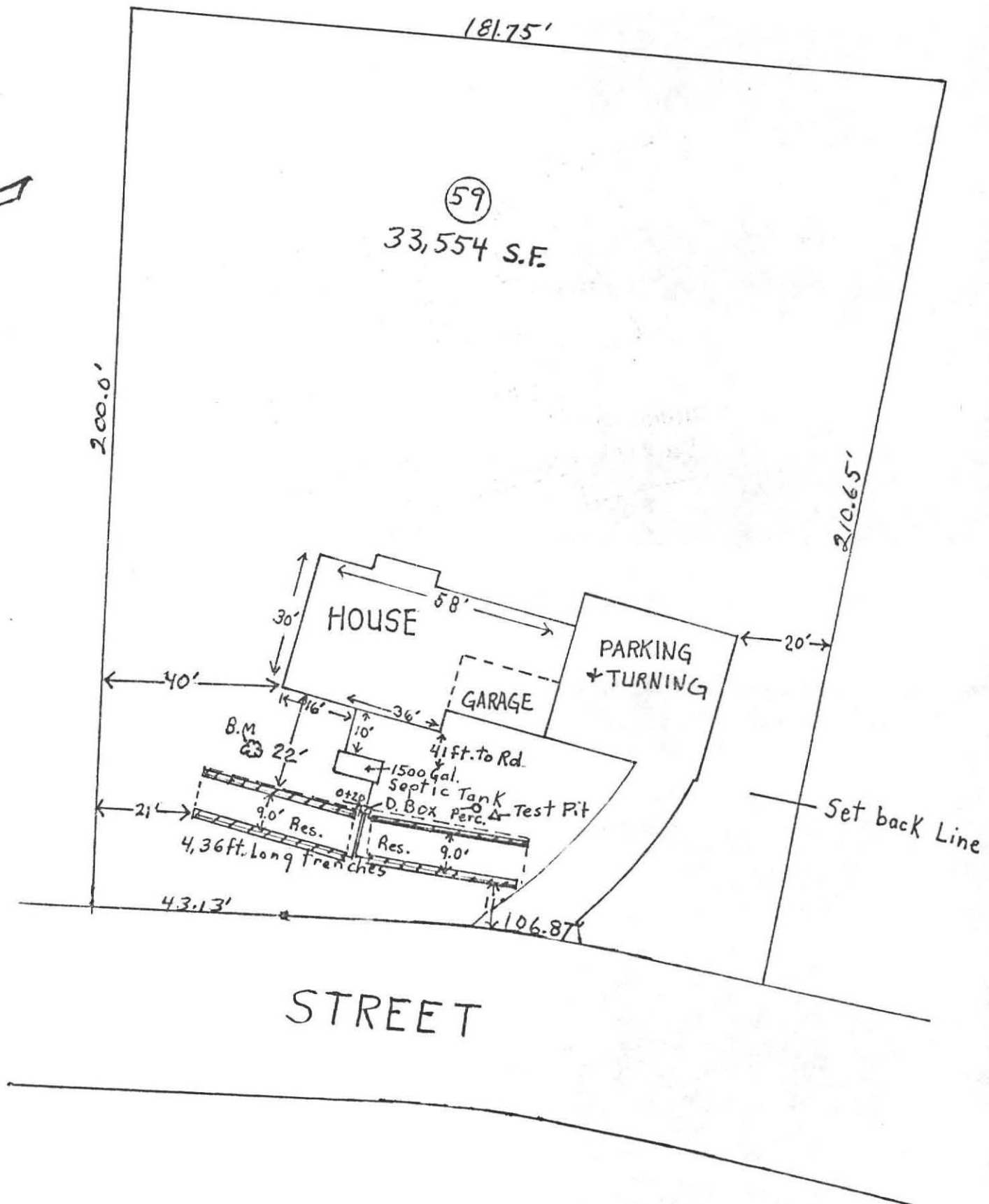
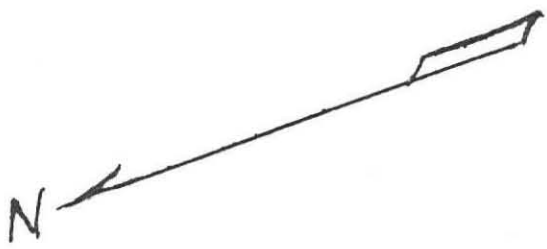

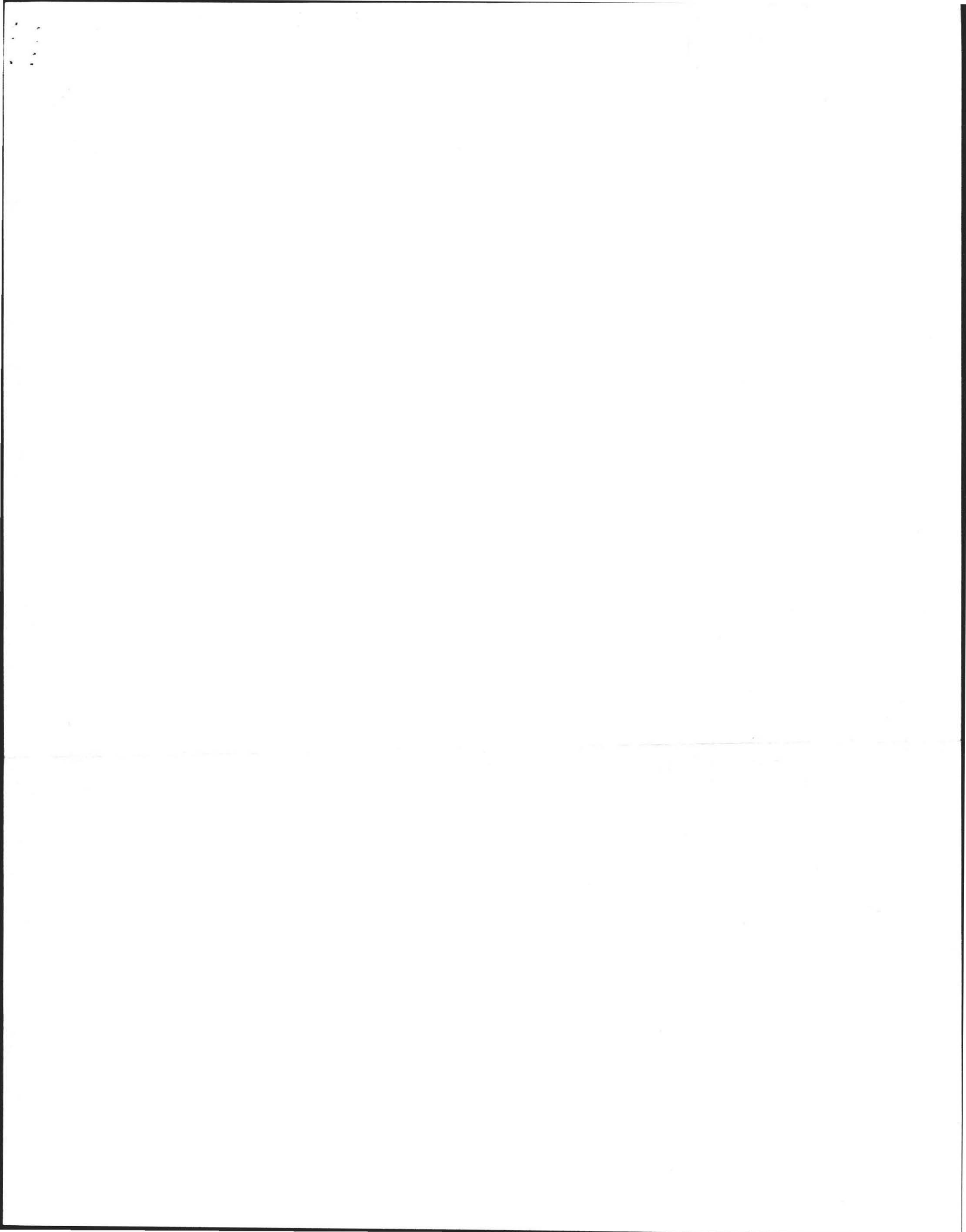



# PROFILE OF SEPTIC SYSTEM

FOR: W. V. FANSLAW  
CUSHMAN RD, SHUTESBURY, MASS.  
 AT: LOT #59 AMHERST WOODS, PHASE 3  
AMHERST, MASS.

BY: FREDERICK A. FILIOS  
69 PELHAM ROAD  
AMHERST, MA 01002

DATE: JULY 1, 1985  
 SCALE: HORIZONTAL 1" = 10'  
 VERTICAL 1" = 3'

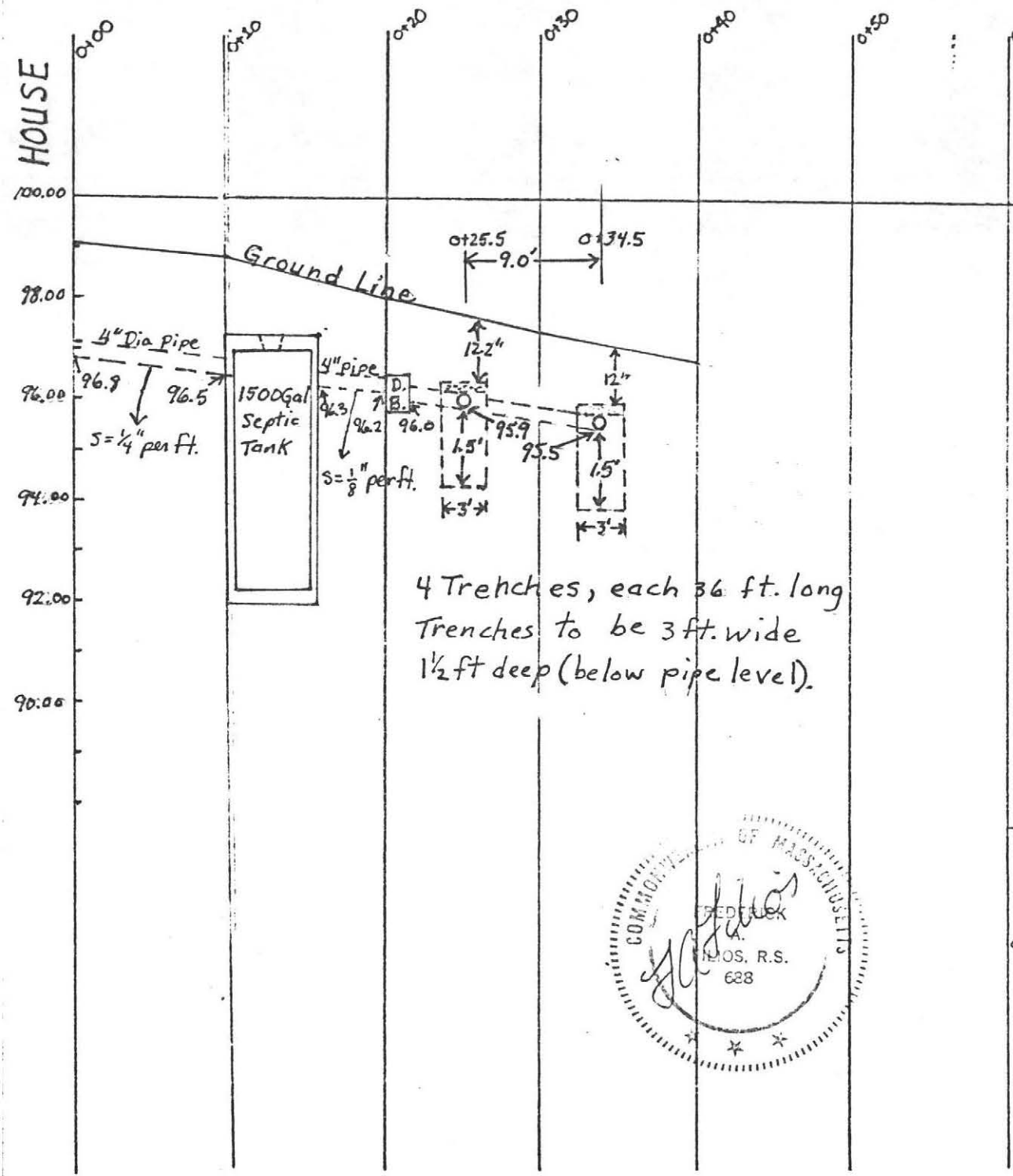

100' ELEVATION  
 ASSUMED  
 B.M. AT nail in  
 8" diameter red  
 oak, about 20ft  
 N.W. of house

## X SECTION

Each lateral Trench line to be 36 feet long.  
 Each Trench line will have a pipeline extend to it from the D. Box.  
 Trenches to be 3ft wide with a minimum of 1.5ft. of 3/4" to 1/2" washed stone under the pipe.

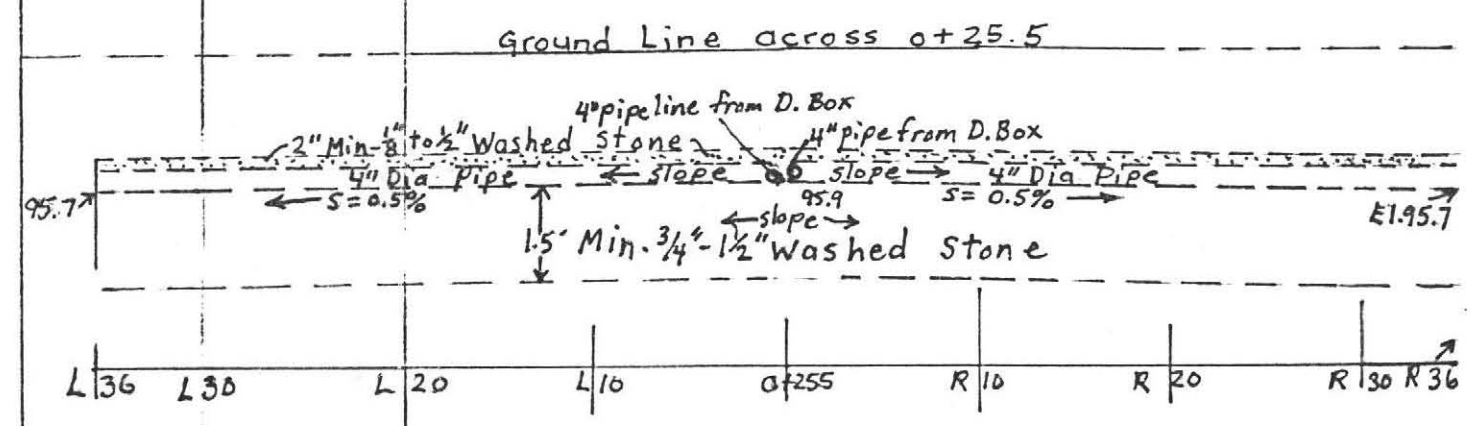

profile of Trenches @ 0+25.5

### SPECIFICATIONS:

All materials and construction are to be in accordance with the Comm. of Mass. D.E.Q.E. STATE ENVIRONMENTAL CODE Title 5.

### CALCULATIONS:

4 Bdrms. @ 110 + Garb. Gr. (50%) = 660 Gals.	Required
Perc rate = 10 minutes per inch	
144 ft. of leach Trenches x 3ft wide x 1.5' deep	
Sides 144 x 1.5 x 2 sides = 432 sq ft x 1.0 gal =	432 Gallons
Btm 144 x 3' = 432 x 0.55 Gals. = 237.6 Gals	
432 + 237.6 = 669.6 Gallons Available	

