

OCT 5 1989

#12

L-124

FILIOS ENTERPRISES, INC.  
69 Pelham Rd.  
Amherst, MA 01002

12 Teaberry

October 3, 1989

David Mullins  
27 Flintlock Lane  
Amherst, MA 01002

Dear Mr. Mullins

This is to notify you that Filios Enterprises, Inc. has inspected the septic system installed at:

Lot 124  
Teaberry Lane  
Amherst, MA 01002

Unless exceptions are noted below, the system complied with the approved design and elevations.

1. The as-built elevations differ from those of the approved plan as shown in red on the enclosed profile.
2. The slopes of the as-built pipes between the house and septic tank and the septic tank and drywell differ from those of the approved design as shown in red on the enclosed profile.
3. The lengths of the pipes between the house and the septic tank and the septic tank and drywells differ from those of the approved design as shown in red on the enclosed profile.

Sincerely,

*Frederick A. Filios*  
(Frederick A. Filios)

C.C. to Board of Health

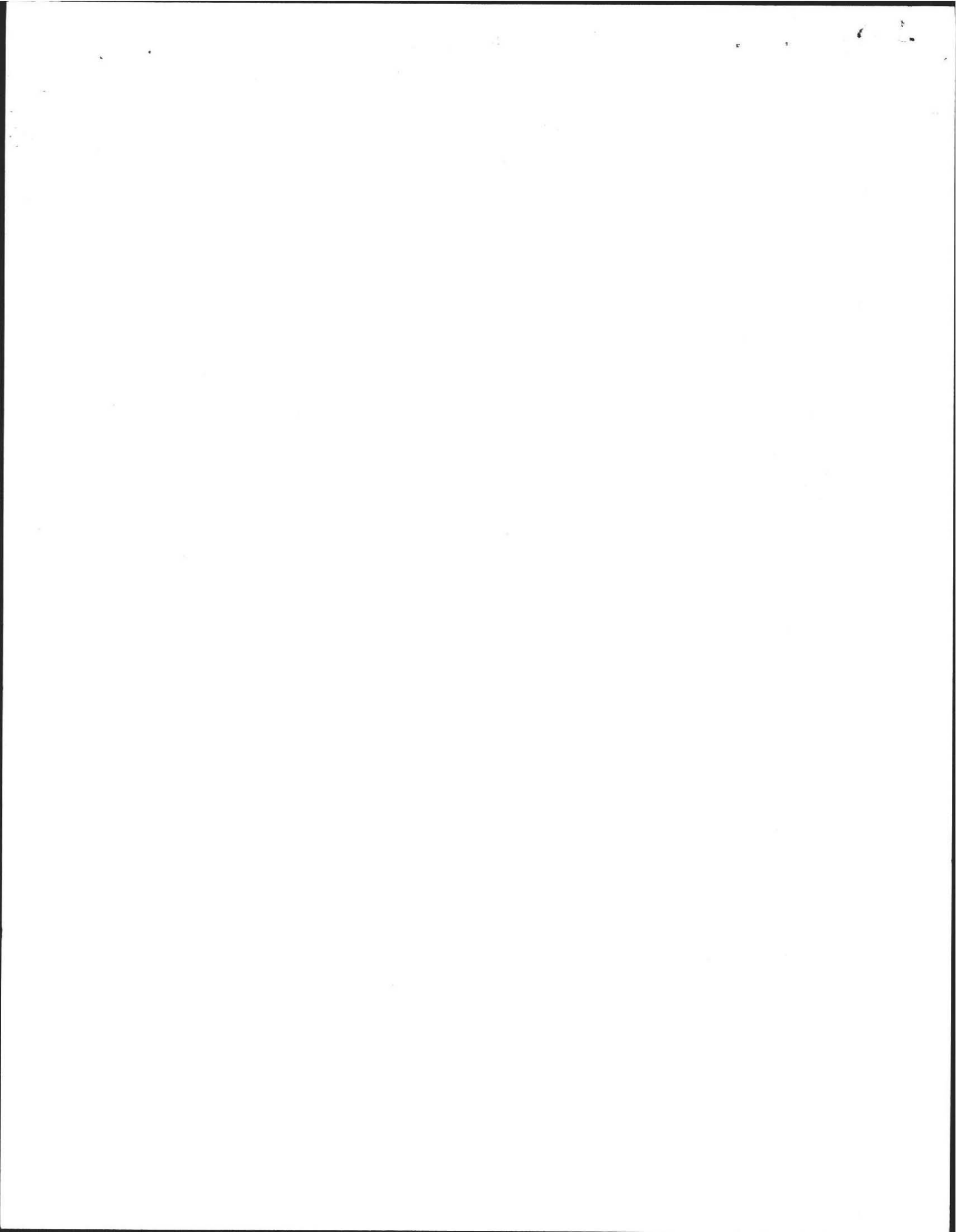

# PROFILE OF SEPTIC SYSTEM

FOR : DAVID MULLINS

27 FLINTLOCK LANE  
AMHERST, MA 01002

SITE : LOT 124

TEABERRY LANE  
AMHERST, MA.

BY : FILIOS ENTERPRISES, INC.

69 PELHAM ROAD (BH)  
AMHERST, MA 01002  
(413) 256-8008

DATE : MAR 16, 1989

SCALE : HORIZONTAL: 1"=10.0'

VERTICAL: 1"=3.0'

## SPECIFICATIONS

ALL MATERIALS AND CONSTRUCTION MUST BE IN ACCORDANCE WITH COMMONWEALTH OF MA. D.E.Q.E. STATE ENVIRONMENTAL CODE TITLE 5.

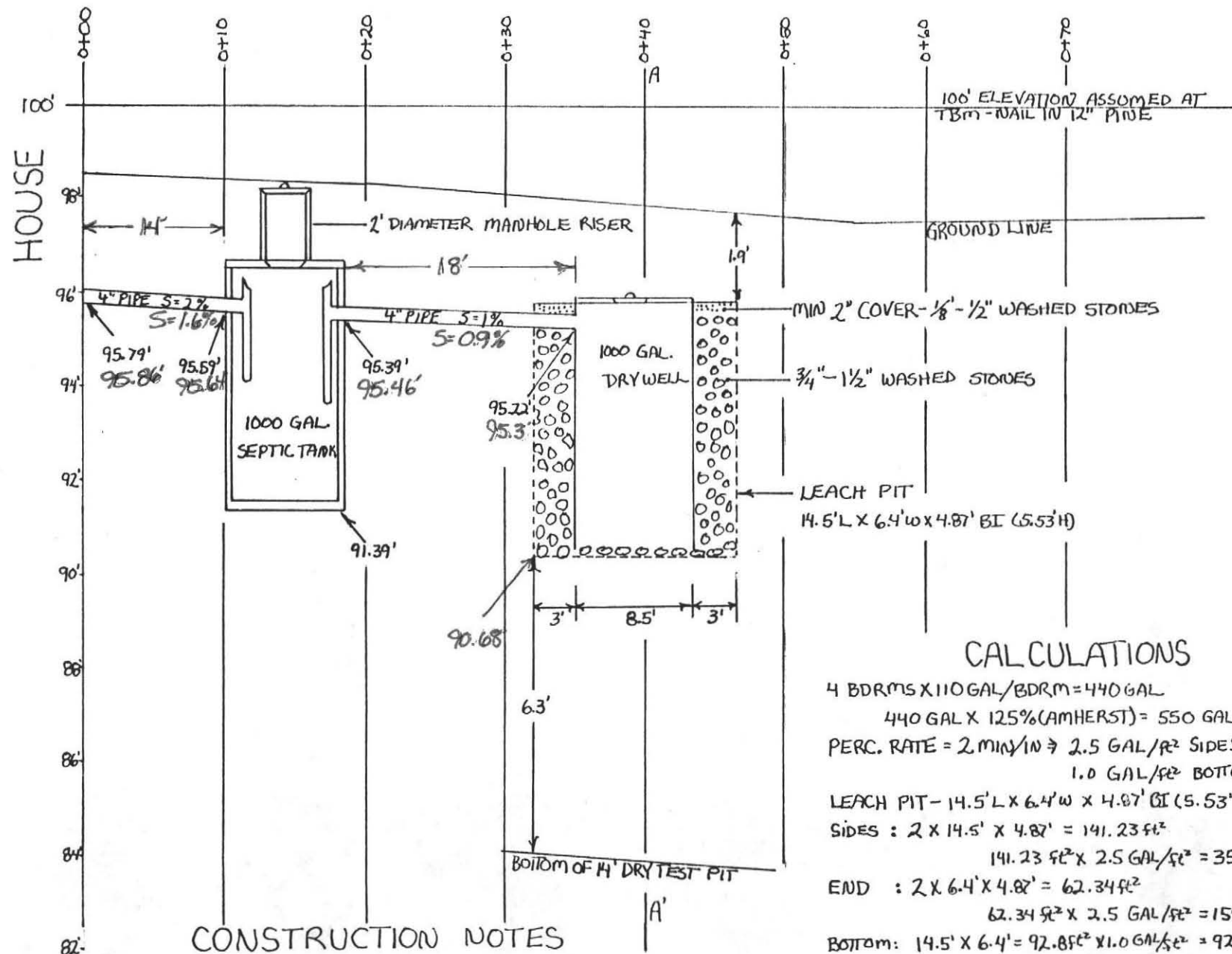

### CONSTRUCTION NOTES

1. Tank should be inspected and pumped at least every second year.
2. The inlet tee of the septic tank should extend 10" below flow line. The outlet tee should extend 14".
3. The pipe should remain level for 2' after exiting the D.Box.
4. All topsoil should be removed to a distance of 10' around system where fill is to be used.

### CALCULATIONS

4 BDRMS X 110 GAL/BDRM = 440 GAL  
 440 GAL X 125% (AMHERST) = 550 GAL REQUIRE  
 PERC. RATE = 2 MIN/IN → 2.5 GAL/ft<sup>2</sup> SIDES  
 1.0 GAL/ft<sup>2</sup> BOTTOM  
 LEACH PIT - 14.5' L X 6.4' W X 4.87' BI (5.53' H)  
 SIDES : 2 X 14.5' X 4.87' = 141.23 ft<sup>2</sup>  
 141.23 ft<sup>2</sup> X 2.5 GAL/ft<sup>2</sup> = 353.08 GAL  
 END : 2 X 6.4' X 4.87' = 62.34 ft<sup>2</sup>  
 62.34 ft<sup>2</sup> X 2.5 GAL/ft<sup>2</sup> = 155.84 GAL  
 BOTTOM : 14.5' X 6.4' = 92.8 ft<sup>2</sup> X 1.0 GAL/ft<sup>2</sup> = 92.80 GAL  
 MAXIMUM DAILY FLOW = 601.72 GAL



### CROSS SECTION AT 0+40 (A-A')

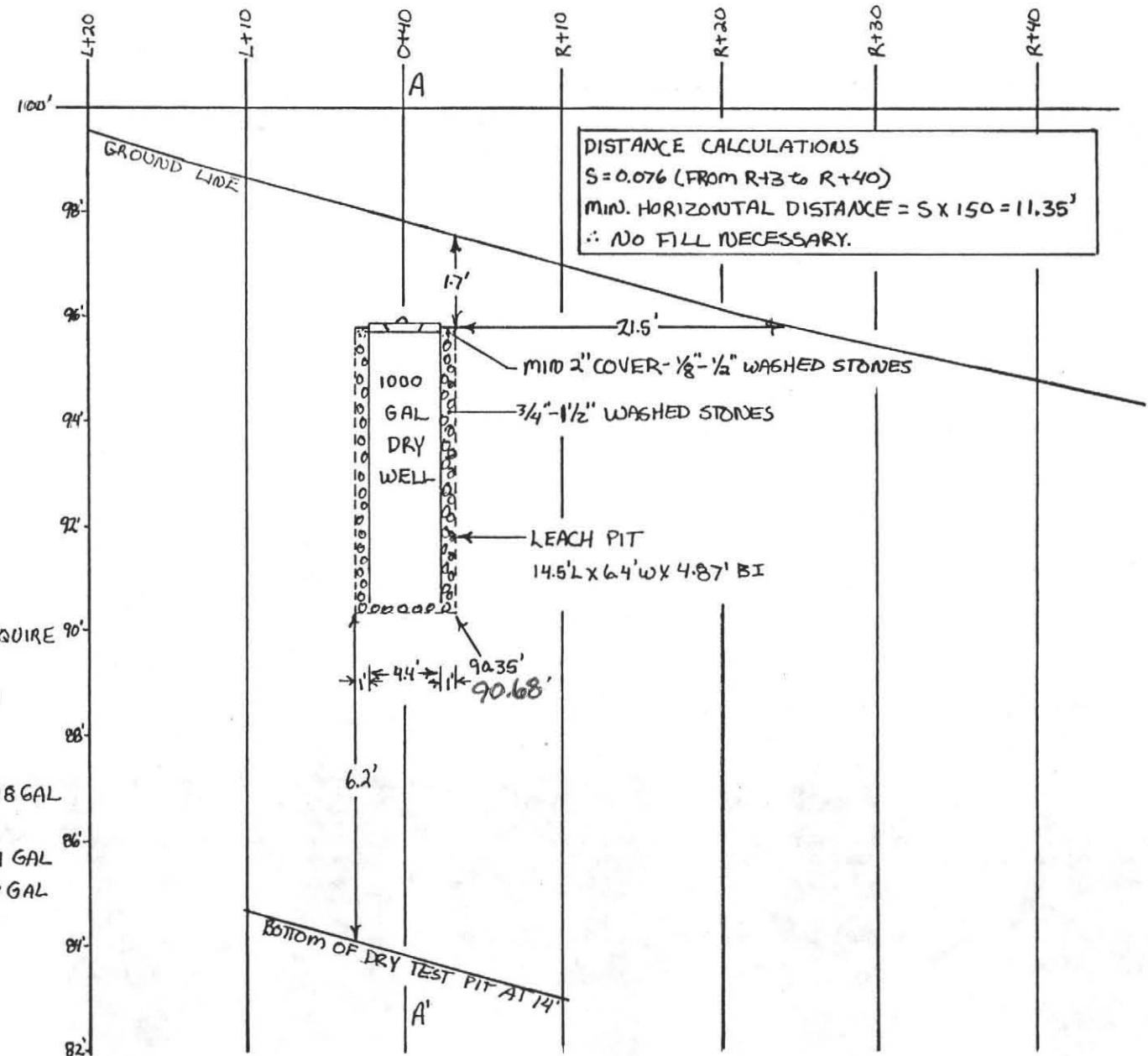

6.188.

6.188.

6.188.

6.188.

6.188.

6.188.

6.188.

6.188.

6.188.

No. 89-2

FEE 90.00

THE COMMONWEALTH OF MASSACHUSETTS

BOARD OF HEALTH

Town OF Amherst

Application for Disposal Works Construction Permit

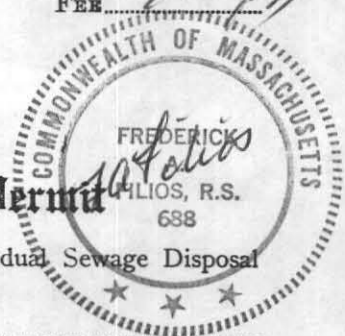

Application is hereby made for a Permit to Construct (✓) or Repair ( ) an Individual Sewage Disposal System at:

12 Teaberry Lane Location - Address Lot 124
David Mullins Owner 27 Flintlock Lane, Amherst or Lot No. Address

Type of Building Dwelling - No. of Bedrooms 4 Expansion Attic ( ) Garbage Grinder (NO)
Other - Type of Building No. of persons Showers ( ) - Cafeteria ( )
Other fixtures

Design Flow 68.75 gallons per person per day. Total daily flow 550.0 gallons.
Septic Tank - Liquid capacity 1000 gallons Length 8.5' Width 5' Diameter 5.3'
Disposal Trench - No. Width Total Length Total leaching area 203.57 sq. ft.
Seepage Pit No. 1 Diameter Depth below inlet 4.67' Total leaching area 92.80 sq. ft.
Other Distribution box ( ) Dosing tank ( )
Percolation Test Results Performed by Filios Enterprises, Inc. Date Mar 7 '86 - H, 1 & Perc.
Test Pit No. 1 2 minutes per inch Depth of Test Pit 10' Depth to ground water None
Test Pit No. 2 minutes per inch Depth of Test Pit 14' Depth to ground water None

Description of Soil Enclosed.
Nature of Repairs or Alterations - Answer when applicable

Agreement: The undersigned agrees to install the aforescribed Individual Sewage Disposal System in accordance with the provisions of TITLE 5 of the State Sanitary Code - The undersigned further agrees not to place the system in operation until a Certificate of Compliance has been issued by the board of health.
Signed David Mullins Date 3/17/89

Application Approved By
Application Disapproved for the following reasons:
Permit No. 89-2 Issued Date

THE COMMONWEALTH OF MASSACHUSETTS

BOARD OF HEALTH

Town OF Amherst

Certificate of Compliance

Checked 10/31/89 Reasonable Compliance J.L. Filios

THIS IS TO CERTIFY, That the Individual Sewage Disposal System constructed (✓) or Repaired ( ) by Lot 124 Teaberry Lane at has been installed in accordance with the provisions of TITLE 5 of The State Sanitary Code as described in the application for Disposal Works Construction Permit No. 89-2 dated

THE ISSUANCE OF THIS CERTIFICATE SHALL NOT BE CONSTRUED AS A GUARANTEE THAT THE SYSTEM WILL FUNCTION SATISFACTORY.
DATE 10/31/89 Inspector David Baygus

THE COMMONWEALTH OF MASSACHUSETTS

BOARD OF HEALTH

Town OF Amherst

Disposal Works Construction Permit

Permission is hereby granted to Construct (✓) or Repair ( ) an Individual Sewage Disposal System at No. Lot 124 Teaberry Lane Street as shown on the application for Disposal Works Construction Permit No. 89-2 Dated DATE 1 March 17, 1989 Board of Health

CHECK OR FILL IN WHERE APPLICABLE

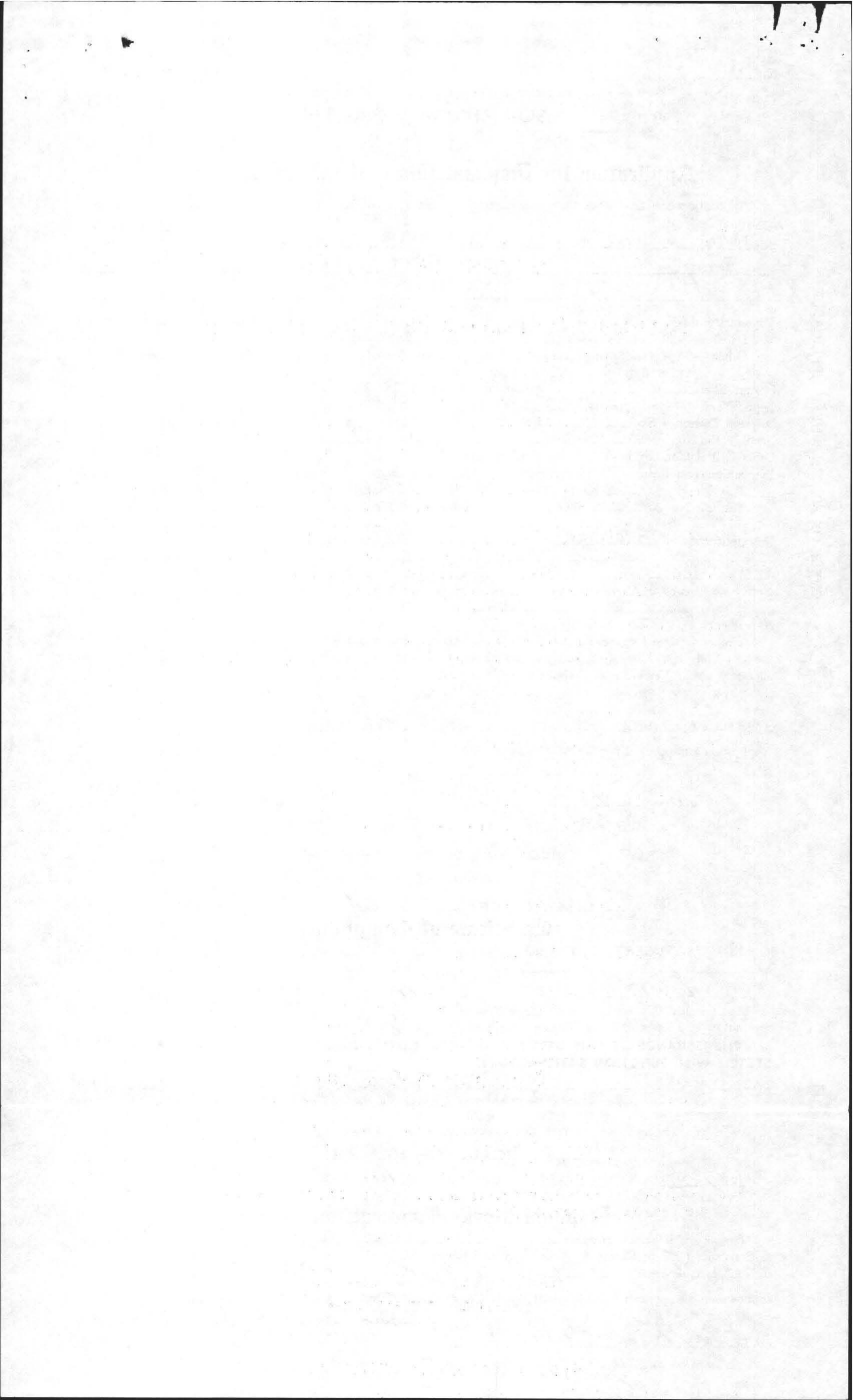



TOWN OF AMHERST

PERC TEST DATA SHEET

DATE 3/14/89 LOCATION Ferris Lane LOT SIZE Lot 124

OWNER Mullins ADDRESS \_\_\_\_\_ TELE # \_\_\_\_\_

P.E./RS Fred Kline FIRM Kline OBSERVED BY EVREZ

BACH HOE OPERATOR D. Haas BENCH MARK \_\_\_\_\_

PERC DEPTH \_\_\_\_\_ PRE SOAK TIME \_\_\_\_\_ PERC DEPTH \_\_\_\_\_ PRE SOAK TIME \_\_\_\_\_

TEST \_\_\_\_\_  
\_\_\_\_\_ Deep Soil Log \_\_\_\_\_  
\_\_\_\_\_ ONLY \_\_\_\_\_ TOWN WATER \_\_\_\_\_

RATE \_\_\_\_\_ RATE \_\_\_\_\_

TOP <u>4</u>
SUB <u>23</u>
<u>co. sand</u> <u>dry 14</u>

TOP
SUB

TOP
SUB

TOP
SUB

TOP
SUB

TOP
SUB

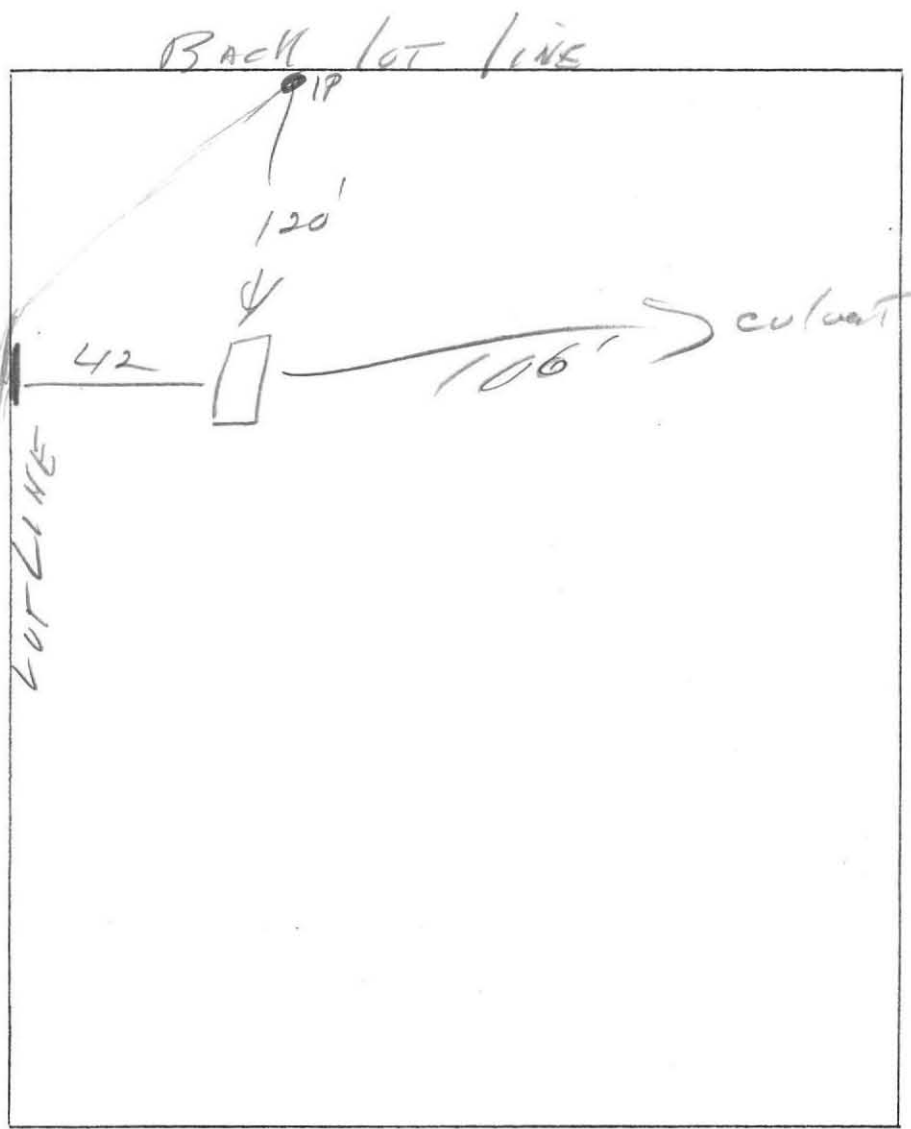

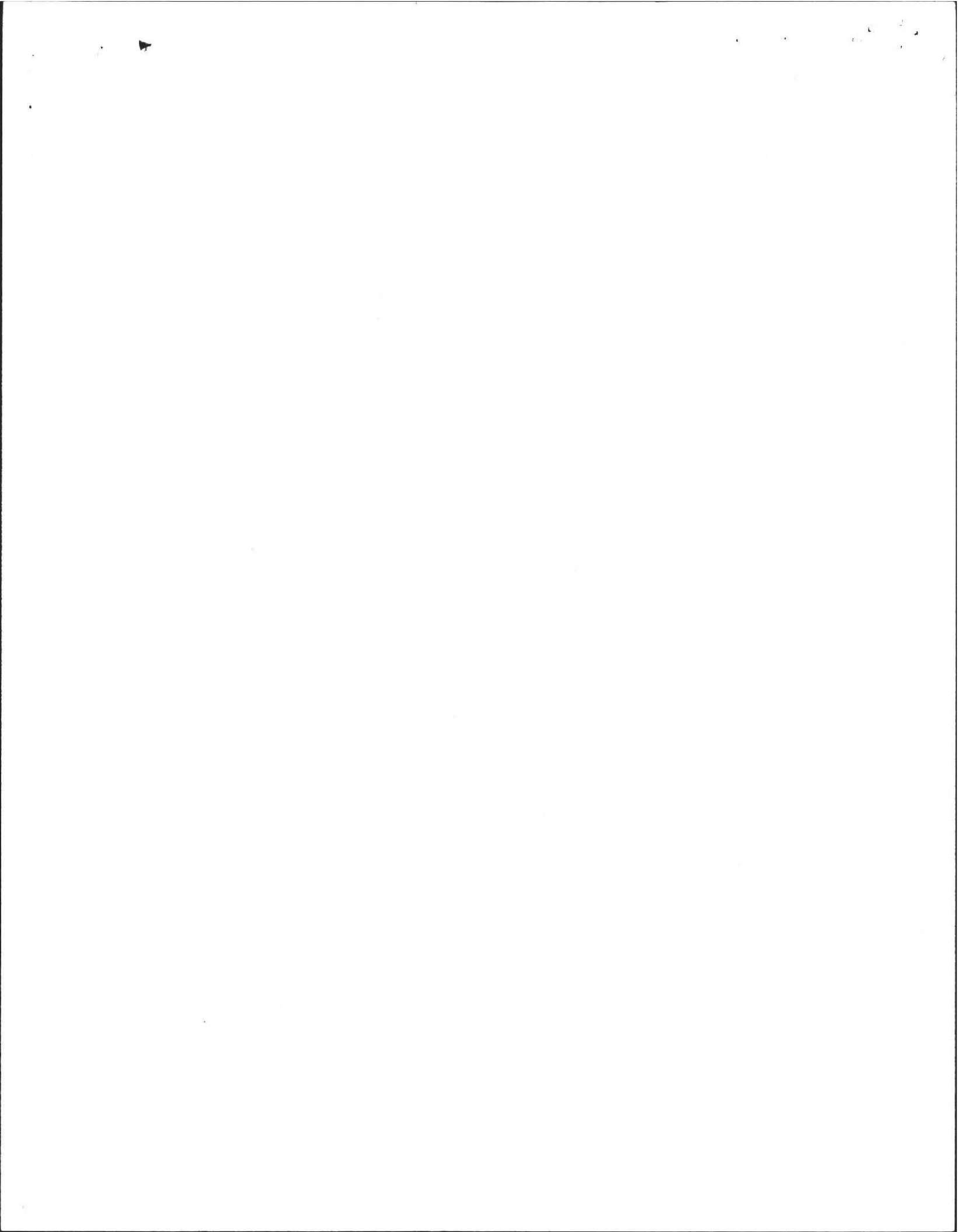



DEEP SOIL LOGS

OWNER Jeffrey W. Flower

DATE March 7, 1986 March 10, 1989 H2  
H1 & Perc.

LOCATION Lot 124 Amherst Woods  
Amherst, MA.

OBSERVER F.A. Filios

B of H C. Drake

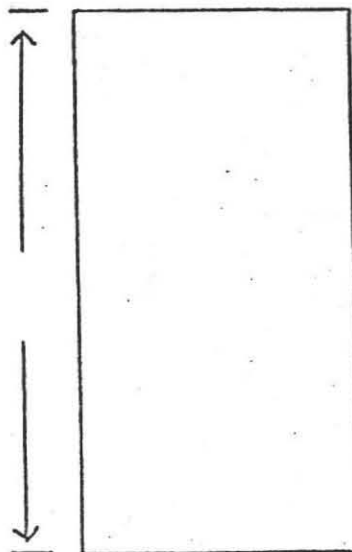
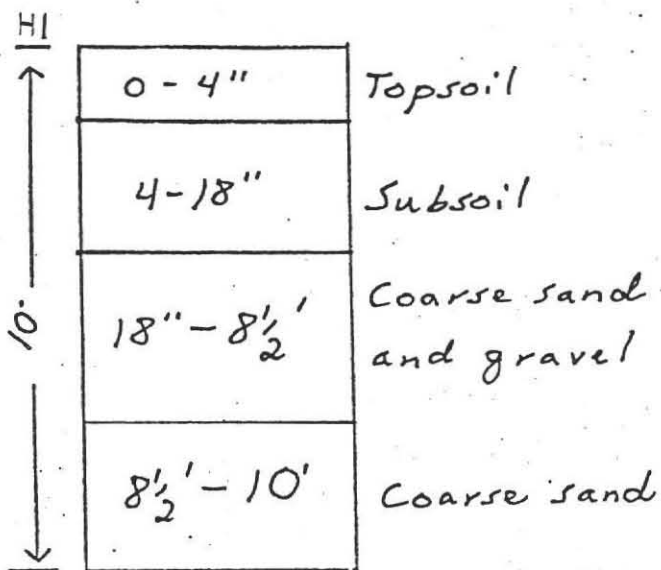

GROUND WATER NONE

GROUND WATER \_\_\_\_\_

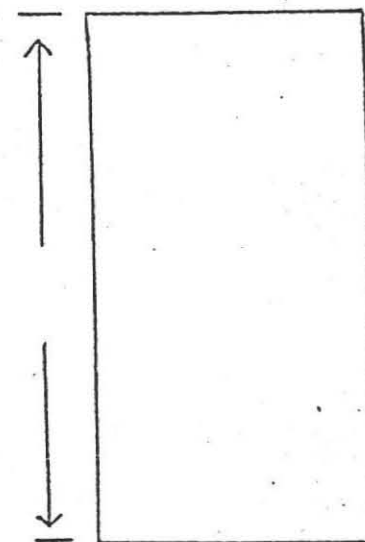
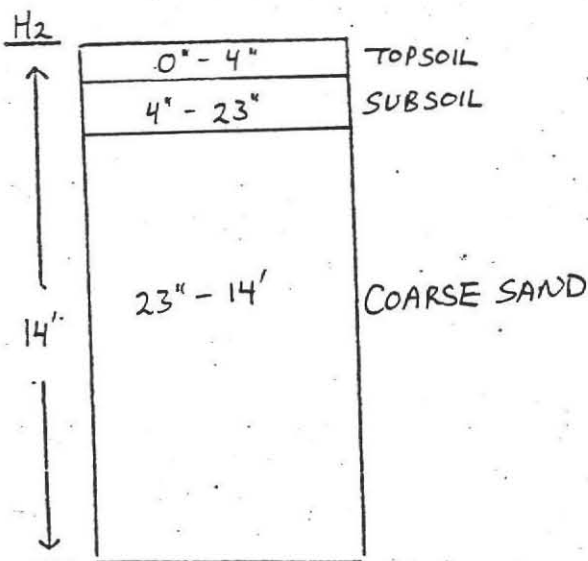

GROUND WATER NONE

GROUND WATER \_\_\_\_\_

PERCOLATION RATE AT 38" :

< 2 min./inch



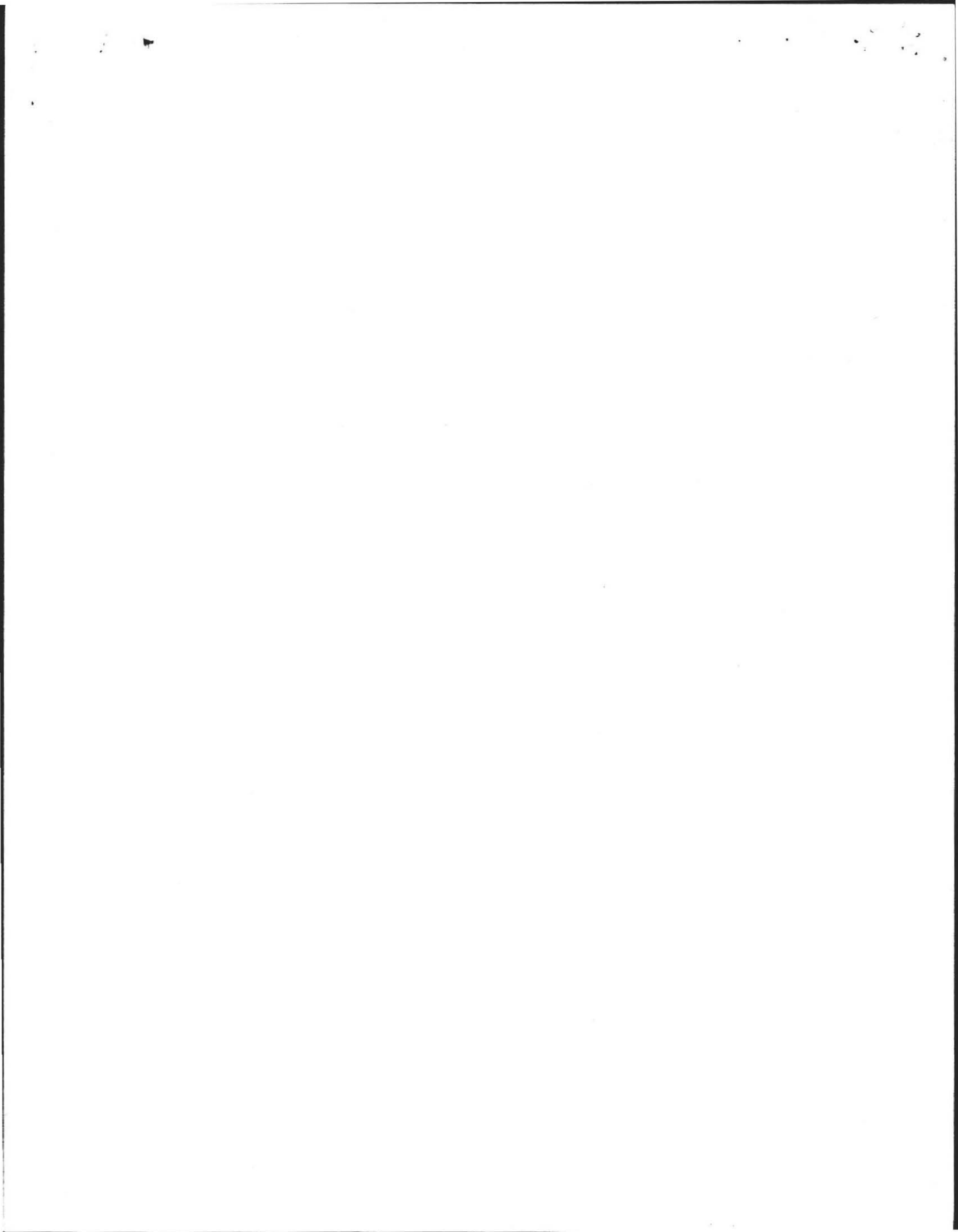

# PLAN SHOWING SEWAGE DISPOSAL SYSTEM

FOR : DAVID MULLINS  
 27 FLINTLOCK LANE,  
 AMHERST, MA. 01002

DATE : MAR. 15, 1989

SCALE : 1" = 30.0'

BY : FILIOS ENTERPRISES, INC.  
 69 PELHAM ROAD  
 AMHERST, MA. 01002

SITE : LOT 124  
 TEABERRY LANE  
 AMHERST, MA. 01002

NOTE : TOWN WATER; NO WELLS IN THE AREA.

LOT  
 124

AREA = 36,813 ± SQ.FT.

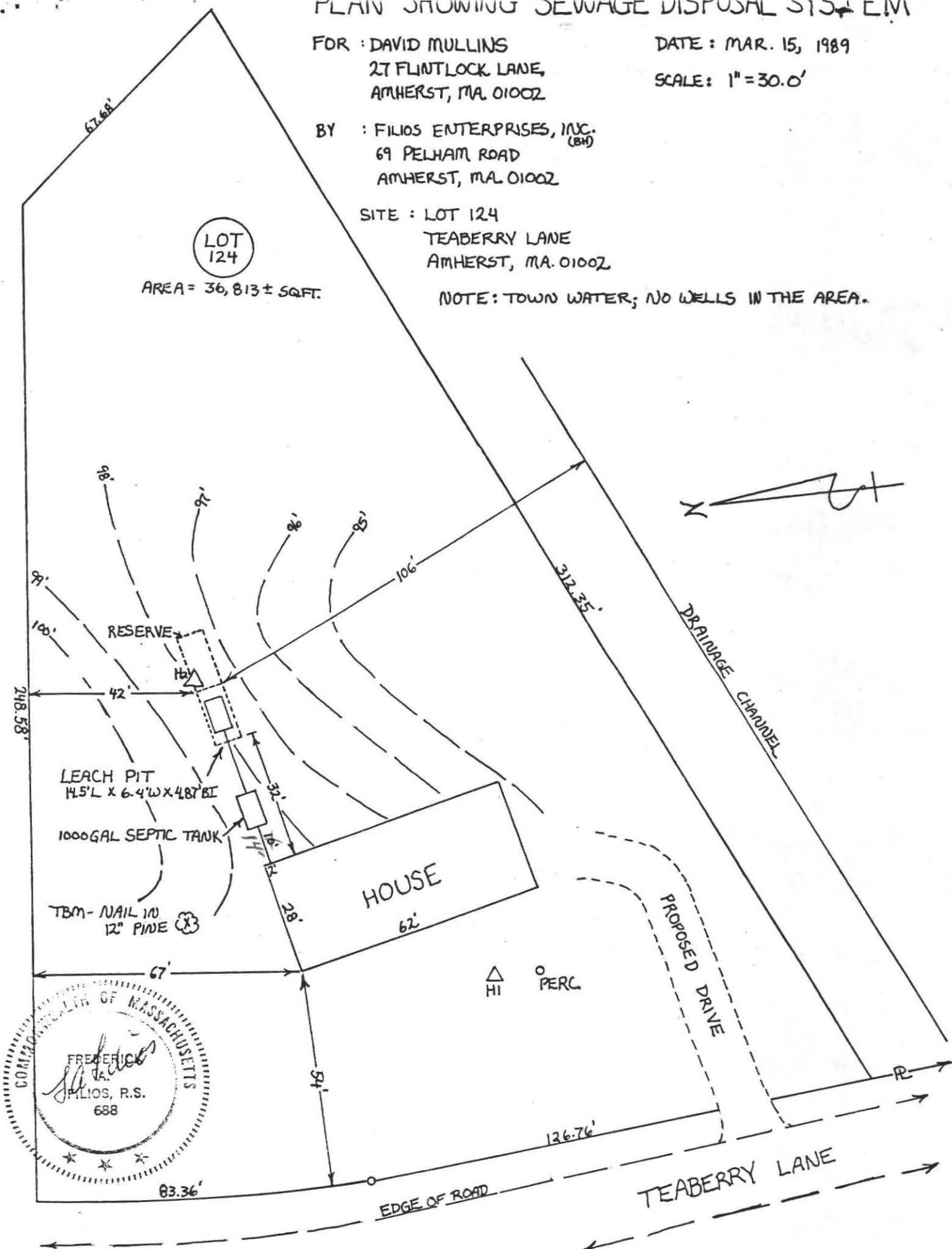

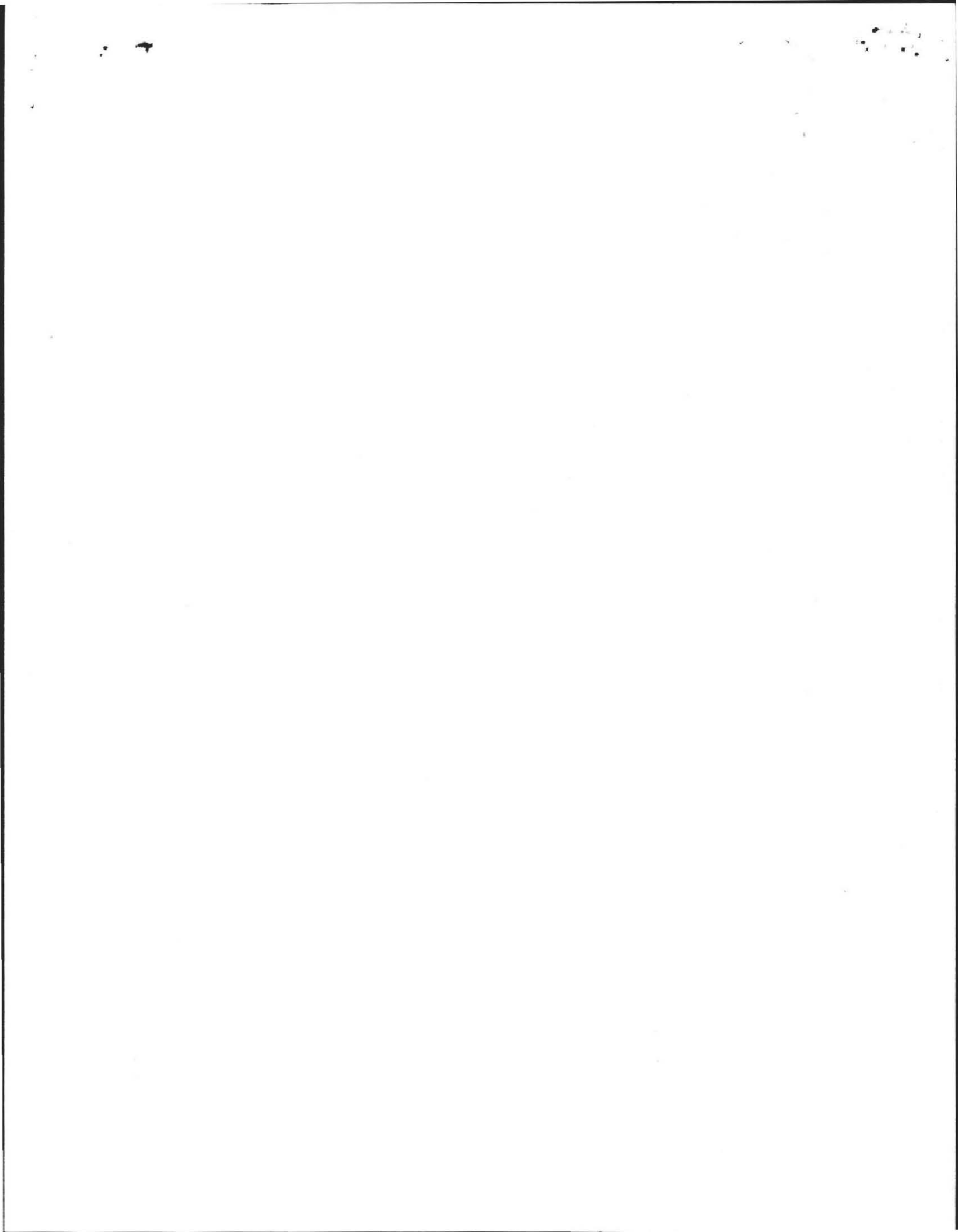

# PROFILE OF SEPTIC SYSTEM

FOR : DAVID MULLINS  
27 FLINTLOCK LANE  
AMHERST, MA 01002

SITE : LOT 124  
TEABERRY LANE  
AMHERST, MA

BY : FILIOS ENTERPRISES, INC. (BH)  
69 PELHAM ROAD  
AMHERST, MA 01002  
(413) 256-8008

DATE : MAR 16, 1989  
SCALE : HORIZONTAL: 1"=10.0'  
VERTICAL: 1"=3.0'

## SPECIFICATIONS

ALL MATERIALS AND CONSTRUCTION MUST BE IN ACCORDANCE WITH COMMONWEALTH OF MA. D.E.Q.E. STATE ENVIRONMENTAL CODE TITLE 5.

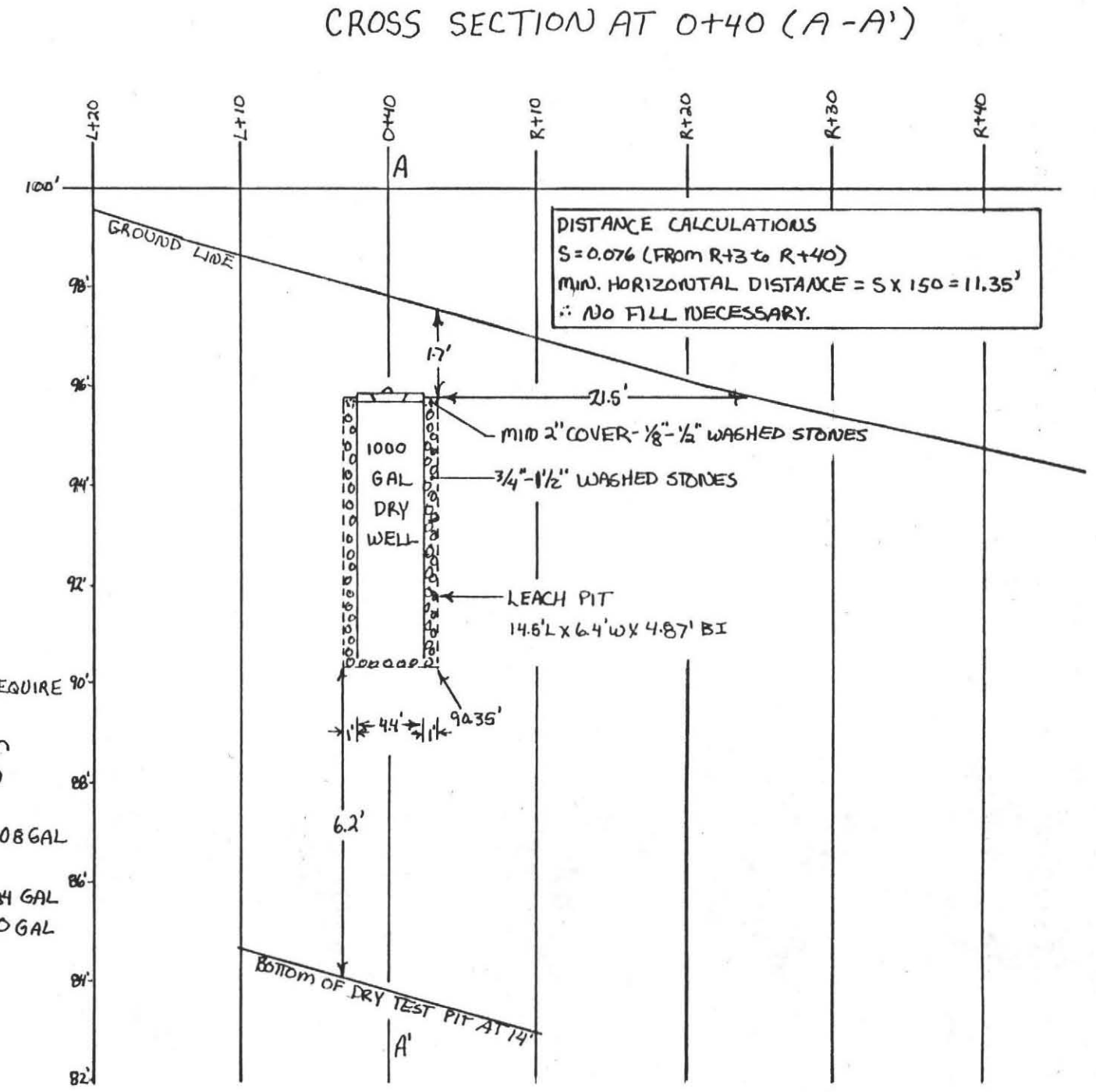
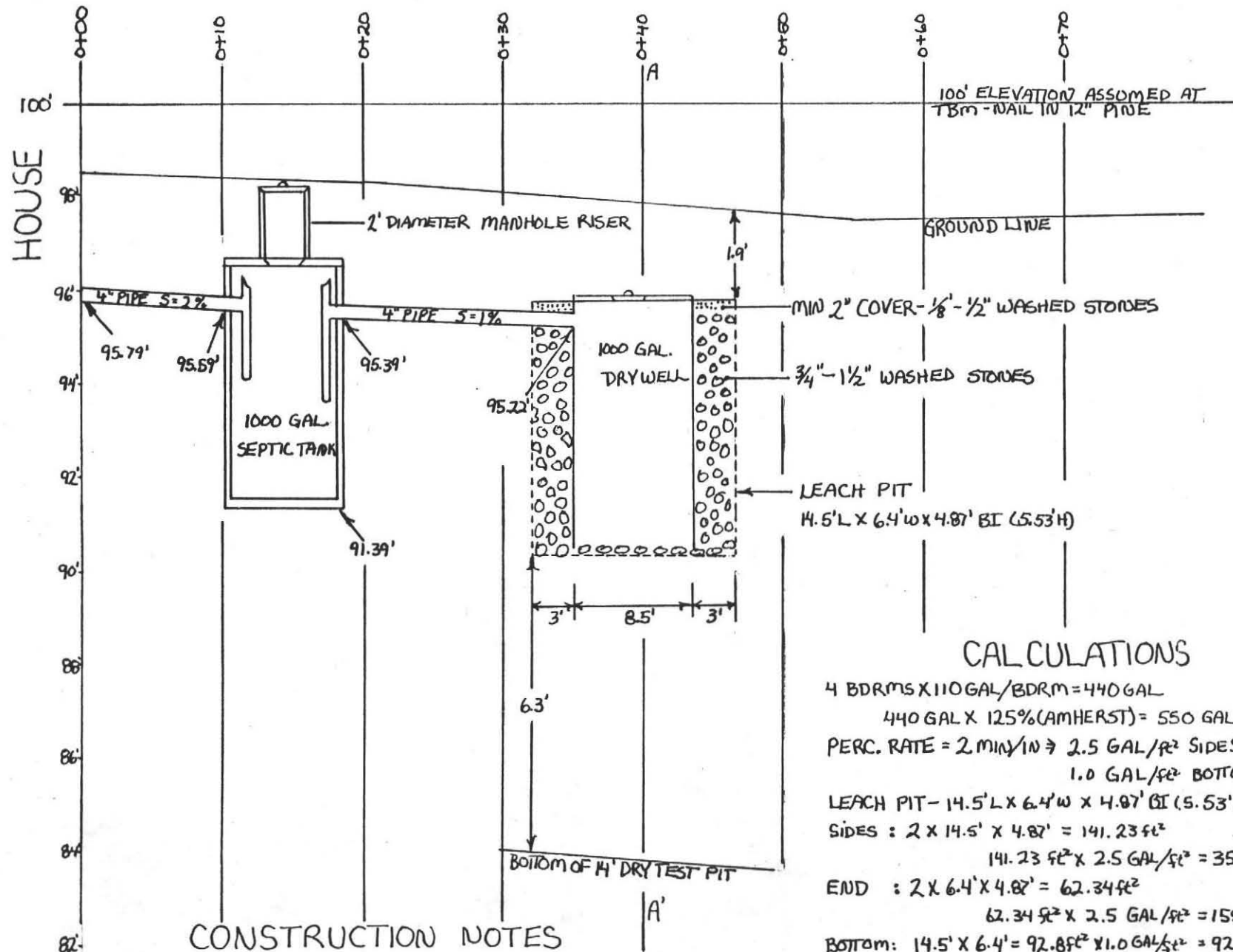

**CALCULATIONS**

4 BDRMS X 110 GAL/BDRM = 440 GAL  
 440 GAL X 125% (AMHERST) = 550 GAL REQUIRE  
 PERC. RATE = 2 MIN/IN  $\Rightarrow$  2.5 GAL/ft<sup>2</sup> SIDES  
 1.0 GAL/ft<sup>2</sup> BOTTOM  
 LEACH PIT - 14.5' L X 6.4' W X 4.87' BI (5.53' H)  
 SIDES : 2 X 14.5' X 4.87' = 141.23 ft<sup>2</sup>  
 141.23 ft<sup>2</sup> X 2.5 GAL/ft<sup>2</sup> = 353.08 GAL  
 END : 2 X 6.4' X 4.87' = 62.34 ft<sup>2</sup>  
 62.34 ft<sup>2</sup> X 2.5 GAL/ft<sup>2</sup> = 155.84 GAL  
 BOTTOM: 14.5' X 6.4' = 92.8 ft<sup>2</sup> X 1.0 GAL/ft<sup>2</sup> = 92.80 GAL  
 MAXIMUM DAILY FLOW = 601.72 GAL

### CONSTRUCTION NOTES

1. Tank should be inspected and pumped at least every second year.
2. The inlet tee of the septic tank should extend 10" below flow line. The outlet tee should extend 14".
3. The pipe should remain level for 2' after exiting the D.Box.
4. All topsoil should be removed to a distance of 10' around system where fill is to be used.



MAR 16 1989