

Station Road - Completed



COPY

No. 79-8

FEB

THE COMMONWEALTH OF MASSACHUSETTS  
BOARD OF HEALTH

Town OF Amherst, Mass.

Application for Disposal Works Construction Permit

Application is hereby made for a Permit to Construct (x) or Repair ( ) an Individual Sewage Disposal System at:

Station Road Lot #5  
Ralph Farrick Location - Address or Lot No.  
196 North Pleasant St., Amherst, Mass. Address

Type of Building Address  
Size Lot 3.742 acres, less sq. feet  
Dwelling - No. of Bedrooms 5 Expansion Attic ( ) Garbage Grinder (x)  
Other - Type of Building Frame No. of persons Max. 10 Showers ( ) - Cafeteria ( )  
Other fixtures

Design Flow 55 gallons per person per day. Total daily 550 gallons.  
Septic Tank - Liquid capacity 1500 gallons Length 10' Width Diameter Depth 5'  
Disposal Trench - No. Bed Width 30' Total Length 0' Total leaching area 1500 sq. ft.  
Seepage Pit No. Diameter Depth below inlet Total leaching area sq. ft.

Other Distribution box (x) Dosing tank ( )  
Percolation Test Results Performed by John A. Brickett No. 69 Date 4/19/79  
Test Pit No. 1 2 minutes per inch Depth of Test Pit 36" Depth to ground water None  
Test Pit No. 2 2 minutes per inch Depth of Test Pit 96" Depth to ground water 84" seepage

Description of Soil 0" to 6" loam - 6" to 12" sand - 12" med. sand w/ fines -  
24" to 42" coarse till w/cobbles - 42" to 96" compact till - water at 84".  
C. Drake present for tests.

Nature of Repairs or Alterations - Answer when applicable

Agreement:

The undersigned agrees to install the aforescribed Individual Sewage Disposal System in accordance with the provisions of TITLE 5 of the State Sanitary Code - The undersigned further agrees not to place the system in operation until a Certificate of Compliance has been issued by the board of health.

Signed [Signature] Date 4/19/79

Application Approved By Date

Application Disapproved for the following reasons: Date

Permit No. Issued Date

THE COMMONWEALTH OF MASSACHUSETTS  
BOARD OF HEALTH

OF  
Certificate of Compliance

THIS IS TO CERTIFY, That the Individual Sewage Disposal System constructed ( ) or Repaired ( )  
by Installer

at  
has been installed in accordance with the provisions of TITLE 5 of The State Sanitary Code as described in the application for Disposal Works Construction Permit No. dated

THE ISSUANCE OF THIS CERTIFICATE SHALL NOT BE CONSTRUED AS A GUARANTEE THAT THE SYSTEM WILL FUNCTION SATISFACTORY.

DATE Inspector

CHECK OR FILL IN WHERE APPLICABLE

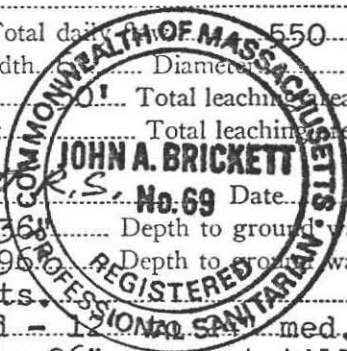

COPY

# DEEP SOIL LOGS

OWNER RALPH FARRICK

DATE 4/19/79

LOCATION STATION RO -

OBSERVER FARRICK  
DRAKE - BRICKETT

#1

LOT #5  
RETEST

#2

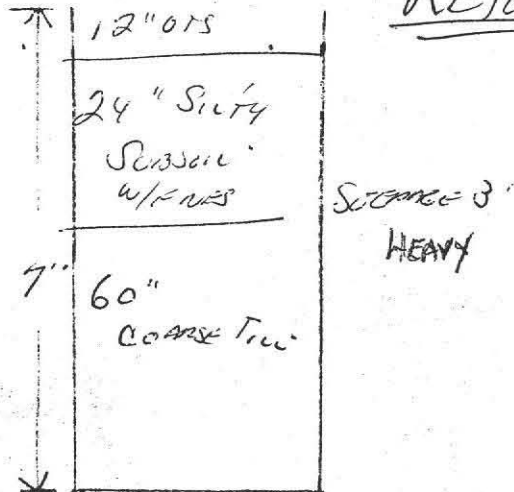

GROUND WATER SEE PAGE 17 3' +  
NGLW AT 7'

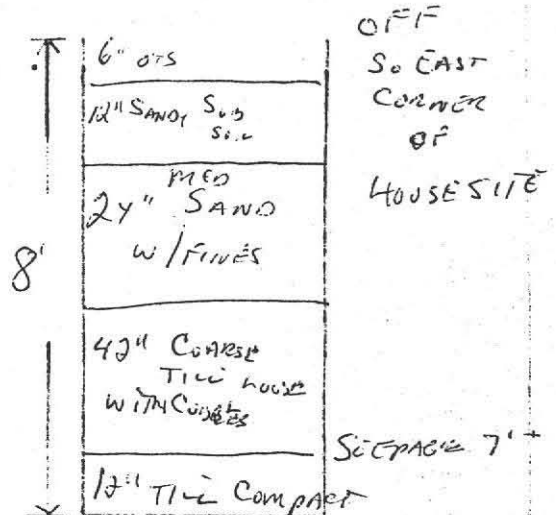

GROUND WATER SEE PAGE 7'



GROUND WATER -



GROUND WATER -

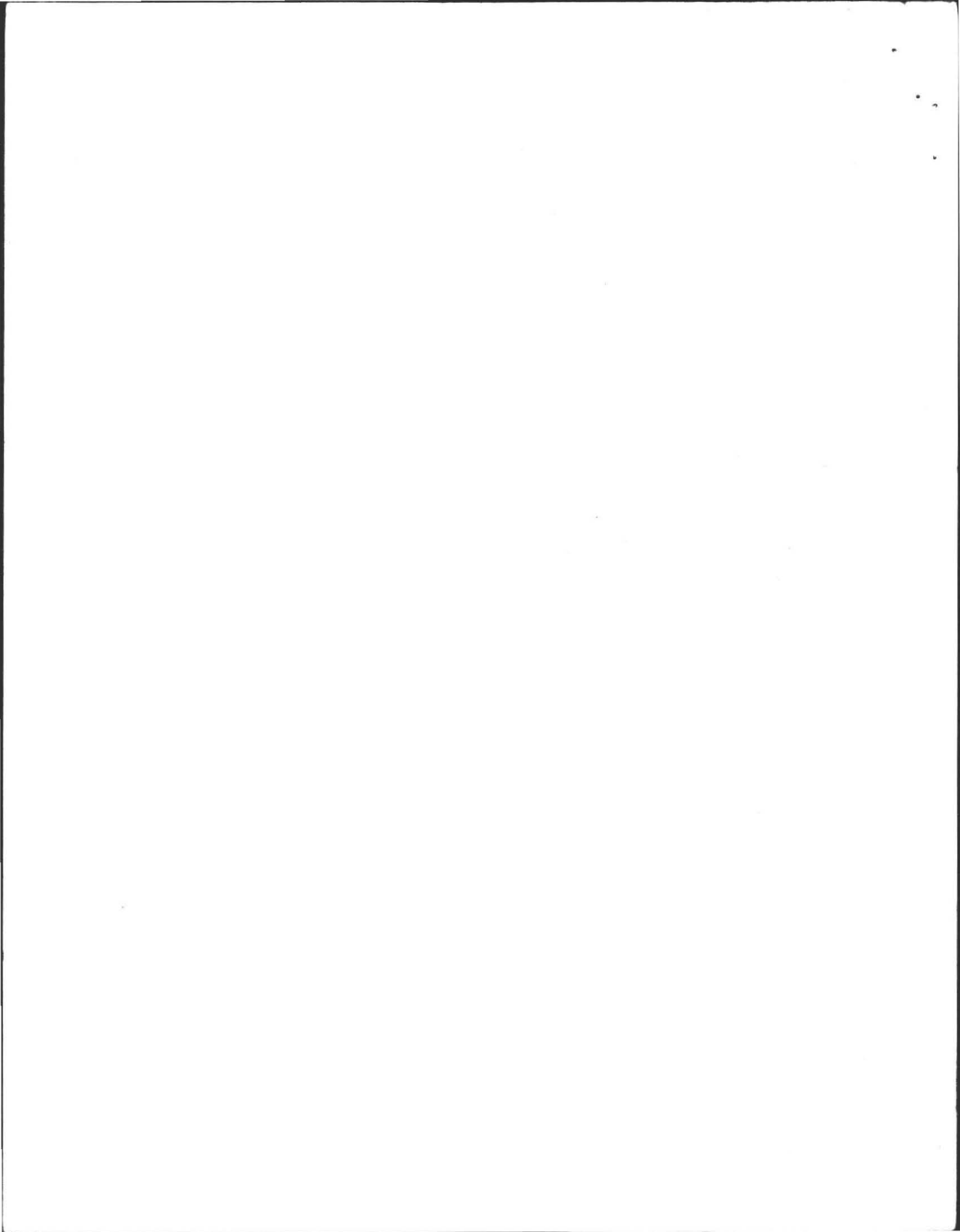

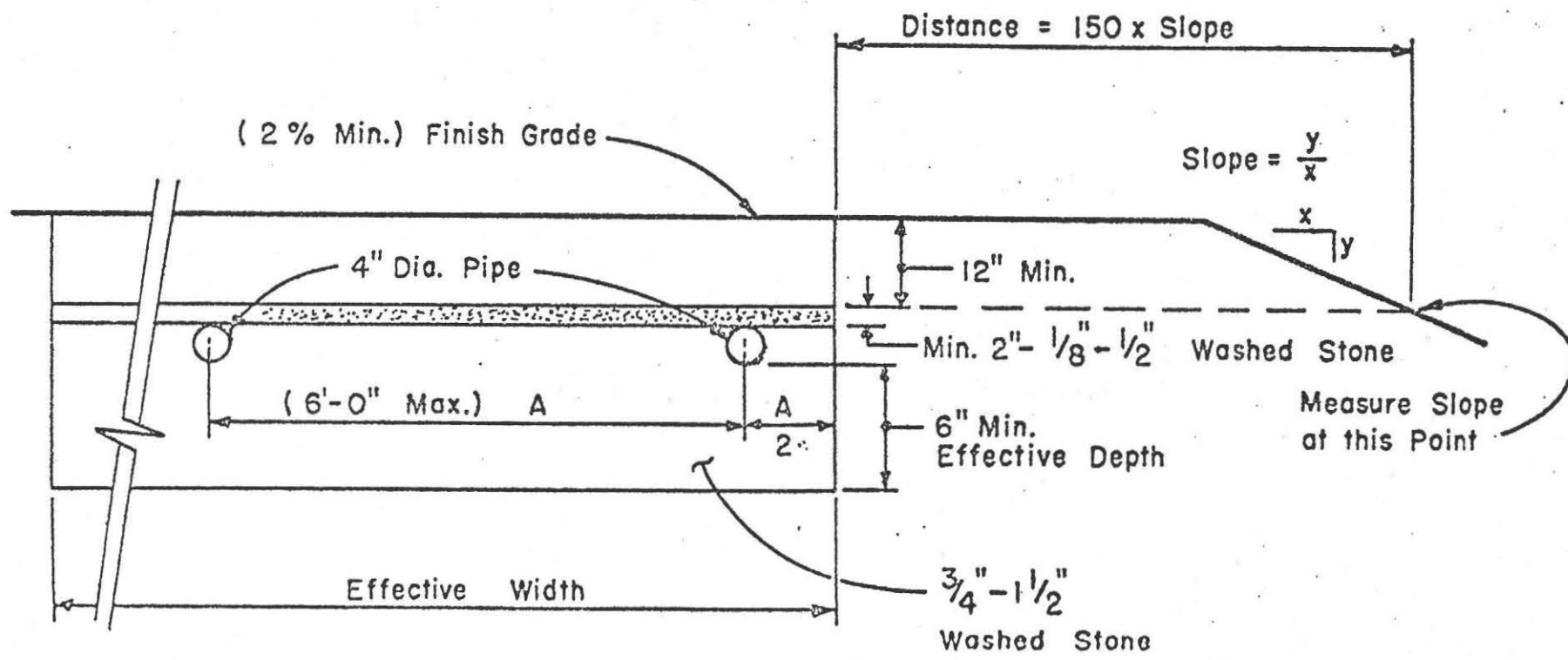

## LEACHING FIELDS

No Scale

Illustration C

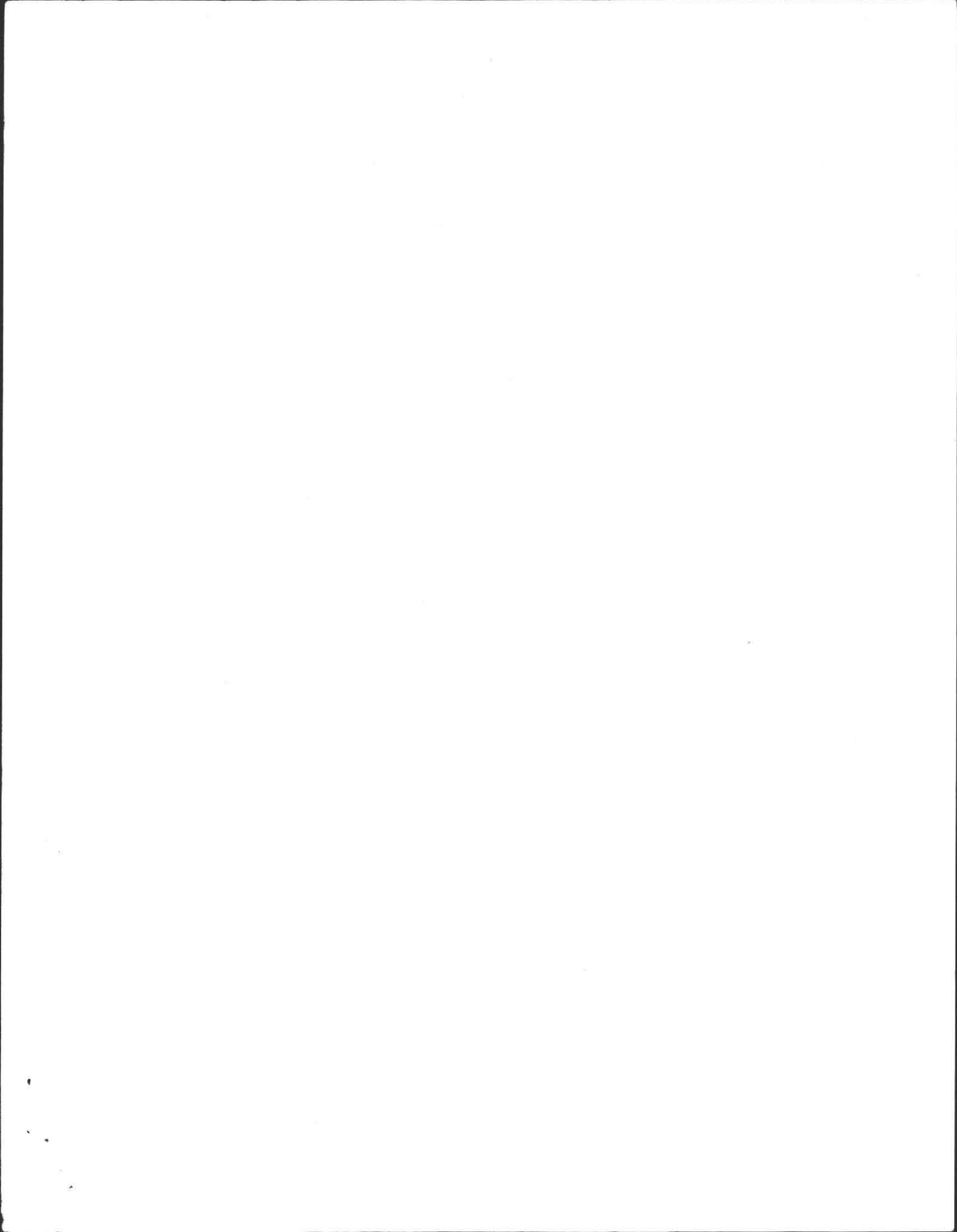



JOHN A. BRICKETT, R.S.  
 19 SUMMER STREET  
 GREENFIELD, MASS. 01301  
*John A. Brackett R.S.*  
 4/19/79

No Scale

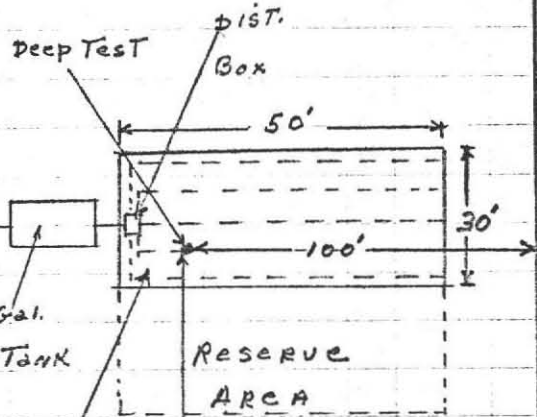
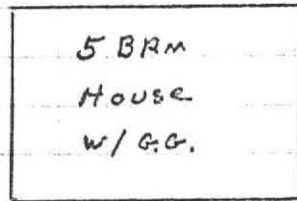

1500 Gal. septic Tank

Leach Field  
 (see ATTACHED  
 SHEET I//.C)

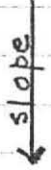

383'

TOWN WATER

450'

916'

DEEP TEST LOG

LOAM	6"
SANDY LOAM	12"
MED SAND	24"
Loose coarse Till w/stones	
	42" Water seepage
Till compact	12"

8'

LOT #5  
3.742 ACRES

170'

STATION ROAD

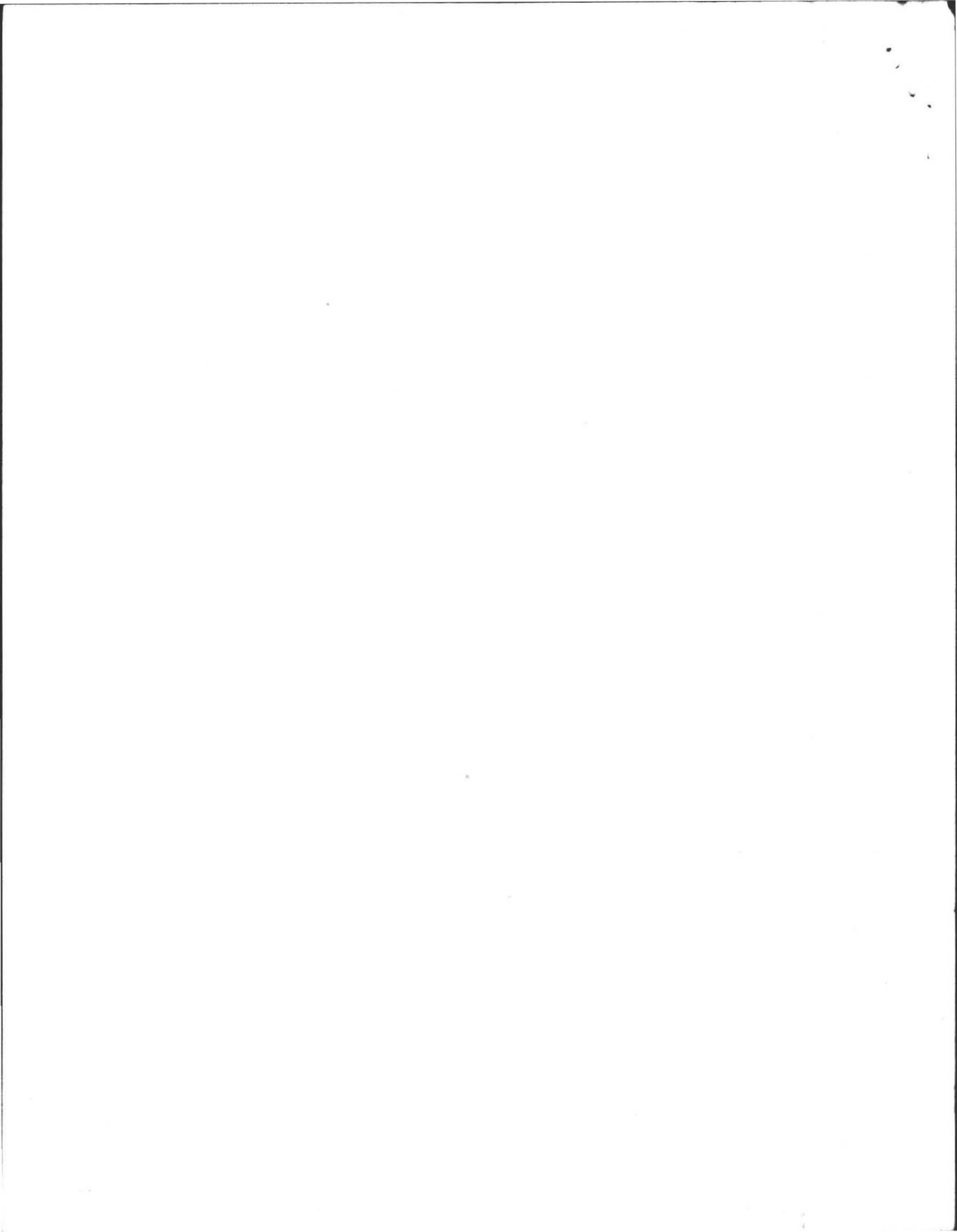

NOTE: LOTS SHOWN HEREON ARE PORTIONS OF BOOK 1376, PAGE 210.

LEGEND

- SET IRON PIN
- FOUND IRON PIN
- △ UNMARKED POINT

LAND OF JONATHAN B. & ALICE S. GREENBERG  
 BOOK 1522, PAGE 10  
 SEE: PLAN BOOK 71, PAGE 42

LAND OF HARRY O. PADDOCK  
 S 71° 23' 18" E  
 502.69'

WB POINT

59° 43' 05" E 200.00' (60.960M)  
 N 63° 22' 13" E 118.95' (36.256M)

TIE COURSE  
 R=70.00' (21.336M)  
 L=142.15' (43.327M)  
 N 31° 32' 39" E

5

3.742 ACRES ±  
 (1.5143 HECTARES ±)

(32.534M) 106.74'  
 N 59° 43' 05" E 475.63'

6

3.309 ACRES ±  
 (1.3391 HECTARES ±)

(38.274M) 125.57'  
 N 59° 43' 05" E 415.55'

7

2.346 ACRES ±  
 (0.9494 HECTARES ±)

(38.274M) 87.87'  
 N 59° 43' 05" E 455.55'

PLAN OF LAND IN  
**AMHERST, MASSACHUSETTS**  
 SURVEYED FOR

(51.816M)

(51.816M)

(51.249M)

BOOK 1121, PAGE 342  
 622.96' (153.220M)  
 73.445M 240.96' (250.951M)

BOOK 1942, PAGE 267  
 49.884M 163.66' (138.584M)

BOOK 1942, PAGE 267  
 218.17' (66.498M)  
 530° 42' 10" W 291.01'  
 56.15' (17.115M)  
 112.069M (1107.692M)



BOARD OF HEALTH

TOWN OF AMHERST, MASSACHUSETTS

STATION ROAD, LOT #5

Important Information Regarding Your Private Sewage Disposal System

DISPLAY THIS DOCUMENT IN A PROMINENT PLACE

Owner ELLIOT FORTESCUE Address IDAHA LANE

Installer HOWARD MANN Address BELCHERTOWN, MA.

Date Installation Inspected and Approved 11-8-79

Description of System: Tank Capacity: 1500 GALLON

Leach Field ( ) Bed (X) Seepage Pit ( ) Square Feet: 1850 ±

Garbage Grinder Yes (X) No ( ) No. Bedrooms: 5 No. People MAX 10

AS - BUILT PLAN:

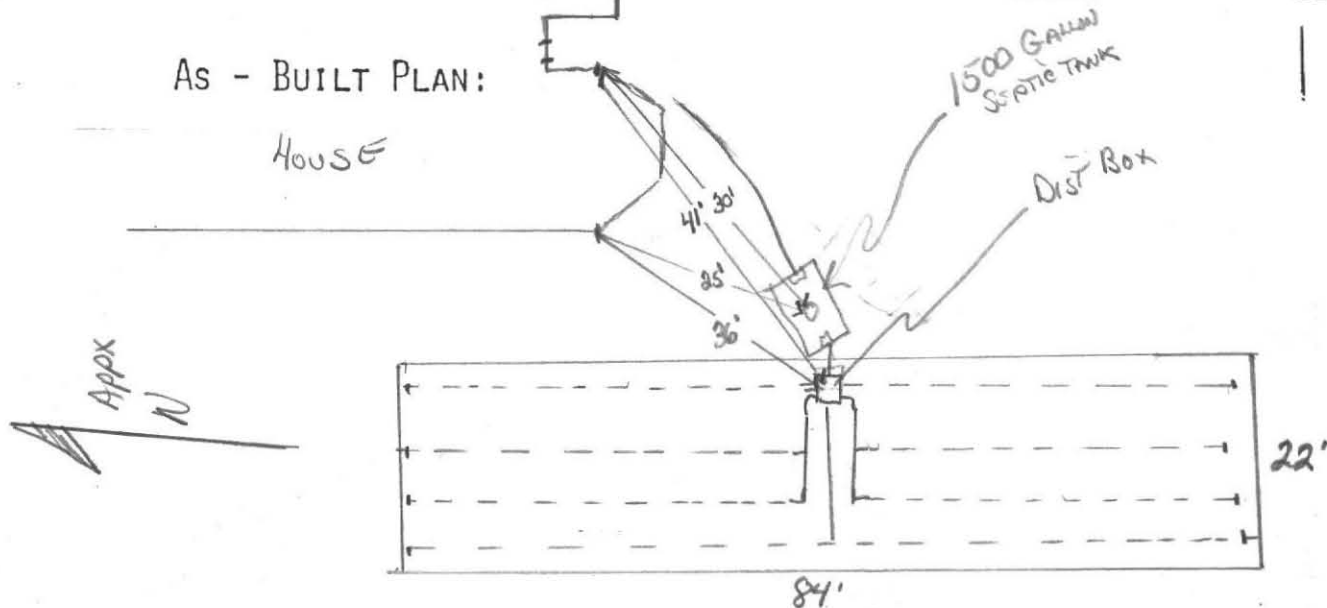

PROPER MAINTENANCE OF YOUR PRIVATE SEWAGE DISPOSAL SYSTEM

1. This system must be inspected periodically and the tank pumped out at an interval not to exceed 3 years.
2. For your protection sanitary pumpers are licensed by the Amherst Board of Health.
3. Regular pumping is crucial to avoid early failure and costly repairs of the system.
4. DO NOT dispose into the system such items as rags, string, sanitary napkins, coffee grounds as they can cause it to clog and fail.
5. Further information can be obtained by contacting your Health Department at 253-7077.

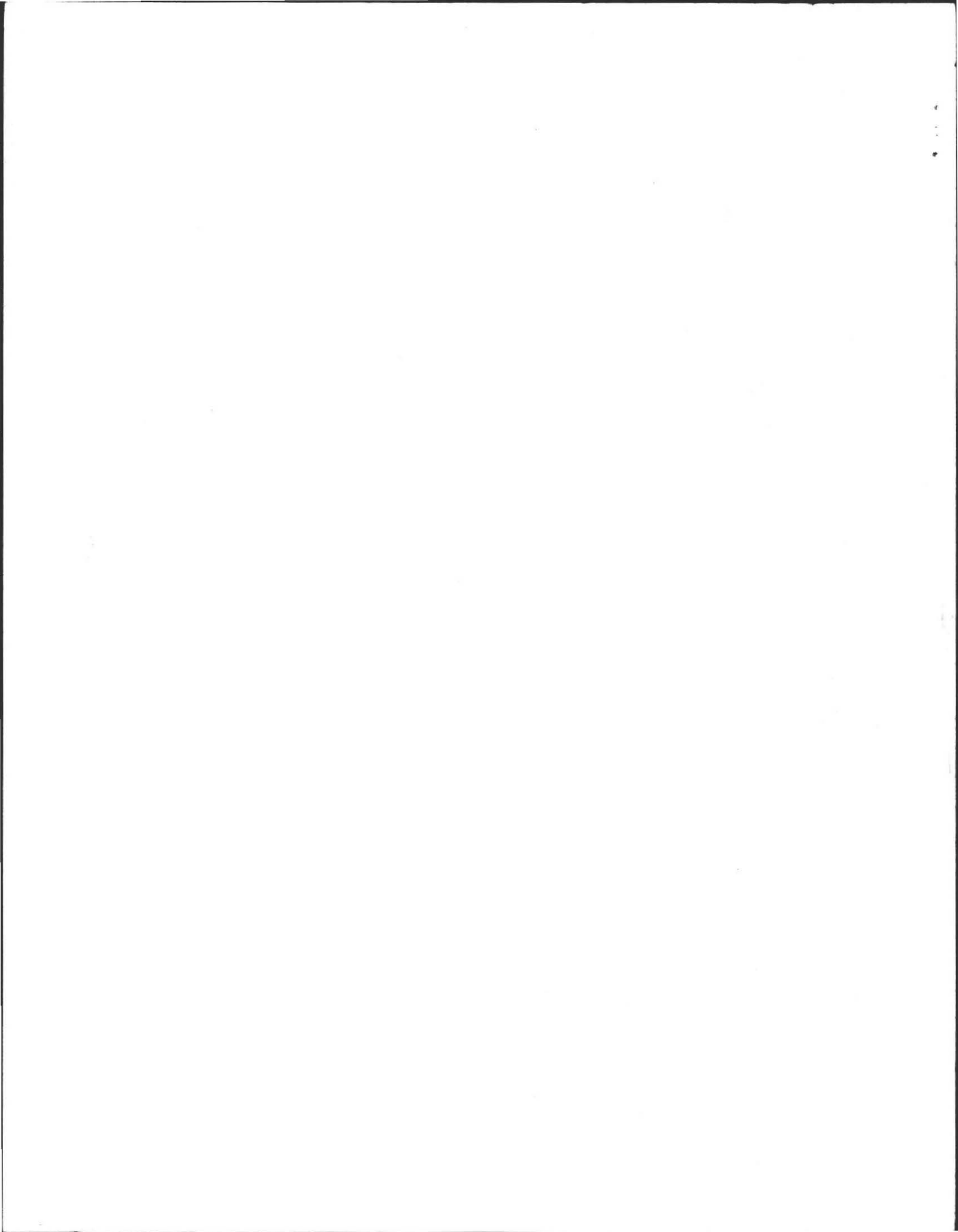

No. 84-4

FEE \$90

THE COMMONWEALTH OF MASSACHUSETTS

BOARD OF HEALTH

Town OF Amherst, Mass.

Application for Disposal Works Construction Permit

Application is hereby made for a Permit to Construct (X) or Repair ( ) an Individual Sewage Disposal System at:

Station Road Lot # 1  
Location - Address  
Wm Pearson or Lot No.  
10 Main Street, Montague, Mass.  
R. Roberts Owner  
Leverett Address  
Installer

Type of Building  
Dwelling - No. of Bedrooms 3 Expansion Attic ( ) Garbage Grinder (X)  
Other - Type of Building Frame No. of persons Max. 6 Showers ( ) - Cafeteria ( )  
Other fixtures

Design Flow 55 gallons per person per day. Total daily flow 330 gallons.  
Septic Tank - Liquid capacity 1500 gallons Length 10' Width 6' Diameter Depth 5'  
Disposal Trench - No. Width Total Length Total leaching area sq. ft.  
Seepage Pit No. 2 Diameter 750 gal Depth below inlet 2 1/2' Total leaching area 800 sq. ft.  
Other Distribution box (X) Dosing tank ( )

Percolation Test Results Performed by F. A. Filios, R.S. Date 3/15/81  
Test Pit No. 1 1 minutes per inch Depth of Test Pit 36" Depth to ground water None  
Test Pit No. 2 ----- minutes per inch Depth of Test Pit 120" Depth to ground water None

Description of Soil 0" to 10" topsoil - 10" to 23" sandy w/some gravel -  
23" to 120" stratified coarse sand & gravel - no water at 120".

Nature of Repairs or Alterations - Answer when applicable.

Agreement:  
The undersigned agrees to install the aforescribed Individual Sewage Disposal System in accordance with the provisions of TITLE 5 of the State Sanitary Code - The undersigned further agrees not to place the system in operation until a Certificate of Compliance has been issued by the board of health.

Signed William E. Pearson Date 2/28/84  
Application Approved By [Signature] Date 3-8-84  
Application Disapproved for the following reasons

Permit No. 84-4 Issued 3-8-84 Date

THE COMMONWEALTH OF MASSACHUSETTS

BOARD OF HEALTH

OF  
Certificate of Compliance

THIS IS TO CERTIFY, That the Individual Sewage Disposal System constructed ( ) or Repaired ( )  
by  
at

has been installed in accordance with the provisions of TITLE 5 of The State Sanitary Code as described in the application for Disposal Works Construction Permit No. dated

THE ISSUANCE OF THIS CERTIFICATE SHALL NOT BE CONSTRUED AS A GUARANTEE THAT THE SYSTEM WILL FUNCTION SATISFACTORY.

DATE Inspector

THE COMMONWEALTH OF MASSACHUSETTS

BOARD OF HEALTH

No. 84-4 Town OF Amherst FEE \$90

Disposal Works Construction Permit

Permission is hereby granted W. Pearson R. Roberts  
to Construct (X) or Repair ( ) an Individual Sewage Disposal System  
at No. Lot # 1 Station Rd - WTC Amherst Woods  
as shown on the application for Disposal Works Construction Permit No. 84-4 Dated 3-8-84

DATE 3-8-84 Board of Health

CHECK OR FILL IN WHERE APPLICABLE

Handwritten text, possibly bleed-through from the reverse side of the page. The text is faint and difficult to decipher but appears to contain several lines of writing.

Handwritten text, possibly bleed-through from the reverse side of the page.

Handwritten text, possibly bleed-through from the reverse side of the page.

Extensive handwritten text, possibly bleed-through from the reverse side of the page. The text is very faint and covers most of the lower half of the page.



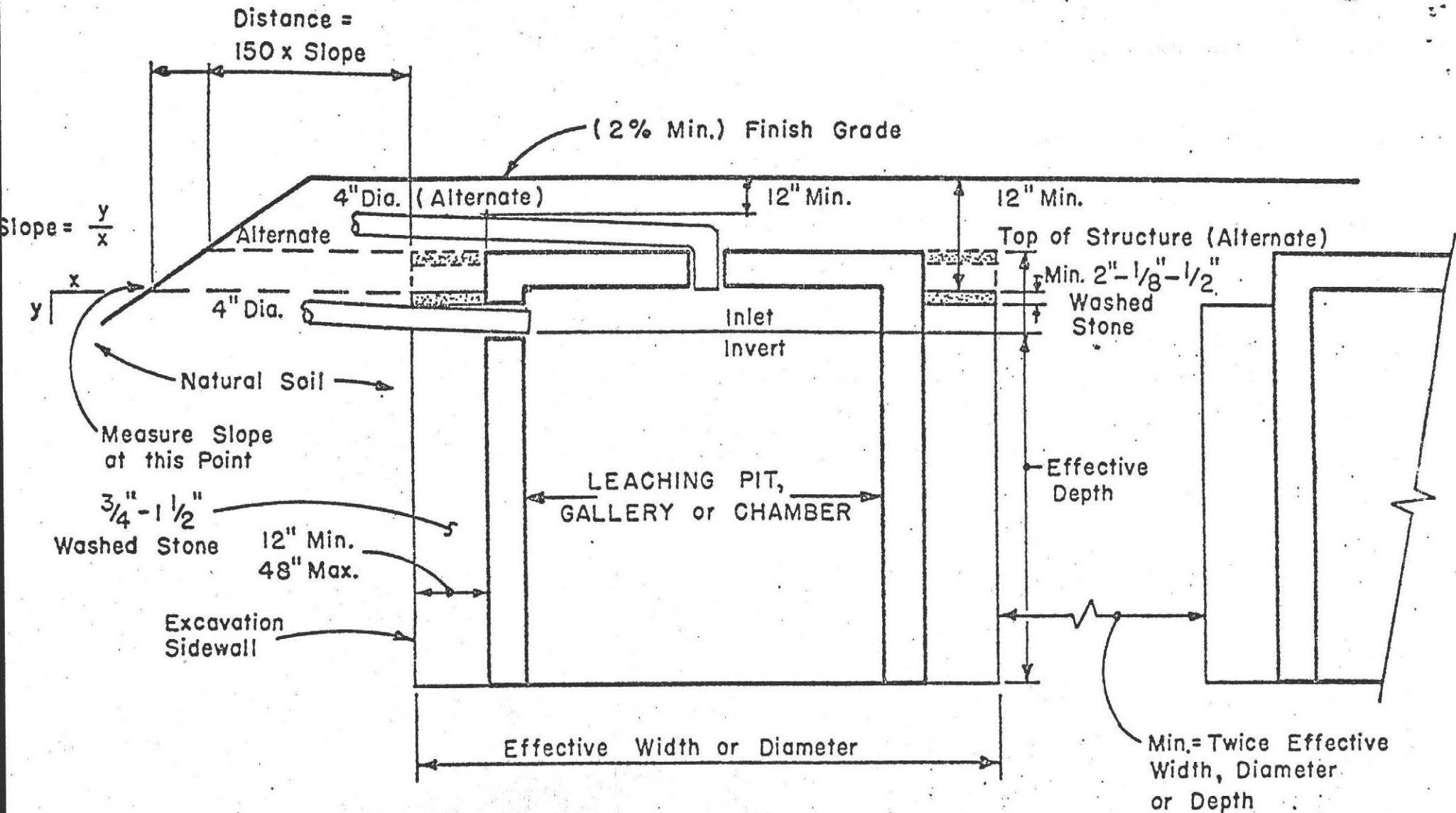

## LEACHING PITS, GALLERIES, CHAMBERS

No Scale

Illustration A

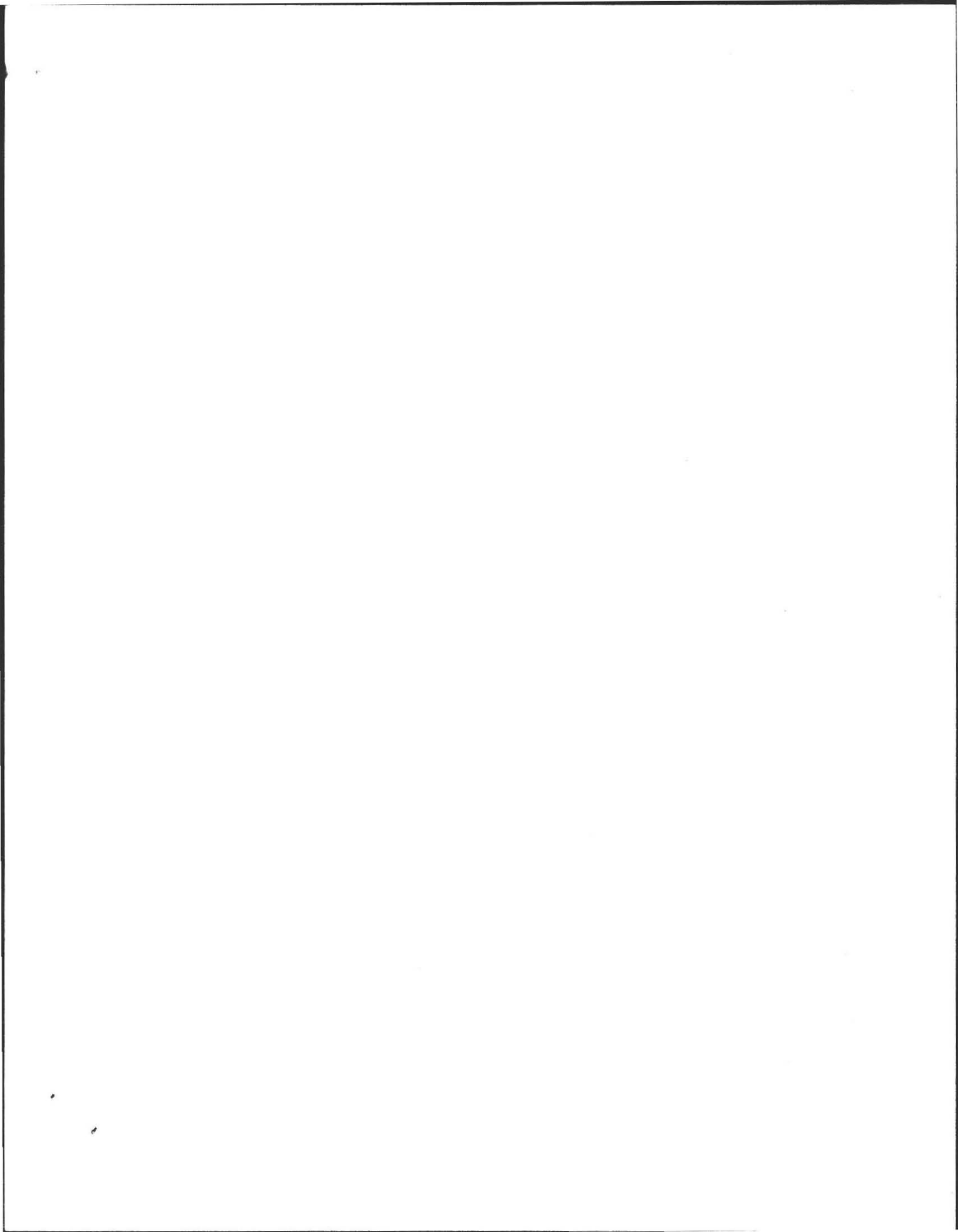

# PERCOLATION TEST LOCATION

For: Amherst Woods

Scale: 1" = 40'

By: Frederick Filios

Lot #1



STATION ROAD

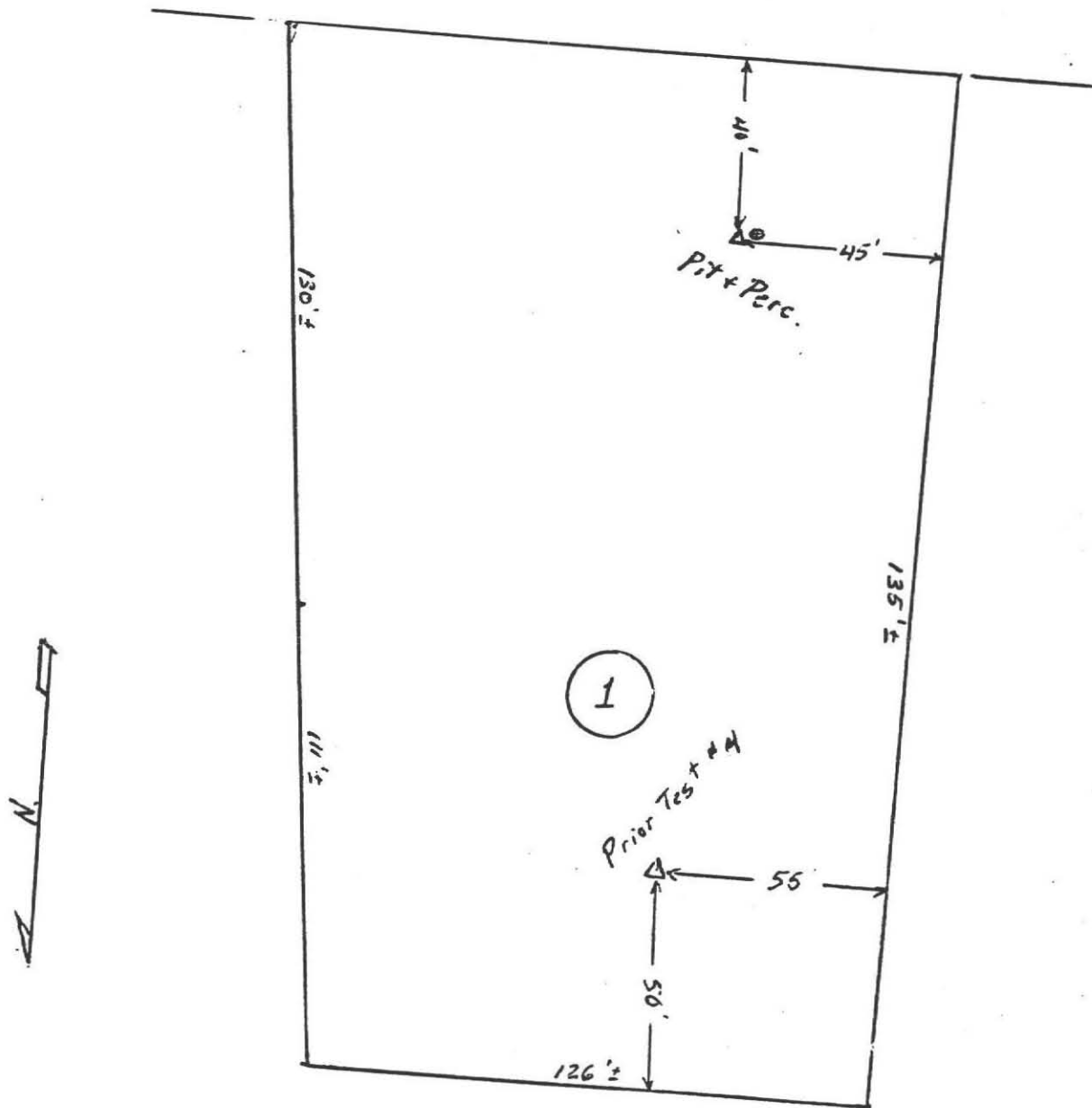

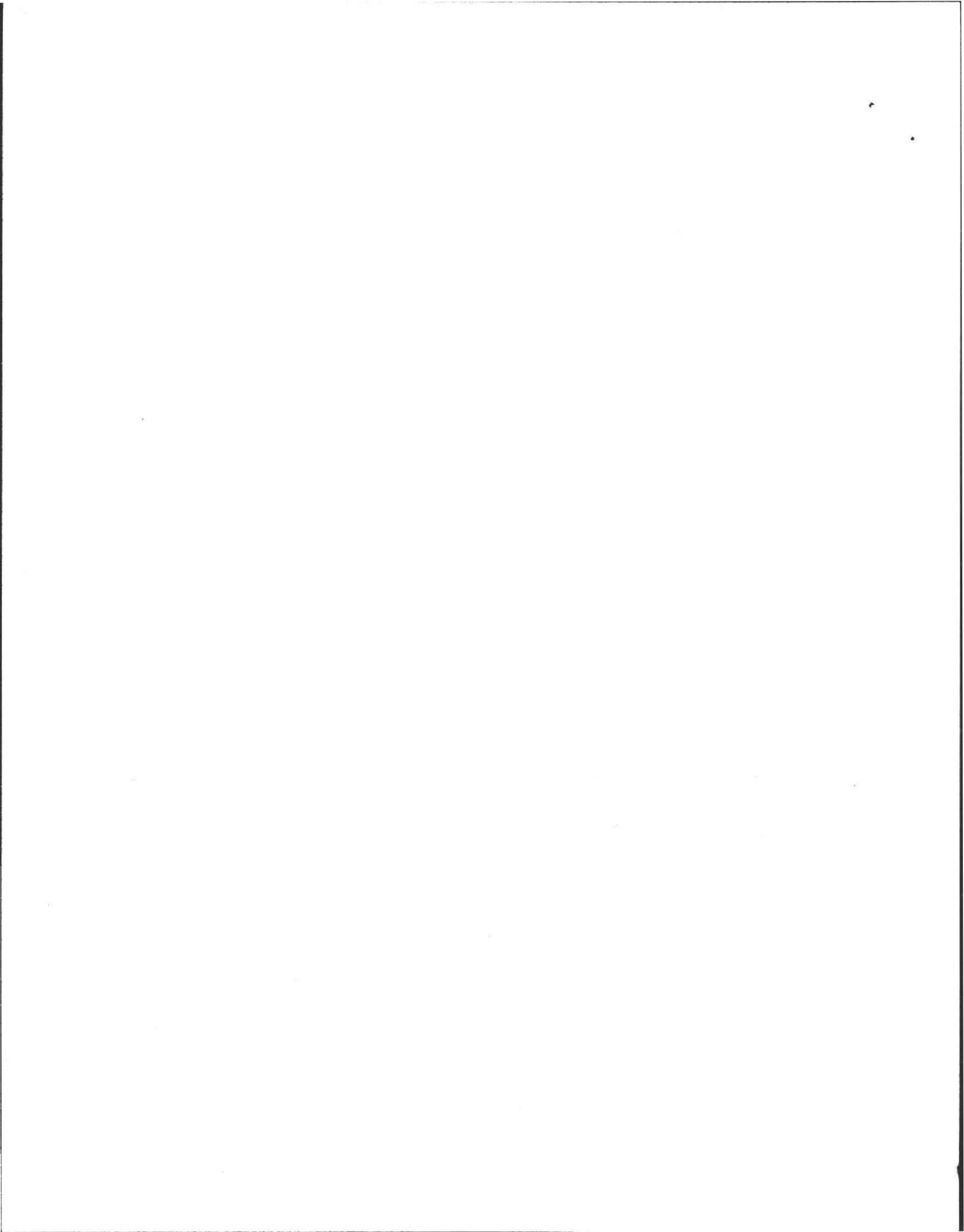

# DEEP SOIL LOGS

OWNER Amherst Woods Phase I

Date Mar. 15, 1981

LOCATION Station Road

OBSERVER F.A. Filios

Soil Lot #1

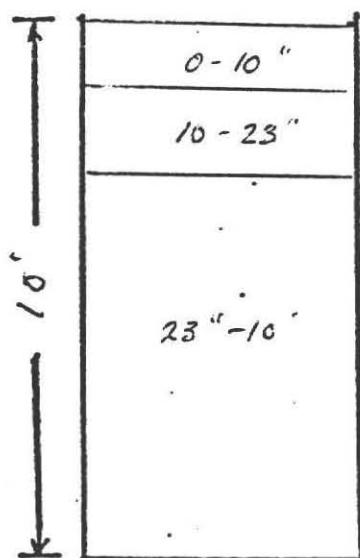

Topsoil  
 Subsoil; sandy w/  
 some gravel.  
 Stratified coarse  
 sand + gravel  
 (a stata with cobbles)

Ground Water none

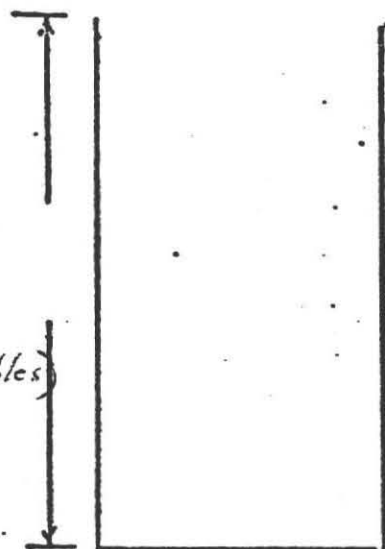

Ground Water \_\_\_\_\_

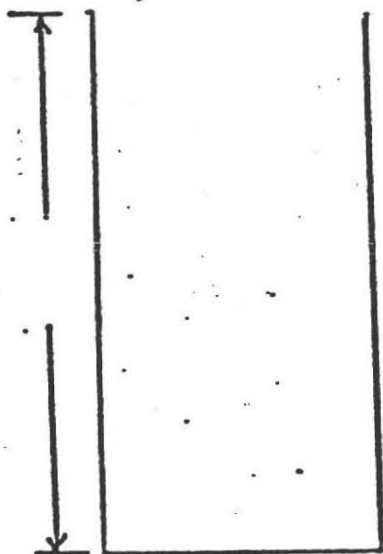

Ground Water \_\_\_\_\_

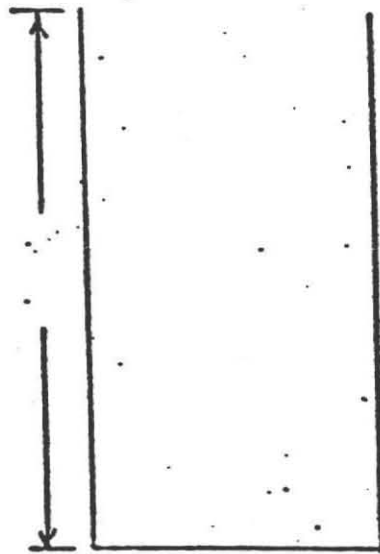

Ground Water \_\_\_\_\_

Percolation at 36"  
.57 minutes/inch



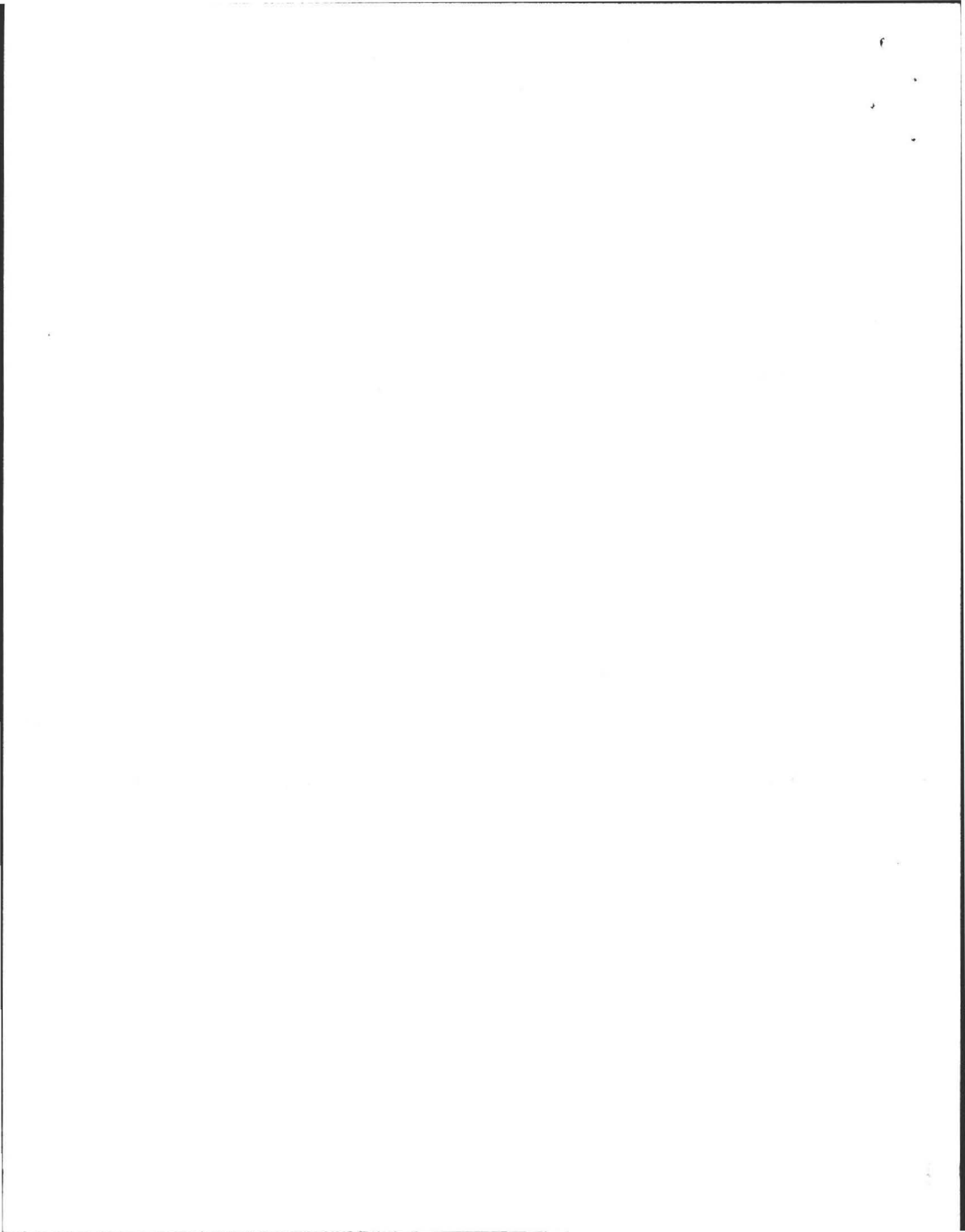

# DEEP SOIL LOGS

OWNER JEFF FLOWER

DATE MAY 1, 1980

LOCATION OFF STATION RD.

OBSERVER DRACE

\* 1

HOLE #1'S

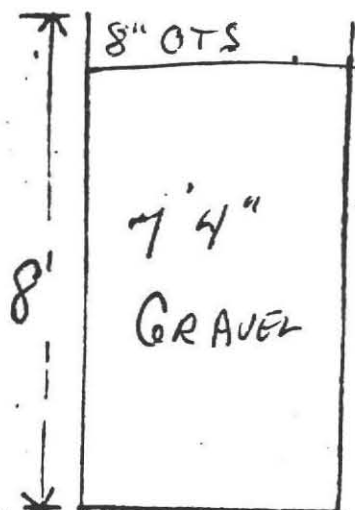

GROUND WATER NONE

\* 2

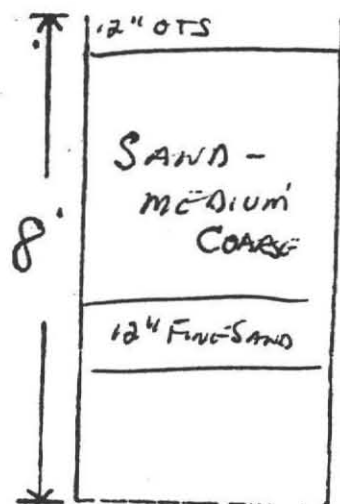

GROUND WATER NONE AT 8'

\* 3

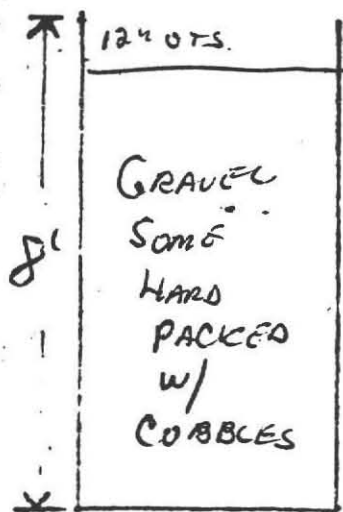

GROUND WATER NONE AT 8'

\* 4

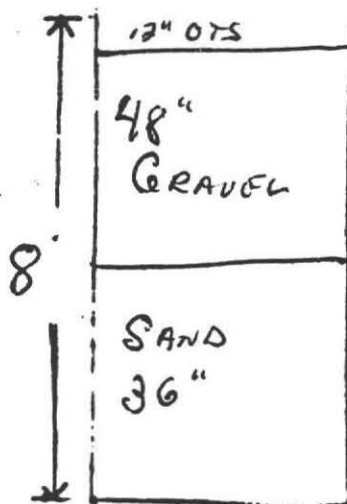

GROUND WATER NONE AT 8'

Bill Prasher

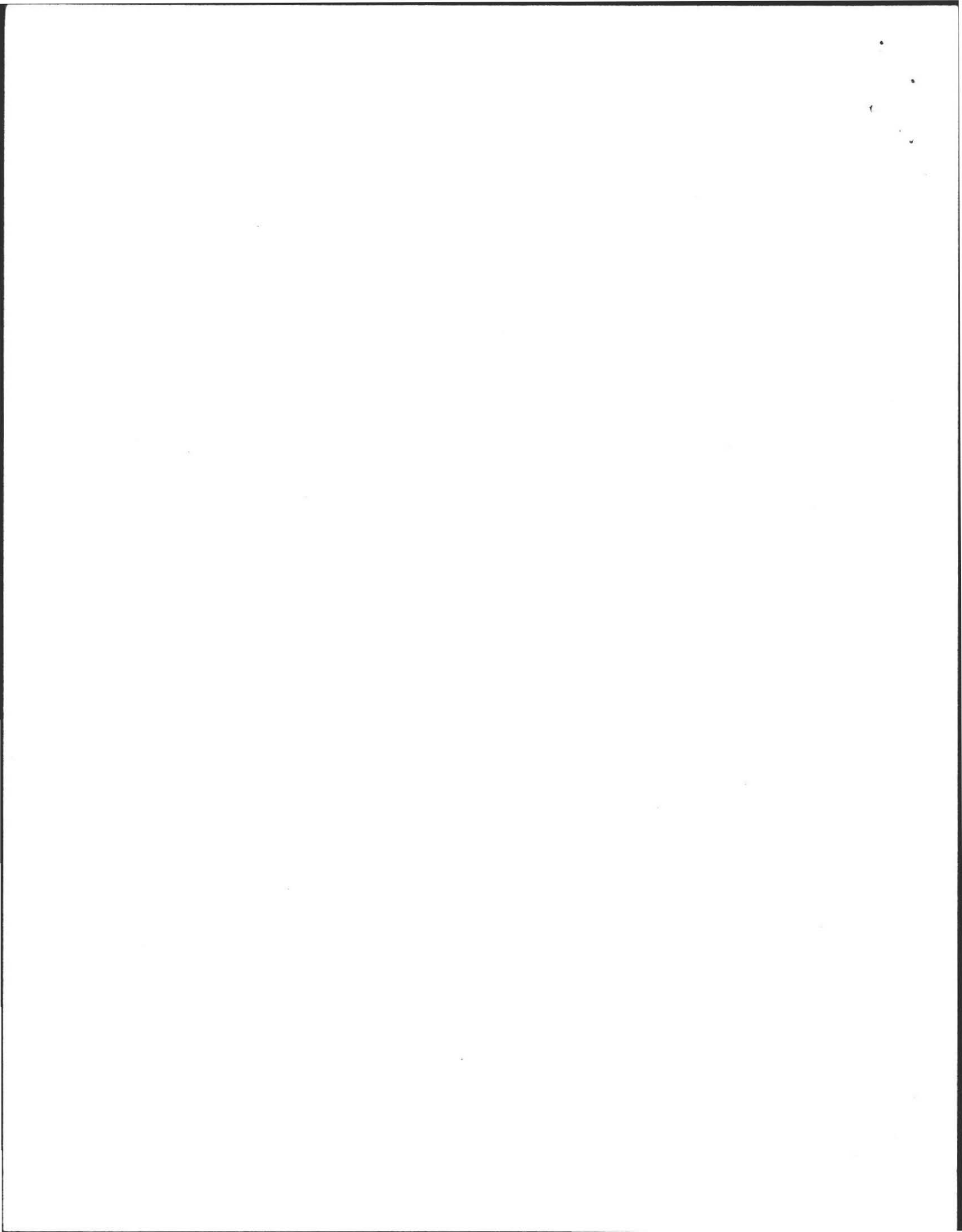



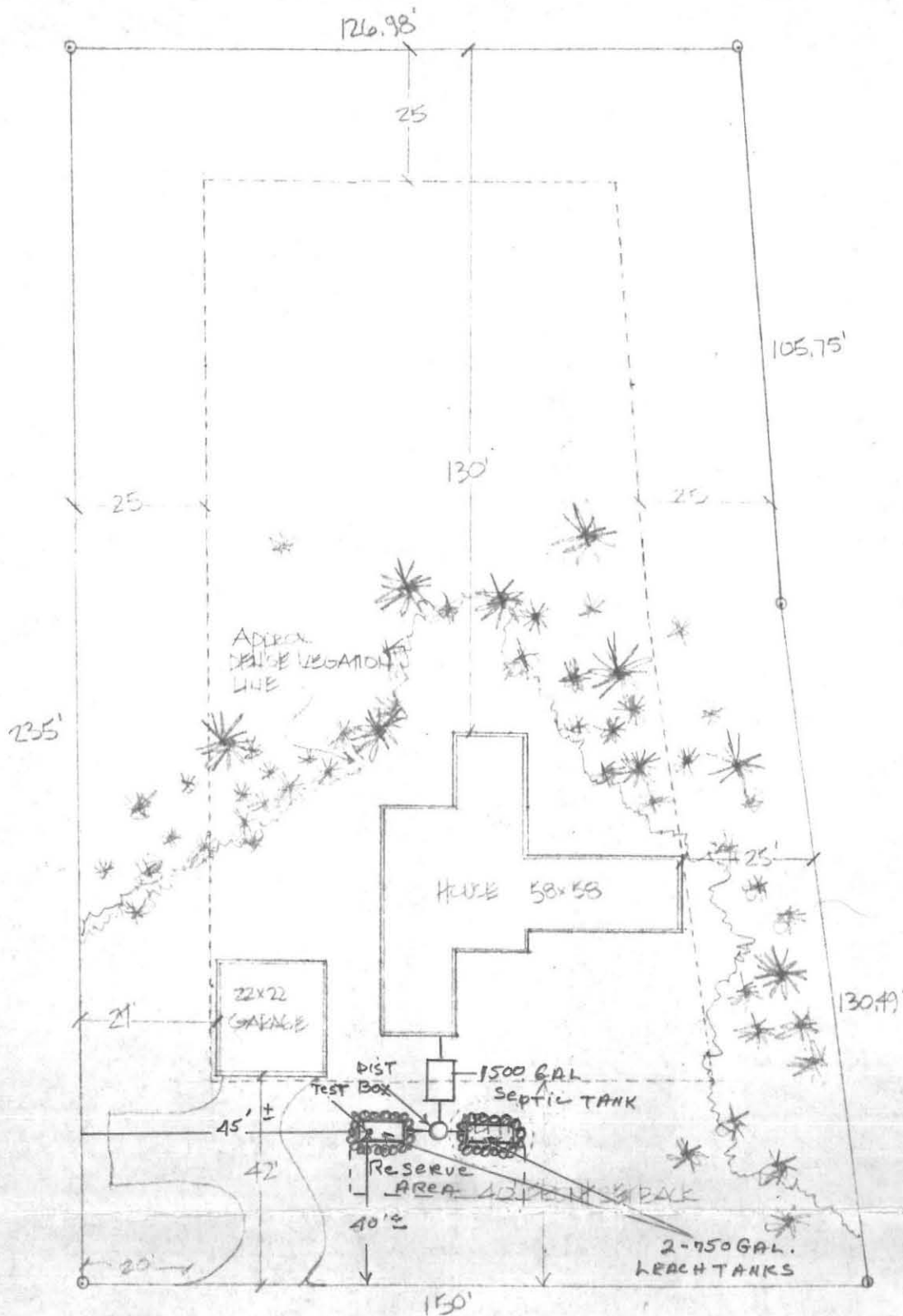

JOHN A. BRICKETT, R.S.  
 19 SUMMER STREET  
 GREENFIELD, MASS. 01301  
*John A. Brickett R.S.*  
 2/20/84  
 NO SCALE  
 SEWAGE DISPOSAL  
 DESIGN

STATION ROAD  
 AMHERST WOODS LOT #1 32,105 SF  
 AMHERST, MASSACHUSETTS

DATE 2/15/84  
 SCALE 3/16  
 BY W. PEARSON

PLAN FOR  
 LOT #1 AMHERST WOODS  
 AMHERST, MA.  
 BILL PEARSON



**SUNBEAM**  
**POST & BEAM**  
 MONTAGUE, MA. 367-2109





**BOARD OF HEALTH, AMHERST, MASSACHUSETTS  
APPLICATION FOR DISPOSAL WORKS CONSTRUCTION PERMIT**

No. 65-32 Date Oct. 25, 1965 Fee 3.00 Date Rec'd. 10-25-65 By CEH

Application is hereby made for a permit to Construct (X) or Repair ( ) an Individual Sewage Disposal System at:

Location—Address 25 Station Rd or Lot No. \_\_\_\_\_  
 Owner William G. Robinson Address 384 C Northampton Rd  
 Contractor William G. Cass Address South Deerfield  
 Type of Building Frame Residence Dimensions 87 x 40 Size Lot 208 x 154  
 Dwelling—No. of Bedrooms (4) Expansion Attic No Garbage Grinder ( )  
 Other \_\_\_\_\_ No. of persons 3 Showers (2) \_\_\_\_\_  
 Other fixtures 2 bathtubs - 3 water closets  
 Town Water? Yes Type of Well \_\_\_\_\_

Design Flow \_\_\_\_\_ gallons per person per day. Total daily flow \_\_\_\_\_ gallons  
 Septic Tank—Liquid capacity 1200 gallons Dimensions: L \_\_\_\_\_ W \_\_\_\_\_ D \_\_\_\_\_  
 Disposal Trench—No. \_\_\_\_\_ Width \_\_\_\_\_ Total Length \_\_\_\_\_ Total leaching area \_\_\_\_\_ sq. ft.  
 Disposal Bed—No. 1 Diameter \_\_\_\_\_ Depth below inlet \_\_\_\_\_ Total leaching area 400 sq. ft. *Min*  
 Dry Well—No. \_\_\_\_\_ Diameter \_\_\_\_\_ Depth below inlet \_\_\_\_\_ Dimensions: \_\_\_\_\_ x \_\_\_\_\_ x \_\_\_\_\_  
 Other: Distribution box ( ) No. \_\_\_\_\_ Dosing tank ( ) \_\_\_\_\_

(Depth of Soil Line Below finished grade at foundation \_\_\_\_\_)  
 Percolation Test Results Performed by Dale Date \_\_\_\_\_  
 Test Pit No. 1 10 minutes per inch Depth of Test Pit 30"  
 Test Pit No. 2 8 minutes per inch Depth of Test Pit 30"

Description of Soil \_\_\_\_\_ Depth to Ground Water \_\_\_\_\_  
 Will disposal area be filled? \_\_\_\_\_ Cut down? \_\_\_\_\_  
 (On reverse side or separate sheet, show plot plan with building. Include dimensions, distances from all boundaries. Show location of wells, streams, ledge, large trees, etc.)

AGREEMENT: The undersigned agrees to construct the aforescribed individual sewage disposal system in accordance with the provisions of Article XI of the Sanitary Code and regulations of the Amherst Board of Health. The undersigned further agrees not to place the system in operation until a Certificate of Compliance has been issued by this board of health.

Application Approved by Dale William G. Robinson Owner or builder 10/25/65 date  
AREA TO BE DETERMINED AFTER CELLAR EXCAVATION 10-27-65 date  
 Application Disapproved for the following reasons: \_\_\_\_\_

**BOARD OF HEALTH, AMHERST, MASSACHUSETTS  
CERTIFICATE OF COMPLIANCE**

THIS IS TO CERTIFY, That the individual Sewage Disposal System installed ( ) or repaired ( ) by \_\_\_\_\_ at \_\_\_\_\_ has been constructed in accordance with the provisions of \_\_\_\_\_ INSTALLER Article XI of the State Sanitary Code as described in the application for Disposal Works Construction Permit No. \_\_\_\_\_ dated \_\_\_\_\_ The issuance of this certificate shall not be construed as a guarantee that the system will function satisfactorily.  
 DATE \_\_\_\_\_ Inspector \_\_\_\_\_

**BOARD OF HEALTH, AMHERST, MASSACHUSETTS  
DISPOSAL WORKS CONSTRUCTION PERMIT**

No. 65-32 Permission is hereby granted Wm G. Robinson to construct (X) or repair ( ) an Individual Sewage Disposal System at 25 Station Rd as shown on the application for Disposal Works Construction Permit No. \_\_\_\_\_ This permit is issued with the understanding that future alterations or additions will be made if necessary. This permit shall not be construed as permission to create or maintain any sewage nuisance and in the issuance of this permit the Board of Health assumes no responsibility for the future operation or maintenance of the system.  
 DATE 10/26/65 CEH Board of Health

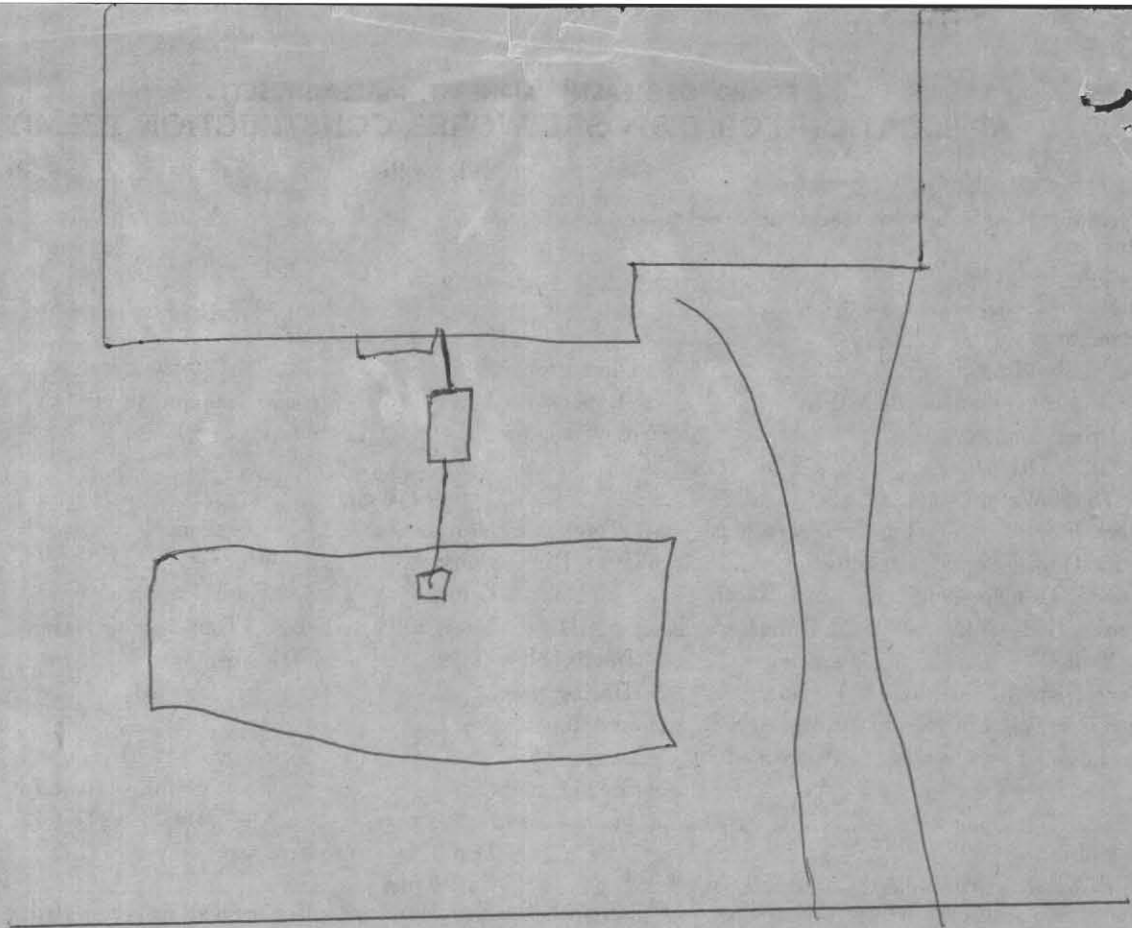

STATION ROAD

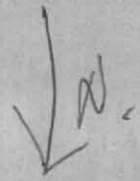



**BOARD OF HEALTH, AMHERST, MASSACHUSETTS  
APPLICATION FOR DISPOSAL WORKS CONSTRUCTION PERMIT**

No. 81-8 Date 6-5-81 Fee 15.00 Date Rec'd. Jun 9, 1981 By [Signature]

Application is hereby made for a permit to Construct (  ) or Repair ( ) an Individual Sewage Disposal System at:

Location—Address Station Road 88 Crossbrook, N.H. or Lot No. 3  
 Owner ~~Don Hadley~~ Chris Hurn & Tony Allen Address ~~83 Hartwood Av. Northampton~~  
 Contractor Designs In Construction INC. KARLS Address 38 Hartlow Av. Northampton  
 Type of Building \_\_\_\_\_ Dimensions \_\_\_\_\_ Size Lot .60 Acres  
 Dwelling—No. of Bedrooms 3 Expansion Attic ( ) Garbage Grinder ( )  
 Other \_\_\_\_\_ No. of persons \_\_\_\_\_ Showers ( )  
 Other fixtures \_\_\_\_\_

X NOTED NUMBER OF DISPOSAL WORKS INSTALLER

Town Water? Yes Type of Well \_\_\_\_\_  
 Design Flow \_\_\_\_\_ gallons per person per day. Total daily flow \_\_\_\_\_ gallons  
 Septic Tank—Liquid capacity 1000 gallons Dimensions: L \_\_\_\_\_ W \_\_\_\_\_ D \_\_\_\_\_  
 Disposal Trench—No. 2 Width 3' Total Length 106 Total leaching area 318 sq. ft. sides bottom  
 Disposal Bed—No. \_\_\_\_\_ Diameter \_\_\_\_\_ Depth below inlet \_\_\_\_\_ Total leaching area \_\_\_\_\_ sq. ft.  
 Dry Well—No. \_\_\_\_\_ Diameter \_\_\_\_\_ Depth below inlet \_\_\_\_\_ Dimensions: \_\_\_\_\_ x \_\_\_\_\_ x \_\_\_\_\_  
 Other: Distribution box (  ) No. \_\_\_\_\_ Dosing tank ( )  
 (Depth of Soil Line Below finished grade at foundation \_\_\_\_\_)

Percolation Test Results Performed by Frederick Filios Date Jan 26 1981  
 Test Pit No. 1 8 minutes per inch Depth of Test Pit \_\_\_\_\_  
 Test Pit No. 2 \_\_\_\_\_ minutes per inch Depth of Test Pit \_\_\_\_\_  
 Description of Soil enclosed Depth to Ground Water \_\_\_\_\_  
 Will disposal area be filled? \_\_\_\_\_ Cut down? \_\_\_\_\_  
 (On reverse side or separate sheet, show plot plan with building. Include dimensions, distances from all boundaries. Show location of wells, streams, ledge, large trees, etc.)

AGREEMENT: The undersigned agrees to construct the aforescribed individual sewage disposal system in accordance with the provisions of Article XI of the Sanitary Code and regulations of the Amherst Board of Health. The undersigned further agrees not to place the system in operation until a Certificate of Compliance has been issued by this board of health.

SEE NOTE RE CURTAIN DRAIN

Application Approved by [Signature] Designs In Construction INC. 6/4/81  
 Owner or builder J. Don Hadley - owner 6-5-81  
 Application Disapproved for the following reasons: \_\_\_\_\_  
 date

**BOARD OF HEALTH, AMHERST, MASSACHUSETTS  
CERTIFICATE OF COMPLIANCE**

THIS IS TO CERTIFY, That the individual Sewage Disposal System installed ( ) or repaired ( ) by \_\_\_\_\_ at \_\_\_\_\_ has been constructed in accordance with the provisions of \_\_\_\_\_ INSTALLER Article XI of the State Sanitary Code as described in the application for Disposal Works Construction Permit No. \_\_\_\_\_ dated \_\_\_\_\_ The issuance of this certificate shall not be construed as a guarantee that the system will function satisfactorily.  
 DATE \_\_\_\_\_ Inspector \_\_\_\_\_

**BOARD OF HEALTH, AMHERST, MASSACHUSETTS  
DISPOSAL WORKS CONSTRUCTION PERMIT**

No. 81-8 Permission is hereby granted KARLS [Signature] to construct (  ) or repair ( ) an Individual Sewage Disposal System at Station Rd - lot #3 as shown on the application for Disposal Works Construction Permit No. 81-8

This permit is issued with the understanding that future alterations or additions will be made if necessary. This permit shall not be construed as permission to create or maintain any sewage nuisance and in the issuance of this permit the Board of Health assumes no responsibility for the future operation or maintenance of the system.

DATE 6-5-81 [Signature]  
 Board of Health

10

STATE OF NEW YORK

IN SENATE

JANUARY 15, 1908

REPORT OF THE

COMMISSIONERS OF THE LAND OFFICE

FOR THE YEAR ENDING DECEMBER 31, 1907

ALBANY:

ANDREW DEWEY, GOVERNOR

ANDREW S. BURNETT, COMMISSIONER

ALBANY: J. B. WARD, PRINTERS

1908

THE STATE OF NEW YORK

IN SENATE

JANUARY 15, 1908

REPORT OF THE

COMMISSIONERS OF THE LAND OFFICE

FOR THE YEAR ENDING DECEMBER 31, 1907

ALBANY:

ANDREW DEWEY, GOVERNOR

ANDREW S. BURNETT, COMMISSIONER

ALBANY: J. B. WARD, PRINTERS

1908

THE STATE OF NEW YORK

IN SENATE

JANUARY 15, 1908

# PLAN SHOWING SEWAGE DISPOSAL

For: Ron Hadley  
38 Harlow Av  
Northampton Ma.

81-8

Scale: 1" = 40'

By: Frederick Filios

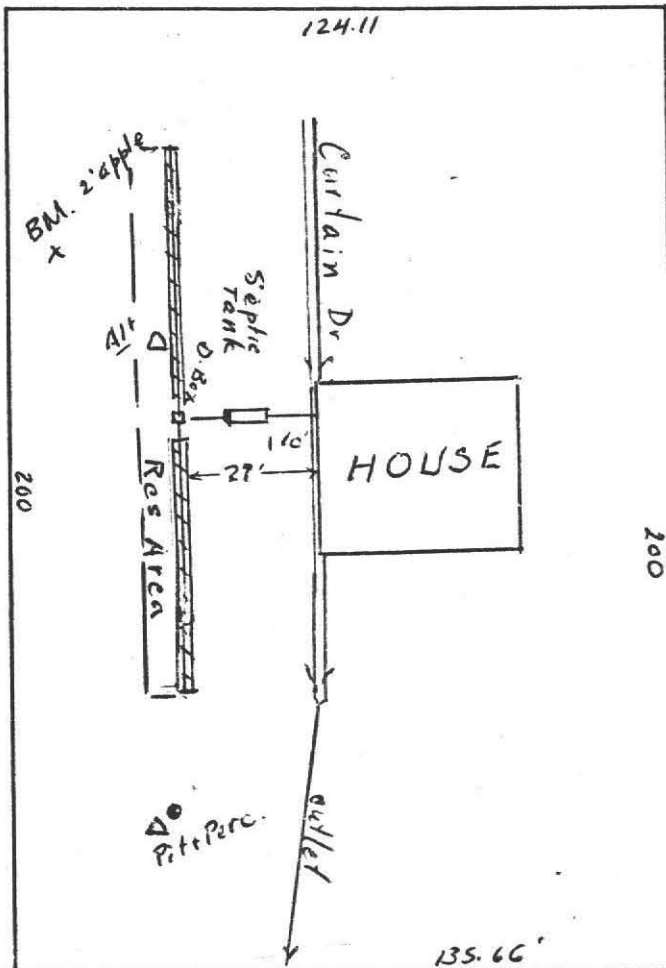
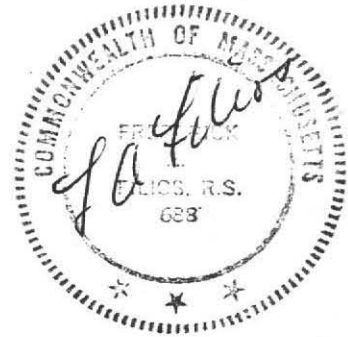

STATION ROAD

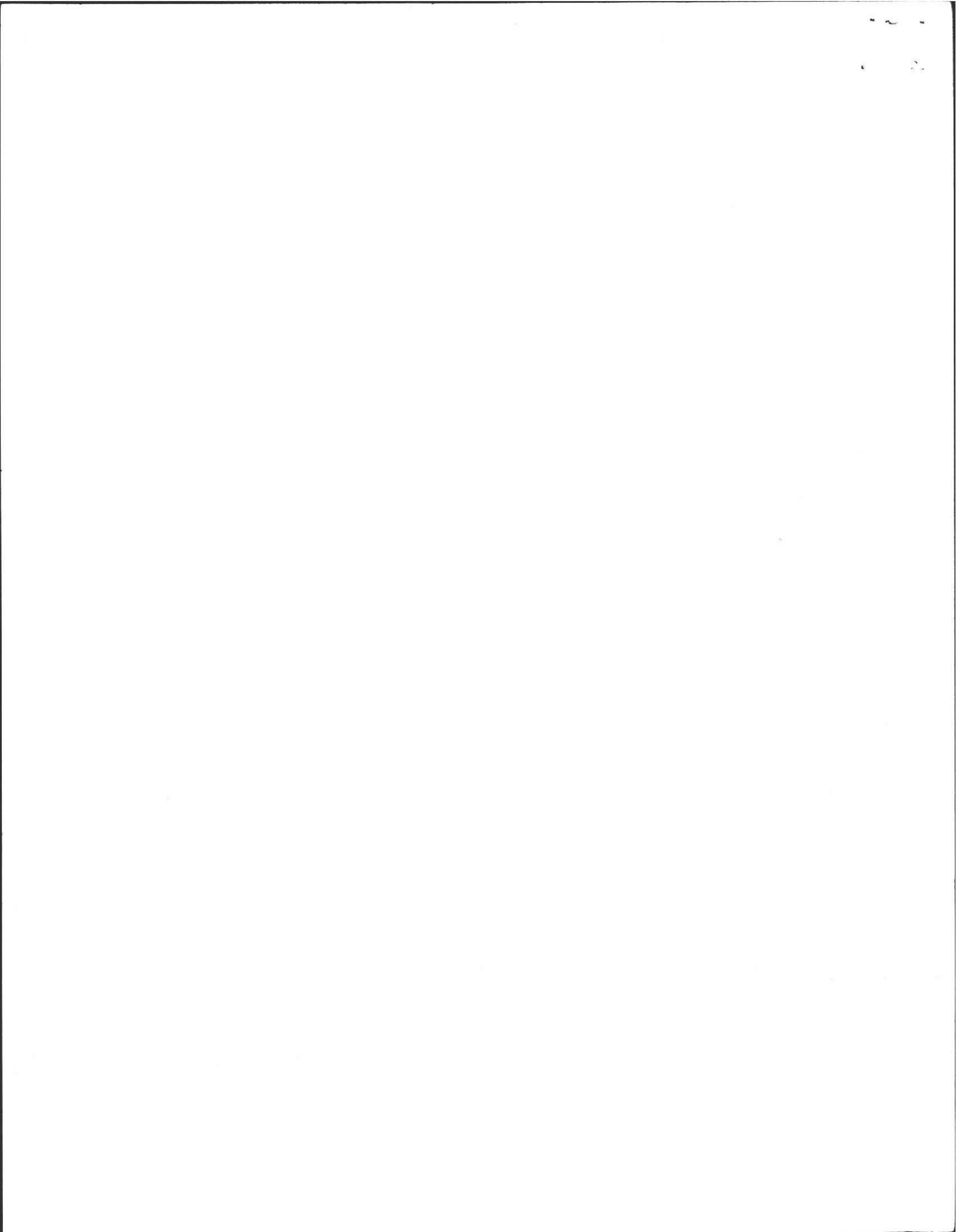



# PROFILE OF SEPTIC SYSTEM

For: Ron Hadley  
 38 Harlow Av.  
 Northampton Mass

Scale: Horizontal, 1" = 10'  
 Vertical, 1" = 3'

By: Frederick Filios

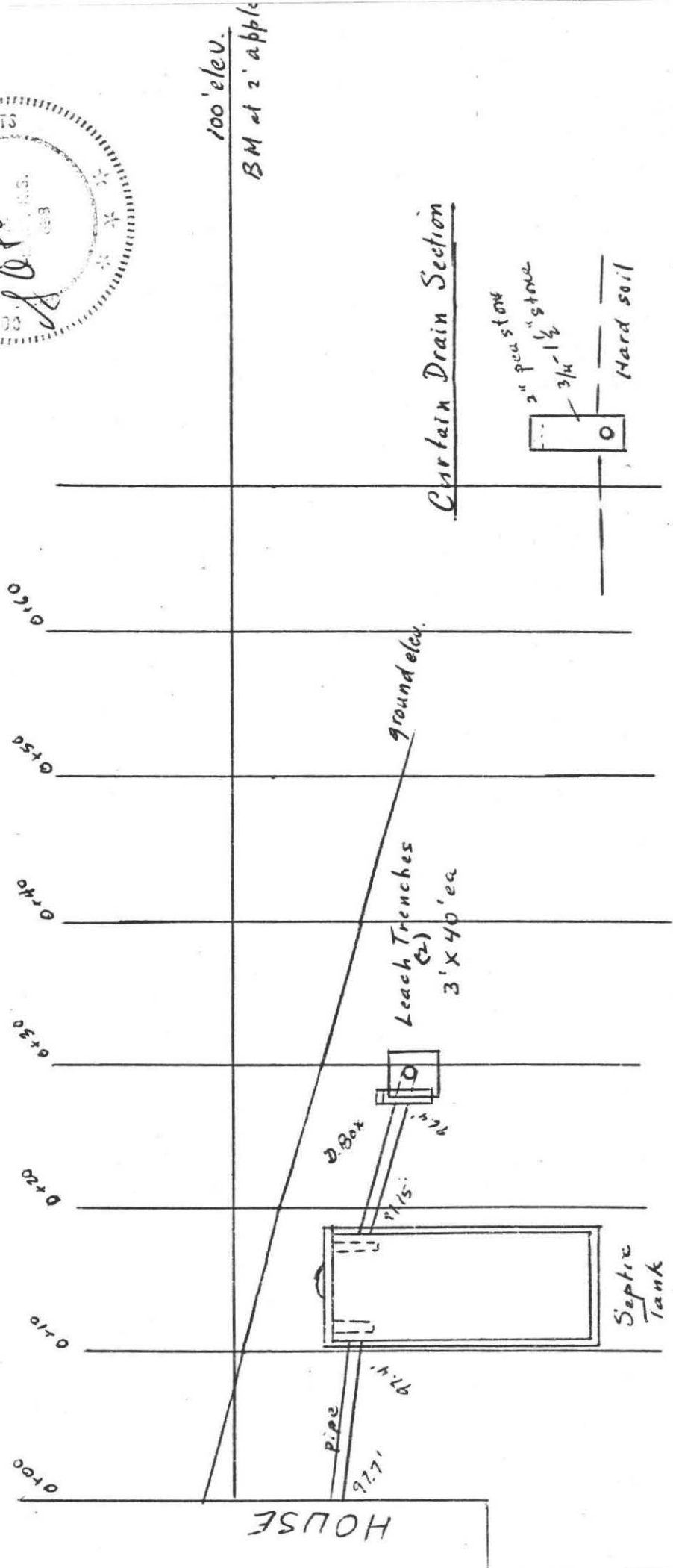
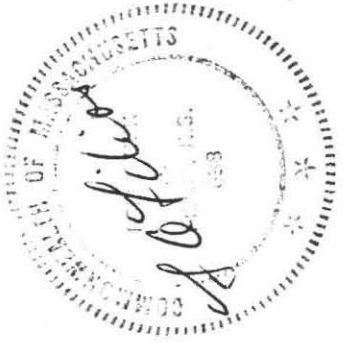



# DEEP SOIL LOGS

OWNER Mr + Mrs Richard Parker

Date Jan 26 1981

LOCATION Station Road

OBSERVER F.A. Filios

Soil

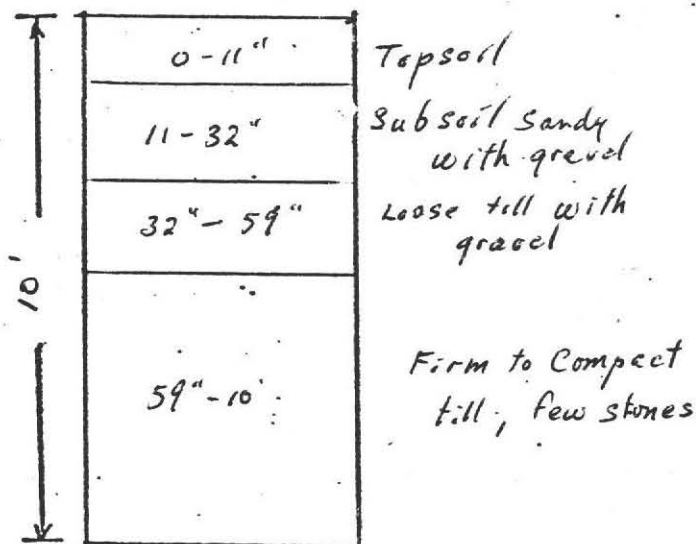

Ground Water 8' 10"  
Alt. Pit

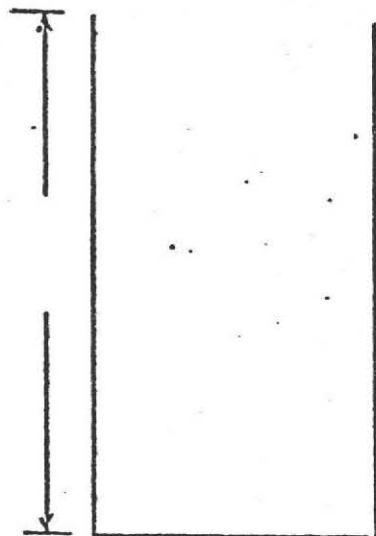

Ground Water

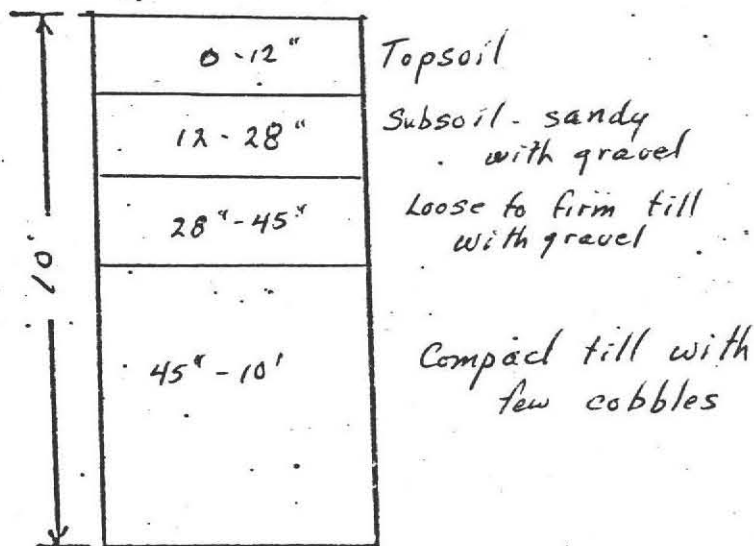

Ground Water none

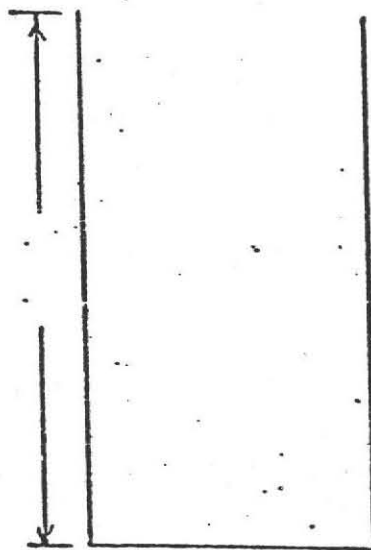

Ground Water

Percolation Rate at 32"

8 ~~in~~ minutes per inch

Certain drain should be provided above leach field to prevent any water seeping over compact soil from entering leach field





57 Station Rd.

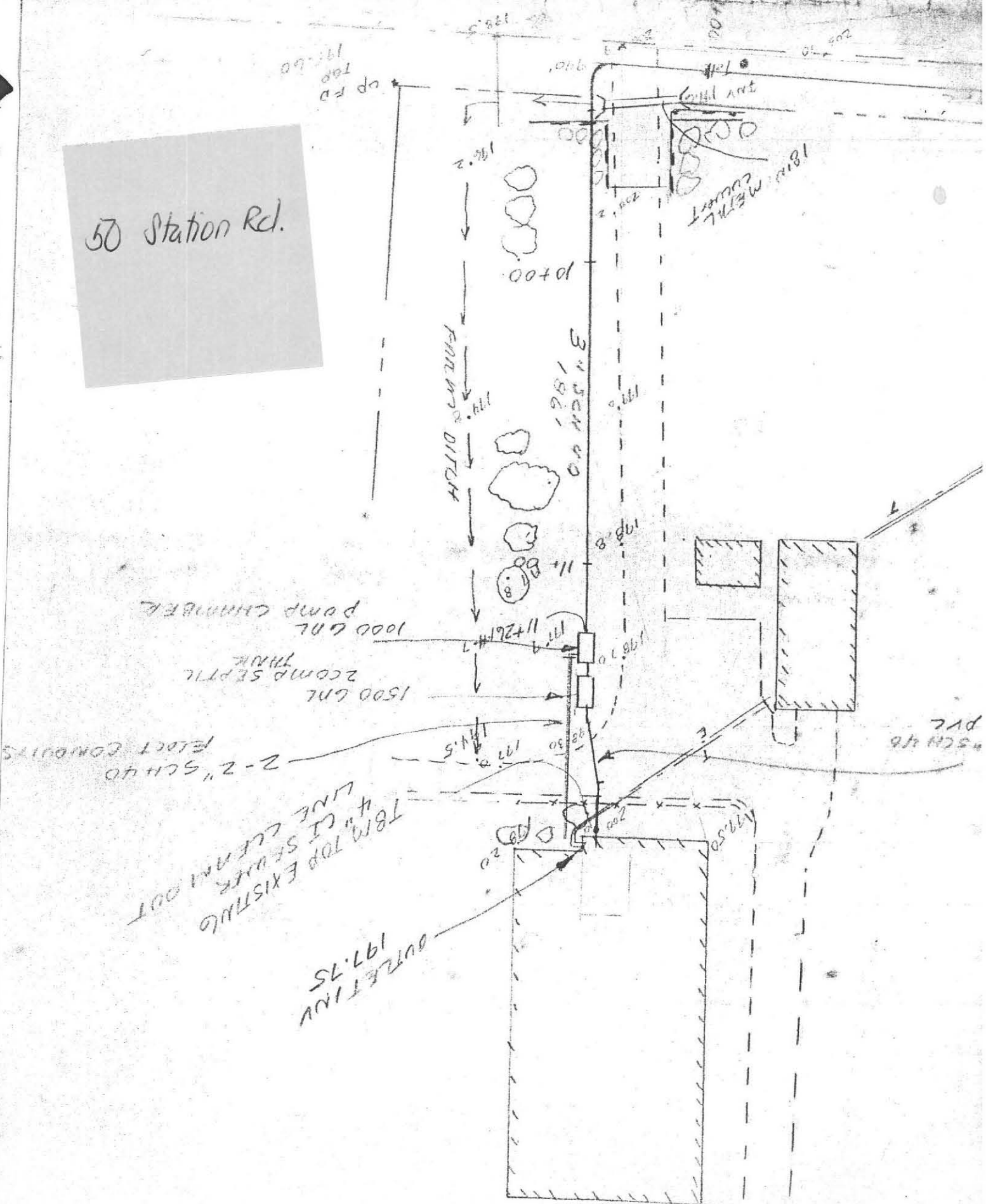

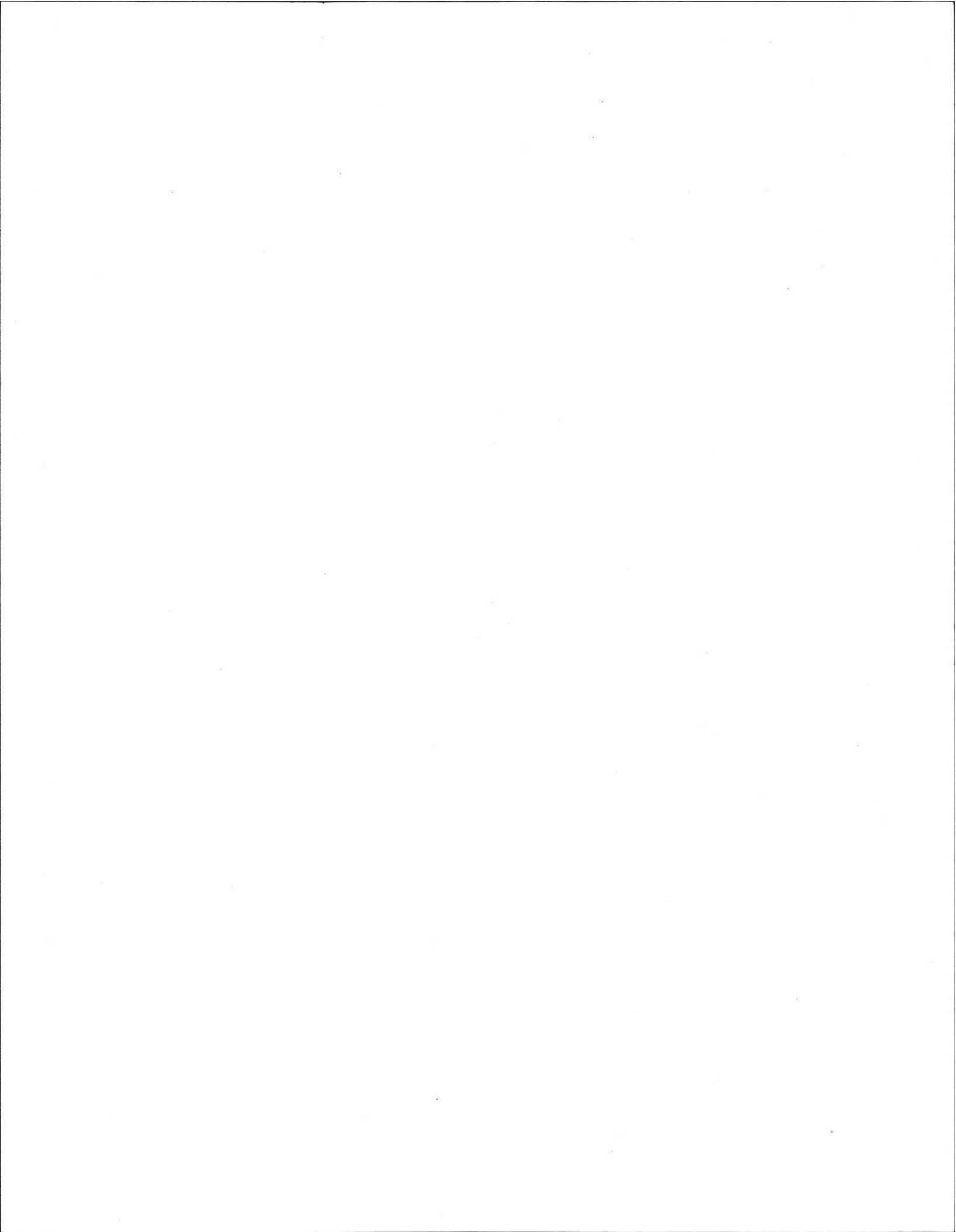

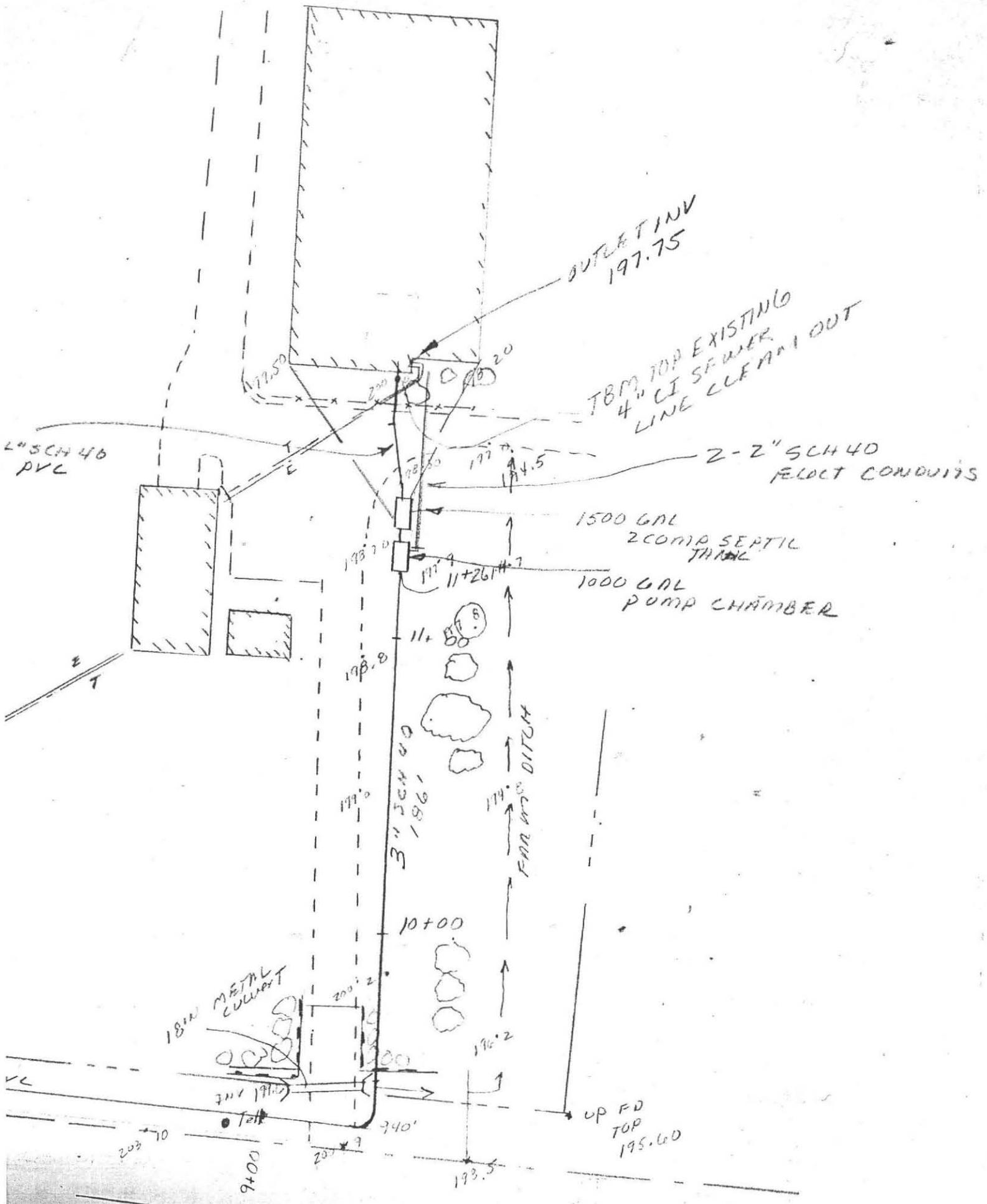

OUTLET INV  
197.75

TBM TOP EXISTING  
4" CI SEWER  
LINE CLEAR OUT

2" SCH 40  
PVC

2-2" SCH 40  
ELECT CONDUITS

1500 GAL  
2 COMP SEPTIC  
TANK

1000 GAL  
PUMP CHAMBER

3" SCH 40  
186.1

FAR END DITCH

18" METAL  
CULVERT

UP FD  
TOP  
195.60

203.70

9+40

203.7

193.5

9+40'

200.2

198.8

198.7

10+00

11+50

11+26.1

174.2

176.2

177.4

178.5

177.5

177.5

177.5

177.5

177.5

177.5

177.5

177.5

177.5

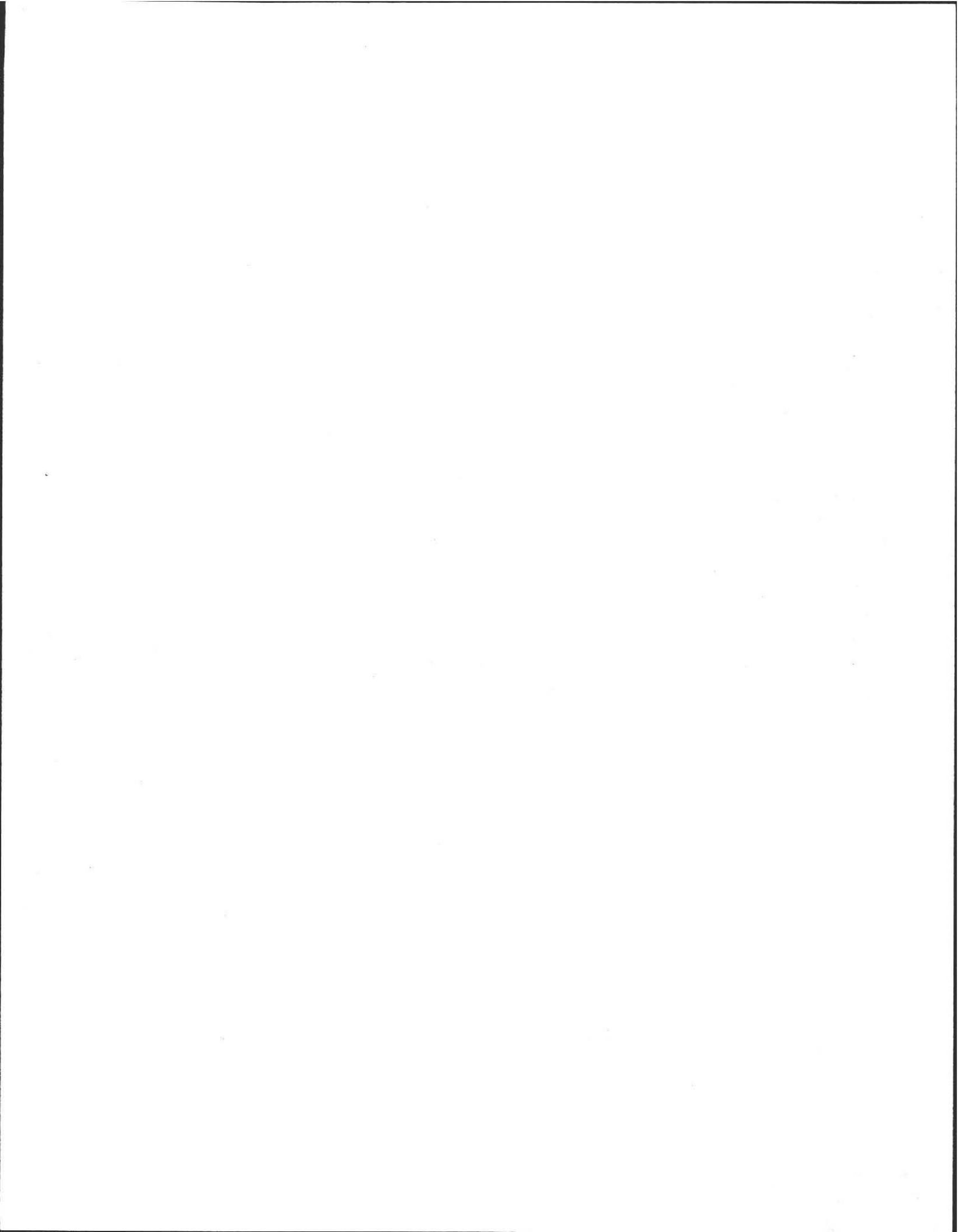



3" SLV  
PVC

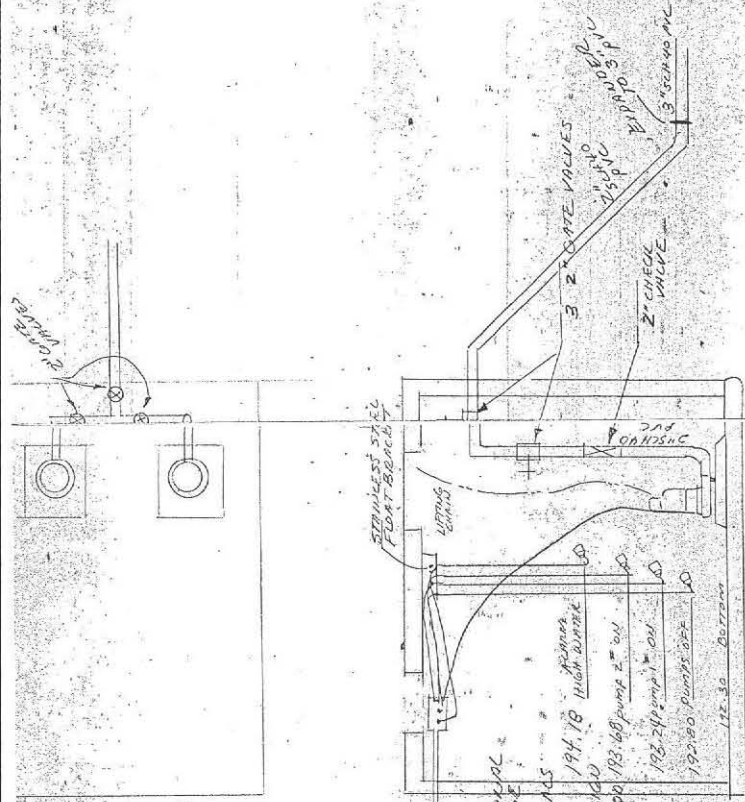

DUMP STATION DETAIL  
SCALE: N.T.S.

MASS STANDARD 8" SEWER MANHOLE FRAME & COVER

GRAND ADJUSTMENT WITH BRICK AND MORTAR

5" MIN

MANHOLE RADIUS 174 PILES

WATER TIGHT JOINT SEALED

SHIELD ELEMENTS SEALED TO INV

BRICK AND MORTAR

1.0 MPH  
FLOW VELOCITY  
1.0 MPH

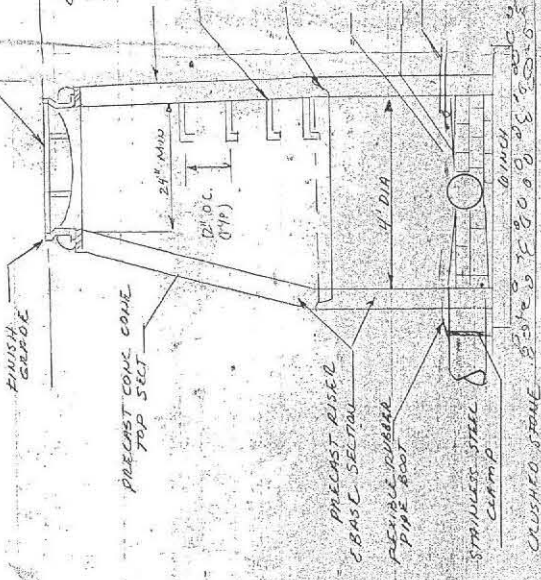

PRECAST CONCRETE SEWER MANHOLE DETAIL  
SCALE: N.T.S.

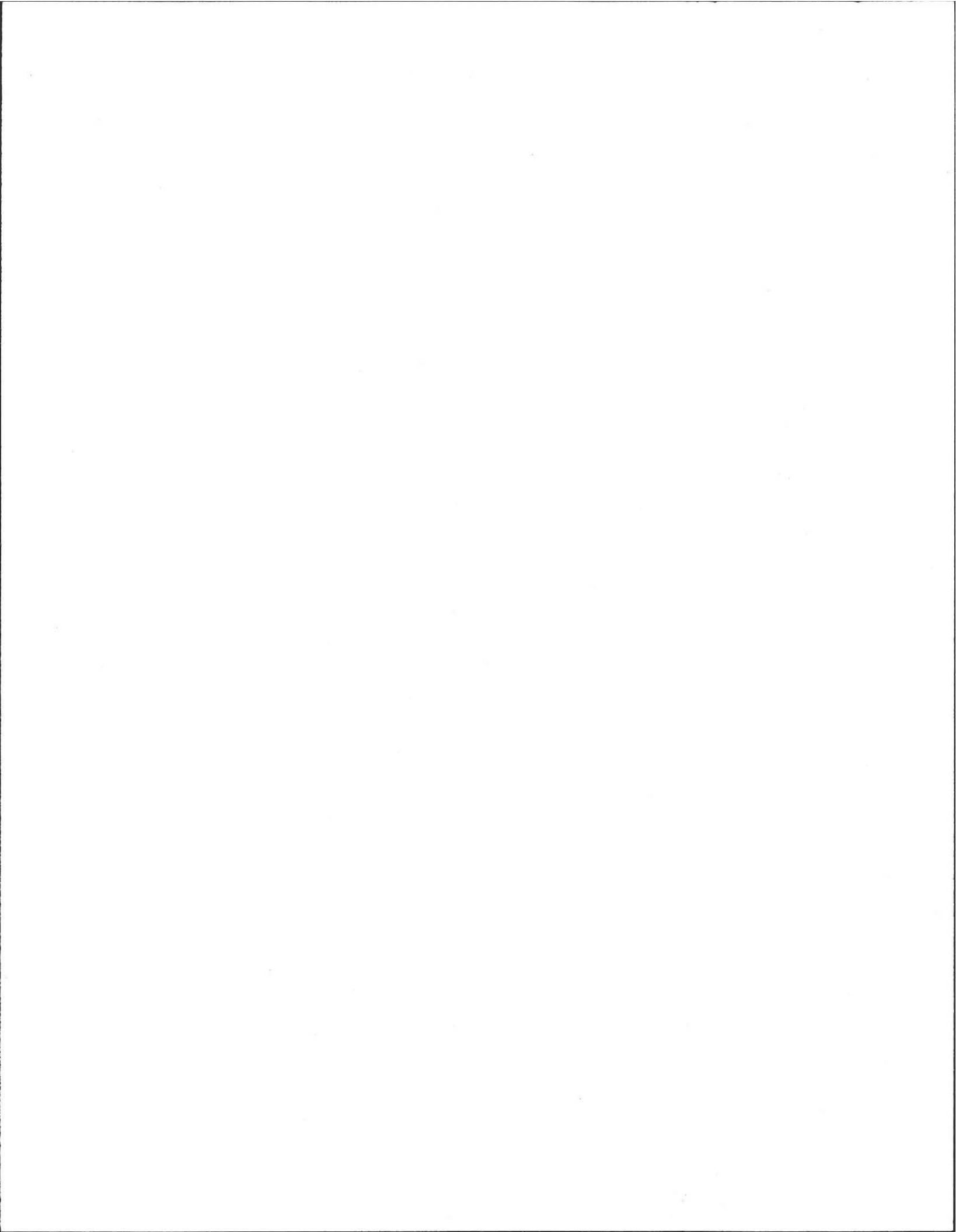

WINS STANDARD 8" SEWER MANHOLE FRAME & COVER

GRAD. ADJUSTMENT WITH BRICK AND MORTAR

5" MIN

MANHOLE RABBER TYP/EMCA

WATER TIGHT JOINT OILED

SHIEL ELEVATION SLOPED TO INU

ROCK AND MORTAR

Flow 192-210 pump 1" out

Flow 192-180 pump 2" out

192-180 PUMP OFF

11E.30 BOTTOM

ADDITIONAL STORAGE CAP

655 GMS

194.18

193.210 pump 1" out

192-180 PUMP OFF

11E.30 BOTTOM

FRAMES & PORTABLE

3 2" GATE VALVES

2 1/2" PVC

2 1/2" PVC

3 1/2" SCH 40 PVC

2" CHECK VALVE

2" SCH 40 PVC

PUMP STATION DETAIL SCALE: N.T.S.

W HOLE DETAIL

LOADING & UNLOADING ALL DISTANCES

FIN CL

COMMON FILL

3" SCH 40 PVC

SELECT SAND FILL

MIN 48" COVER

60" ±

TYPICAL TRENCH DETAIL SCALE: 1/4" = 1'

