

**BOARD OF HEALTH, AMHERST, MASSACHUSETTS**  
**APPLICATION FOR DISPOSAL WORKS CONSTRUCTION PERMIT**

#41

No. 76-7 Date 3/29/76 Fee \$3.00 Date Rec'd. 3/29/76 By DGF

Application is hereby made for a permit to Construct (X) or Repair ( ) an Individual Sewage Disposal System at:

Location—Address Stage Coach Road or Lot No. 230

Owner Larry Miller Address 4 works

Contractor " " Address " "

Type of Building Wood frame Dimensions 24 x 30 Size Lot 0.90 ac.

Dwelling—No. of Bedrooms 3 Expansion Attic ( ) Garbage Grinder ( )

Other \_\_\_\_\_ No. of persons \_\_\_\_\_ Showers ( )

Other fixtures \_\_\_\_\_

Town Water? yes Type of Well \_\_\_\_\_

Design Flow \_\_\_\_\_ gallons per person per day. Total daily flow \_\_\_\_\_ gallons

Septic Tank—Liquid capacity 1500 gallons Dimensions: L 8 W 5 D 5

Disposal Trench—No. \_\_\_\_\_ Width \_\_\_\_\_ Total Length \_\_\_\_\_ Total leaching area \_\_\_\_\_

Disposal Bed—No. \_\_\_\_\_ Diameter \_\_\_\_\_ Depth below inlet \_\_\_\_\_ Total leaching area \_\_\_\_\_

Dry Well—No. \_\_\_\_\_ Diameter \_\_\_\_\_ Depth below inlet \_\_\_\_\_ Dimensions: \_\_\_\_\_ x \_\_\_\_\_

Other: Distribution box ( ) No. \_\_\_\_\_ Dosing tank ( )

(Depth of Soil Line Below finished grade at foundation \_\_\_\_\_)

Percolation Test Results Performed by J. Hart - Huntley Engineer Date 4/4/73

Test Pit No. 1 6.3 minutes per inch Depth of Test Pit 2'6"

Test Pit No. 2 \_\_\_\_\_ minutes per inch Depth of Test Pit 9'0"

Description of Soil see left Depth to Ground Water None

Will disposal area be filled? \_\_\_\_\_ Cut down? \_\_\_\_\_

(On reverse side or separate sheet, show plot plan with building. Include dimensions, distances from all boundaries. Show location of wells, streams, ledge, large trees, etc.)

AGREEMENT: The undersigned agrees to construct the aforescribed individual sewage disposal system in accordance with the provisions of Article XI of the Sanitary Code and regulations of the Amherst Board of Health. The undersigned further agrees not to place the system in operation until a Certificate of Compliance has been issued by this board of health.

Application Approved by [Signature] N. James Miller 3/29/76  
 Owner or builder date  
3-29-76  
 date

Application Disapproved for the following reasons:

**BOARD OF HEALTH, AMHERST, MASSACHUSETTS**  
**CERTIFICATE OF COMPLIANCE**

THIS IS TO CERTIFY, That the individual Sewage Disposal System installed ( ) or repaired ( ) by \_\_\_\_\_ at \_\_\_\_\_ has been constructed in accordance with the provisions of

INSTALLER  
 Article XI of the State Sanitary Code as described in the application for Disposal Works Construction Permit No. \_\_\_\_\_ dated \_\_\_\_\_

The issuance of this certificate shall not be construed as a guarantee that the system will function satisfactorily.

DATE \_\_\_\_\_ Inspector \_\_\_\_\_

**BOARD OF HEALTH, AMHERST, MASSACHUSETTS**  
**DISPOSAL WORKS CONSTRUCTION PERMIT**

No. 76-7  
 Permission is hereby granted N. L. Miller to construct (X) or repair ( ) an Individual Sewage Disposal System at Lot # 230, Stage Coach Rd as shown on the application for Disposal Works Construction Permit No. 76-7

This permit is issued with the understanding that future alterations or additions will be made if necessary. This permit shall not be construed as permission to create or maintain any sewage nuisance and in the issuance of this permit the Board of Health assumes no responsibility for the future operation or maintenance of the system.

DATE 3-29-76 [Signature]  
 Board of Health

4" OTS, 1'8" silt and gravel, 4'0" clay, 3'0" sand and gravel.

Note: This certification is to test results only. See attached sheets for design.

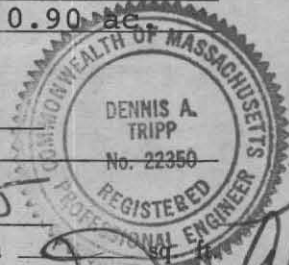

[Signature]



see left  
J. Hart - Pontiac Engineer

W. A. Miller

W. A. Miller

See Engr. 102350  
W. A. Miller

THE GRADES SHOWN HEREON ARE AS EXISTING IN THE FIELD PRIOR TO CONSTRUCTION. THERE IS NO GRADE REGULATION OR BYLAW IN THE TOWN OF AMHERST.

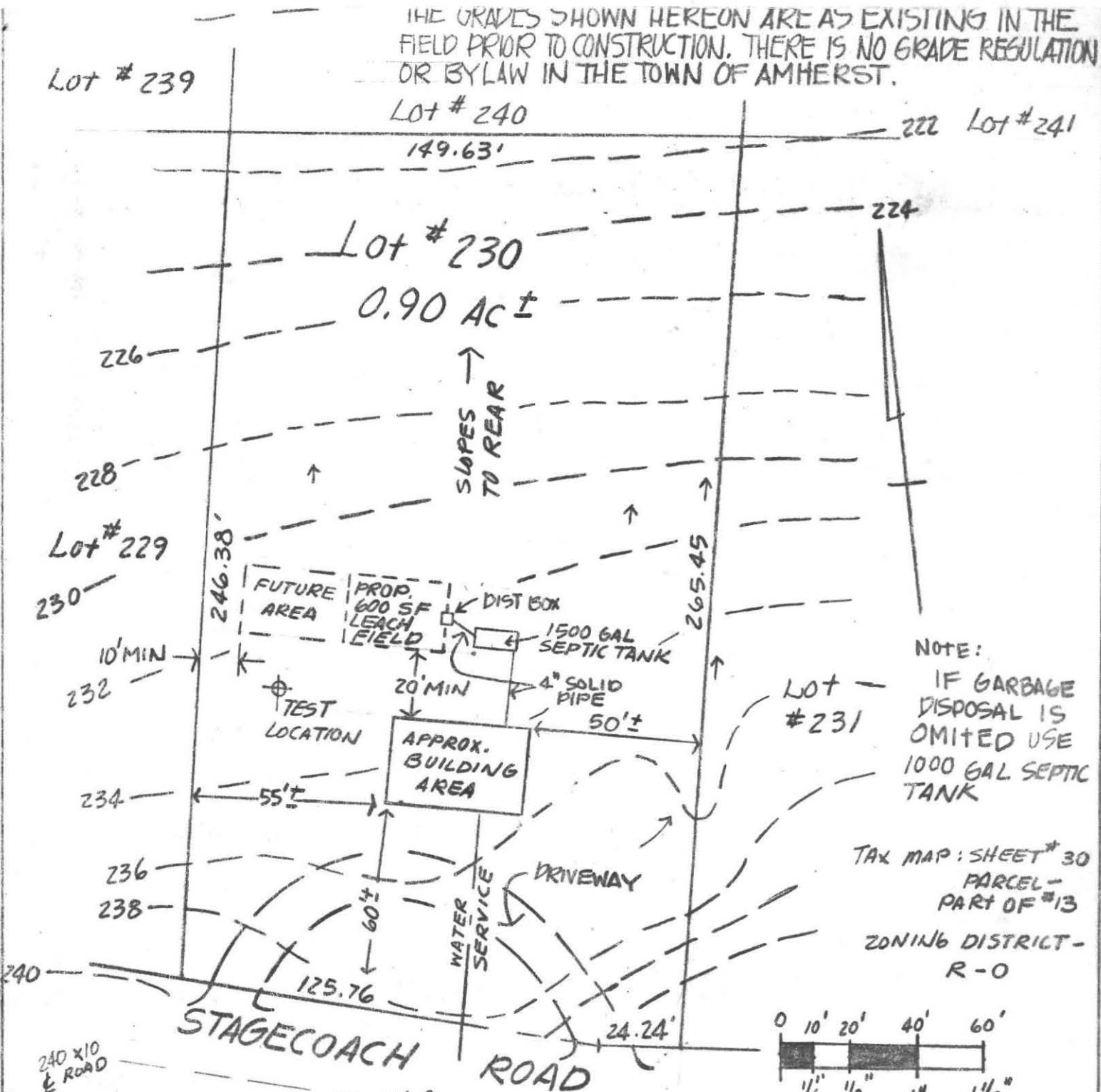

NOTE:  
IF GARBAGE DISPOSAL IS OMITTED USE 1000 GAL SEPTIC TANK

TAX MAP: SHEET # 30  
PARCEL - PART OF #13  
ZONING DISTRICT - R-0

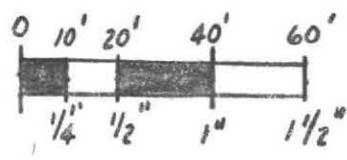

PLAN OF SEWAGE DISPOSAL SYSTEM FOR LOT #230, STAGECOACH ROAD, AMHERST, MASS.

PREPARED FOR N. LARRY MILLER

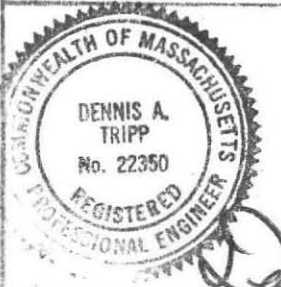

ALMER HUNTLEY, JR. & ASSOCIATES, INC.  
REGISTERED LAND SURVEYORS & CIVIL ENGINEERS  
125 PLEASANT STREET  
NORTHAMPTON, MASS.

DRAWN: RPB

SCALE: 1" = 40'

DATE: 3/26/76

NOTE:  
ALL WORK TO BE DONE IN ACCORDANCE WITH STATE SANITARY CODE ART. XI

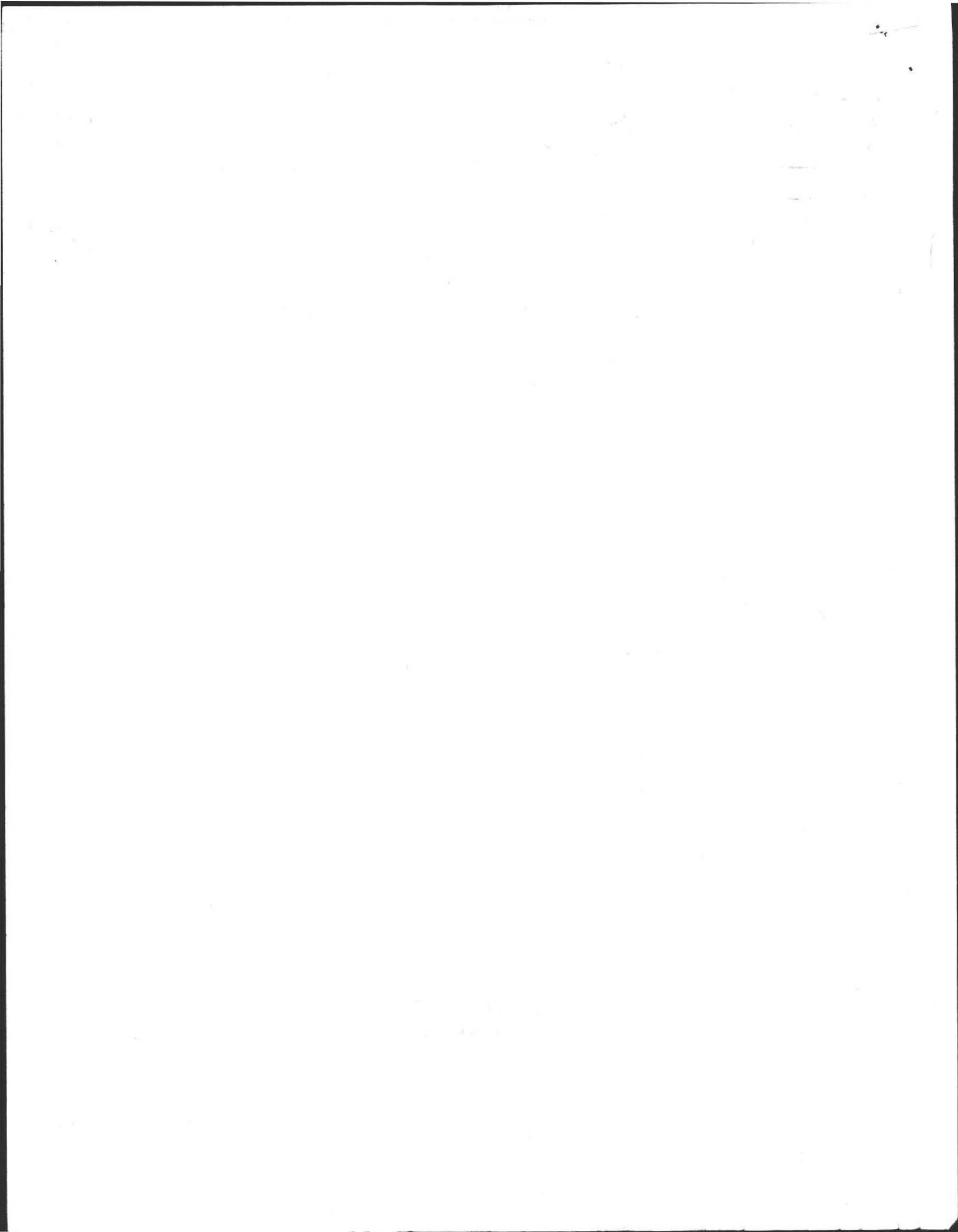

ALMER HUNTLEY, JR., & ASSOCIATES, INC.  
SURVEYORS - ENGINEERS - PLANNERS

P.O. Box 568  
125 PLEASANT STREET  
NORTHAMPTON, MASS. 01060  
(413) 584-7444

March 26, 1976  
(Date)

Larry Miller  
\_\_\_\_\_  
\_\_\_\_\_  
\_\_\_\_\_

On 4/4/73 we completed percolation tests and observation pits for a proposed Individual Sewage Disposal System to be located at Lot 230, Stage Coach Rd., Amherst.

RESULTS AND RECOMMENDATIONS

- See attached sheets for results of tests
- Soil should be suitable if system is properly installed
- 1500 gallon septic tank for a daily flow of 300 gallons
- 600 square feet of leach area for a daily flow of 300 gallons
- More percolation tests should be taken
- More observation pits should be dug
- Soils are not suitable for a leaching area
- Contact your local Board of Health for additional information
- Application attached
- Plot Plan attached
- System detail sheets attached

Remarks:

Very truly yours,  
ALMER HUNTLEY, JR. & ASSOCIATES, INC.

  
\_\_\_\_\_  
Richard P. Brazeau

THE ABOVE RECOMMENDATIONS DO NOT CONSTITUTE APPROVAL OR DISAPPROVAL OF SEWAGE DISPOSAL SYSTEM

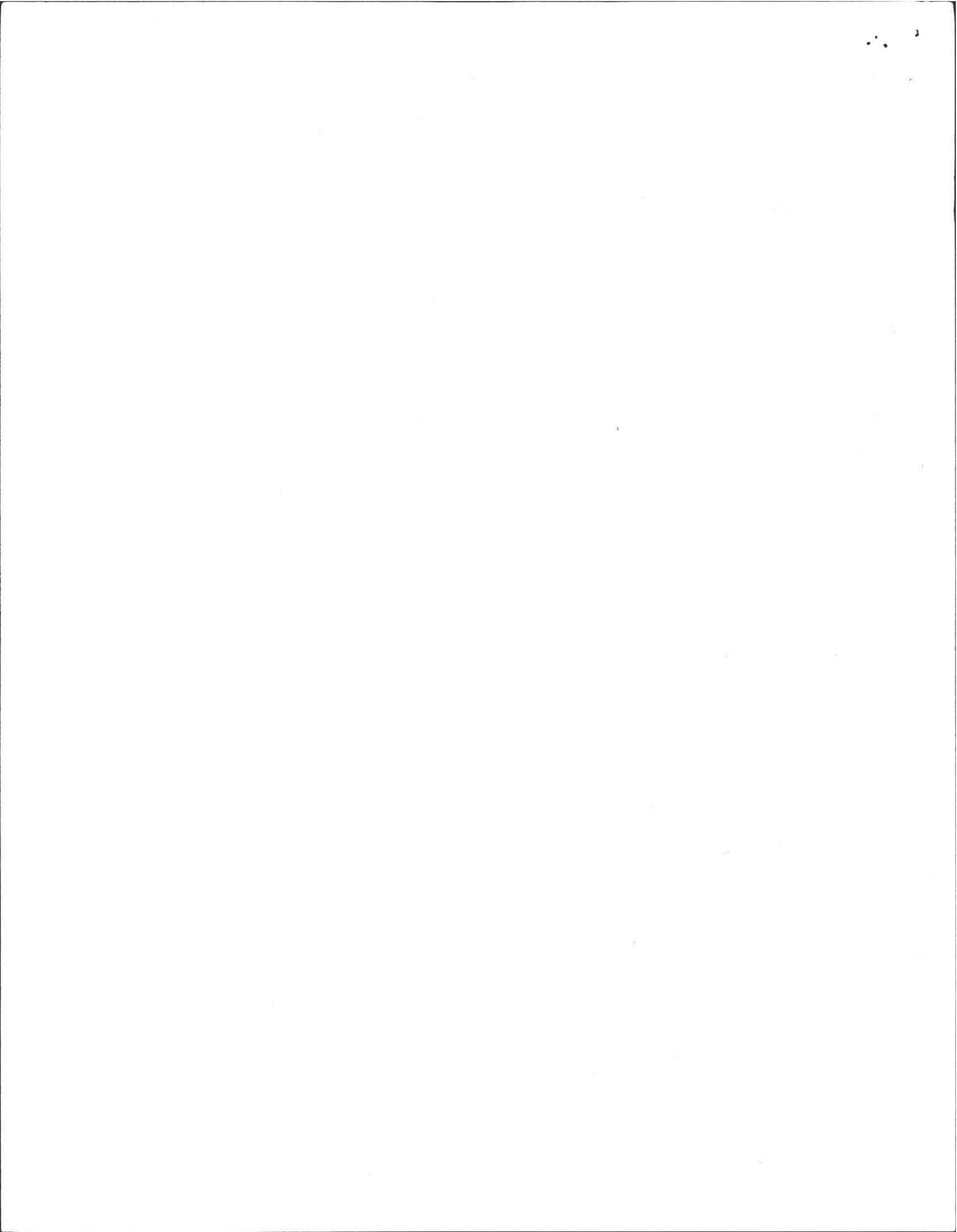

PROPOSED DOMESTIC SUB-SURFACE DISPOSAL SYSTEM DESIGN

Prepared for: Larry Miller

Location: Lot 230 Stage Coach Rd., Amherst, MA

Number of Bedrooms: 3 Garbage Disposal: yes

LEACH AREA DESIGN

3 Bedrooms X 2 persons/bedroom = 6 persons

6 Persons X 50 gallons of waste water/person per day =

300 total gallons waste water per day

Percolation Rate: 6.3 min./in.

Square feet of leach area required/gallon of waste water for a

Percolation Rate of 6.3 min./in. = 1.0 S.F./gallon

\* If a leach bed is to be installed, one S.F./gallon is the minimum area that can be used for a Perc. rate of 10 min./in. or less.

300 Total gallons of waste water per day X 1.0 S.F./gallon

= 300 S.F. of leach area (required)

\* If a garbage disposal is installed, leach area will be increased by 25%

300 S.F. of leach area X 125% = 375 S.F. of leach area

RECOMMENDED LEACH AREA: 600

\*\* Minimum area for leaching trench or seepage pit is 0.5 square feet per gallon for a perc. rate of 2.0 min./in. or less.

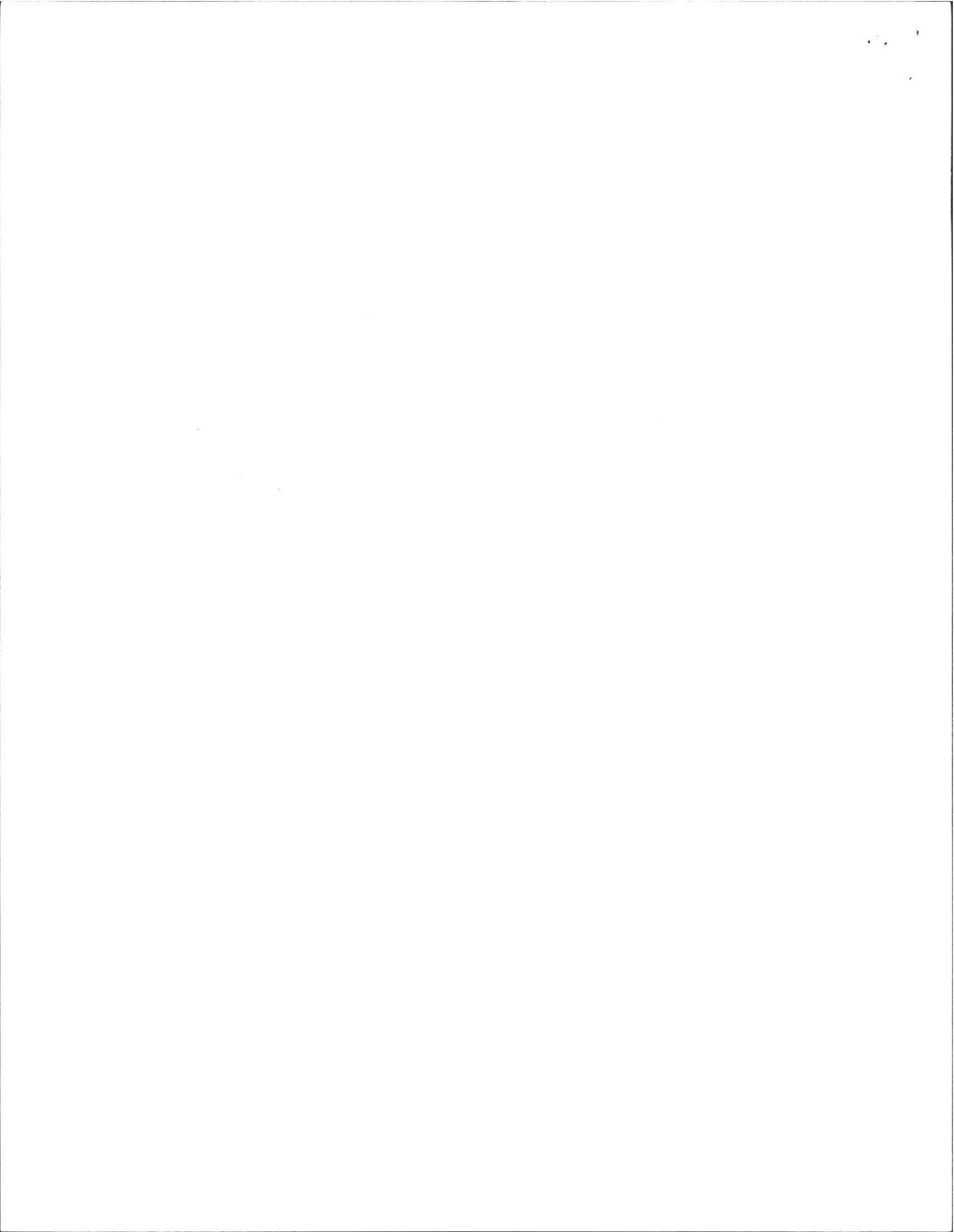



TYPE OF SYSTEM

LEACH  
BED

Recommended Leach Area 600 S.F.

L = 30

W = 20

- \* The minimum lines per field is 2
- \*\* The maximum length per line is 100'  
(75' when daily flow is greater than 2000 gal.)

LEACH  
TRENCH

Recommended Leach Area \_\_\_\_\_ S.F.

$\div$  3' wide = \_\_\_\_\_ feet of trench

\_\_\_\_\_ trench lines, \_\_\_\_\_ feet long

- \* The minimum lines per field is 2
- \*\* The maximum length per line is 100'  
(75' when daily flow is greater than 2000 gal.)

LEACH  
PIT

Recommended Leach Area \_\_\_\_\_ S.F.

Check attached sheets for type of Pit and amount of stone

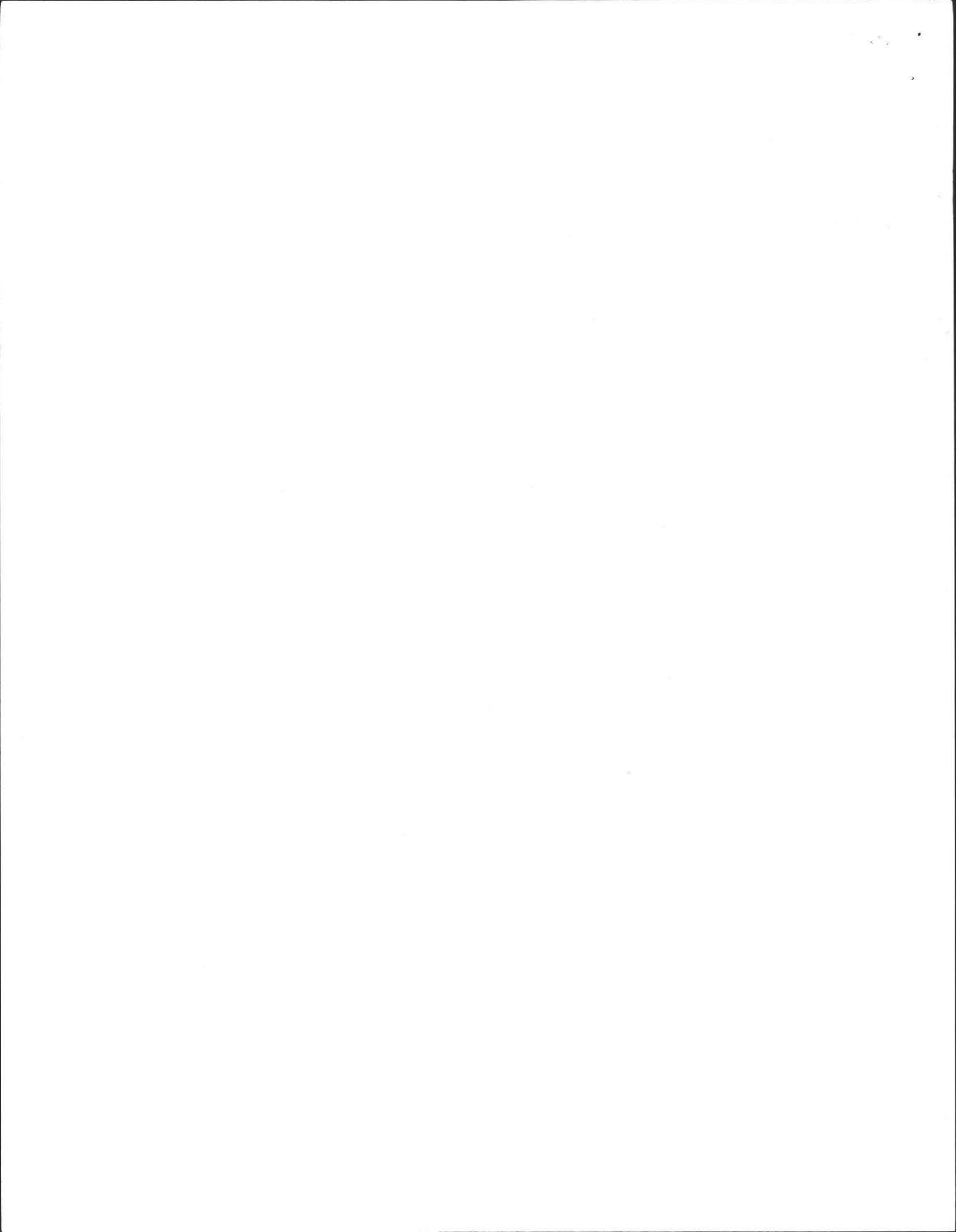

SEPTIC TANK

-----  
\* without Garbage Disposal

\_\_\_\_\_ Gallons of waste water per day X 150% =

\_\_\_\_\_ Required effective liquid capacity of septic tank

RECOMMENDED: \_\_\_\_\_ Septic Tank

\* In no case will the septic tank be less than 750 gallons  
(effective liquid capacity).

-----  
\*\* with Garbage Disposal

300 Gallons of waste water per day X 200% =

600 Required effective liquid capacity of septic tank

RECOMMENDED: 1500 Septic Tank

\*\* In no case will the septic tank be less than 1500 gallons  
(effective liquid capacity).

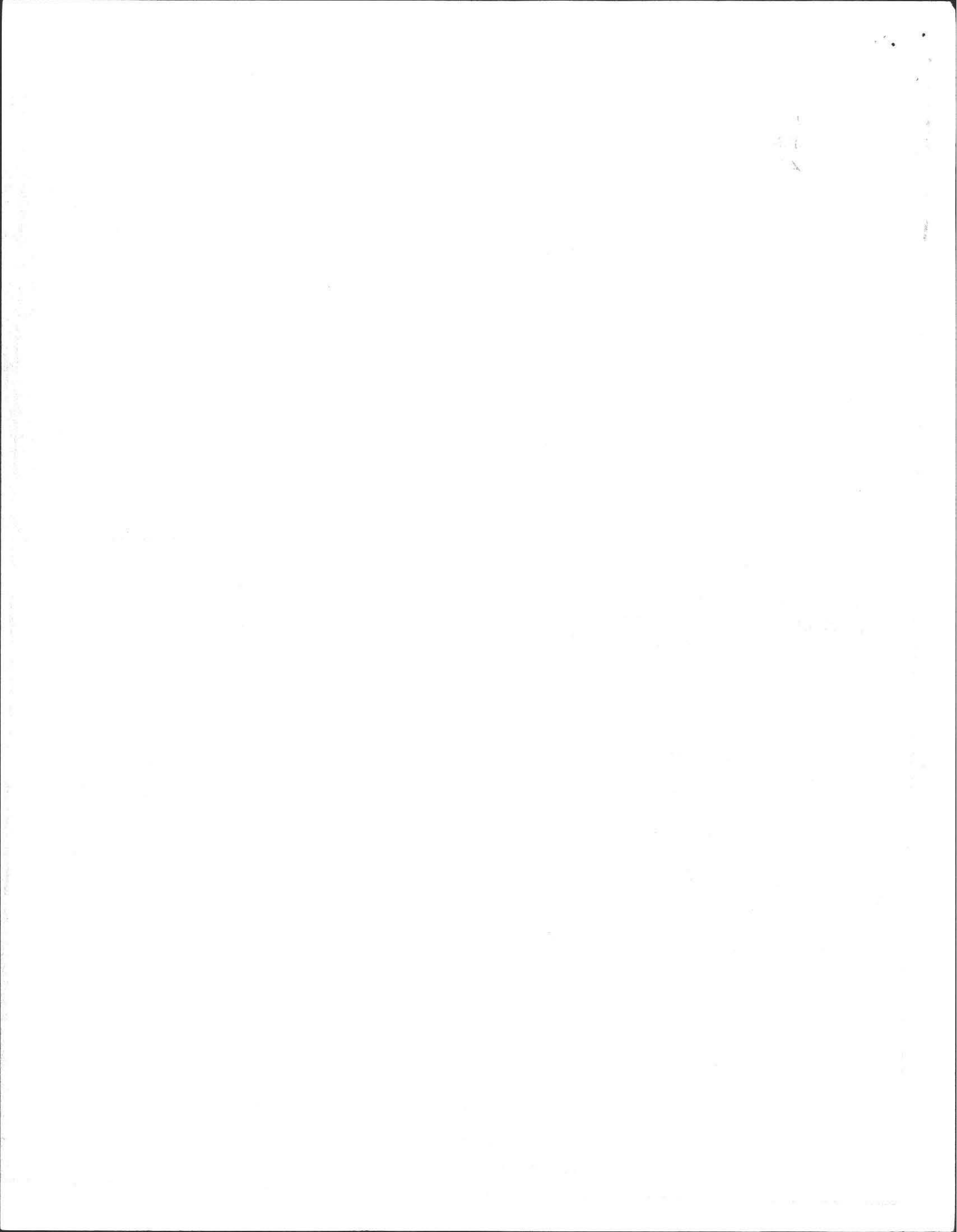



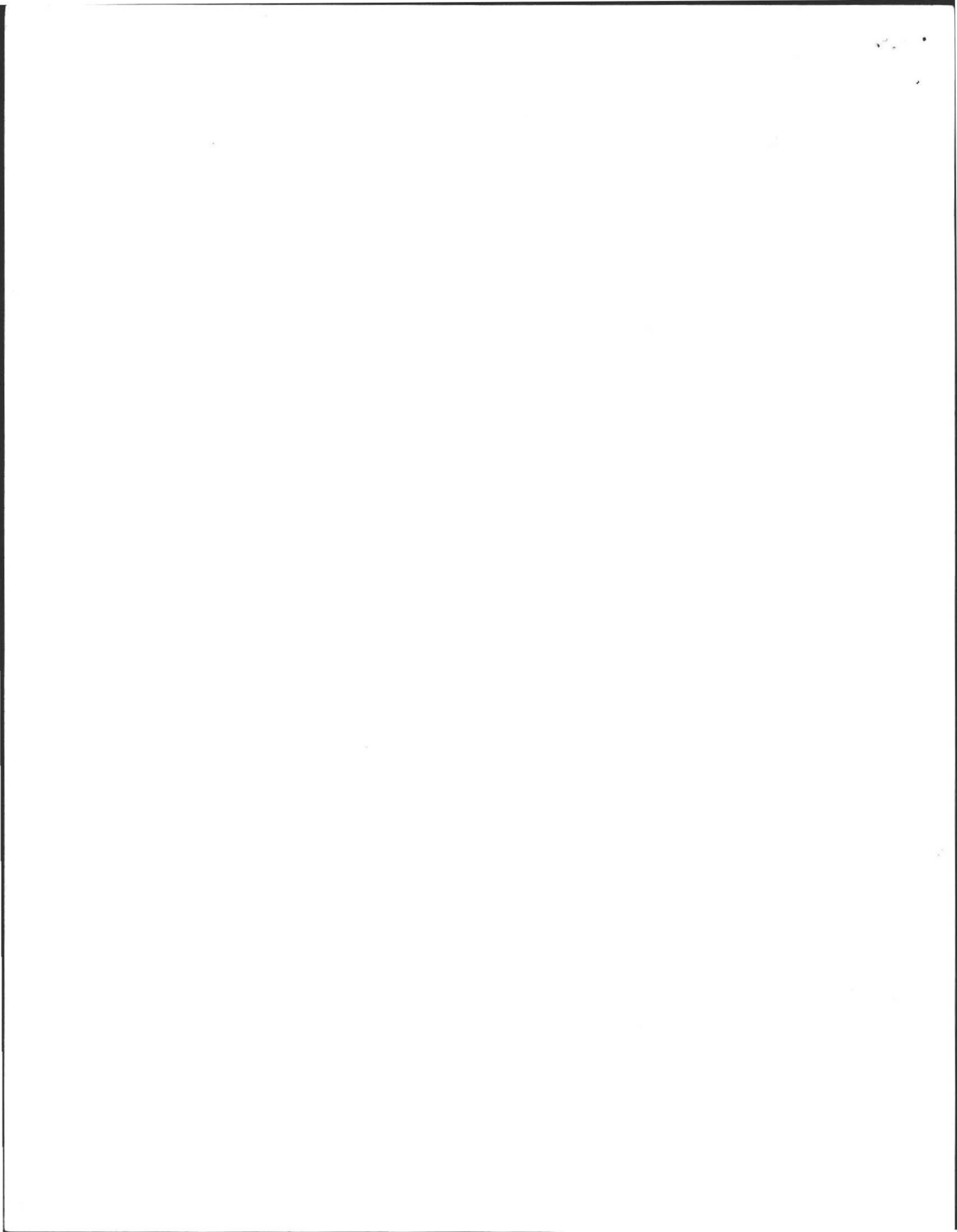

REQUESTED BY: Al Rainford

LOCATION: Stage Coach Rd.  
Amherst, MA

MAILING ADDRESS: \_\_\_\_\_

DATE: 4/4/73 OBSERVER: J. Hart & D. Lawler

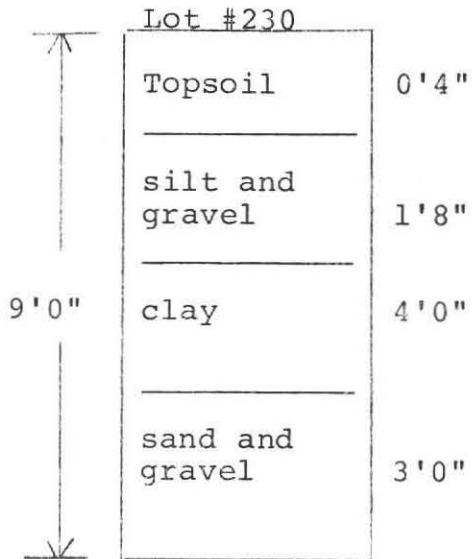

Groundwater none

Perc Rate 6.3 min/in

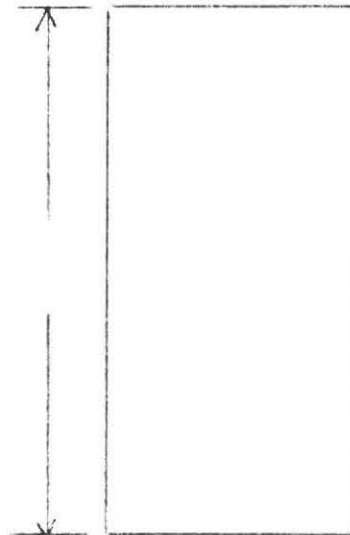

Groundwater \_\_\_\_\_

Perc Rate \_\_\_\_\_

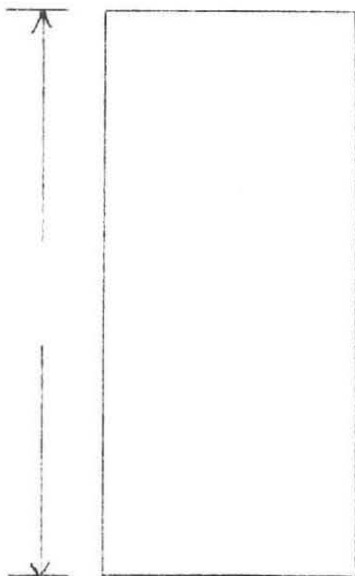

Groundwater \_\_\_\_\_

Perc Rate \_\_\_\_\_

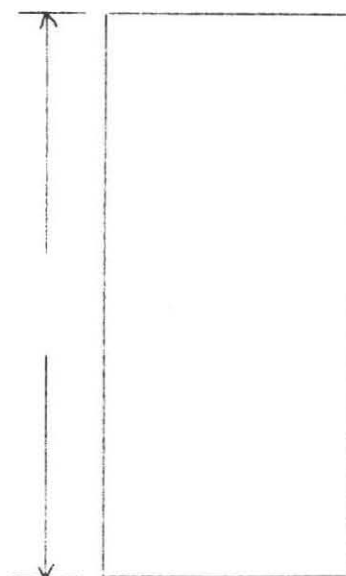

Groundwater \_\_\_\_\_

Perc Rate \_\_\_\_\_

\* Overnight Test

