

8/4/95

" Ratner "

Variance

- Perc Rates

- impermeable
barrier

16 Stage Coach 100%
of Amherst
Reg
Rd

Fred Filios is
looking for Plans
for Repair

Have been approved by State

TOWN OF AMHERST

CASES ISSUED

DM: 07/01/95 TO: 07/31/95

Parcel #	Date Received	Date Issued	a t	Cost	Fee
5C000017	07/10/95	07/10/95	I	\$0.00	\$15.00
ge thermostats Apt. 35 A13361					
C000017	07/10/95	07/10/95	I	\$0.00	\$15.00
e thermostats Apt. 36 A13361					
000017	07/10/95	07/10/95	I	\$0.00	\$15.00
thermostats Apt. 37 A13361					
00017	07/10/95	07/10/95	I	\$0.00	\$15.00

JUL - 8 1994

Filos Enterprises, Inc.

69 Pelham Rd., Amherst, MA 01002 - (413) 256-8008 / FAX (413) 253-7475

June 30, 1994

Board of Health
Town of Amherst
Bangs Community Center
Boltwood Walk
Amherst, MA 01002

Dear Board Members:

On February 16, 1994 you approved variances to the Town of Amherst Board of Health regulations for the property located at 16 Stagecoach Road and you recommended that the Department of Environmental Protection (DEP) approve requested variances to Title 5 of the state sanitary code. The DEP on April 26, 1994 denied the request for variance pending receipt of two items: a completed Wetland's Determination of Applicability form, and a change in the calculations showing that no bottom area be used in determining the system size.

The Amherst Conservation Commission issued the completed Determination of Applicability with a negative determination (no state protected wetlands are present) on June 23, 1994; it is enclosed.

The plans have been revised to show no bottom area is used in calculating the size of the system; the revised plans are enclosed.

These changes must be reviewed and approved by you prior to being resubmitted to DEP.

Sincerely,



Frederick A. Filios, R.S.
President

THE UNIVERSITY OF CHICAGO

DEPARTMENT OF THE HISTORY OF ARTS AND ARCHITECTURE

1954-1955

THE UNIVERSITY OF CHICAGO
DEPARTMENT OF THE HISTORY OF ARTS AND ARCHITECTURE
1954-1955
THE UNIVERSITY OF CHICAGO
DEPARTMENT OF THE HISTORY OF ARTS AND ARCHITECTURE
1954-1955

THE UNIVERSITY OF CHICAGO
DEPARTMENT OF THE HISTORY OF ARTS AND ARCHITECTURE
1954-1955
THE UNIVERSITY OF CHICAGO
DEPARTMENT OF THE HISTORY OF ARTS AND ARCHITECTURE
1954-1955

THE UNIVERSITY OF CHICAGO
DEPARTMENT OF THE HISTORY OF ARTS AND ARCHITECTURE
1954-1955

THE UNIVERSITY OF CHICAGO
DEPARTMENT OF THE HISTORY OF ARTS AND ARCHITECTURE
1954-1955

THE UNIVERSITY OF CHICAGO
DEPARTMENT OF THE HISTORY OF ARTS AND ARCHITECTURE
1954-1955

JUL - 8 1994

Rattner

310 CMR 10.99

Form 2

Commonwealth
of Massachusetts

Town File # 94-410

DEP File No.

N/A

(To be provided by DEP)

City/Town AMHERST

Applicant Janice Rattner

Date Request Filed May 2, 1994

Date Issued 6-22-94

Determination of Applicability
Massachusetts Wetlands Protection Act, G.L. c. 131, §40
 and the Town of Amherst Wetland Protection Bylaw

From Amherst Conservation Commission Issuing Authority

To Janice Rattner same
 (Name of person making request) (Name of property owner)

Address 16 Stagecoach Road Address

This determination is issued and delivered as follows:

- ☐ by hand delivery to person making request on _____ (date)
☒ by certified mail, return receipt requested on 6-23-94 (date)

Pursuant to the authority of G.L. c. 131, §40, the Conservation Commission
 has considered your request for a Determination of Applicability and its supporting documentation, and has
 made the following determination (check whichever is applicable):

Location: MAP _____ PARCEL _____ LOT(subdivision) _____
 Street Address: 16 Stagecoach Rd.

1. ☐ The area described below, which includes all/part of the area described in your request, is an Area Subject to Protection Under the Act. Therefore, any removing, filling, dredging or altering of that area requires the filing of a Notice of Intent.

2. ☐ The work described below, which includes all/part of the work described in your request, is within an Area Subject to Protection Under the Act and will remove, fill, dredge or alter that area. Therefore, said work requires the filing of a Notice of Intent.

3. ☐ The work described below, which includes all/part of the work described in your request, is within the Buffer Zone as defined in the regulations, and will alter an Area Subject to Protection Under the Act. Therefore, said work requires the filing of a Notice of Intent.

This Determination is negative:

1. ☒ The area described in your request is not an Area Subject to Protection Under the Act.
2. ☐ The work described in your request is within an Area Subject to Protection Under the Act, but will not remove, fill, dredge, or alter that area. Therefore, said work does not require the filing of a Notice of Intent.
3. ☐ The work described in your request is within the Buffer Zone, as defined in the regulations, but will not alter an Area Subject to Protection Under the Act. Therefore, said work does not require the filing of a Notice of Intent.
4. ☐ The area described in your request is Subject to Protection Under the Act, but since the work described therein meets the requirements for the following exemption, as specified in the Act and the regulations, no Notice of Intent is required: _____

Issued by Amherst Conservation Commission Conservation Commission

Signature(s) _____
[Signature] _____
James E. Scott _____
Homera. Crowler _____
Ella M. Knag _____

This Determination must be signed by a majority of the Conservation Commission.

On this 22nd day of June, 19 94, before me personally appeared [Signature] Conservation Director, to me known to be the person described in, and who executed, the foregoing instrument, and acknowledged that the signatures above represent a majority of the Amherst Conservation Commission.

[Signature] _____
Notary Public _____ My commission expires _____
August 28, 1998

This Determination does not relieve the applicant from complying with all other applicable federal, state or local statutes, ordinances, by-laws or regulations. This Determination shall be valid for three years from the date of issuance.

The applicant, the owner, any person aggrieved by this Determination, any owner of land abutting the land upon which the proposed work is to be done, or any ten residents of the city or town in which such land is located, are hereby notified of their right to request the Department of Environmental Protection to issue a Superseding Determination of Applicability, providing the request is made by certified mail or hand delivery to the Department, with the appropriate filing fee and Fee Transmittal Form as provided in 310 CMR 10.03(7) within ten days from the date of issuance of this Determination. A copy of the request shall at the same time be sent by certified mail or hand delivery to the Conservation Commission and the applicant.



Commonwealth of Massachusetts
Executive Office of Environmental Affairs

**Department of
Environmental Protection**
Western Regional Office

William F. Weld
Governor

Trudy Coxo
Secretary, EOE

Thomas B. Powers
Acting Commissioner

06/29/94

Janice Ratner
16 Stagecoach Road
Amherst, MA 01002

Re: AGREEMENT TO EXTEND SCHEDULE
Application for: BRFP02
Sewage variance

At: Ratner Home
16 Stagecoach Road
Amherst, MA

Transmittal Number: 85562

Dear Ms. Ratner:

The Department of Environmental Protection and the Permittee, James & Janice Ratner have agreed to the following extension of the schedule of review for the above referenced permit application:

July 29, 1994: Submit four copies of the revised plans for the above referenced permit application, along with the approval from the Amherst Health Department on the variances requested.

The reasons for such agreement are as follows:

To allow time for the Amherst Health Department's action on the revised supplemental information.

This agreement shall be in effect from the date below.

Date 6/29/94 by *Alan Weinberg*
DEPARTMENT OF ENVIRONMENTAL PROTECTION
Alan Weinberg
Acting Regional Engineer
Bureau of Resource Protection

310 CMR 10.99

Form 2



Commonwealth
of Massachusetts

Town File # 94-410

DEP File No.

N/A

(To be provided by DEP)

AMHERST

City/Town

Janice Rattner

Applicant

Date Request Filed May 2, 1994

Date Issued 6-22-94

Determination of Applicability
Massachusetts Wetlands Protection Act, G.L. c. 131, §40
and the Town of Amherst Wetland Protection Bylaw

From Amherst Conservation Commission Issuing Authority

To Janice Rattner same
(Name of person making request) (Name of property owner)

Address 16 Stagecoach Road Address _____

This determination is issued and delivered as follows:

- ☐ by hand delivery to person making request on _____ (date)
☒ by certified mail, return receipt requested on 6-23-94 (date)

Pursuant to the authority of G.L. c. 131, §40, the Conservation Commission
has considered your request for a Determination of Applicability and its supporting documentation, and has
made the following determination (check whichever is applicable):

Location: MAP _____ PARCEL _____ LOT(subdivision) _____
Street Address: 16 Stagecoach Rd.

1. ☐ The area described below, which includes all/part of the area described in your request, is an Area Subject to Protection Under the Act. Therefore, any removing, filling, dredging or altering of that area requires the filing of a Notice of Intent.

2. ☐ The work described below, which includes all/part of the work described in your request, is within an Area Subject to Protection Under the Act and will remove, fill, dredge or alter that area. Therefore, said work requires the filing of a Notice of Intent.

3. ☐ The work described below, which includes all/part of the work described in your request, is within the Buffer Zone as defined in the regulations, and will alter an Area Subject to Protection Under the Act. Therefore, said work requires the filing of a Notice of Intent.

This Determination is negative:

1. ☒ The area described in your request is not an Area Subject to Protection Under the Act.
2. ☐ The work described in your request is within an Area Subject to Protection Under the Act, but will not remove, fill, dredge, or alter that area. Therefore, said work does not require the filing of a Notice of Intent.
3. ☐ The work described in your request is within the Buffer Zone, as defined in the regulations, but will not alter an Area Subject to Protection Under the Act. Therefore, said work does not require the filing of a Notice of Intent.
4. ☐ The area described in your request is Subject to Protection Under the Act, but since the work described therein meets the requirements for the following exemption, as specified in the Act and the regulations, no Notice of Intent is required: _____

Issued by Amherst Conservation Commission Conservation Commission

Signature(s) _____

[Signature] *Ella M. Knag*
James E. Scott _____
Homera. Crowler _____

This Determination must be signed by a majority of the Conservation Commission.

On this 22nd day of June, 1994, before me personally appeared *[Signature]* Conservation Director, to me known to be the person described in, and who executed, the foregoing instrument, and acknowledged that the signatures above represent a majority of the Amherst Conservation Commission.

[Signature] August 28, 1998
Notary Public My commission expires

This Determination does not relieve the applicant from complying with all other applicable federal, state or local statutes, ordinances, by-laws or regulations. This Determination shall be valid for three years from the date of issuance.

The applicant, the owner, any person approved by this Determination, any owner of land abutting the land upon which the proposed work is to be done, or any ten residents of the city or town in which such land is located, are hereby notified of their right to request the Department of Environmental Protection to issue a Superseding Determination of Applicability, providing the request is made by certified mail or hand delivery to the Department, with the appropriate filing fee and Fee Transmittal Form as provided in 310 CMR 10.03(7) within ten days from the date of issuance of this Determination. A copy of the request shall at the same time be sent by certified mail or hand delivery to the Conservation Commission and the applicant.

No.

THE COMMONWEALTH OF MASSACHUSETTS

BOARD OF HEALTH

Town OF Amherst

Application for Disposal Works Construction Permit



Application is hereby made for a Permit to Construct () or Repair (☒) an Individual Sewage Disposal System at:

Location - Address: 116 Stagecoach Rd.
Owner: Janice Ratner
or Lot No. Address: 116 Stagecoach Rd., Amherst, MA 01002
Installer Address:

Type of Building: Dwelling — No. of Bedrooms: 4 Expansion Attic () Garbage Grinder (no)
Other — Type of Building: No. of persons: Showers () — Cafeteria ()
Other fixtures:

Design Flow: 55 gallons per person per day. Total daily flow: 440.0 gallons.
Septic Tank — Liquid capacity: 1000 gallons Length: 8.5' Width: 5.0' Diameter: Depth: 4.0' (liquid)
Disposal Trench — No. 5 Width: 2.0' Total Length: 275.0' Total leaching area: 1,925 sq. ft. Sidewalk
Seepage Pit No. Diameter: Depth below inlet: 3.5' Total leaching area: 550.0 sq. ft. Bottom
Other Distribution box (☒) Dosing tank ()
Percolation Test Results Performed by: Filios Enterprises, Inc. Date: December 9, 1993
Test Pit No. 1: 37.5 minutes per inch Depth of Test Pit: 10' Depth to ground water: 94"
Test Pit No. 2: minutes per inch Depth of Test Pit: 10' Depth to ground water: 48"

Description of Soil: Attached

Nature of Repairs or Alterations — Answer when applicable:

Agreement:

The undersigned agrees to install the aforescribed Individual Sewage Disposal System in accordance with the provisions of TITLE 5 of the State Environmental Code — The undersigned further agrees not to place the system in operation until a Certificate of Compliance has been issued by the board of health.

Signed: Date:

Application Approved By: Date:

Application Disapproved for the following reasons:

Permit No. Issued: Date:

THE COMMONWEALTH OF MASSACHUSETTS

BOARD OF HEALTH

Town OF Amherst

Certificate of Compliance

THIS IS TO CERTIFY, That the Individual Sewage Disposal System constructed () or Repaired (☒) by:

at 116 Stagecoach Rd. has been installed in accordance with the provisions of TITLE 5 of The State Environmental Code as described in the application for Disposal Works Construction Permit No. dated

THE ISSUANCE OF THIS CERTIFICATE SHALL NOT BE CONSTRUED AS A GUARANTEE THAT THE SYSTEM WILL FUNCTION SATISFACTORY.

DATE: Inspector:

CHECK OR FILL IN WHERE APPLICABLE



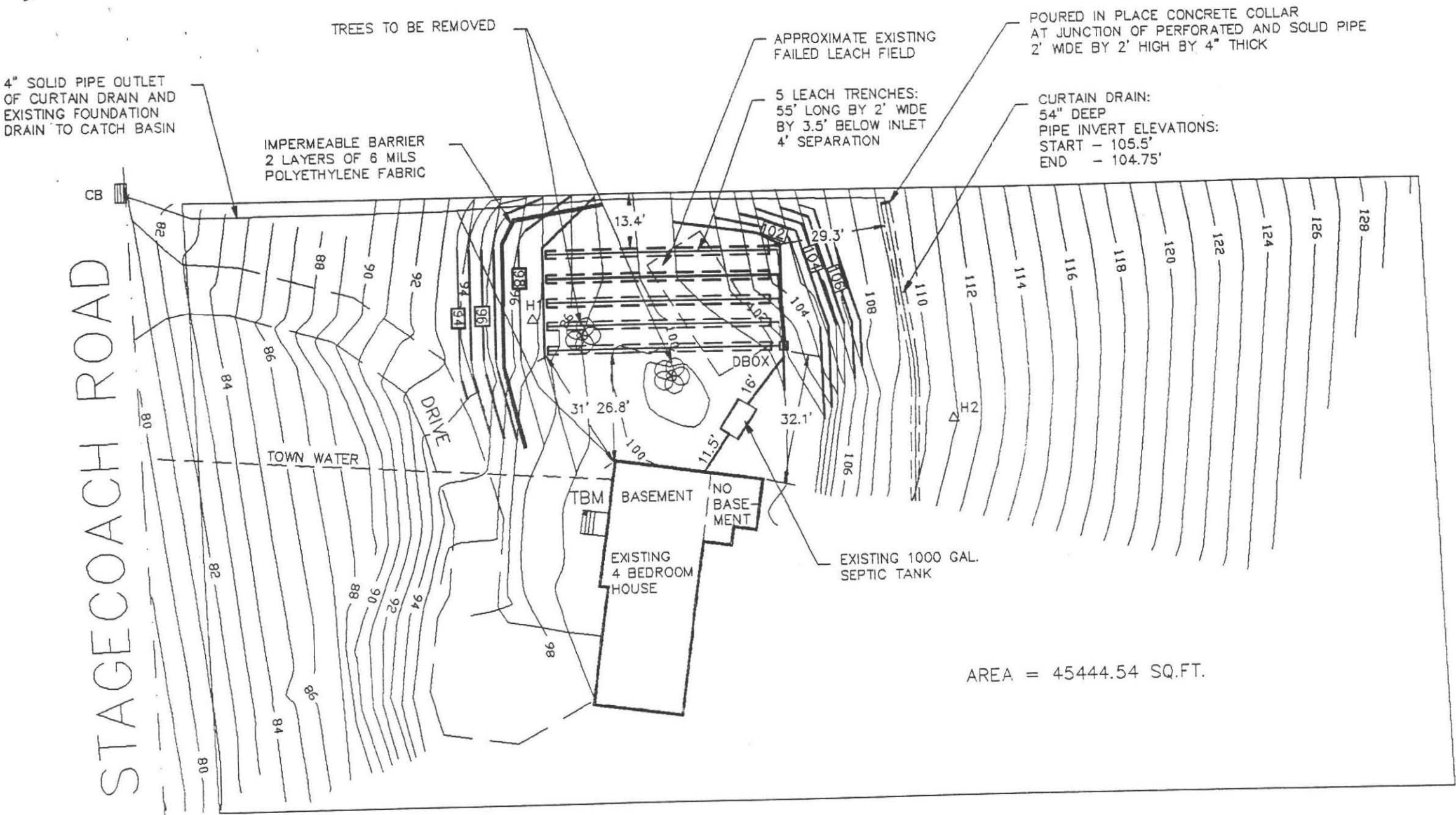

LEGEND

- PT PERCOLATION TEST
- △ Hx DEEP TEST PIT
- PROPOSED CONTOUR LINES (1' INTERVAL)
- EXISTING CONTOUR LINES (1' INTERVAL)

VARIANCES REQUIRED:

THIS PLAN REQUIRES VARIANCES TO TITLE 5 OF THE MASS. STATE SANITARY CODE, AND TO TOWN OF AMHERST TOWN BOARD OF HEALTH REGULATIONS AS FOLLOWS:

- TITLE 5 VARIANCES:
 - 15.03 (4) LEACHING AREA REQUIREMENTS; NOTE (5) TO ALLOW A PERCOLATION RATE OF 37.5 MIN./INCH.
 - 15.14 LEACHING TRENCHES, FIGURE 1., ILLUSTRATION B, LEACHING TRENCH, SLOPE REQUIREMENTS. TO ALLOW THE USE OF AN IMPERMEABLE BARRIER IN LIEU OF MINIMUM DISTANCES.
- TOWN OF AMHERST REGULATIONS:
 - SECTION 2 A. VOLUME OF SANITARY SEWAGE. TO ALLOW SIZE OF THE LEACHING AREA TO BE LESS THAN 1.25% OF THAT REQUIRED BY TITLE 5.

NOTES:

- TBM IS EAST CORNER OF BOTTOM FRONT STEP.
- NO OTHER WELLS WITHIN 200' OF THE LEACH AREA AT THE TIME OF SURVEY.

PLAN OF SEWAGE DISPOSAL SYSTEM	
AT: 16 STAGE COACH RD., AMHERST, MA	
BY: FILIOS ENTERPRISES, INC. 69 PELHAM RD. AMHERST MA 01002 (413)256-8008	FOR: JANICE RATNER 16 STAGECOACH RD. AMHERST, MA 01002
DRAWN BY: P. FILIOS	SCALE: 1" = 30'
REV. #2, 27 JULY, 1994	PAGE 1 OF 2

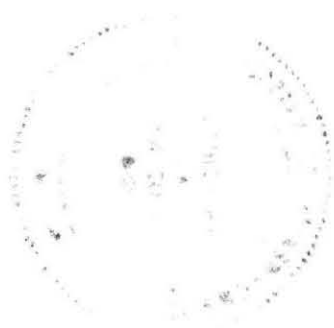

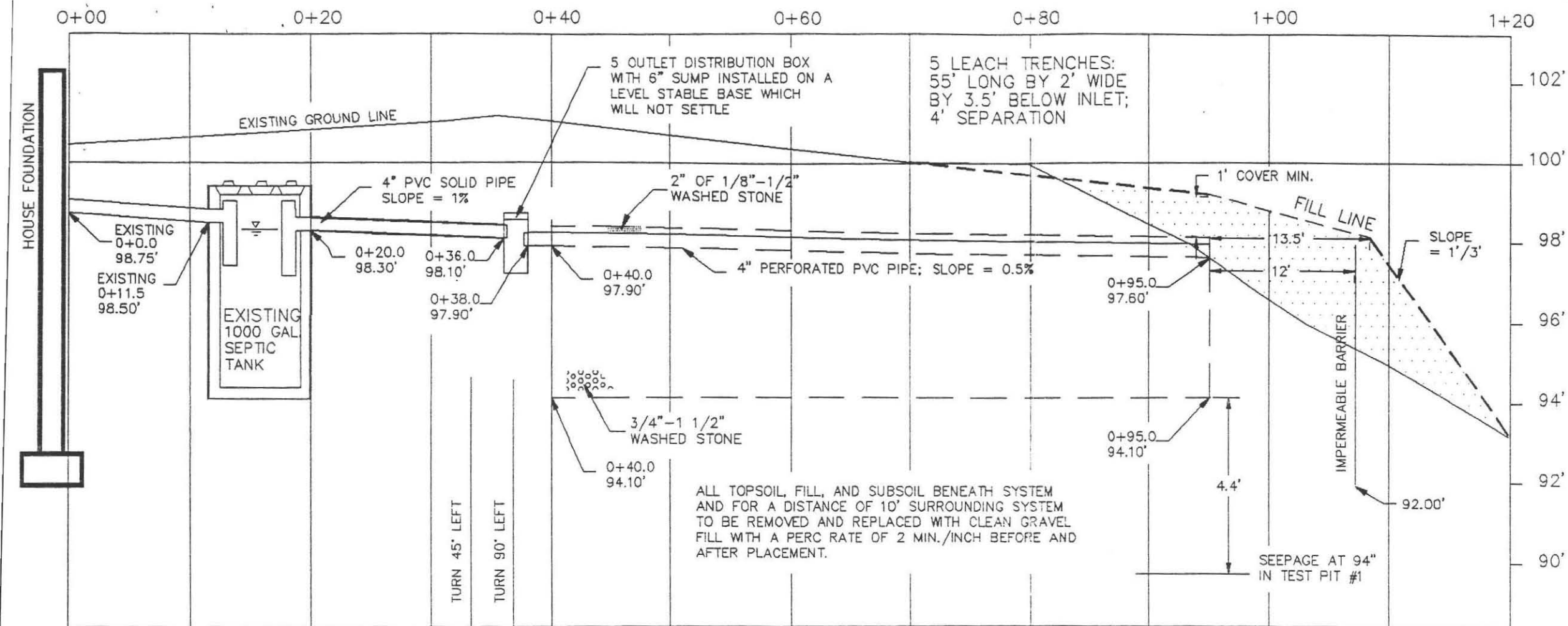

100' Elevation Assumed at TBM. TBM is East corner of bottom step as shown on Plan view.

SPECIFICATIONS

ALL MATERIALS AND CONSTRUCTION MUST BE IN ACCORDANCE WITH COMMONWEALTH OF MASSACHUSETTS DEPT. OF ENVIRONMENTAL PROTECTION STATE ENVIRONMENTAL CODE TITLE 5.

Construction Notes

- Existing Septic Tank to be inspected at time of construction to insure tees are in place and meet Title 5 requirements (inlet tee must extend 10" below the flow line and outlet tee 14").
- Septic Tank to be inspected and pumped every three years following construction.

CROSS-SECTION AT A - A' (0+70)

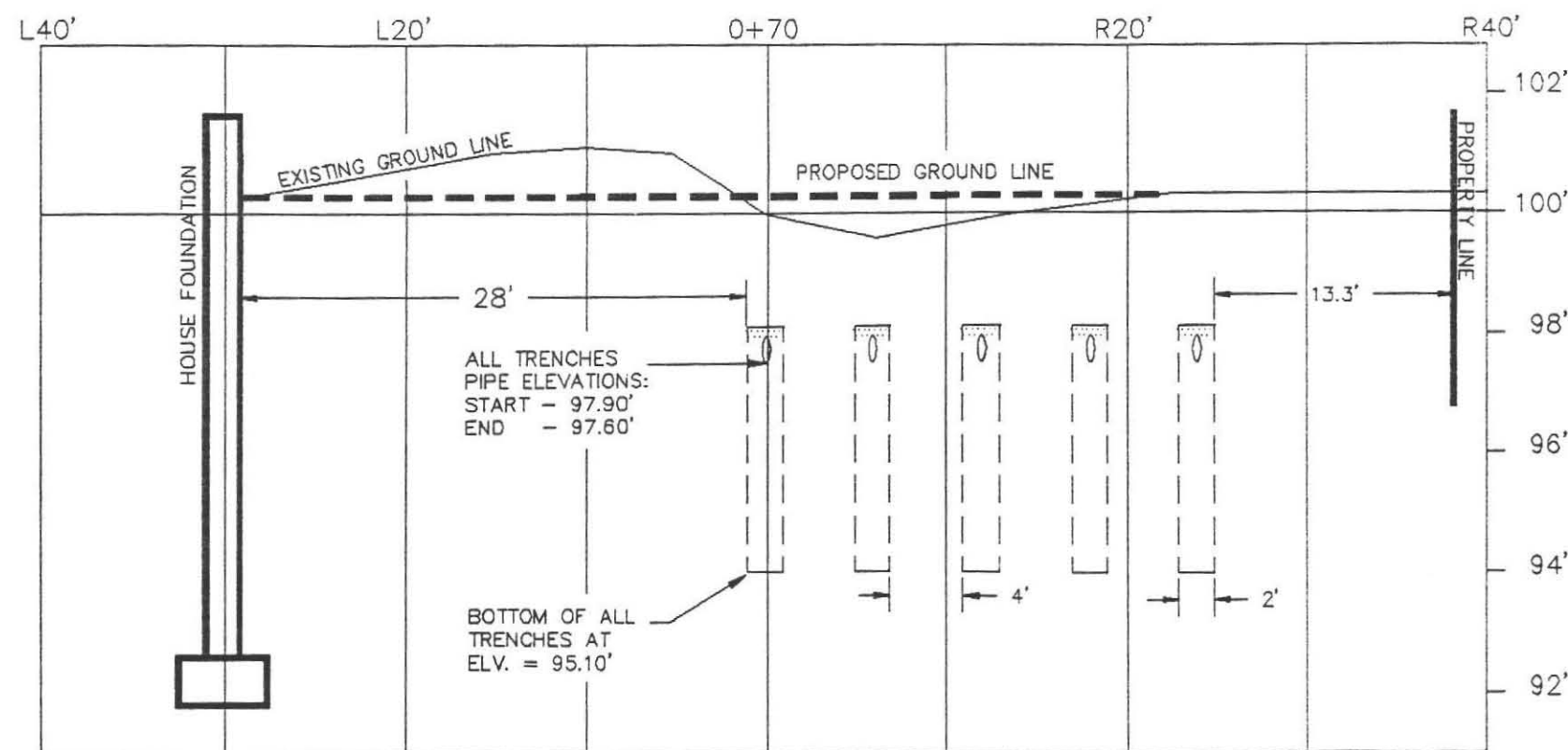

CALCULATIONS

REQUIRED: For a 4 bedroom house without a garbage grinder a capacity of 440.0 gal./day.

DESIGNED: 5 leach trenches 55.0'L X 2.0'W X 3.50' below inlet (effective depth), for a perc rate of 30 min./in., yielding side and bottom loading factors of 0.232 and 0.0 gal./sq.ft. respectively.

SIDEWALL:	10 Sides(55.0' X 3.5')0.232 Gal./Sq.Ft.	= 446.6 Gal.
BOTTOM:	5 Trenches(55.0' X 2.0')0.00 Gal./Sq.Ft.	= 0.0 Gal.
TOTAL		446.6 Gal.



PROFILE OF SEWAGE DISPOSAL SYSTEM

AT: 16 STAGECOACH RD., AMHERST, MA

BY: FILIOS ENTERPRISES, INC.
69 PELHAM RD.
AMHERST MA 01002
(413)256-8008

FOR: Janice Ratner
16 Stagecoach Rd.
Amherst, MA 01002

Drawn by: P. Filios

SCALE: 1" = 10' HOR.
3' VER.

REV. #2: 26 JULY, 1994

PAGE 2 OF 2

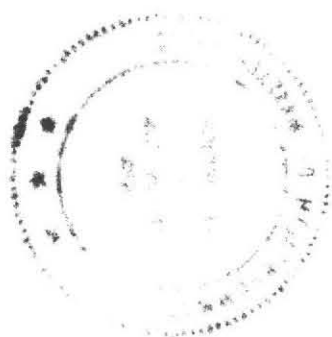

APR 29 1994



Commonwealth of Massachusetts
Executive Office of Environmental Affairs
**Department of
Environmental Protection**
Western Regional Office

William F. Weld
Governor

Trudy Coxe
Secretary, EOE

Thomas B. Powers
Commissioner

04/26/94

Janice Ratner
16 Stagecoach Road
Amherst, MA 01002

Re: STATEMENT OF TECHNICAL DEFICIENCY
Application for: BRPWP02
Sewage variance

At: Ratner Home
16 Stagecoach Road
Amherst, MA

Transmittal Number: 85562

Dear Ms. Ratner:

The Department of Environmental Protection has completed its technical review of the permit application listed above. Based on information currently in the record and pursuant to 310 CMR 15.20, Title 5 of the State Environmental Code, the permit will be denied as proposed.

Denial is based on the Department's determination that as presented, approval would not provide the same degree of environmental protection as required under Title 5. However, in accordance with 310 CMR 4.00, the Timely Action and Fee Provisions, the application may be supplemented by the applicant. Therefore, to address noted deficiencies, the Department requests in accordance with 310 CMR 4.00, that you submit the information indicated below within sixty (60) calendar days from the date of this letter. Please note, you must allow for appropriate Board of Health action on the revised submittal within the sixty (60) calendar days since any further filing on this matter would be considered a new application.

Information required to be submitted is as follows:

1. A completed Wetland's Determination of Applicability form. This document must be signed by the Chairman of the local Conservation Commission, and must contain the determination.
2. The leaching area availability must be recalculated. Pursuant to 310 CMR 15.03(4)(e) no bottom area is allowed for a percolation rate over 20 minutes per inch.

If you fail to submit the above requested information within 60 days from the date of this letter, your application will be deemed withdrawn, and you must reapply if you still wish to seek a permit. You will not receive a refund as a result of this action.

April 26, 1994

The Department may, at its option, agree to a written request for an extension of the time allowed if you cannot accommodate the schedule of the Board of Health within the sixty (60) calendar day period, or will for other reasons require additional time to submit the information. However, the request must be received within the sixty (60) calendar day timeframe.

Should the application, based on submittal of the additional information, still be deemed inadequate, the Department may request additional information during the course of the supplemental Technical Review in accordance with 310 CMR 4.04(3)(b).

Further, you may, within 45 days, elect in writing to proceed on the application and supporting materials as they presently stand. If you elect to proceed in this manner you may not modify the application and supporting materials in any way. However, you are advised that following the Department's receipt of the request, a decision will be issued to deny the permit within 45 days subject to any adjustment in the schedule according to 310 CMR 4.04(2)(d)2. or 4.04(2)(d)3.a.

Following receipt of the information indicated above, the Department has 30 days to complete a supplemental Technical Review and issue a final decision to grant or deny the permit.

Submittal of additional information must be accompanied by the enclosed Supplemental Transmittal Form to ensure correct processing by the Department. The coordinator assigned to your project is Minh Tonthat; and may be reached at extension 216.

Sincerely,

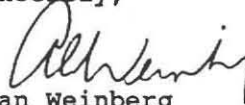

Alan Weinberg
Acting Regional Engineer
Bureau of Resource Protection

MT/mt/kz
wpc108/185562a

enclosure: Supplemental Transmittal Form

cc: Amherst Health Department
Filius Enterprises, Inc., 69 Pelham Rd, Amherst, MA 01002/Enclosure



Bettye Anderson Frederic, Director

AMHERST

Massachusetts

AMHERST HEALTH DEPARTMENT
70 BOLTWOOD WALK
AMHERST, MA 01002-2128
(413) 256-4077

OFFICE OF THE
HEALTH DEPARTMENT

SANITARIAN (413) 256-4030

MISCELLANEOUS INSPECTIONS

Inspection of Hand - Filled Septic
Name Tanice RATHEN
Date: 5/16/94 Time: _____
Owner Same
Business Address 16 Stage Coach Rd
(Street)
Type of Business Rental
Amherst
(City or Town)

Violation(s) and remarks: Possible Failed Septic System
Peric Test conducted on 12/8/93.
Filio's Enterprises submitted a proposal to
The Board because Variances were needed -
I informed Filio's Enterprises that they needed
A wetlands determination - IT WASNT
DONE. Filio's ENT SUBMITTED THE PLAN TO
D.E.P. - D.E.P. REQUESTED A WETLANDS INSPECTION.
MARY FROM CONSERVATION FOUND WETLANDS ON
PROPERTY - Filio's will Re-Draw -
Board of Health will need to approve New
Plan -

This Inspection Report is signed and certified
Under the pains and penalties of perjury.

Signature of Inspector: _____

Signature of Owner or Person in Charge: _____

Town of



AMHERST

Massachusetts

TOWN HALL
4 BOLTWOOD AVENUE
AMHERST, MA. 01002-2351

INSPECTION SERVICES DEPARTMENT
Phone (413) 256-4030

January 26, 1994

To: Bettye Anderson Frederic

From: David Zarozinski

Re: Variance Request of Leaching System at 16 Stagecoach Road, Amherst

I have reviewed the septic system plan designed by Mr. Fred Filios, R.S. of Filios Enterprises, Inc. This plan design is prepared for Mrs. Janice Ratner of 16 Stagecoach Road, Amherst, MA.

I would recommend the variances be granted for this septic system for the following reasons:

1. A variance request is needed for the perc rate of 37.5 minutes per inch. Under Title V of the State Sanitary Code the allowed rate is thirty (30) minutes per inch (Title V Section 15.03 (4 & 5). Copies enclosed.

At the present time there are no regulations that can be used as a guideline for percolation rates above thirty (30) minutes per inch. In order to meet the requirements of 37.5 minutes per inch Filios Enterprises calculated the number of trenches for the leaching area by extrapolating the bottom and sidewall area in the present code.

2. Title V, Section 15.14 - Leaching Trenches (Figure 1) illustration B, Slope Requirements. The impermeable barrier in lieu of minimum distance required will serve the same function and will allow a steeper fill slope to prevent filling over the existing driveway. Sufficient distance from the trenches is provided in the proposed design to allow adequate area for the treatment and disposal of the leachate. Copies enclosed
3. Town of Amherst (Section 2, A. - Volume of Sanitary Sewer) Requirement of septic system to be designed 25% larger to accommodate the daily flow capacity. The new system will be 10% larger than required by D.E.P. Copy enclosed

enc.

WP/DZ/Ratner

JUL - 8 1994

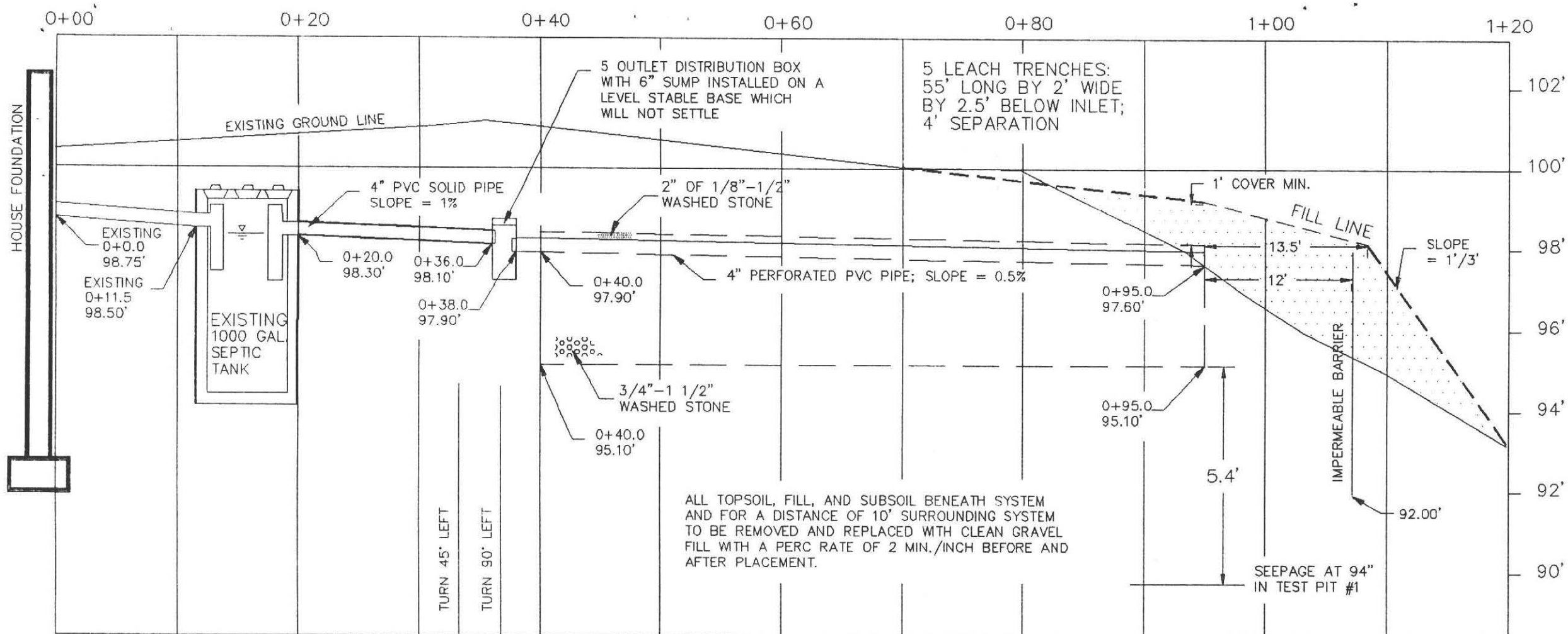

100' Elevation Assumed at TBM. TBM is East corner of bottom step as shown on Plan view.

SPECIFICATIONS

ALL MATERIALS AND CONSTRUCTION MUST BE IN ACCORDANCE WITH COMMONWEALTH OF MASSACHUSETTS DEPT. OF ENVIRONMENTAL PROTECTION STATE ENVIRONMENTAL CODE TITLE 5.

Construction Notes

- Existing Septic Tank to be inspected at time of construction to insure tees are in place and meet Title 5 requirements (inlet tee must extend 10" below the flow line and outlet tee 14").
- Septic Tank to be inspected and pumped every three years following construction.

CROSS-SECTION AT A - A' (0+70)

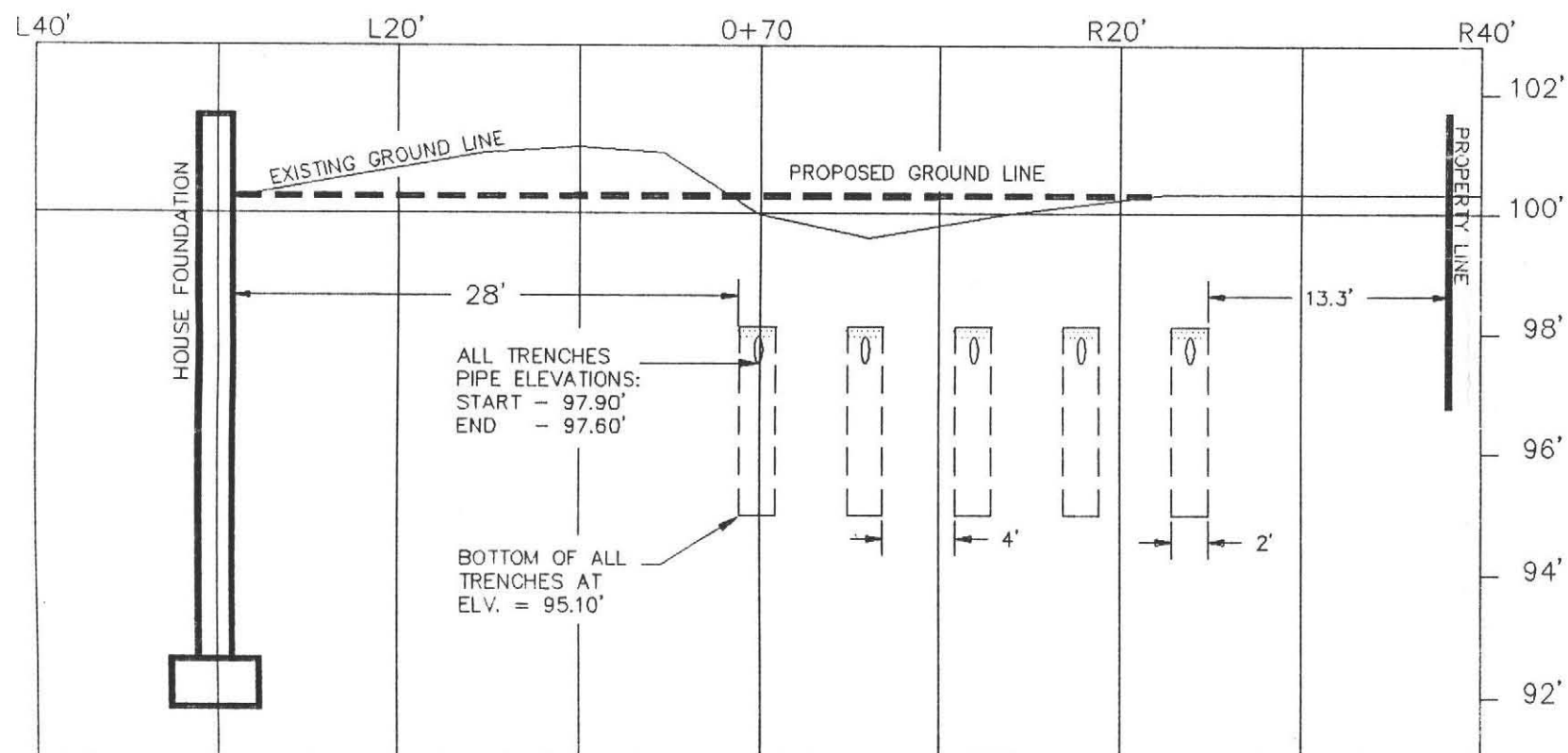

CALCULATIONS

REQUIRED: For a 4 bedroom house without a garbage grinder a capacity of 440.0 gal./day.

DESIGNED: 5 leach trenches 55.0'L X 2.0'W X 2.50' below inlet (effective depth), for a perc rate of 37.5 min./in using a side loading factor of 0.32 gal./sq.ft.

SIDEWALL: 10 Sides (55' X 2.5') 0.32 gal./sq.ft.	= 440.00 gal.
BOTTOM: not allowed	= 0
TOTAL	440.00 gal.

PROFILE OF SEWAGE DISPOSAL SYSTEM

AT: 16 STAGECOACH RD., AMHERST, MA

BY: FILIOS ENTERPRISES, INC.
69 PELHAM RD.
AMHERST MA 01002
(413)256-8008

FOR: Janice Ratner
16 Stagecoach Rd.
Amherst, MA 01002

Drawn by: P. Filios

SCALE: 1" = 10' HOR.
3' VER.

REVISION #1: 2 MAY, 1994

PAGE 2 OF 2

JUL - 8 1994

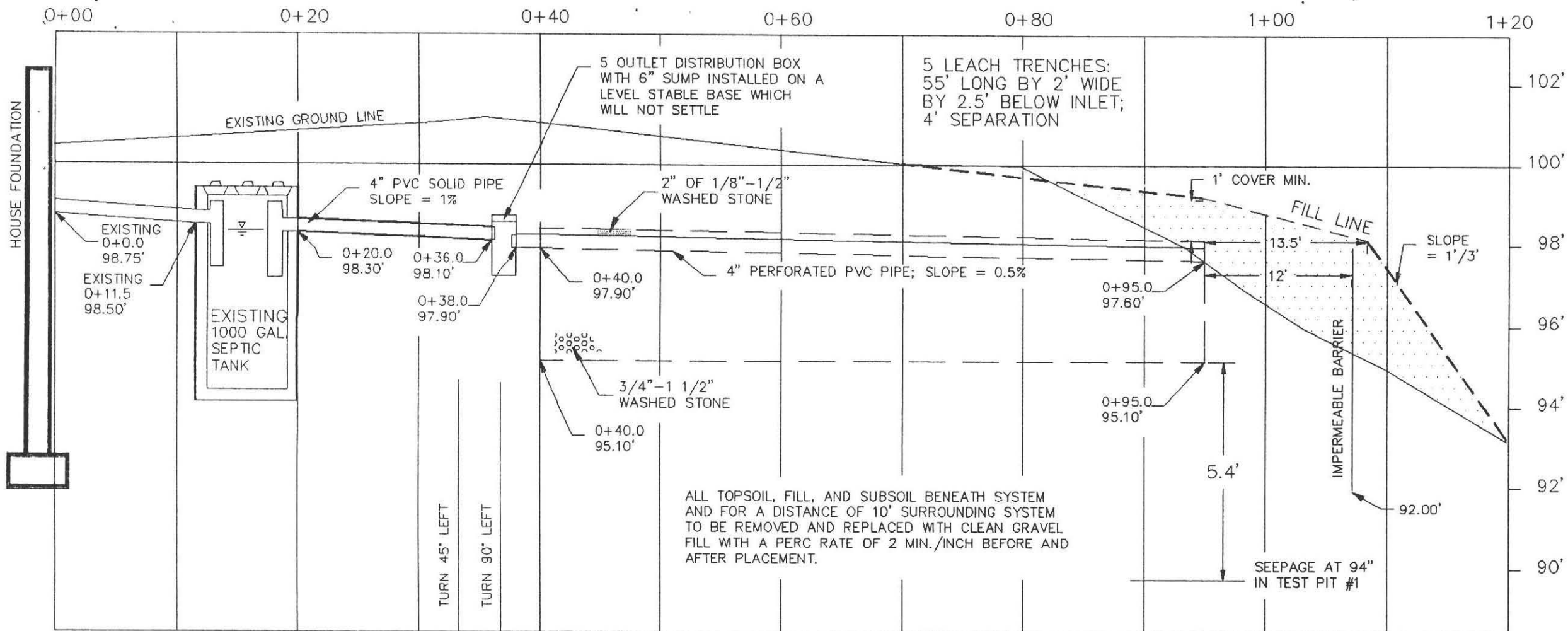

JUL - 8 1994

100' Elevation Assumed at TBM. TBM is East corner of bottom step as shown on Plan view.

SPECIFICATIONS

ALL MATERIALS AND CONSTRUCTION MUST BE IN ACCORDANCE WITH COMMONWEALTH OF MASSACHUSETTS DEPT. OF ENVIRONMENTAL PROTECTION STATE ENVIRONMENTAL CODE TITLE 5.

Construction Notes

- Existing Septic Tank to be inspected at time of construction to insure tees are in place and meet Title 5 requirements (inlet tee must extend 10" below the flow line and outlet tee 14").
- Septic Tank to be inspected and pumped every three years following construction.

CROSS-SECTION AT A - A' (0+70)

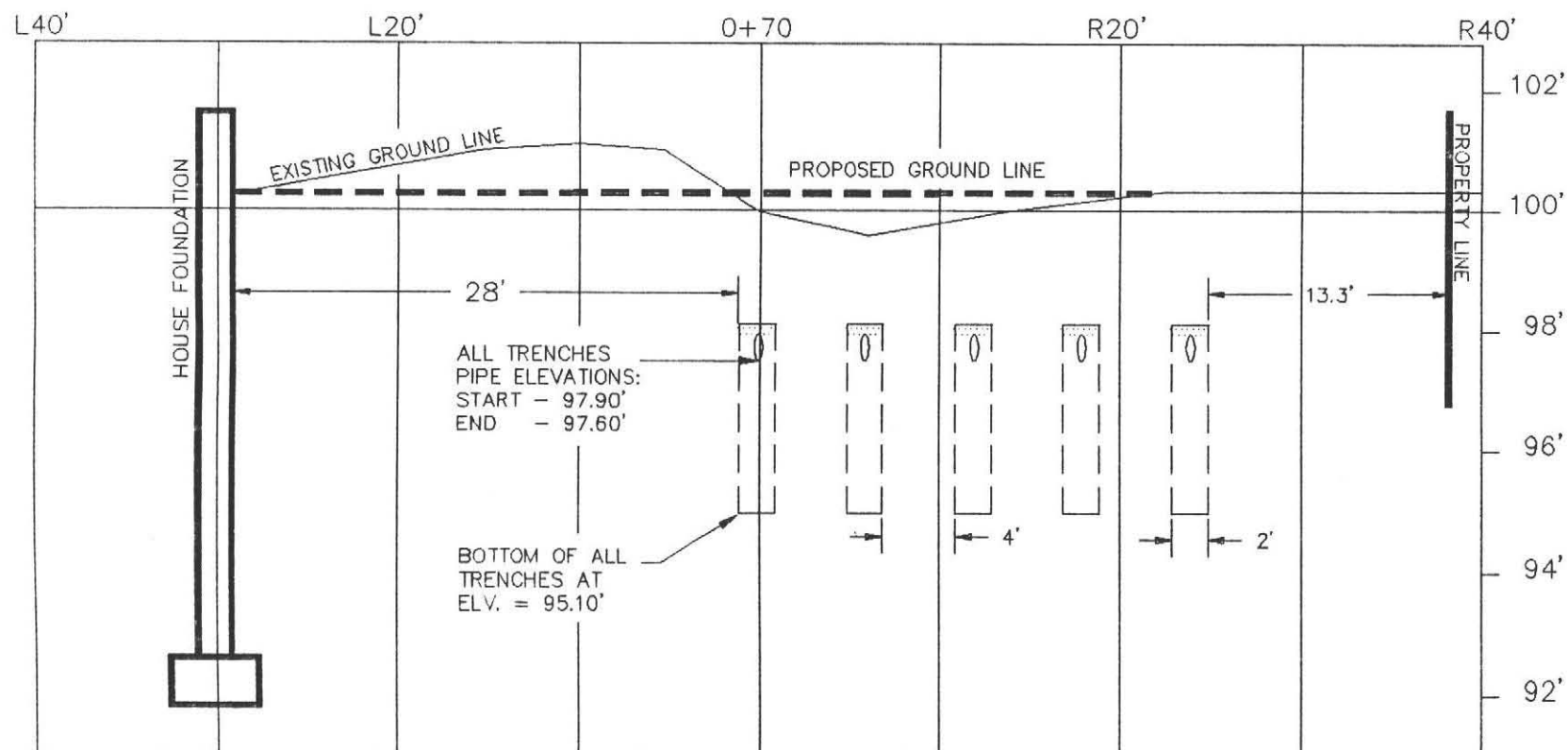

CALCULATIONS

REQUIRED: For a 4 bedroom house without a garbage grinder a capacity of 440.0 gal./day.

DESIGNED: 5 leach trenches 55.0'L X 2.0'W X 2.50' below inlet (effective depth), for a perc rate of 37.5 min./in using a side loading factor of 0.32 gal./sq.ft.

SIDEWALL: 10 Sides (55' X 2.5') 0.32 gal./sq.ft.	= 440.00 gal.
BOTTOM: not allowed	= 0
TOTAL	440.00 gal.

PROFILE OF SEWAGE DISPOSAL SYSTEM

AT: 16 STAGECOACH RD., AMHERST, MA

BY: FILIOS ENTERPRISES, INC.
69 PELHAM RD.
AMHERST MA 01002
(413)256-8008

FOR: Janice Ratner
16 Stagecoach Rd.
Amherst, MA 01002

Drawn by: P. Filios

SCALE: 1" = 10' HOR.
3' VER.

REVISION #1: 2 MAY, 1994

PAGE 2 OF 2

JUL - 8 1994

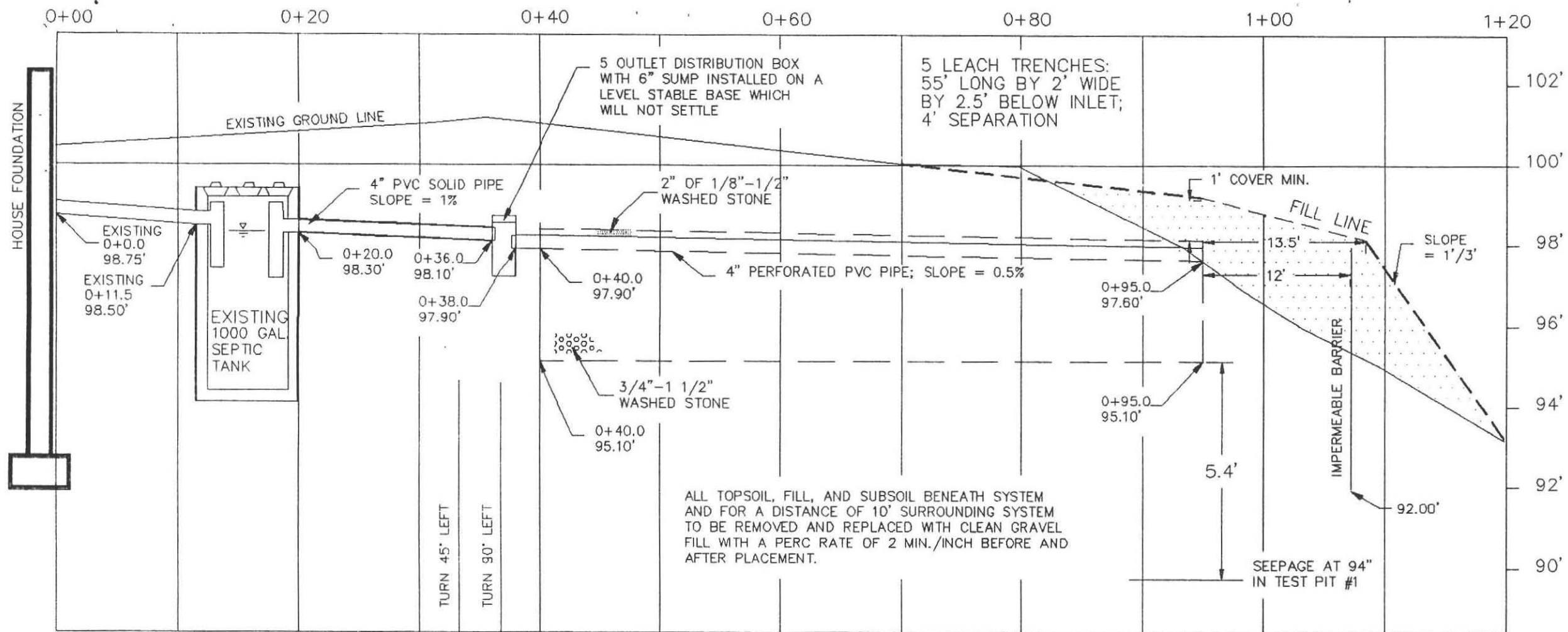

100' Elevation Assumed at TBM. TBM is East corner of bottom step as shown on Plan view.

SPECIFICATIONS
ALL MATERIALS AND CONSTRUCTION MUST BE IN ACCORDANCE WITH COMMONWEALTH OF MASSACHUSETTS DEPT. OF ENVIRONMENTAL PROTECTION STATE ENVIRONMENTAL CODE TITLE 5.

Construction Notes
1. Existing Septic Tank to be inspected at time of construction to insure tees are in place and meet Title 5 requirements (inlet tee must extend 10" below the flow line and outlet tee 14").
2. Septic Tank to be inspected and pumped every three years following construction.

CROSS-SECTION AT A - A' (0+70)

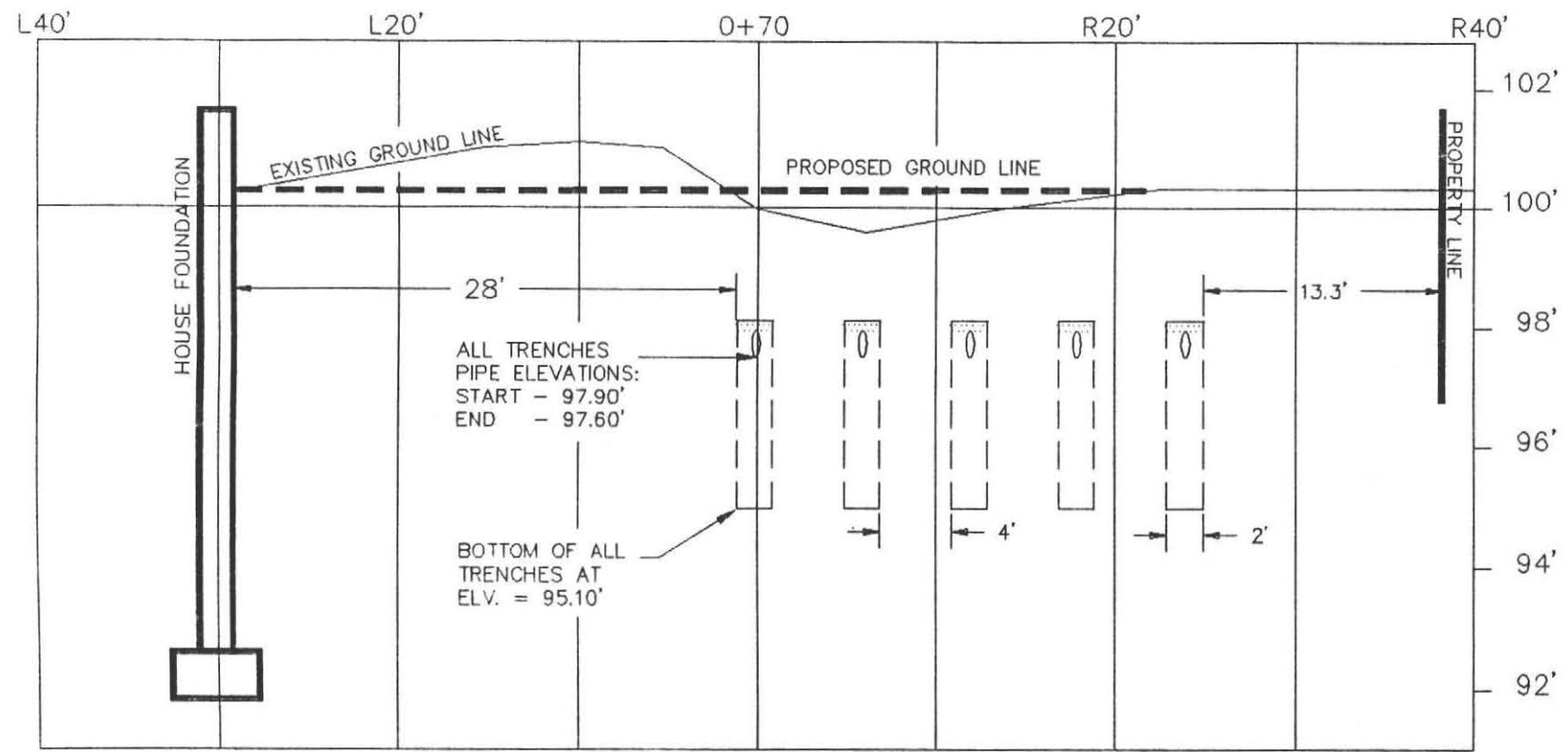

CALCULATIONS	
REQUIRED: For a 4 bedroom house without a garbage grinder a capacity of 440.0 gal./day.	
DESIGNED: 5 leach trenches 55.0'L X 2.0'W X 2.50' below inlet (effective depth), for a perc rate of 37.5 min./in using a side loading factor of 0.32 gal./sq.ft.	
SIDEWALL: 10 Sides (55' X 2.5') 0.32 gal./sq.ft.	= 440.00 gal.
BOTTOM: not allowed	= 0
TOTAL	440.00 gal.

PROFILE OF SEWAGE DISPOSAL SYSTEM	
AT: 16 STAGECOACH RD., AMHERST, MA	
BY: FILIOS ENTERPRISES, INC. 69 PELHAM RD. AMHERST MA 01002 (413)256-8008	FOR: Janice Ratner 16 Stagecoach Rd. Amherst, MA 01002
Drawn by: P. Filios	SCALE: 1" = 10' HOR. 3' VER.
REVISION #1: 2 MAY, 1994	PAGE 2 OF 2

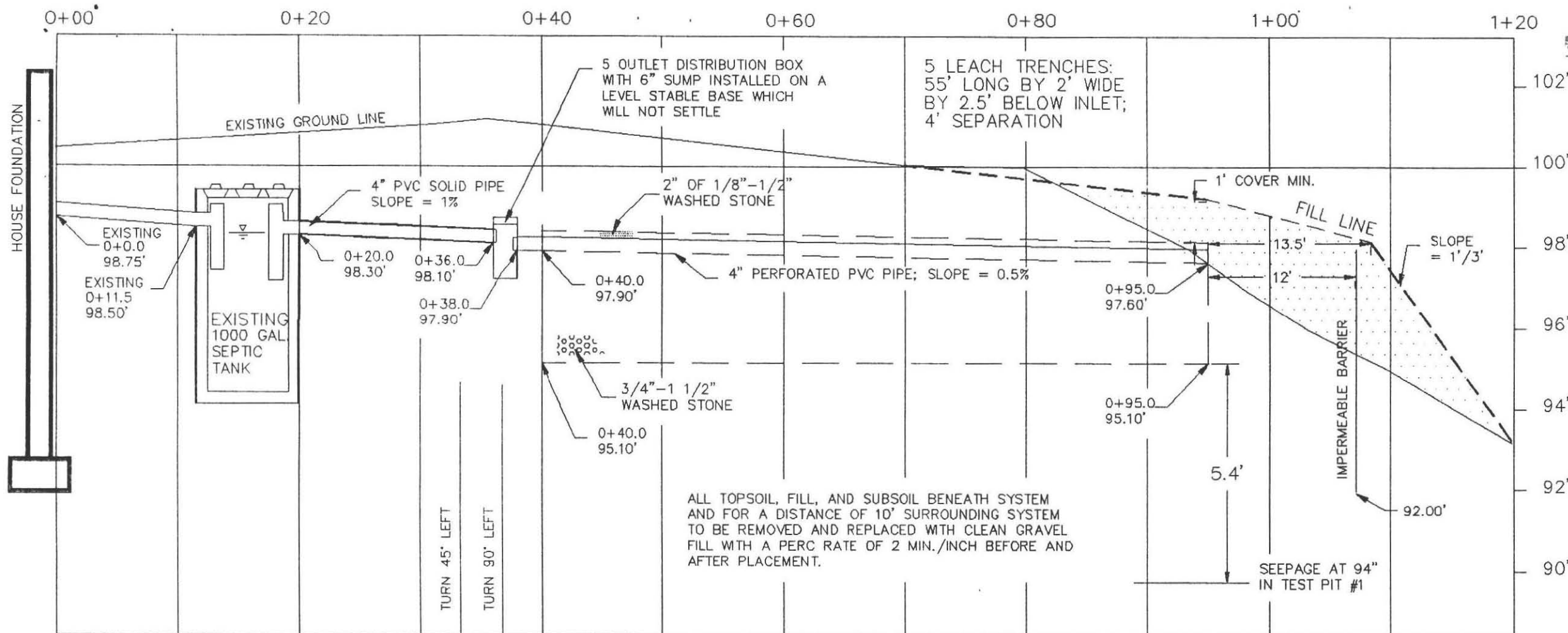

JUL - 8 1994

100' Elevation Assumed at TBM. TBM is East corner of bottom step as shown on Plan view.

SPECIFICATIONS

ALL MATERIALS AND CONSTRUCTION MUST BE IN ACCORDANCE WITH COMMONWEALTH OF MASSACHUSETTS DEPT. OF ENVIRONMENTAL PROTECTION STATE ENVIRONMENTAL CODE TITLE 5.

Construction Notes

- Existing Septic Tank to be inspected at time of construction to insure tees are in place and meet Title 5 requirements (inlet tee must extend 10" below the flow line and outlet tee 14").
- Septic Tank to be inspected and pumped every three years following construction.

CROSS-SECTION AT A - A' (0+70)

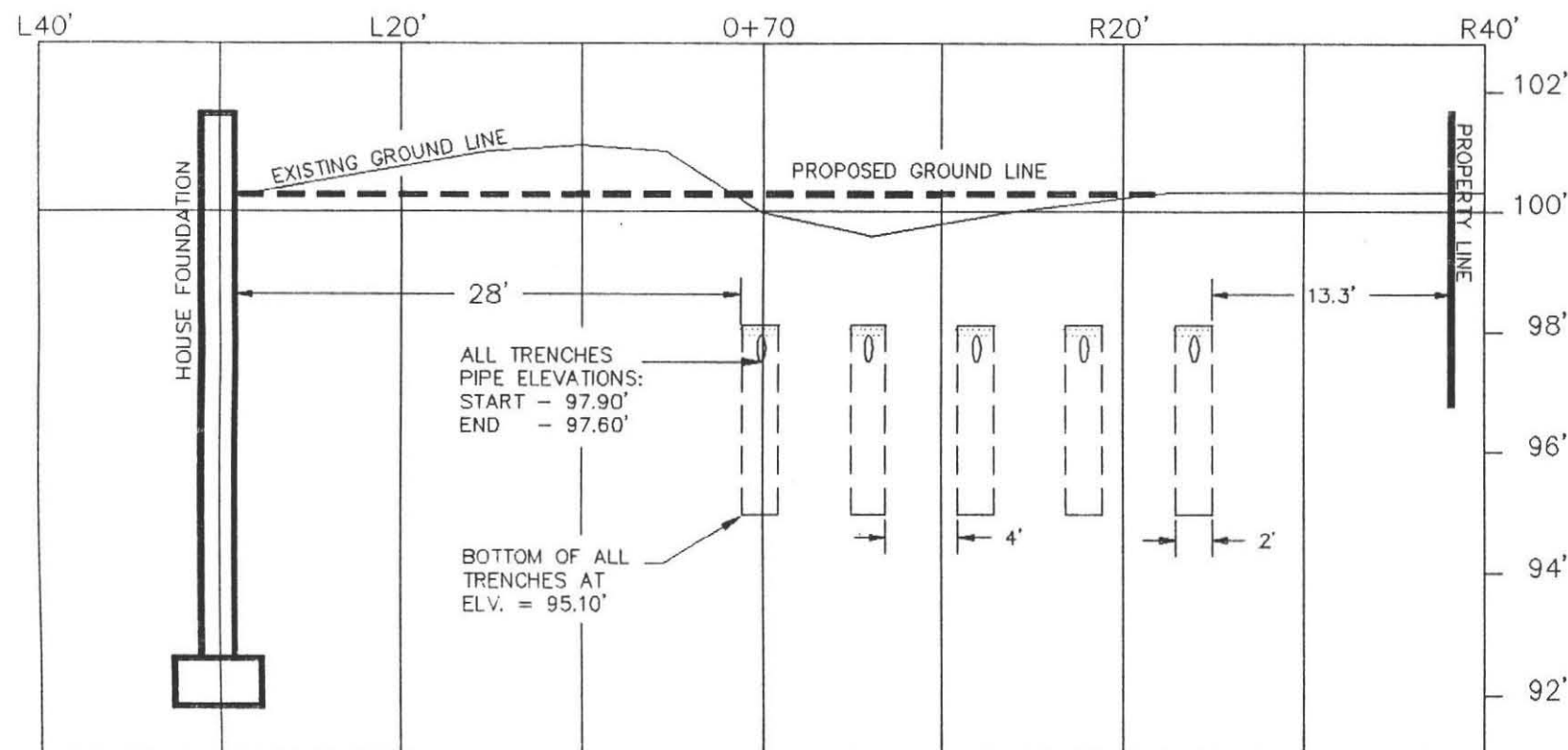

CALCULATIONS

REQUIRED: For a 4 bedroom house without a garbage grinder a capacity of 440.0 gal./day.

DESIGNED: 5 leach trenches 55.0'L X 2.0'W X 2.50' below inlet (effective depth), for a perc rate of 37.5 min./in using a side loading factor of 0.32 gal./sq.ft.

SIDEWALL: 10 Sides (55' X 2.5')	0.32 gal./sq.ft.	= 440.00 gal.
BOTTOM: not allowed		= 0
TOTAL		440.00 gal.

PROFILE OF SEWAGE DISPOSAL SYSTEM

AT: 16 STAGECOACH RD., AMHERST, MA

BY: FILIOS ENTERPRISES, INC.
69 PELHAM RD.
AMHERST MA 01002
(413)256-8008

FOR: Janice Ratner
16 Stagecoach Rd.
Amherst, MA 01002

Drawn by: P. Filios

SCALE: 1" = 10' HOR.
3' VER.

REVISION #1: 2 MAY, 1994

PAGE 2 OF 2

16 Stagecoach

BOARD OF HEALTH, AMHERST, MASSACHUSETTS
APPLICATION FOR DISPOSAL WORKS CONSTRUCTION PERMIT

No. 72-30 Date 9-18-72 Fee \$ 00 Date Rec'd. 9-18-72 By CED

Application is hereby made for a permit to Construct (X) or Repair () an Individual Sewage Disposal System at: 16 Stagecoach Hill - Old Stage Rd. STAGECOACH RD. or Lot No. #222

Location—Address Paul Testaglier Address _____

Owner AL VADONAI Address _____

Contractor _____ Address _____

Type of Building _____ Dimensions _____ Size Lot 1 acre ±

Dwelling—No. of Bedrooms 4 Expansion Attic () Garbage Grinder (X)

Other _____ No. of persons _____ Showers ()

Other fixtures _____

Town Water? yes Type of Well _____

Design Flow 50 gallons per person per day. Total daily flow 400 gallons

Septic Tank—Liquid capacity 1200 gallons Dimensions: L 10'-0" W 5'-4" D 4'-10"

Disposal Trench—No. 4 Width 3'-0" Total Length 200' Total leaching area 600 sq. ft.

OR Disposal Bed—No. 1 Diameter 15'x40' Depth below inlet _____ Total leaching area 200 sq. ft.

Dry Well—No. _____ Diameter _____ Depth below inlet _____ Dimensions: _____ x _____ x _____

Other: Distribution box () No. _____ Dosing tank ()

(Depth of Soil Line Below finished grade at foundation _____)

Percolation Test Results Performed by J. HART - HUNTLEY ENGR. Date 9/8/72

Test Pit No. 1 12 minutes per inch Depth of Test Pit 2'-7"

Test Pit No. 2 3 minutes per inch COBBES Depth of Test Pit 2'-4"

Description of Soil GRAVEL W/LAYERS OF SAND Depth to Ground Water #1 2'-7" #2 NONE

Will disposal area be filled? _____ Cut down? _____

(On reverse side or separate sheet, show plot plan with building. Include dimensions, distances from all boundaries. Show location of wells, streams, ledge, large trees, etc.)

AGREEMENT: The undersigned agrees to construct the aforescribed individual sewage disposal system in accordance with the provisions of Article XI of the Sanitary Code and regulations of the Amherst Board of Health. The undersigned further agrees not to place the system in operation until a Certificate of Compliance has been issued by this board of health.

Application Approved by CED

Paul Testaglier
Owner or builder

9/18/72
date

Application Disapproved for the following reasons:

SITE MAY HAVE TO BE
CURTAIN DRAINED - (DEWATERED)
9/18/72
date

BOARD OF HEALTH, AMHERST, MASSACHUSETTS
CERTIFICATE OF COMPLIANCE

THIS IS TO CERTIFY, That the individual Sewage Disposal System installed () or repaired () by _____ at _____ has been constructed in accordance with the provisions of

INSTALLER

Article XI of the State Sanitary Code as described in the application for Disposal Works Construction Permit No. _____ dated _____

The issuance of this certificate shall not be construed as a guarantee that the system will function satisfactorily.

DATE _____

Inspector _____

BOARD OF HEALTH, AMHERST, MASSACHUSETTS
DISPOSAL WORKS CONSTRUCTION PERMIT

No. 72-30 Permission is hereby granted A. VADONAI to construct (X) or repair () an

Individual Sewage Disposal System at 405 222 STAGECOACH RD.

as shown on the application for Disposal Works Construction Permit No. 72-30

This permit is issued with the understanding that future alterations or additions will be made if necessary. This permit shall not be construed as permission to create or maintain any sewage nuisance and in the issuance of this permit the Board of Health assumes no responsibility for the future operation or maintenance of the system.

DATE 9/18/72

CED
Board of Health

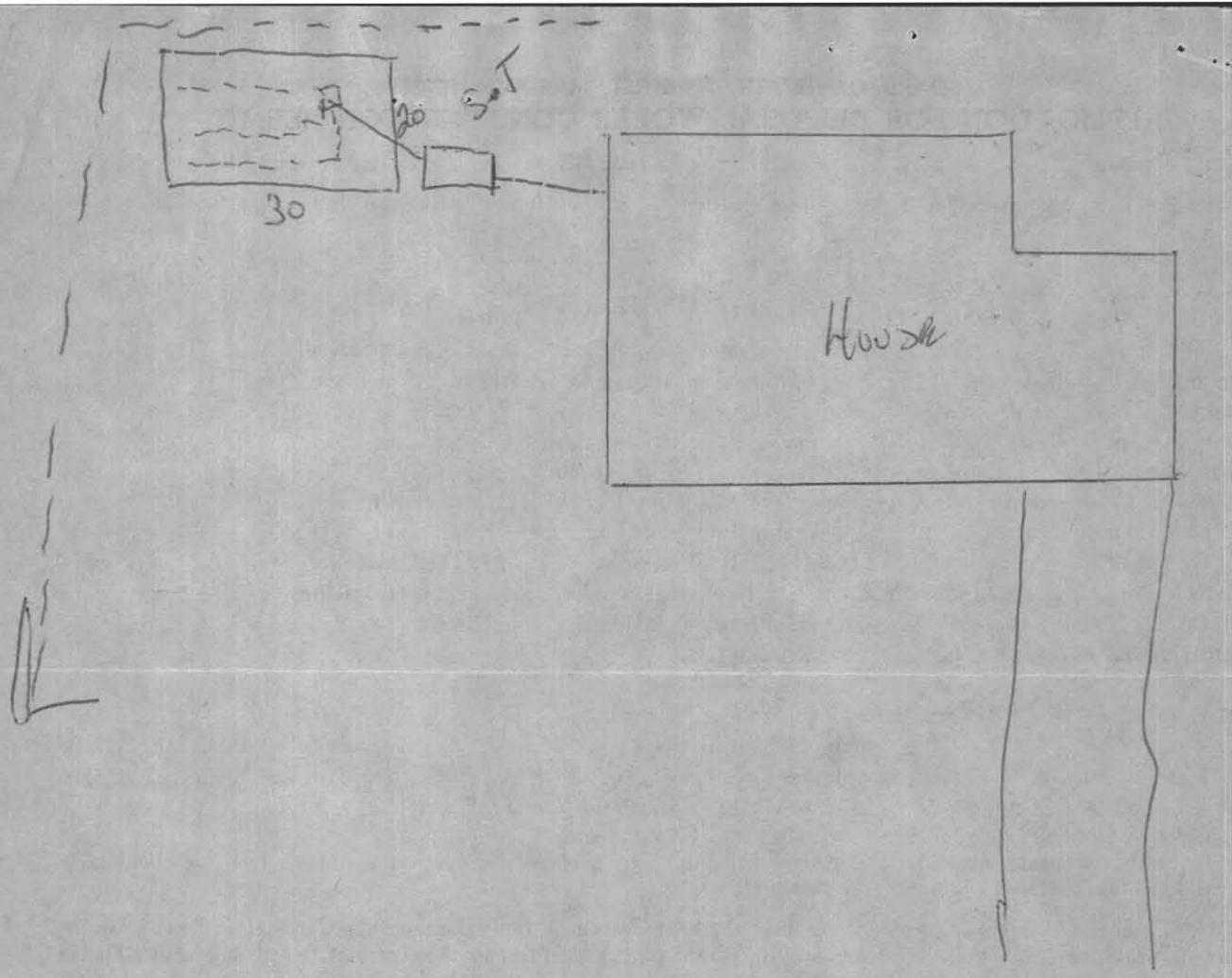

STAGE COACH RD

3/31/82

Charlie
call Karl
549 5396

Lot

16 Stagecoach
RD.

- RATNER -

EAST
SIDE OF
HOUSE

have been identified, the committee can
models that maximize accomodation of com
minimize the potential conflicts because
If certain areas are *amenable* to negotiat
explore ways to achieve consensus or comp
analyzed for strengths and weaknesses and
each model should be described and assess
implementation, costs, and policy issues
defined more clearly.

The planning process involves the fo

1. Assessment and projection of nee
2. Establishment of goals, objective

January 19, 1994

Amherst Board of Health
Bangs Community Center
Boltwood Walk
Amherst, MA 01002

Re: Request for variances for repair of leach system at 16 Stagecoach Rd., Amherst, MA

Dear Board Members:

I request the following variances be granted to allow the safest and most economical repair to the failed leaching system at 16 Stagecoach Rd.:

1. A variance to the requirements of Title 5 paragraph 15.03 (4) Leaching Area Requirements, Note (5); to allow a percolation rate greater than 30 min./inch. The actual percolation rate found was 37.5 min./inch at a depth of 55".
2. A variance to the requirements of Title 5 paragraph 15.14 Leaching Trenches, Figure 1, Illustration B, Slope Requirements, to allow the use of an impermeable barrier in lieu of the minimum distance.
3. A variance to Town of Amherst requirements (Section 2, A. Volume of Sanitary Sewage) that systems be designed to accommodate 125% of the minimum daily flow capacity required by Title 5.

Sincerely,

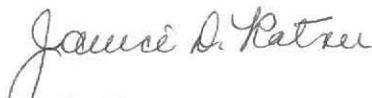
Janice Ratner

1000

1000

1000

1000

1000

1000

1000

1000

1000

1000

1000

1000

1000

1000

1000

1000

1000

1000