

APR 18 1989

No. 89-5

#15

FEE 90.00

pd

4/19/89

THE COMMONWEALTH OF MASSACHUSETTS

BOARD OF HEALTH

TOWN OF AMHERST

Application for Disposal Works Construction Permit



Application is hereby made for a Permit to Construct () or Repair (✓) an Individual Sewage Disposal System at:

15 SOUTH ORCHARD DRIVE Location - Address
KIM TOWNSEND Owner
Karl's Excavating Installer
15 SOUTH ORCHARD DRIVE or Lot No. Address

Type of Building Dwelling - No. of Bedrooms 4 Expansion Attic (-) Garbage Grinder (No)
Other - Type of Building - No. of persons - Showers (-) - Cafeteria (-)
Other fixtures -

Design Flow 55 gallons per person per day. Total daily flow 440 x 1.25 = 550 gallons.
Septic Tank - Liquid capacity 1200 gallons Length 10' Width 5' Diameter - Depth 5.3'
Disposal Trench - No. 5 Width 2' Total Length 200' Total leaching area 600 sq. ft. SIDES
Seepage Pit No. - Diameter - Depth below inlet 1.5' Total leaching area 400 sq. ft. BOTTOM
Other Distribution box (✓) Dosing tank (-)
Percolation Test Results Performed by FILIOS ENTERPRISES, INC. Date 4/4/89
Test Pit No. 1 15 minutes per inch Depth of Test Pit 11.5' Depth to ground water 11.8"
Test Pit No. 2 minutes per inch Depth of Test Pit Depth to ground water

Description of Soil SEE ATTACHED SHEET

Nature of Repairs or Alterations - Answer when applicable -

Agreement:

The undersigned agrees to install the aforescribed Individual Sewage Disposal System in accordance with the provisions of TITLE 5 of the State Sanitary Code - The undersigned further agrees not to place the system in operation until a Certificate of Compliance has been issued by the board of health.

Signed Robert C. Townsend Date April 18, 1989

Application Approved By

Application Disapproved for the following reasons:

Permit No. 89-5 Issued Date

THE COMMONWEALTH OF MASSACHUSETTS

BOARD OF HEALTH

TOWN OF AMHERST

Certificate of Compliance

Reasonable Compliance 5/26/89 Fred Filios

THIS IS TO CERTIFY, That the Individual Sewage Disposal System constructed () or Repaired (✓) by KARL'S EXCAVATING Installer at 15 South Orchard St has been installed in accordance with the provisions of TITLE 5 of The State Sanitary Code as described in the application for Disposal Works Construction Permit No. 89-5 dated April 21, 1989.

THE ISSUANCE OF THIS CERTIFICATE SHALL NOT BE CONSTRUED AS A GUARANTEE THAT THE SYSTEM WILL FUNCTION SATISFACTORY.

DATE May 24, 1989 Inspector David Fitzgerald

THE COMMONWEALTH OF MASSACHUSETTS

BOARD OF HEALTH

TOWN OF AMHERST

No. 89-5

FEE 90.00 pd

Disposal Works Construction Permit

Permission is hereby granted KIM TOWNSEND to Construct () or Repair (✓) an Individual Sewage Disposal System at No. 15 SOUTH ORCHARD DRIVE

as shown on the application for Disposal Works Construction Permit No. 89-5 Dated

DATE David Fitzgerald for Amherst Board of Health

CHECK OR FILL IN WHERE APPLICABLE



1911

1911

1911

1911

1911

1911

1911

1911

1911

1911

1911

1911

1911

1911

1911

1911

1911

1911

1911

1911

1911

1911

1911

1911

1911

1911

1911

1911

1911

1911

1911

1911

1911

1911

1911

1911

1911

1911

1911

1911

1911

1911

1911

1911

1911

1911

1911

1911

1911

1911

1911

1911

1911

1911

1911

1911

1911

1911

1911

1911

1911

1911

1911

1911

1911

1911

1911

1911

1911

1911

1911

1911

1911

1911

1911

1911

1911

1911

No. 89-5

FEE 90 pp. 1/19/89

THE COMMONWEALTH OF MASSACHUSETTS

BOARD OF HEALTH

TOWN OF AMHERST

Application for Disposal Works Construction Permit



Application is hereby made for a Permit to Construct () or Repair (✓) an Individual Sewage Disposal System at:

15 SOUTH ORCHARD DRIVE Location - Address
KIM TOWNSEND Owner
15 SOUTH ORCHARD DRIVE or Lot No. Address

Type of Building
Dwelling - No. of Bedrooms 4 Expansion Attic (-) Garbage Grinder (N)
Other - Type of Building - No. of persons - Showers (-) - Cafeteria (-)
Other fixtures -

Design Flow 55 gallons per person per day. Total daily flow 140 x 1.25 = 550 gallons.
Septic Tank - Liquid capacity 1200 gallons Length 10' Width 5' Diameter - Depth 5.3'
Disposal Trench - No. 5 Width 2' Total Length 200' Total leaching area 600 sq. ft. SIDES
Seepage Pit No. - Diameter - Depth below inlet 1.5' Total leaching area 400 sq. ft. BOTTOM
Other Distribution box (✓) Dosing tank (-)
Percolation Test Results Performed by FILIOS ENTERPRISES, INC. Date 4/4/89
Test Pit No. 1 15 minutes per inch Depth of Test Pit 11.5' Depth to ground water 11.8"
Test Pit No. 2 - minutes per inch Depth of Test Pit - Depth to ground water -

Description of Soil SEE ATTACHED SHEET
Nature of Repairs or Alterations - Answer when applicable -

Agreement:
The undersigned agrees to install the aforescribed Individual Sewage Disposal System in accordance with the provisions of TITLE 5 of the State Sanitary Code - The undersigned further agrees not to place the system in operation until a Certificate of Compliance has been issued by the board of health.
Signed Robert C. Townsend Date April 15, 1989

Application Approved By
Application Disapproved for the following reasons:
Permit No. 89-5 Issued Date

THE COMMONWEALTH OF MASSACHUSETTS

BOARD OF HEALTH

TOWN OF AMHERST

Certificate of Compliance

Reasonable Compliance May 26/89 J. Williams

THIS IS TO CERTIFY, That the Individual Sewage Disposal System constructed () or Repaired (✓) by HART'S EXCAVATING at 15 South Orchard St has been installed in accordance with the provisions of TITLE 5 of The State Sanitary Code as described in the application for Disposal Works Construction Permit No. 89-5 dated April 21, 1989

THE ISSUANCE OF THIS CERTIFICATE SHALL NOT BE CONSTRUED AS A GUARANTEE THAT THE SYSTEM WILL FUNCTION SATISFACTORY.
DATE May 26, 1989 Inspector David J. [Signature]

THE COMMONWEALTH OF MASSACHUSETTS

BOARD OF HEALTH

TOWN OF AMHERST

Disposal Works Construction Permit

Permission is hereby granted KIM TOWNSEND to Construct () or Repair (✓) an Individual Sewage Disposal System at No. 15 SOUTH ORCHARD DRIVE as shown on the application for Disposal Works Construction Permit No. 89-5 Dated DATE David J. [Signature] Board of Health

CHECK OR FILL IN WHERE APPLICABLE

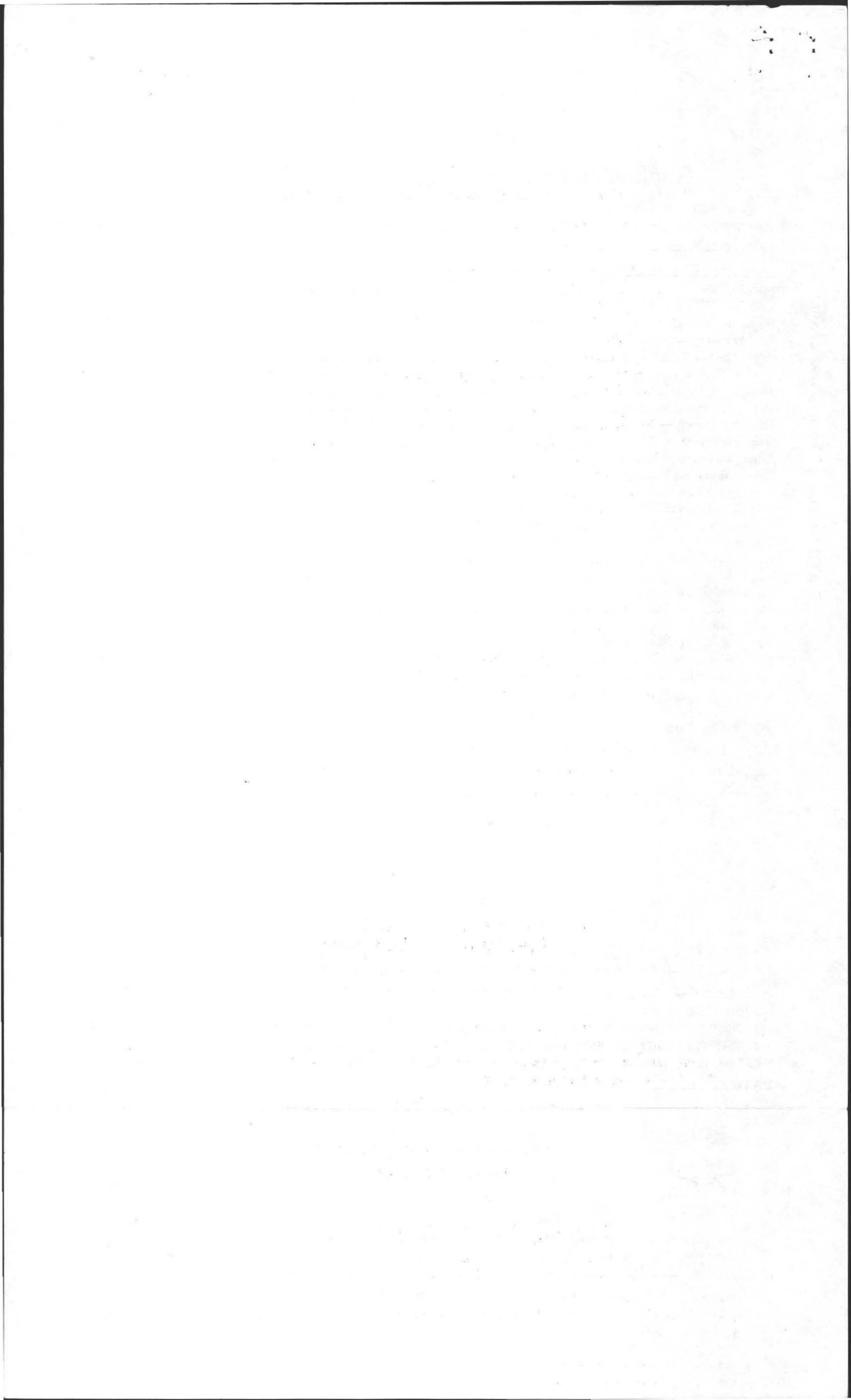

TOWN OF AMHERST

PERC TEST DATA SHEET

DATE April 4 89 LOCATION 15 South Orchard Dr LOT SIZE _____

OWNER Kim Townsend ADDRESS 15 South Orchard Dr TELE # 253-5905

P.E./RS Bill Tylor FIRM Filio's ENR OBSERVED BY 542-2478
DAVID ZAMMILLI

BACK HOE OPERATOR Karl S BENCH MARK _____

PERC DEPTH 40 PRE SOAK TIME 9:11- PERC DEPTH _____ PRE SOAK TIME _____

TEST	<u>9:27</u>	<u>12"</u>	<u>8"</u>	<u>9:52</u>	_____	_____
	<u>9:31</u>	<u>11"</u>	<u>7"</u>	<u>10:04</u>	_____	_____
	<u>9:37</u>	<u>10"</u>	<u>6"</u>	<u>10:19</u>	_____	_____
	<u>9:44</u>	<u>9"</u>	<u>35min</u>		_____	_____

RATE 15 RATE _____

#1

TOP	6	TOP	
SUB	16	SUB	
Compact Sand + Gravel 32"		Seepage AT 118"	
Fine Sand 104"			
Clay 138"			

TOP		TOP	
SUB		SUB	

TOP		TOP	
SUB		SUB	

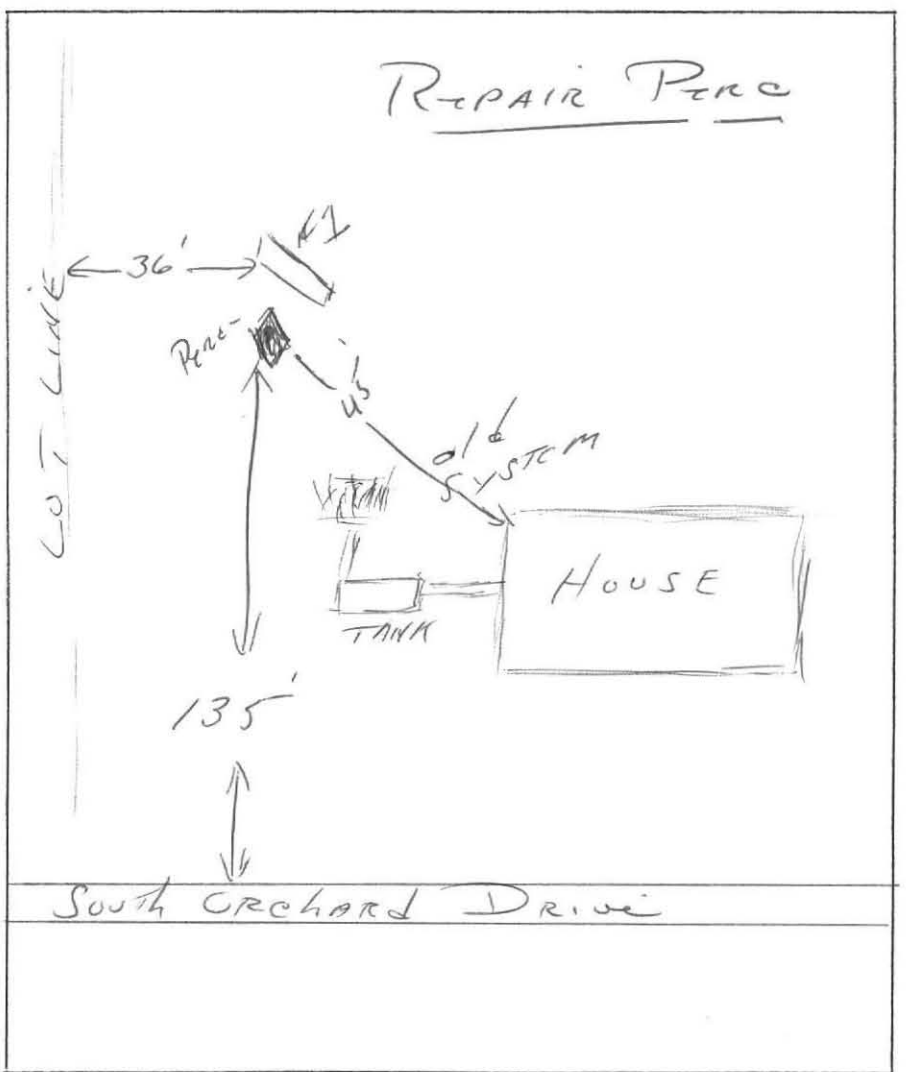

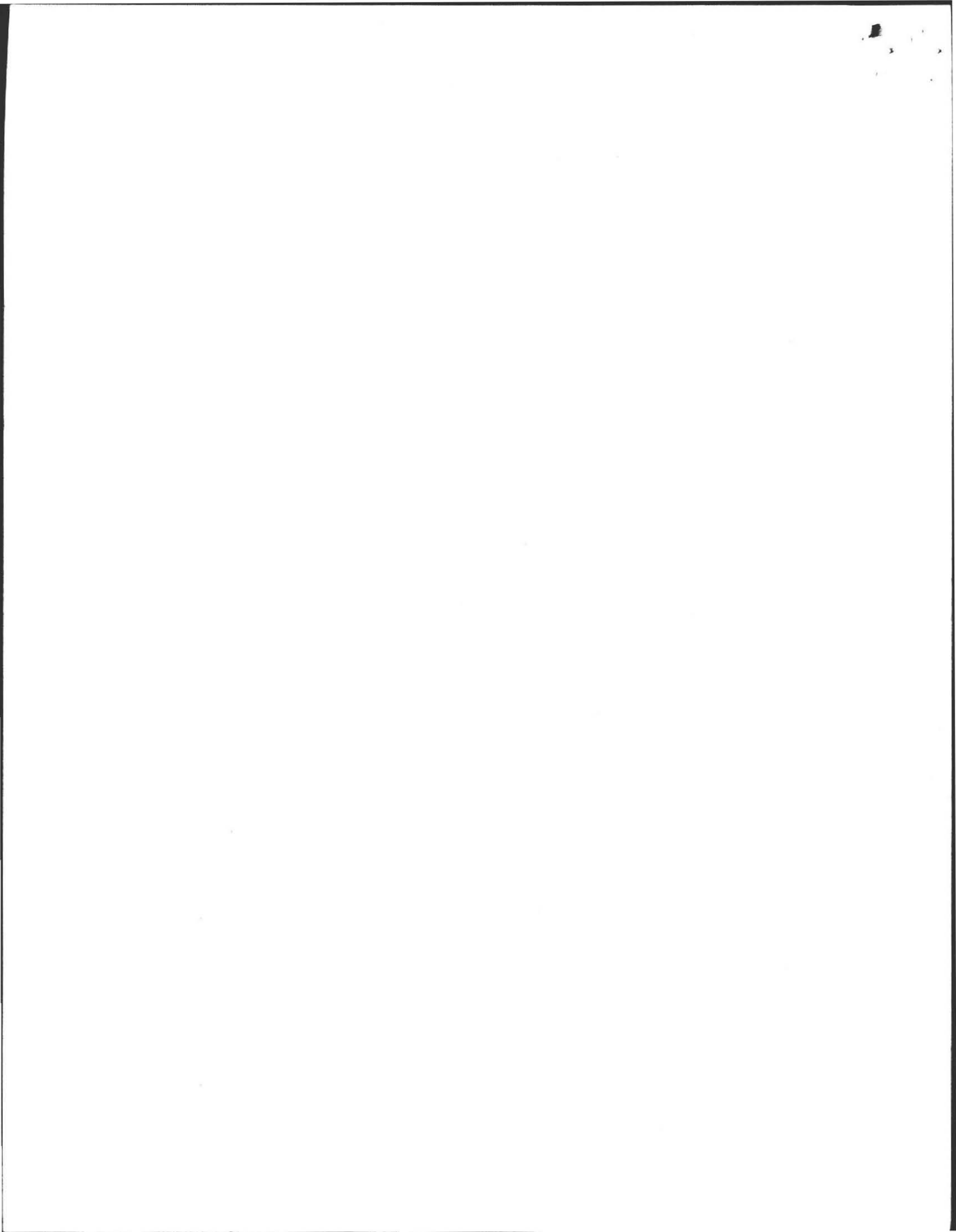

DEEP SOIL LOGS

APR 18 1989

OWNER KIM TOWNSEND

DATE APRIL 4, 1989

LOCATION 15 SOUTH ORCHARD DRIVE
AMHERST, MA 01002
REPAIR

OBSERVER Filos Enterprises, Inc.
B.of H. DAVID ZARCZINSKI

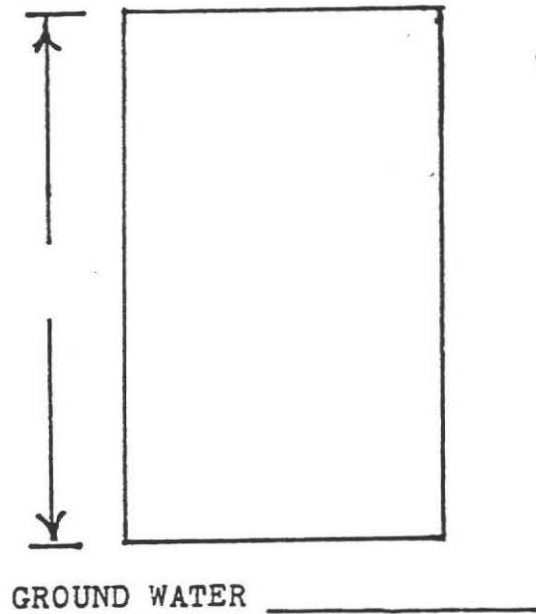
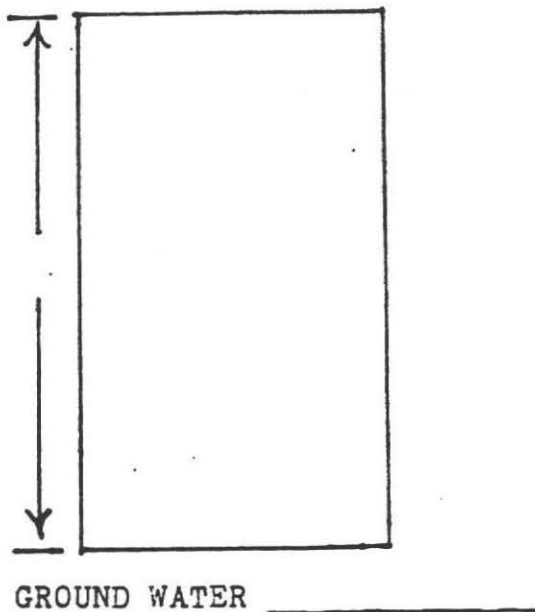
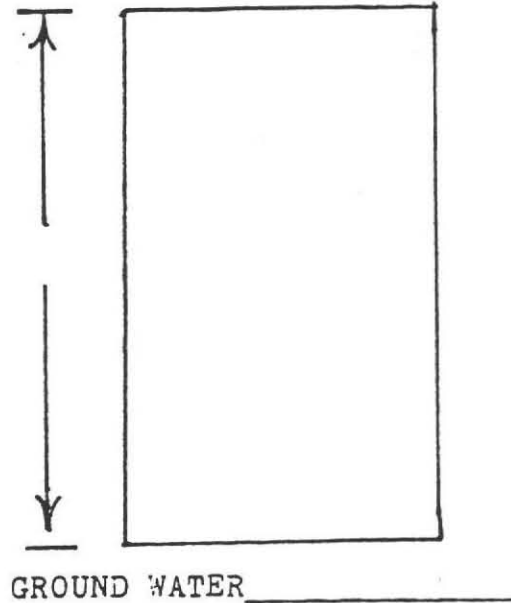
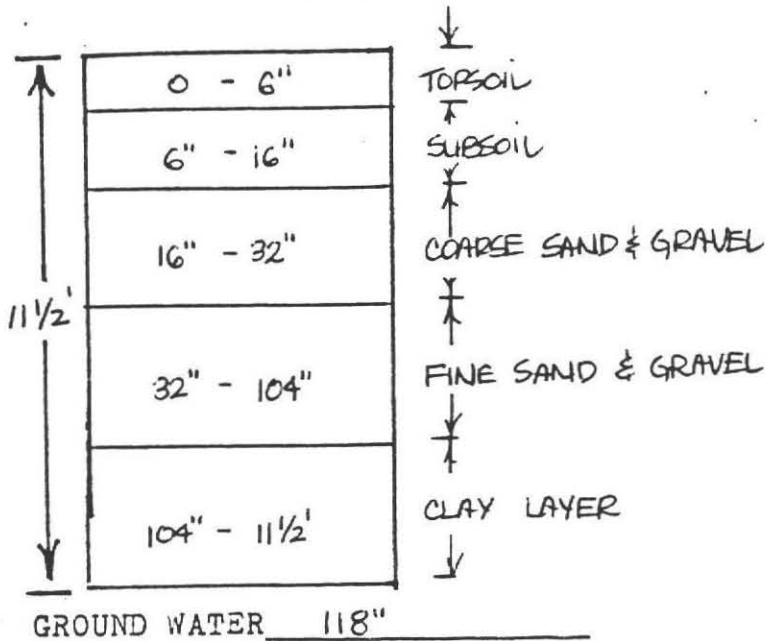

PERCOLATION RATE AT 40" :
15 min./inch



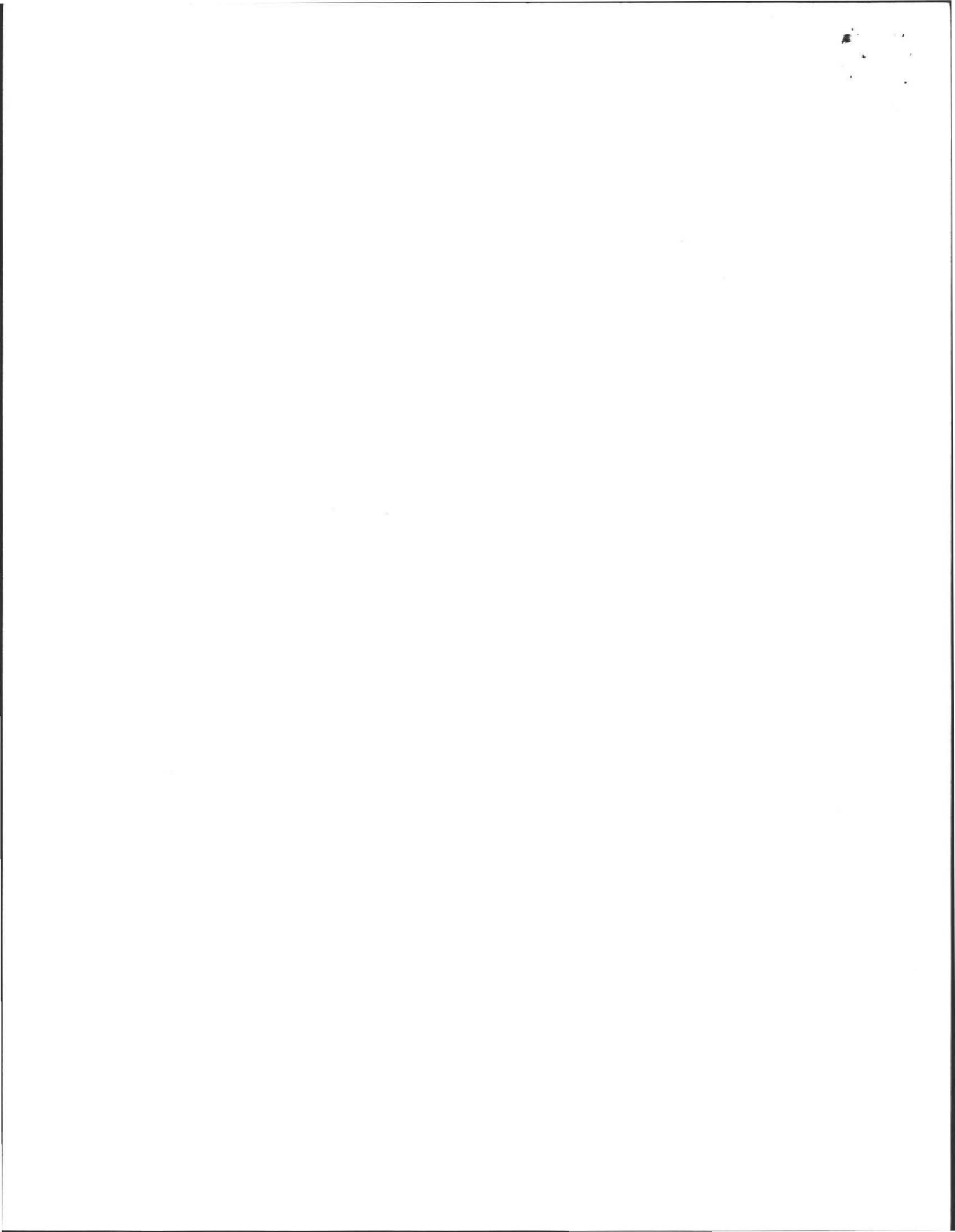

APPROX. 33,700 FT²

NOTE: TOWN WATER ~ NO WELLS IN AREA
NO FILL REQUIRED THEREFORE CONTOURS
WILL NOT CHANGE SIGNIFICANTLY.

5 LEACH TRENCHES
40' L X 2' W X 1.5' B.I.

TBM - CEMENT ON
BULKHEAD



SCALE: 1" = 20' - 00"

PLAN SHOWING SEWAGE DISPOSAL SYSTEM
(REPAIR)
CLIENT: KIM TOWNSEND
15 SOUTH ORCHARD DRIVE
AMHERST, MA 01002
DATE: 5/2/89
BY: FILIOS ENTERPRISES, INC.
69 PELHAM ROAD
AMHERST, MA 01002
SITE: SAME AS ABOVE
REVISION

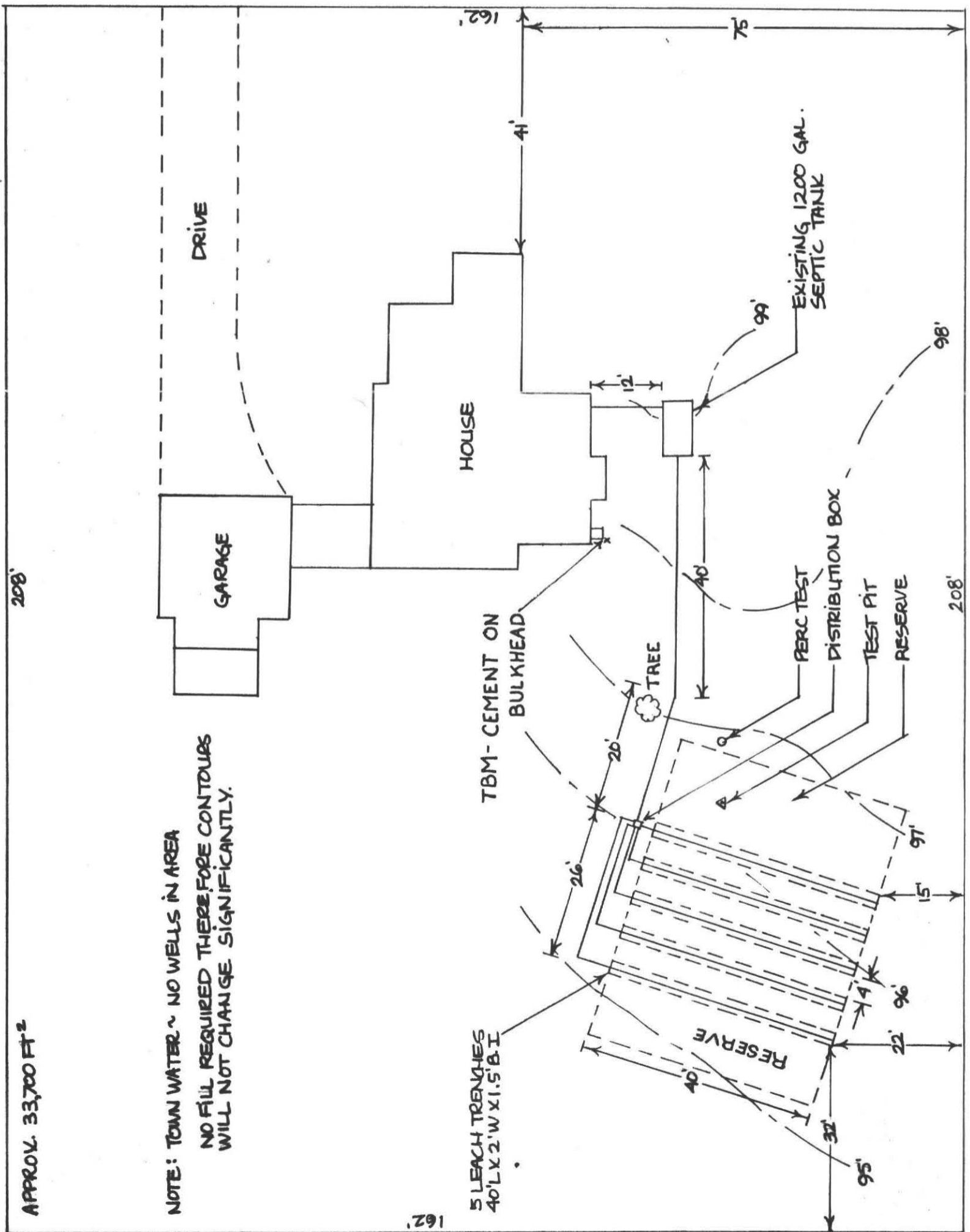

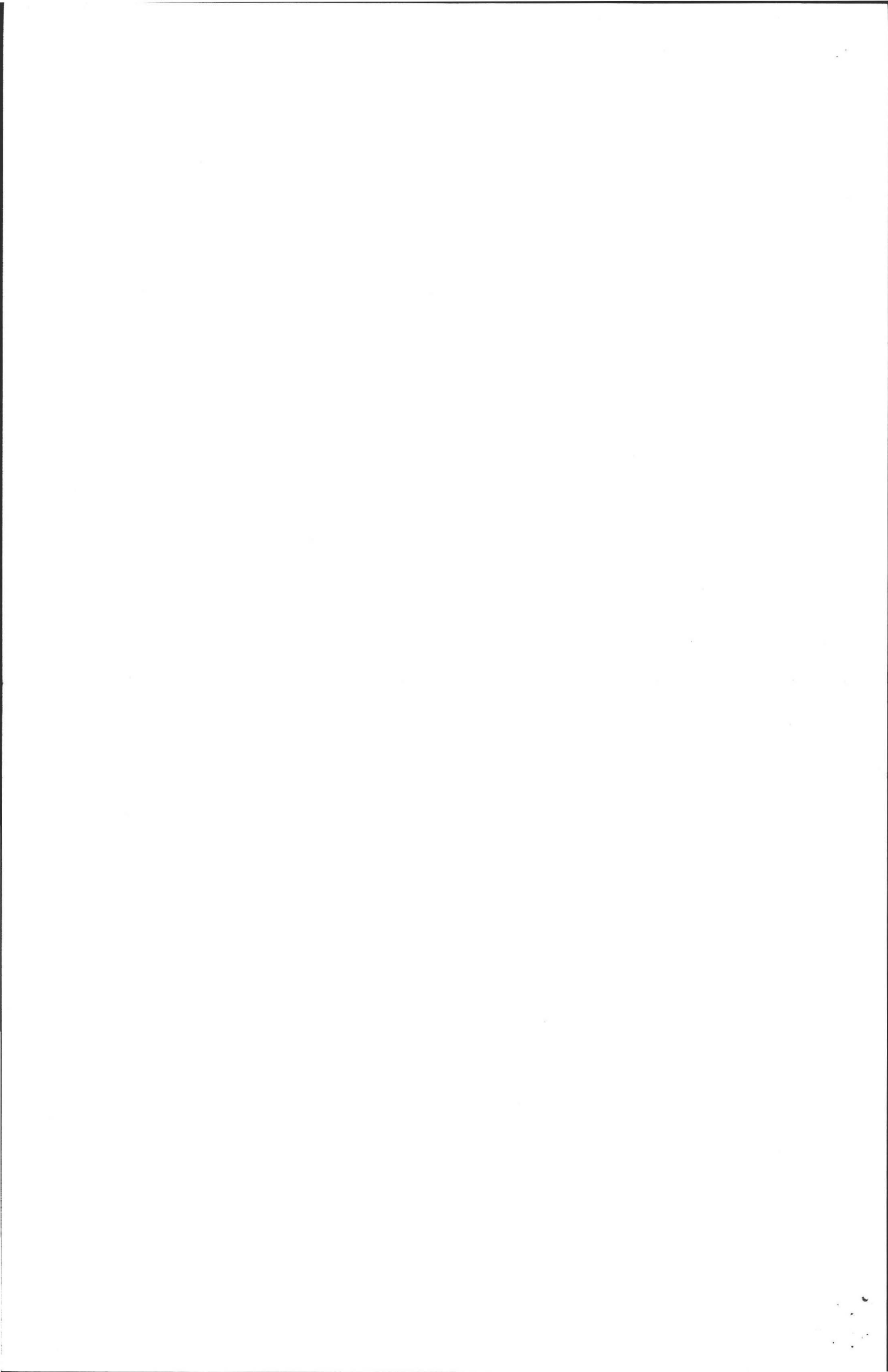

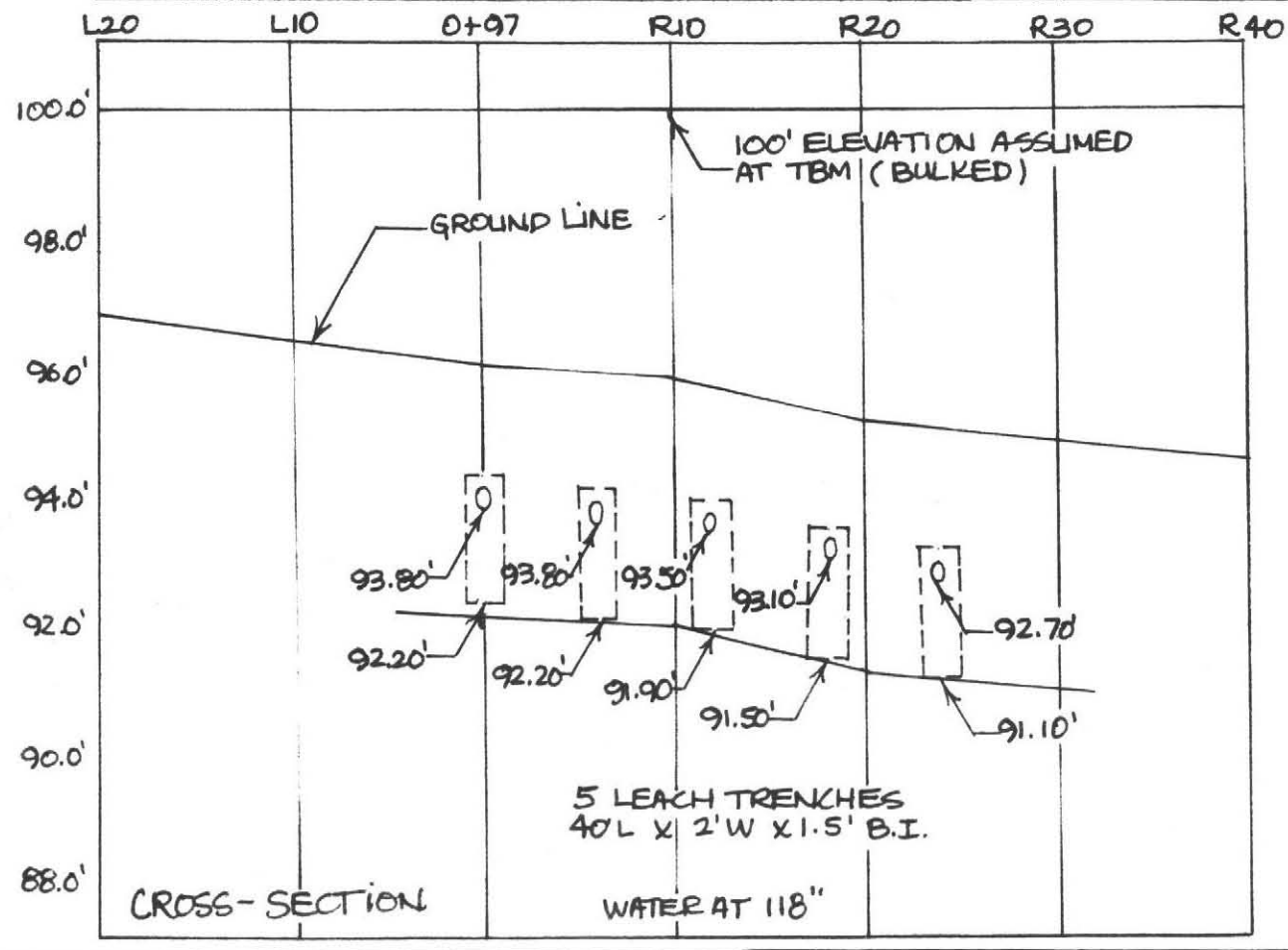
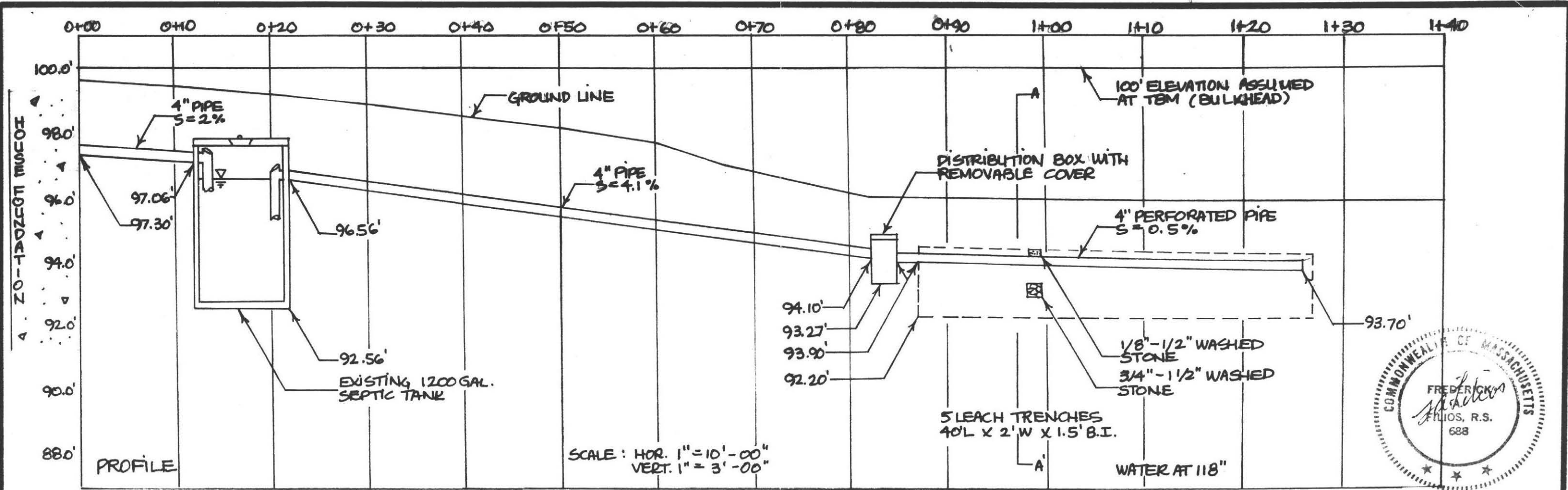

CALCULATIONS

PERCOLATION RATE : 15 MIN/INCH
 4 BDRMS X 110 GAL/BDRM X 1.25 = 550
 NOTE: DISPOSAL DISCONTINUED
 SIDEWALL : 0.66 BOTTOM : 0.43

5 LEACH TRENCHES 40'L X 2' W X 1.5' B.

SIDEWALL : (40' X 1.5') 10 X 0.66 = 396
 BOTTOM : (40' X 2') 5 X 0.43 = 172

TOTAL GAL. SUPPLIED 568

CONSTRUCTION NOTES

1. SEPTIC TANK SHOULD BE PUMPED AND INSPECTED
2. INLET AND OUTLET TEE OF THE SEPTIC TANK SHOULD EXTEND 10" AND 14" BELOW FLOW LINE RESPECTIVELY.
3. PIPE EXITING THE DISTRIBUTION BOX SHOULD REMAIN LEVEL FOR 2'
4. TOPSOIL SHOULD BE REMOVED TO A DISTANCE OF 10' IF FILL IS TO BE USED.

SPECIFICATIONS

ALL MATERIALS AND CONSTRUCTION MUST BE IN ACCORDANCE WITH COMMONWEALTH OF MA D.E.Q.E. STATE ENVIRONMENTAL CODE TITLE 5.

PROFILE & CROSS-SECTION OF SEPTIC SYSTEM (REPAIR)

CLIENT : KIM TOWNSEND
 15 SOUTH ORCHARD DRIVE
 AMHERST, MA 01002

BY : FILIOS ENTERPRISES, INC. D. LA BELLE
 69 PELHAM ROAD
 AMHERST, MA 01002

SITE : SAME AS ABOVE
 REVISION

