

No. 87-7

#317



THE COMMONWEALTH OF MASSACHUSETTS

BOARD OF HEALTH

Town OF Amherst

Application for Disposal Works Construction Permit

Application is hereby made for a Permit to Construct (✓) or Repair ( ) an Individual Sewage Disposal System at:

317 Shutesbury Road  
Location - Address  
Fred H Houck  
Owner  
LA VALLEY & SONS  
Installer  
12?  
or Lot No.  
38 Maplewood Cr., Amherst, MA  
Address  
541 Ryan Rd. Florence  
Address

Type of Building  
Dwelling - No. of Bedrooms 4 Expansion Attic ( ) Garbage Grinder (no)  
Other - Type of Building No. of persons Showers ( ) - Cafeteria ( )  
Other fixtures

Design Flow 5.5 gallons per person per day. Total daily flow 440 gallons.  
Septic Tank ✓ Liquid capacity 1000 gallons Length 8.5' Width 5' Diameter Depth 5'4"  
Disposal Trench - No. 3 Width 2' Total Length 150 Total leaching area 150 sq. ft. Sides  
Seepage Pit No. Diameter Depth below inlet Total leaching area 300 sq. ft. Bottom  
Other Distribution box (✓) Dosing tank ( )  
Percolation Test Results Performed by F.A. Filios Date  
Test Pit No. 1 4 minutes per inch Depth of Test Pit 10' Depth to ground water 8'  
Test Pit No. 2 minutes per inch Depth of Test Pit Depth to ground water

Description of Soil Attached - May Consider 1500 Gallon Septic Tank  
TRENCH WIDTH MAY BE INCREASED TO 3' TO GIVE ADDED SQUARE  
FOOTAGE AND CAPACITY FOR GARAGE DISPOSAL IF INSTALLED  
Nature of Repairs or Alterations - Answer when applicable

Agreement:  
The undersigned agrees to install the aforescribed Individual Sewage Disposal System in accordance with the provisions of TITLE 5 of the State Sanitary Code - The undersigned further agrees not to place the system in operation until a Certificate of Compliance has been issued by the board of health.

Signed Fred H Houck Date 2/27/87  
Application Approved By [Signature] Date 3-2-87  
Application Disapproved for the following reasons:

Permit No. 87-7 Issued 3-2-87 Date

THE COMMONWEALTH OF MASSACHUSETTS

BOARD OF HEALTH

Town OF Amherst

Certificate of Compliance

THIS IS TO CERTIFY, That the Individual Sewage Disposal System constructed ( ) or Repaired ( )  
by La Valley & Sons  
at Shutesbury Road Amherst Installer  
has been installed in accordance with the provisions of TITLE 5 of The State Sanitary Code as described in the application for Disposal Works Construction Permit No. 87-7 dated 03.02.87

THE ISSUANCE OF THIS CERTIFICATE SHALL NOT BE CONSTRUED AS A GUARANTEE THAT THE SYSTEM WILL FUNCTION SATISFACTORY.  
DATE 09.11.87 Inspector Walter Lowler, R.S.

THE COMMONWEALTH OF MASSACHUSETTS

BOARD OF HEALTH

Town OF Amherst

Disposal Works Construction Permit

Permission is hereby granted Fred Houck - LA VALLEY & SONS  
to Construct (X) or Repair ( ) an Individual Sewage Disposal System  
at No. lot 12 SHUTESBURY Street  
as shown on the application for Disposal Works Construction Permit No. 87-7 Dated 3-2-87

DATE 3-2-87 Board of Health [Signature] 0987

CHECK OR FILL IN WHERE APPLICABLE

90

7-18

1-1-1

2

# DEEP SOIL LOGS

OWNER W. D. COWLS, INC.

Date DEC 4, 1984

LOCATION SHUTESBURY ROAD

OBSERVER F. A. FILIOS

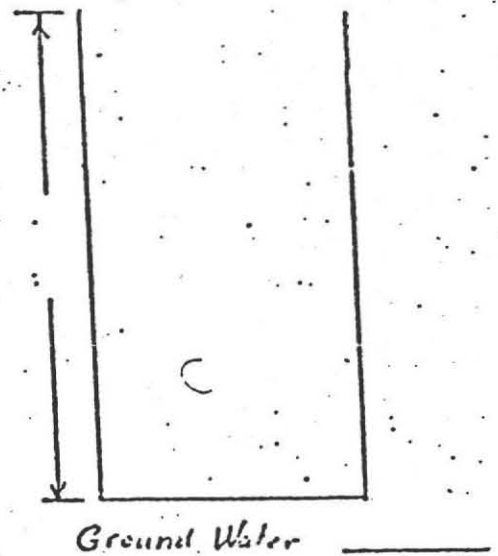
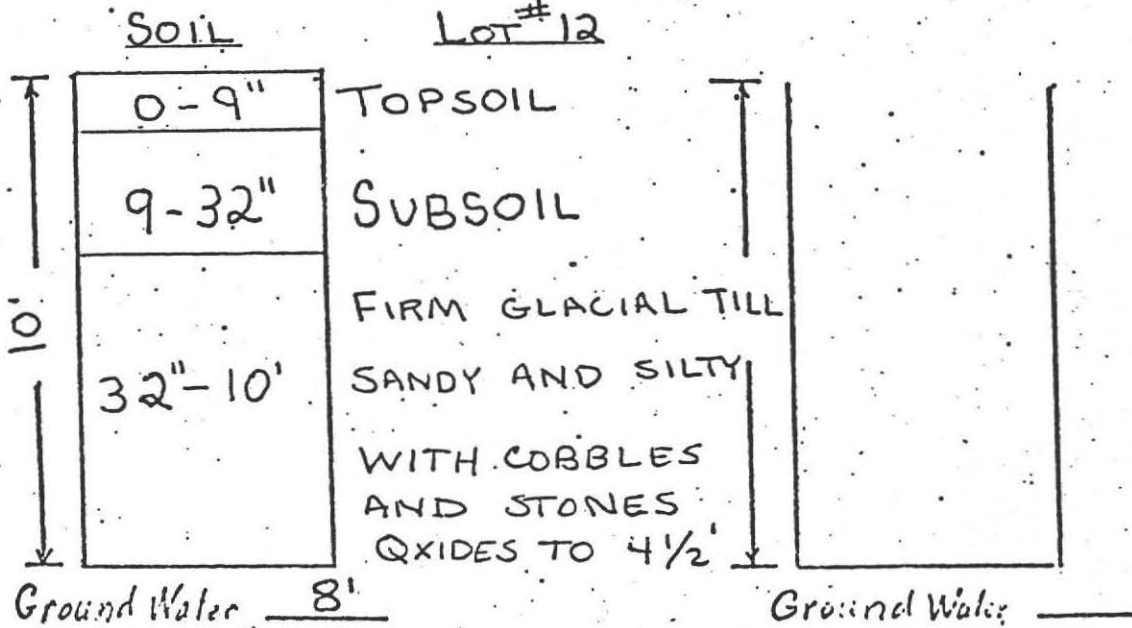

*Certain Drain  
needed*

PERCOLATION RATE AT 28"  
3 MINUTES / INCH



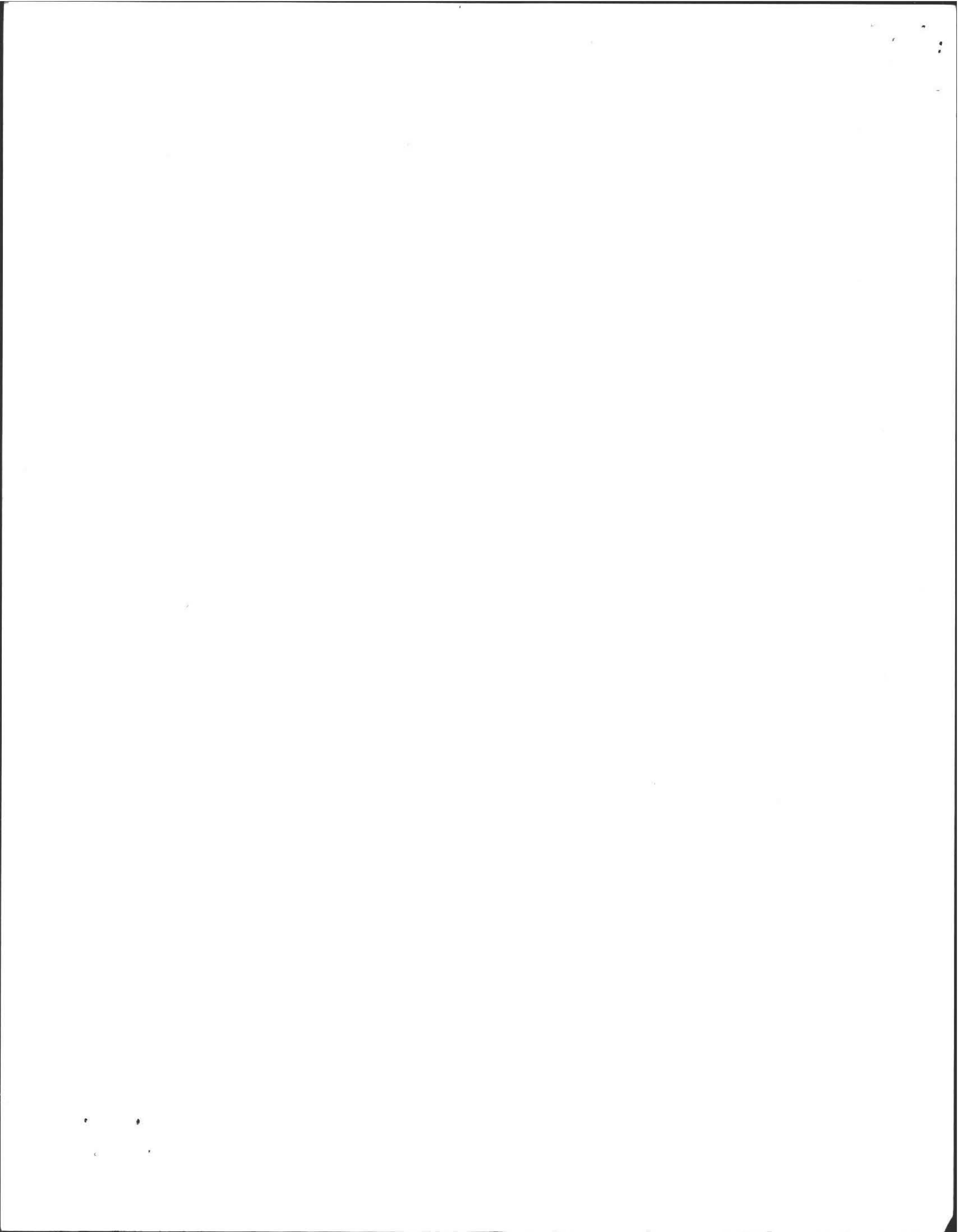

# PLAN. SHOWING SEWAGE DISPOSAL SYSTEM

FOR: Fred Houck  
 38 Maplewood Circle  
 Amherst, MA 01002

SITE: Lot 52  
 Shutesbury Rd, Amherst, MA.

BY: F.A. Filios  
 69 Pelham Road  
 Amherst, MA

SCALE: 1" = 40'

DATE: January 22, 1987  
 R.W.S.

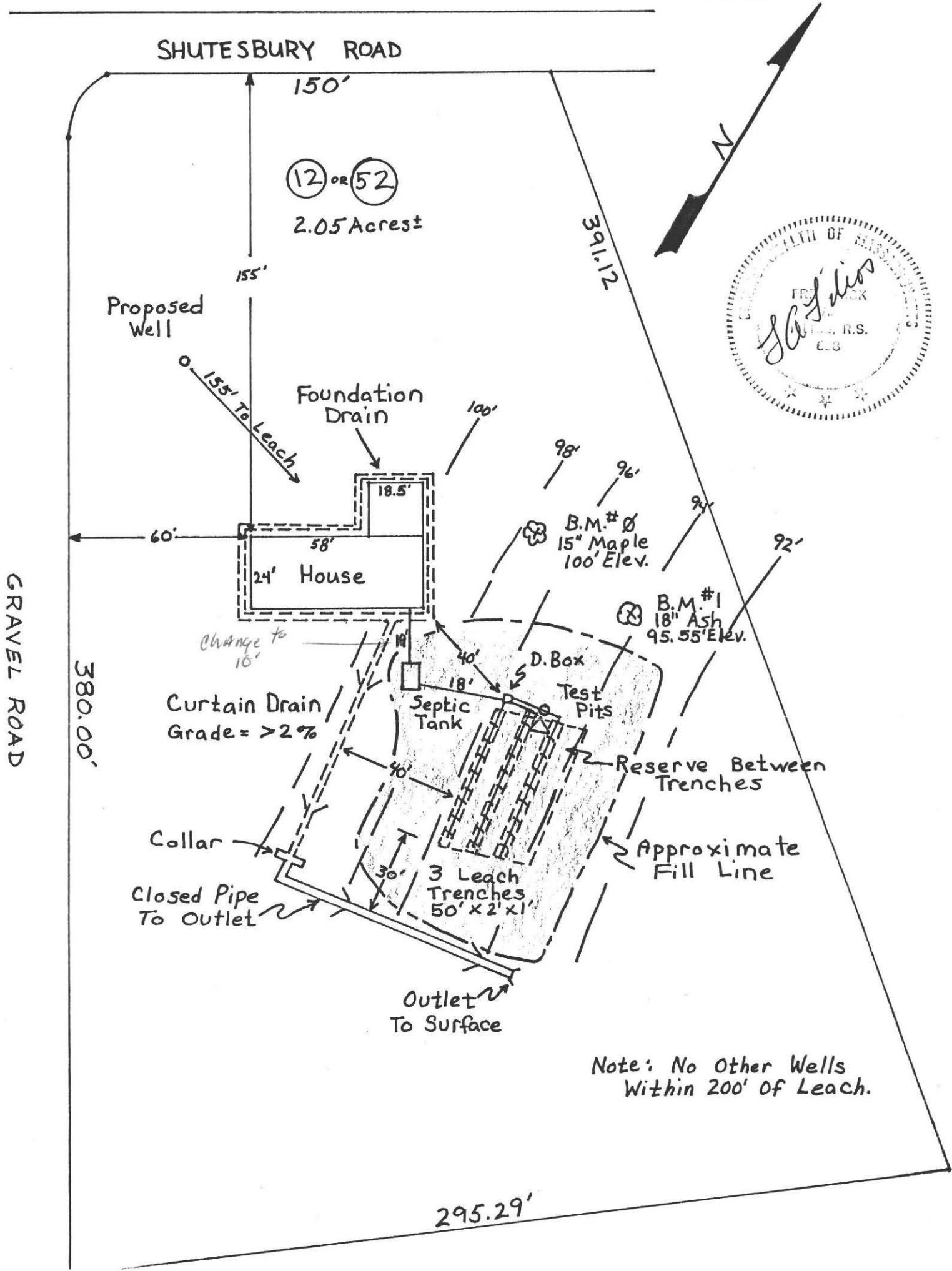

Note: No Other Wells  
 Within 200' of Leach.

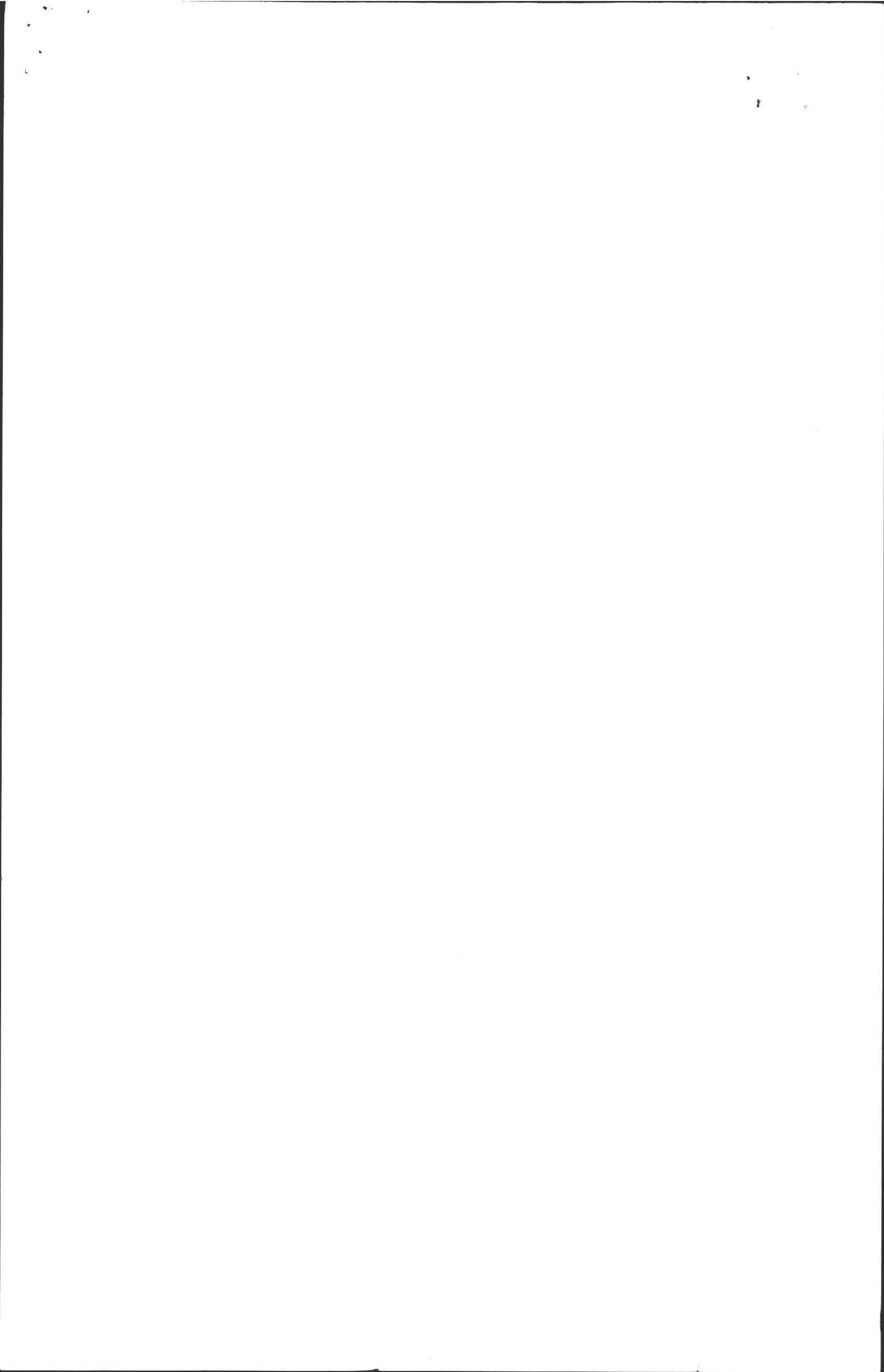

# PROFILE OF SEPTIC SYSTEM

For: Frederick Houck  
38 Maplewood Circle  
Amherst, MA 01002

By: Frederick A. Filios  
January 20, 1987  
Site: Lot 52, Shutesbury Rd.

Scale: Horizontal: 1" = 10'  
Vertical: 1" = 3'

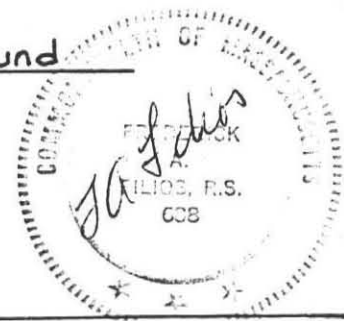
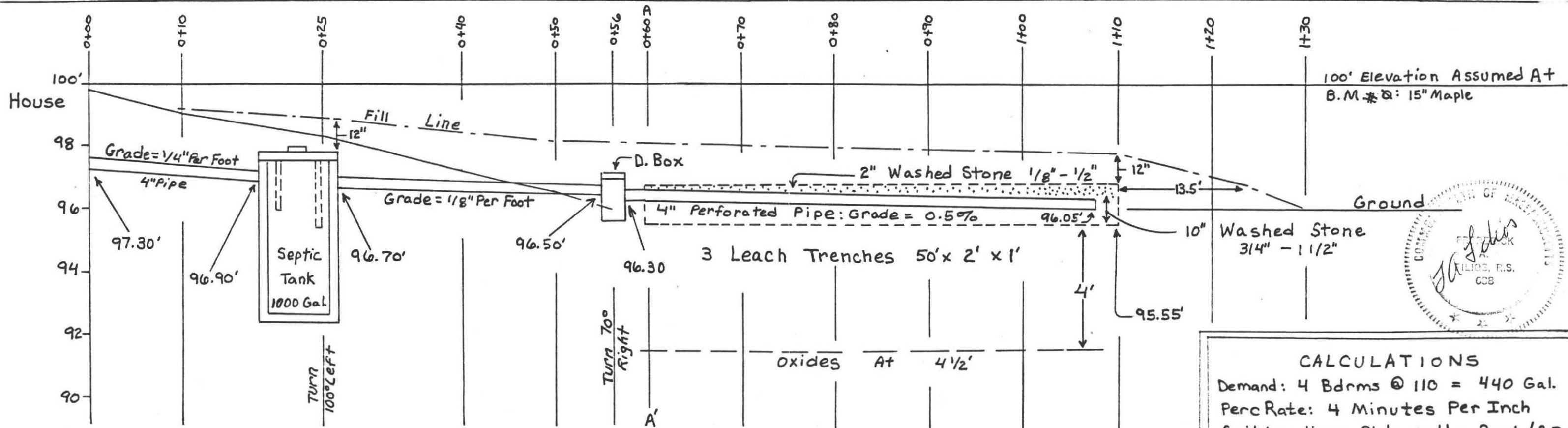

CROSS-SECTION OF LEACH TRENCHES AT A-A' (0+60)

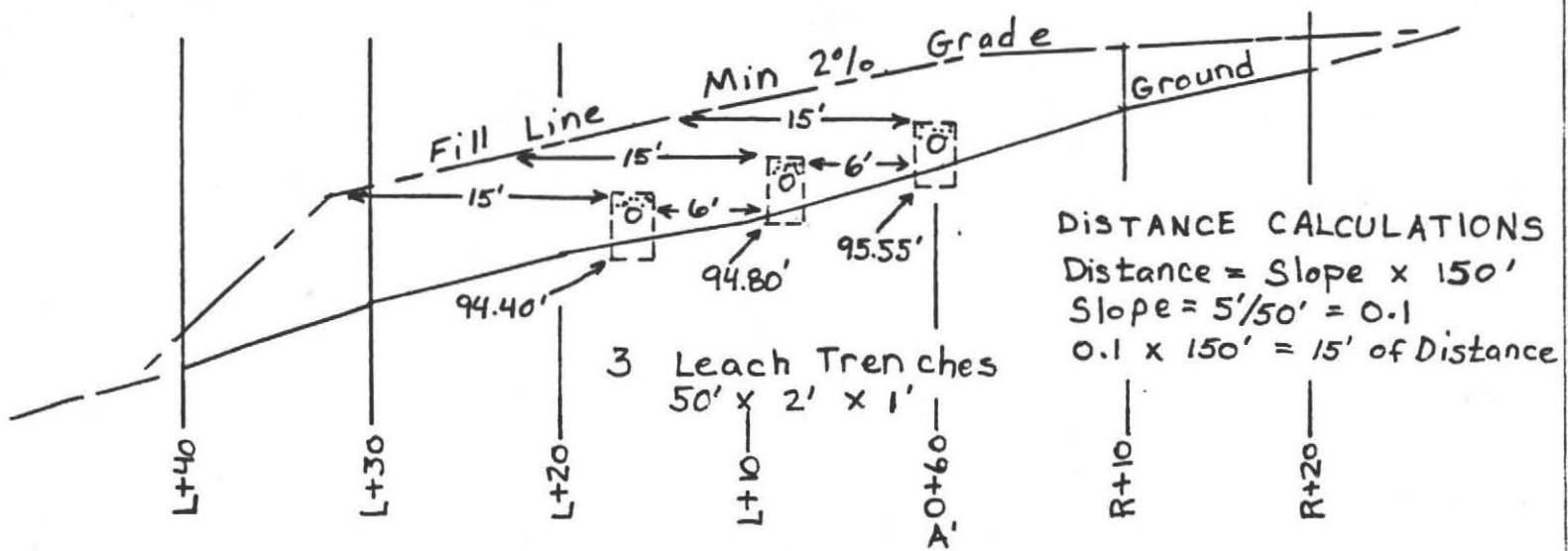

DISTANCE CALCULATIONS  
Distance = Slope x 150'  
Slope = 5'/50' = 0.1  
0.1 x 150' = 15' of Distance

CROSS-SECTION CURTAIN DRAIN

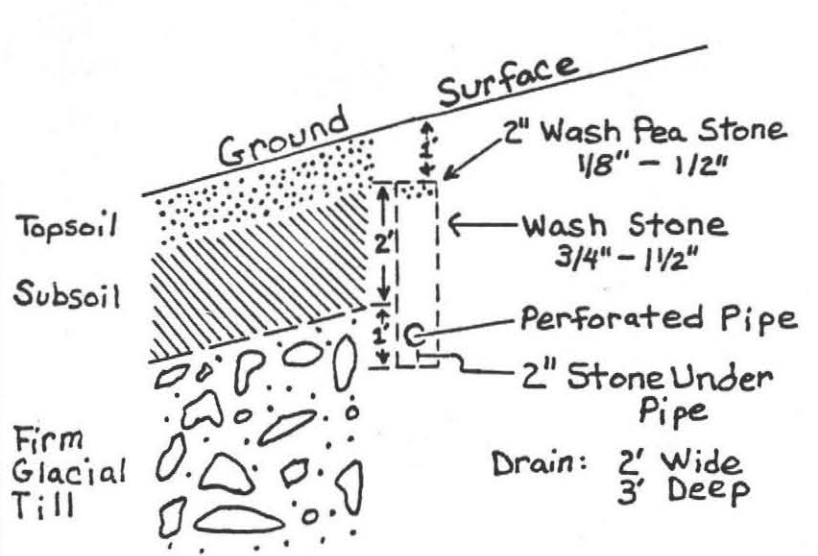

**CALCULATIONS**  
Demand: 4 Bdrms @ 110 = 440 Gal.  
Perc Rate: 4 Minutes Per Inch  
Soil Loading: Side wall = 2 gal./S.F.  
Bottom Area = 0.83 gal./S.F.  
3 Leach Trenches: 50' X 2' X 1'  
Sides: (50' X 1') 3 = 150 S.F. x 2 = 300 Gal.  
Bottom: (50' X 2') 3 = 300 S.F. X 0.83 = 249 Gal.  
Total Available Capacity: 549 Gal.

**SPECIFICATIONS**  
All Materials And Construction Will Be In Accordance with Com. of Mass. D.E.Q.E. State Environmental Code Title 5.  
R.W.S.

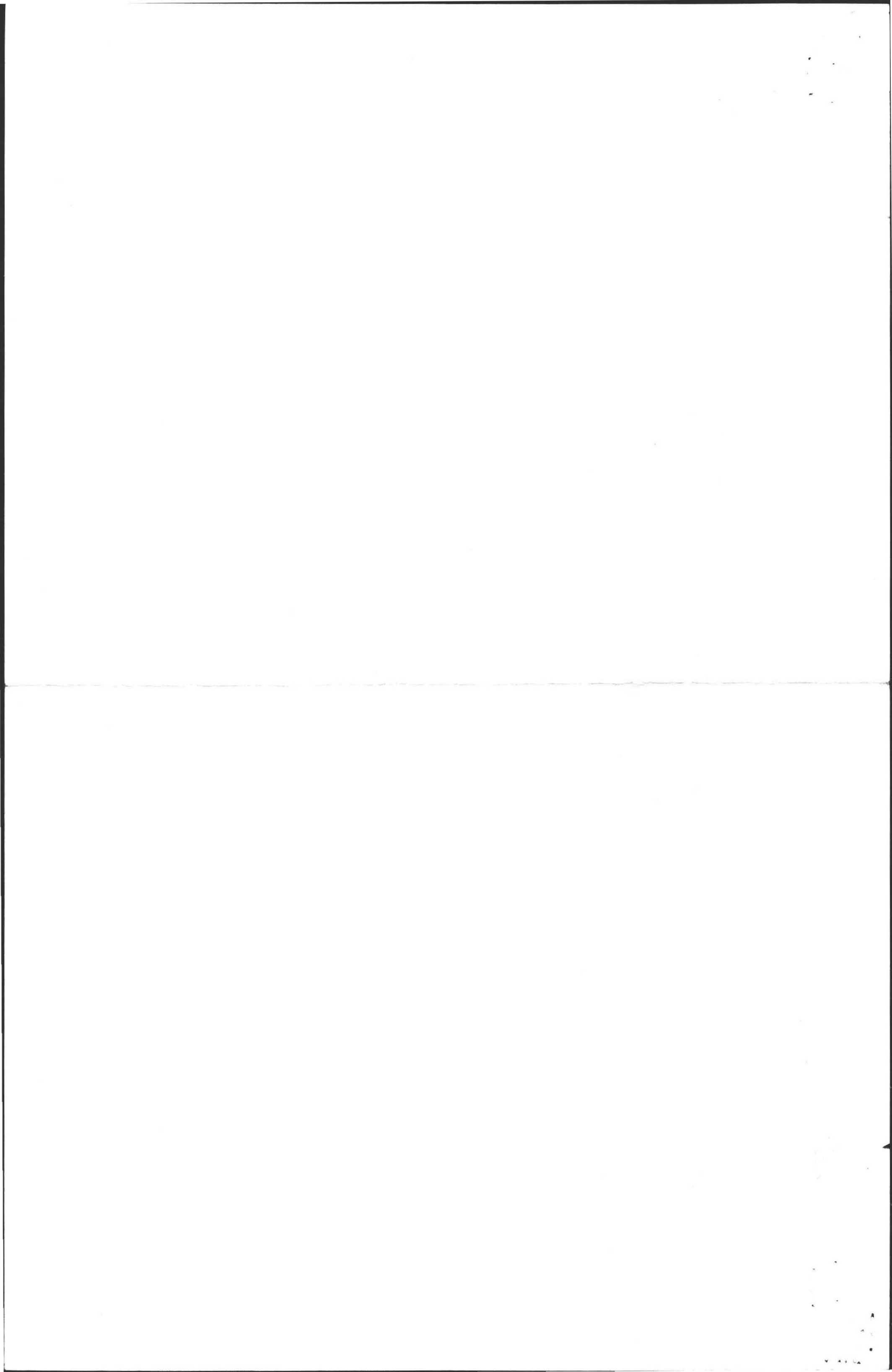



12/8/00

Fred & Sarah Houck  
317 Shutesbury Road  
Amherst, MA 01002

This was our  
Confirmation - on June 13, 2000 -  
that we have a  
1500 gallon Septic tank  
in the ground.

Fred L. Houck

Any questions, please phone me  
at 256-1421

Please add these to our file - Thanks

1911  
1912  
1913

# KARL'S SITE WORK, INC

327 RIVER DRIVE HADLEY, MASSACHUSETTS 01035  
(413)549-5396 FAX (413)549-6115

November 10, 2000

Fred Houck  
317 Shutesbury Road  
Amherst, MA 01002

Dear Mr. Houck;

Please find enclosed a copy of the invoice for pumping of your 1500 gallon septic tank on June 13,2000.

This is to confirm that we did pump 1500 gallons from your system.

If we can be of further assistance to you please do not hesitate to call.

Sincerely,



Cheryl Carey  
Secretary  
Karl's Site Work, Inc

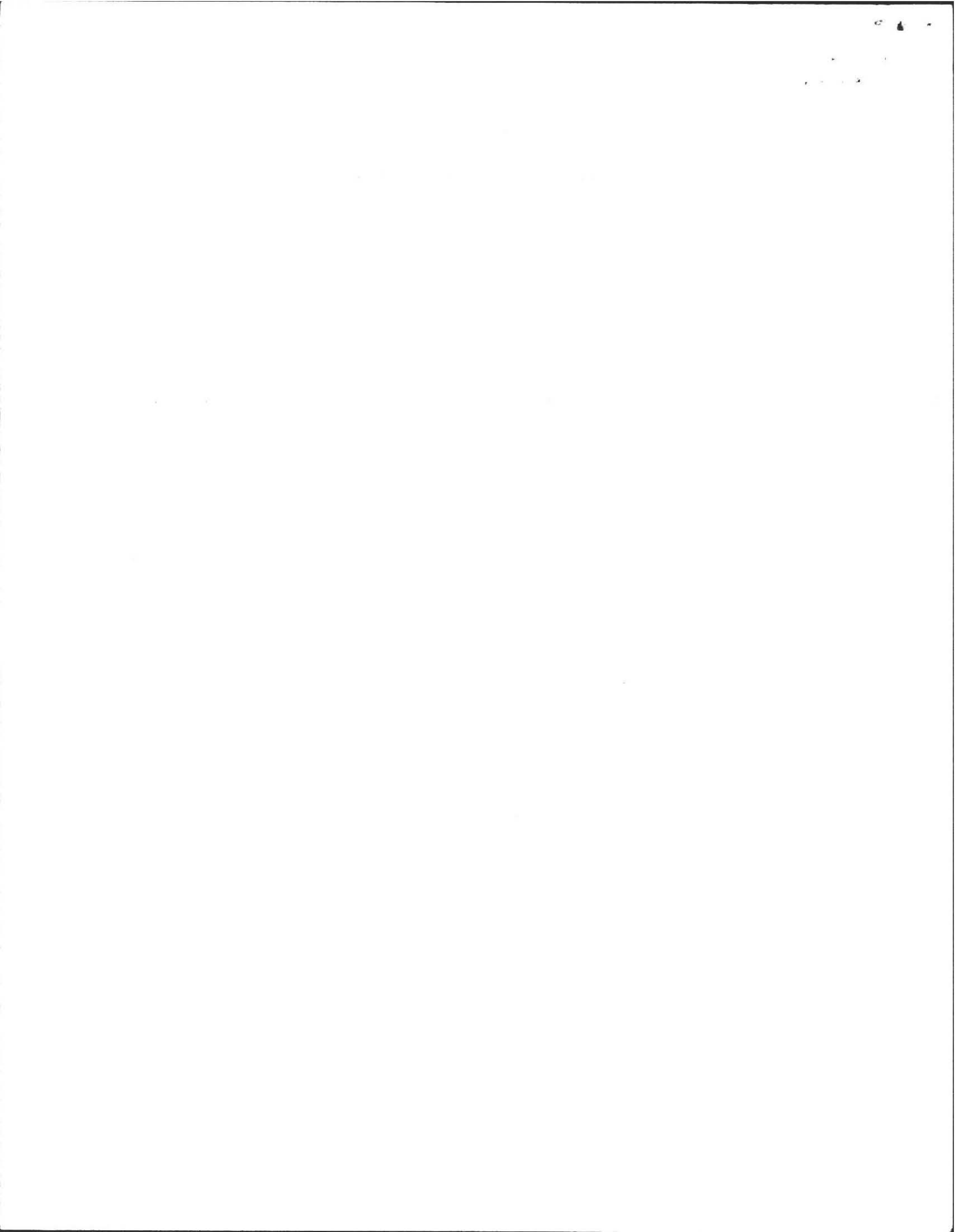

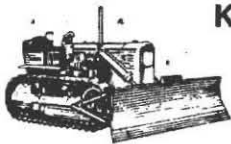

**KARL'S SITE WORK, INC.**

327 RIVER DRIVE  
HADLEY, MA 01035  
(413) 549-5396

DATE	NUMBER
07/01/2000	0000023001

Page: 1

Invoice

To: FRED HOUGH  
317 SHUTESBURY ROAD

**PLEASE PAY FROM  
THIS INVOICE**

AMHERST, MA 01002-

**STATEMENTS WILL NOT  
BE MAILED.**

TERMS: 30 DAYS, 1-1/2% OVER 30 DAYS.

Description	Quantity	Price	Unit	Amount
DISPOSAL FEE 6/13 1500 GAL	1.0000	150.0000	LOAD	150.00
			Tax:	0.00
PUMP & TRANSPORT	1.0000	80.0000	HR	80.00
			Tax:	0.00

Invoice Totals

Gross	230.00
Tax	0.00
Invoice Totals	230.00

WHEN REMITTING PLEASE INCLUDE INVOICE NUMBER ON CHECK.

