

Town of



AMHERST *Massachusetts*

AMHERST HEALTH DEPARTMENT, 70 BOLTWOOD WALK, AMHERST, MA 01002
(413) 256-4077 (VOICE OR TDD)

(413) 256-4033 ENVIRONMENTAL HEALTH SERVICES
(413) 256-4053 (FAX)

To: Bill Start
From: David Zarozinski, Sanitarian
Date: September 11, 2001
Re: Alice Walas, 315 Potwine Lane, Amherst, septic system upgrade

It is my understanding that the Zoning Board of Appeals granted a special permit to Ms Alice Walas, 315 Potwine Lane, Amherst for a converted dwelling for a total of two units on the premises. (application #2 BA FY 2002-0001)

One of the conditions of the permit requires the petitioner to request from the Board of Health septic system approval prior to the issuance of a Certificate of Occupancy for the apartment.

A requirement of Title Five is that the septic system is sized for the number of bedrooms in the house. Therefore: Mrs. Wales septic system would require an upgrade. Upgrading the septic system to meet the new Title Five standards would cause an undue hardship.

In the spring of 2002 the Town of Amherst is going to start a sewer project in the Potwine area. Therefore, it is my opinion that the plumbing for Mrs. Wales new apartment could be connected to her old septic system until the town sewer is accessible.

Sincerely

David Zarozinski
Sanitarian



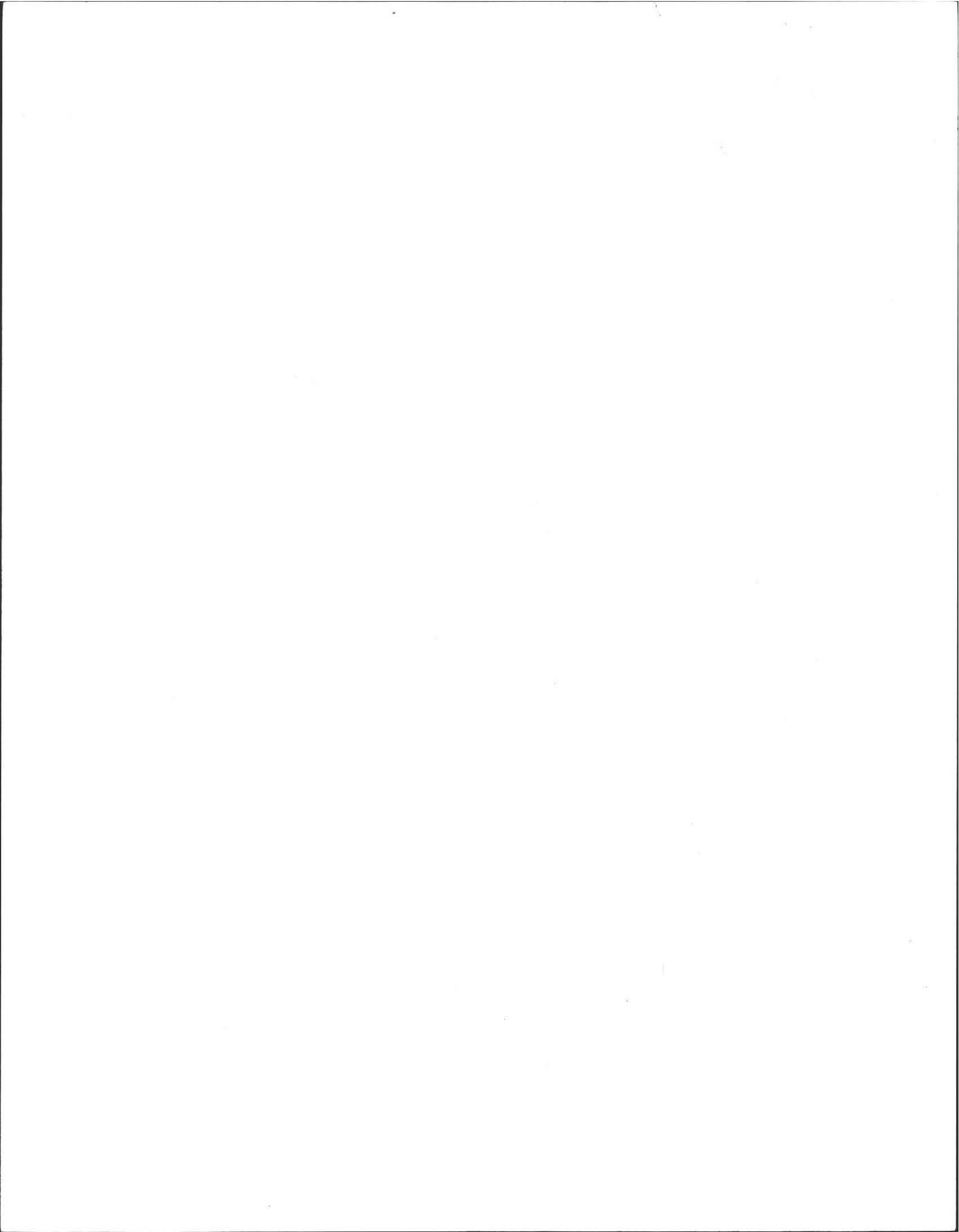



**COLD SPRING ENVIRONMENTAL
CONSULTANTS**

350 Old Enfield Road • Belchertown, MA 01007 • (413) 323-5957
Fax: 323-4916

LETTER OF TRANSMITTAL

DEP# 94-251

DATE 5/16/95	JOB NO. 94-404
ATTENTION	
RE: DEP Transmittal 58599	
MANDLE PROP.	
POTWINE LA.	
AMHERST	

MR. LARRY GALONILA
TO MASSACHUSETTS DEP

GENTLEMEN:

- WE ARE SENDING YOU Attached Under separate cover via _____ the following items:
- Boring Logs Prints Plans Samples Specifications
- Copy of letter Change order Analytical Lab Results Training/Seminar Manuals

COPIES	DATE	NO.	DESCRIPTION
1	5/25/95	1.	AS BUILT PLAN

THESE ARE TRANSMITTED as checked below:

- For approval Approved as submitted Resubmit _____ copies for approval
- For your use Approved as noted Submit _____ copies for distribution
- As requested Returned for corrections Return _____ corrected prints
- For review and comment _____
- FOR BIDS DUE _____ 19 ____ PRINTS RETURNED AFTER LOAN TO US

REMARKS LARRY,
FOR YOUR RECORDS

COPY TO Amherst Health Dept, Planning Dept
Ms. Mandley

SIGNED: Alca

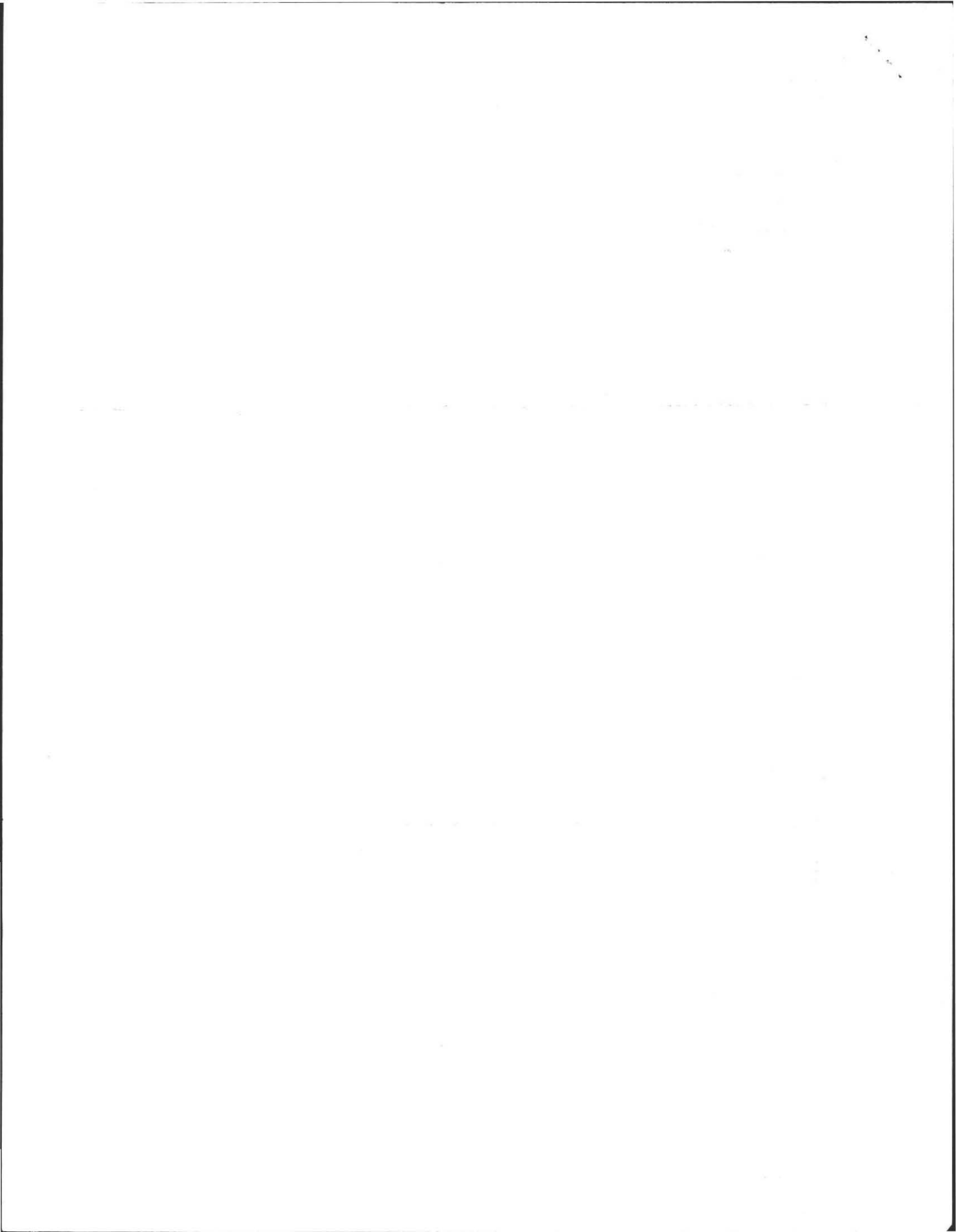

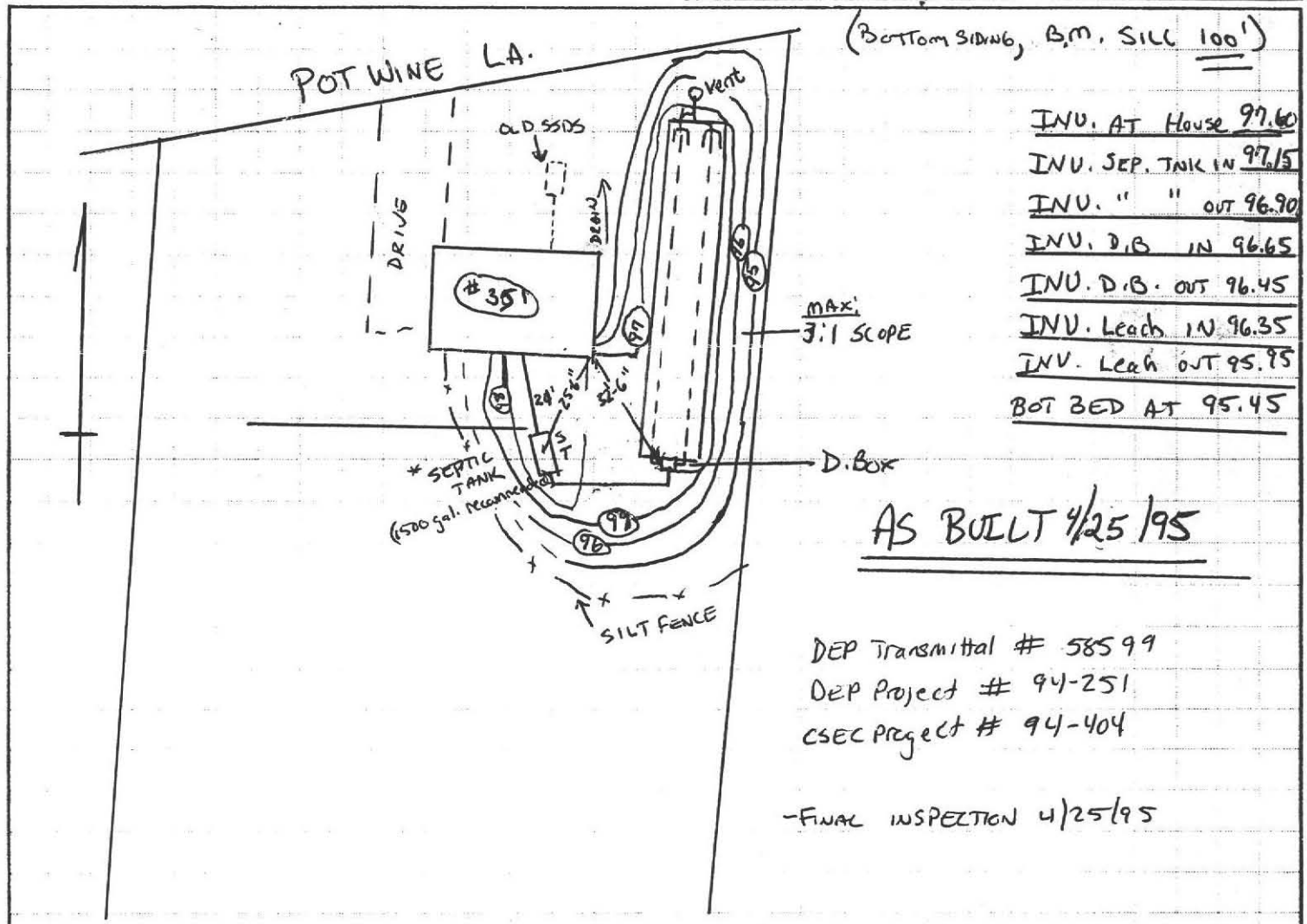

- NOTE: - WITH THIS CHANGE
- PLUMBING COST TO BE LOWER.
 - NO PUMP & CHAMBER NEEDED.
 - MORE FILL REQUIRED IN REAR OF HOUSE
 - MUST ENCLOSE WORK AREA W/ SILT FENCE.
 - BED ELEVATION + LOCATION IS SAME. AS APPROVED.
 - BED PITCH IS TO NORTH.
 - MULCH + SEED AT COMPLETION.

NOTE: PLUMBING AT REAR W/O PUMP COMPLETED AT RECOMMENDATION OF INSTALLER IN ORDER TO ACHIEVE GRAVITY FLOW AND MINIMIZE BASEMENT PLUMBING + CARPENTRY (FINISHED BASEMENT).

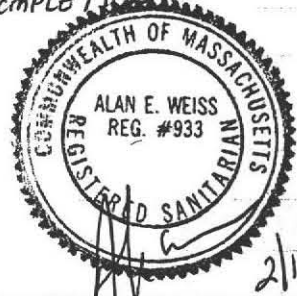

4/25/95

2/14/95

(AW)

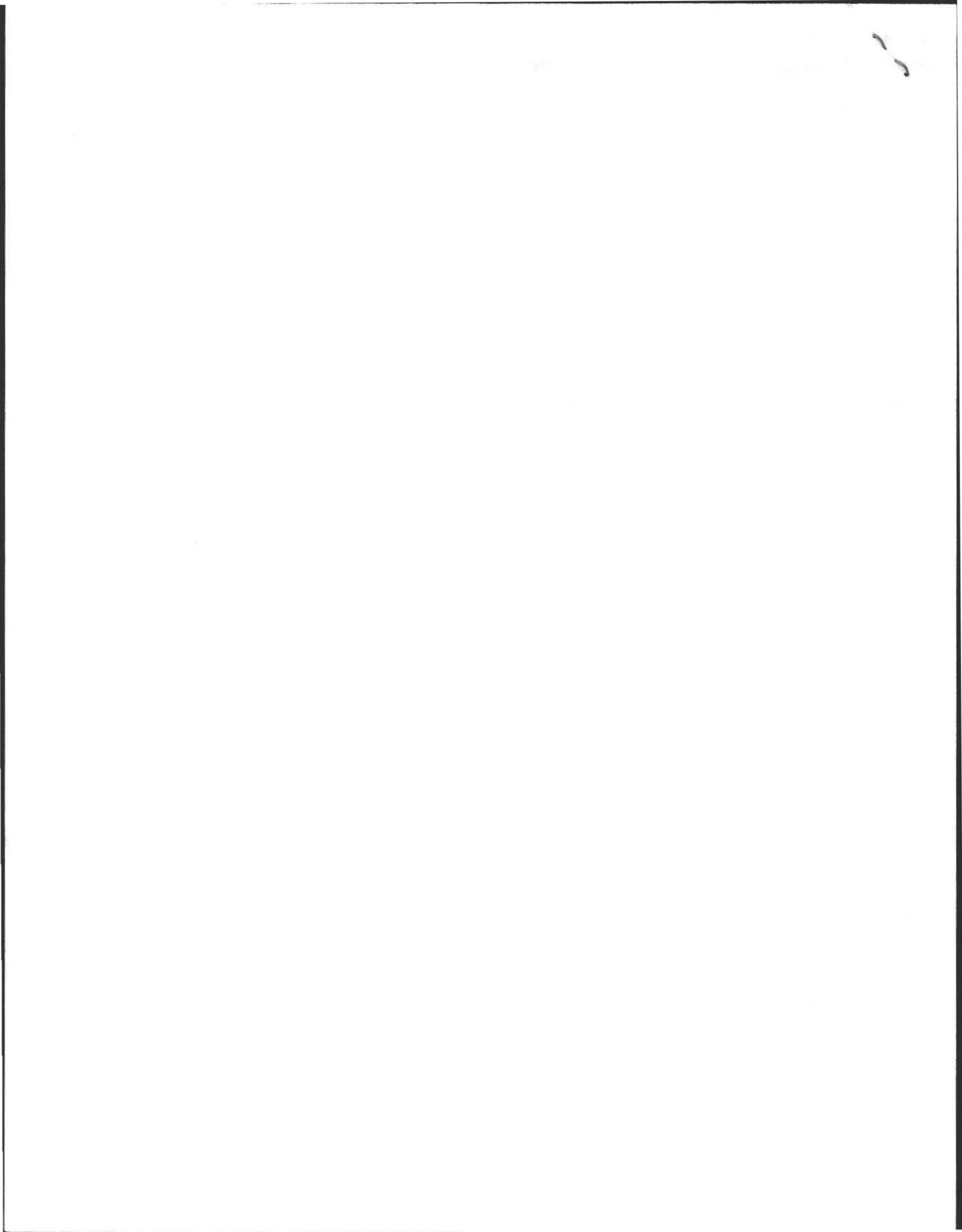

Rec 7/6/95
DJ.

Rob Adair
Potwine Lane
Amherst, MA 01002

July 5, 1995

Dear Rob,

This letter is a follow up to the phone conversation we had on Sunday July 3 regarding water leakage in my basement in the area where your company had conducted excavating work outdoors. I also called you on Tuesday, June 20 and spoke to Sue asking for you to come and inspect my basement for the same problem. I mentioned that since you had done the work each and every time it rained I had quite a bit of water seeping into the basement area from the back outside wall (around the water heater and in back of the sump pump). There had never been a problem with leakage prior to this work being done since I have lived on Potwine Lane.

To my knowledge you did not come by to inspect my basement after my call on the 20th and I called again on the July 3 following a rainstorm over the weekend when I noticed the same problem. This time, the bottom of a new wall in the basement area began to rot because the water mixed in with the drywall at the base of the wall. This is most disturbing to me and I would like the situation rectified immediately before more damage is done.

I am not clear at this point if it is the design of the grade or the execution that is causing the problem. This morning when I spoke with Alan Weiss, the engineer who designed the system, he mentioned that there was sometimes a problem with seepage after a raised system such as mine was constructed. If this is the case, I don't understand why part of the design didn't include precautionary measures in the design, or why your plumbers or town inspectors did not take this into account. At any rate I expect that whoever the responsible party is, will rectify the situation.

Thank you for your immediate attention to this matter.

Sincerely,

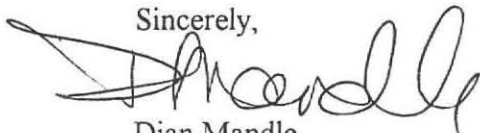

Dian Mandle

cc Alan Weiss
David Zaronsinski
Marleen Leech

