

Johnson / madsen lot Rk 63
Old Montague Rd.



**BOARD OF HEALTH, AMHERST, MASSACHUSETTS
APPLICATION FOR DISPOSAL WORKS CONSTRUCTION PERMIT**

No. 74-38 Date Jun 11, 1974 Fee 3.00 Date Rec'd. 6/11/74 By RGF

Application is hereby made for a permit to Construct () or Repair () an Individual Sewage Disposal System at:

Location—Address JOHNSON ~ MADSEN LOT RTE #63 or Lot No. _____

Owner ANDREW SINAUER Address 21 WATSON RD. BOSTON, MASS.

Contractor JAMES MALANDRINO Address 29 PHOENIX ST. AMHERST, MASS.

Type of Building _____ Dimensions _____ Size Lot _____
 Dwelling—No. of Bedrooms 4 Expansion Attic () Garbage Grinder ()
 Other _____ No. of persons _____ Showers ()

Other fixtures _____
 Town Water? Type of Well _____

Design Flow 50 gallons per person per day. Total daily flow 400 gallons

Septic Tank—Liquid capacity 1200 gallons Dimensions: L. 10'-0" W. 5'-4" D. 4'-10"

Disposal Trench—No. 1 Width 20' Total Length 37' Total leaching area 740 sq. ft.

Disposal Bed—No. _____ Diameter _____ Depth below inlet _____ Total leaching area 7 sq. ft.

Dry Well—No. _____ Diameter _____ Depth below inlet _____ Dimensions: _____ x _____ x _____

Other: Distribution box () No. _____ Dosing tank ()

(Depth of Soil Line Below finished grade at foundation _____)

Percolation Test Results Performed by R. BRAZEAU ~ HUNTLEY ENG'R Date 6/15/74

Test Pit No. 1 7.0 minutes per inch FROM 5'-5" TO 5'-8" Depth of Test Pit 6'-3"

Test Pit No. 2 _____ minutes per inch Depth of Test Pit 8'-0"

Description of Soil 3' OTS, 6" SILT, 12" V. FINE SAND, 1' 6" SAND, GRAVEL, 3'-0" TILL Depth to Ground Water NONE

Will disposal area be filled? TILL Cut down? _____

(On reverse side or separate sheet, show plot plan with building. Include dimensions, distances from all boundaries. Show location of wells, streams, ledge, large trees, etc.)

AGREEMENT: The undersigned agrees to construct the aforescribed individual sewage disposal system in accordance with the provisions of Article XI of the Sanitary Code and regulations of the Amherst Board of Health. The undersigned further agrees not to place the system in operation until a Certificate of Compliance has been issued by this board of health.

Soil Log to Follow CE Drake James Malandrino Owner or builder
 Application Approved by _____ date 6/17/74

Application Disapproved for the following reasons: _____

**BOARD OF HEALTH, AMHERST, MASSACHUSETTS
CERTIFICATE OF COMPLIANCE**

THIS IS TO CERTIFY, That the individual Sewage Disposal System installed () or repaired () by _____ at _____ has been constructed in accordance with the provisions of

INSTALLER
 Article XI of the State Sanitary Code as described in the application for Disposal Works Construction Permit No. _____ dated _____

The issuance of this certificate shall not be construed as a guarantee that the system will function satisfactorily.
 DATE _____ Inspector _____

**BOARD OF HEALTH, AMHERST, MASSACHUSETTS
DISPOSAL WORKS CONSTRUCTION PERMIT**

No. 74-38
 Permission is hereby granted JAMES MALANDRINO to construct () or repair () an Individual Sewage Disposal System at JOHNSON - MADSEN PROP.
 as shown on the application for Disposal Works Construction Permit No. 74-38

This permit is issued with the understanding that future alterations or additions will be made if necessary. This permit shall not be construed as permission to create or maintain any sewage nuisance and in the issuance of this permit the Board of Health assumes no responsibility for the future operation or maintenance of the system.

DATE 6/17/74 CE Drake
 Board of Health

78

reimbursed money

John W. ...

John W. ...

John W. ...

N/F PEDLFORD

216.8

2.0 Act

LEACH FIELD - 20' FROM HOUSE MIN.
- 10' FROM P.E. MIN.
SEPTIC TANK - 10' FROM HOUSE MIN.

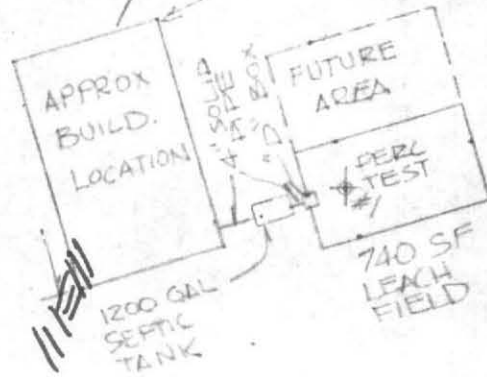

DETAIL LEACHING FIELD

18" MAX 26' O.C.S

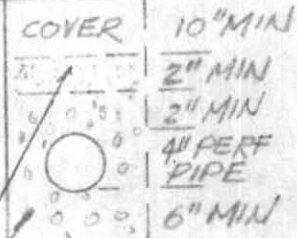

3/4" TO 1 1/2" WASHED STONE
1/8" TO 1/4" WASHED STONE

PLAN OF SEWAGE DISPOSAL SYSTEM ON
A LOT IN AMHEST, MASSACHUSETTS
PREPARED FOR
ANDREW SINAUER

Almer M. Huntley, Jr.

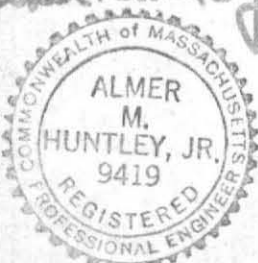

ALMER HUNTLEY, JR. & ASSOCIATES, INC.
REGISTERED LAND SURVEYORS & CIVIL ENGINEERS
125 PLEASANT STREET
NORTHAMPTON, MASS.

DRAWN: RPB
DATE: 6/11/74
SCALE: 1" = 40'

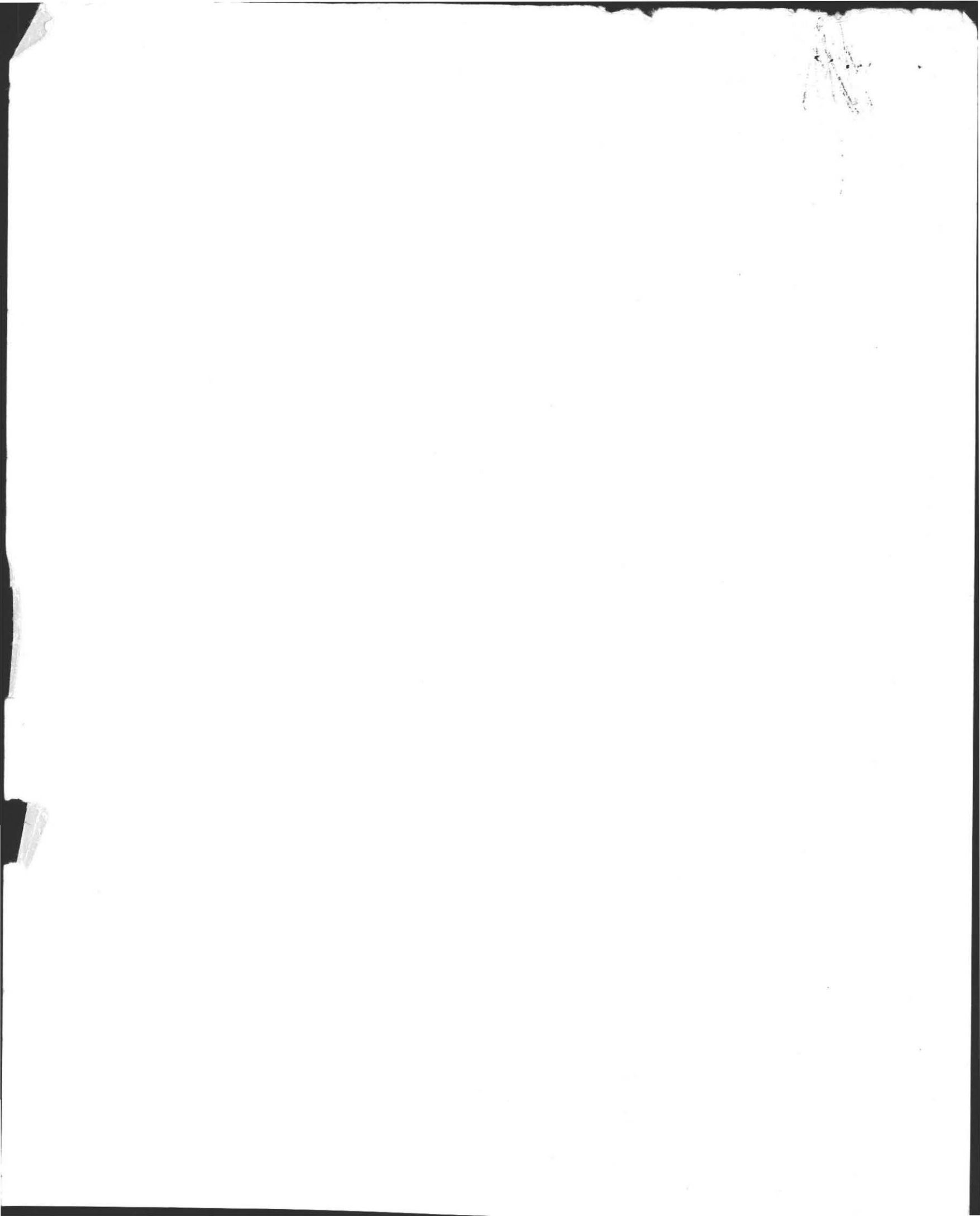

N/F PEDLFORD

216.8

2.0 Act

LEACH FIELD - 20' FROM HOUSE MIN
- 10' FROM FL MIN
SEPTIC TANK - 10' FROM HOUSE MIN



OLD MONTAGUE ROAD

272.6'

DETAIL LEACHING FIELD

18" MAX 26' O.C.S

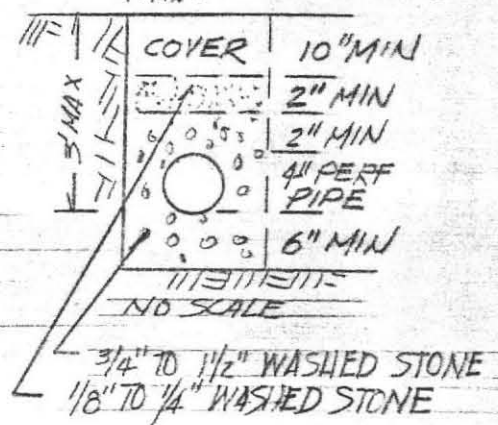

PLAN OF SEWAGE DISPOSAL SYSTEM ON
A LOT IN AMHEST, MASSACHUSETTS
PREPARED FOR
ANDREW SINAUER

Almer Huntley, Jr.

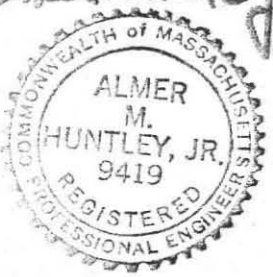

ALMER HUNTLEY, JR. & ASSOCIATES, INC.
 REGISTERED LAND SURVEYORS & CIVIL ENGINEERS
 125 PLEASANT STREET
 NORTHAMPTON, MASS.

DRAWN: RPB
DATE: 6/11/74
SCALE: 1"=40'

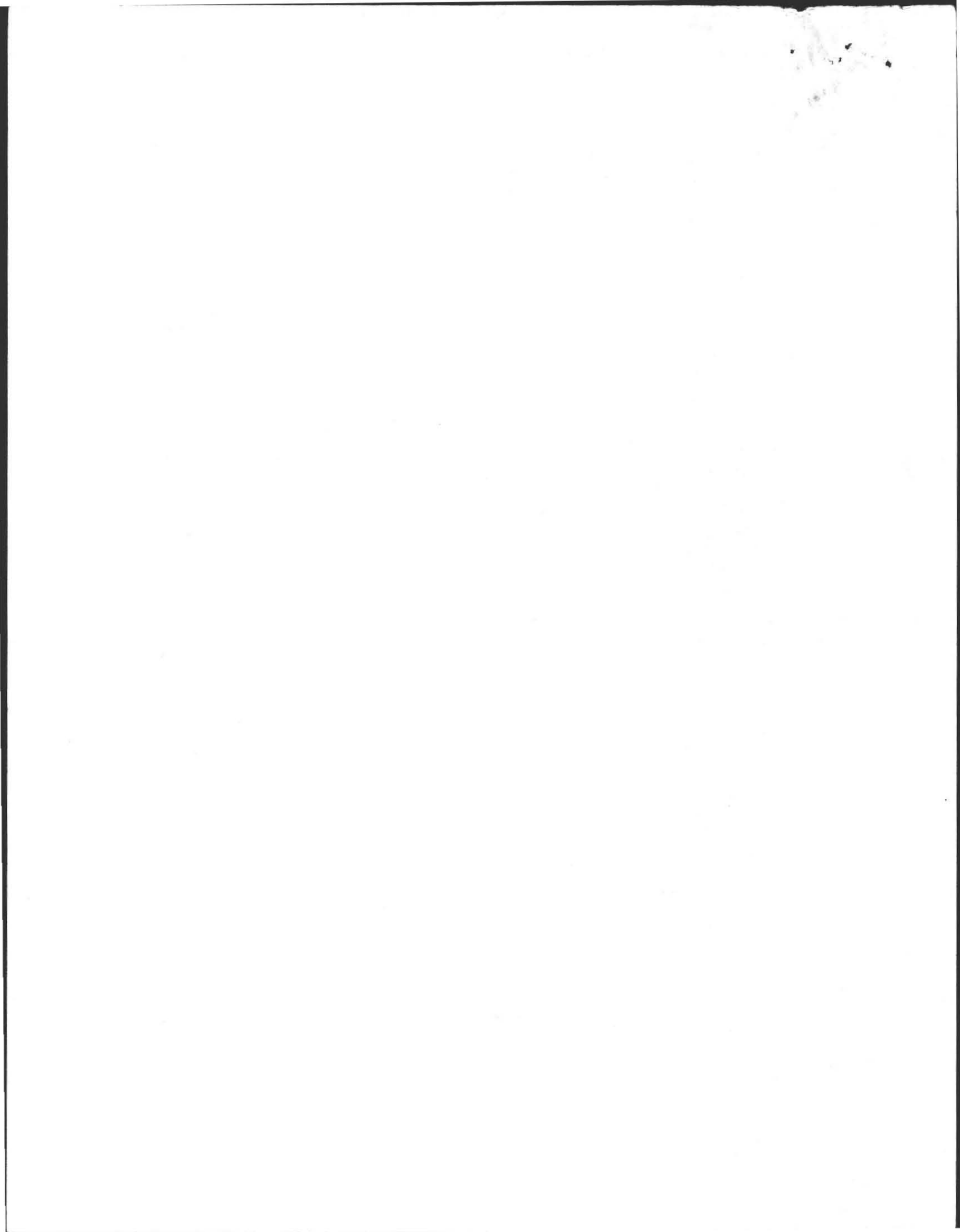

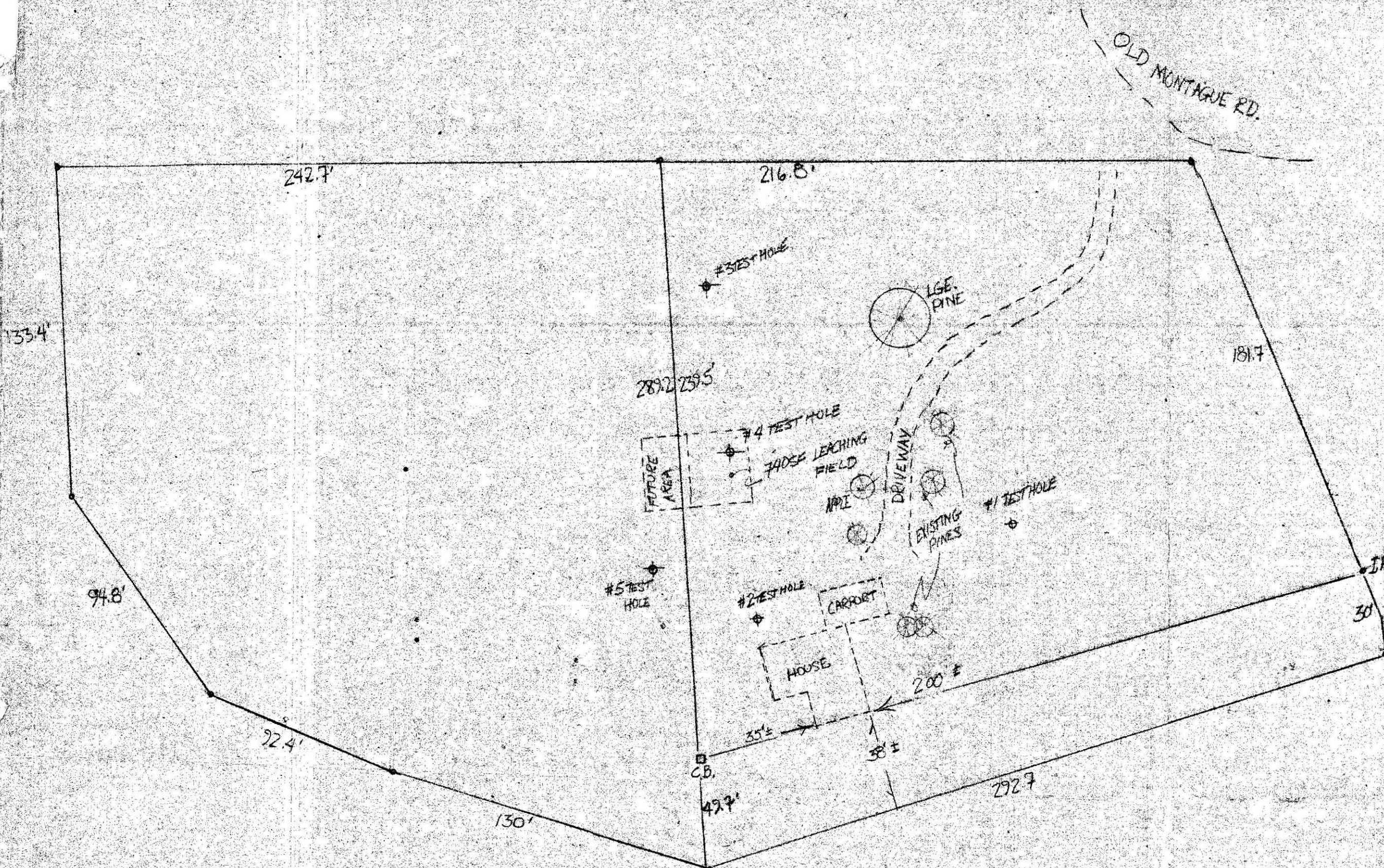

MONTAGUE ROAD
(RT63)

SINAUER RESIDENCE OLD MONTAGUE RD. NORTH AMHERST MA	SITE PLAN	7
J.M. MALANDRINO & CO AMHERST MA		

Karol S. Wisnieski
193 E. Pleasant St
Amherst, MA 01002

June 15, 1974

Almer Huntly, Jr. & Associates, Inc.
125 Pleasant St.
Northampton, Mass.

Re. description of soil for proposed leach field on
site off Old Montague Road to determine presence, or not,
of impervious formations (ledge).

Pit #5 located

as indicated on plat.

Pit #4 located

as indicated on plat.

*No impervious formations to
depth of 8' at pit #4, 7'8" at pit. #5.*

Observation certified by

Karol S. Wisnieski

Karol S. Wisnieski, Chrm.
Amherst Board of Health

COTTON FIBER COM. + 17

APR 15 1954

USA

POSTAGE

PAID



UNITED STATES POSTAL SERVICE

POSTAGE WILL BE PAID BY ADDRESSEE

~~3~~

Top soil:

Silt & sand:

Gravel & sand

Depth

~~4~~

3"

6" silt

2' 9" fine sand

1' 6" -

till.

7'

~~Spec test~~
Perce. 0.6 / inch
2.6 / inch

Breugo

~~45~~

3"

6"

5' 1" fine sand

gravel till

7' 8"

7' 8" No gravel water

69

hugos pool
valley

2.5'

square

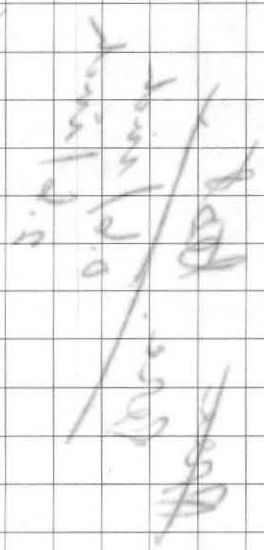

18'

1'

hugos

hugos pool

hugos pool

1'

hugos pool
1.5'

1.5'

hugos pool

hugos pool

1.5'

1.5'

1.5'

hugos pool

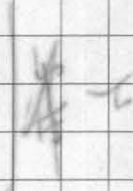

OBSERVATION PITS

REQUESTED BY: MADSON & JOHNSON DATE: 5/25/72
 LOCATION: OLD RTE #63 NORTH AMHERST OBSERVER: J. HART
 MAIL ADDRESS: _____

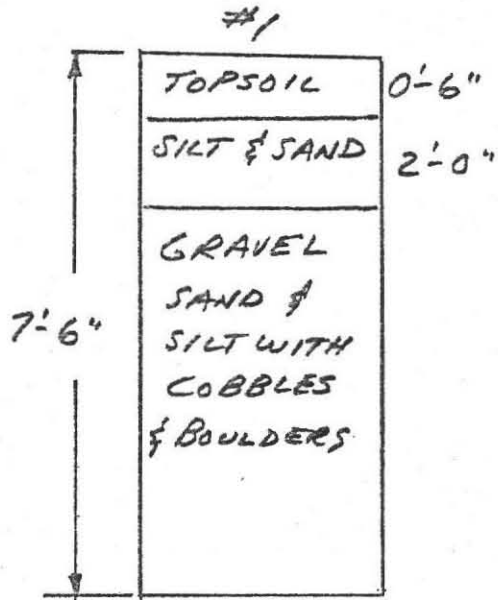

* PERC RATE : 12 MM./IN.

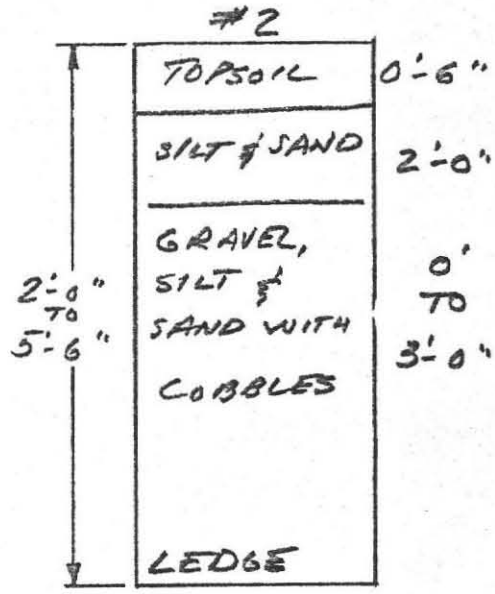

PERC RATE :

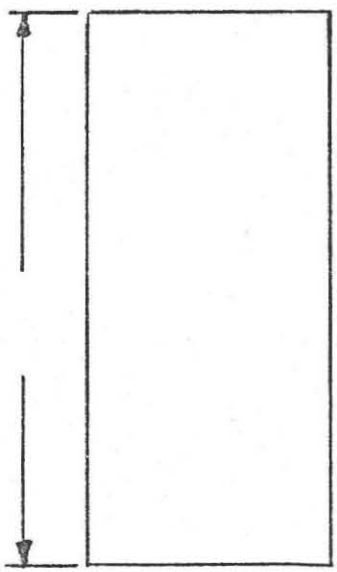

GROUND WATER _____
 PERC RATE :

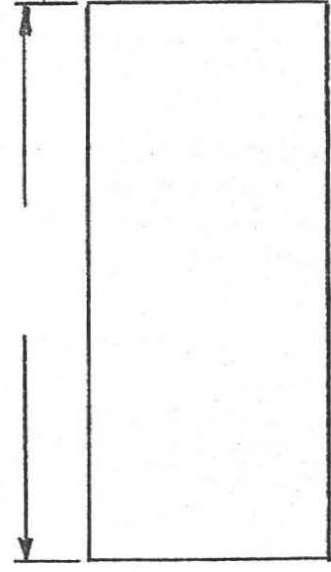

GROUND WATER _____
 PERC RATE :

* OVER
 NIGHT TEST

ALMER HUNTLEY, JR. & ASSOCIATES, INC.
 REGISTERED LAND SURVEYORS & CIVIL ENGINEERS
 238 BRIDGE STREET
 NORTHAMPTON, MASS.

