

88-32
MONTAGUE ROAD Lot 520
(Pending)



No. 88-32

THE COMMONWEALTH OF MASSACHUSETTS

BOARD OF HEALTH

Town of Amherst

Application for Disposal Works Construction Permit

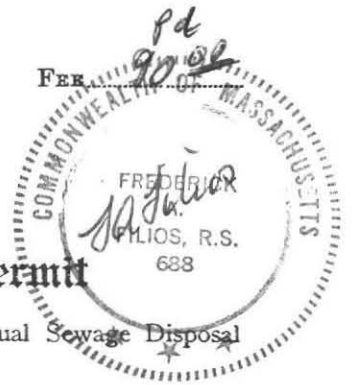

Application is hereby made for a Permit to Construct () or Repair (✓) an Individual Sewage Disposal System at:

Location - Address: Montague Road No. 528
Owner: Bob Wiley
Address: 528 Montague Road
Installer: Rays Excavating

Type of Building: Dwelling - No. of Bedrooms: 4
Expansion Attic ()
Garbage Grinder (NO)
Other - Type of Building:
No. of persons:
Showers () - Cafeteria ()
Other fixtures:

Design Flow: 55 gallons per person per day. Total daily flow: 440 gallons.

*Septic Tank - Liquid capacity: 1000 gallons. Length: 8 1/2'. Width: 5'. Diameter: 5'. Depth: 5'.

Disposal Trench - No.: Width: 7'. Total Length: 16.5'. Total leaching area: 141 sq. ft. Sides

Seepage Pit No.: 1. Diameter: Depth below inlet: 3.0'. Total leaching area: 115.5 sq. ft. Bottom

Other Distribution box () Dosing tank ()

Percolation Test Results Performed by: Elias Enterprises, Inc. Date: 8/15/88

Test Pit No. 1: 2 minutes per inch Depth of Test Pit: 11 1/2' Depth to ground water: NONE

Test Pit No. 2: minutes per inch Depth of Test Pit: Depth to ground water:

Description of Soil: Enclosed

Nature of Repairs or Alterations - Answer when applicable:

Use existing septic tank

Agreement:

The undersigned agrees to install the aforescribed Individual Sewage Disposal System in accordance with the provisions of TITLE 5 of the State Sanitary Code - The undersigned further agrees not to place the system in operation until a Certificate of Compliance has been issued by the board of health.

Signed: Robert J. Wiley Date: Sept. 1, 1988

Application Approved By: D. Pinski Date: 9/19/88

Application Disapproved for the following reasons:

Permit No. Issued Date

THE COMMONWEALTH OF MASSACHUSETTS

BOARD OF HEALTH

Town of Amherst

Certificate of Compliance

THIS IS TO CERTIFY, That the Individual Sewage Disposal System constructed () or Repaired (✓) by Rays Excavating

at 528 Montague Road

has been installed in accordance with the provisions of TITLE 5 of The State Sanitary Code as described in the application for Disposal Works Construction Permit No. dated

THE ISSUANCE OF THIS CERTIFICATE SHALL NOT BE CONSTRUED AS A GUARANTEE THAT THE SYSTEM WILL FUNCTION SATISFACTORY.

DATE Inspector

THE COMMONWEALTH OF MASSACHUSETTS

BOARD OF HEALTH

Town of Amherst

No. 88-32 FEE

Disposal Works Construction Permit

Permission is hereby granted, Bob Wiley to Construct () or Repair (✓) an Individual Sewage Disposal System

at No. 528 Montague Road

as shown on the application for Disposal Works Construction Permit No. 88-32 Dated

DATE 9/19/88 for Bd. of Health: Dennis Pinski Board of Health

CHECK OR FILL IN WHERE APPLICABLE

Town Amherst

258 Montague Road
No. 258

Montague Road
Bob Wiley
Roy's Excavating

440
141
112.2
8/12/88
Bottom

2.0
11/2
Elias Enterprises, Inc.

22
1000
1
2

Enclosed

Use existing sept - tank

Town Amherst

258 Montague Road
Roy's Excavating

Town Amherst

258 Montague Road
Bob Wiley

DEEP SOIL LOGS

OWNER Bob Wiley

DATE AUGUST 15, 1988

LOCATION 528 MONTAGUE RD.
AMHERST, MA.

OBSERVER Filios Enterprises, Inc.

B. of H. DENNIS PINSKI

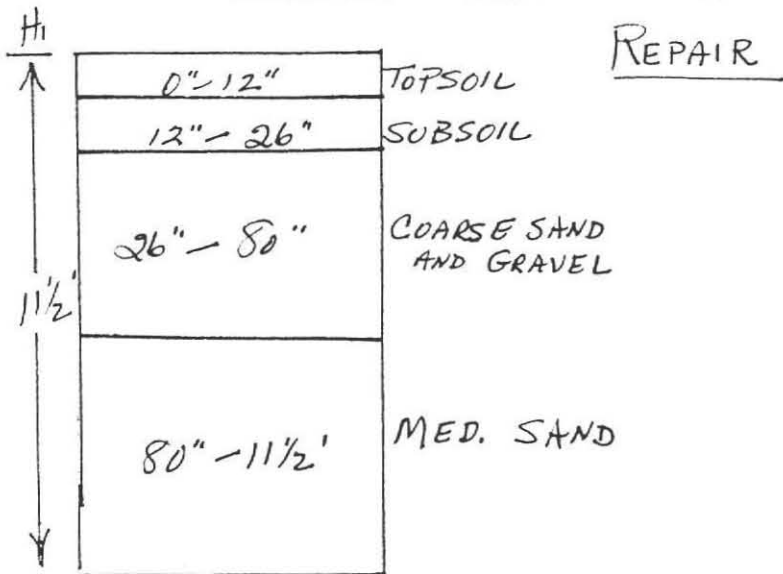

GROUND WATER NONE

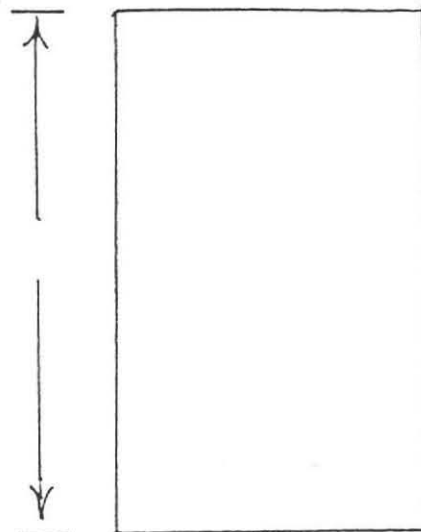

GROUND WATER _____

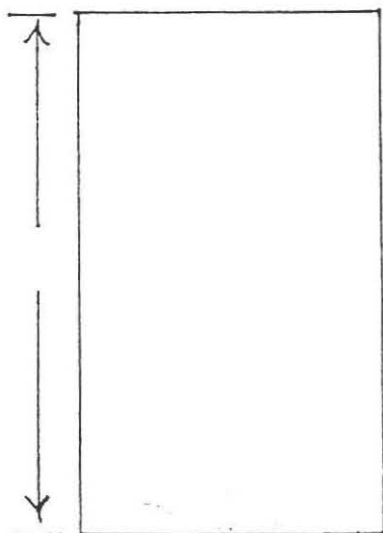

GROUND WATER _____

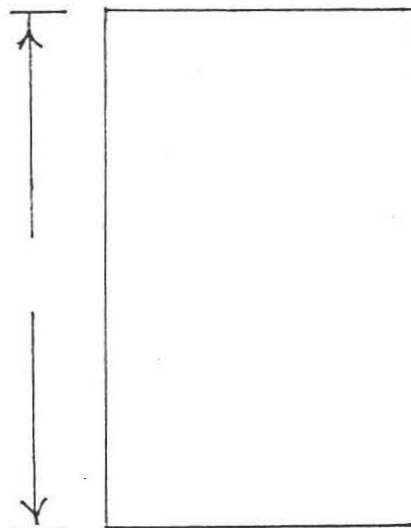

GROUND WATER _____

PERCOLATION RATE AT 48" :
< 2 min./inch



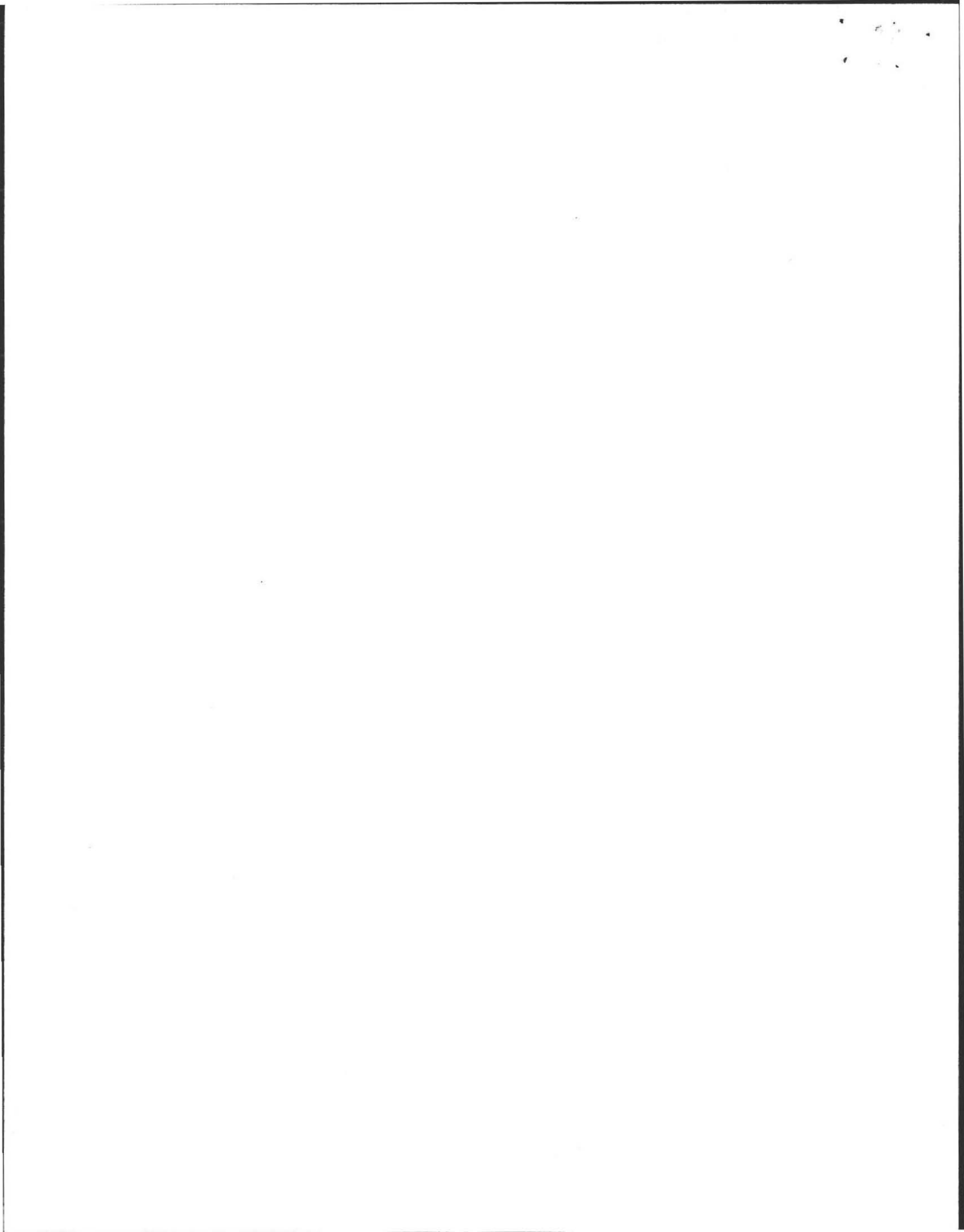

PLAN SHOWING SEWAGE DISPOSAL SYSTEM REPAIR

FOR: Bob Wiley
528 Montogue Rd.
Amherst, MA

BY: Filios Enterprises, Inc.
69 Pelham Road
Amherst, MA
W.T.

AT: 528 Montogue Rd.
Amherst, MA

SCALE: 1" = 40'
DATE: 8/17/88

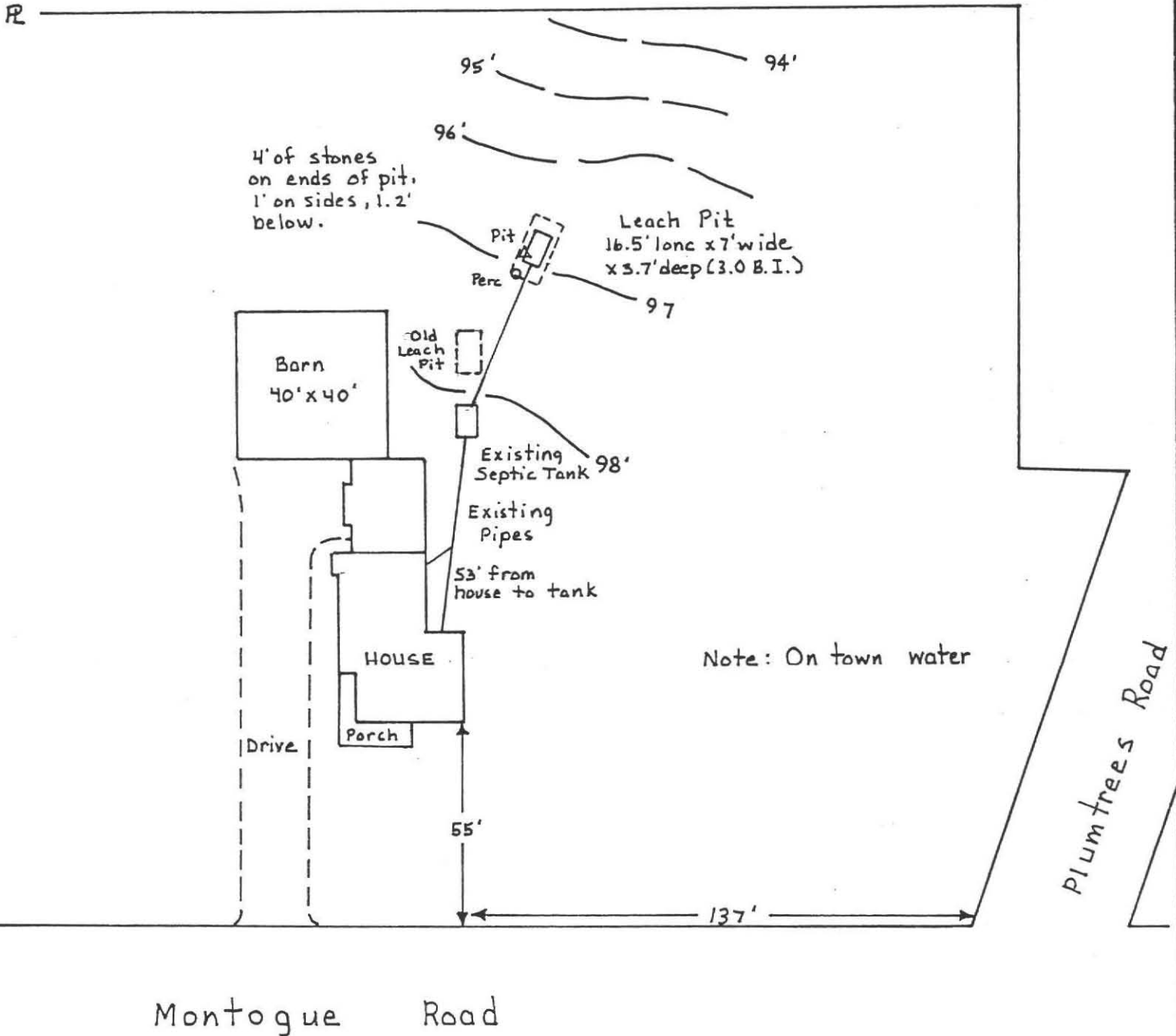
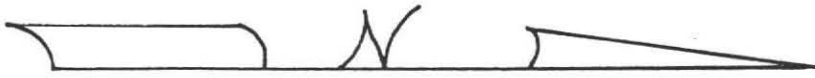

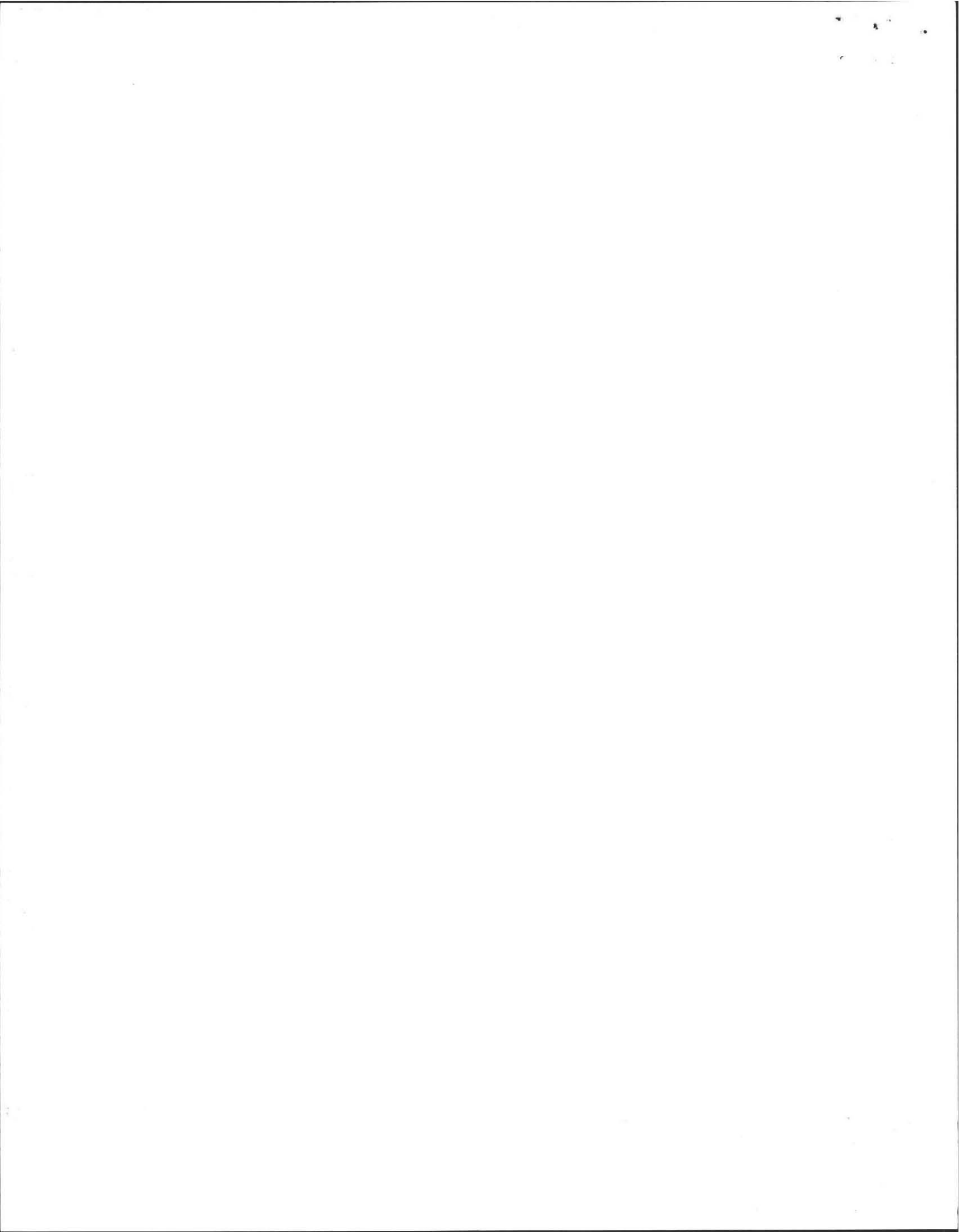

PROFILE OF SEPTIC SYSTEM REPAIR

SPECIFICATIONS

CONSTRUCTION NOTES

FOR: Bob Wiley
528 Montague Rd.
Amherst, MA

BY: Filios Enterprises Inc.
69 Pelham Road
Amherst, MA W.T.

AT: 528 Montague Rd
Amherst, MA

SCALE:
Horizontal: 1" = 10'

DATE: 8/17/88

Vertical: 1" = 3'

All materials and construction will be in accordance with Comm. of Mass. D.E.Q.E. state environmental Code Title 5.

1. Tank should be inspected and pumped at least every second year.
2. The inlet tee of the septic tank should extend 10" below flow line. The outlet tee should extend 14".
3. The pipe should remain level for 2' after exiting the D.Box.
4. All topsoil should be removed to a distance of 10' around system where fill is to be used.

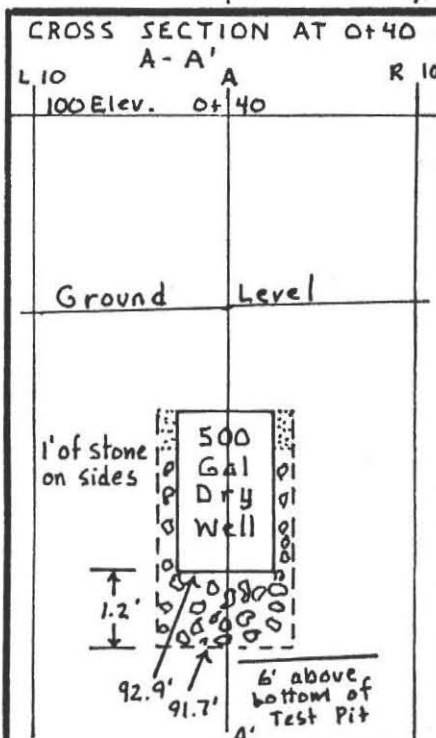
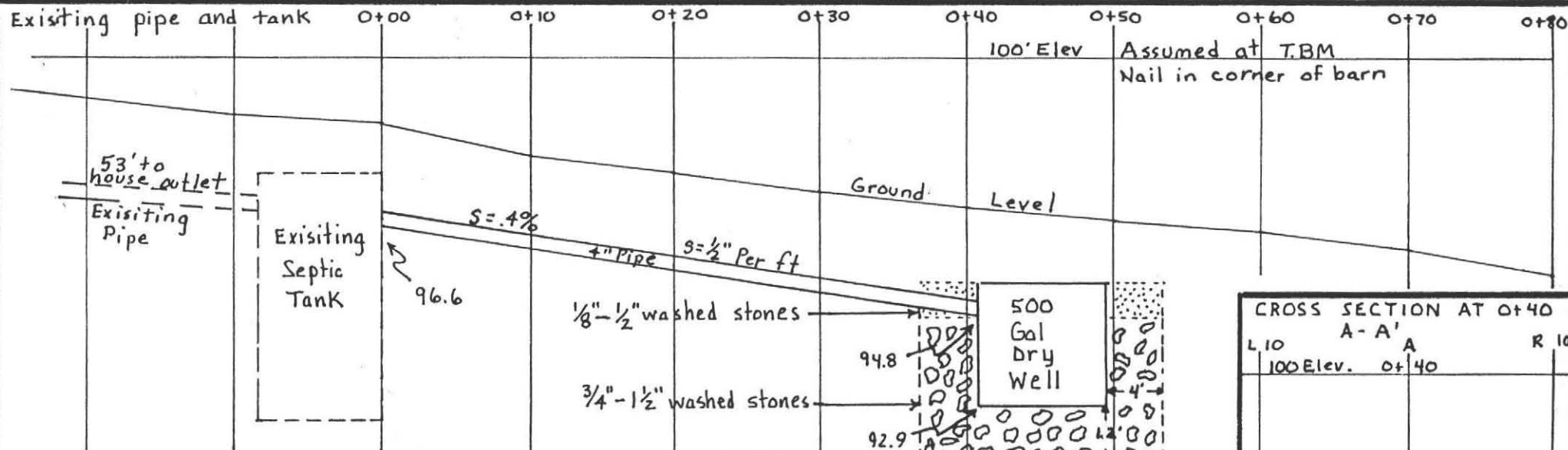

CALCULATIONS

4 Bdm x 110 = 440 gallons

PerL Rate = 2 min / inch. sides = 2.5 gal/sq.ft.
Bottom = 1.0 gal/sq.ft.

Shallow Pit: 16.5' long x 7' wide
x 3.7' deep (3.0' below inlet)

sides: 16.5' x 2 x 3' = 99 sq.ft x 2.5 gal/sq.ft.
= 247.5 gals.

7' x 2 x 3' = 42 sq.ft. x 2.5 gal/sq.ft.
= 105 gals.

Bottom: 16.5' x 7' = 115.5 sq.ft. x 1.0 gal/sq.ft.
= 115.5 gals.

Total = 468 gallons

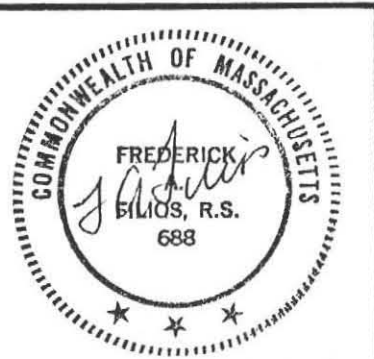

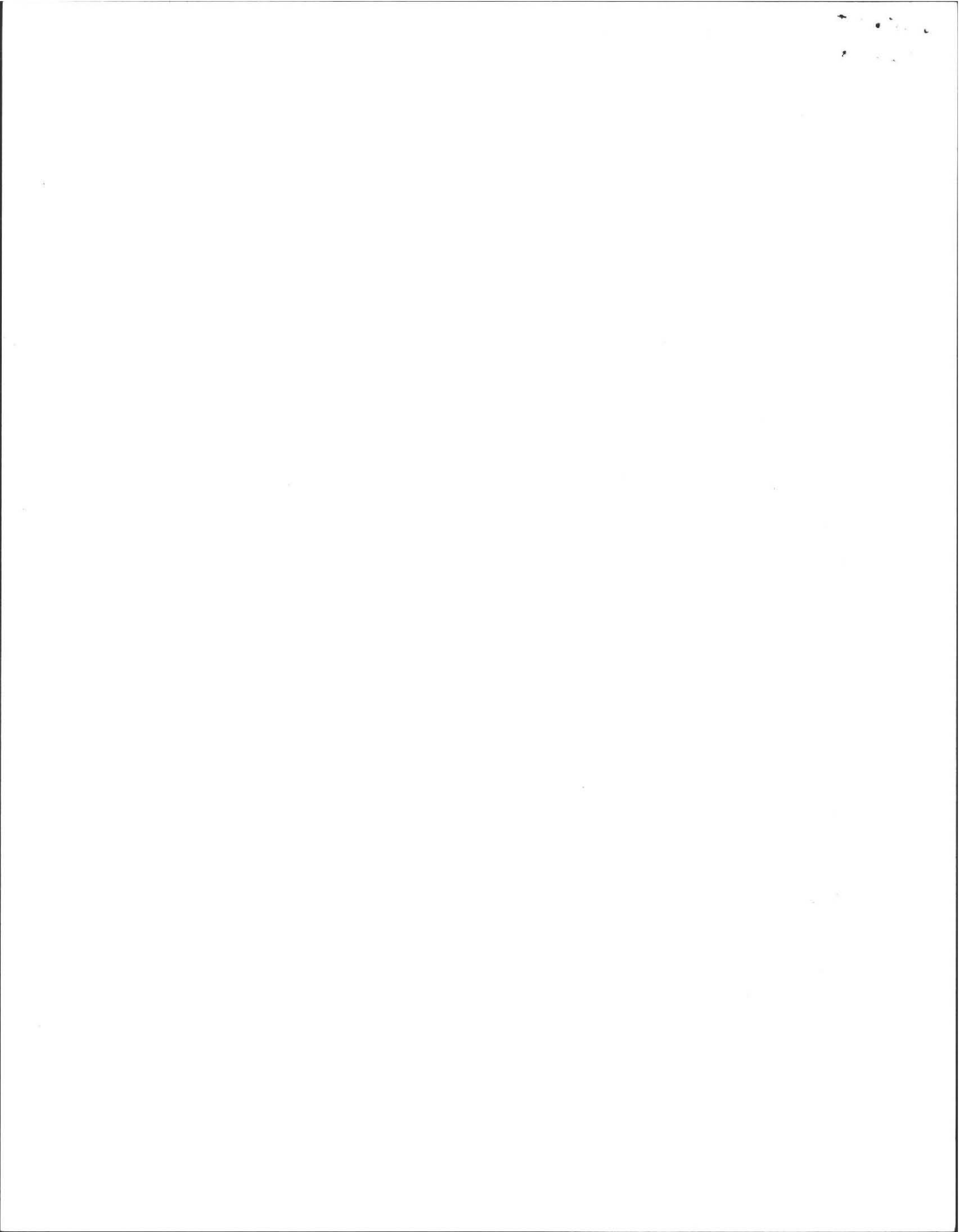

October 13, 1988

Mr. Robert Wiley
525 Montague Road
Amherst, MA 01002

Dear Mr. Wiley:

Enclosed please find copies of permits, etc.
regarding your septic system.

Sincerely,

Dennis Pinski
Sanitarian

DP:klw
encls.

