

No. 88-45R Revision

JUL 5 1989

#365

Revision

FEE 30.00

THE COMMONWEALTH OF MASSACHUSETTS

BOARD OF HEALTH

Town of Amherst

Application for Disposal Works Construction Permit

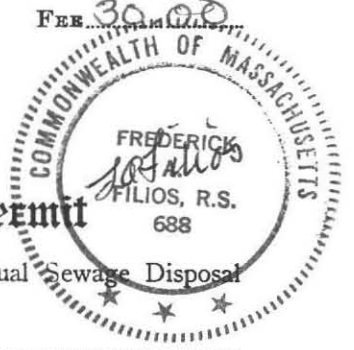

Application is hereby made for a Permit to Construct (X) or Repair () an Individual Sewage Disposal System at:

365 Middle Street Location - Address Lot B
Henry Whitlock Owner 399 Warren Wright Rd., Belchertown MA, 01007
Men Hislop Installer

Type of Building Dwelling - No. of Bedrooms 4 Expansion Attic () Garbage Grinder (Yes)
Other - Type of Building No. of persons Showers () - Cafeteria ()
Other fixtures

Design Flow 103.13 gallons per person per day. Total daily flow 825.00 gallons.
Septic Tank - Liquid capacity 1500 gallons Length 10.5 Width 5.67 Diameter 5.3 Depth 5.3
Disposal Trench - No. 3 Width 2 Total Length 120 Total leaching area 360 sq. ft. SIDE
Seepage Pit No. Diameter Depth below inlet Total leaching area 240 sq. ft. BASE

Percolation Test Results Performed by Filios Enterprises, Inc. Date Dec 13, 1988
Test Pit No. 1 minutes per inch Depth of Test Pit 10 1/2 Depth to ground water 108" (TPI-6)
Test Pit No. 2 minutes per inch Depth of Test Pit 10 Depth to ground water 108" (TPI-6)
(TPI-6) Perc. by: William J. Sieruta - Perc. Rate = 4 min/in @ 46"

Description of Soil Enclosed

Nature of Repairs or Alterations - Answer when applicable

Agreement: The undersigned agrees to install the aforementioned Individual Sewage Disposal System in accordance with the provisions of TITLE 5 of the State Sanitary Code. The undersigned further agrees not to place the system in operation until a Certificate of Compliance has been issued by the board of health.

Signed [Signature] Date 7-5-89

Application Approved By _____ Date _____

Application Disapproved for the following reasons: _____ Date _____

Permit No. 88-45R Issued _____ Date _____

THE COMMONWEALTH OF MASSACHUSETTS

BOARD OF HEALTH

Town of Amherst

Certificate of Compliance

Checked to Reasonable Compliance [Signature]

THIS IS TO CERTIFY, That the Individual Sewage Disposal System constructed (X) or Repaired () by Men Hislop Installer at Middle Street

has been installed in accordance with the provisions of TITLE 5 of The State Sanitary Code as described in the application for Disposal Works Construction Permit No. 88-45R dated _____

THE ISSUANCE OF THIS CERTIFICATE SHALL NOT BE CONSTRUED AS A GUARANTEE THAT THE SYSTEM WILL FUNCTION SATISFACTORY.

DATE 7/14/89 Inspector [Signature]

THE COMMONWEALTH OF MASSACHUSETTS

BOARD OF HEALTH

Town of Amherst

Disposal Works Construction Permit

FEE 30.00 Revision

Permission is hereby granted Men Hislop to Construct (X) or Repair () an Individual Sewage Disposal System at No. Middle Street

as shown on the application for Disposal Works Construction Permit No. 88-45R Dated _____

DATE 7/5/89 [Signature] Board of Health

CHECK OR FILL IN WHERE APPLICABLE

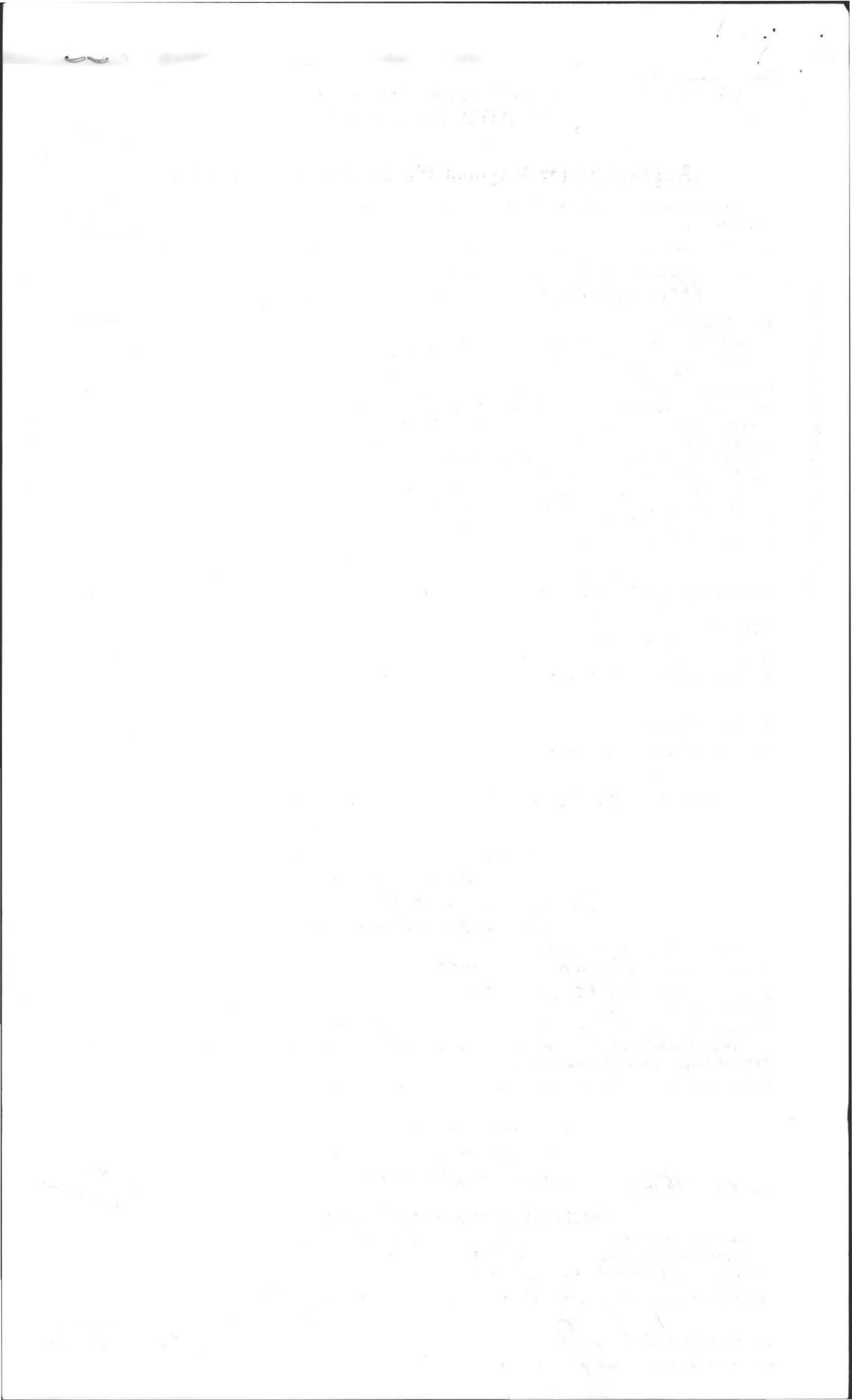

DEEP SOIL LOGS

OWNER David Keenan

DATE Dec. 13, 1988

LOCATION Lot B
Middle Street
Amburst, Ma

OBSERVER Filios Enterprises, Inc.
B. of H. D. Zarajinski

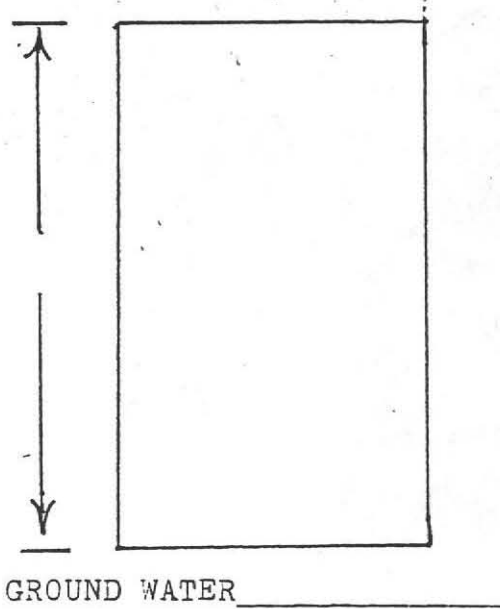
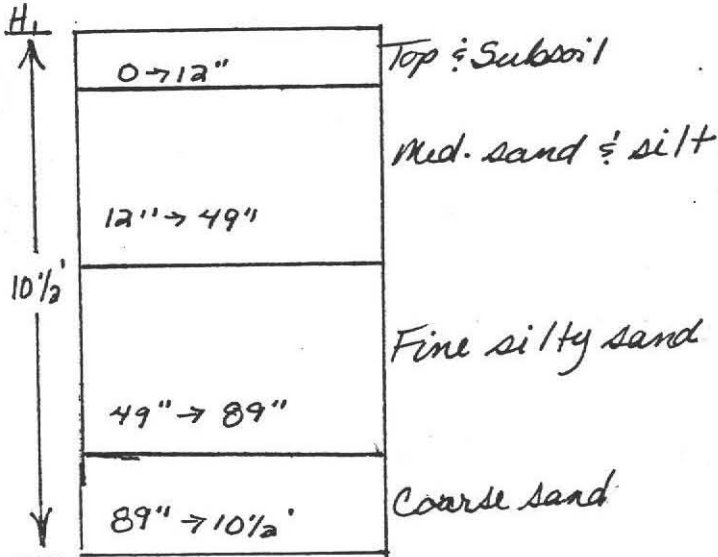

GROUND WATER Dry

GROUND WATER _____

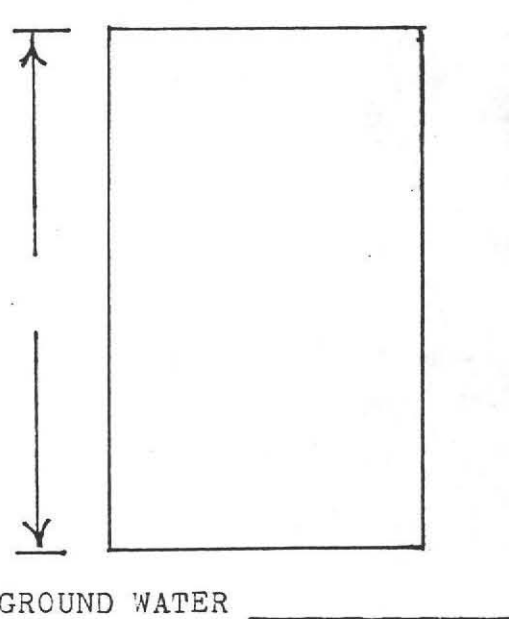
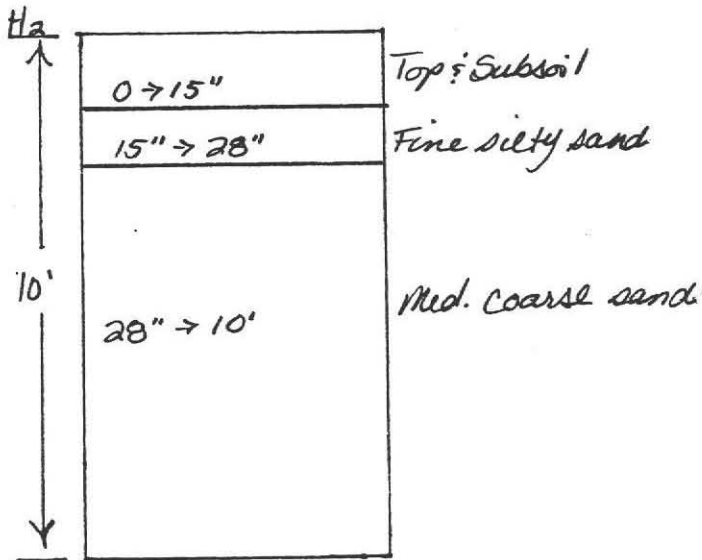

GROUND WATER _____

GROUND WATER _____

PERCOLATION RATE AT _____ :
_____ min./inch

DZ limit 100" seepage



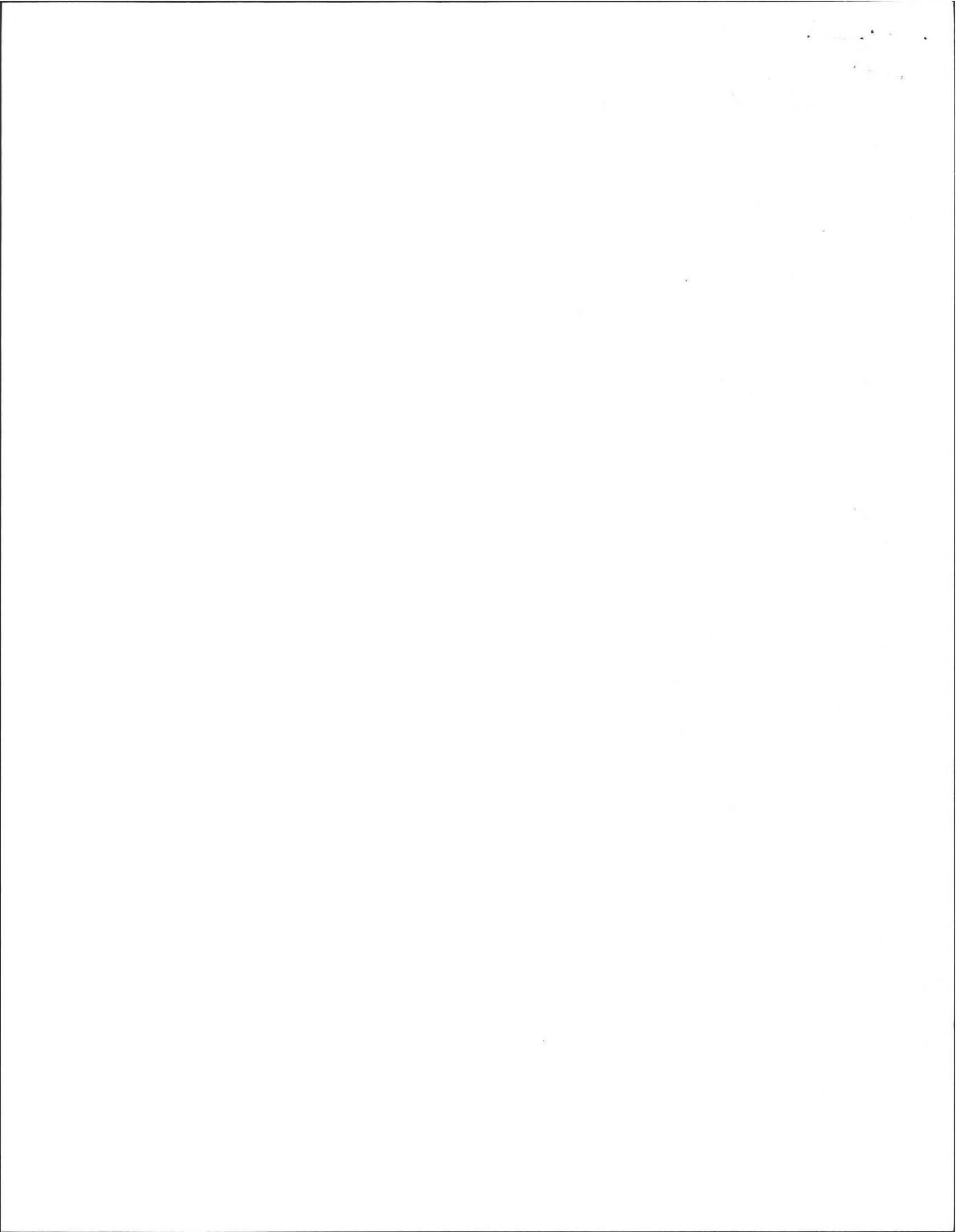

Time
 (5min) 15 MIN SOAK

<u>17 1/2</u>	<u>10:52</u>	ACTUAL
<u>11 1/2</u>	<u>11:04</u>	9 min
<u>8</u>	<u>11:13</u>	3.5"

DESIGN RATE
 Perc. Rate 4.0 Min/inch
 Ground Elev. _____
 Depth of Hole 46"

DEEP TEST PIT/S

Test Pit - TP1-5
 Depth Soil Description
0-10" SAND TOP
10"-107" MED SAND
107-130 COARSE GRAVEL

OXIDE @ 107"

Groundwater Depth 107" Elev. _____
 Bedrock Depth DNA Elev. _____
 Ground Elevation _____

S.C.S. Soil Designation SAND Seasonal High Water Table? _____

Bench Mark: Elev. _____ Description _____
ELEV TO BE SET AT PERL SITES.

Test No _____ (if required)
 Reading Time
 Saturation (15min) 15 MIN SOAK

<u>18 1/2</u>	<u>11:15</u>	5 3
<u>14 1/2</u>	<u>11:20</u>	
<u>11 1/2</u>	<u>11:25</u>	

DESIGN RATE
 Perc. Rate 2.0 Min/inch
 Ground Elev. _____
 Depth of Hole 52"

1.66
 min
 inc.

Test Pit - TP1-6
 Depth Soil Description
0-10" SAND TOP SOIL
10"-108" MED SAND
108-130" COARSE GRN
 AND SAND

Groundwater Depth 108" Elev. _____
 Bedrock Depth DNA Elev. _____
 Ground Elevation _____

COMMENTS:

TP1-5 and TP1-6
VERY GOOD SOIL CONDITIONS
WITH DEEP GROUND WATER
PERL TESTS AT THIS SITE.



Parcel @
357 MIDDLE ST
50 AMHERST, MASS
KEENAN PROP INC.
MARK OFFICE B...

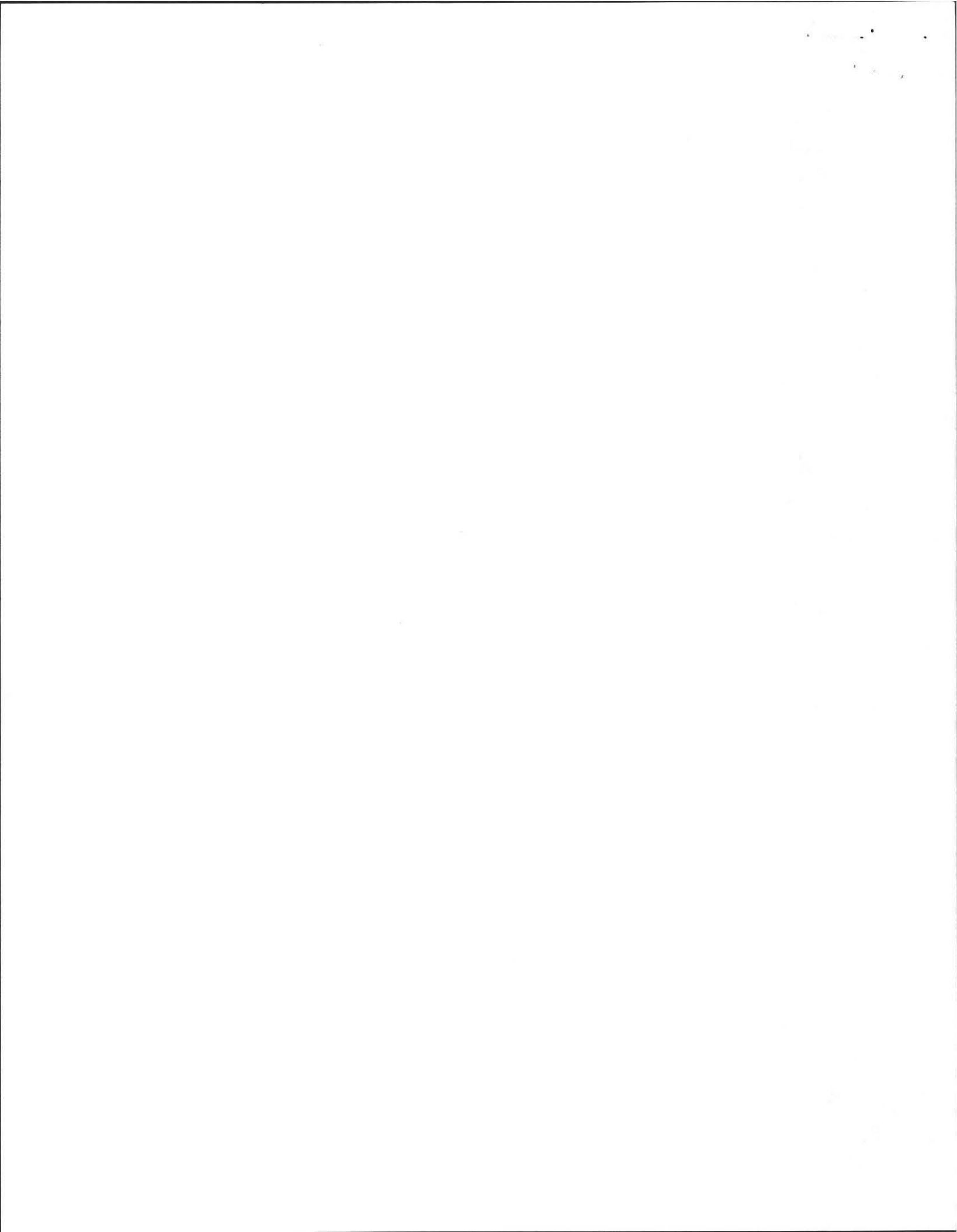

CROSS-SECTION AT 1+40 (A-A')

FOR = HENRY WHITLOCK
 399 WARREN WRIGHT RD.
 BELCHERTOWN, MA. 01007

BY = FILIOS ENTERPRISES, INC.
 69 PELHAM ROAD.
 AMHERST, MA. 01002

SCALE: HORIZONTAL: 1" = 10.0'
 VERTICAL: 1" = 3.0'
 DATE: JUNE 30, 1989

SITE: LOT B
 MIDDLE ST.,
 AMHERST, MA.

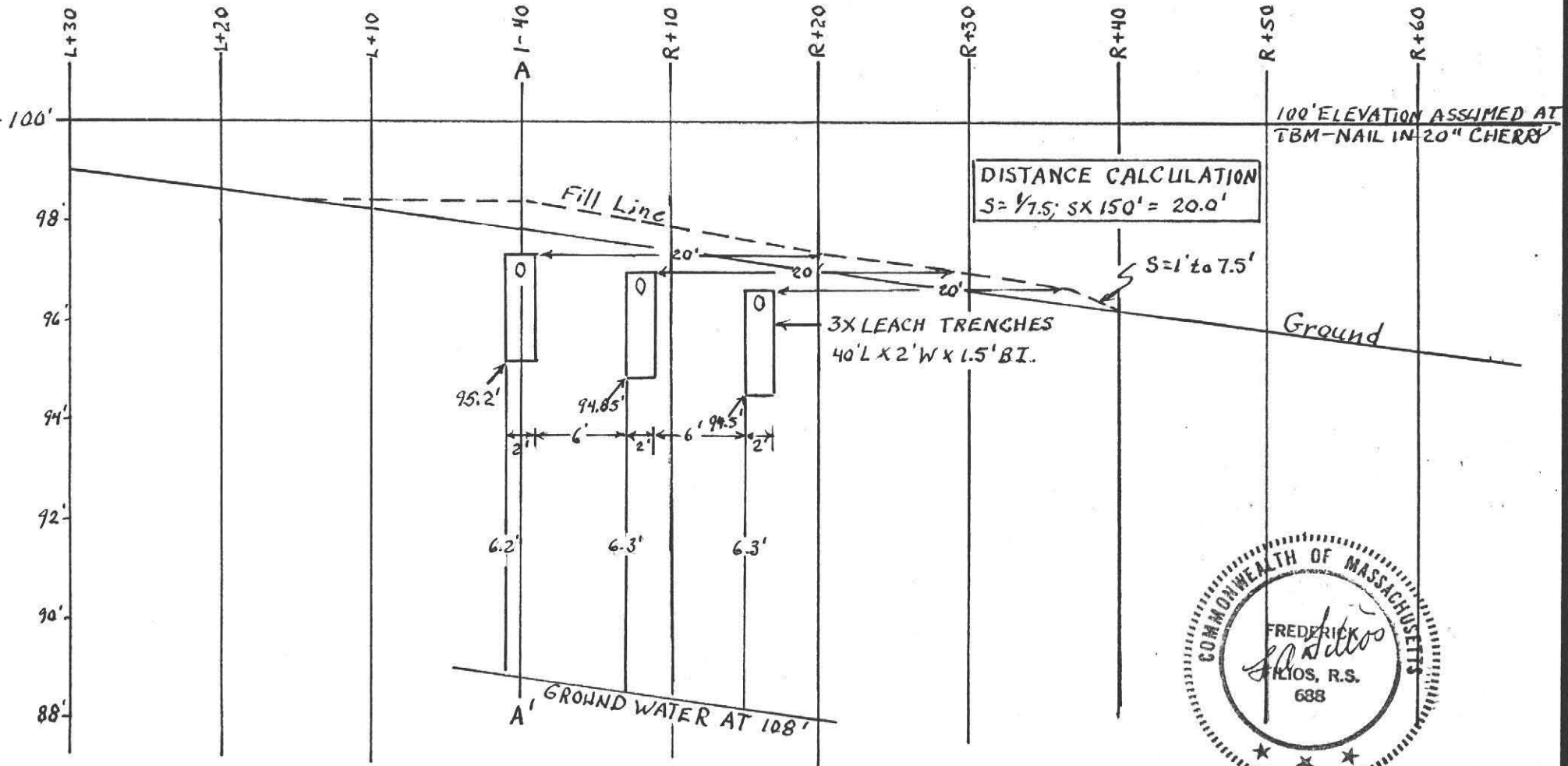

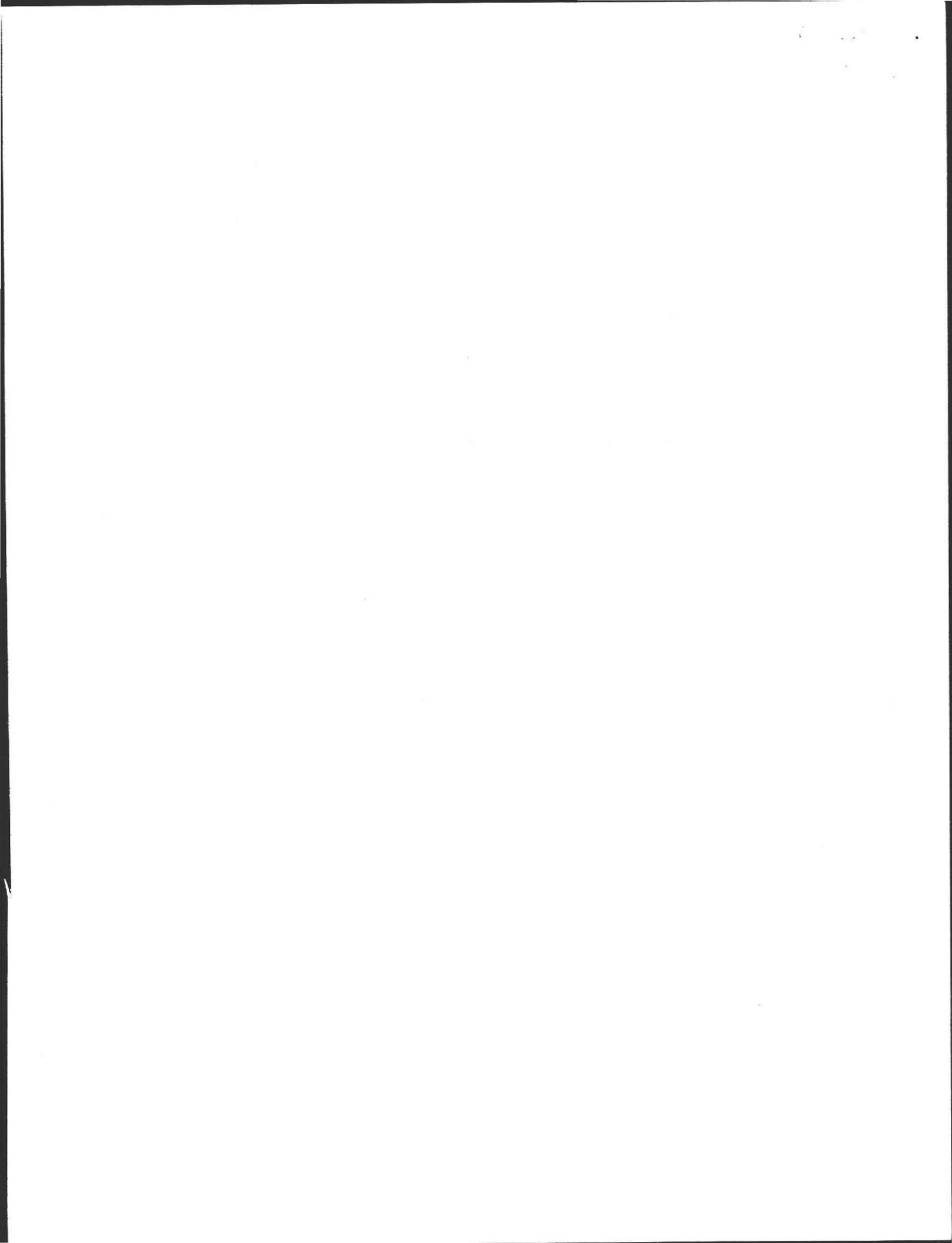

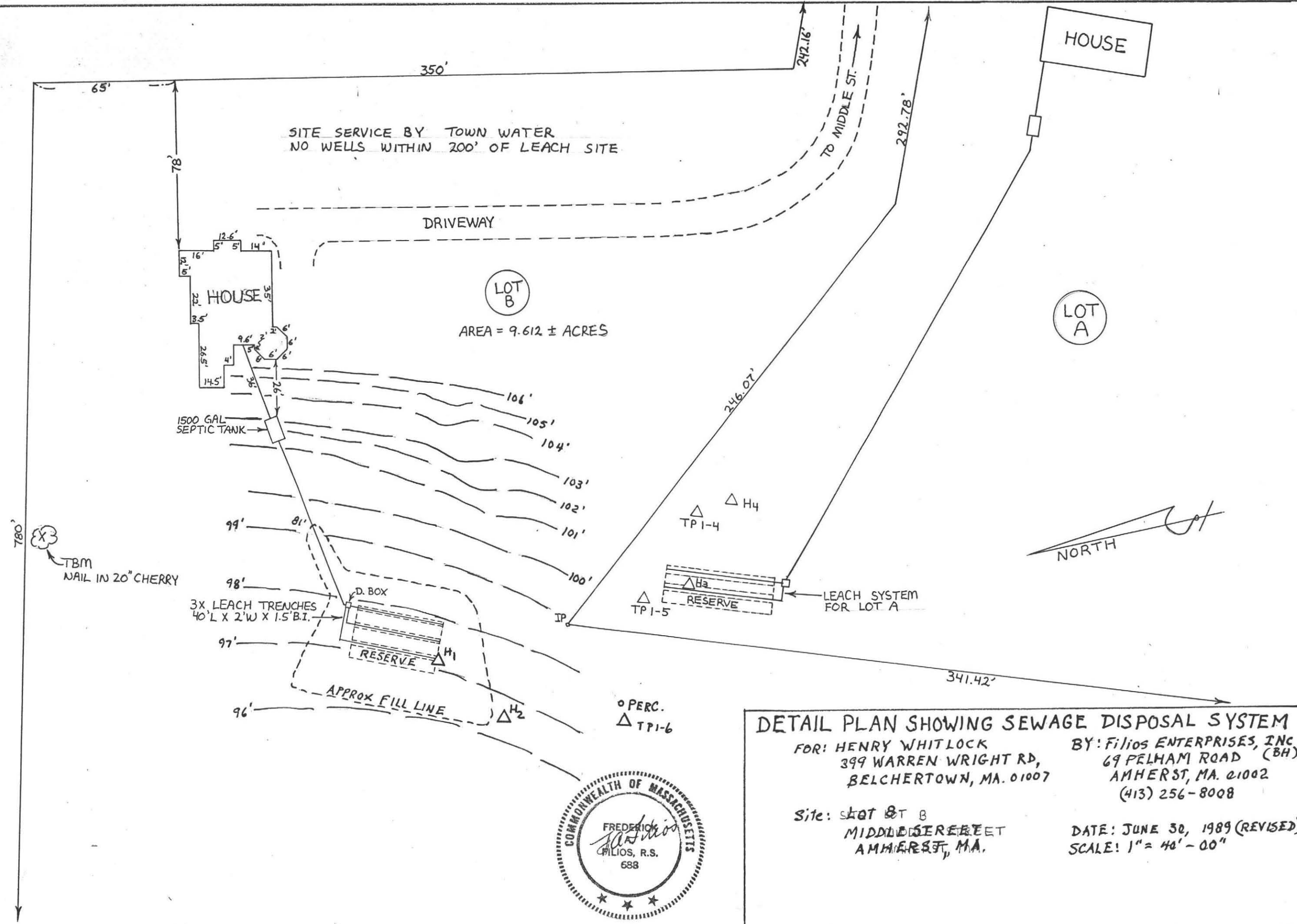

SITE SERVICE BY TOWN WATER
NO WELLS WITHIN 200' OF LEACH SITE

DRIVEWAY

LOT B

AREA = 9.612 ± ACRES

1500 GAL SEPTIC TANK

3X LEACH TRENCHES
40' L X 2' W X 1.5' B.I.

RESERVE

APPROX FILL LINE

RESERVE

LEACH SYSTEM FOR LOT A

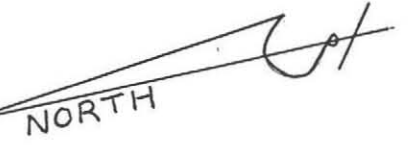

DETAIL PLAN SHOWING SEWAGE DISPOSAL SYSTEM
 FOR: HENRY WHITLOCK
 399 WARREN WRIGHT RD,
 BELCHERTOWN, MA. 01007
 BY: Filios ENTERPRISES, INC
 69 PELHAM ROAD (BH)
 AMHERST, MA. 01002
 (413) 256-8008
 Site: LOT B
 MIDDLE STREET
 AMHERST, MA.
 DATE: JUNE 30, 1989 (REVISED)
 SCALE: 1" = 40' - 00"

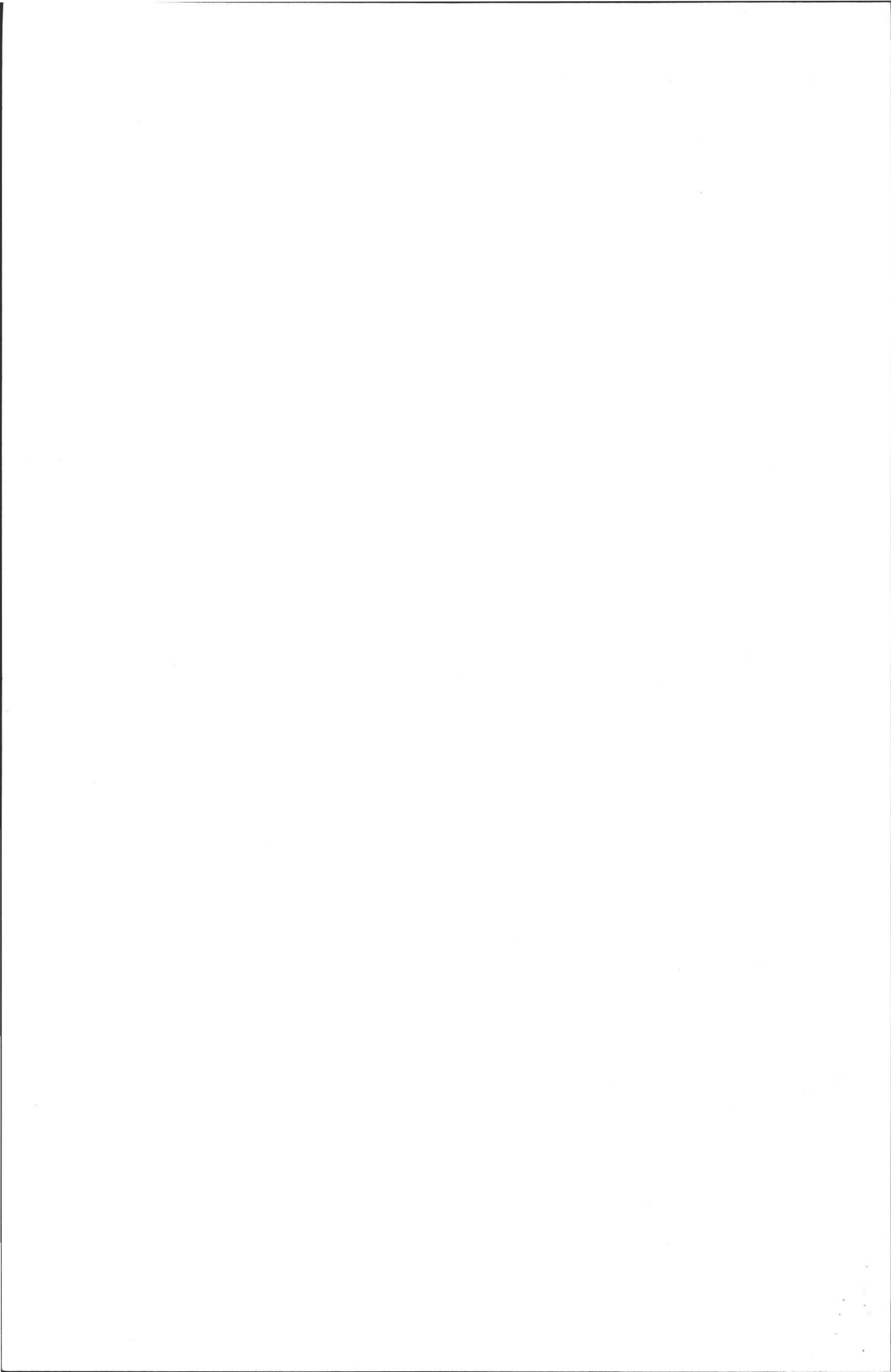

PROFILE OF SEPTIC SYSTEM - REVISION

FOR : HENRY WHITLOCK
399 WARREN WRIGHT ROAD,
BELCHERTOWN, MA. 01007

SITE : LOT B
MIDDLE ST.,
AMHERST, MA.

BY : FILIOS ENTERPRISES, INC.
(BH)
69 PELHAM ROAD,
AMHERST, MA. 01002

SCALE : HORIZONTAL : 1" = 20.00'
VERTICAL : = 3.00'

DATE : JUNE 30, 1989

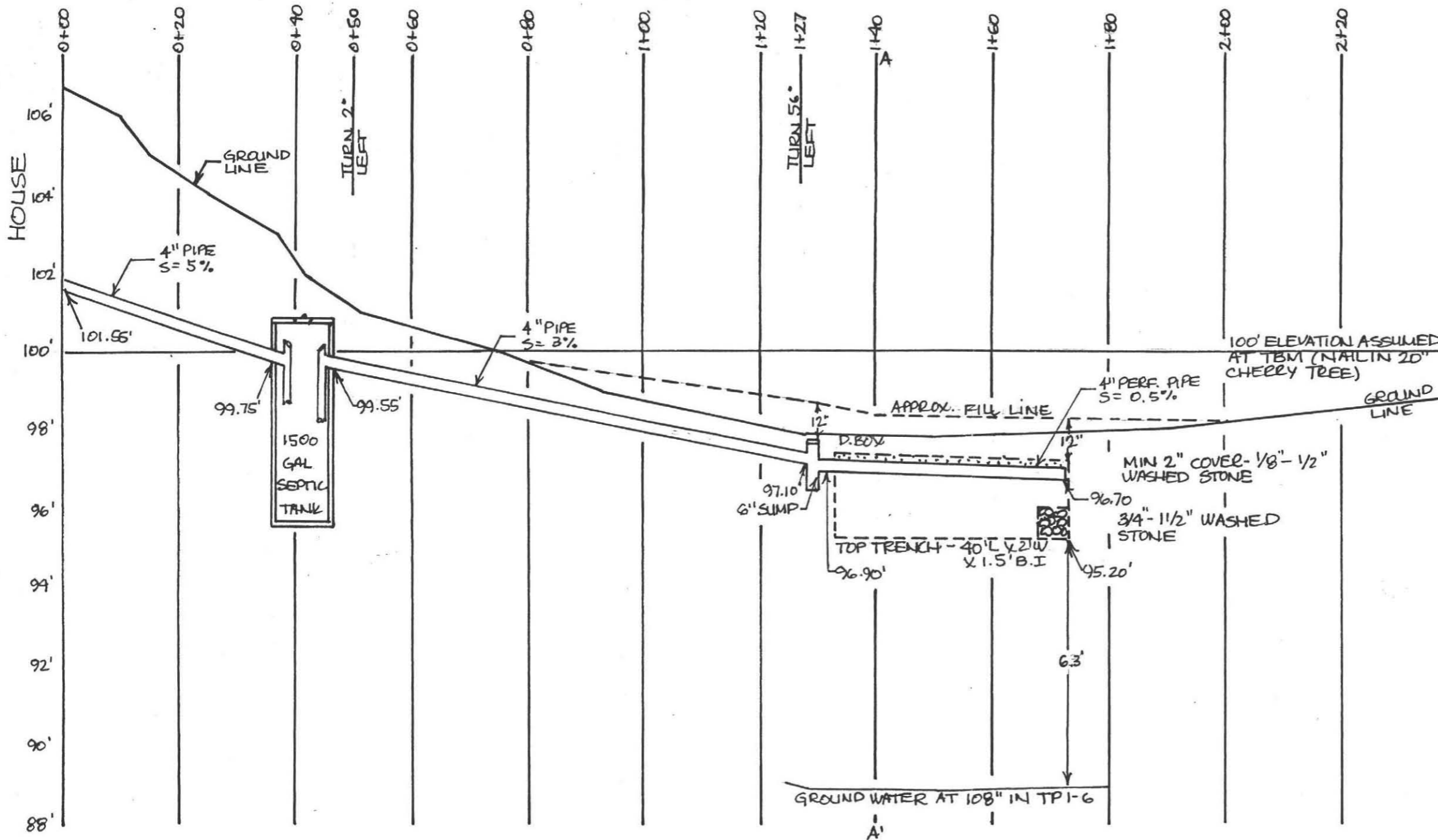

SPECIFICATIONS

ALL MATERIALS AND CONSTRUCTION
MUST BE IN ACCORDANCE WITH
COMMONWEALTH OF MA D.E.Q.E.
STATE ENVIRONMENTAL CODE
TITLE 5

CONSTRUCTION NOTES

1. Tank should be inspected and pumped at least every second year.
2. The inlet tee of the septic tank should extend 10" below flow line. The outlet tee should extend 14".
3. The pipe should remain level for 2' after exiting the D.Box.
4. All topsoil should be removed to a distance of 10' around system where fill is to be used.

CALCULATIONS

4 BDRM X 110 GAL / BDRM = 440 GAL
440 GAL X 150% (GARBAGE GRINDER) = 660 GAL
660 GAL X 125% (AMHERST) = 825 GAL REQUIRED
PERC RATE = 4 MIN / IN → 2 GAL / FT² SIDE
0.83 GAL / FT² BASE
3 TRENCHES - 40' L X 2' W X 1.5' BELOW INVERT
SIDE: 6 X 40' X 1.5' X 2 GAL / FT² = 720.0 GAL.
BASE: 3 X 40' X 2' X 0.83 GAL / FT² = 199.2 GAL.
TOTAL = 919.2 GAL / DAY



