

420 Meadows St -



No. \_\_\_\_\_

FEE \_\_\_\_\_

# COMMONWEALTH OF MASSACHUSETTS

Board of Health, Amherst, MA.

## APPLICATION FOR DISPOSAL SYSTEM CONSTRUCTION PERMIT



Application for a Permit to Construct ( ) Repair (x) Upgrade ( ) Abandon ( ) -  Complete System  Individual Components

Location <u>420 Meadow Rd</u>	Owner's Name <u>Mike Ziomek</u>
Map/Parcel# <u>40/11</u>	Address <u>420 Meadow St.</u>
Lot# <u>11</u>	Telephone# <u>413.549-5276</u>
Installer's Name	Designer's Name <u>Alan E. Weiss RS.</u>
Address	Address <u>Belchertown</u>
Telephone#	Telephone# <u>413.323.5957</u>

Type of Building Residence Lot Size 19,403± sq. ft.  
 Dwelling - No. of Bedrooms 4 Bedrooms Garbage grinder ( )  
 Other - Type of Building \_\_\_\_\_ No. of persons \_\_\_\_\_ Showers ( ), Cafeteria ( )  
 Other Fixtures \_\_\_\_\_  
 Design Flow (min. required) 110 gpd Calculated design flow 440 Design flow provided 445 gpd  
 Plan: Date 7/24/09 Number of sheets \_\_\_\_\_ Revision Date \_\_\_\_\_  
 Title Septic System Repair Plan  
 Description of Soil(s) Class I  
 Soil Evaluator Form No. \_\_\_\_\_ Name of Soil Evaluator A. Weiss Date of Evaluation 9/24/09

DESCRIPTION OF REPAIRS OR ALTERATIONS Install New Septic System

The undersigned agrees to install the above described Individual Sewage Disposal System in accordance with the provisions of TITLE 5 and further agrees to not to place the system in operation until a Certificate of Compliance has been issued by the Board of Health.

Signed Michael E. Ziomek Date 10-9-09



Inspections \_\_\_\_\_

No. \_\_\_\_\_

FEE \_\_\_\_\_

# COMMONWEALTH OF MASSACHUSETTS

Board of Health, \_\_\_\_\_, MA.

## CERTIFICATE OF COMPLIANCE

Description of Work:  Individual Component(s)  Complete System

The undersigned hereby certify that the Sewage Disposal System; Constructed ( ), Repaired ( ), Upgraded ( ), Abandoned ( )

by: \_\_\_\_\_

at \_\_\_\_\_

has been installed in accordance with the provisions of 310 CMR 15.00 (Title 5) and the approved design plans/as-built plans relating to application No. \_\_\_\_\_, dated \_\_\_\_\_, Approved Design Flow \_\_\_\_\_(gpd)

Installer \_\_\_\_\_

Designer: \_\_\_\_\_ Inspector: \_\_\_\_\_ Date: \_\_\_\_\_

The issuance of this permit shall not be construed as a guarantee that the system will function as designed.

No. \_\_\_\_\_

FEE \_\_\_\_\_

# COMMONWEALTH OF MASSACHUSETTS

Board of Health, \_\_\_\_\_, MA.

## DISPOSAL SYSTEM CONSTRUCTION PERMIT

Permission is hereby granted to; Construct ( ) Repair ( ) Upgrade ( ) Abandon ( ) an individual sewage disposal system at \_\_\_\_\_ as described in the application for Disposal System Construction Permit No. \_\_\_\_\_, dated \_\_\_\_\_.

Provided: Construction shall be completed within three years of the date of this permit. All local conditions must be met.

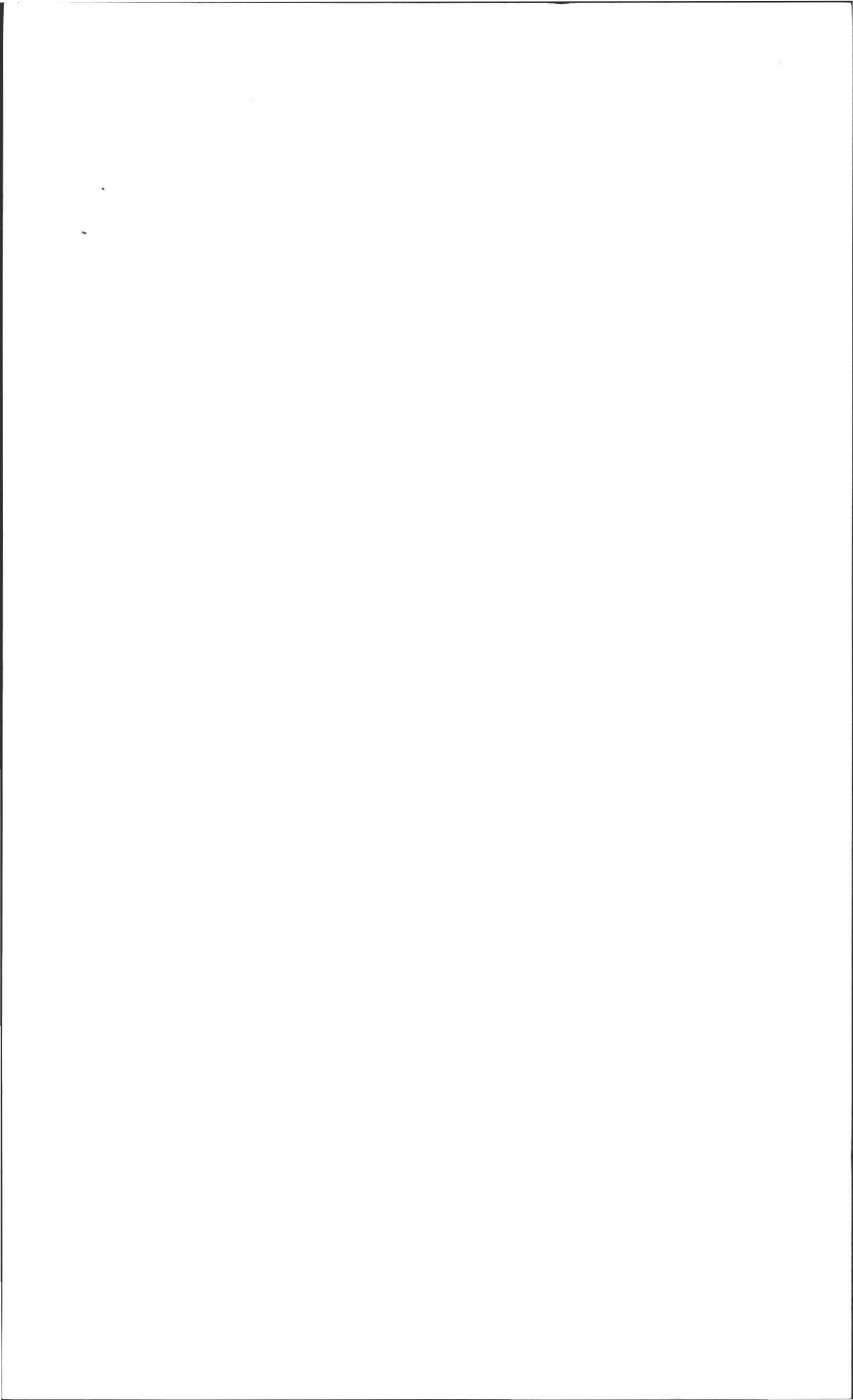

ALAN E. WEISS, M.S., L.S.P.

Licensed Site Professional  
Registered Sanitarian  
Hydrogeologist  
President

- Subsurface Investigations
- 21E Site Investigations
- Pollution Remediation
- Percolation Tests and Septic Designs

350 Old Enfield Rd.  
Belchertown, MA 01007  
(413) 323-5957 & 323-4916 (FAX)

Date: 9-24-09

Commonwealth of Massachusetts  
Amherst, Massachusetts

Soil Suitability Assessment for On-site Sewage Disposal

Performed By: A Weiss  
Witnessed By: G Courtmarche

Date:

Location Address or Lot # <u>420 Meadow St</u>	Owner's Name, Address, and Telephone # <u>MIKE ZIONCK</u> <u>420 Meadow St</u> <u>Amherst, MA</u> <u>01002</u>
New Construction <input type="checkbox"/> Repair <input checked="" type="checkbox"/>	

547-5276

Office Review

Published Soil Survey Available: No  Yes

Year Published \_\_\_\_\_ Publication Scale \_\_\_\_\_ Soil Map Unit \_\_\_\_\_

Drainage Class \_\_\_\_\_ Soil Limitations \_\_\_\_\_

Surficial Geologic Report Available: No  Yes

Year Published \_\_\_\_\_ Publication Scale \_\_\_\_\_

Geologic Material (Map Unit) \_\_\_\_\_

Landform \_\_\_\_\_

Flood Insurance Rate Map:

Above 500 year flood boundary No  Yes

Within 500 year flood boundary No  Yes

Within 100 year flood boundary No  Yes

Wetland Area:

National Wetland Inventory Map (map unit) \_\_\_\_\_

Wetlands Conservancy Program Map (map unit) \_\_\_\_\_

Current Water Resource Conditions (USGS): Month \_\_\_\_\_

Range : Above Normal  Normal  Below Normal

Other References Reviewed: \_\_\_\_\_



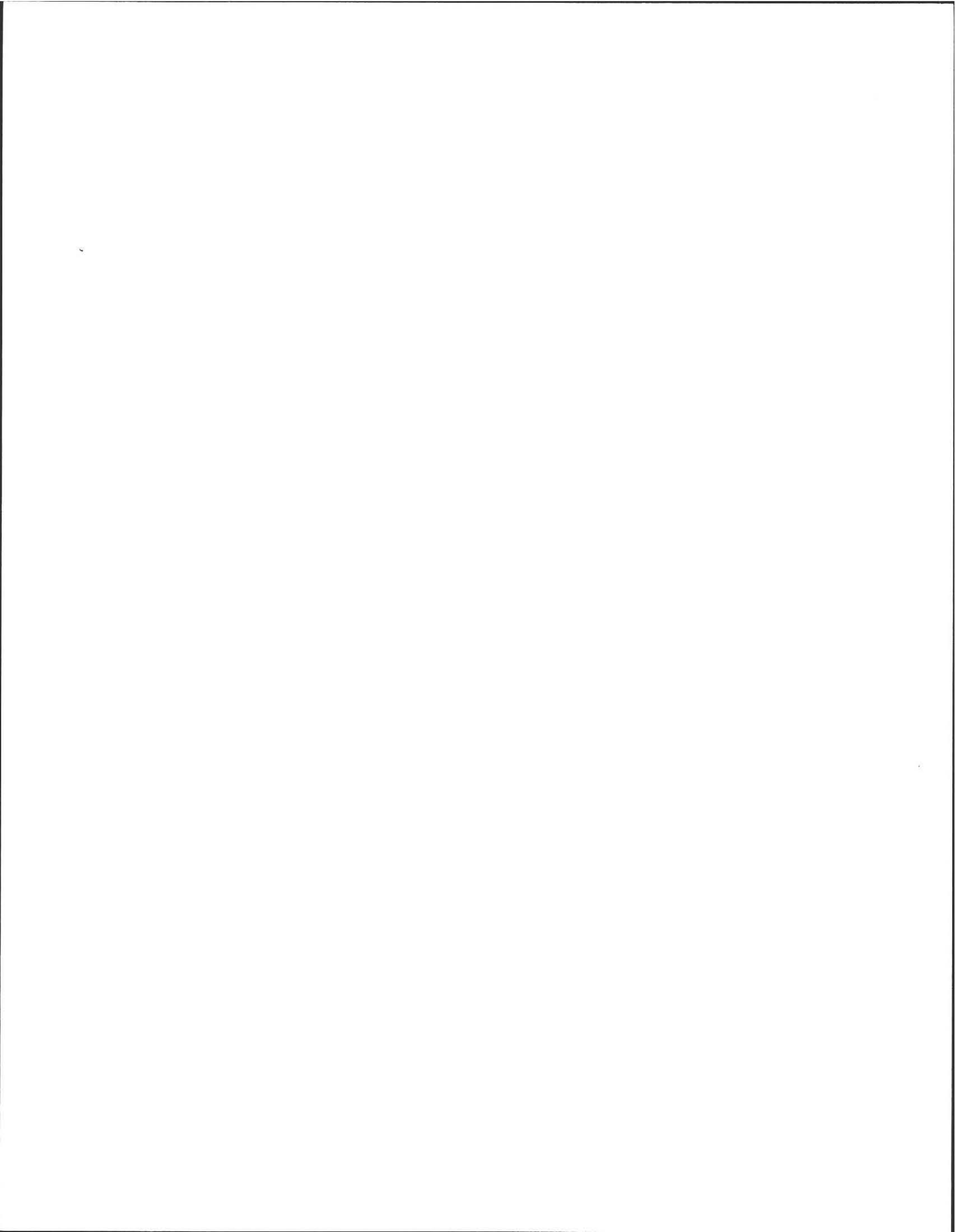

Location Address or Lot No. 420 Meadow ST

On-site Review

Deep Hole Number 1+2 Date: 9/24/09 Time: 9:00 Weather SUN 70°F

Location (identify on site plan) \_\_\_\_\_

Land Use Ag. C. Slope (%) 2 Surface Stones None

Vegetation grass

Landform Terrace plateau.

Position on landscape (sketch on the back) \_\_\_\_\_

Distances from:

Open Water Body 100+ feet      Drainage way 25+ feet  
 Possible Wet Area 100+ feet      Property Line 20' feet  
 Drinking Water Well \_\_\_\_\_ feet      Other \_\_\_\_\_  
 "No wells in area"

DEEP OBSERVATION HOLE LOG\*

Depth from Surface (Inches)	Soil Horizon	Soil Texture (USDA)	Soil Color (Munsell)	Soil Mottling	Other (Structure, Stones, Boulders, Consistency, % Gravel)
0-18	Ap	FSL	10YR 3/2		-Friable
18-26	Bw	LS	2.5Y 5/6	7B"	-Friable, loose
26"-110"	C <sub>1</sub>	LS	2.5Y 5/2	10YR 6/8	Fine Sand, granular, little silt, var. vel.
0-14"	Ap	FSL	10YR 3/2		-Friable
14"-24"	Bw	LS	2.5Y 5/6		-Friable loose
24"-100"	C <sub>1</sub>	LS	2.5Y 5/2	4B" 10YR 6/8	-Fine Sand, granular.

\* MINIMUM OF 2 HOLES REQUIRED AT EVERY PROPOSED DISPOSAL AREA

Parent Material (geologic) Limestone - Sand. Depth to Bedrock: 120"

Depth to Groundwater: Standing Water in the Hole: 100" Weeping from Pit Face: 80"-86"

Estimated Seasonal High Ground Water: 48-50"

Established where matrix color was grey as well



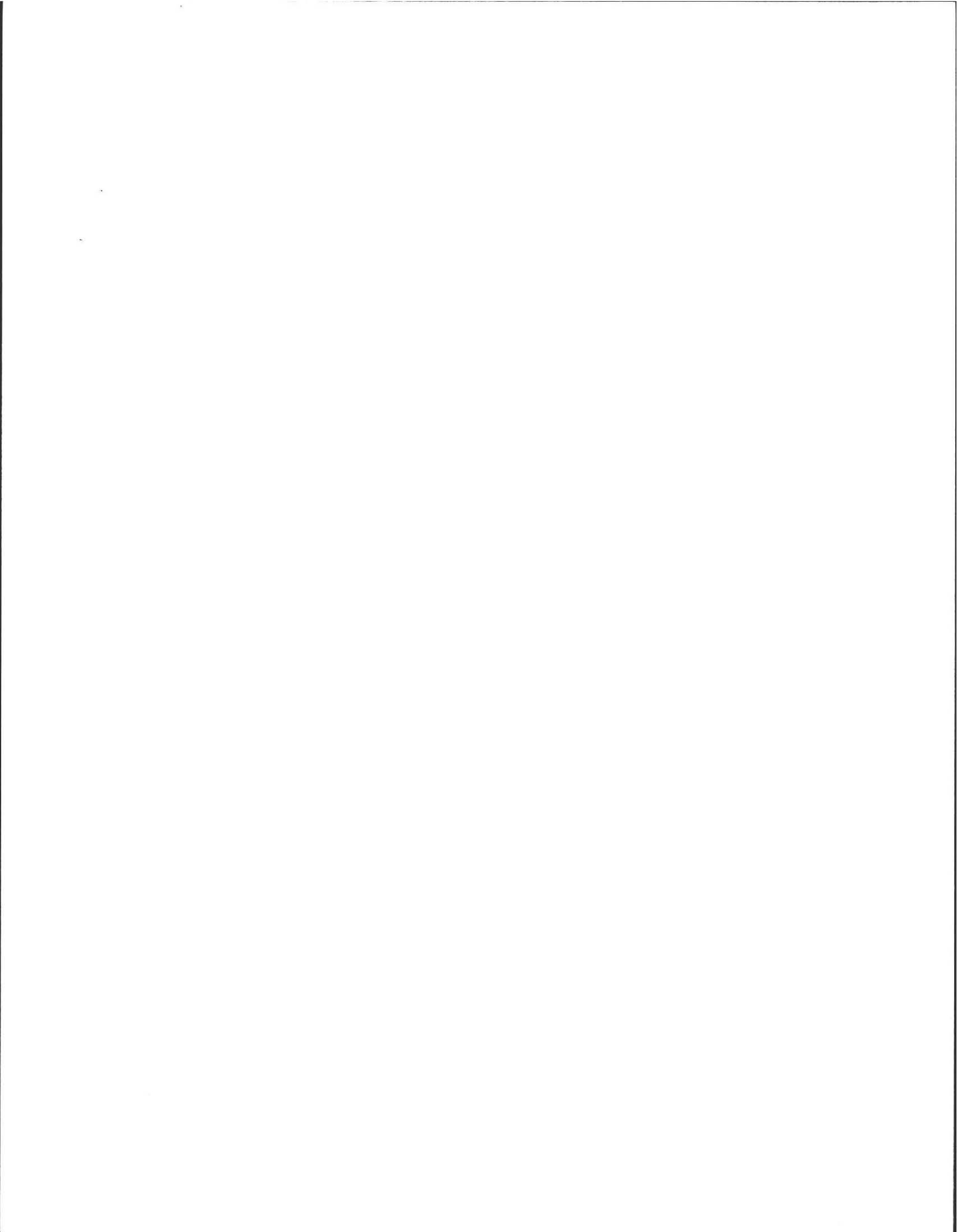



Location Address or Lot No. 470 Meadow St

COMMONWEALTH OF MASSACHUSETTS  
Amherst, Massachusetts

Percolation Test*		
Date: <u>9/24/09</u>		Time: _____
Observation Hole #	<u>P<sub>1</sub></u>	Repair          ↓
Depth of Perc	<u>60"</u>	
Start Pre-soak	<u>8:45</u>	
End Pre-soak	<u>9:00</u>	
Time at 12"	<u>9:00</u>	
Time at 9"	<u>9:06</u>	
Time at 6"	<u>9:14</u>	
Time (9"-6")	<u>8 MIN</u>	
Rate Min./Inch	<u>3 MIN IN.</u>	

\* Minimum of 1 percolation test must be performed in both the primary area AND reserve area.

Site Passed  Site Failed

Performed By: A. Weiss

Witnessed By: C Courtmanche

Comments: \_\_\_\_\_



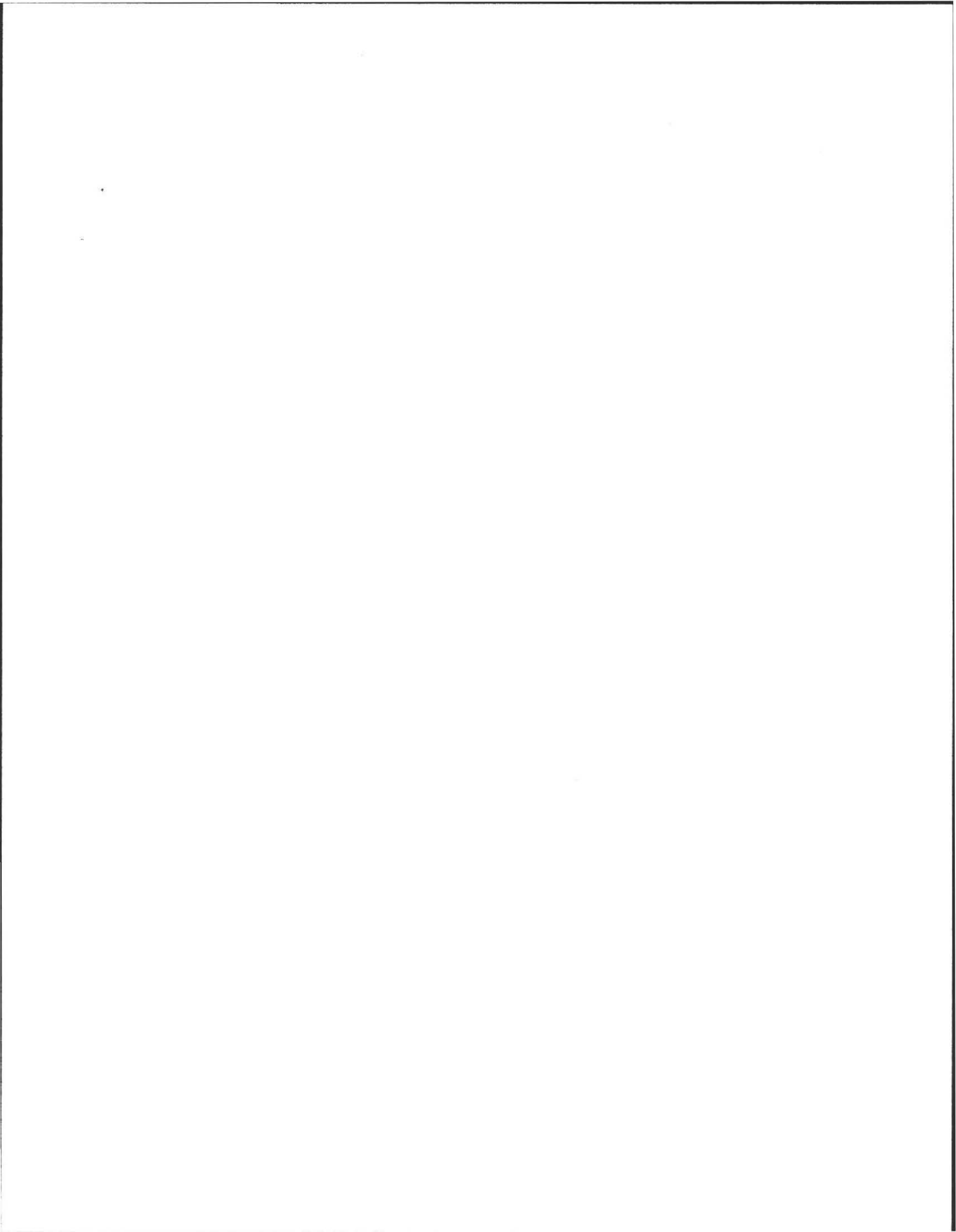

Location Address or Lot No. 470 Meadow ST.

### Determination for Seasonal High Water Table

Method Used:

- Depth observed standing in observation hole ..... inches
- Depth weeping from side of observation hole ..... inches
- Depth to soil mottles 48-52" inches
- Ground water adjustment ..... feet

Index Well Number ..... Reading Date ..... Index well level

Adjustment factor ..... Adjusted ground water level .....

### Depth of Naturally Occurring Pervious Material

Does at least four feet of naturally occurring pervious material exist in all areas observed throughout the area proposed for the soil absorption system? YES

If not, what is the depth of naturally occurring pervious material? \_\_\_\_\_

### Certification

I certify that on 6/95 (date) I have passed the soil evaluator examination approved by the Department of Environmental Protection and that the above analysis was performed by me consistent with the required training, expertise and experience described in 310 CMR 15.017.

Signature AL Date 9/24/09

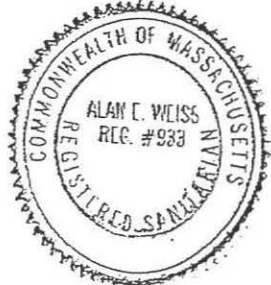

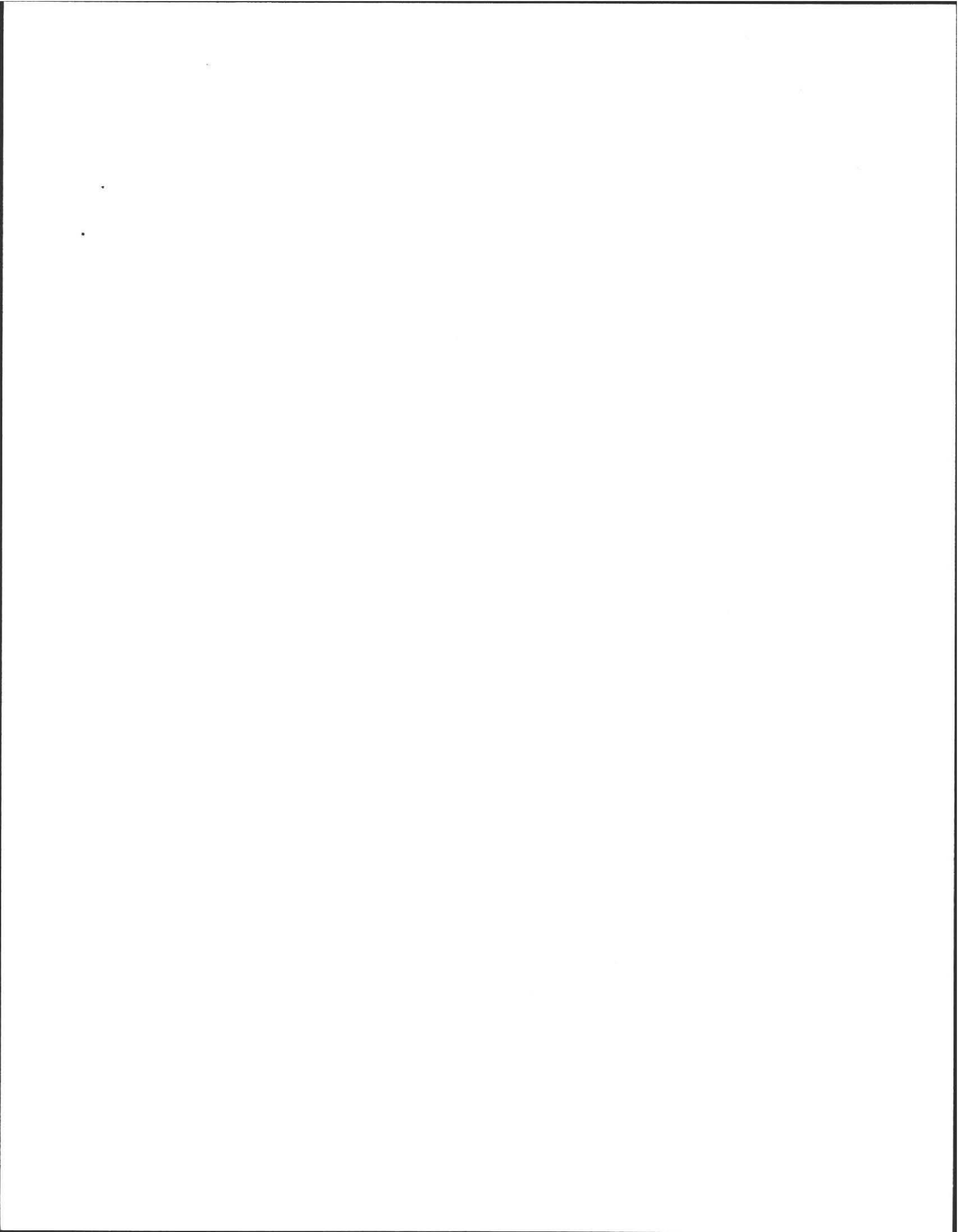

No. \_\_\_\_\_

FEE \_\_\_\_\_

# COMMONWEALTH OF MASSACHUSETTS

Board of Health, Amherst, MA.

## APPLICATION FOR DISPOSAL SYSTEM CONSTRUCTION PERMIT

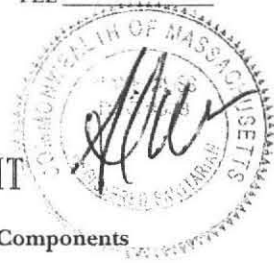

Application for a Permit to Construct( ) Repair() Upgrade( ) Abandon( ) -  Complete System  Individual Components

Location <u>420 Meadow Rd</u>	Owner's Name <u>Mike Ziomek</u>
Map/Parcel# <u>410/11</u>	Address <u>420 Meadow St.</u>
Lot# <u>11</u>	Telephone# <u>413.549-5276</u>
Installer's Name	Designer's Name <u>Alan E. Weiss P.E.</u>
Address	Address <u>Belchertown</u>
Telephone#	Telephone# <u>413.323.5957</u>

Type of Building Residence Lot Size 19,403± sq. ft.  
 Dwelling - No. of Bedrooms 4 Bedrooms Garbage grinder ( )  
 Other - Type of Building \_\_\_\_\_ No. of persons \_\_\_\_\_ Showers ( ), Cafeteria ( )  
 Other Fixtures \_\_\_\_\_  
 Design Flow (min. required) 110 gpd Calculated design flow 440 Design flow provided 445 gpd  
 Plan: Date 7/24/09 Number of sheets \_\_\_\_\_ Revision Date \_\_\_\_\_  
 Title Septic System Repair Plan  
 Description of Soil(s) Class I  
 Soil Evaluator Form No. \_\_\_\_\_ Name of Soil Evaluator A. Weiss Date of Evaluation 9/24/09

DESCRIPTION OF REPAIRS OR ALTERATIONS Install New Septic System

The undersigned agrees to install the above described Individual Sewage Disposal System in accordance with the provisions of TITLE 5 and further agrees to not to place the system in operation until a Certificate of Compliance has been issued by the Board of Health.

Signed Michael E. Ziemeck Date 10-9-09



Inspections \_\_\_\_\_

No. \_\_\_\_\_

FEE \_\_\_\_\_

# COMMONWEALTH OF MASSACHUSETTS

Board of Health, \_\_\_\_\_, MA.

## CERTIFICATE OF COMPLIANCE

Description of Work:  Individual Component(s)  Complete System

The undersigned hereby certify that the Sewage Disposal System; Constructed ( ), Repaired ( ), Upgraded ( ), Abandoned ( )

by: \_\_\_\_\_  
at \_\_\_\_\_

has been installed in accordance with the provisions of 310 CMR 15.00 (Title 5) and the approved design plans/as-built plans relating to application No. \_\_\_\_\_, dated \_\_\_\_\_, Approved Design Flow \_\_\_\_\_(gpd)

Installer: \_\_\_\_\_

Designer: \_\_\_\_\_ Inspector: \_\_\_\_\_ Date: \_\_\_\_\_

The issuance of this permit shall not be construed as a guarantee that the system will function as designed.

No. \_\_\_\_\_

FEE \_\_\_\_\_

# COMMONWEALTH OF MASSACHUSETTS

Board of Health, \_\_\_\_\_, MA.

## DISPOSAL SYSTEM CONSTRUCTION PERMIT

Permission is hereby granted to; Construct( ) Repair( ) Upgrade( ) Abandon( ) an individual sewage disposal system at \_\_\_\_\_ as described in the application for

Disposal System Construction Permit No. \_\_\_\_\_, dated \_\_\_\_\_.

Provided: Construction shall be completed within three years of the date of this permit. All local conditions must be met.

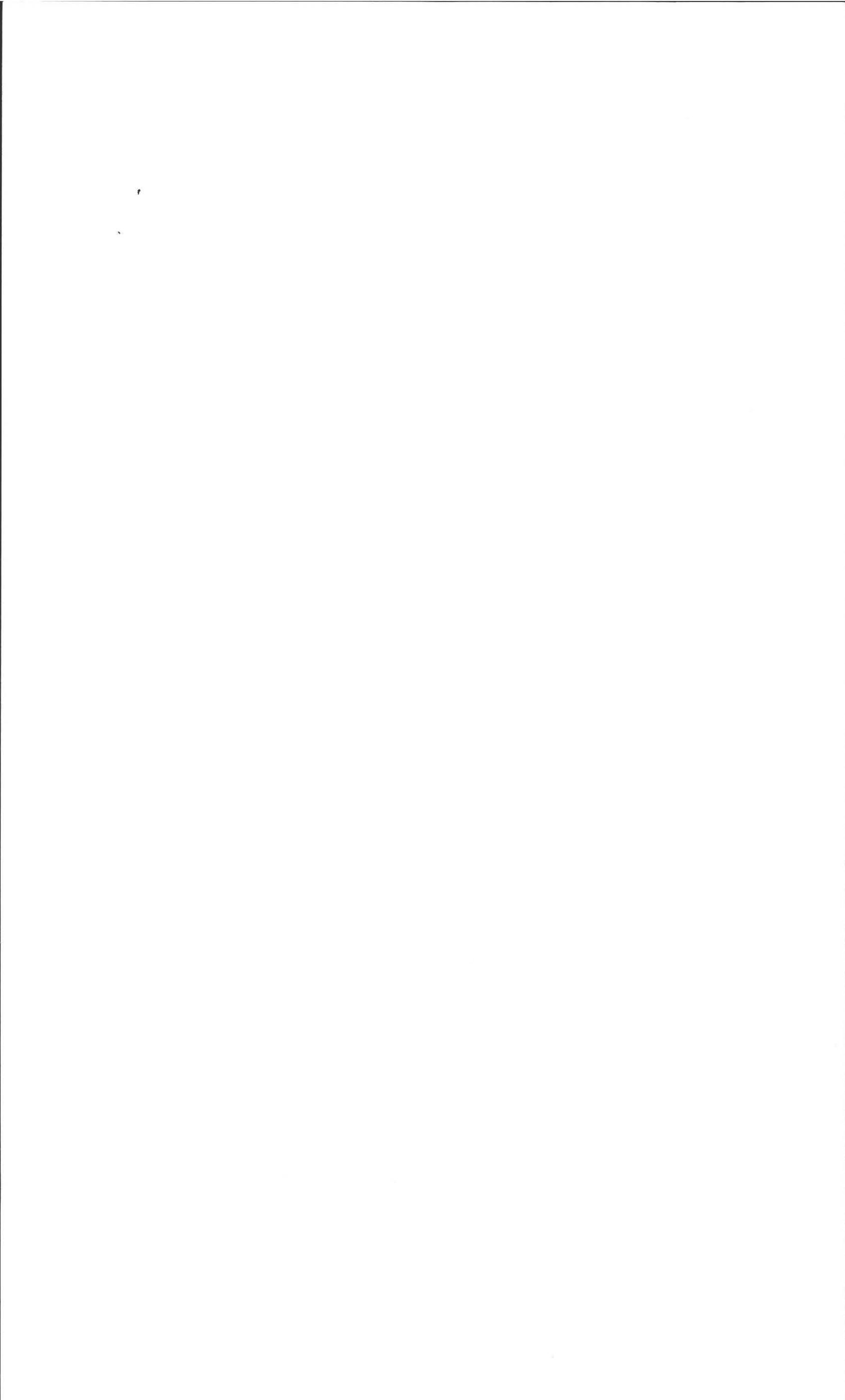

No. \_\_\_\_\_

FEE \_\_\_\_\_

# COMMONWEALTH OF MASSACHUSETTS

Board of Health, Amherst, MA.

## APPLICATION FOR DISPOSAL SYSTEM CONSTRUCTION PERMIT



Application for a Permit to Construct( ) Repair() Upgrade( ) Abandon( ) -  Complete System  Individual Components

Location <u>420 Meadow Rd</u>	Owner's Name <u>Mike Ziometz</u>
Map/Parcel# <u>40/11</u>	Address <u>420 Meadow St.</u>
Lot# <u>11</u>	Telephone# <u>413.549-5276</u>
Installer's Name	Designer's Name <u>Alan E. Weiss RS.</u>
Address	Address <u>Belchertown</u>
Telephone#	Telephone# <u>413.323.5957</u>

Type of Building Residence Lot Size 19,403± sq. ft.

Dwelling - No. of Bedrooms 4 Bedrooms Garbage grinder ( )

Other - Type of Building \_\_\_\_\_ No. of persons \_\_\_\_\_ Showers ( ), Cafeteria ( )

Other Fixtures \_\_\_\_\_

Design Flow (min. required) 110 gpd Calculated design flow 440 Design flow provided 445 gpd

Plan: Date 7/24/09 Number of sheets \_\_\_\_\_ Revision Date \_\_\_\_\_

Title Septic System Repair Plan

Description of Soil(s) Class I

Soil Evaluator Form No. \_\_\_\_\_ Name of Soil Evaluator A. Weiss Date of Evaluation 9/24/09

DESCRIPTION OF REPAIRS OR ALTERATIONS Install New Septic System

The undersigned agrees to install the above described Individual Sewage Disposal System in accordance with the provisions of TITLE 5 and further agrees to not to place the system in operation until a Certificate of Compliance has been issued by the Board of Health.

Signed \_\_\_\_\_ Date \_\_\_\_\_



Inspections \_\_\_\_\_

No. \_\_\_\_\_

FEE \_\_\_\_\_

# COMMONWEALTH OF MASSACHUSETTS

Board of Health, \_\_\_\_\_, MA.

## CERTIFICATE OF COMPLIANCE

Description of Work:  Individual Component(s)  Complete System

The undersigned hereby certify that the Sewage Disposal System; Constructed ( ), Repaired ( ), Upgraded ( ), Abandoned ( )

by: \_\_\_\_\_

at \_\_\_\_\_

has been installed in accordance with the provisions of 310 CMR 15.00 (Title 5) and the approved design plans/as-built plans relating to application No. \_\_\_\_\_, dated \_\_\_\_\_, Approved Design Flow \_\_\_\_\_ (gpd)

Installer \_\_\_\_\_

Designer: \_\_\_\_\_ Inspector: \_\_\_\_\_ Date: \_\_\_\_\_

The issuance of this permit shall not be construed as a guarantee that the system will function as designed.

No. \_\_\_\_\_

FEE \_\_\_\_\_

# COMMONWEALTH OF MASSACHUSETTS

Board of Health, \_\_\_\_\_, MA.

## DISPOSAL SYSTEM CONSTRUCTION PERMIT

Permission is hereby granted to; Construct( ) Repair( ) Upgrade( ) Abandon( ) an individual sewage disposal system at \_\_\_\_\_ as described in the application for

Disposal System Construction Permit No. \_\_\_\_\_, dated \_\_\_\_\_.

Provided: Construction shall be completed within three years of the date of this permit. All local conditions must be met.

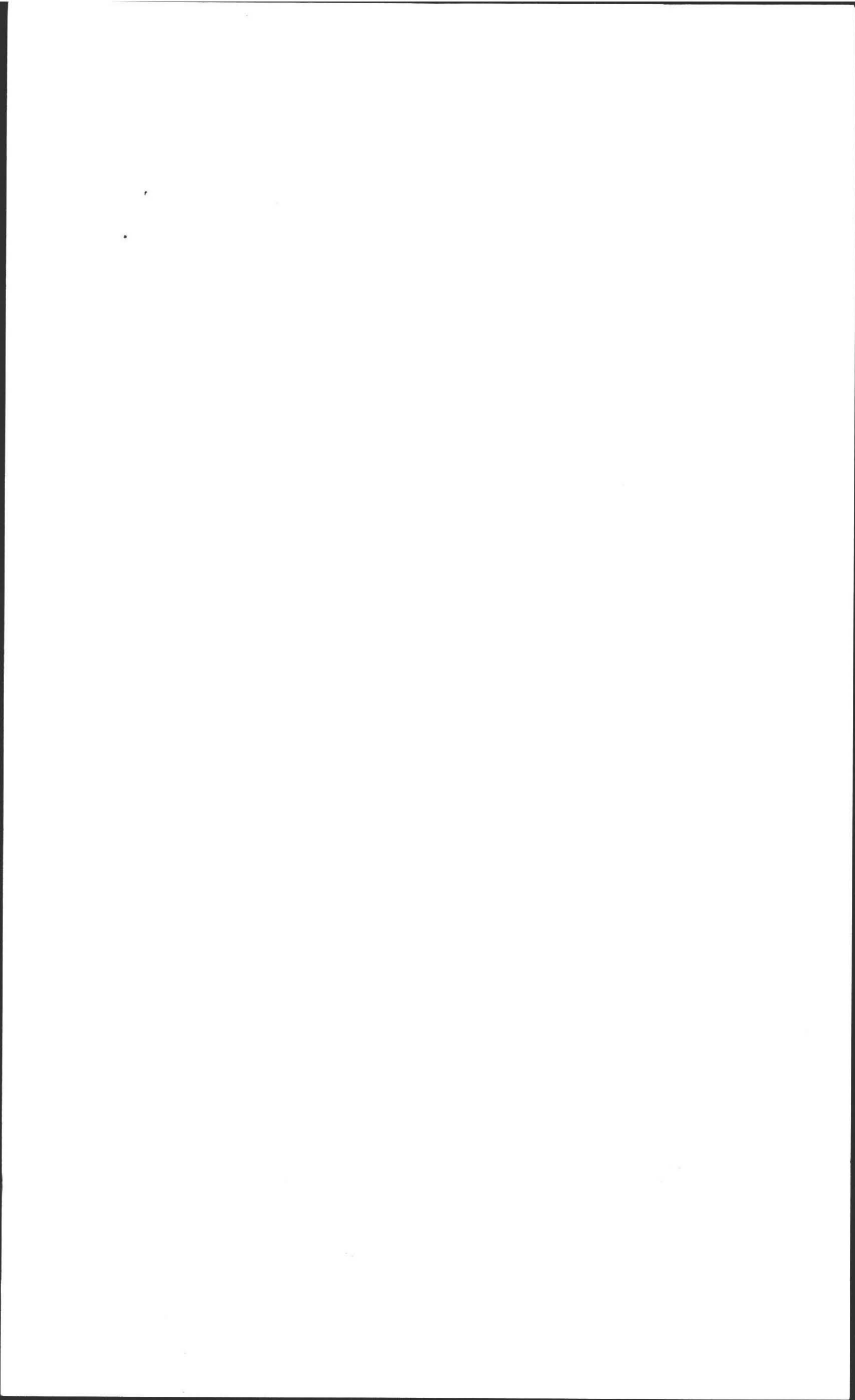



ALAN E. WEISS, M.S., L.S.P.

Licensed Site Professional  
Registered Sanitarian  
Hydrogeologist  
President

- Subsurface Investigations
- 21E Site Investigations
- Pollution Remediation
- Percolation Tests and Septic Designs

350 Old Enfield Rd.  
Belchertown, MA 01007  
(413) 323-5957 & 323-4916 (FAX)

Date: 9-24-09

Commonwealth of Massachusetts  
Amherst, Massachusetts

Soil Suitability Assessment for On-site Sewage Disposal

Performed By: A Weiss  
Witnessed By: G Courtmarche

Date:

Location Address or Lot # <u>420 Meadow St</u>	Owner's Name, Address, and Telephone # <u>MIKE ZIONCK</u> <u>420 Meadow St</u> <u>Amherst, MA,</u> <u>01002</u>
New Construction <input type="checkbox"/> Repair <input checked="" type="checkbox"/>	

Office Review

547-5276

Published Soil Survey Available: No  Yes

Year Published \_\_\_\_\_ Publication Scale \_\_\_\_\_ Soil Map Unit \_\_\_\_\_  
Drainage Class \_\_\_\_\_ Soil Limitations \_\_\_\_\_

Surficial Geologic Report Available: No  Yes

Year Published \_\_\_\_\_ Publication Scale \_\_\_\_\_

Geologic Material (Map Unit) \_\_\_\_\_

Landform \_\_\_\_\_

Flood Insurance Rate Map:

Above 500 year flood boundary No  Yes

Within 500 year flood boundary No  Yes

Within 100 year flood boundary No  Yes

Wetland Area:

National Wetland Inventory Map (map unit) \_\_\_\_\_

Wetlands Conservancy Program Map (map unit) \_\_\_\_\_

Current Water Resource Conditions (USGS): Month \_\_\_\_\_

Range :Above Normal  Normal  Below Normal

Other References Reviewed: \_\_\_\_\_



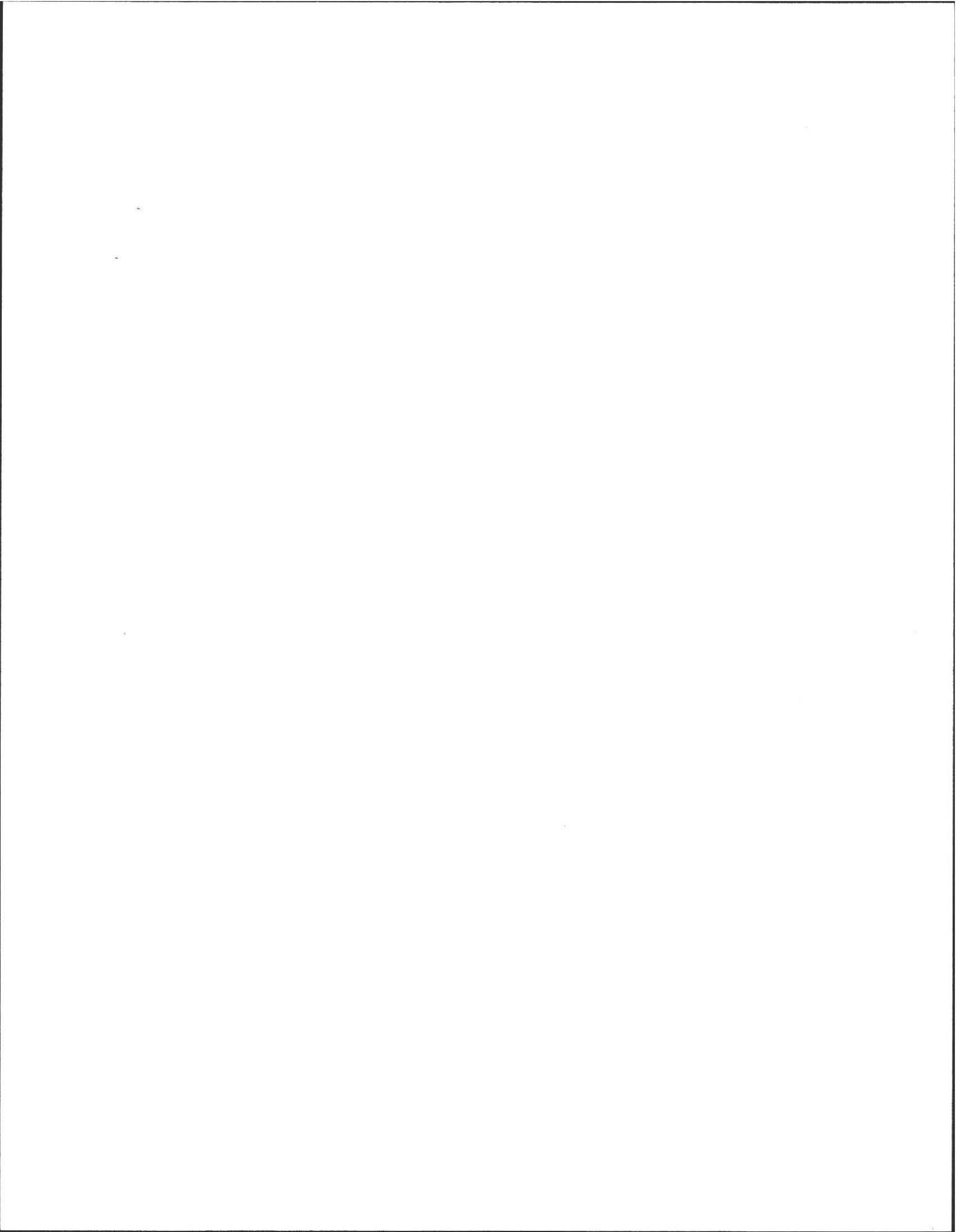

Location Address or Lot No. 420 Meadow ST

On-site Review

Deep Hole Number 1+2 Date: 9/24/09 Time: 9:00 Weather SUN 70°F

Location (identify on site plan) \_\_\_\_\_

Land Use Ag. C. Slope (%) 2 Surface Stones None

Vegetation grass

Landform Terrace plateau.

Position on landscape (sketch on the back) \_\_\_\_\_

Distances from:  
 Open Water Body 100+ feet  
 Possible Wet Area 100+ feet  
 Drinking Water Well \_\_\_\_\_ feet  
 "Nowalls in area"  
 Drainage way 25+ feet  
 Property Line 20' feet  
 Other \_\_\_\_\_

DEEP OBSERVATION HOLE LOG\*

#  
1  
  
2  
3

Depth from Surface (inches)	Soil Horizon	Soil Texture (USDA)	Soil Color (Munsell)	Soil Mottling	Other (Structure, Stones, Boulders, Consistency, % Gravel)
0-18	Ap	FSL	10YR3/2		-Friable
18-26	Bw	LS	2.5Y5/6	7B	-Friable, loose
26"-110"	C <sub>1</sub>	LS	2.5Y5/2	10YR6/8	Fine Sand, granular, little silt, varved.
0-14"	Ap	FSL	10YR3/2		-friable
14"-24"	Bw	LS	2.5Y5/6		-friable loose
24"-100"	C <sub>1</sub>	LS	2.5Y5/2	4B 10YR6/8	-Fine Sand, granular.

\* MINIMUM OF 2 HOLES REQUIRED AT EVERY PROPOSED DISPOSAL AREA

Parent Material (geologic) Limestone - Sand. Depth to Bedrock: 120"

Depth to Groundwater: Standing Water in the Hole: 100" Weeping from Pit Face: 80"-86"

Estimated Seasonal High Ground Water: 48-50"

↳ Established where matrix color was grey" as well



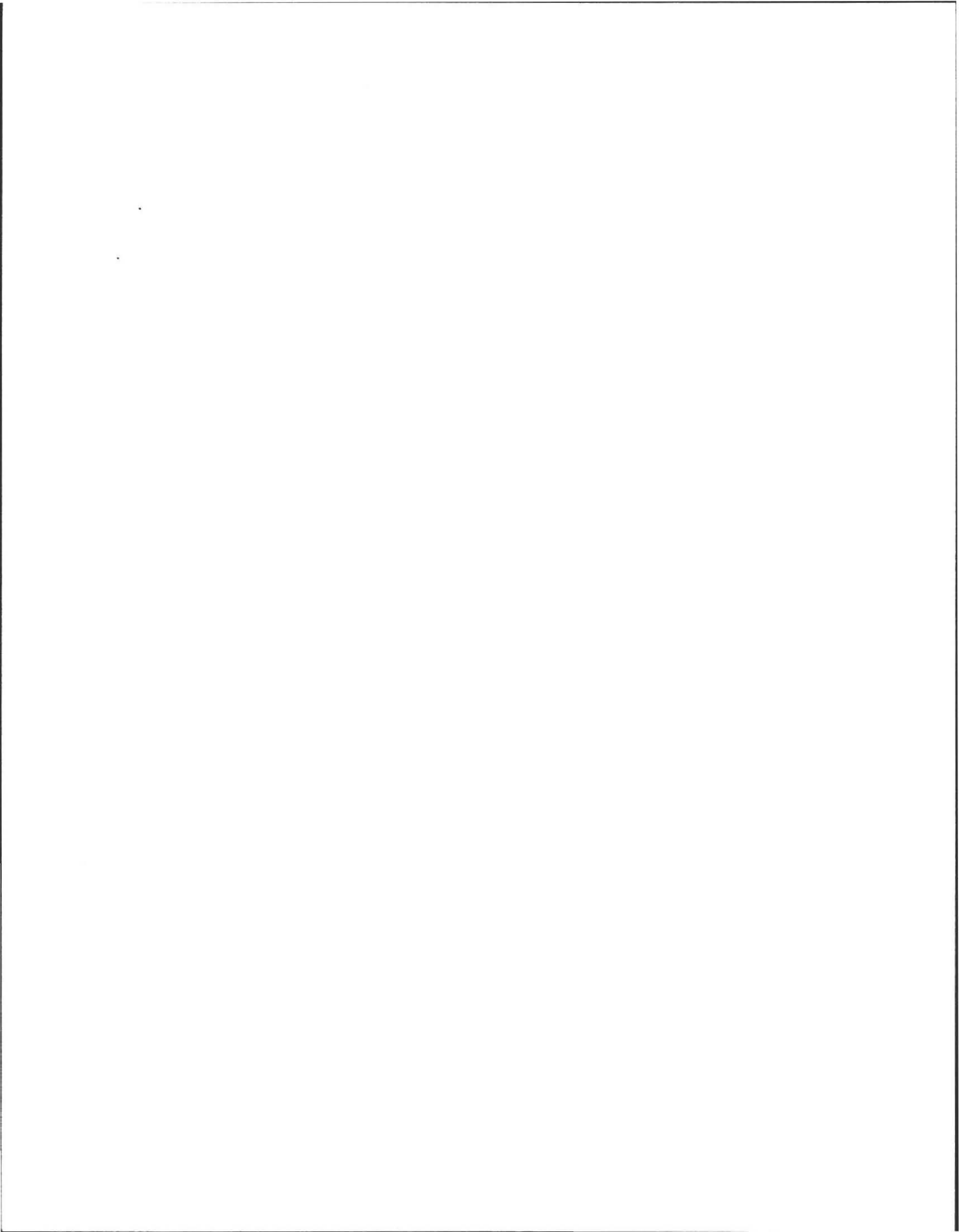

Location Address or Lot No. 470 Meadow St

COMMONWEALTH OF MASSACHUSETTS  
 Amherst, Massachusetts

Percolation Test*		
Date: <u>9/24/09</u>		Time: _____
Observation Hole #	<u>P1</u>	Repair 
Depth of Perc	<u>60"</u>	
Start Pre-soak	<u>8:45</u>	
End Pre-soak	<u>9:00</u>	
Time at 12"	<u>9:00</u>	
Time at 9"	<u>9:06</u>	
Time at 6"	<u>9:14</u>	
Time (9"-6")	<u>8 MIN</u>	
Rate Min./Inch	<u>3 MIN IN.</u>	

\* Minimum of 1 percolation test must be performed in both the primary area AND reserve area.

Site Passed  Site Failed

Performed By: A. Weiss

Witnessed By: C Courtmanche

Comments: \_\_\_\_\_



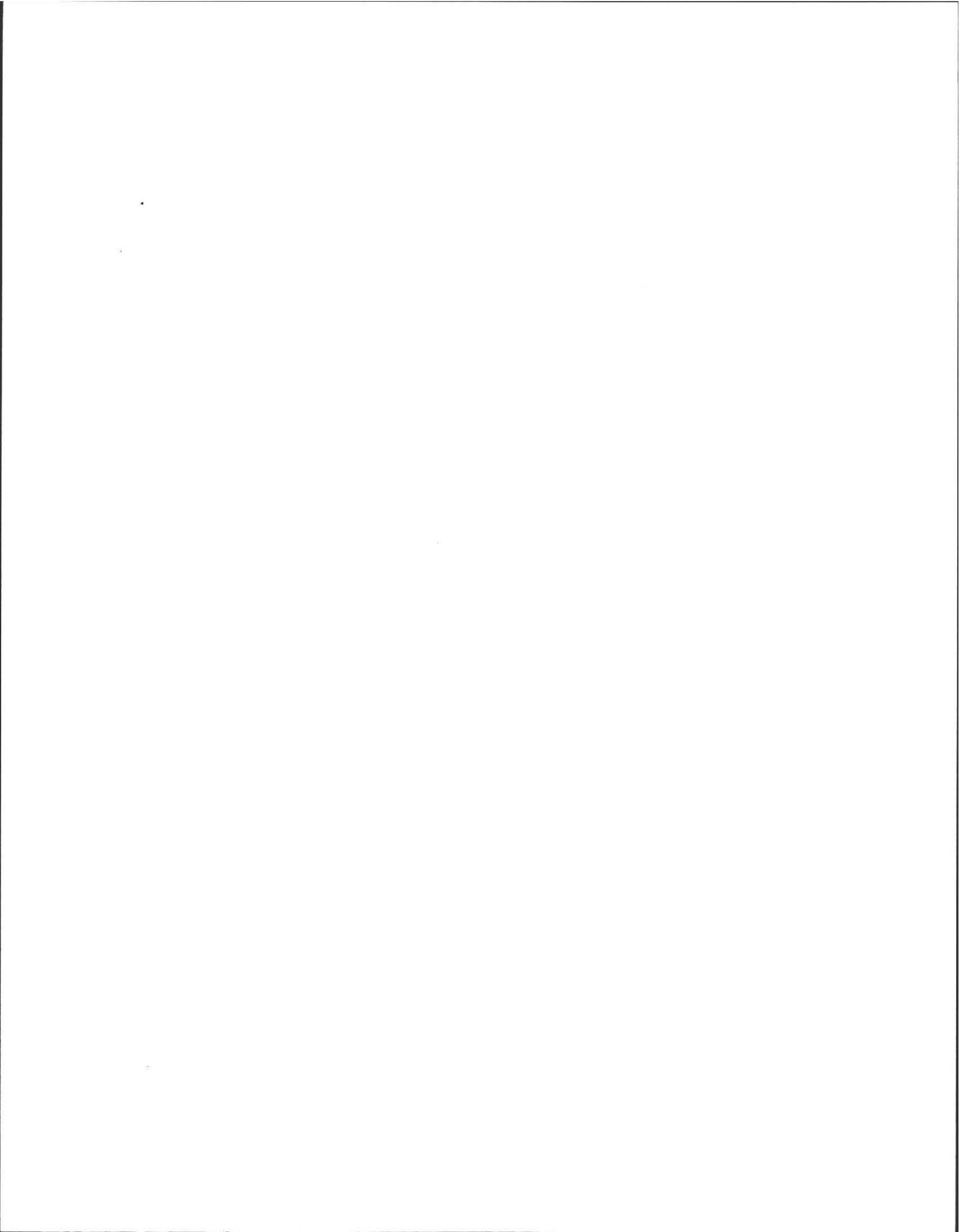

Location Address or Lot No. 470 Meadow ST.

### Determination for Seasonal High Water Table

Method Used:

- Depth observed standing in observation hole ..... inches
- Depth weeping from side of observation hole ..... inches
- Depth to soil mottles 48-50" inches
- Ground water adjustment ..... feet

Index Well Number ..... Reading Date ..... Index well level

Adjustment factor ..... Adjusted ground water level .....

Depth of Naturally Occurring Pervious Material

Does at least four feet of naturally occurring pervious material exist in all areas observed throughout the area proposed for the soil absorption system? YES

If not, what is the depth of naturally occurring pervious material? \_\_\_\_\_

Certification

I certify that on 6/95 (date) I have passed the soil evaluator examination approved by the Department of Environmental Protection and that the above analysis was performed by me consistent with the required training, expertise and experience described in 310 CMR 15.017.

Signature AL Date 9/24/09

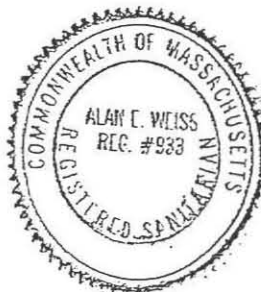

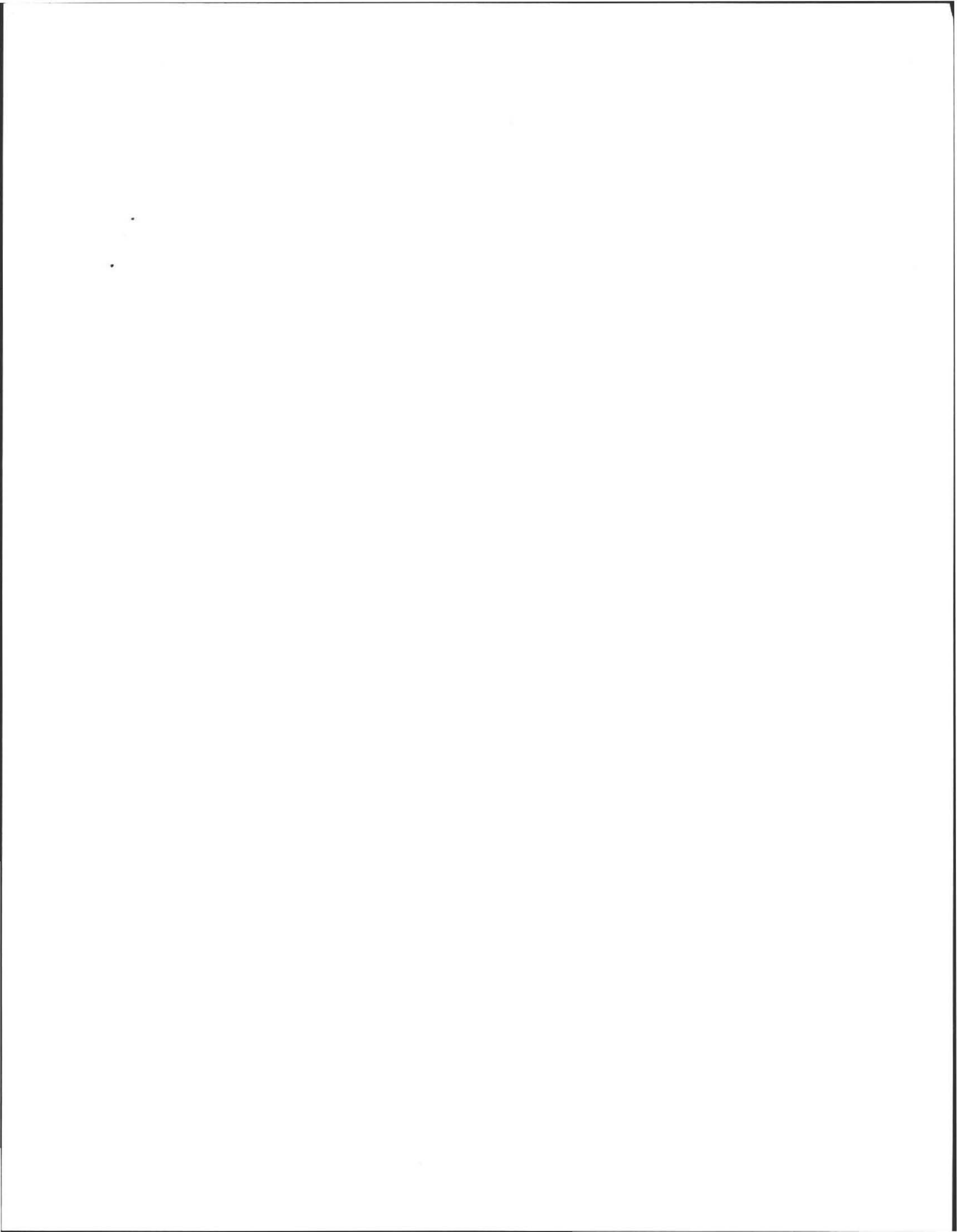



NOTE TO HOMEOWNER: MOUNDS, WHERE USED, ARE REQUIRED BY STATE CODE TO MAXIMIZE THE DISTANCE FROM THE BOTTOM OF THE LEACHING FIELD TO THE TOP OF THE ESTIMATED HIGH GROUNDWATER. THIS "SEPARATION" FROM HIGH GROUNDWATER (3.4, OR 5 FEET), IS NOT THE SAME AS THE HEIGHT OF THE FINISHED MOUND SURFACE. THE ACTUAL FINISHED MOUND IS TYPICALLY HIGHER THAN THE "SEPARATION". BY SIGNING PERMIT YOU ACKNOWLEDGE THAT COLD SPRING ENVIRONMENTAL CONSULTANTS INC. IS NOT RESPONSIBLE FOR THE AESTHETICS OF FILLED OR MOUNDED SYSTEMS.

NOTE TO INSTALLER: A PLUMBER MUST INSPECT INSIDE PLUMBING AND FIX ANY LEAKING FAUCETS OR TOILETS IF FOUND TO BE LEAKING OR FLOWING IMPROPERLY INTO SEPTIC SYSTEM PRIOR TO FINAL INSPECTION.

USING EXISTING SEPTIC TANKS:  
AN EXISTING 1,000 OR 1,500 GALLON SEPTIC TANK CAN BE USED IF UPON INSPECTION BY THE INSTALLING CONTRACTOR, IF THE TANK IS INSPECTED AND PUMPED AND FOUND TO BE STRUCTURALLY SOUND AT THE TIME OF THE SUBGRADE INSPECTION. IF BAFFLES ARE NOT BUILT IN, THAN SCH 40 PVC TEES MUST BE ADDED. IF TANK IS NOT SOUND THAN, NOTIFY ENGINEER IMMEDIATELY IN ORDER TO ACCOMMODATE A NEW 1,500 GALLON (MIN.) SEPTIC TANK.

PLOT PLAN  
MAP 4D LOT 11  
SCALE: 1"=30'  
19,403± Sq. Ft.  
0.445± Ac.

NOT AN ACTUAL SURVEY!!  
LINES DRAWN FOR SEPTIC LOCATION PURPOSES ONLY!

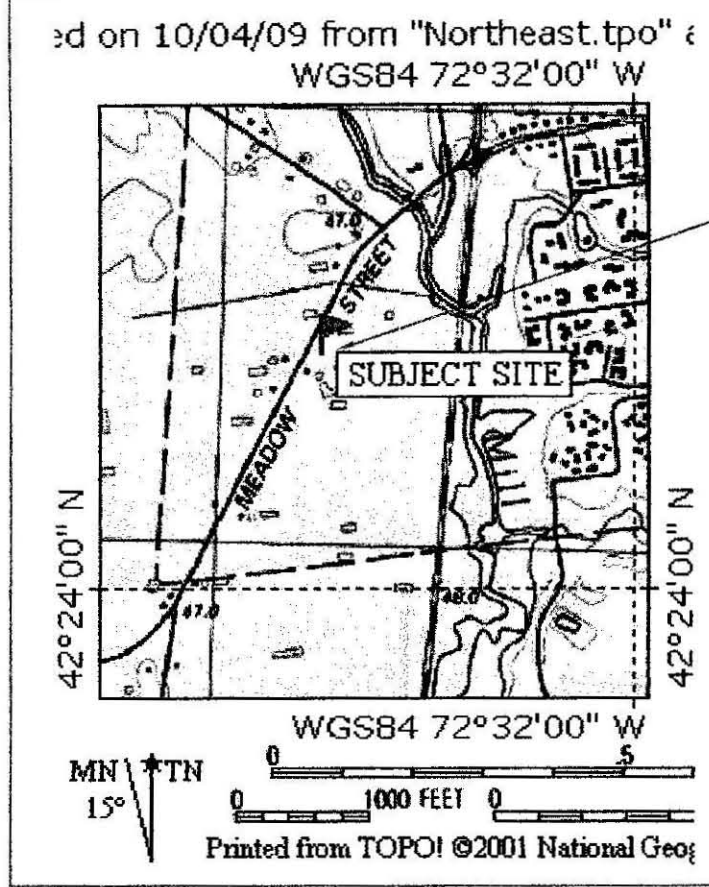
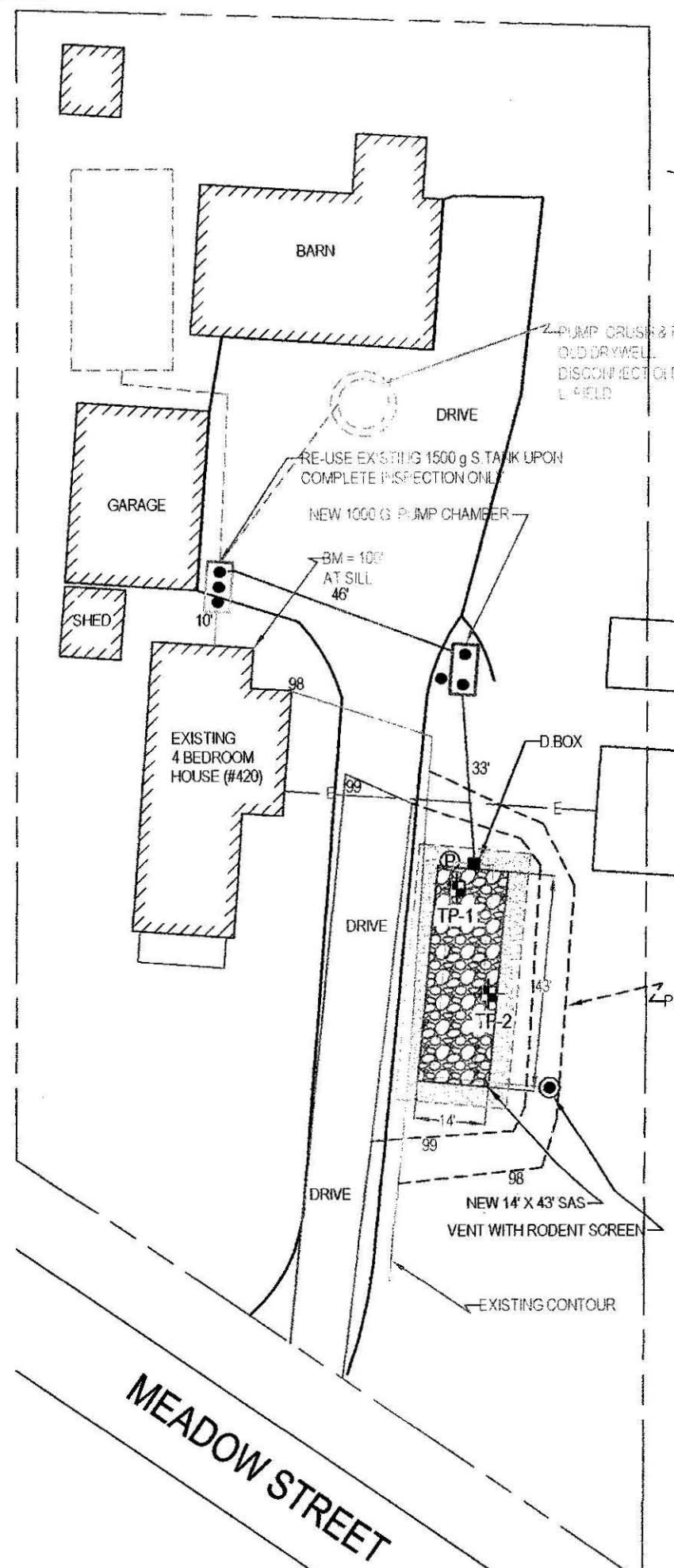

SUBJECT SITE LOCATION

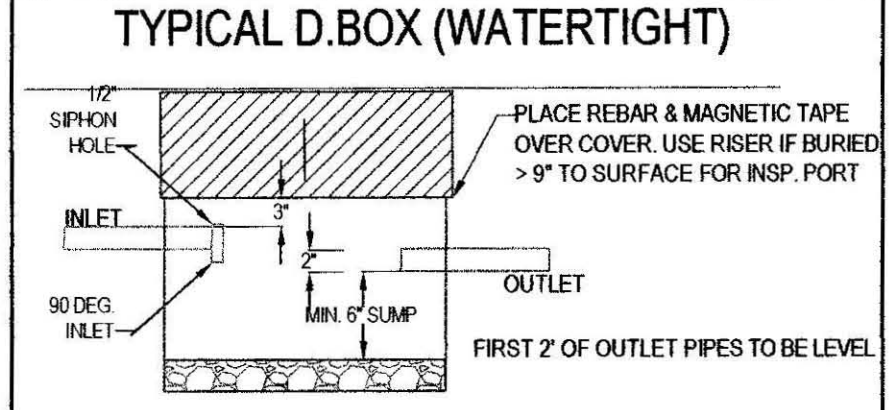

- PLACE ON STABLE 6" BASE OF 3/4" TO 1-1/2" D.W. STONE
- USE CONCRETE BOX WITH 2" MINIMUM WALL THICKNESS.
- FILL WITH WATER FOR FINAL INSPECTION.
- USE LARGE STYLE D.BOX 6 outlet (Underground Supply)
- ADAPT FROM 2" TO 4" BEFORE BOX IF PUMPED.

**EFFLUENT DISPOSAL AREA**  
CROSS SECTION - NOT TO SCALE  
(LEVEL DISPOSAL AREA)  
NUMBER OF SEPTIC LINES: 2  
CENTER TO CENTER SPACING: 6'

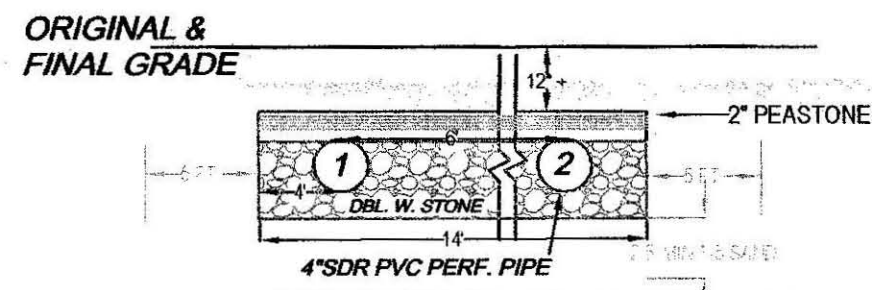

- PUMP CHAMBER/MOUNDED SEPTIC SYSTEM OPERATION AND MAINTENANCE NOTES FOR HOMEOWNER:**
- HAVE SEPTIC TANK PUMPED EVERY SECOND (2) YEARS.
  - HAVE Tank, PUMP AND PUMP CHAMBER & OUTLET FILTER & D BOX INSPECTED ANNUALLY
  - MAKE CERTAIN TO TEST HI WATER SHUT OFF ALARM ANNUALLY.
  - MAINTAIN AREA OVER SEPTIC AS GRASSY OR SIMILAR GROUND COVER ATTEMPTING TO MAXIMIZE SUNLIGHT TO AREA.
  - DO NOT PLANT ANY TREES OR DEEP ROOTING SHRUBS WITHIN 10 FEET OF LEACHFIELD.
  - USE ONLY LIQUID DETERGENTS IN WASHER OR DISHWASHER.
  - CONSERVE WATER WHEREVER POSSIBLE TO LENGTHEN LIFE OF SYSTEM. USE WATER SAVING DEVICES AND FIXTURES ONLY.
  - KEEP ALL RUNOFF DRAINS SUCH AS GUTTERS OR CURTAIN DRAINS AT LEAST 25 FEET FROM LEACHING FIELD.

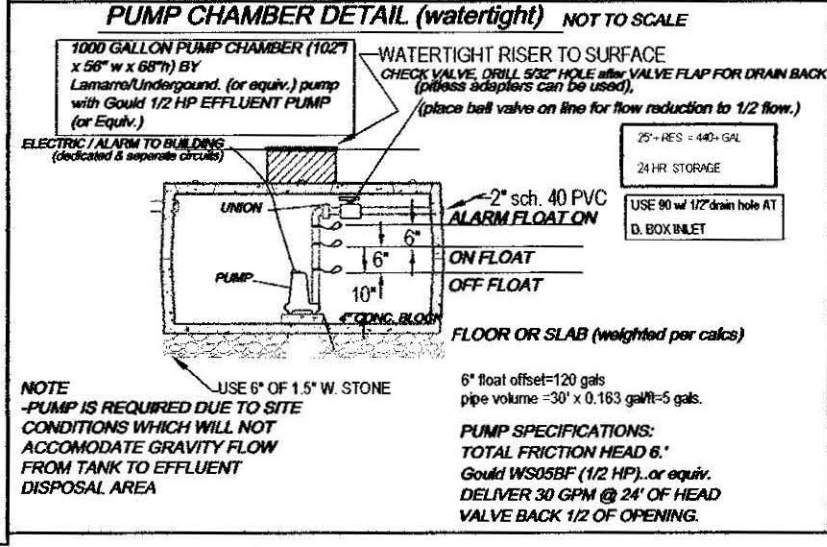
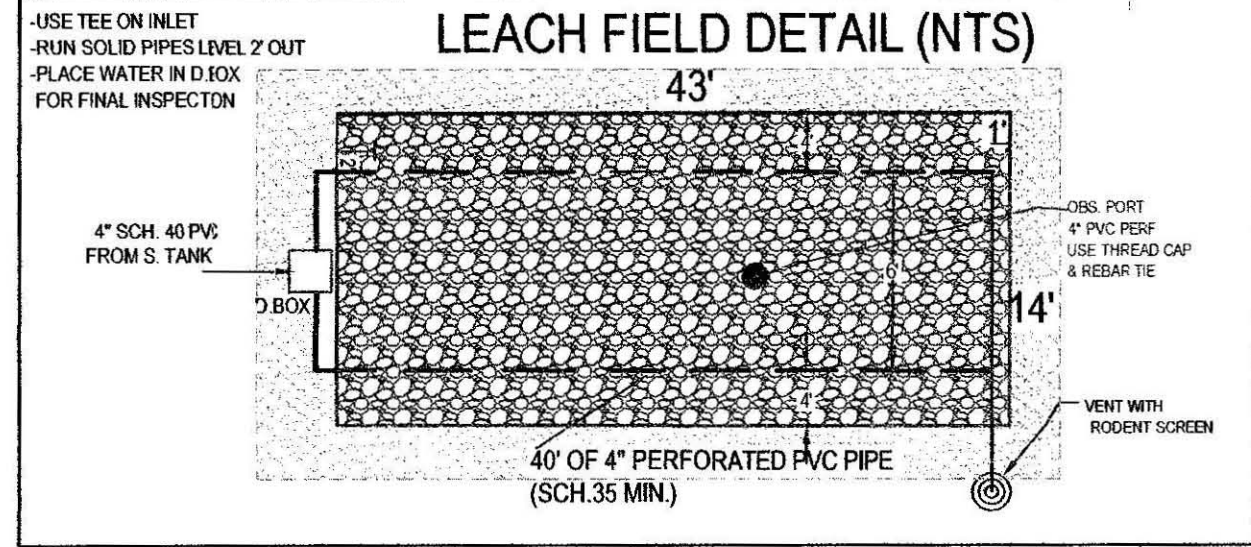

**DESIGN NOTES AND CALCULATIONS:**

- 1.) 4 BEDROOM HOME X 110 GPD /BR = 440 GPD. REQUIRED,
- Use ONE FIELD: 14' WIDE X 43' LONG WITH 6" OF 3/4" TO 1 1/2" DBL WASHED STONE BELOW INVERT
  - BOTTOM AREA: 14' W X 43' L = 602 SF.
  - SIDE AREA: 0 SF.
  - TOTAL AREA: 602 SF X 0.74 GAL/SF = 445 GPD
- GARBAGE DISPOSAL NOT ALLOWED, ...
  - NO OTHER PRIVATE WELLS WITHIN 100 FEET OF SAS (TOWN WATER).
  - NO OTHER WETLANDS WITHIN 100 FEET OF SAS
  - USE EXISTING 1,500 GAL S. TANK UPON COMPLETE INSPECTION ONLY. INSTALL OUTLET BAFFLE
  - INSTALL & INSPECT SCH. 40 TEES / BAFFLES (10" INLET, 14" OUTLET),
  - USE NEW 1000 GALLON PUMP CHAMBER
- NOTE:  
- ALL COMPONENTS OF NEW SYSTEM MUST BE MARKED WITH MAGNETIC TAPE. BE SURE TO MAINTAIN 3" CLEARANCE FROM TOP OF TEES TO BOTTOM OF TANK COVERS & BOXES.
- USE LARGE STYLE (6 OUTLET) D.BOX ONLY.
  - ALL D. BOX OUTLET PIPES LEVEL FOR FIRST 2'. BOXES MUST HAVE 2"+ CONC. WALLS
- NOTE:  
- D. BOXES WITH MORE THAN 9" OF COVER SOIL MUST HAVE RISERS TO 6" OF SURFACE.
- USE APPROVED (.75"-1 1/2") DBL. WASHED STONE UNDER TANK & D. BOX FOR 6".
  - CONFIRM STONE PROPERLY DOUBLE WASHED PRIOR TO PLACEMENT.
  - USE PROPER SCH. 40 PVC TEES AS SHOWN.
  - PRE & POST CONTOURS NOTED AS NECESSARY, RESERVE AS NOTED (not required for repairs).
  - SLOPE CALCS (SEE CONTOURS). SUBGRADE INSP. REQD.
  - USE FIELD DUE TO TOPOGRAPHY AND SPACE OF LOT WITH RESPECT TO LOCATION AND ELEVATION OF RESIDENCE (310 CMR 15.240)
  - USE 2% MIN. SLOPE OVER SAS
  - CLEAR TOP AND SUB TO 24" MIN. AS NEEDED (INSPECTION REQUIRED).
  - CLEAR PAST BASE OF B (MIN. 24") & SCARIFY UNDER BED PRIOR TO TITLE V SAND/STONE PLACEMENT.
  - EXCAVATE EXISTING LOAM, SUB AND ANY EXISTING DEBRIS, DIRTY FILL OR PRIOR SYSTEM IF PRESENT.
  - SOIL EVALUATION: BY A. WEISS, RS. ON 9/24/09 (G. COURTMARCHE, BOH AGENT).
  - DEPTH OF PERC. 60"
  - PERC RATE = 3 MIN/IN,
  - CLASS I SOIL RATING
  - NO TREES WITHIN 10 FT. OF NEW LEACH FIELD.
  - ENGINEER & TOWN (IF REQUIRED) TO INSPECT SUBGRADE, TOWN AND ENGINEER INSPECT AT FINAL
  - BM=100.00 @ (WALK OUT DOOR SILL, as noted), CONFIRM PROPER PIPE SLOPES
  - USE/INSPECT SCH. 40 PIPE FOR PIPE FROM HOUSE TO NEW OR EXISTING TANK
  - GRADE MULCH AND SEED OVER SAS AS NOTED.
  - INSTALLATION IN FLOW GROUNDWATER SEASON RECOMMENDED.
  - USE OBSERVATION PORT NEAR CENTER OF STONE BED HAVE 4" PERFORATED, PVC INSPECTION PORTALS TO BOTTOM OF STONE BED, WITH RISER TO 3" OF SURFACE & THREADED CAP & MARK WITH RE-BAR.

**TEST PIT LOG:**

TP-1 EFF. ELEV. 97.30				SOIL EVALUATOR: A. WEISS, RS				DATE OF EVALUATION: 9/24/09			
DEPTH	HORIZ	TEXTURE	PERC. (MINIBELL)	MATERIAL	DEPTH	HORIZ	TEXTURE	PERC. (MINIBELL)	MATERIAL		
0-18	A	FSL	10 YR 3/2	FRIABLE	0-14	A	FSL	10 YR 3/2	FRIABLE		
18-26	Bw	LS	2.5 Y 5/6	FRIABLE, LOOSE	14-24	Bw	LS	2.5 Y 5/6	FRIABLE, LOOSE		
26-110	C1	LS	2.5 Y 5/2	F. SAND, GRANULAR, LITTLE SILT, VARVED	24-100	C1	LS	2.5 Y 5/2	F. SAND, GRANULAR		

  

OXIDES:	10 YR 6/8	OBSERVED @ 48"	OXIDES:	10 YR 6/8	OBSERVED @ 48"
EHWT:	48"=93.3'		EHWT:	48"	
STANDING H2O:	100'		STANDING H2O:	100'	
WEEPING:	80-86		WEEPING:	80-86	
BEDROCK:	110'+		BEDROCK:	110'+	

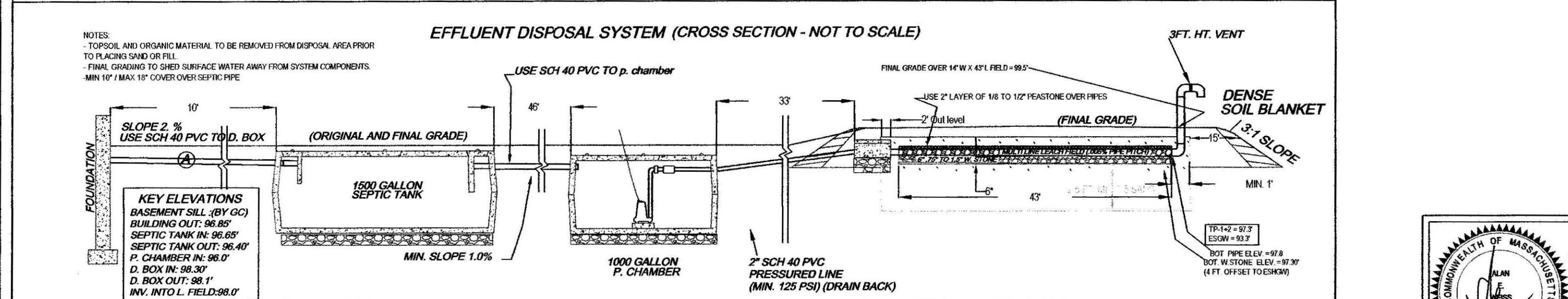

ATTENTION INSTALLER!!  
CALL DIG SAFE BEFORE YOU DIG!! MASSACHUSETTS STATE LAW CHAPTER 82 SECTIONS 4 - 40E REQUIRE THAT PREMARKING OF GAS, ELECTRIC, WATER, TELEPHONE AND CABLE T.V. UTILITY LINES BE MADE A MINIMUM OF 72 HOURS PRIOR TO GROUND BREAK FOR ANY EXCAVATION.

NOTE: INSTALLER MUST CONTACT ENGINEER/BD OF HEALTH 48 HOURS PRIOR TO SUBGRADE INSPECTION. INSTALLER MUST HAVE ALL BREAK OUT FILL ON SITE AND IN PLACE PRIOR TO SIGN OFF BY ENGINEER AT TIME OF FINAL INSPECTION OR APPROVAL WILL NOT BE GIVEN TO BACKFILL.

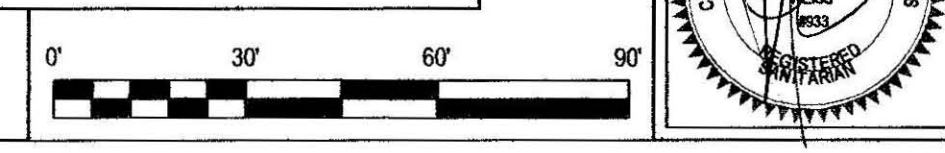

SEPTIC SYSTEM REPAIR PLAN FOR MIKE ZIOMEK  
420 MEADOW STREET  
AMHERST, MA.

**Cold Spring Environmental Consultants Inc.**  
350 Old Enfield Road  
Belchertown, MA. 01007

PHONE: (413) 323-5957  
FAX: (413) 323-4916  
E-Mail: AEW@CSEI.com

DATE: 9/24/09  
SCALE: 1"=30'

DRAWN BY: ARS  
CHECKED BY: AEW

REVISED:  
DRAWING NUMBER: 109-3239-0924

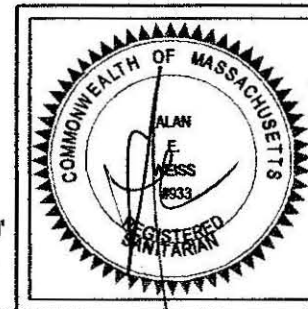

**NOTE TO HOMEOWNER: MOUNDS, WHERE USED, ARE REQUIRED BY STATE CODE TO MAXIMIZE THE DISTANCE FROM THE BOTTOM OF THE LEACHING FIELD TO THE TOP OF THE ESTIMATED HIGH GROUNDWATER. THIS "SEPARATION" FROM HIGH GROUNDWATER (3.4 OR 5 FEET), IS NOT THE SAME AS THE HEIGHT OF THE FINISHED MOUND SURFACE. THE ACTUAL FINISHED MOUND IS TYPICALLY HIGHER THAN THE "SEPARATION". BY SIGNING PERMIT YOU ACKNOWLEDGE THAT COLD SPRING ENVIRONMENTAL CONSULTANTS INC. IS NOT RESPONSIBLE FOR THE AESTHETICS OF FILLED OR MOUNDED SYSTEMS.**

**NOTE TO INSTALLER: A PLUMBER MUST INSPECT INSIDE PLUMBING AND FIX ANY LEAKING FAUCETS OR TOILETS IF FOUND TO BE LEAKING OR FLOWING IMPROPERLY INTO SEPTIC SYSTEM PRIOR TO FINAL INSPECTION.**

**USING EXISTING SEPTIC TANKS:**  
 AN EXISTING 1,000 OR 1,500 GALLON SEPTIC TANK CAN BE USED IF UPON INSPECTION BY THE INSTALLING CONTRACTOR, IF THE TANK IS INSPECTED AND PUMPED AND FOUND TO BE STRUCTURALLY SOUND AT THE TIME OF THE SUBGRADE INSPECTION. IF BAFFLES ARE NOT BUILT IN, THAN SCH 40 PVC TEES MUST BE ADDED. IF TANK IS NOT SOUND THAN, NOTIFY ENGINEER IMMEDIATELY IN ORDER TO ACCOMMODATE A NEW 1,500 GALLON (MIN) SEPTIC TANK.

**PLOT PLAN  
 MAP 4D LOT 11  
 SCALE: 1"=30'  
 19,403± Sq. Ft.  
 0.445± Ac.**

**NOT AN ACTUAL SURVEY!!  
 LINES DRAWN FOR SEPTIC  
 LOCATION PURPOSES ONLY!**

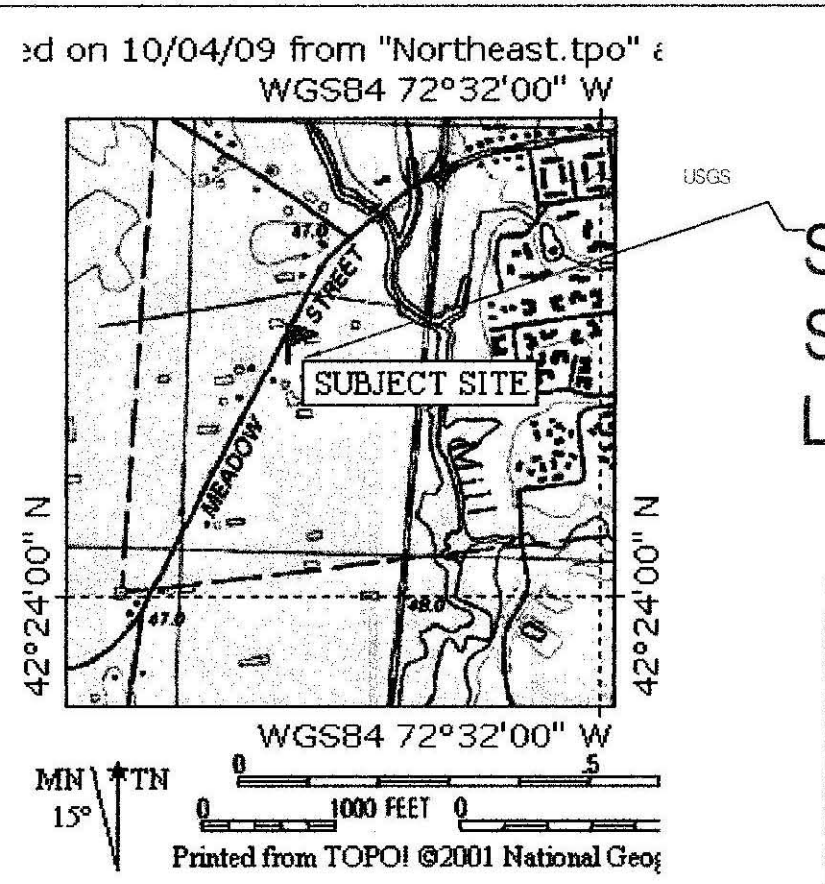
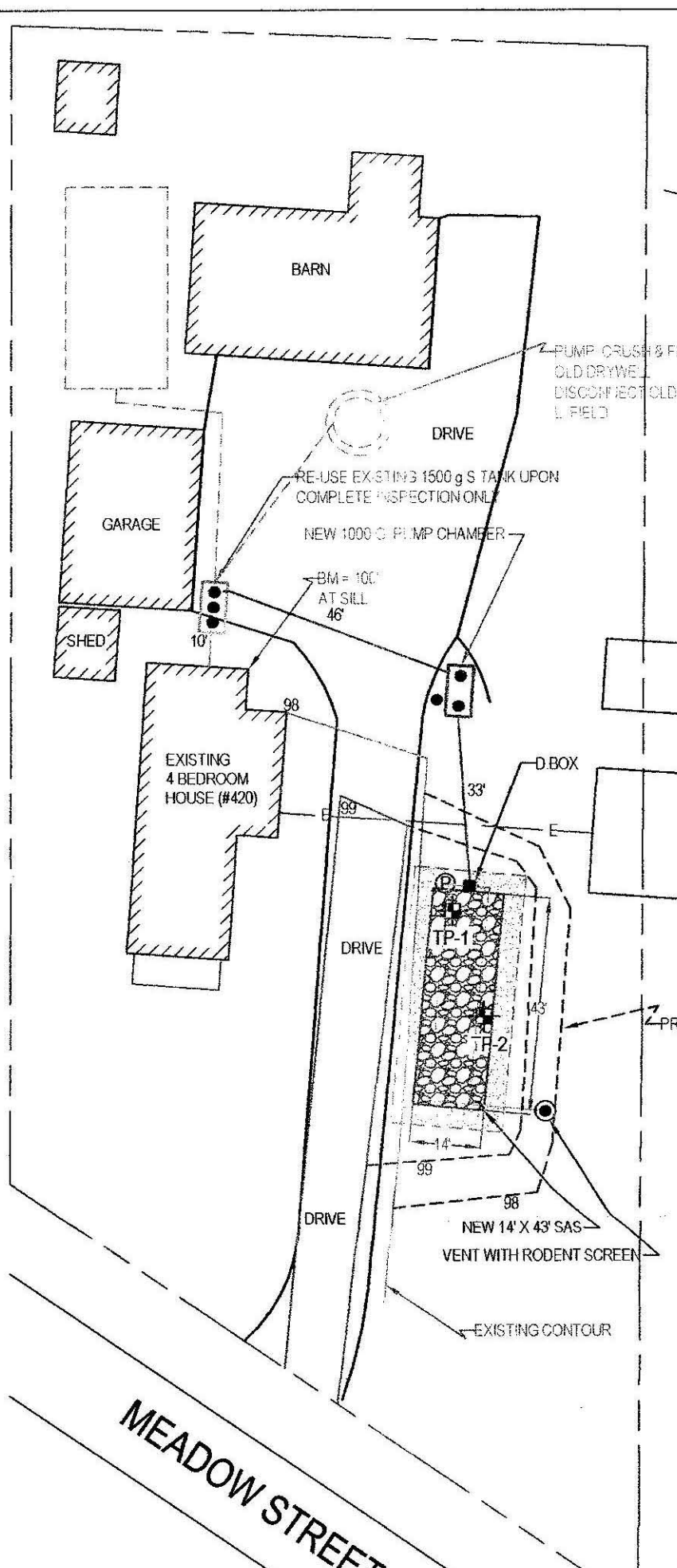

**SUBJECT  
 SITE  
 LOCATION**

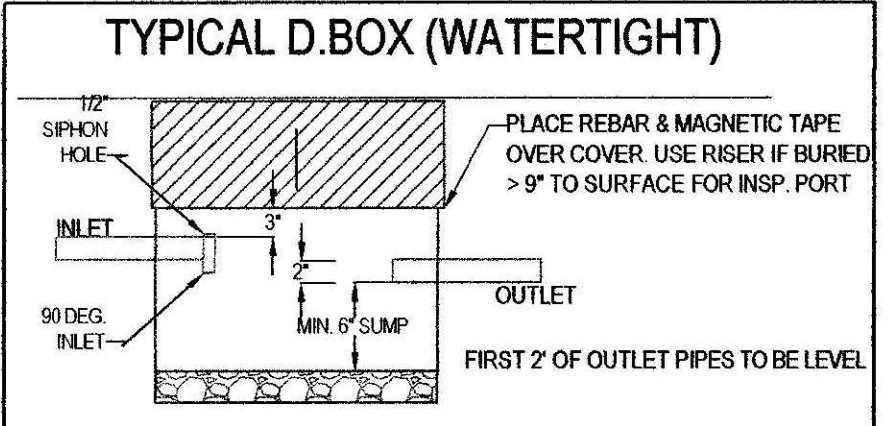

**TYPICAL D.BOX (WATERTIGHT)**  
 - PLACE ON STABLE 6" BASE OF 3/4" TO 1-1/2" D.W. STONE  
 - USE CONCRETE BOX WITH 2" MINIMUM WALL THICKNESS.  
 - FILL WITH WATER FOR FINAL INSPECTION.  
 - USE LARGE STYLE D.BOX 6 outlet (Underground Supply)  
 - ADAPT FROM 2" TO 4" BEFORE BOX IF PUMPED.

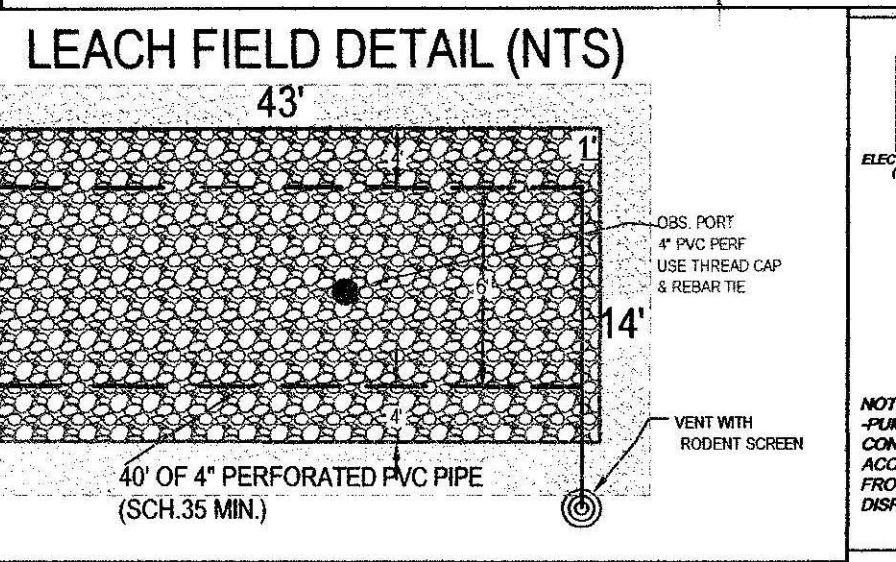
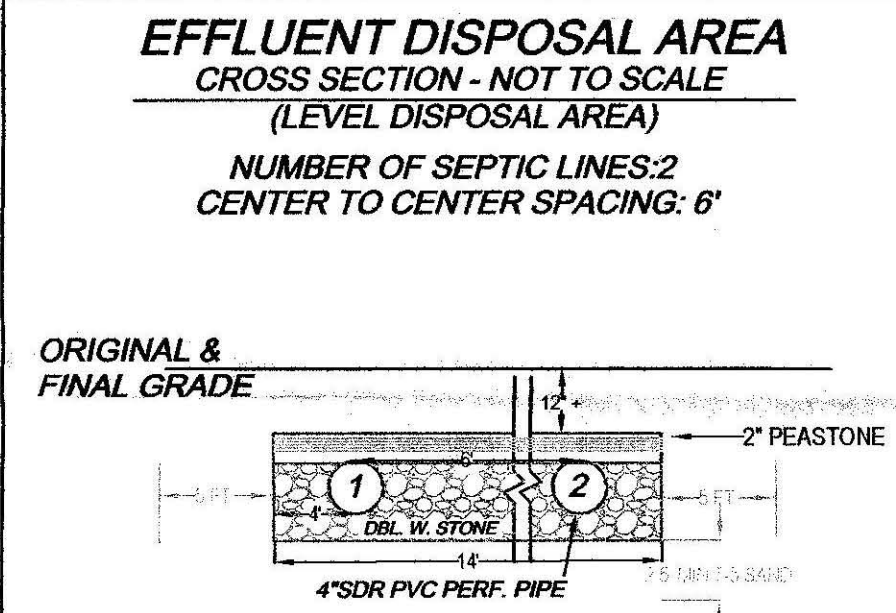

**PUMP CHAMBER/MOUNDED SEPTIC SYSTEM OPERATION AND MAINTENANCE NOTES FOR HOMEOWNER:**  
 1. HAVE SEPTIC TANK PUMPED EVERY SECOND (2) YEARS.  
 2. \*\*HAVE Tank, PUMP AND PUMP CHAMBER & OUTLET FILTER & D BOX INSPECTED ANNUALLY.  
 3. MAKE CERTAIN TO TEST HI WATER SHUT OFF ALARM ANNUALLY.  
 4. MAINTAIN AREA OVER SEPTIC AS GRASSY OR SIMILAR GROUND COVER ATTEMPTING TO MAXIMIZE SUNLIGHT TO AREA.  
 5. DO NOT PLANT ANY TREES OR DEEP ROOTING SHRUBS WITHIN 10 FEET OF LEACHFIELD.  
 6. USE ONLY LIQUID DETERGENTS IN WASHER OR DISHWASHER.  
 7. CONSERVE WATER WHEREVER POSSIBLE TO LENGTHEN LIFE OF SYSTEM. USE WATER SAVING DEVICES AND FIXTURES ONLY.  
 8. KEEP ALL RUNOFF DRAINS SUCH AS GUTTERS OR CURTAIN DRAINS AT LEAST 25 FEET FROM LEACHING FIELD.

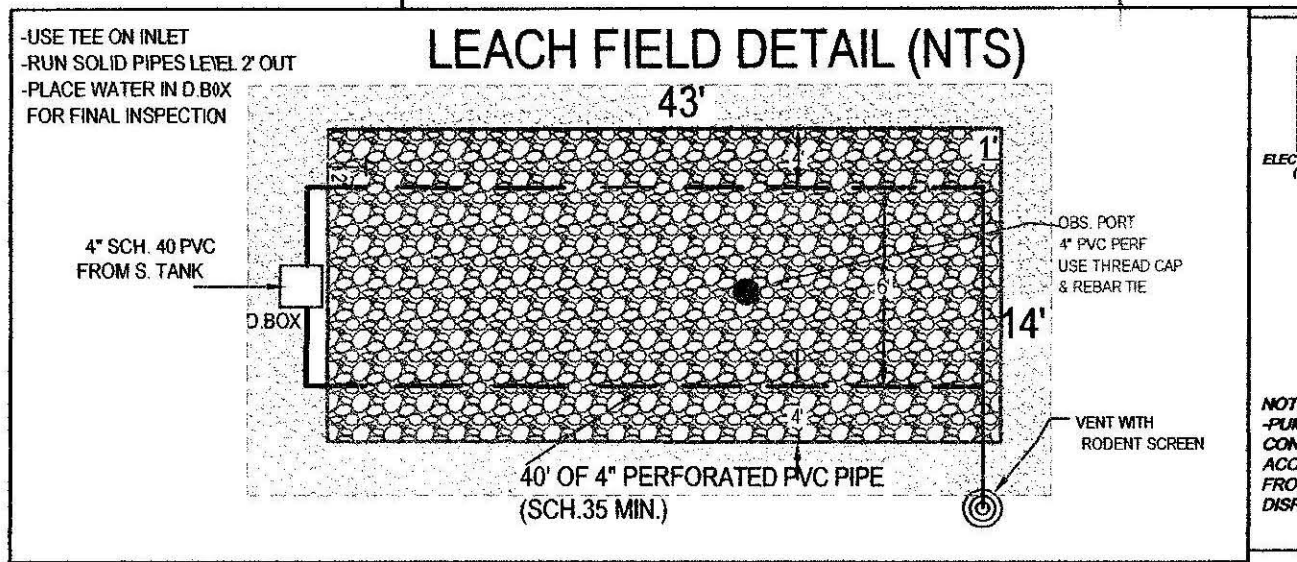
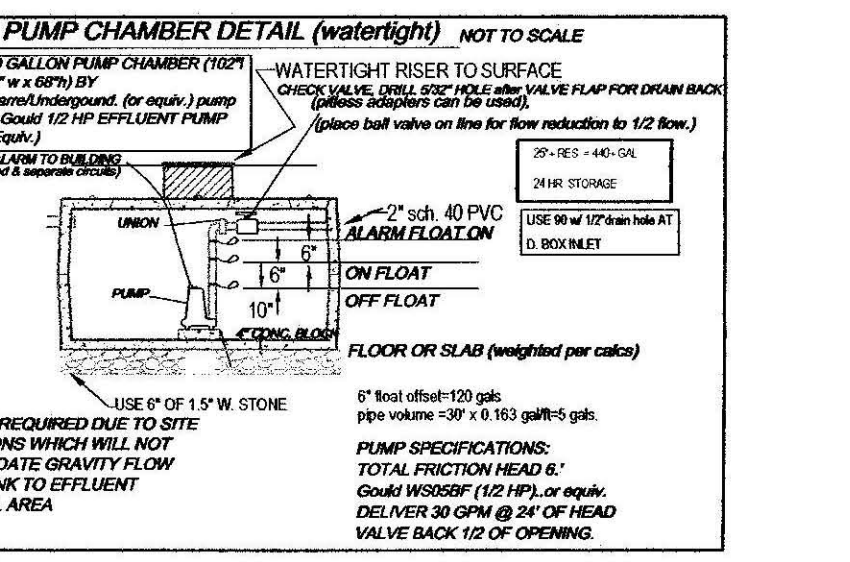

**DESIGN NOTES AND CALCULATIONS:**  
 1.) 4 BEDROOM HOME X 110 GPD /BR = 440 GPD. REQUIRED,  
 -Use ONE FIELD: 14' WIDE X 43' LONG WITH 6" OF 3/4" TO 1 1/2" DBL WASHED STONE BELOW INVERT  
 - BOTTOM AREA: 14' W X 43' L = 602 SF.  
 - SIDE AREA: 0 ISF.  
 - TOTAL AREA: 602 SF X 0.74 GAL/SF = 445 GPD  
 3. GARBAGE DISPOSAL NOT ALLOWED, ...  
 4. NO OTHER PRIVATE WELLS WITHIN 100 FEET OF SAS (TOWN WATER).  
 5. NO OTHER WETLANDS WITHIN 100 FEET OF SAS  
 6. USE EXISTING 1,500 GAL S. TANK UPON COMPLETE INSPECTION ONLY. INSTALL OUTLET BAFFLE  
 - INSTALL & INSPECT SCH. 40 TEES / BAFFLES (10" INLET, 14" OUTLET),  
 6A USE NEW 1000 GALLON PUMP CHAMBER  
**NOTE:**  
 - ALL COMPONENTS OF NEW SYSTEM MUST BE MARKED WITH MAGNETIC TAPE. BE SURE TO MAINTAIN 3" CLEARANCE FROM TOP OF TEES TO BOTTOM OF TANK COVERS & BOXES.  
 7. USE LARGE STYLE (6 OUTLET) D.BOX ONLY.  
 7A ALL D. BOX OUTLET PIPES LEVEL FOR FIRST 2'. BOXES MUST HAVE 2"+ CONC. WALLS  
**NOTE:**  
 - D. BOXES WITH MORE THAN 9" OF COVER SOIL MUST HAVE RISERS TO 6" OF SURFACE.  
 - CONFIRM STONE (PROPERLY DOUBLE WASHED PRIOR TO PLACEMENT).  
 9. USE PROPER SCH. 40 PVC TEES AS SHOWN.  
 10. PRE & POST CONTOURS NOTED AS NECESSARY, RESERVE AS NOTED (not required for repairs).  
 - CONFIRM STONE (PROPERLY DOUBLE WASHED PRIOR TO PLACEMENT).  
 11. SLOPE CALCS (SEE: CONTOURS). SUBGRADE INSP. REQD.  
 13. USE FIELD DUE TO TOPOGRAPHY AND SPACE OF LOT WITH RESPECT TO LOCATION AND ELEVATION OF RESIDENCE (310 CMR 15.240)  
 14. USE 2% MIN. SLOPE OVER SAS  
 - CLEAR TOP AND SUB TO 24" MIN. AS NEEDED (INSPECTION REQUIRED).  
 - CLEAR PAST BASIS OF B (MIN. 24") & SCARIFY UNDER BED PRIOR TO TITL E V SAND/STONE PLACEMENT.  
 - EXCAVATE EXISTING LOAM, SUB AND ANY EXISTING DEBRIS, DIRTY FILL OR PRIOR SYSTEM IF PRESENT.  
 15. SOIL EVALUATION BY A. WEISS, RS. ON 9/24/09 (G. COURTMARCHE, BOH AGENT).  
 - DEPTH OF PERC. 60"  
 - PERC RATE = 3 MIN / IN,  
 - CLASS I SOIL RATING  
 16. NO TREES WITHIN 10 FT. OF NEW LEACH FIELD.  
 17. ENGINEER & TOWN (IF REQUIRED) TO INSPECT SUBGRADE, TOWN AND ENGINEER INSPECT AT FINAL.  
 18. BM=100.00 @ (WALK OUT DOOR SILL, as noted), CONFIRM PROPER PIPE SLOPES  
 - USE/INSPECT SCH. 40 PIPE FOR PIPE FROM HOUSE TO NEW OR EXISTING TANK  
 19. GRADE MULCH AND SEED OVER SAS AS NOTED.  
 20. INSTALLATION IN LOW GROUNDWATER SEASON RECOMMENDED.  
 21. USE OBSERVATION PORT NEAR CENTER OF STONE BED HAVE 4" PERFORATED, PVC INSPECTION PORTALS TO BOTTOM OF STONE BED, WITH RISER TO 3" OF SURFACE & THREADED CAP & MARK WITH RE-BAR.

**TEST PIT LOG:**

TP-1 EFF. ELEV: 97.30				TP-2 EFF. ELEV:					
DEPTH	HORIZ	TEXTURE	COLOUR (MUNSELL)	MATERIAL	DEPTH	HORIZ	TEXTURE	COLOUR (MUNSELL)	MATERIAL
0-18	A	FSL	110 YR 3/2	FRIABLE	0-14	A	FSL	10 YR 3/2	FRIABLE
18-26	Bw	LS	2.5 Y 5/6	FRIABLE, LOOSE	14-24	Bw	LS	2.5 Y 5/6	FRIABLE, LOOSE
26-110	C1	LS	2.5 Y 5/2	F. SAND, GRANULAR, LITTLE SILT, VARVED	24-100	C1	LS	2.5 Y 5/2	F. SAND, GRANULAR

  

OXIDES:	TEXTURE:	COLOUR (MUNSELL):	DEPTH:
110 YR 6/8	OBSERVED @ 48"	48"=93.3'	10 YR 6/8
EHWT:	1100'	80-86	110'+
STANDING H2O:	80-86	WEEPING:	WEEPING:
WEEPING:	110'+	BEDROCK:	BEDROCK:

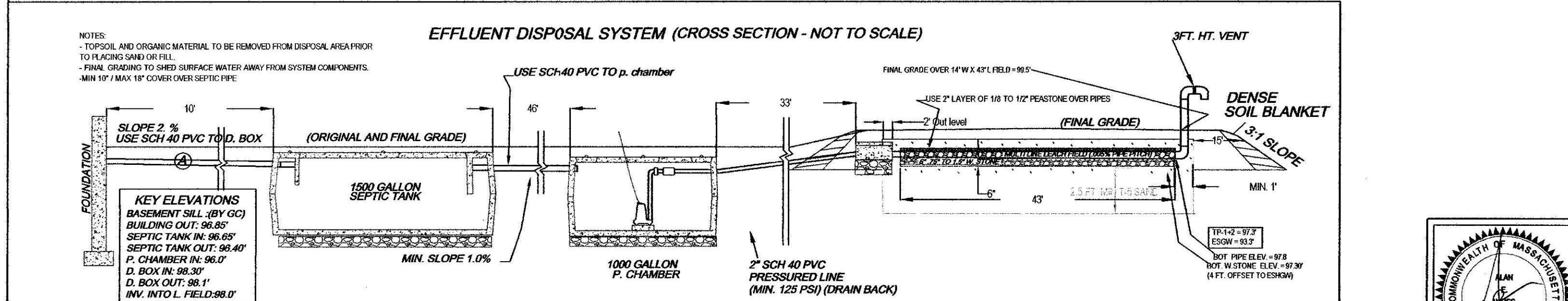

**ATTENTION INSTALLER!!**  
 CALL DIG SAFE BEFORE YOU DIG! MASSACHUSETTS STATE LAW CHAPTER 82 SECTIONS 40-40E REQUIRE THAT REMARKING OF GAS, ELECTRIC, WATER, TELEPHONE AND CABLE T.V. UTILITY LINES BE MADE A MINIMUM OF 72 HOURS PRIOR TO GROUND BREAK FOR ANY EXCAVATION

**NOTE: INSTALLER MUST CONTACT ENGINEER/BD OF HEALTH 48 HOURS PRIOR TO SUBGRADE INSPECTION. INSTALLER MUST HAVE ALL BREAK OUT FILL ON SITE AND IN PLACE PRIOR TO SIGN OFF BY ENGINEER AT TIME OF FINAL INSPECTION OR APPROVAL WILL NOT BE GIVEN TO BACKFILL.**

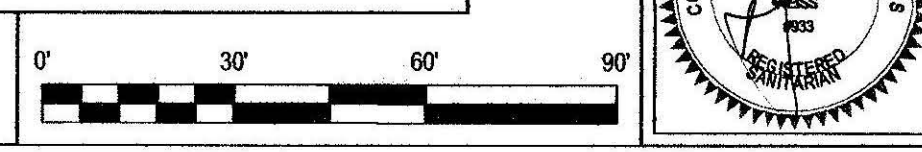

**SEPTIC SYSTEM REPAIR PLAN FOR MIKE ZIOMEK  
 420 MEADOW STREET  
 AMHERST, MA.**

**Cold Spring Environmental Consultants Inc.**  
 350 Old Enfield Road  
 Belchertown, MA. 01007

PROJ. NO: (413) 323-5957  
 FAX: (413) 323-4976  
 DATE: 9/24/09  
 SCALE: 1"=30'

**COMMONWEALTH OF MASSACHUSETTS**  
 REGISTERED PROFESSIONAL ENGINEER  
 1000 STATE STREET, SUITE 200  
 WESTFIELD, MA 01095  
 TEL: (413) 323-5957  
 FAX: (413) 323-4976  
 E-MAIL: AEW@CS-ES.COM

DATE: 9/24/09  
 DRAWN BY: ARS  
 CHECKED BY: AEW  
 REVISED:  
 DRAWING NUMBER: 109-3239-0924