

549-0410

#336

No. 9223-Revised

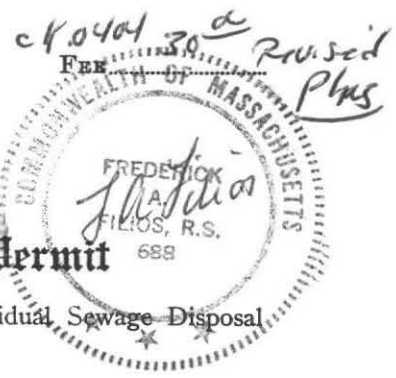

THE COMMONWEALTH OF MASSACHUSETTS

BOARD OF HEALTH

Town OF Amherst

Application for Disposal Works Construction Permit

Revision of Nancy S. Ruder Application

Application is hereby made for a Permit to Construct ( ) or Repair (X) an Individual Sewage Disposal System at:

336 366 Market Hill Rd.

Lot B

Barbara Davis Genoa

420 Fairway Village, Leeds, MA 01053

ED Lavalley

Type of Building

Dwelling - No. of Bedrooms 4

Expansion Attic ( )

Garbage Grinder (no)

Other - Type of Building

No. of persons

Showers ( ) - Cafeteria ( )

Other fixtures

Design Flow 55 X 1.25 gallons per person per day. Total daily flow 550 gallons.

Septic Tank - Liquid capacity 1000 gallons Length 8.5' Width 5' Diameter 5.3' Depth 5.3'

Disposal Trench - No. 2 Width 2.0' Total Length 100.0' Total leaching area 200.0 sq. ft.

Seepage Pit No. Diameter Depth below inlet 1.0' Total leaching area 200.0 sq. ft.

Other Distribution box (X) Dosing tank ( )

Percolation Test Results Performed by Filios Enterprises, Inc. Date 20 August, 1992

Test Pit No. 1 4 minutes per inch Depth of Test Pit 10' Depth to ground water 80"

Test Pit No. 2 minutes per inch Depth of Test Pit Depth to ground water

Description of Soil Attached

Nature of Repairs or Alterations - Answer when applicable

Agreement:

The undersigned agrees to install the aforescribed Individual Sewage Disposal System in accordance with the provisions of TITLE 5 of the State Environmental Code - The undersigned further agrees not to place the system in operation until a Certificate of Compliance has been issued by the board of health.

Signed Barbara L. Davis Nov. 4, 1992

Application Approved By

Application Disapproved for the following reasons:

Permit No. 92-23 Revised

Issued 11/3/92

1/4/93

THE COMMONWEALTH OF MASSACHUSETTS

BOARD OF HEALTH

Town OF Amherst

Certificate of Compliance

THIS IS TO CERTIFY That the Individual Sewage Disposal System constructed ( ) or Repaired (X)

by 336 Ed Lavalley

Installer

at 366 Market Hill Rd., Amherst, MA

has been installed in accordance with the provisions of TITLE 5 of The State Environmental Code as described in the application for Disposal Works Construction Permit No. 92-23 Revised dated

THE ISSUANCE OF THIS CERTIFICATE SHALL NOT BE CONSTRUED AS A GUARANTEE THAT THE SYSTEM WILL FUNCTION SATISFACTORY.

DATE

Inspector

CHECK OR FILL IN WHERE APPLICABLE



No. 92-23-<sup>Revised</sup>

THE COMMONWEALTH OF MASSACHUSETTS  
BOARD OF HEALTH

Town Amherst OF

Application for Disposal Works Construction Permit

*Revision of Nancy S. Ruder Application*

Application is hereby made for a Permit to Construct ( ) or Repair (  ) an Individual Sewage Disposal System at:

336

Market Hill Rd.

Lot B

Location - Address

Barbara Davis Garage

420 Fairway Village, Leeds, MA 01053

or Lot No.

Owner

FD Hawley

Howard III

Address

Installer

Type of Building

Address

Size Lot 72,684 Sq. feet

Dwelling - No. of Bedrooms 4 Expansion Attic ( )

Garbage Grinder ( no )

Other - Type of Building \_\_\_\_\_ No. of persons \_\_\_\_\_

Showers ( ) - Cafeteria ( )

Other fixtures \_\_\_\_\_

Design Flow 55 x 1.25 gallons per person per day. Total daily flow 550 gallons.

Septic Tank - Liquid capacity 1000 gallons Length 8.5' Width 5' Diameter \_\_\_\_\_ Depth 5.3'

Disposal Trench - No. 2 Width 2.0' Total Length 100.0' Total leaching area 200.0 sq. ft.

Seepage Pit No. \_\_\_\_\_ Diameter \_\_\_\_\_ Depth below inlet 1.0' Total leaching area 200.0 sq. ft.

Other Distribution box (  ) Dosing tank ( )

Percolation Test Results Performed by Filios Enterprises, Inc. Date 26 August, 1992

Test Pit No. 1 4 minutes per inch Depth of Test Pit 10' Depth to ground water 80"

Test Pit No. 2 \_\_\_\_\_ minutes per inch Depth of Test Pit \_\_\_\_\_ Depth to ground water \_\_\_\_\_

Description of Soil Attached

Nature of Repairs or Alterations - Answer when applicable \_\_\_\_\_

Agreement:

The undersigned agrees to install the aforescribed Individual Sewage Disposal System in accordance with the provisions of TITLE 5 of the State Environmental Code - The undersigned further agrees not to place the system in operation until a Certificate of Compliance has been issued by the board of health.

Signed

Paulina S. Lewis

Nov. 4, 1992

Date

Application Approved By \_\_\_\_\_

Date

Application Disapproved for the following reasons: \_\_\_\_\_

Permit No. 92-23 Revised

Issued

11/3/92

Date

THE COMMONWEALTH OF MASSACHUSETTS

BOARD OF HEALTH

Town Amherst OF

Certificate of Compliance

THIS IS TO CERTIFY That the Individual Sewage Disposal System constructed ( ) or Repaired (  )

by

336

Installer

at Market Hill Rd., Amherst, MA

has been installed in accordance with the provisions of TITLE 5 of The State Environmental Code as described in the application for Disposal Works Construction Permit No. 92-23 Revised dated \_\_\_\_\_

**THE ISSUANCE OF THIS CERTIFICATE SHALL NOT BE CONSTRUED AS A GUARANTEE THAT THE SYSTEM WILL FUNCTION SATISFACTORY.**

DATE \_\_\_\_\_

Inspector \_\_\_\_\_

THE COMMONWEALTH OF MASSACHUSETTS

BOARD OF HEALTH

Town Amherst OF

No. 92-23

Revised

Disposal Works Construction Permit

FEE

30<sup>00</sup> Revised

CK 0404

Permission is hereby granted Barbara Davis

to Construct ( ) or Repair (  ) an Individual Sewage Disposal System

at No. 336 Market Hill Rd.

as shown on the application for Disposal Works Construction Permit No. 92-23 Dated \_\_\_\_\_

DATE 11/3/92

Board of Health

CHECK OR FILL IN WHERE APPLICABLE



Sidewall Bottom Area

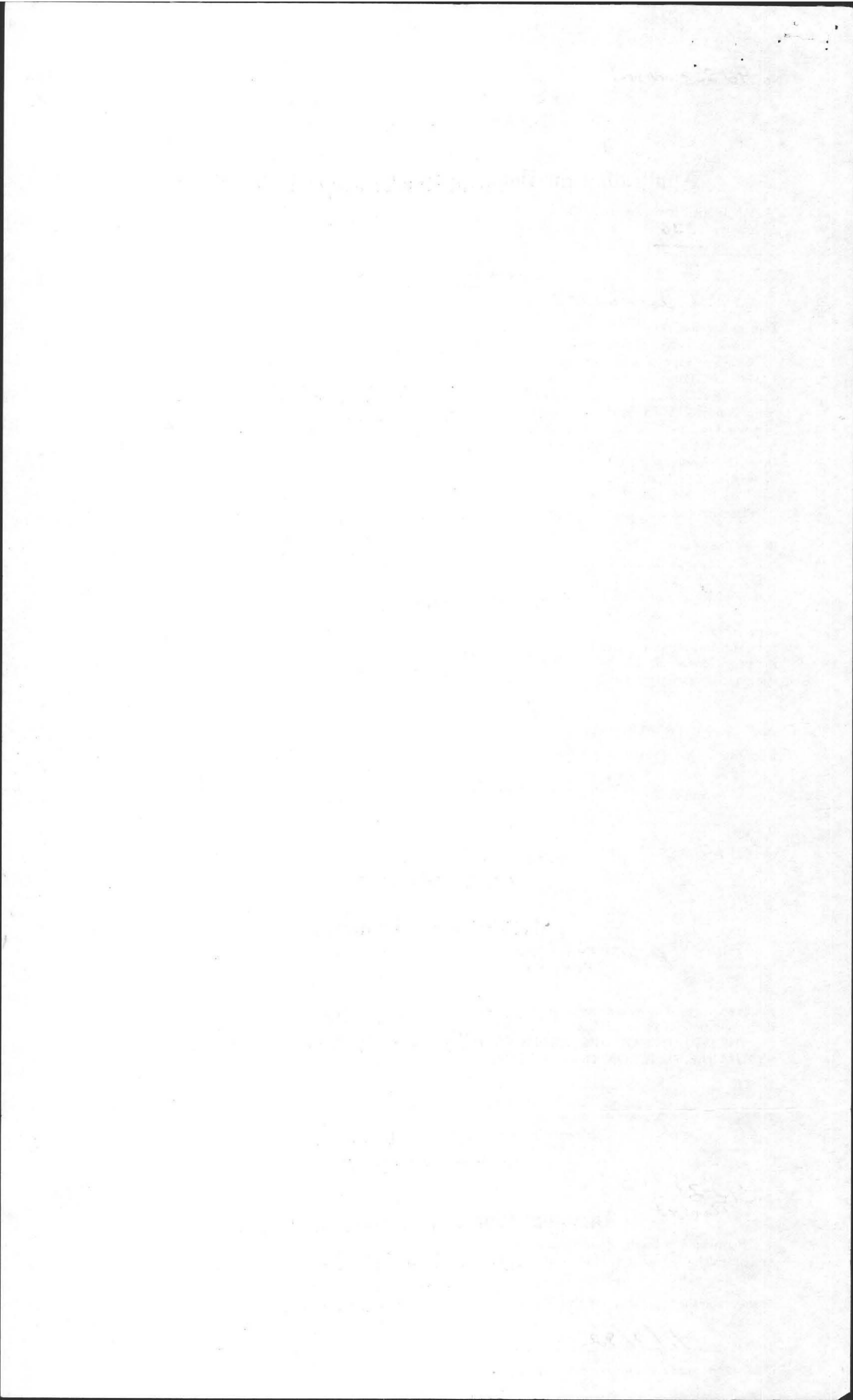

10 miles

NANCY S Ruder  
Pd 160<sup>00</sup> CH 3183  
8/26/92

TOWN OF AMHERST  
PERC TEST DATA SHEET

DATE 8/26/92 LOCATION 366 MARKET Hill Road LOT SIZE \_\_\_\_\_

OWNER Nancy S Ruder ADDRESS 405 MARKET Hill TELE # \_\_\_\_\_

P.E. (RS) Fred Filios FIRM Filios ENT. OBSERVED BY David Zarozny

BACK HOE OPERATOR KARL'S BENCH MARK \_\_\_\_\_

PERC DEPTH 42" PRE SOAK TIME 8:50-9:10 PERC DEPTH \_\_\_\_\_ PRE SOAK TIME \_\_\_\_\_

TEST	<u>12"</u>	<u>9:10</u>	<u>8"</u>	<u>9:18</u>	_____	_____
	<u>11"</u>	<u>-</u>	<u>7"</u>	<u>9:21</u>	_____	_____
	<u>10"</u>	<u>9:13</u>	<u>6"</u>	<u>9:24</u>	_____	_____
	<u>9"</u>	<u>9:16</u>	_____	_____	_____	_____

RATE (4) RATE \_\_\_\_\_

# 1

TOP <u>8"</u>	TOP
SUB <u>13"</u>	SUB
<u>Secore 80"</u> <u>Gravelly Sandy</u> <u>Till Firm w/</u> <u>Depth</u>	
<u>122"</u>	

TOP	TOP
SUB	SUB

TOP	TOP
SUB	SUB

3 Bedrooms 110 G/B underground well

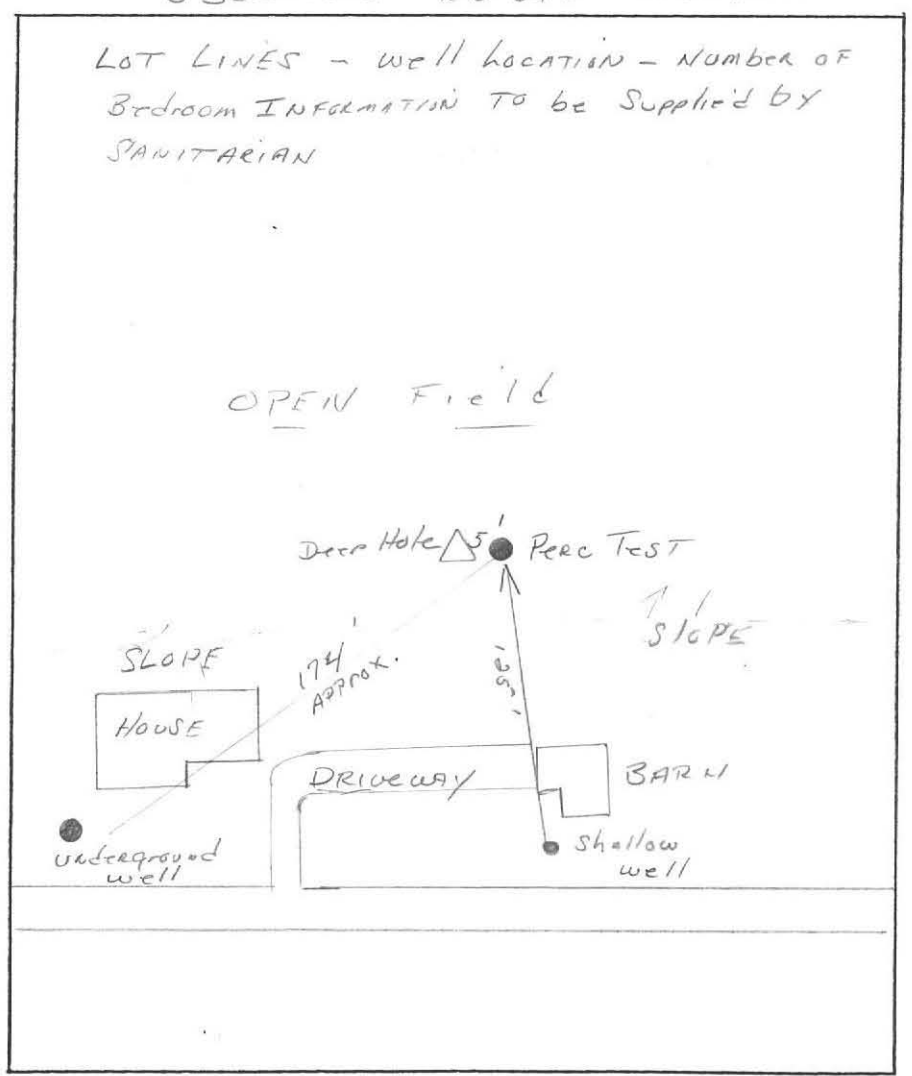

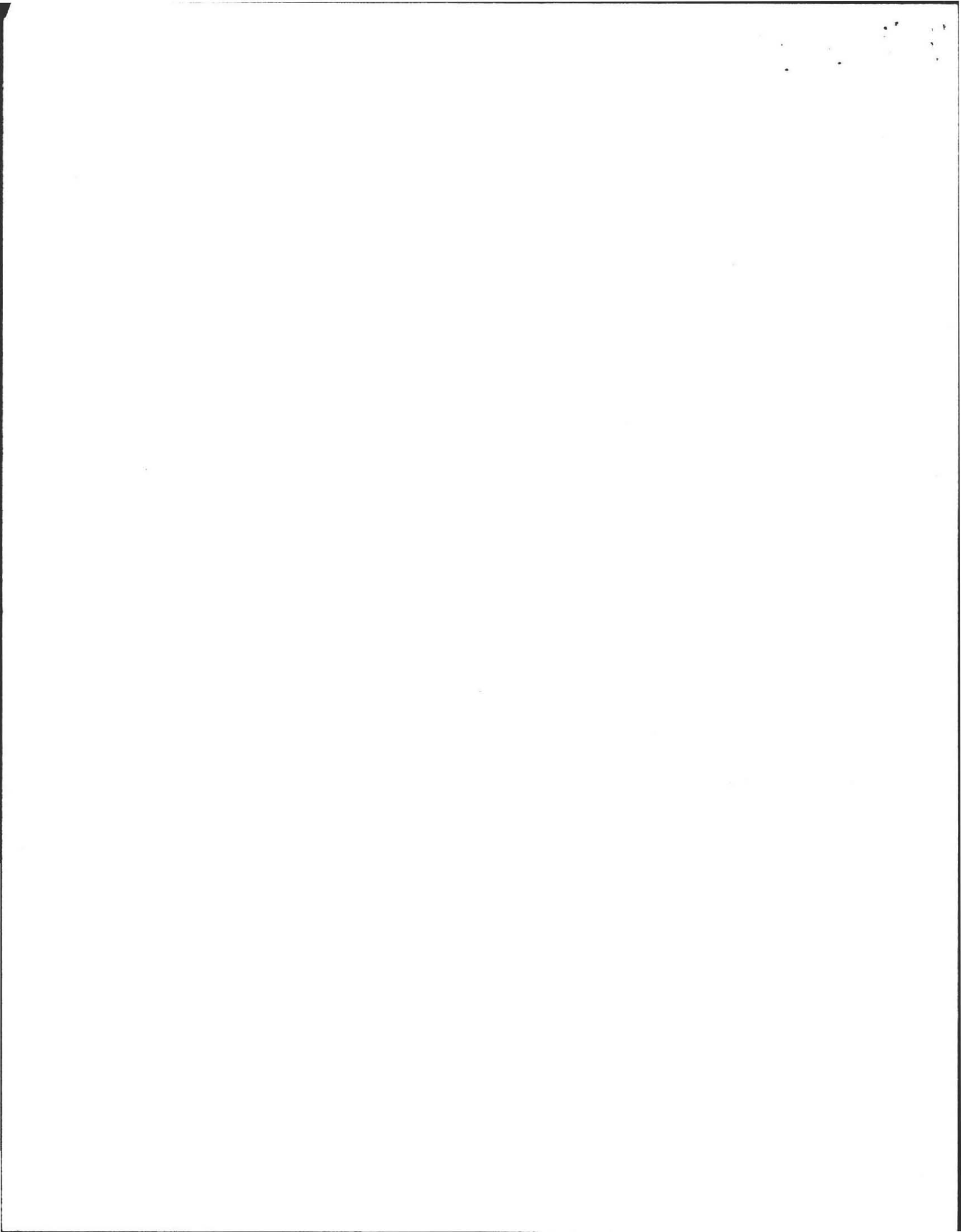



# Deep Soil Logs

## Filios Enterprises, Inc.

69 Pelham Rd., Amherst MA 01002. (413) 256-8008

Owner: NANCY S. RUDER Date: 26 AUGUST, 1992  
Location: 366 MARKET HILL RD B. of H. DAVE ZAROZINSKI  
AMHERST, MA

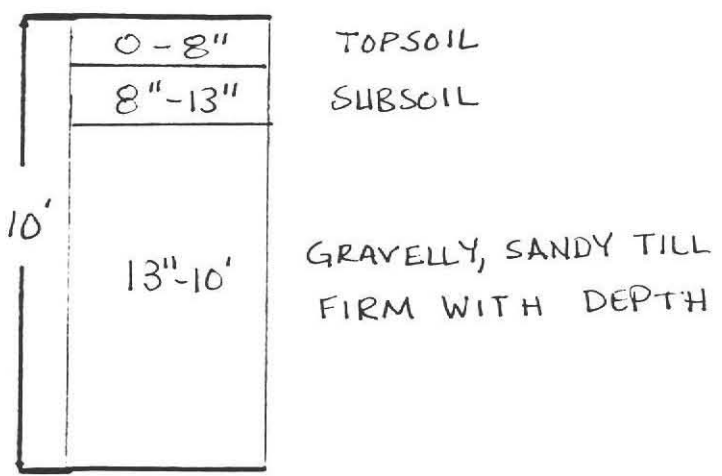

Ground Water SEEPAGE @ 80"

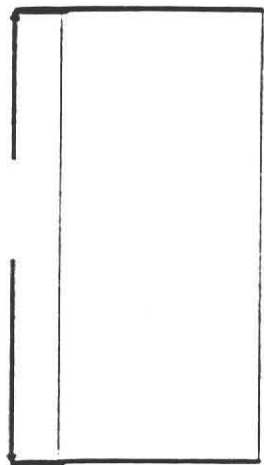

Ground Water \_\_\_\_\_

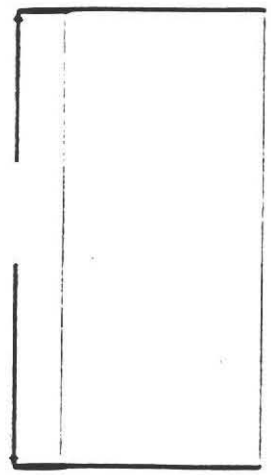

Ground Water \_\_\_\_\_

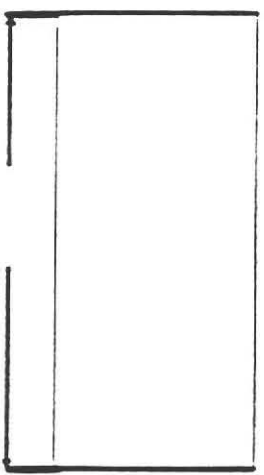

Ground Water \_\_\_\_\_

Percolation Rate at: 42"  
4 min./inch

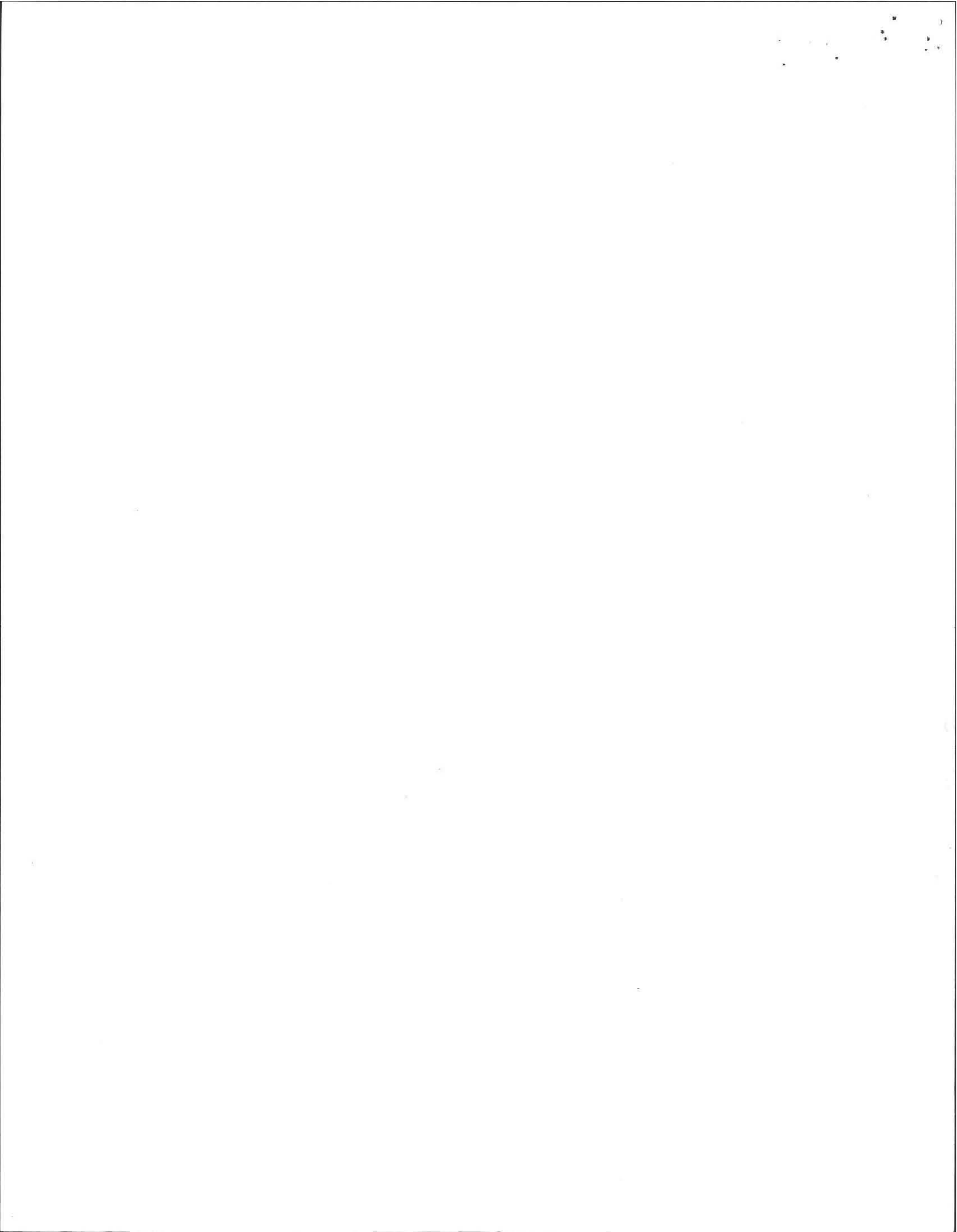



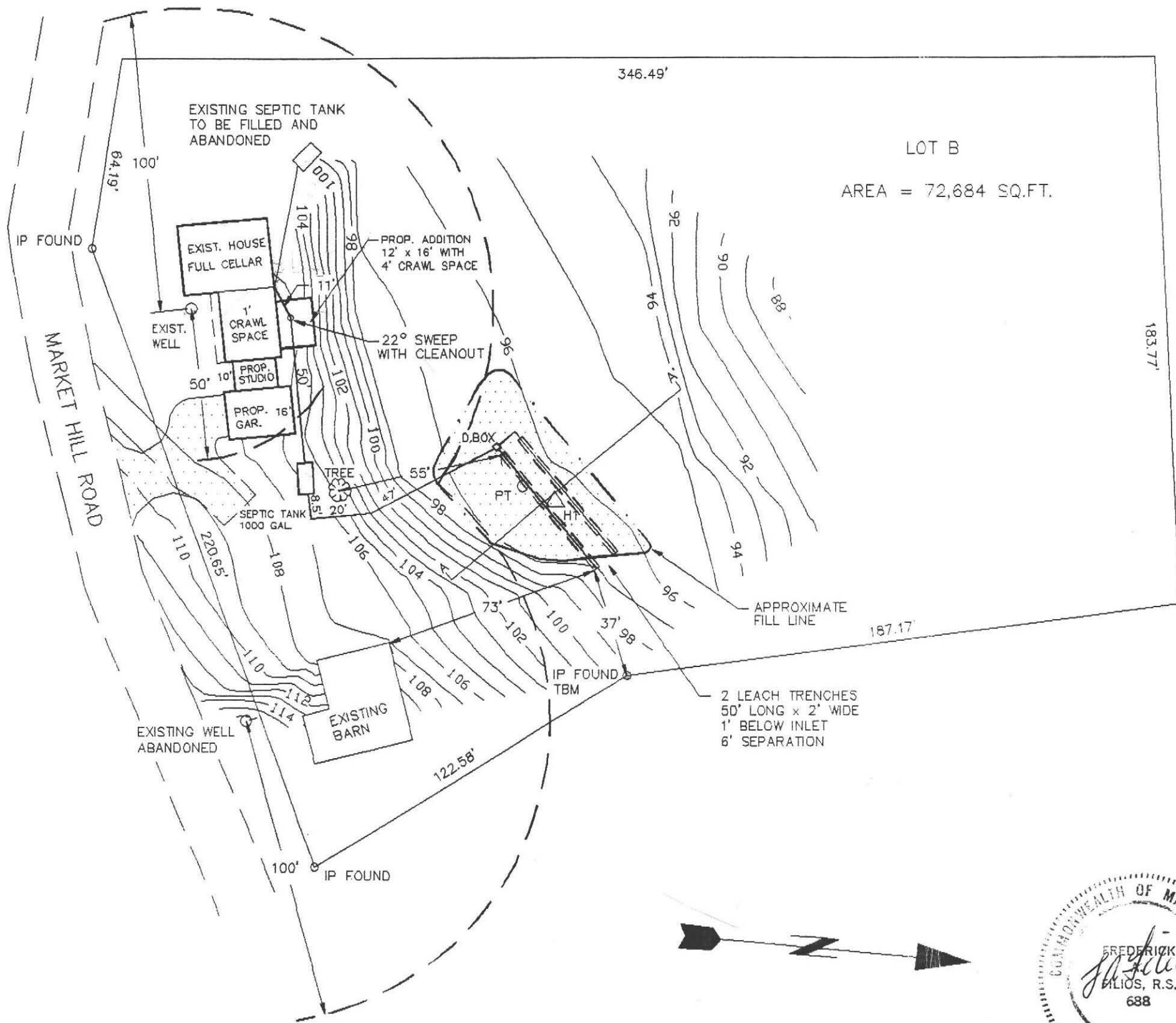

LOT B  
 AREA = 72,684 SQ.FT.

**LEGEND**

- PT PERCOLATION TEST
- △ Hx DEEP TEST PIT
- CONTOUR LINES (1' INTERVAL)

**NOTES:**

1. TOPSOIL AND SUBSOIL SHALL BE REMOVED WHERE FILL TO BE PLACED.
2. NO OTHER WELLS WITHIN 200' OF THE LEACH AREA AT THE TIME OF SURVEY.
3. TBM IS TOP OF IRON PROPERTY PIN.

PLAN OF SEWAGE DISPOSAL SYSTEM	
REPAIR AT 366 MARKET HILL RD., AMHERST, MA	
BY: FILIOS ENTERPRISES, INC. 69 PELHAM RD. AMHERST MA 01002 (413)256-8008	FOR: BARBARA DAVIS 420 FAIRWAY VILLAGE LEEDS, MA 01053
DRAWN BY R. STOVER 27 OCTOBER, 1992	SCALE: 1" = 40'00" PAGE ONE OF THREE
REVISION OF NANCY RUDER PLAN PREPARED 10 SEPTEMBER, 1992	





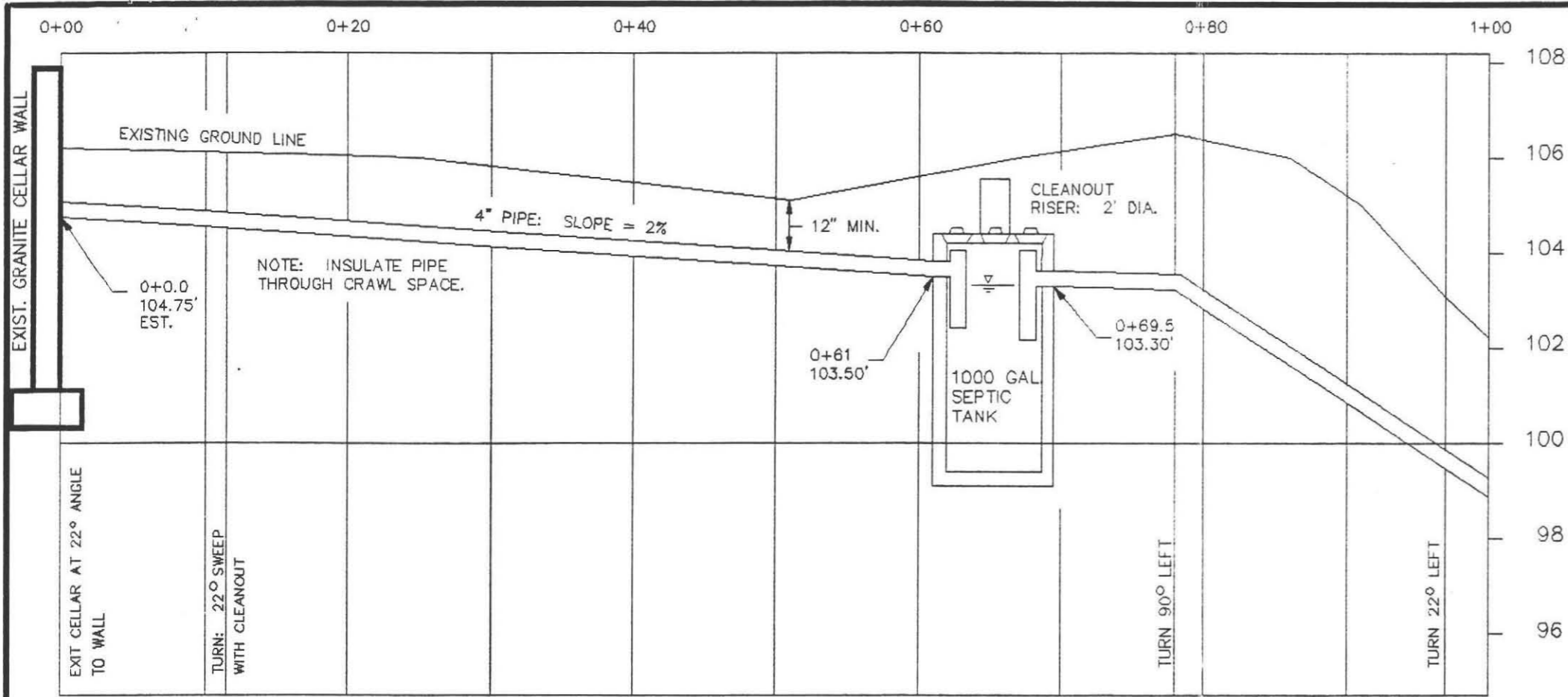

**SPECIFICATIONS**  
 ALL MATERIALS AND CONSTRUCTION MUST BE IN ACCORDANCE WITH COMMONWEALTH OF MASSACHUSETTS DEPT. OF ENVIRONMENTAL PROTECTION STATE ENVIRONMENTAL CODE TITLE 5.

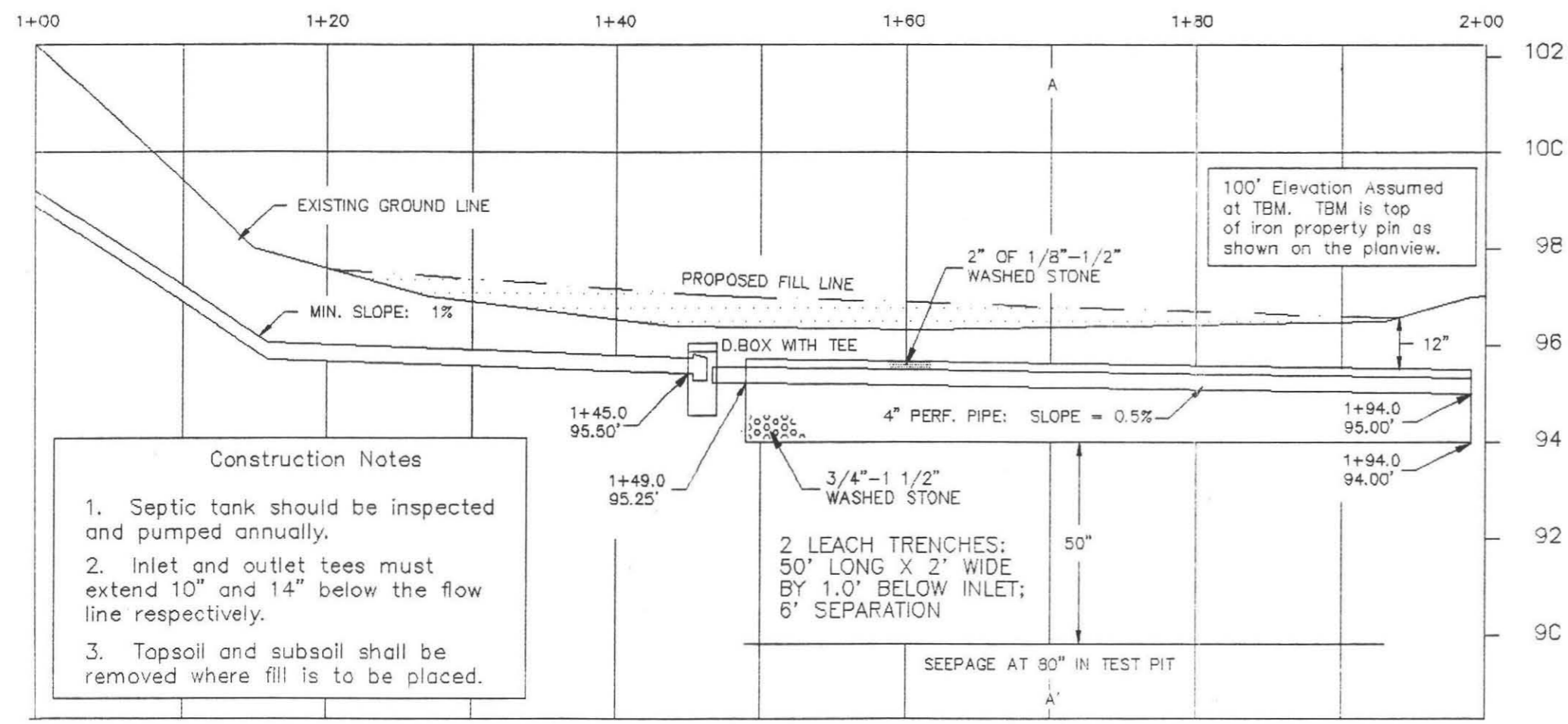

**Construction Notes**

1. Septic tank should be inspected and pumped annually.
2. Inlet and outlet tees must extend 10" and 14" below the flow line respectively.
3. Topsoil and subsoil shall be removed where fill is to be placed.

**CALCULATIONS**

REQUIRED: For a 4 bedroom house without a garbage grinder a capacity of 440.0 gal./day = 550.00gal./day.

DESIGNED: 2 leach trenches 50.0'L X 2.0'W X 1.00' below inlet (effective depth), for a perc rate of 4 min./in., yielding side and bottom loading factors of 2.00 and 0.83 gal./sq.ft. respectively.

SIDEWALL: 4 Sides(50.0' X 1.0')2.00 Gal./Sq.Ft. = 400.0 Gal.  
 BOTTOM: 2 Trenches(50.0' X 2.0')0.83 Gal./Sq.Ft. = 166.0 Gal.  
 TOTAL = 566.0 Gal.

PROFILE OF SEWAGE DISPOSAL SYSTEM	
REPAIR AT 366 MARKET HILL RD., AMHERST, MA	
BY: FILIOS ENTERPRISES, INC. 69 PELHAM RD. AMHERST MA 01002 (413)256-8008	FOR: BARBARA DAVIS 420 FAIRWAY VILLAGE LEEDS, MA 01053
DRAWN BY R. STOVER 26 OCTOBER, 1992	SCALE: 1" = 10' HOR. 3" VER. PAGE TWO OF THREE
REVISION OF NANCY RUDER PLAN PREPARED 10 SEPTEMBER, 1992	

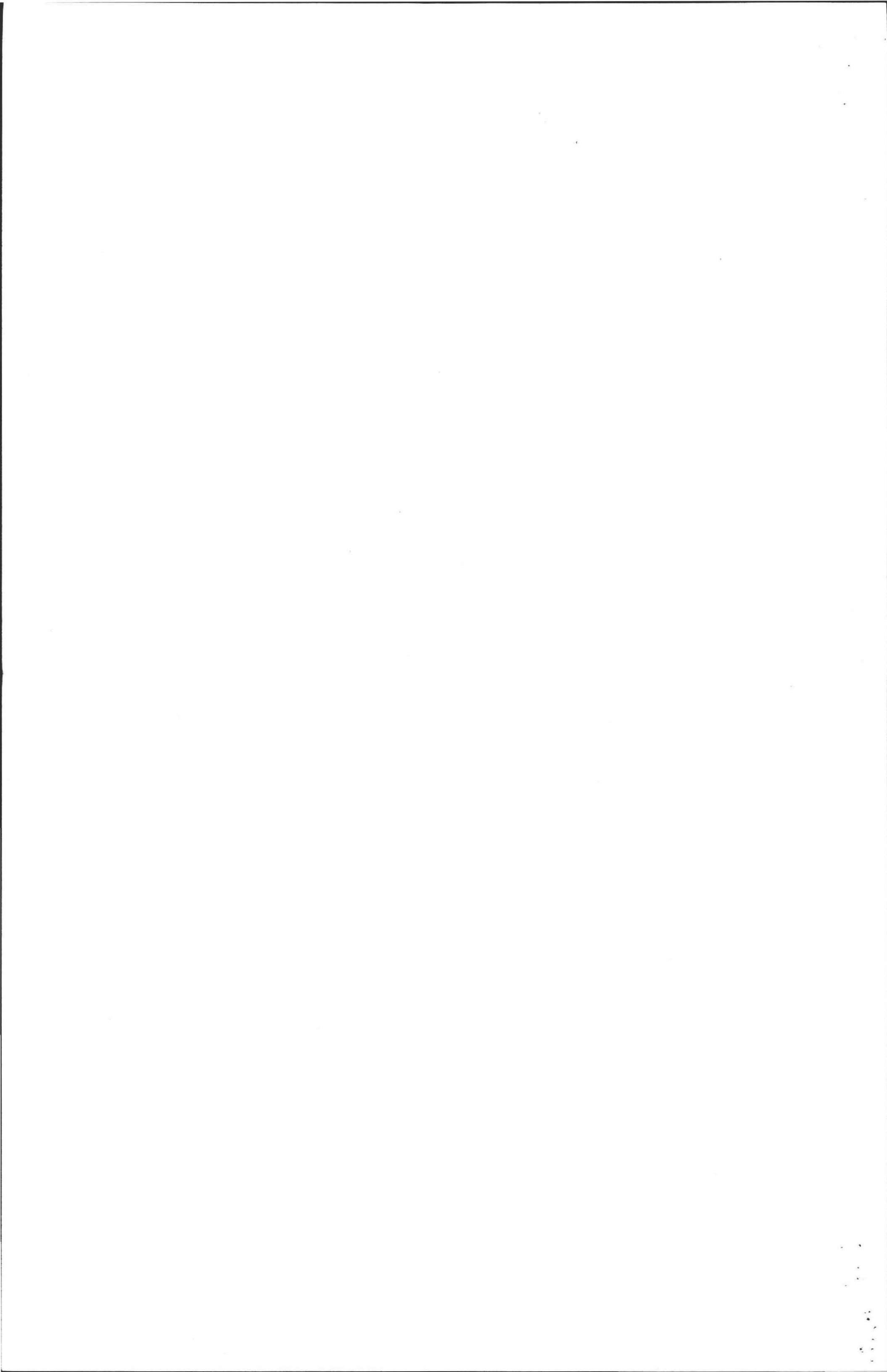

CROSS-SECTION OF LEACH TRENCHES AT A-A'

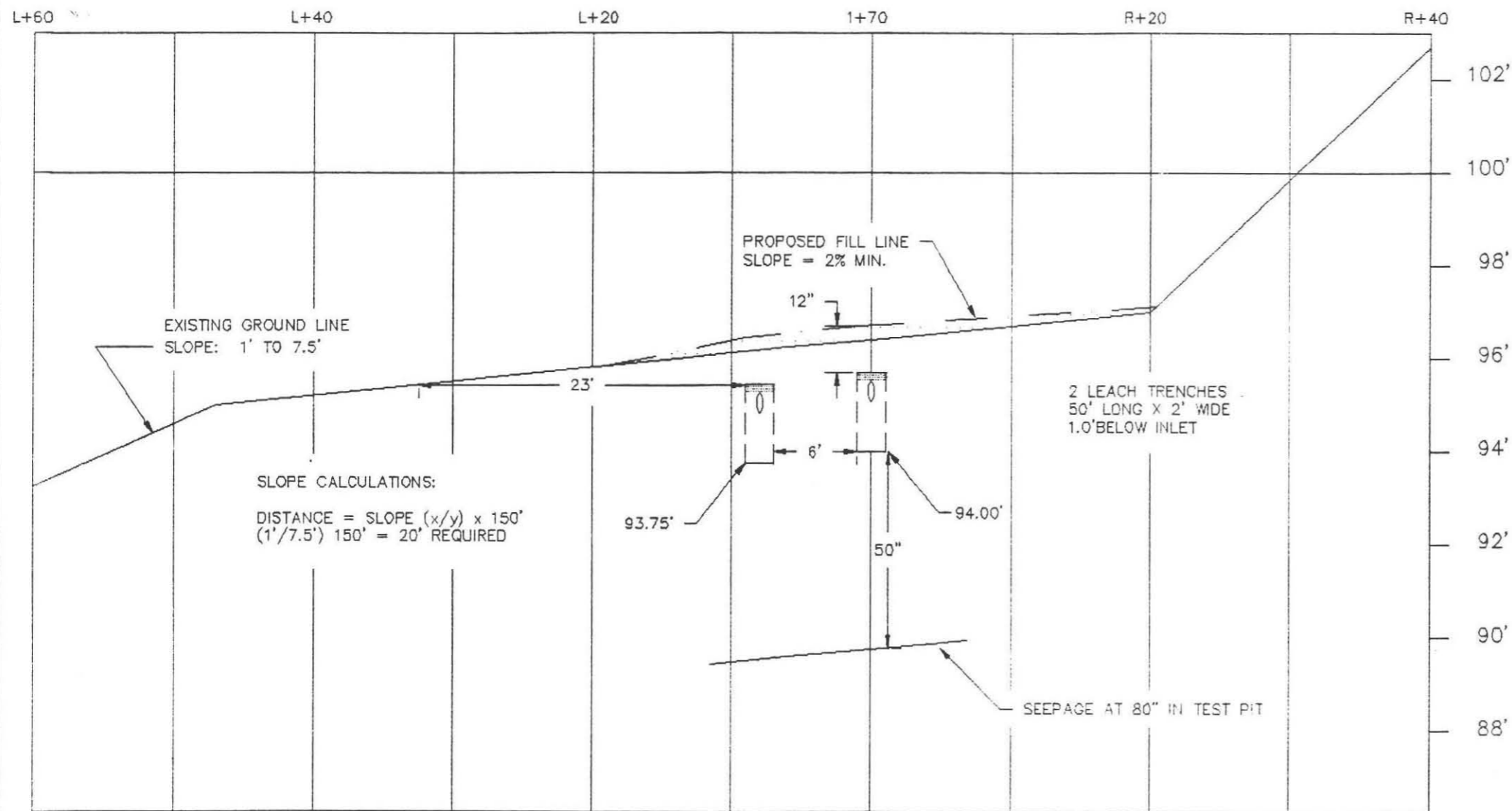

100' Elevation Assumed at TBM. TBM is top of iron property pin as shown on Plan view.



CROSS-SECTION OF LEACH TRENCHES	
REPAIR AT 366 MARKET HILL RD., AMHERST, MA	
BY: FILIOS ENTERPRISES, INC. 69 PELHAM RD. AMHERST MA 01002 (413)256-8008	FOR: BARBARA DAVIS 420 FAIRWAY VILLAGE LEEDS, MA 01053
DRAWN BY R. STOVER	SCALE: 1" = 10' HOR. 3' VER.
27 OCTOBER, 1992	PAGE THREE OF THREE
REVISION OF NANCY RUDER PLAN PREPARED 10 SEPTEMBER, 1992	

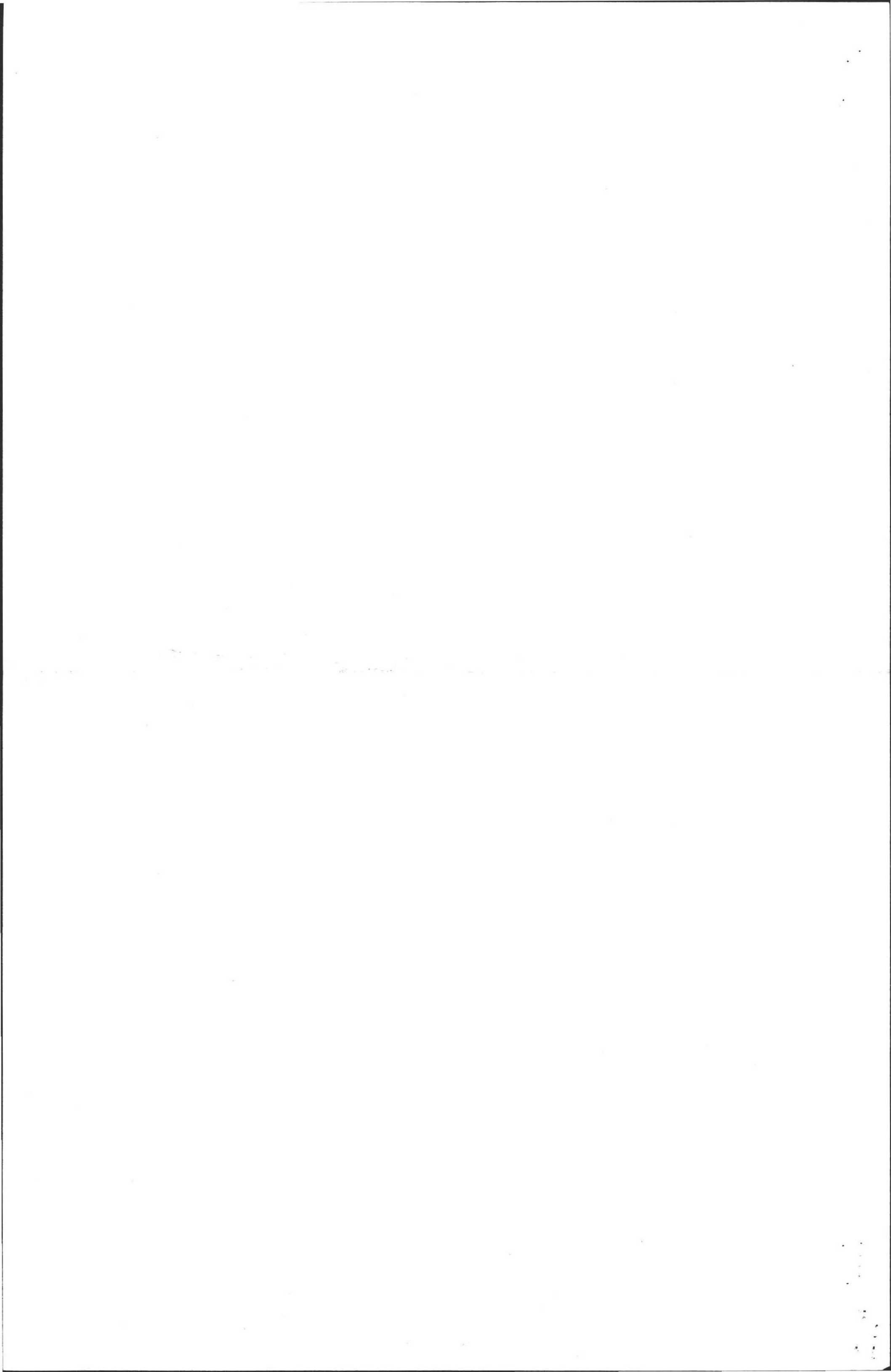



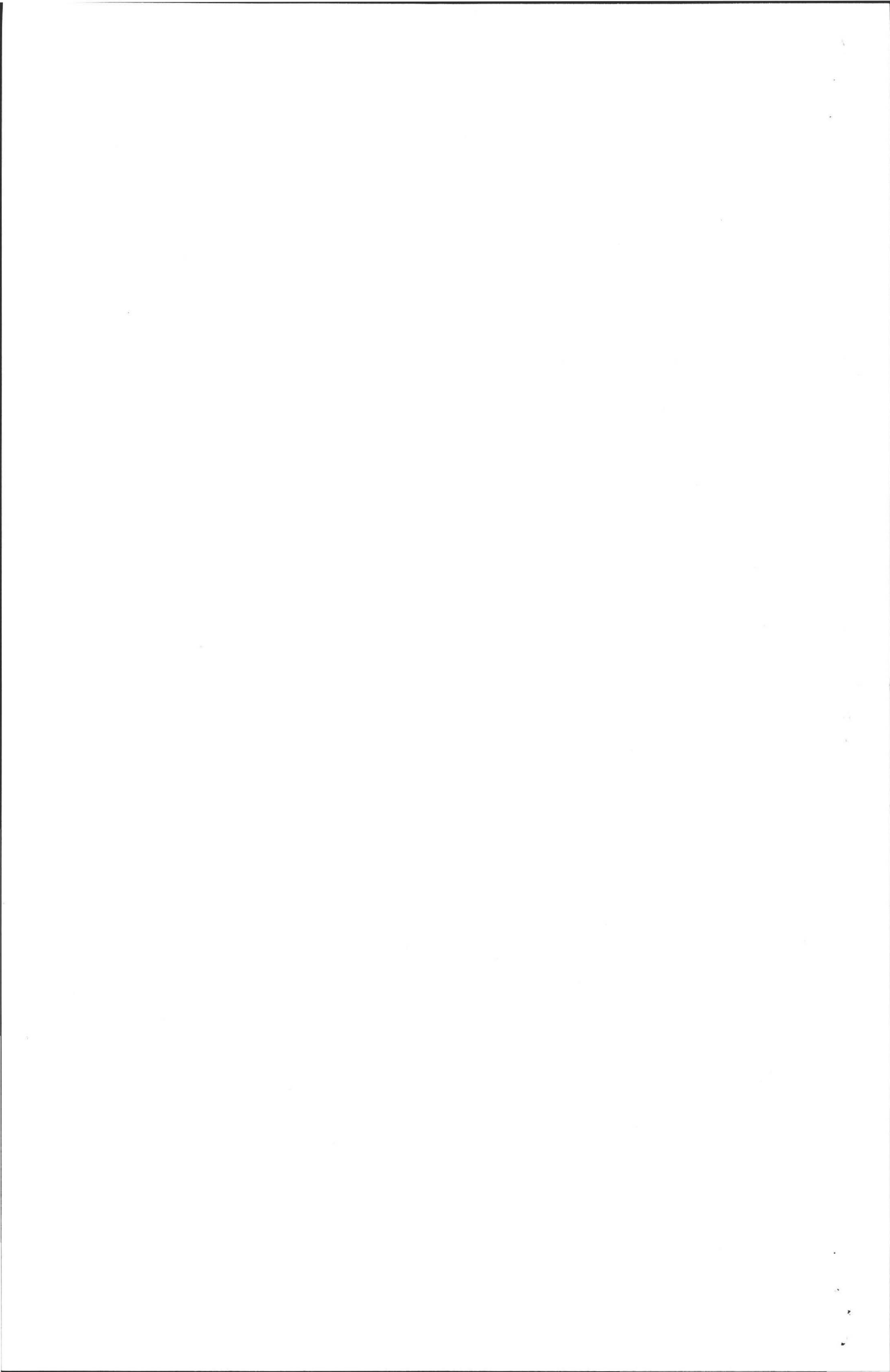



# CROSS-SECTION AT A - A' (1+90)

100' Elevation Assumed at TBM. TBM is nail in base of 16 inch willow tree as shown on planview.

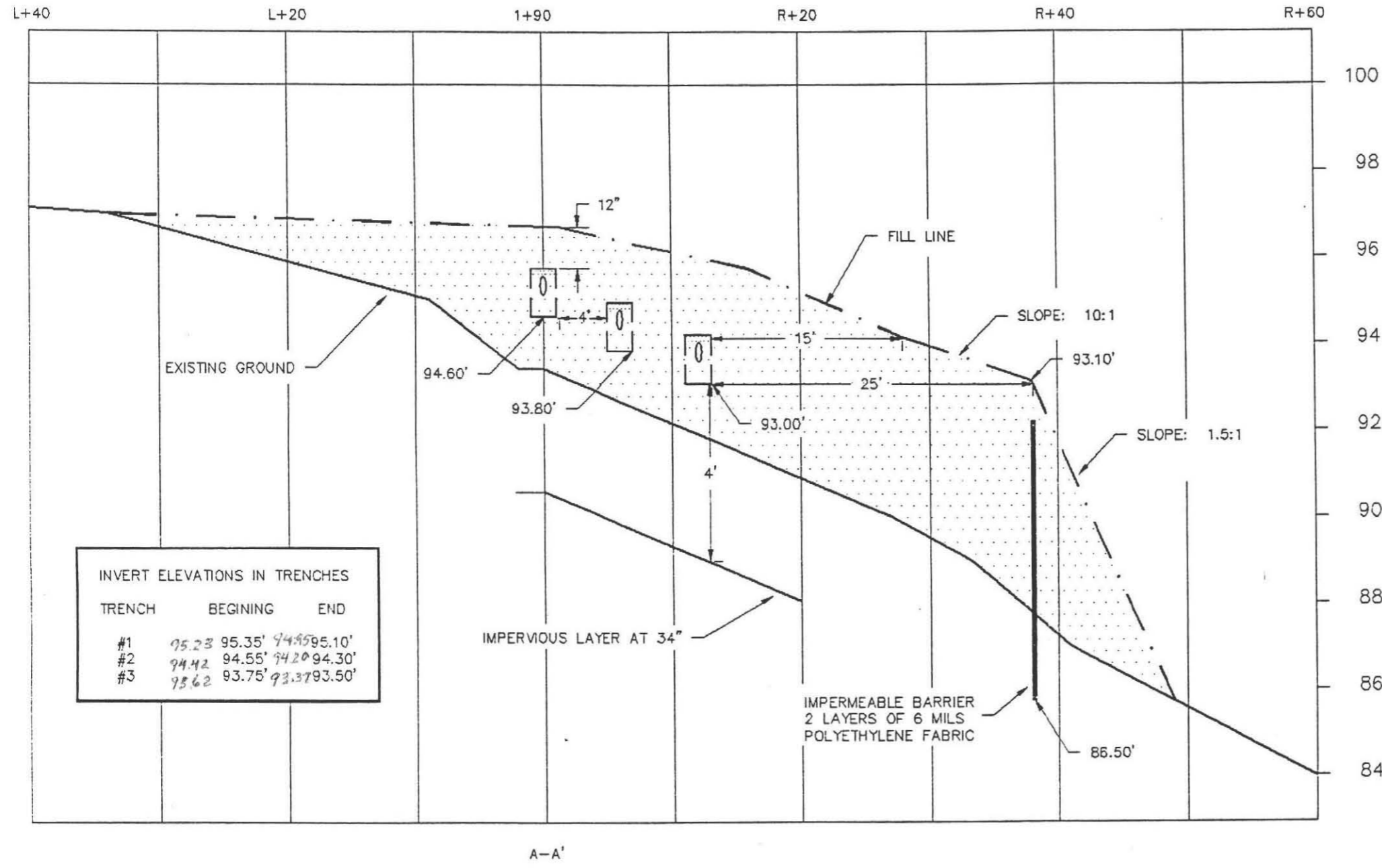

INVERT ELEVATIONS IN TRENCHES		
TRENCH	BEGINING	END
#1	95.23 95.35'	94.95 95.10'
#2	94.42 94.55'	94.20 94.30'
#3	93.62 93.75'	93.37 93.50'

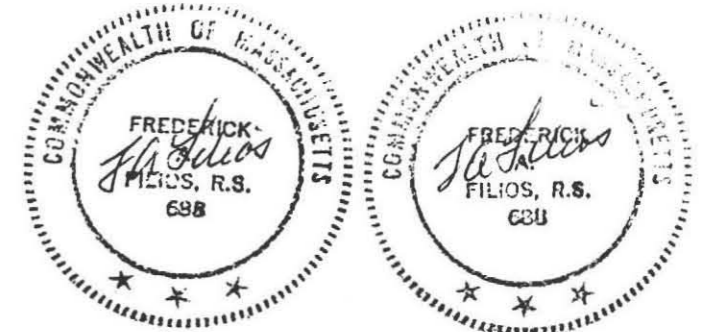

CROSS-SECTION OF LEACH TRENCHES	
REPAIR AT 330 MARKET HILL RD., AMHERST, MA	
BY: FILIOS ENTERPRISES, INC. 69 PELHAM RD. AMHERST MA 01002 (413)256-8008	FOR: MARY CLARK 159 GLENDALE RD. AMHERST, MA 01002
ROBERT STOVER	SCALE: 1" = 10' HOR. 3" VER.
JUNE 29, 1993	PAGE THREE OF THREE
REV. #1, JULY 14, 1993	

