

JUN 19 1990, CK# 151

100.00 perc Test
60 PLANS
00

No. 90-7

THE COMMONWEALTH OF MASSACHUSETTS

BOARD OF HEALTH

Town OF Amherst

Application for Disposal Works Construction Permit



Application is hereby made for a Permit to Construct () or Repair (✓) an Individual Sewage Disposal System at:

170 Market Hill Road
Estate of Robert Francis
Karl's Excavating Co
Location - Address
Owner
Installer
none
or Lot No. 110 Maple St.
c/o Paul Carman Assoc. Springfield Mass
Hedley Mass
Address
Address

Type of Building
Dwelling - No. of Bedrooms 1 Expansion Attic () Garbage Grinder (no)
Other - Type of Building No. of persons Showers () - Cafeteria ()
Other fixtures

Design Flow 55 gallons per person per day. Total daily flow 110 gallons.
Septic Tank ✓ Liquid capacity 1000 gallons Length 8.5' Width 5' Diameter Depth 5.3'
Disposal Trench - No. Width Total Length Total leaching area 97.5 sq. ft. sides
Seepage Pit No. 1 Diameter 12.5' x 7' Depth below inlet 2.5 Total leaching area 87.5 sq. ft. bottom

Percolation Test Results Performed by Filios Enterprises, Inc Date May 31, 1990
Test Pit No. 1 2 minutes per inch Depth of Test Pit 13 1/2' Depth to ground water none
Test Pit No. 2 minutes per inch Depth of Test Pit Depth to ground water

Description of Soil Attached

Nature of Repairs or Alterations - Answer when applicable

Agreement:
The undersigned agrees to install the aforescribed Individual Sewage Disposal System in accordance with the provisions of TITLE 5 of the State Environmental Code - The undersigned further agrees not to place the system in operation until a Certificate of Compliance has been issued by the board of health.

Signed Henry Lyman Jr. Trustee of Estate of Robert Francis
Application Approved By David Jozanski for Amherst Health Dept Date 6/19/90

Application Disapproved for the following reasons:

Permit No. 90-7 Issued Date

THE COMMONWEALTH OF MASSACHUSETTS

BOARD OF HEALTH

Town OF Amherst

Certificate of Compliance

THIS IS TO CERTIFY, That the Individual Sewage Disposal System constructed () or Repaired (✓) by KARL'S EXCAVATING at 170 MARKET HILL Road has been installed in accordance with the provisions of TITLE 5 of The State Environmental Code as described in the application for Disposal Works Construction Permit No. 90-7 dated

THE ISSUANCE OF THIS CERTIFICATE SHALL NOT BE CONSTRUED AS A GUARANTEE THAT THE SYSTEM WILL FUNCTION SATISFACTORY.

DATE Inspector

THE COMMONWEALTH OF MASSACHUSETTS

BOARD OF HEALTH

Town OF Amherst

Disposal Works Construction Permit

Permission is hereby granted KARL'S to Construct () or Repair (✓) an Individual Sewage Disposal System at No. 170 MARKET HILL ROAD Street

as shown on the application for Disposal Works Construction Permit No. 90-7 Dated

DATE 6/19/90 David Jozanski for the Amherst Board of Health

CK# - 151
100.00 PLANS
60.00 PERMS
FEE 160.00

CHECK OR FILL IN WHERE APPLICABLE



Town of Amherst

170 Market Hill Road

Estate of Robert Francis
Korte Excavating

Paul Cornwell Assoc
Fading Glass
12/21/11

110

100

12' x 12'

side
bottom

12' x 12'

File: Entropy 1/1/11

May 31, 1990

Attended

No. 90-7

INSPECTED!
6/25/90
TO Close TO Slope

JUN 19 1990

#190
CK#
151

100.00 Penn Test
60.00 Plans
FEE 160.00

THE COMMONWEALTH OF MASSACHUSETTS

BOARD OF HEALTH

Town OF Amherst

Application for Disposal Works Construction Permit



Application is hereby made for a Permit to Construct () or Repair () an Individual Sewage Disposal System at:

170 Market Hill Road
Location - Address
Estate of Robert Francis
Owner
Karls Excavating Co
Installer
or Lot No. none
Address 110 Maple St. Springfield Mass
Address Hodley Mass

Type of Building
Dwelling - No. of Bedrooms 1 Expansion Attic () Garbage Grinder ()
Other - Type of Building _____ No. of persons _____ Showers () - Cafeteria ()
Other fixtures _____

Design Flow 55 gallons per person per day. Total daily flow 110 gallons.
Septic Tank Liquid capacity 1000 gallons Length 8.5' Width 5' Diameter _____ Depth 5.3'
Disposal Trench - No. _____ Width _____ Total Length _____ Total leaching area 97.5 sq. ft. sides
Seepage Pit No. 1 Diameter 12.5' x 7' Depth below inlet 2.5 Total leaching area 87.5 sq. ft. bottom
Other Distribution box () Dosing tank ()
Percolation Test Results Performed by Filios Enterprises, Inc Date May 31, 1990
Test Pit No. 1 2 minutes per inch Depth of Test Pit 13 1/2' Depth to ground water none
Test Pit No. 2 _____ minutes per inch Depth of Test Pit _____ Depth to ground water _____

Description of Soil Attached

Nature of Repairs or Alterations - Answer when applicable _____

Agreement:
The undersigned agrees to install the aforescribed Individual Sewage Disposal System in accordance with the provisions of TITLE 5 of the State Environmental Code - The undersigned further agrees not to place the system in operation until a Certificate of Compliance has been issued by the board of health.

Signed Henry Lyman Jr Trustee of Estate of Robert Francis
Application Approved By David Jozowski for Amherst Health Dept Date 6/19/90

Application Disapproved for the following reasons: _____

Permit No. 90-7 Issued _____ Date _____

THE COMMONWEALTH OF MASSACHUSETTS

BOARD OF HEALTH

Town OF Amherst

Certificate of Compliance

THIS IS TO CERTIFY, That the Individual Sewage Disposal System constructed () or Repaired () by KARL'S EXCAVATING Installer at 170 MARKET HILL ROAD has been installed in accordance with the provisions of TITLE 5 of the State Environmental Code as described in the application for Disposal Works Construction Permit No. 90-7 dated _____

THE ISSUANCE OF THIS CERTIFICATE SHALL NOT BE CONSTRUED AS A GUARANTEE THAT THE SYSTEM WILL FUNCTION SATISFACTORY.

DATE _____ Inspector _____

THE COMMONWEALTH OF MASSACHUSETTS

BOARD OF HEALTH

Town OF Amherst

Disposal Works Construction Permit

CK# - 151
100.00 Plans
60.00 Penn
FEE 160.00

No. 90-7

Permission is hereby granted KARL'S to Construct () or Repair () an Individual Sewage Disposal System at No. 170 MARKET HILL ROAD Street as shown on the application for Disposal Works Construction Permit No. 90-7 Dated _____

DATE 6/19/90 David Jozowski for the Amherst Board of Health

CHECK OR FILL IN WHERE APPLICABLE

1937

1937

1937

1937

1937

1937

CITY/TOWN OF Amherst
 PERC TEST DATA SHEET

DATE 5/31/98 LOCATION 170 MARKET Hill Road LOT SIZE _____
 OWNER Trus Paul Carman ADDRESS 110 MARKET 01105 SUITE 211 SPRINGFIELD TEL.# 737-4797
 P.E./RS Robert Stover FIRM FILIOS ENT. OBSERVED BY D. ZAROZINSKI
 BACK HOE OPERATOR MARL'S BENCH MARK _____

PERC DEPTH 42" PRE SOAK TIME 3:20 PERC DEPTH _____ PRE SOAK TIME _____
 TEST 12" 3:21 8" 3:36 _____
11" - 7" 3:37 _____
10" - 6" 3:38 _____
9" 3:34³⁰ _____
 RATE (2) RATE _____

#1			
TOP 4"		TOP	
SUB 16"		SUB	
STRATIFIED SAND + gravel			
Dry 13'6"			
TOP		TOP	
SUB		SUB	
TOP		TOP	
SUB		SUB	

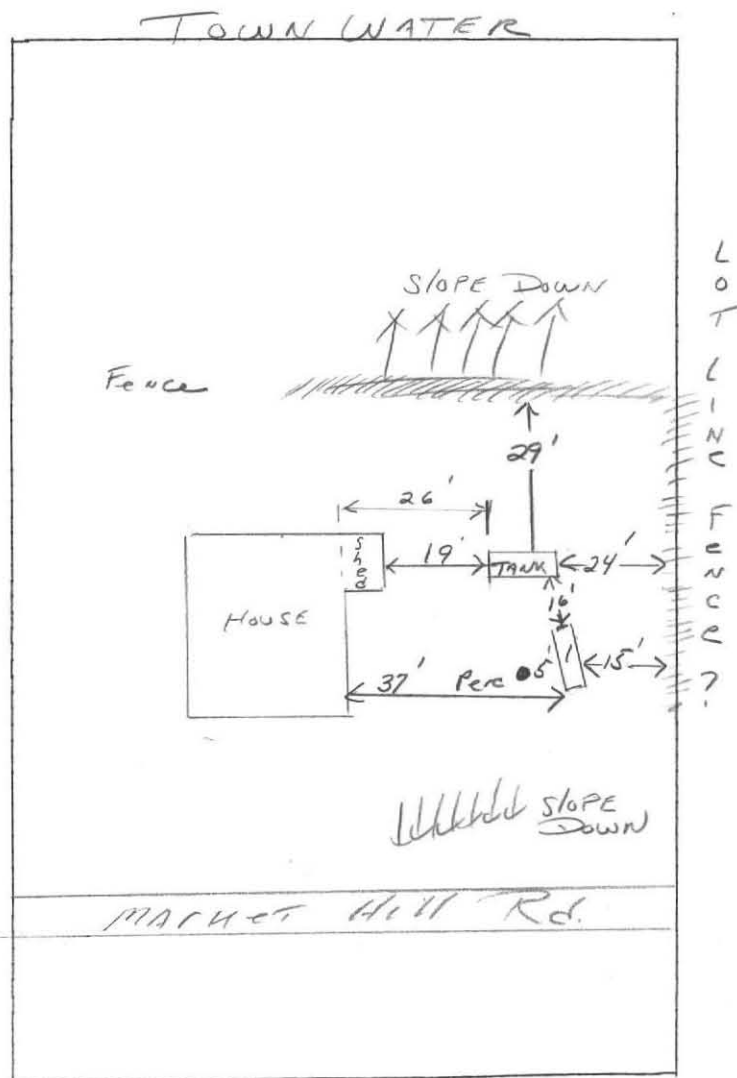

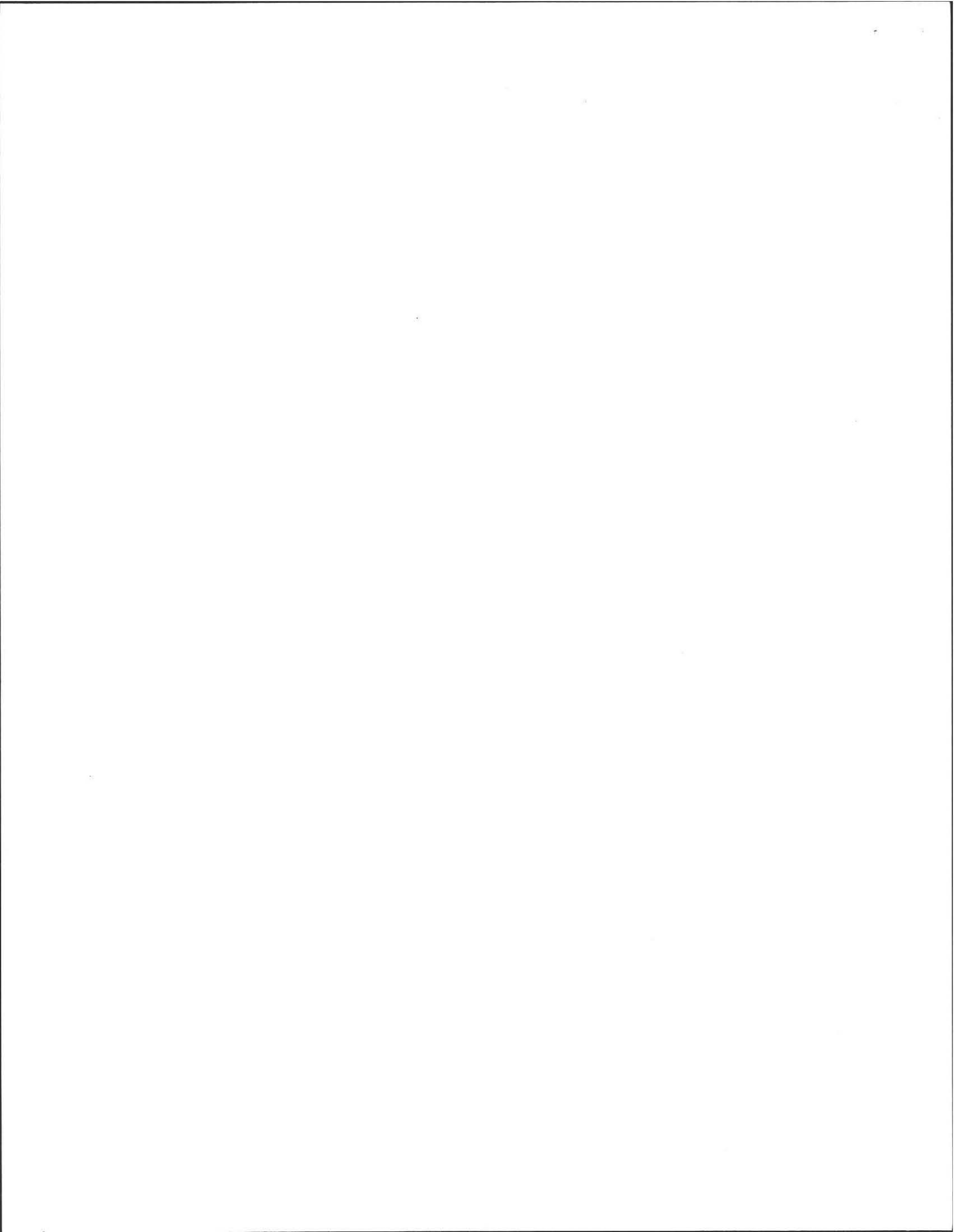

JUN 19 1990

Deep Soil Logs

Filios Enterprises, Inc.

69 Pelham Rd., Amherst MA 01002, (413) 256-8008

Owner: ESTATE OF ROBT. FRANCIS CARMEN ASSOCIATES-TRUSTEE Date: MAY 31, 1990
(PAUL CARMEN)
Location: 170 MARKET HILL RD B. of H. DAVID ZAROZINSKI
AMHERST, MA

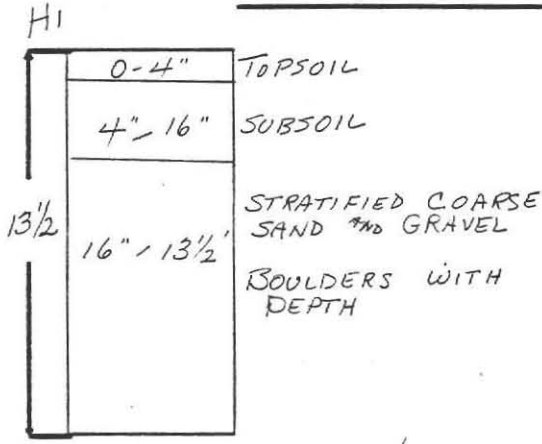

Ground Water None

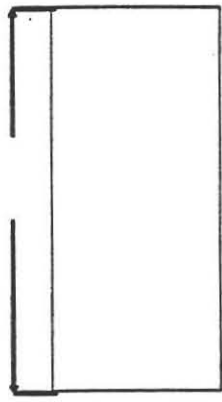

Ground Water _____

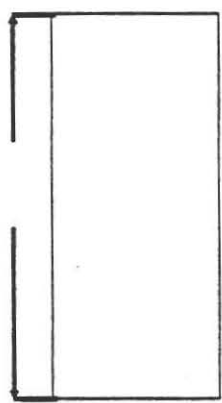

Ground Water _____

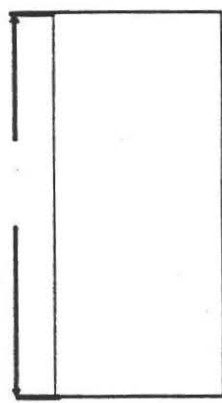

Ground Water _____

Percolation Rate at: 42"
2 min./inch



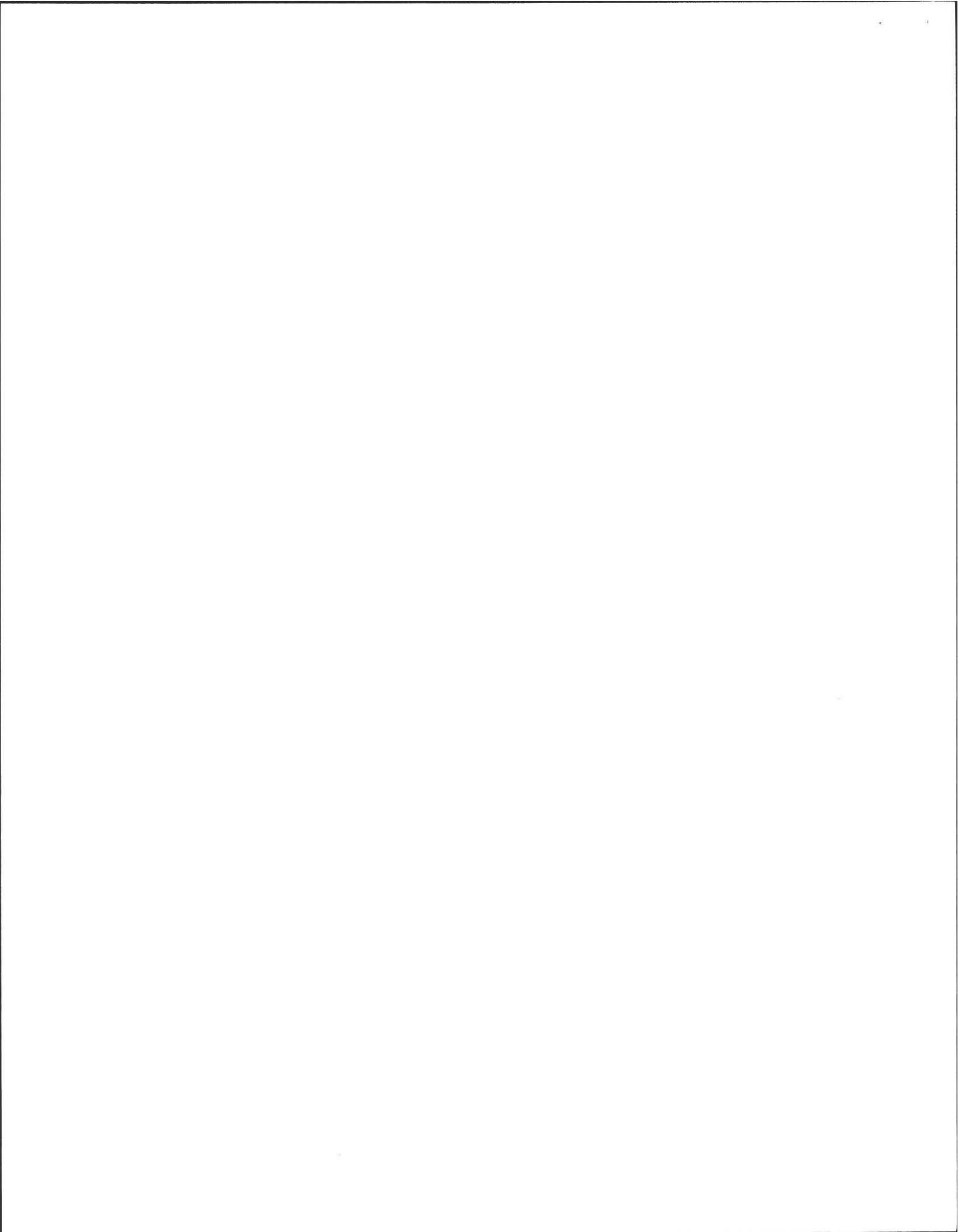

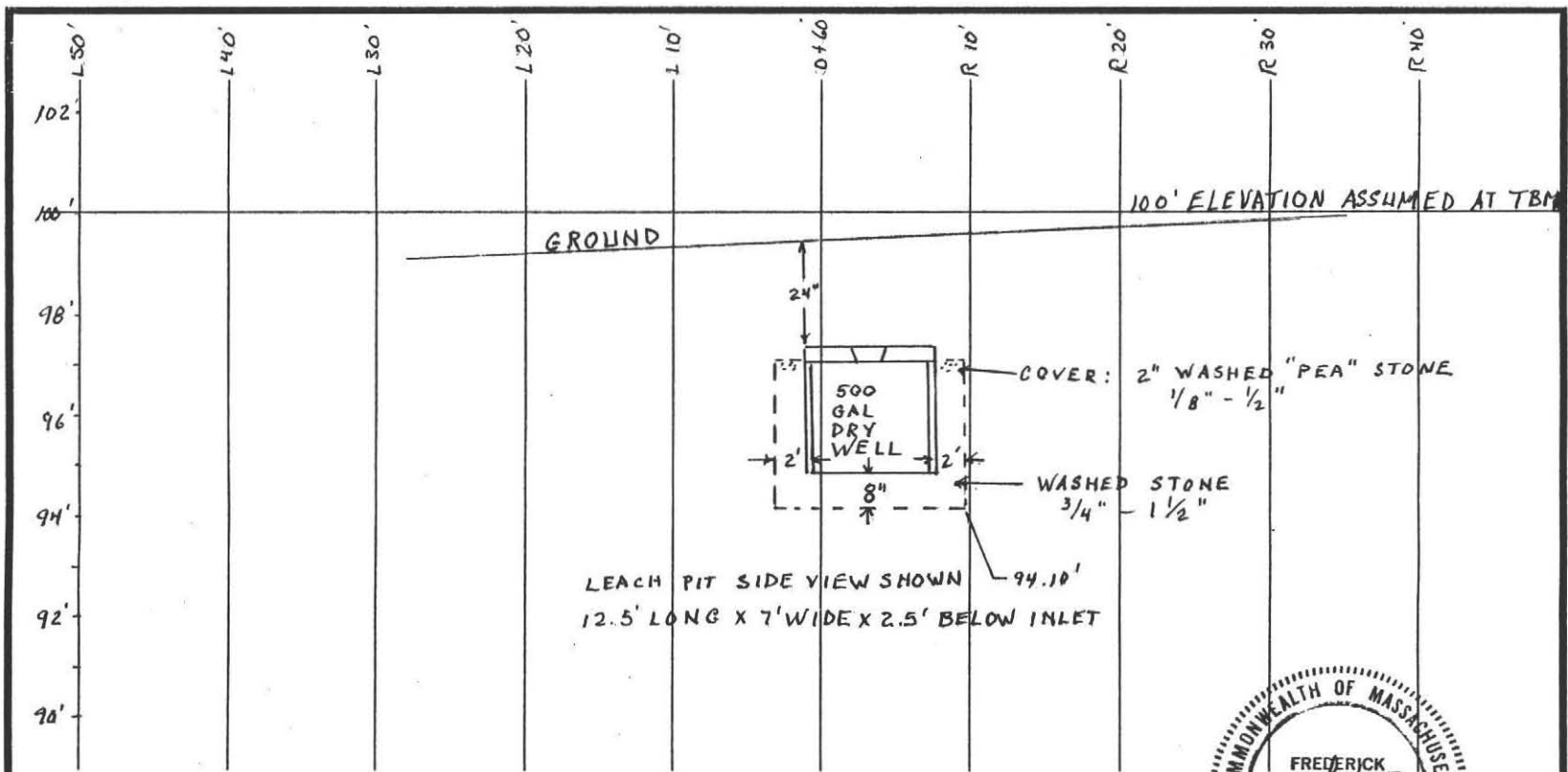

CROSS SECTION AT A-A' (0+60)



CLIENT: THE ESTATE OF ROBERT FRANCIS
 PAUL CARMEN ASSOCIATES
 110 MAPLE ST. SUITE 211
 SPRINGFIELD, MA 01105

SITE:
 170 MARKET HILL RD
 AMHERST MA

BY: FILIOS ENTERPRISES, INC.
 69 PELHAM ROAD
 AMHERST, MA 01002

DATE: JUNE 18, 1990 R. STOVER.

SCALE: HORIZONTAL: 1" = 10'-00"
 VERTICAL: 1" = 03'-00"

JUN 19 1990

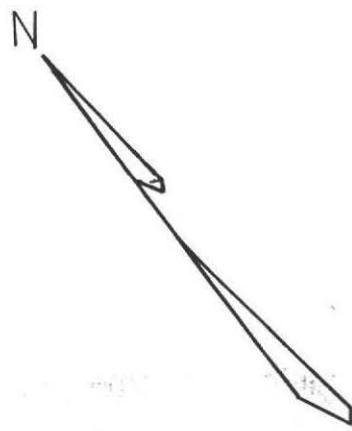

JUN 19 1990

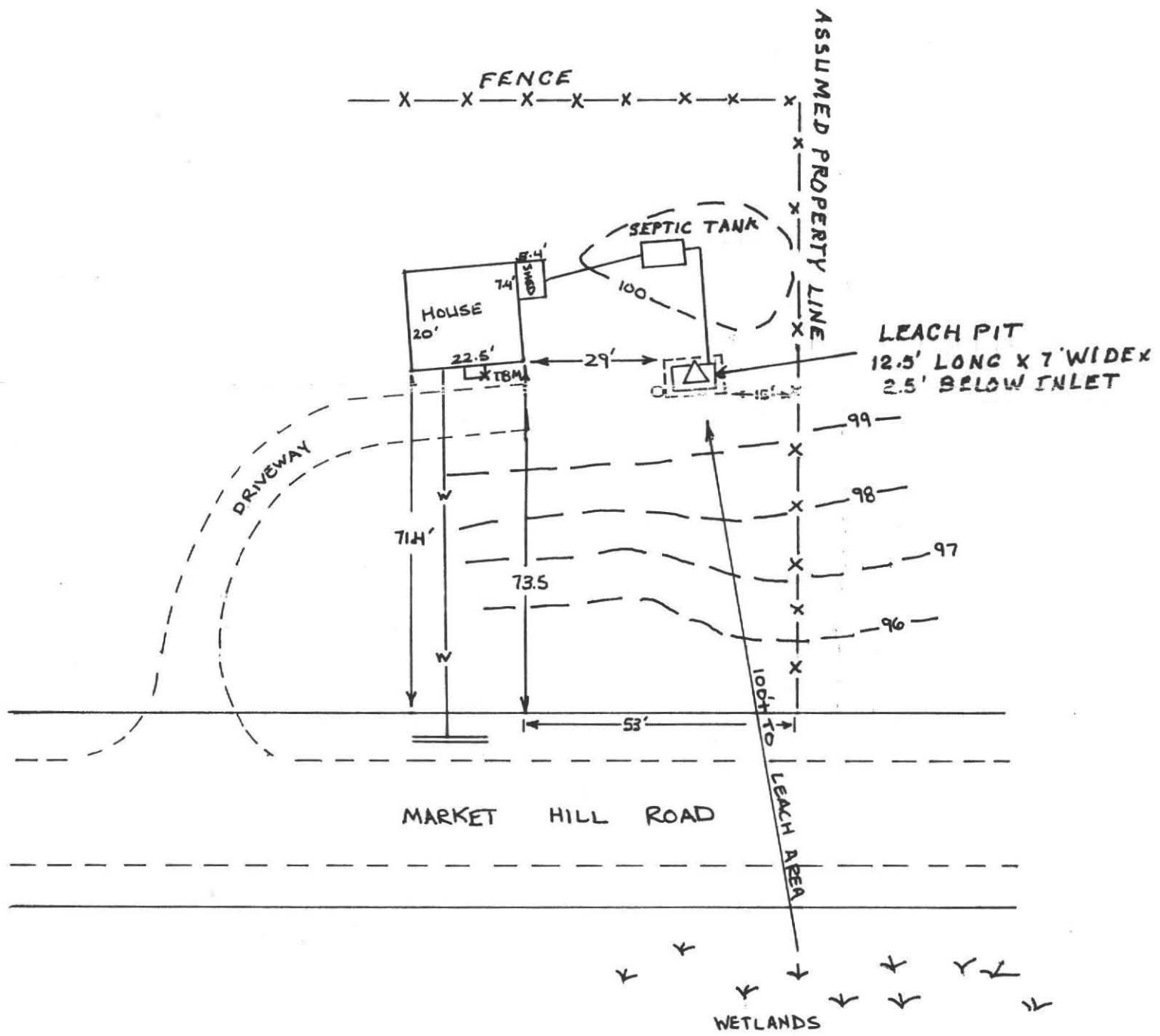

<p>PLAN SHOWING SEWAGE DISPOSAL REPAIR AT 170 MARKET HILL RD. AMHERST, MA</p>
<p>FOR: ROBERT FRANCIS ESTATE CARMAN ASSOCIATES 110 MAPLE ST. SUITE 211 SPRINGFIELD, MA 01105</p>
<p>BY: FILIOS ENTERPRISES, INC. 69 PELHAM ROAD AMHERST, MA 01002</p>
<p>DATE: JUNE 18, 1990 DRAFTED BY: R. STOVER</p>
<p>SCALE: 1" = 30' 00"</p>

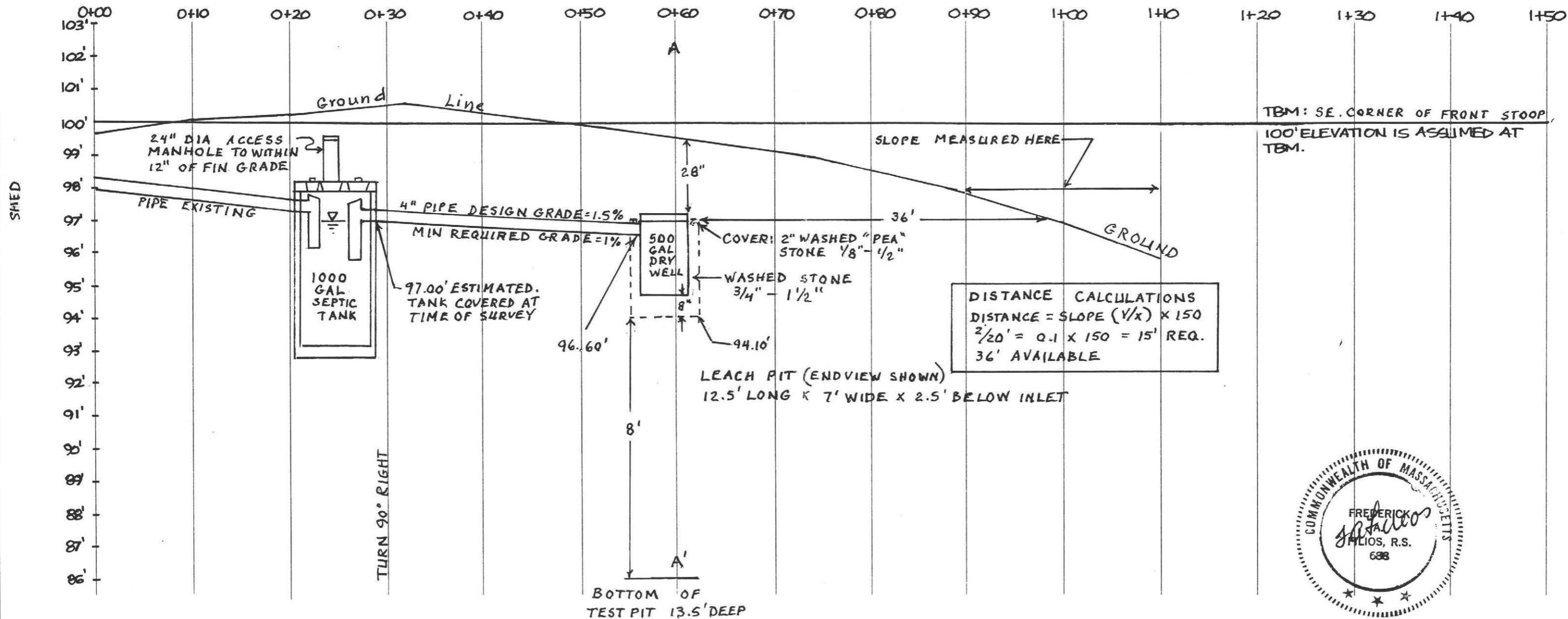

LEACHING AREA REQUIREMENTS CALCULATIONS

REQUIRED CAPACITY FOR A ONE BEDROOM IN AMHERST MA.
 (TOWN OF AMHERST REQUIRES 125% OF TITLE 5 CAPACITY):
 ONE BEDROOM X 110 GAL./BEDROOM X 125% = 137.5 GAL REQUIRED.

PROPOSED SYSTEM OF ONE LEACH PIT: 12.5' LONG X 7' WIDE X 2.5' BELOW INLET (EFFECTIVE DEPTH).

DESIGNED WITH A PERCOLATION RATE OF 2 MIN/INCH GIVING SIDEWALL AND BOTTOM AREA LOADING FACTORS OF 2.5 AND 1.0 GAL. PER SQ. FT. RESPECTIVELY

SIDEWALL: (12.5' x 2.5') x 2 SIDES = 62.5 SQ. FT. x 2.5 GAL = 156.25 GAL
 ENDWALL: (7.0' x 2.5') x 2 ENDS = 35.0 SQ. FT. x 2.5 GAL = 87.50 GAL
 BOTTOM AREA 12.5' x 7.0' = 87.5 SQ. FT. x 1.0 GAL = 87.50 GAL

TOTAL CAPACITY OF PROPOSED SYSTEM: 331.25 GAL.

CONSTRUCTION NOTES

1. Septic tank should be inspected and pumped annually.
2. Inlet and outlet tee must extend 10" and 14" below the flow line respectively.
3. The pipes exiting the D.Box must remain level for at least 2'.
4. Topsoil and subsoil must be removed to a distance of 10' around system and where fill is to be used.

SPECIFICATIONS

All materials and construction must be in accordance with Commonwealth of MA Dept. of Environmental Protection State Environmental Code Title 5.

PROFILE OF SEPTIC SYSTEM

CLIENT: THE ESTATE OF ROBERT FRANCIS
 PAUL CARMAN ASSOCIATES
 110 MAPLE STREET SUITE 211
 SPRINGFIELD, MA. 01105

SITE: 170 MARKET HILL ROAD
 AMHERST MA.

BY: FILIOS ENTERPRISES, INC.
 69 PELHAM ROAD
 AMHERST, MA 01002

JUN 19 1990

DATE: JUNE 19, 1990 R STOVER

SCALE: HORIZONTAL: 1" = 10'-00"
 VERTICAL: 1" = 03'-00"



11-05 COPY
JUL 26 1990

FILIOS ENTERPRISES, INC.
69 Pelham Road
Amherst, Ma 01002

July 19, 1990

Estate of Robert Francis
c/o Paul Carman Associates
110 Maple St. Suite 211
Springfield, Ma 01105

Dear Sir or Madam,

This is to notify you that Filios Enterprises, Inc. has inspected the septic system installed at 170 Market Hill Road in Amherst, Ma.

Unless exceptions are noted below, the system complied with the approved design and elevations.

Exception:

The elevations of the "as-built" septic system vary from those of the approved design to the extent shown in red on the copy of the profile enclosed.

Sincerely,



Frederick A. Filios

c.c. to Board of Health

1870

JUL 26 1990

AMHERST HEALTH DEPARTMENT
 BANGS COMMUNITY CENTER
 70 BOLTWOOD WALK
 AMHERST, MA 01002

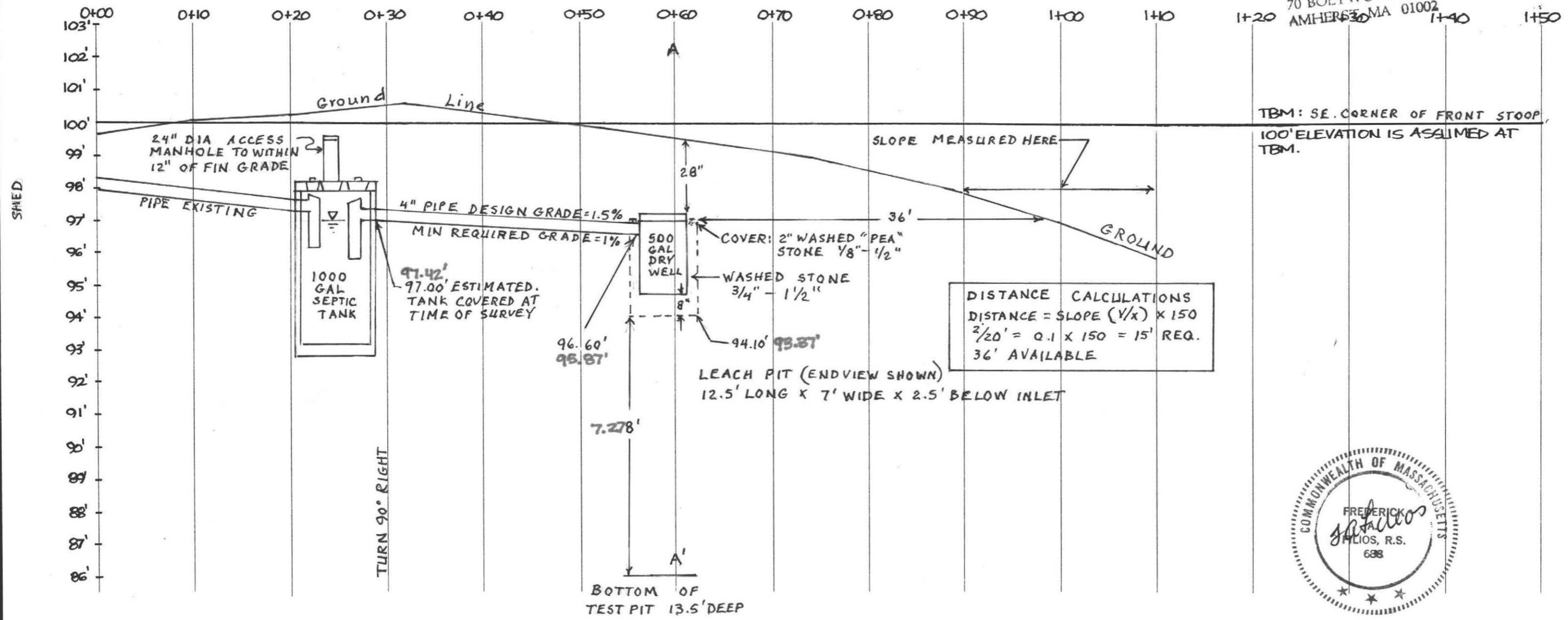

LEACHING AREA REQUIREMENTS
 CALCULATIONS

REQUIRED CAPACITY FOR A ONE BEDROOM IN AMHERST MA.
 (TOWN OF AMHERST REQUIRES 125% OF TITLE 5 CAPACITY):
 ONE BEDROOM X 110 GAL./BEDROOM X 125% = 137.5 GAL REQUIRED.

PROPOSED SYSTEM OF ONE LEACH PIT: 12.5' LONG X 7' WIDE
 X 2.5' BELOW INLET (EFFECTIVE DEPTH).

DESIGNED WITH A PERCOLATION RATE OF 2 MIN/INCH
 GIVING SIDEWALL AND BOTTOM AREA LOADING FACTORS
 OF 2.5 AND 1.0 GAL. PER SQ. FT. RESPECTIVELY.

SIDEWALL: (12.5' x 2.5') x 2 SIDES = 62.5 SQ. FT. x 2.5 GAL = 156.25 GAL
 ENDWALL: (7.0' x 2.5') x 2 ENDS = 35.0 SQ. FT. x 2.5 GAL = 87.50 GAL
 BOTTOM AREA 12.5' x 7.0' = 87.5 SQ. FT. x 1.0 GAL = 87.50 GAL

TOTAL CAPACITY OF PROPOSED SYSTEM: 331.25 GAL.

CONSTRUCTION NOTES

1. Septic tank should be inspected and pumped annually.
2. Inlet and outlet tee must extend 10" and 14" below the flow line respectively.
3. The pipes exiting the D.Box must remain level for at least 2'.
4. Topsoil and subsoil must be removed to a distance of 10' around system and where fill is to be used.

SPECIFICATIONS

All materials and construction must be in accordance with Commonwealth of MA Dept. of Environmental Protection State Environmental Code Title 5.

PROFILE OF SEPTIC SYSTEM

CLIENT: THE ESTATE OF ROBERT FRANCIS
 PAUL CARMAN ASSOCIATES
 110 MAPLE STREET SUITE 211
 SPRINGFIELD, MA. 01105

SITE: 170 MARKET HILL ROAD
 AMHERST MA.

BY: FILIOS ENTERPRISES, INC.
 69 PELHAM ROAD
 AMHERST, MA 01002

DATE: JUNE 19, 1990 R. STOVER

SCALE: HORIZONTAL: 1" = 10'-00"
 VERTICAL: 1" = 03'-00"

3317 02 CVT

THE FOLLOWING IS A SUMMARY OF THE DATA FOR THE 3317 02 CVT

1. *[Faded text]*

2. *[Faded text]*

3. *[Faded text]*

4. *[Faded text]*

5. *[Faded text]*

6. *[Faded text]*

7. *[Faded text]*

8. *[Faded text]*

9. *[Faded text]*

10. *[Faded text]*

11. *[Faded text]*

12. *[Faded text]*

13. *[Faded text]*

14. *[Faded text]*

15. *[Faded text]*

16. *[Faded text]*

17. *[Faded text]*

18. *[Faded text]*

19. *[Faded text]*

20. *[Faded text]*

21. *[Faded text]*

22. *[Faded text]*

23. *[Faded text]*

24. *[Faded text]*

25. *[Faded text]*

26. *[Faded text]*

27. *[Faded text]*

28. *[Faded text]*

29. *[Faded text]*

30. *[Faded text]*

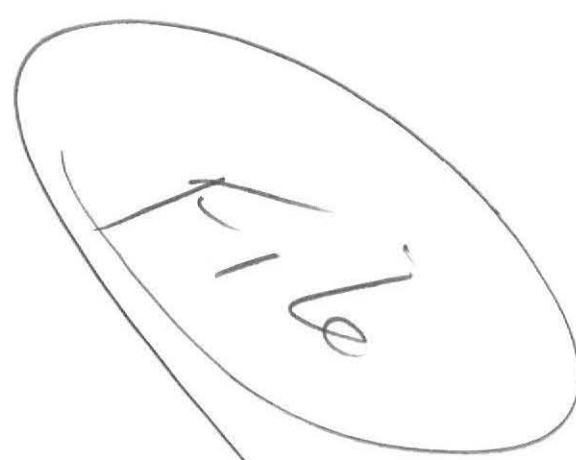

REGISTERED ON LEAF 7100A

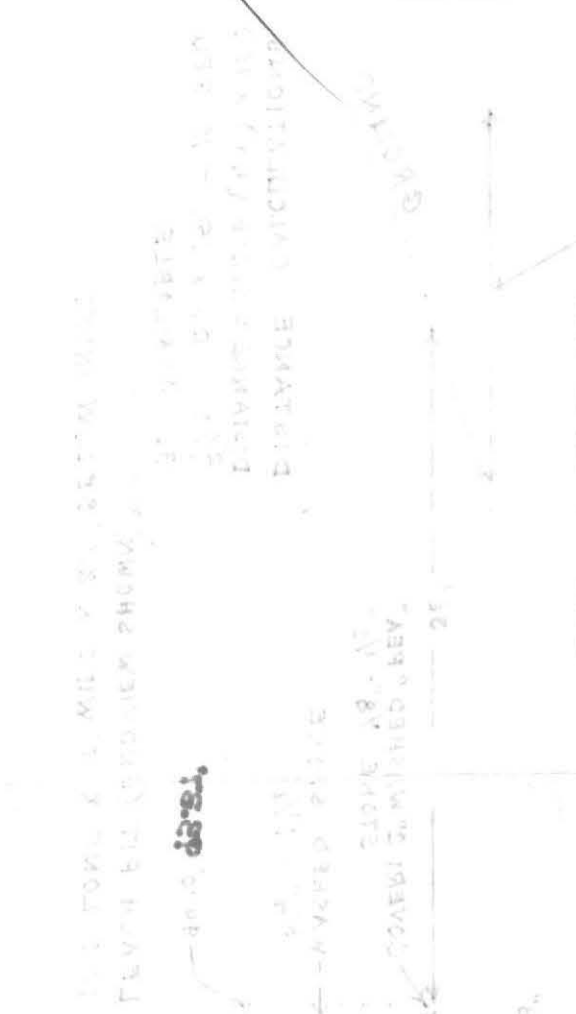

THE TOTAL LENGTH OF THE ROAD IS 3.217 KM WHICH IS 3.217 KM (3217 METERS) PHASE

desi.

desi.

desi.

desi.

2442

ENDING

A