

Levee T-d  
25-31



No. 99-27

#73

CHK # 4822 FEE 160.00 PD

COMMONWEALTH OF MASSACHUSETTS

Board of Health, Amherst, MA.

APPLICATION FOR DISPOSAL SYSTEM CONSTRUCTION PERMIT



Application for a Permit to Construct ( ) Repair (x) Upgrade (x) Abandon ( ) -  Complete System  Individual Components

Location	73 Leverett Rd.	Owner's Name	John F. Skidmore
Map/Parcel#		Address	50 Hastings Hgts, Northampton
Lot#		Telephone#	413-586-1827
Installer's Name	Karl's	Designer's Name	Alan Weiss
Address	327 River Drive Hadley	Address	Belchertown
Telephone#	549-5396	Telephone#	413-373-5957

Type of Building Res. Lot Size 19,950 +/- sq. ft.  
 Dwelling - No. of Bedrooms 4 Garbage grinder (N)  
 Other - Type of Building \_\_\_\_\_ No. of persons \_\_\_\_\_ Showers ( ), Cafeteria ( )  
 Other Fixtures \_\_\_\_\_  
 Design Flow (min. required) 440 gpd Calculated design flow 504 Design flow provided 504 gpd  
 Plan: Date 12/13/99 Number of sheets 4 Revision Date 12  
 Title SEPTIC REPAIR DESIGN  
 Description of Soil(s) CLASS I. LOAMY SAND  
 Soil Evaluator Form No. \_\_\_\_\_ Name of Soil Evaluator A. Weiss Date of Evaluation 11/04/99

DESCRIPTION OF REPAIRS OR ALTERATIONS New S. TANK, P. chamber + L. Field.

The undersigned agrees to install the above described Individual Sewage Disposal System in accordance with the provisions of TITLE 5 and further agrees to not to place the system in operation until a Certificate of Compliance has been issued by the Board of Health.

Signed John F. Skidmore Jr. Date 12-13-99

Inspections \_\_\_\_\_

No. 99-27

COMMONWEALTH OF MASSACHUSETTS

Board of Health, Amherst, MA.

CERTIFICATE OF COMPLIANCE

FEE 160.00 PD

Description of Work:  Individual Component(s)  Complete System

The undersigned hereby certify that the Sewage Disposal System; Constructed ( ), Repaired ( ), Upgraded ( ), Abandoned ( )

by: \_\_\_\_\_ at 73 Leverett Road

has been installed in accordance with the provisions of 310 CMR 15.00 (Title 5) and the approved design plans/as-built plans relating to application No. 99-27, dated \_\_\_\_\_, Approved Design Flow \_\_\_\_\_ (gpd)

Installer Robert Seaman Inspector: Alan Weiss Date: 12-28-99

The issuance of this permit shall not be construed as a guarantee that the system will function as designed.

No. 99-27

COMMONWEALTH OF MASSACHUSETTS

Board of Health, Amherst, MA.

DISPOSAL SYSTEM CONSTRUCTION PERMIT

FEE 160.00 PD  
CHK 4822

Permission is hereby granted to; Construct ( ) Repair (x) Upgrade ( ) Abandon ( ) an individual sewage disposal system at 73 Leverett Road as described in the application for Disposal System Construction Permit No. 99-27, dated 12-15-99

Provided: Construction shall be completed within three years of the date of this permit. All local conditions must be met.

Form 1255 Rev. 5/96 A.M. Sulkin Co. Boston, MA Date 12-15-99 Board of Health Alan Weiss



REPUBLICAN PARTY - NATIONAL COMMITTEE

NAME	EDWARD J. BREWSTER
RESIDENCE	1234 5th St. N.W.
CITY	WASHINGTON, D.C.
STATE	D.C.
COUNTRY	U.S.A.

I hereby certify that the above named person is a member of the Republican Party of the District of Columbia, and that he is entitled to vote in the primary election to be held on the 15th day of June, 1912, at the residence of the said person.

Witness my hand and seal this 10th day of May, 1912.

REPUBLICAN PARTY - NATIONAL COMMITTEE

I hereby certify that the above named person is a member of the Republican Party of the District of Columbia, and that he is entitled to vote in the primary election to be held on the 15th day of June, 1912, at the residence of the said person.

Witness my hand and seal this 10th day of May, 1912.

REPUBLICAN PARTY - NATIONAL COMMITTEE

I hereby certify that the above named person is a member of the Republican Party of the District of Columbia, and that he is entitled to vote in the primary election to be held on the 15th day of June, 1912, at the residence of the said person.

Witness my hand and seal this 10th day of May, 1912.

4 Bedrooms

no c/c

160 ac  
64 # 4822  
12-14-99

No. \_\_\_\_\_

Date: 11-4-99

Commonwealth of Massachusetts  
, Massachusetts

Soil Suitability Assessment for On-site Sewage Disposal

Performed By: AL Weiss

Date: 11-4-99

Witnessed By: David Zarnowski

Location Address or Lot # <u>73 Bennett Road</u>	Owner's Name, Address, and Telephone # <u>John Skibiski</u> <u>P.O. Box 381</u> <u>Northampton 01061</u>
New Construction <input type="checkbox"/> Repair <input checked="" type="checkbox"/>	

Office Review

Published Soil Survey Available: No  Yes

Year Published \_\_\_\_\_ Publication Scale \_\_\_\_\_ Soil Map Unit \_\_\_\_\_

Drainage Class \_\_\_\_\_ Soil Limitations \_\_\_\_\_

Surficial Geologic Report Available: No  Yes

Year Published \_\_\_\_\_ Publication Scale \_\_\_\_\_

Geologic Material (Map Unit) \_\_\_\_\_

Landform \_\_\_\_\_

Flood Insurance Rate Map:

Above 500 year flood boundary No  Yes

Within 500 year flood boundary No  Yes

Within 100 year flood boundary No  Yes

Wetland Area:

National Wetland Inventory Map (map unit) \_\_\_\_\_

Wetlands Conservancy Program Map (map unit) \_\_\_\_\_

Current Water Resource Conditions (USGS): Month \_\_\_\_\_

Range :Above Normal  Normal  Below Normal

Other References Reviewed: \_\_\_\_\_



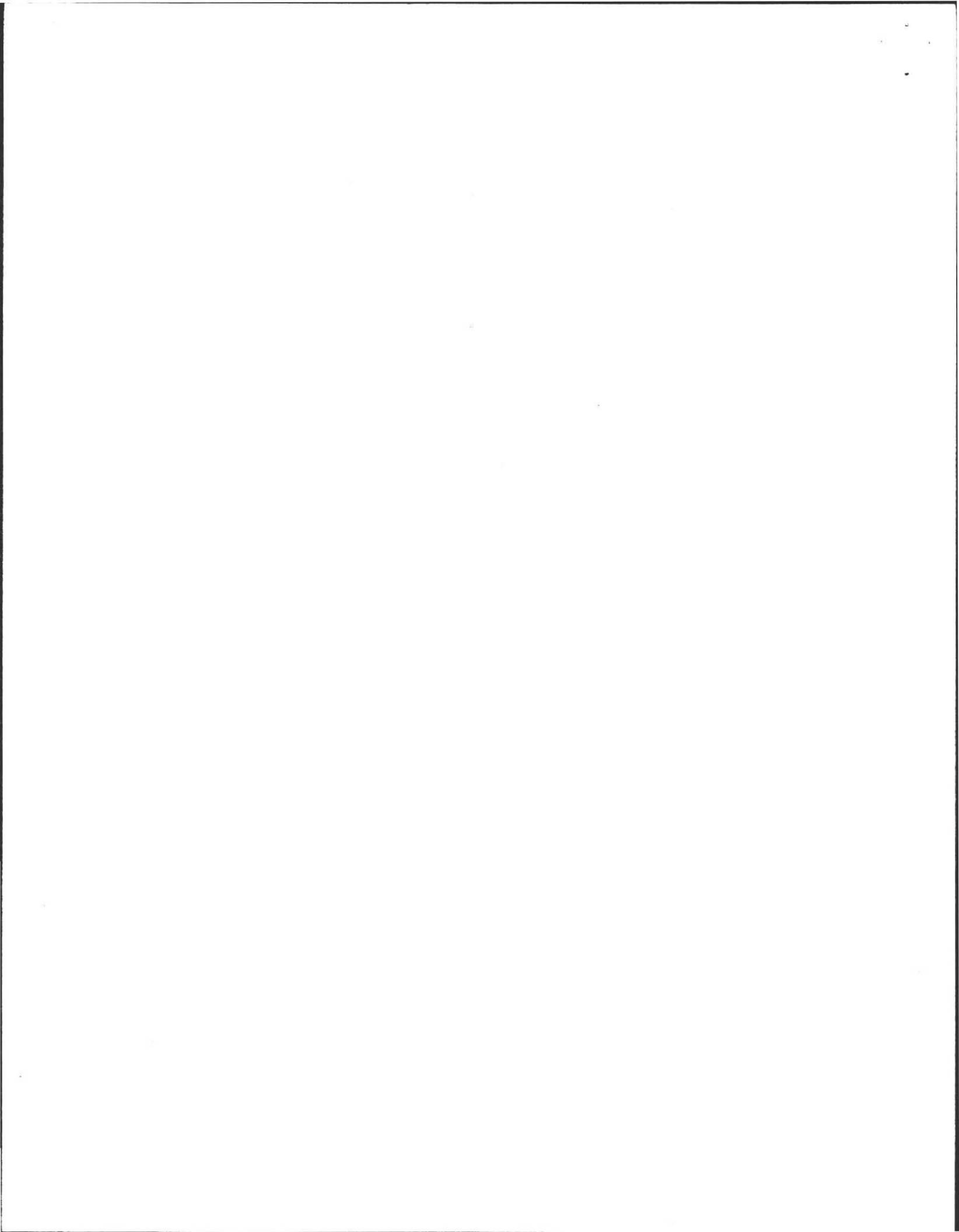

Location Address or Lot No. 73 LEVERETT RD

On-site Review

Deep Hole Number \_\_\_\_\_ Date: \_\_\_\_\_ Time: \_\_\_\_\_ Weather \_\_\_\_\_  
 Location (identify on site plan) \_\_\_\_\_  
 Land Use \_\_\_\_\_ Slope (%) \_\_\_\_\_ Surface Stones \_\_\_\_\_  
 Vegetation \_\_\_\_\_  
 Landform \_\_\_\_\_  
 Position on landscape (sketch on the back) \_\_\_\_\_  
 Distances from:  
 Open Water Body \_\_\_\_\_ feet Drainage way \_\_\_\_\_ feet  
 Possible Wet Area \_\_\_\_\_ feet Property Line \_\_\_\_\_ feet  
 Drinking Water Well \_\_\_\_\_ feet Other \_\_\_\_\_

DEEP OBSERVATION HOLE LOG*					
Depth from Surface (Inches)	Soil Horizon	Soil Texture (USDA)	Soil Color (Munsell)	Soil Mottling	Other (Structure, Stones, Boulders, Consistency, % Gravel)
8	A	KSL	10YR 3/2		
27	B <sub>w</sub>	KSL	10YR 4/6	36" STRONG 7.5YR 5/8	Fillie Sand Loose 20 to Boulder Cobbles
96"	C	LS	2.5Y 4/3		

\* MINIMUM OF 2 HOLES REQUIRED AT EVERY PROPOSED DISPOSAL AREA

Parent Material (geologic) \_\_\_\_\_ Depth to Bedrock: \_\_\_\_\_  
 Depth to Groundwater: Standing Water in the Hole: \_\_\_\_\_ Weeping from Pit Face: \_\_\_\_\_  
 Estimated Seasonal High Ground Water: \_\_\_\_\_



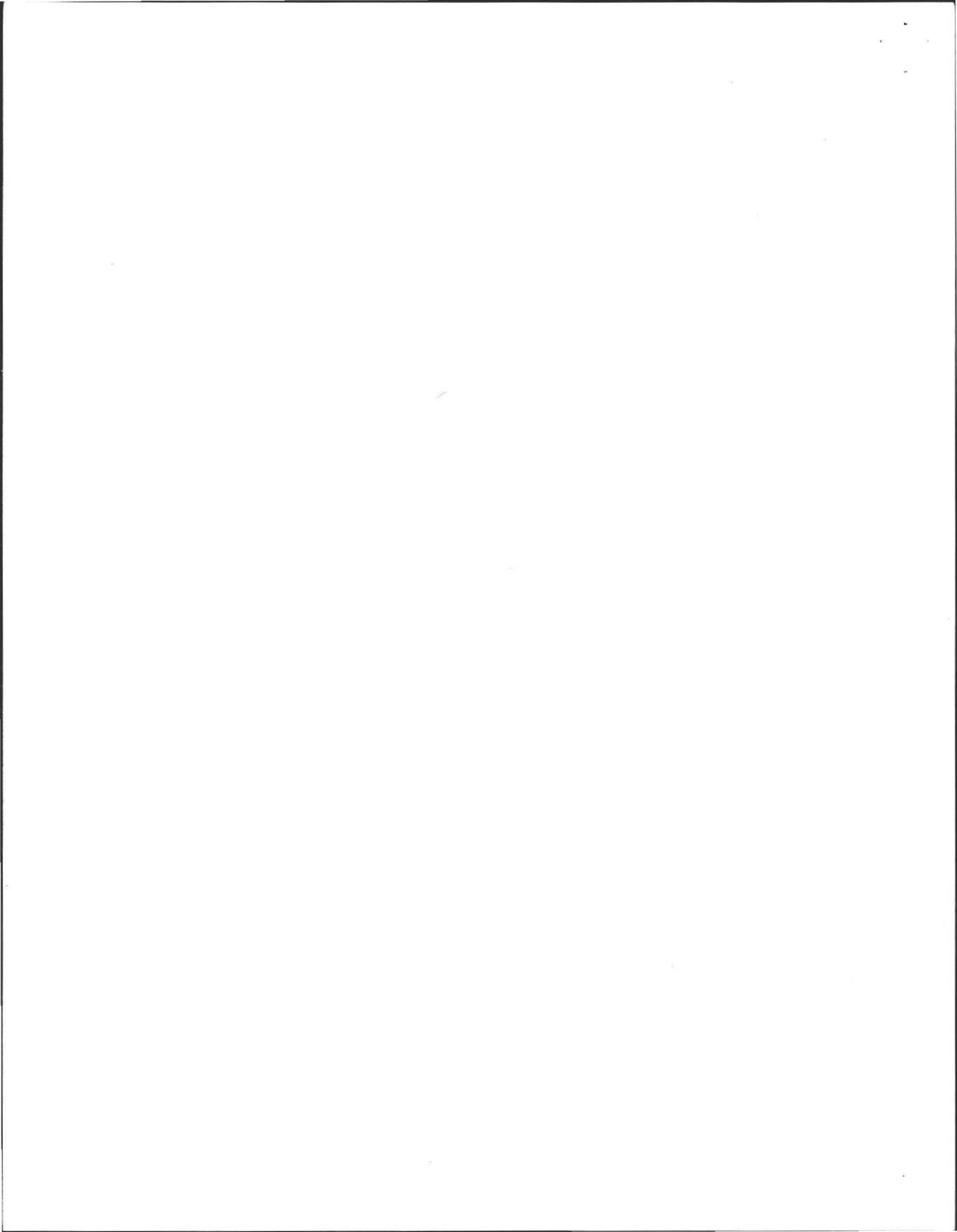



FORM 12 - PERCOLATION TEST

Location Address or Lot No. 73 Leverett Rd

COMMONWEALTH OF MASSACHUSETTS

, Massachusetts

Percolation Test*		
Date:		Time:
Observation Hole #	1	
Depth of Perc	38"	
Start Pre-soak	8:59	
End Pre-soak	9:15	
Time at 12"	9:15	
Time at 9"	9:31	
Time at 6"	10:00	
Time (9"-6")	9.5	
Rate Min./Inch	10	

\* Minimum of 1 percolation test must be performed in both the primary area AND reserve area.

Site Passed  Site Failed

Performed By: AL Weis

Witnessed By: David Zornelli

Comments: \_\_\_\_\_



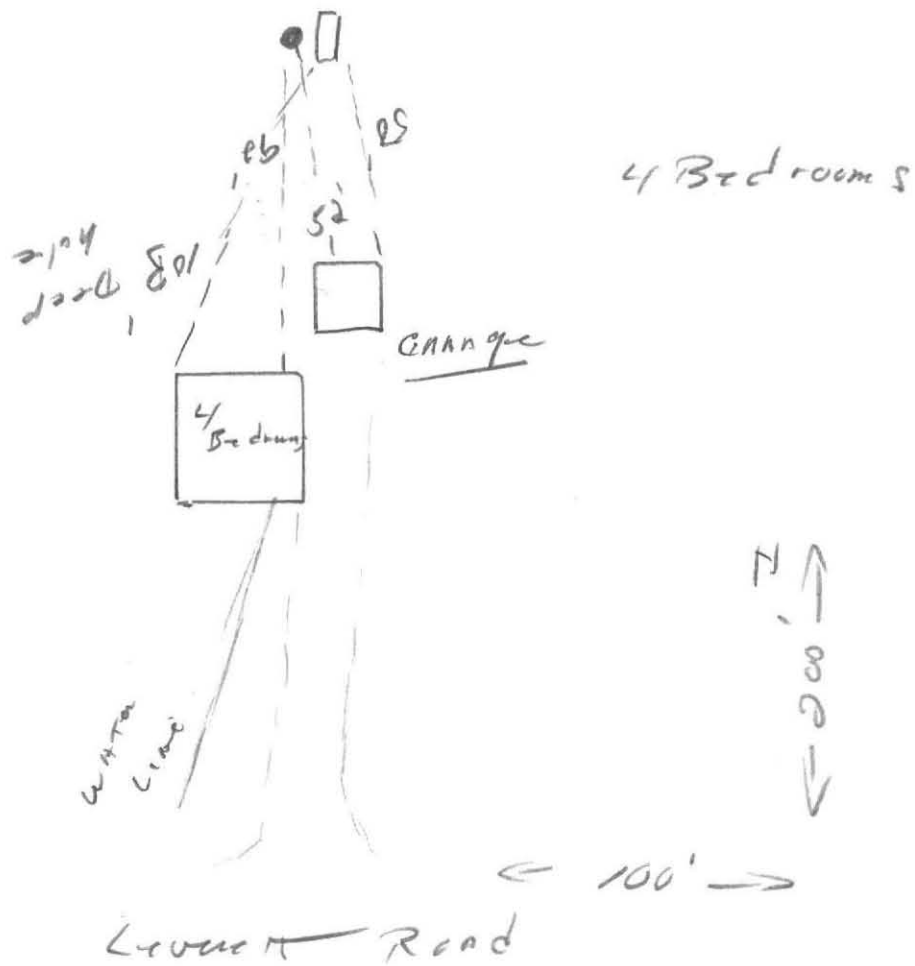

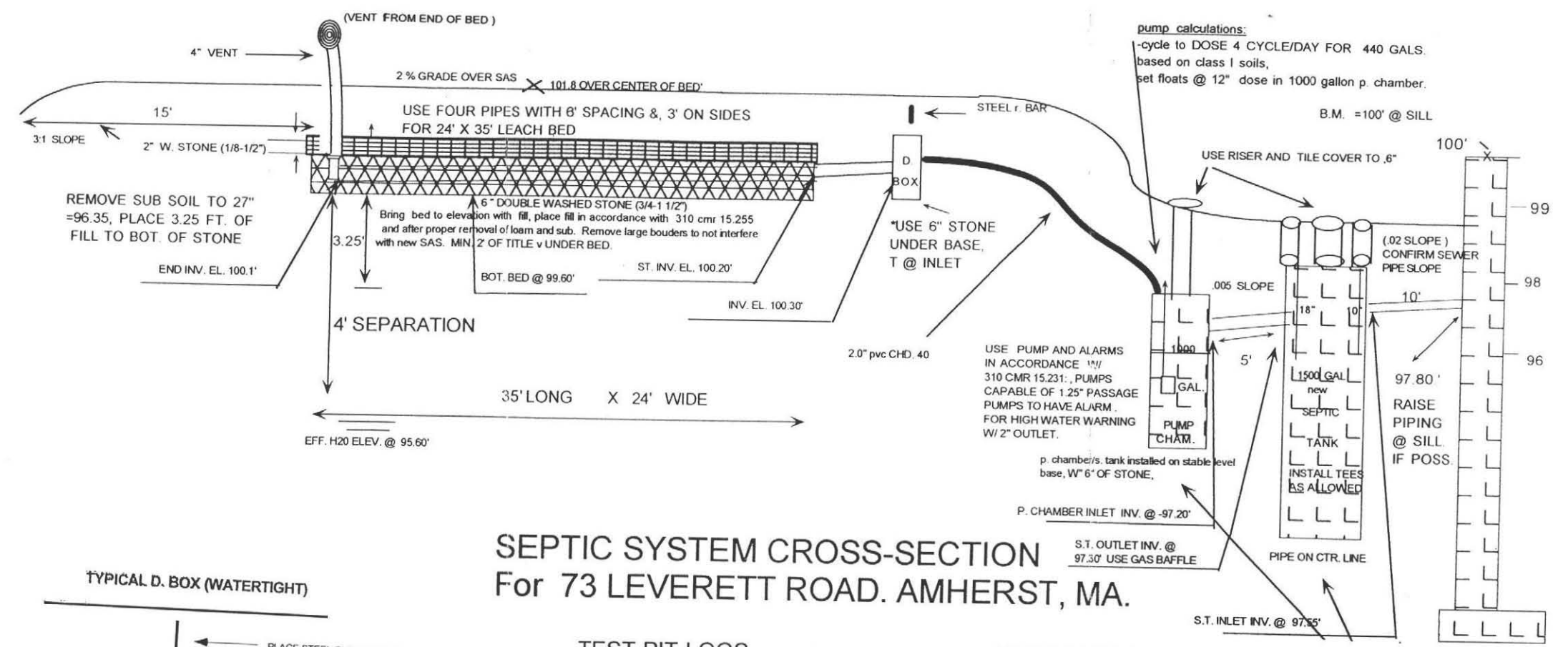
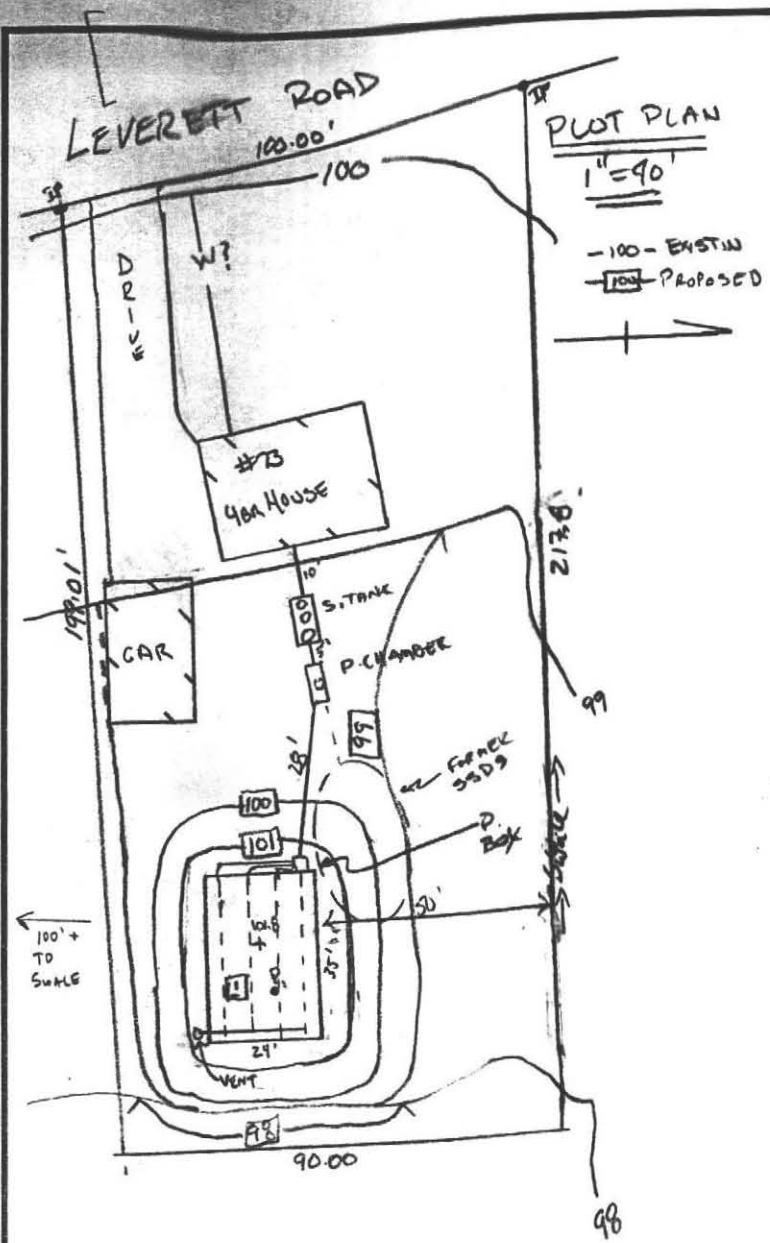

### SEPTIC SYSTEM CROSS-SECTION For 73 LEVERETT ROAD, AMHERST, MA.

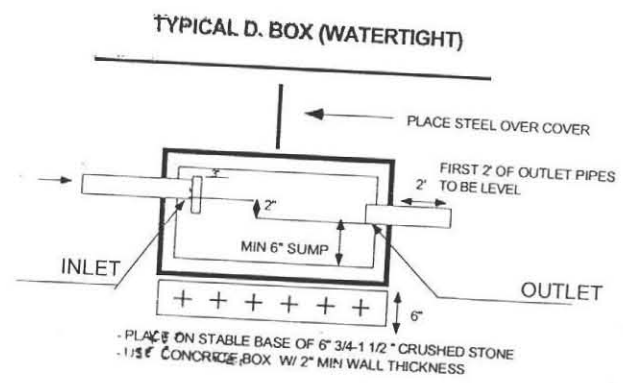

**TEST PIT LOGS**

TP-1 EL. 98.60' (EFFECTIVE)		
0-8"	FINE SANDY LOAM, FRIABLE (10YR 3/2)	A
8-27"	FINE SANDY LOAM, FRIABLE (10 YR 4/6)	BW
27-96"	FINE SAND, SOME COARSE SAND, LOOSE 20% BOULDERS AND COBBLES (2.5 Y 4/3)	C 1

EOP 96" @ TP-1  
ESHWT = 36" = 95.6' @ TP-1 (EFFECTIVE FOR DESIGN)

72" STATIC & SEEPS OF G. H2O  
NOT OBS. BEDROCK  
36" OXIDES (7.5 YR 5/6, STRONG)

- DESIGN NOTES:**
- 4BR. x 110 gal/day = 440 gal./day.
  - Use one Leach FIELD 24' wide x 35' LONG W/6" stone below invert. Bot. Area: 24' wide x 35' long = 840 sf. Side Area: NA. Tot. Area: 840 sf x 0.74 gal./sf. = 504 gal./day.
  - NO GARBAGE DISPOSAL ALLOWED.
  - ALL D. BOX OUTLET PIPES LEVEL FOR 2', ALL PERF./PIPE MIN. SDR .35.
  - NO WELLS NOTED WITHIN 100 FEET OF SAS SYSTEM
  - NO WETLANDS NOTED WITHIN 100 FEET OF SAS
  - PRE & POST CONTOURS NOTED AS NECESSARY.
  - RESERVE AREA: NOT REQUIRED
  - SLOPE CALCS NOT APPLIC. (SEE CONTOURS) 3:1 SLOPE MET
  - 2% MIN. SLOPE OVER SAS., SLOPE FINAL GRADE AWAY FROM SILL AND L. FIELD FOR RUNOFF
  - USE NEW 1,500 GAL. S. TANK AND NEW 1000 + GAL. PUMP CHAMBERS W/ PROPER FLOATS AND ALARMS PER 310 CMR. 15.231.
  - INSTALL TEES IN S. TANK, 10" AT INLET, 14" AT OUTLET AND CHAMBER BAFFLE
  - PERC TEST BY A. WEISS., ON 11/04/99, RATE = 10 MIN/IN -CLASS I SOILS IDENTIFIED. (LOAMY SAND) FOR LOADING FACTOR -CLASS I SOIL, @ 0.60 GAL/SF., BM=100 @ sill of house.
  - PUMP, CRUSH/FILL OLD TANK PER TITLE V REGS. (REMOVE OLD SYSTEM ONLY WHERE INTERFERES WITH NEW SAS).
  - FOUR FOOT SEPARATION PROVIDED TO ESHGW.
  - USE APPROVED DOUBLE WASHED 3/4 IN. STONE UNDER BED, D. BOX S. TANK AND P. CHAMBER (MIN. 6"). CONTRACTOR TO CONFIRM STONE PROPERLY WASHED WITH BUCKET/SILT H2O TEST.

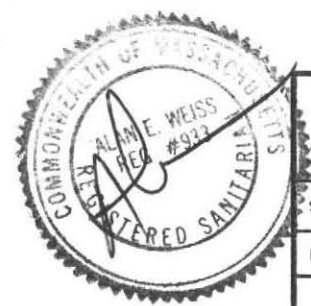
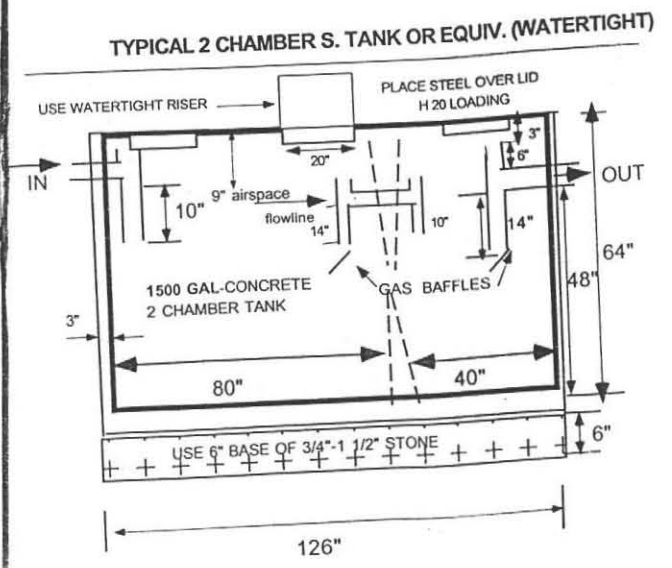
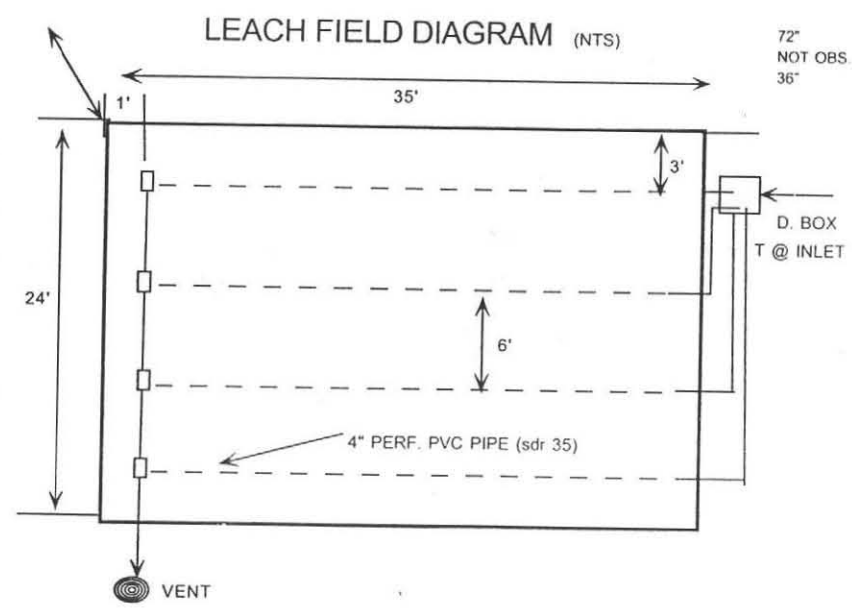

**SEPTIC DESIGN PLAN FOR JOHN SKIBISKI  
73 LEVERETT RD., AMHERST, MA**

SCALE: NOTED	APPROVED BY:	DRAWN BY <b>AW</b>
DATE: 12/13/99		REVISED
COLD SPRING ENVIRONMENTAL, INC.		DRAWING NUMBER <b>99-1132-1022</b>

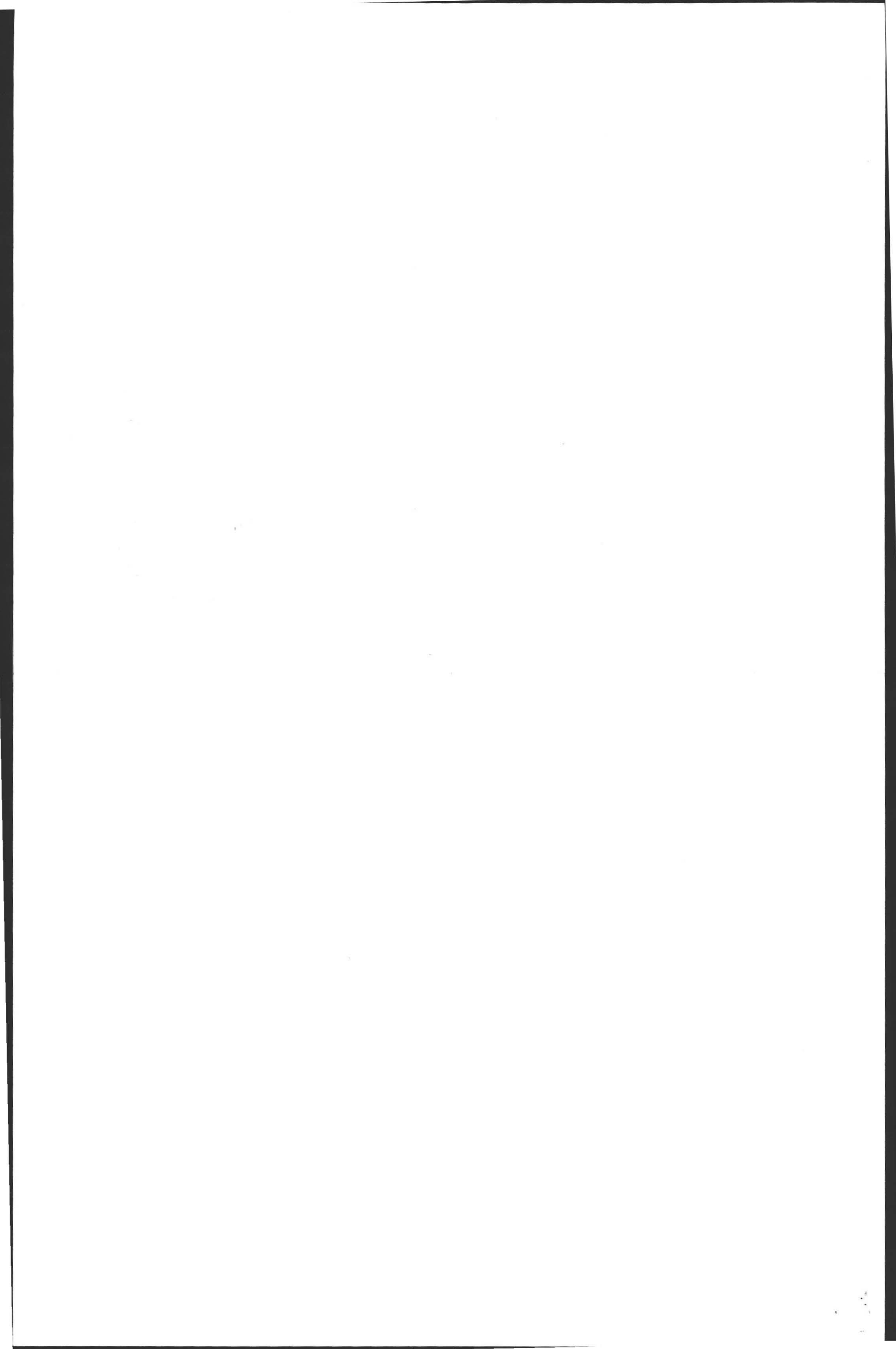



ALAN E. WEISS, M.S., L.S.P.

Licensed Site Professional  
Registered Sanitarian  
Hydrogeologist  
President

- Subsurface Investigations
- 21E Site Investigations
- Pollution Remediation
- Percolation Tests and Septic Designs

350 Old Enfield Rd.  
Belchertown, MA 01007  
(413) 323-5957 & 323-4916 (FAX)

Date: 11/4/99

Commonwealth of Massachusetts  
Amherst, Massachusetts

Soil Suitability Assessment for On-site Sewage Disposal

Performed By: A. Weiss

Date: 11/4/99

Witnessed By: D. ZAROZINSKI

Location Address or Lot # JOHN SKIBISKI 73 Leverett Rd. Amherst, MA	Owner's Name Address, and Telephone #
New Construction <input type="checkbox"/> Repair <input checked="" type="checkbox"/>	

Office Review

Published Soil Survey Available: No  Yes

Year Published 1981 Publication Scale 1:15,000 Soil Map Unit MeB

Drainage Class MOD-RAPID Soil Limitations

Surficial Geologic Report Available: No  Yes

Year Published Publication Scale

Geologic Material (Map Unit)

Landform

Flood Insurance Rate Map:

Above 500 year flood boundary No  Yes

Within 500 year flood boundary No  Yes

Within 100 year flood boundary No  Yes

Wetland Area:

National Wetland Inventory Map (map unit)

Wetlands Conservancy Program Map (map unit) N/A

Current Water Resource Conditions (USGS): Month

Range: Above Normal  Normal  Below Normal

Other References Reviewed:



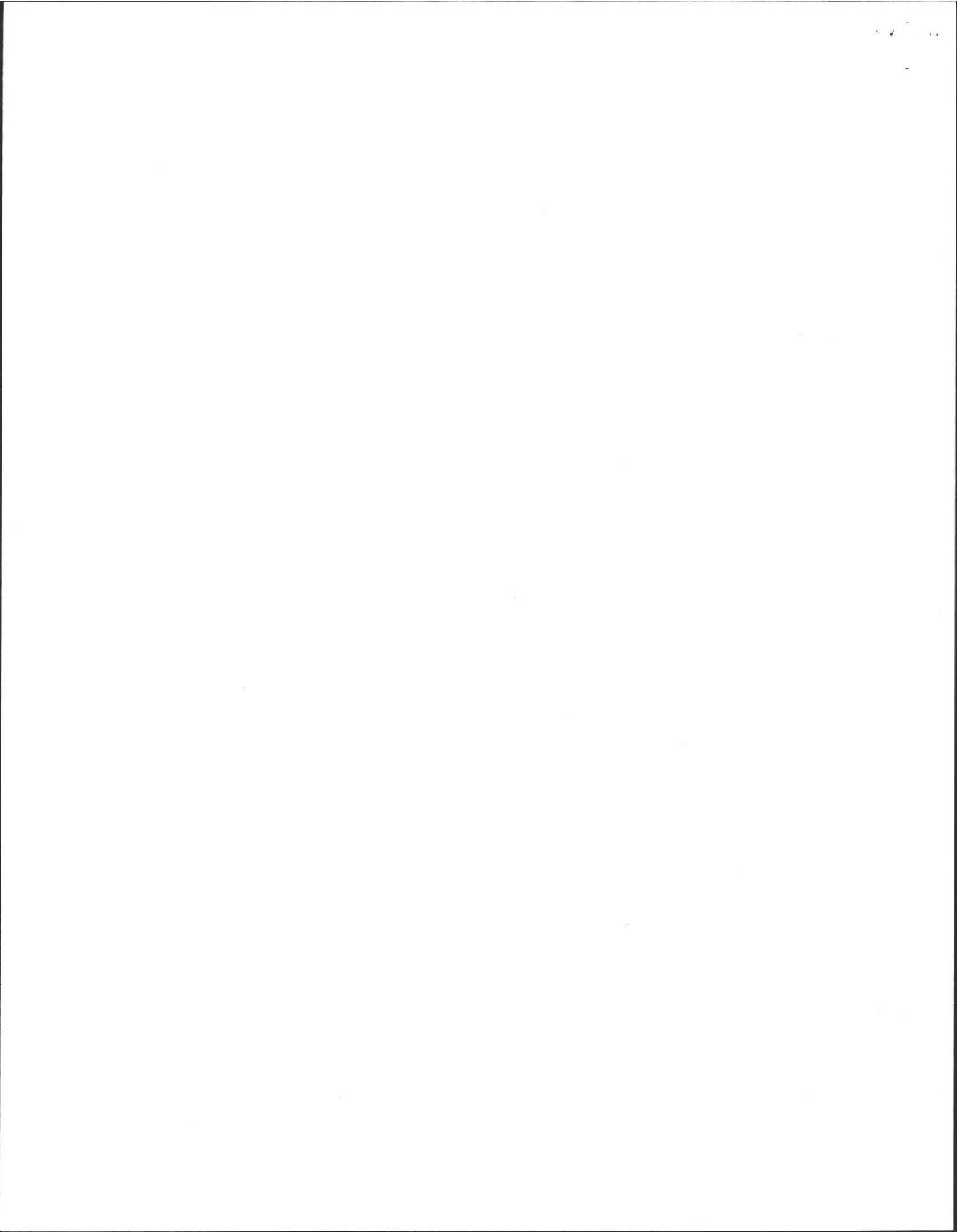

Location Address or Lot No. 73 Leverett Rd.

On-site Review

Deep Hole Number TP-1 Date: 11/4/99 Time: 8:00 AM Weather COLD  
 Location (identify on site plan) \_\_\_\_\_  
 Land Use Resid. Slope (%) 1 Surface Stones Few  
 Vegetation Deciduous  
 Landform Terrace

Position on landscape (sketch on the back)

Distances from:

Open Water Body 100' feet      Drainage way 55' feet  
 Possible Wet Area 100' feet      Property Line 30' feet  
 Drinking Water Well 100' feet      Other \_\_\_\_\_

**DEEP OBSERVATION HOLE LOG\***

Depth from Surface (Inches)	Soil Horizon	Soil Texture (USDA)	Soil Color (Munsell)	Soil Mottling	Other (Structure, Stones, Boulders, Consistency, % Gravel)
0-8"	A	FSL	10YR3/2		FRIABLE
8-27"	B <sub>w</sub>	FSL	10YR4/6		FRIABLE.
27"-96"	C <sub>1</sub>	LS	2.5Y4/3	7.5YR 5/8 e 36" STRONG.	F. Sand, some coarse Sand. Loose, outwash. 20% cobbles + boulders.

\* MINIMUM OF 2 HOLES REQUIRED AT EVERY PROPOSED DISPOSAL AREA

Parent Material (geologic) outwash.      Depth to Bedrock: 96" +  
 Depth to Groundwater: Standing Water in the Hole: 72"      Weeping from Pit Face: 72"  
 Estimated Seasonal High Ground Water: 36"







FORM 12 - PERCOLATION TEST

Location Address or Lot No. 73 Leverett Rd

COMMONWEALTH OF MASSACHUSETTS

, Massachusetts

Percolation Test*		
Date: <u>12/4/99</u>		Time: <u>8:00</u>
Observation Hole #	<u>P<sub>1</sub></u>	
Depth of Perc	<u>38"</u>	
Start Pre-soak	<u>8:59</u>	
End Pre-soak	<u>9:15</u>	
Time at 12"	<u>9:15</u>	
Time at 9"	<u>9:31</u>	
Time at 6"	<u>10:00</u>	
Time (9"-6")	<u>29 min</u>	
Rate Min./Inch	<u>9.5 MIN/IN</u>	

\* Minimum of 1 percolation test must be performed in both the primary area AND reserve area.

Site Passed  Site Failed

Performed By: A. Weiss

Witnessed By: D. ZAROWSKI

Comments: \_\_\_\_\_



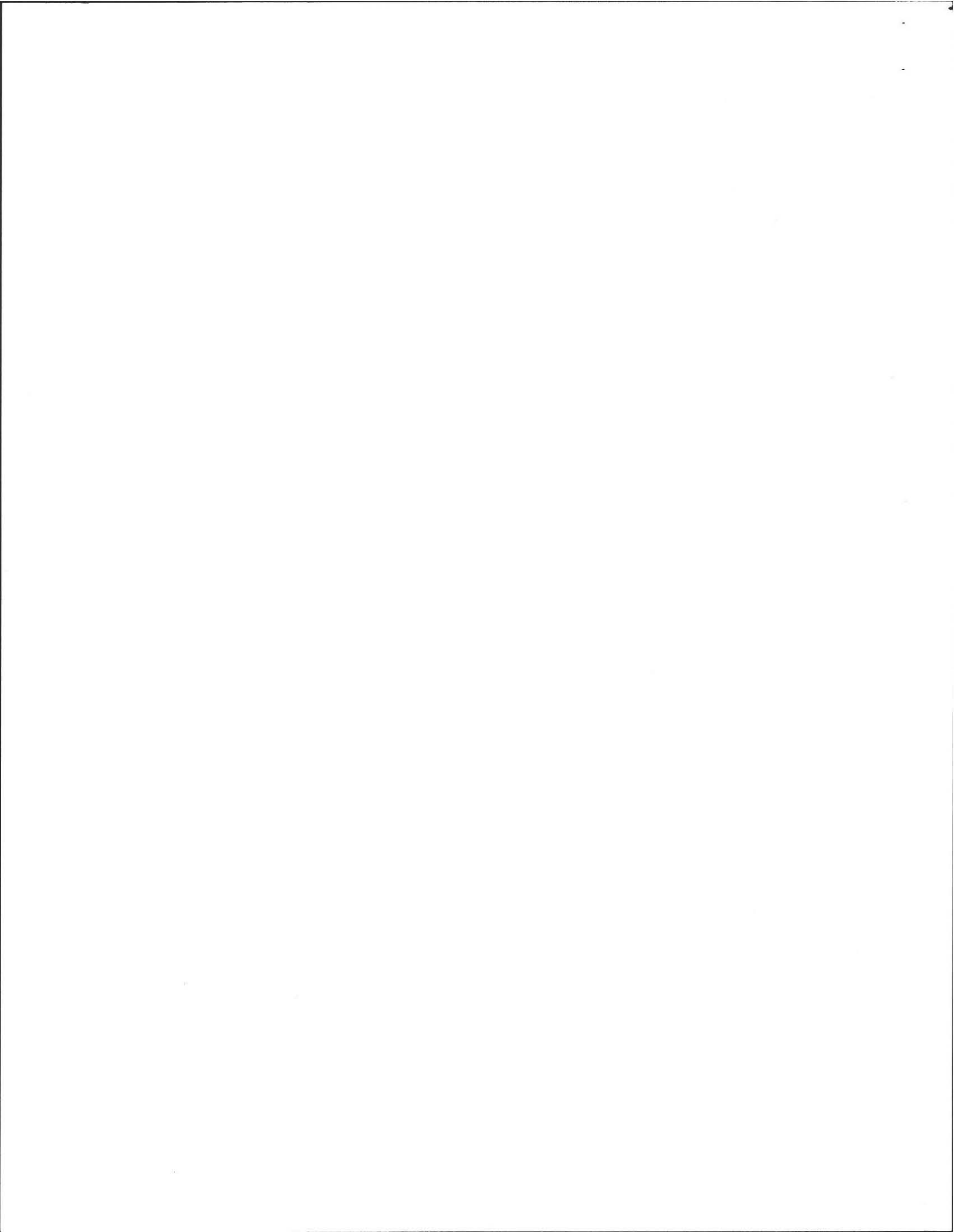

Location Address or Lot No. 73 Leverett Rd.

Determination for Seasonal High Water Table

Method Used:

- Depth observed standing in observation hole \_\_\_\_\_ inches
- Depth weeping from side of observation hole \_\_\_\_\_ inches
- Depth to soil mottles 36 inches
- Ground water adjustment \_\_\_\_\_ feet

Index Well Number \_\_\_\_\_ Reading Date \_\_\_\_\_ Index well level \_\_\_\_\_

Adjustment factor \_\_\_\_\_ Adjusted ground water level \_\_\_\_\_

Depth of Naturally Occurring Pervious Material

Does at least four feet of naturally occurring pervious material exist in all areas observed throughout the area proposed for the soil absorption system? yes

If not, what is the depth of naturally occurring pervious material? \_\_\_\_\_

Certification

I certify that on June, 95 (date) I have passed the soil evaluator examination approved by the Department of Environmental Protection and that the above analysis was performed by me consistent with the required training, expertise and experience described in 310 CMR 15.017.

Signature  Date 11/4/99  
12/13/99



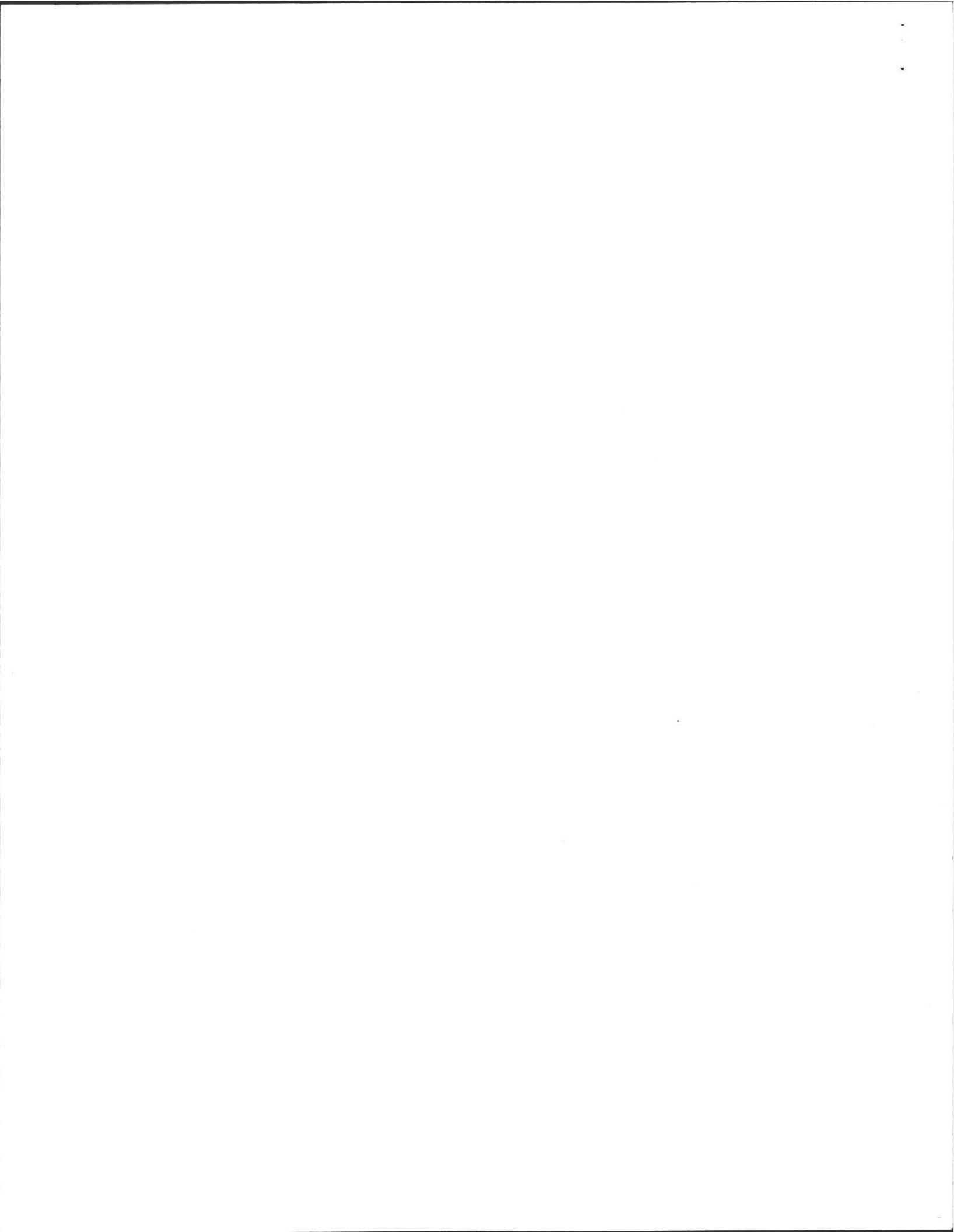

# FIGURE 1: SITE LOCUS

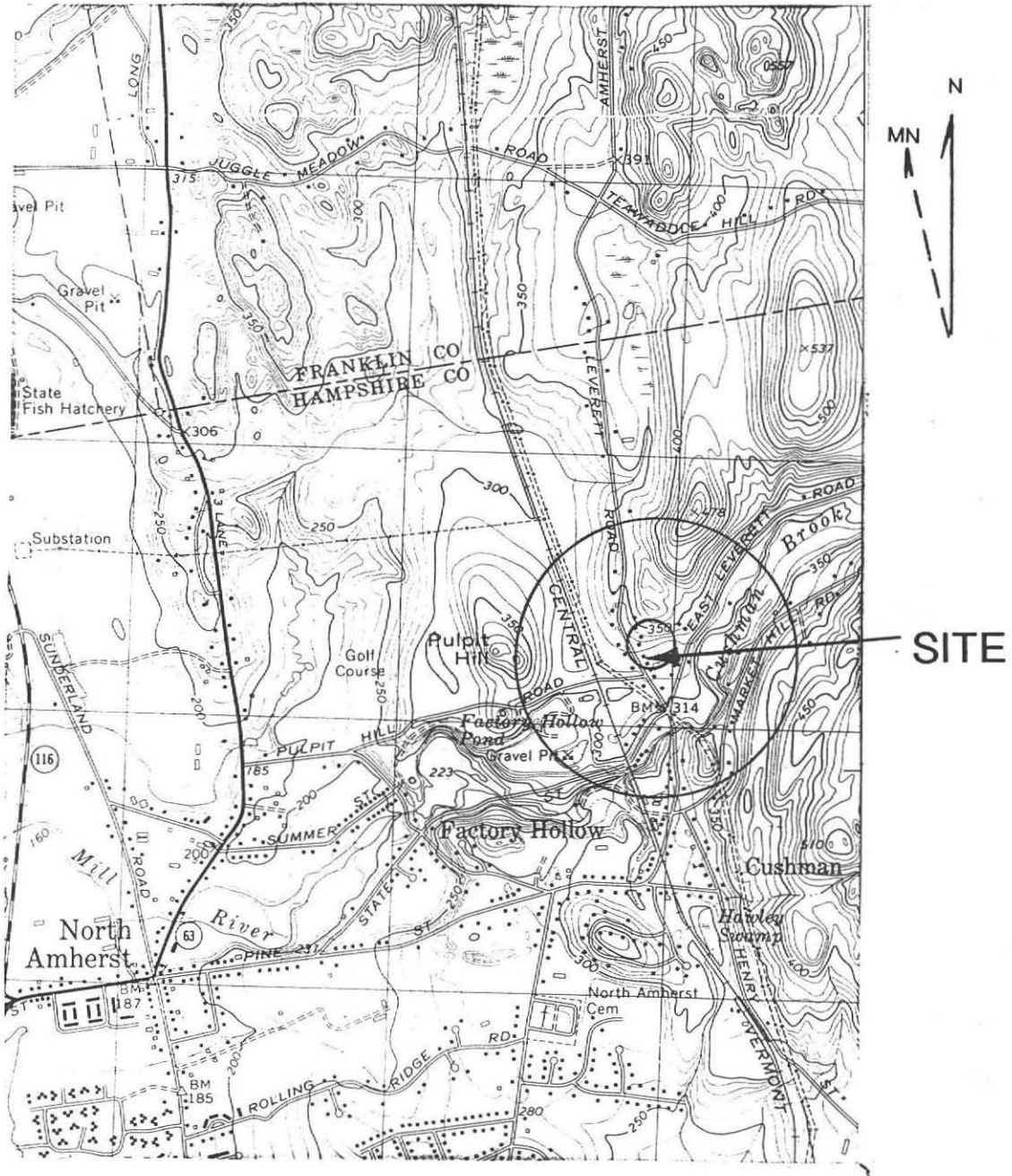

SCALE: 1"=2,083 FT.

USGS 7.5 MIN. QUAD.



COLD SPRING ENVIRONMENTAL INC.

