

INDIAN PIPE LANE -

Charles F. Aycock, Burke # 131 Woodliff Ave,
48-22

Speed

No 153L

HASTINGS, MN
LOS ANGELES-CHICAGO-LOGAN, OH
MCGREGOR, TX-LOCUST GROVE, GA
U.S.A.

#7

RECEIVED APR 1 2 1999



COMMONWEALTH OF MASSACHUSETTS
EXECUTIVE OFFICE OF ENVIRONMENTAL AFFAIRS
DEPARTMENT OF ENVIRONMENTAL PROTECTION
ONE WINTER STREET, BOSTON MA 02108 (617) 292-5500

ARGEO PAUL CELLUCCI
Governor

TRUDY COXE
Secretary
DAVID B. STRUHS
Commissioner

SUBSURFACE SEWAGE DISPOSAL SYSTEM INSPECTION FORM
PART A
CERTIFICATION

Property Address: 7 Ladies Pipe Lane, Amherst, Ma
Name of Owner: William Zimmer
Address of Owner: _____
Date of Inspection: 3/13/99
Name of Inspector: (Please Print) Pamela Biswell
I am a DEP approved system inspector pursuant to Section 15.340 of Title 5 (310 CMR 15.00G)
Company Name: Appordable Home/Septic Inspections
Mailing Address: 254 St James Ave, Holyoke
Telephone Number: (413) 532-5600

CERTIFICATION STATEMENT

I certify that I have personally inspected the sewage disposal system at this address and that the information reported below is true, accurate and complete as of the time of inspection. The inspection was performed based on my training and experience in the proper function and maintenance of on-site sewage disposal systems. The system:

- Passes
- Conditionally Passes
- Needs Further Evaluation By the Local Approving Authority
- Fails

Inspector's Signature: Pamela Biswell Date: 3/13/99

The System Inspector shall submit a copy of this inspection report to the Approving Authority (Board of Health or DEP) within thirty (30) days of completing this inspection. If the system is a shared system or has a design flow of 10,000 gpd or greater, the inspector and the system owner shall submit the report to the appropriate regional office of the Department of Environmental Protection. The original should be sent to the system owner and copies sent to the buyer, if applicable, and the approving authority.

NOTES AND COMMENTS

Septic Tank to Leach Pit. System Functional

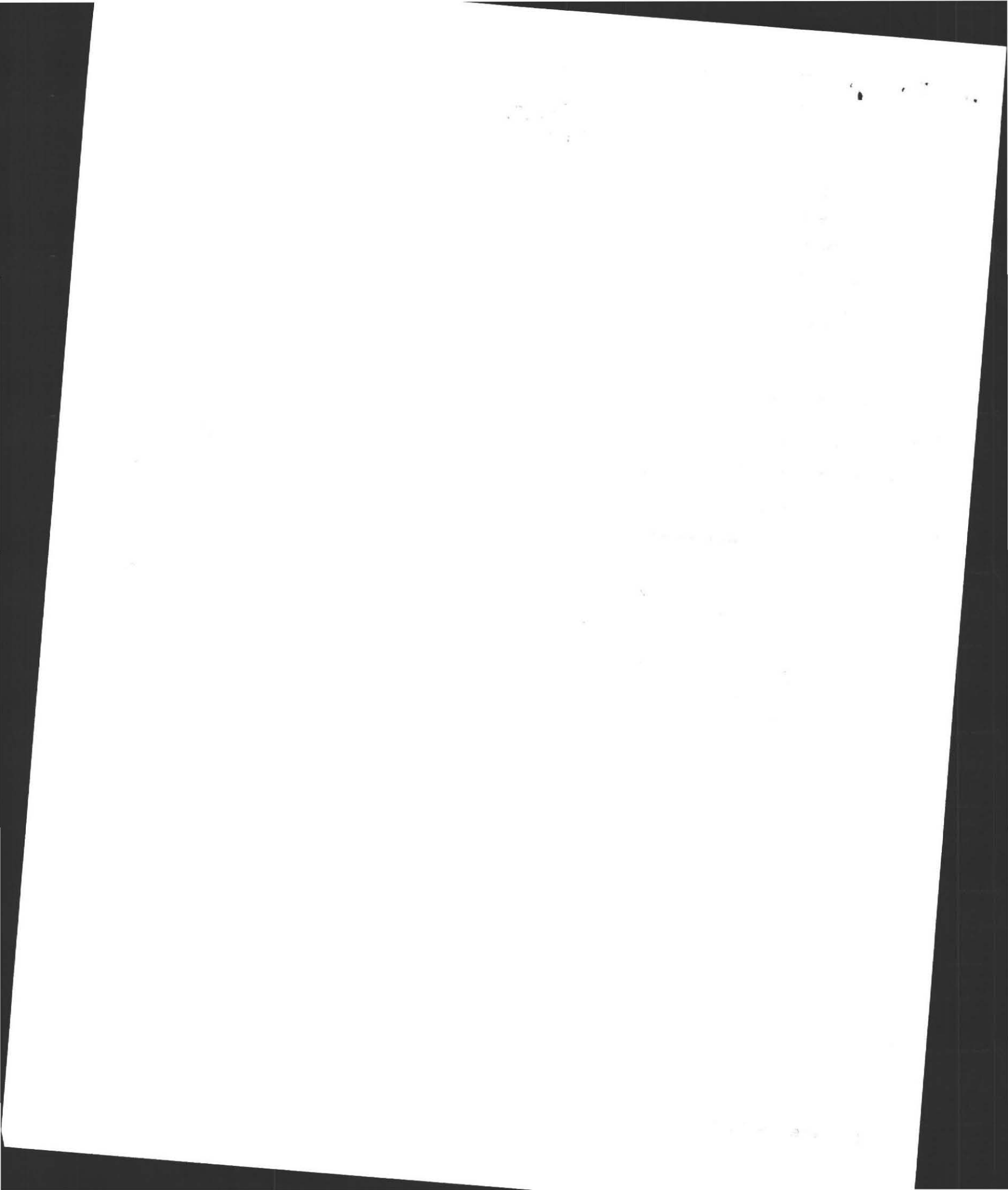

SUBSURFACE SEWAGE DISPOSAL SYSTEM INSPECTION FORM

PART A

CERTIFICATION (continued)

Property Address: 7 Indian Pipe Lane, Amherst
Owner: William Zimmer
Date of Inspection: 3/13/99

INSPECTION SUMMARY: Check (A), B, C, or D:

A. SYSTEM PASSES:

Yes I have not found any information which indicates that any of the failure conditions described in 310 CMR 15.303 exist. Any failure criteria not evaluated are indicated below.

COMMENTS: No indications of failure.

B. SYSTEM CONDITIONALLY PASSES:

_____ One or more system components as described in the "Conditional Pass" section need to be replaced or repaired. The system, upon completion of the replacement or repair, as approved by the Board of Health, will pass.

Indicate yes, no, or not determined (Y, N, or ND). Describe basis of determination in all instances. If "not determined", explain why not.

_____ The septic tank is metal, unless the owner or operator has provided the system inspector with a copy of a Certificate of Compliance (attached) indicating that the tank was installed within twenty (20) years prior to the date of the inspection; or the septic tank, whether or not metal, is cracked, structurally unsound, shows substantial infiltration or exfiltration, or tank failure is imminent. The system will pass inspection if the existing septic tank is replaced with a complying septic tank as approved by the Board of Health.

_____ Sewage backup or breakout or high static water level observed in the distribution box is due to broken or obstructed pipe(s) or due to a broken, settled or uneven distribution box. The system will pass inspection if (with approval of the Board of Health).

- _____ broken pipe(s) are replaced
- _____ obstruction is removed
- _____ distribution box is levelled or replaced

_____ The system required pumping more than four times a year due to broken or obstructed pipe(s). The system will pass inspection if (with approval of the Board of Health):

- _____ broken pipe(s) are replaced
- _____ obstruction is removed

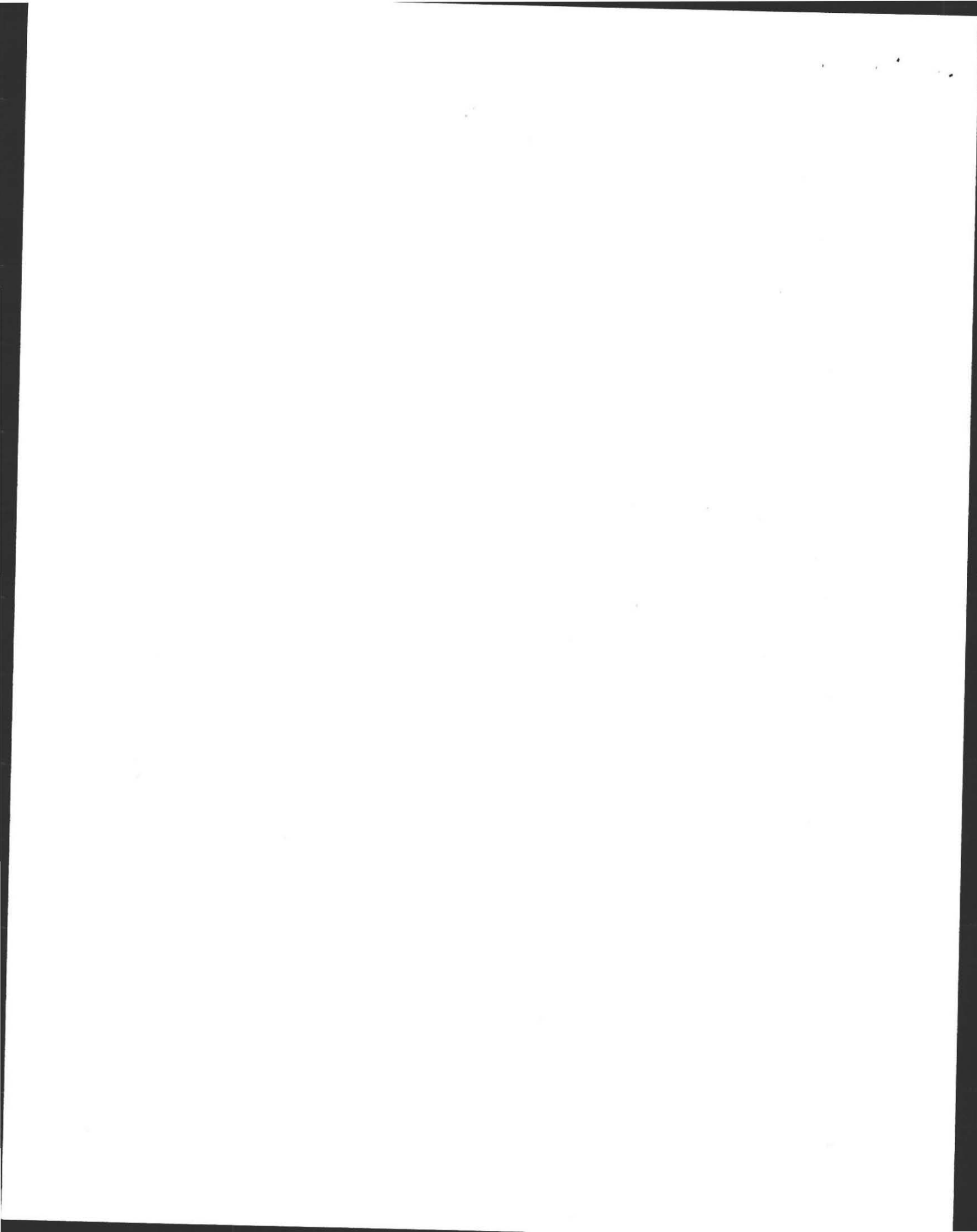

SUBSURFACE SEWAGE DISPOSAL SYSTEM INSPECTION FORM

PART A

CERTIFICATION (continued)

Property Address: 7 Indian Pipe Lane, Amherst
Owner: Zimmer
Date of Inspection: 3/13/99

C. FURTHER EVALUATION IS REQUIRED BY THE BOARD OF HEALTH:

_____ Conditions exist which require further evaluation by the Board of Health in order to determine if the system is failing to protect the public health, safety and the environment.

1) **SYSTEM WILL PASS UNLESS BOARD OF HEALTH DETERMINES IN ACCORDANCE WITH 310 CMR 15.303 (1)(b) THAT THE SYSTEM IS NOT FUNCTIONING IN A MANNER WHICH WILL PROTECT THE PUBLIC HEALTH AND SAFETY AND THE ENVIRONMENT:**

- ___ Cesspool or privy is within 50 feet of surface water
- ___ Cesspool or privy is within 50 feet of a bordering vegetated wetland or a salt marsh.

2) **SYSTEM WILL FAIL UNLESS THE BOARD OF HEALTH (AND PUBLIC WATER SUPPLIER, IF ANY) DETERMINES THAT THE SYSTEM IS FUNCTIONING IN A MANNER THAT PROTECTS THE PUBLIC HEALTH AND SAFETY AND THE ENVIRONMENT:**

- ___ The system has a septic tank and soil absorption system (SAS) and the SAS is within 100 feet of a surface water supply or tributary to a surface water supply.
- ___ The system has a septic tank and soil absorption system and the SAS is within a Zone I of a public water supply well.
- ___ The system has a septic tank and soil absorption system and the SAS is within 50 feet of a private water supply well.
- ___ The system has a septic tank and soil absorption system and the SAS is less than 100 feet but 50 feet or more from a private water supply well unless a well water analysis for coliform bacteria and volatile organic compounds indicates that the well is free from pollution from that facility and the presence of ammonia nitrogen and nitrate nitrogen is equal to or less than 5 ppm. Method used to determine distance _____ (approximation not valid).

3) OTHER

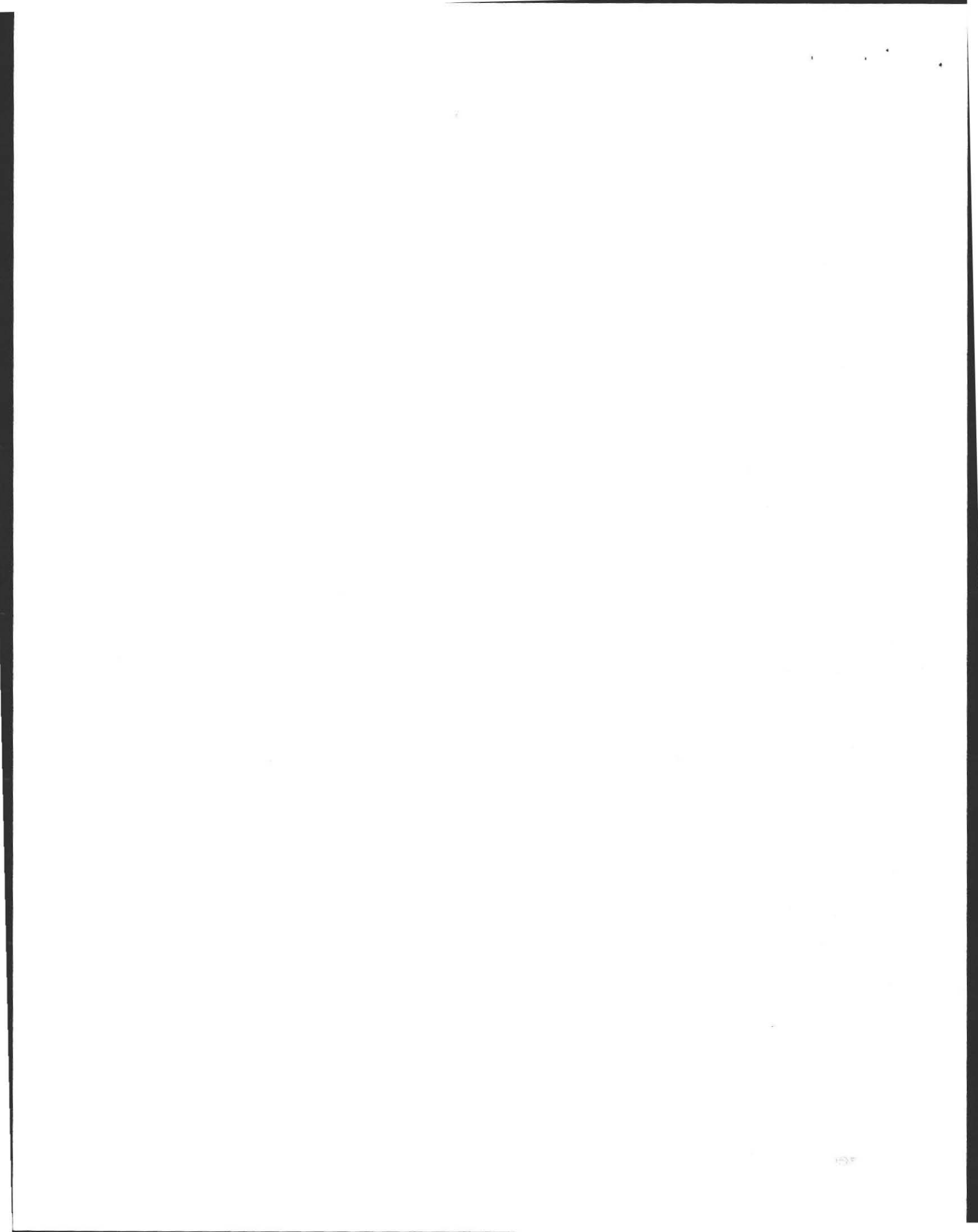

SUBSURFACE SEWAGE DISPOSAL SYSTEM INSPECTION FORM
PART A
CERTIFICATION (continued)

Property Address: 7 Indian Pipe Lane, Amherst
 Owner: Zimmer
 Date of Inspection: 3/03/99

D. SYSTEM FAILS:

You must indicate either "Yes" or "No" to each of the following:

I have determined that one or more of the following failure conditions exist as described in 310 CMR 15.303. The basis for this determination is identified below. The Board of Health should be contacted to determine what will be necessary to correct the failure.

- | Yes | No | |
|--------------------------|--------------------------|--|
| <input type="checkbox"/> | <input type="checkbox"/> | Backup of sewage into facility or system component due to an overloaded or clogged SAS or cesspool. |
| <input type="checkbox"/> | <input type="checkbox"/> | Discharge or ponding of effluent to the surface of the ground or surface waters due to an overloaded or clogged SAS or cesspool. |
| <input type="checkbox"/> | <input type="checkbox"/> | Static liquid level in the distribution box above outlet invert due to an overloaded or clogged SAS or cesspool. |
| <input type="checkbox"/> | <input type="checkbox"/> | Liquid depth in cesspool is less than 6" below invert or available volume is less than 1/2 day flow. |
| <input type="checkbox"/> | <input type="checkbox"/> | Required pumping more than 4 times in the last year NOT due to clogged or obstructed pipe(s).
Number of times pumped <u> </u> . |
| <input type="checkbox"/> | <input type="checkbox"/> | Any portion of the Soil Absorption System, cesspool or privy is below the high groundwater elevation. |
| <input type="checkbox"/> | <input type="checkbox"/> | Any portion of a cesspool or privy is within 100 feet of a surface water supply or tributary to a surface water supply. |
| <input type="checkbox"/> | <input type="checkbox"/> | Any portion of a cesspool or privy is within a Zone I of a public well. |
| <input type="checkbox"/> | <input type="checkbox"/> | Any portion of a cesspool or privy is within 50 feet of a private water supply well. |
| <input type="checkbox"/> | <input type="checkbox"/> | Any portion of a cesspool or privy is less than 100 feet but greater than 50 feet from a private water supply well with no acceptable water quality analysis. If the well has been analyzed to be acceptable, attach copy of well water analysis for coliform bacteria, volatile organic compounds, ammonia nitrogen and nitrate nitrogen. |

E. LARGE SYSTEM FAILS:

You must indicate either "Yes" or "No" to each of the following:

The following criteria apply to large systems in addition to the criteria above:

The system serves a facility with a design flow of 10,000 gpd or greater (Large System) and the system is a significant threat to public health and safety and the environment because one or more of the following conditions exist:

- | Yes | No | |
|--------------------------|--------------------------|---|
| <input type="checkbox"/> | <input type="checkbox"/> | the system is within 400 feet of a surface drinking water supply |
| <input type="checkbox"/> | <input type="checkbox"/> | the system is within 200 feet of a tributary to a surface drinking water supply |
| <input type="checkbox"/> | <input type="checkbox"/> | the system is located in a nitrogen sensitive area (Interim Wellhead Protection Area - IWPA) or a mapped Zone II of a public water supply well) |

The owner or operator of any such system shall upgrade the system in accordance with 310 CMR 15.304(2). Please consult the local regional office of the Department for further information.

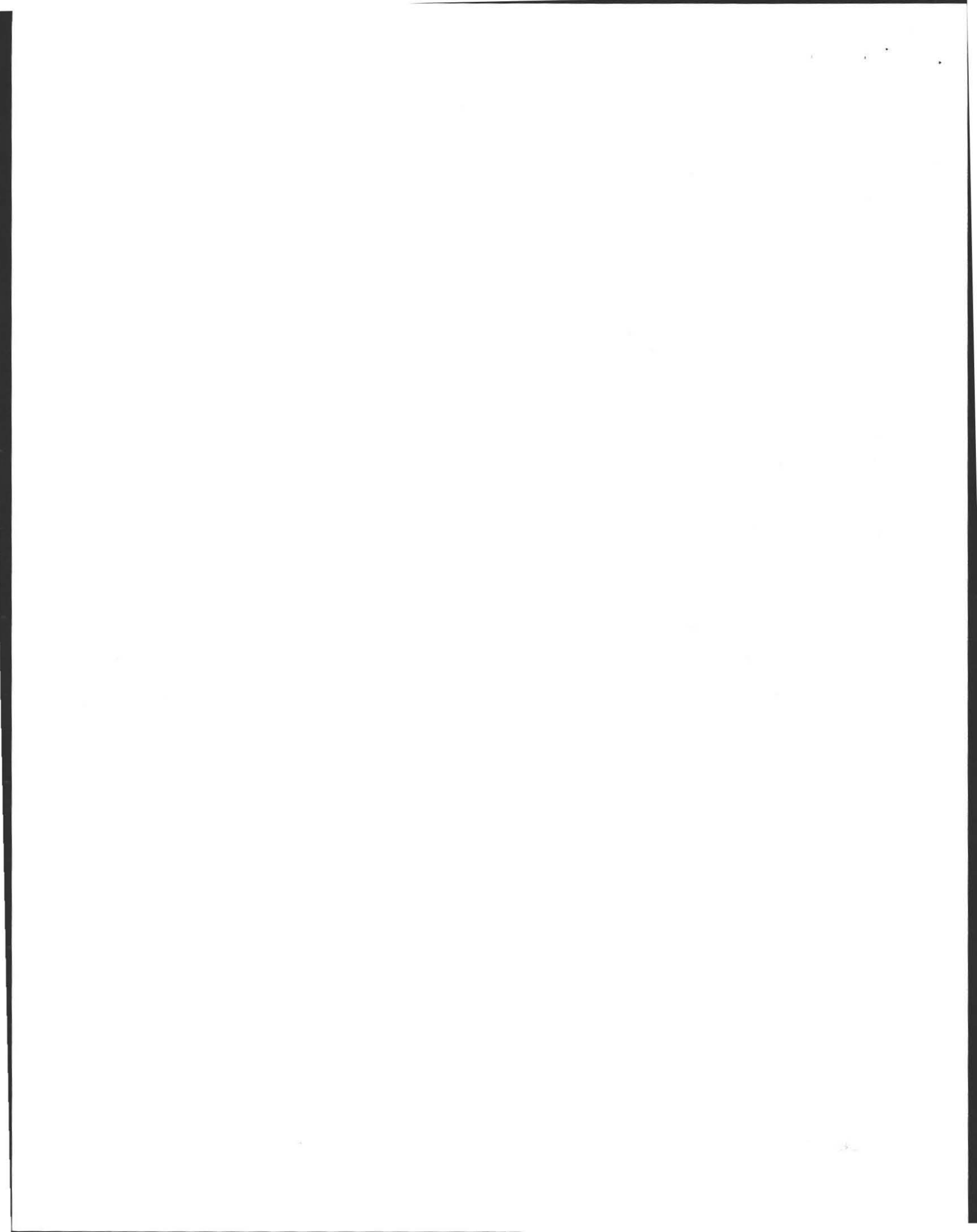

**SUBSURFACE SEWAGE DISPOSAL SYSTEM INSPECTION FORM
PART B
CHECKLIST**

Property Address: 7 Indian Pipe Lane, Hamlet
 Owner: Sumner
 Date of inspection: 3/13/99

Check if the following have been done: You must indicate either "Yes" or "No" as to each of the following:

- | Yes | No | |
|-------------------------------------|-------------------------------------|--|
| <input checked="" type="checkbox"/> | <input type="checkbox"/> | Pumping information was provided by the owner, occupant, or Board of Health. |
| <input checked="" type="checkbox"/> | <input type="checkbox"/> | None of the system components have been pumped for at least two weeks and the system has been receiving normal flow rates during that period. Large volumes of water have not been introduced into the system recently or as part of this inspection. |
| <u>N/A</u> | <input type="checkbox"/> | As built plans have been obtained and examined. Note if they are not available with N/A. |
| <input checked="" type="checkbox"/> | <input type="checkbox"/> | The facility or dwelling was inspected for signs of sewage back-up. |
| <input checked="" type="checkbox"/> | <input type="checkbox"/> | The system does not receive non-sanitary or industrial waste flow. |
| <input checked="" type="checkbox"/> | <input type="checkbox"/> | The site was inspected for signs of breakout. |
| <input checked="" type="checkbox"/> | <input type="checkbox"/> | All system components, excluding the Soil Absorption System, have been located on the site. |
| <input checked="" type="checkbox"/> | <input type="checkbox"/> | The septic tank manholes were uncovered, opened, and the interior of the septic tank was inspected for condition of baffles or tees, material of construction, dimensions, depth of liquid, depth of sludge, depth of scum.
The size and location of the Soil Absorption System on the site has been determined based on: |
| <input checked="" type="checkbox"/> | <input checked="" type="checkbox"/> | Existing information. For example, Plan at B.O.H. |
| <input checked="" type="checkbox"/> | <input checked="" type="checkbox"/> | Determined in the field (if any of the failure criteria related to Part C is at issue, approximation of distance is unacceptable) [15.302(3)(b)] |
| <input checked="" type="checkbox"/> | <input type="checkbox"/> | The facility owner (and occupants, if different from owner) were provided with information on the proper maintenance of SubSurface Disposal Systems. |

SUBSURFACE SEWAGE DISPOSAL SYSTEM INSPECTION FORM
PART C
SYSTEM INFORMATION

Property Address: 7 Indian Pipe Lane, Amherst
Owner: Summer
Date of Inspection: 3/13/99

FLOW CONDITIONS

RESIDENTIAL:

Design flow: unk g.p.d./bedroom.
Number of bedrooms (design): 3 Number of bedrooms (actual): 3
Total DESIGN flow unk
Number of current residents: 3
Garbage grinder (yes or no): No
Laundry (separate system) (yes or no): No; If yes, separate inspection required
Laundry system inspected (yes or no)
Seasonal use (yes or no): No
Water meter readings, if available (last two year's usage (gpd)): Town Water
Sump Pump (yes or no): No
Last date of occupancy: Presently

COMMERCIAL/INDUSTRIAL:

Type of establishment: _____
Design flow: _____ gpd (Based on 15.203)
Basis of design flow _____
Grease trap present: (yes or no) _____
Industrial Waste Holding Tank present: (yes or no) _____
Non-sanitary waste discharged to the Title 5 system: (yes or no) _____
Water meter readings, if available: _____
Last date of occupancy: _____
OTHER: (Describe) _____
Last date of occupancy: _____

GENERAL INFORMATION

PUMPING RECORDS and source of information:

Dec 1998
System pumped as part of inspection: (yes or no) No
If yes, volume pumped: _____ gallons
Reason for pumping: _____

TYPE OF SYSTEM

- Septic tank/distribution box/soil absorption system
 Single cesspool
 Overflow cesspool
 Privy
 Shared system (yes or no) (if yes, attach previous inspection records, if any)
 I/A Technology etc. Attach copy of up to date operation and maintenance contract
 Tight Tank _____ Copy of DEP Approval

Other Septic Tank to Leach Pit

APPROXIMATE AGE of all components, date installed (if known) and source of information: 1984 approx.

Sewage odors detected when arriving at the site: (yes or no) No

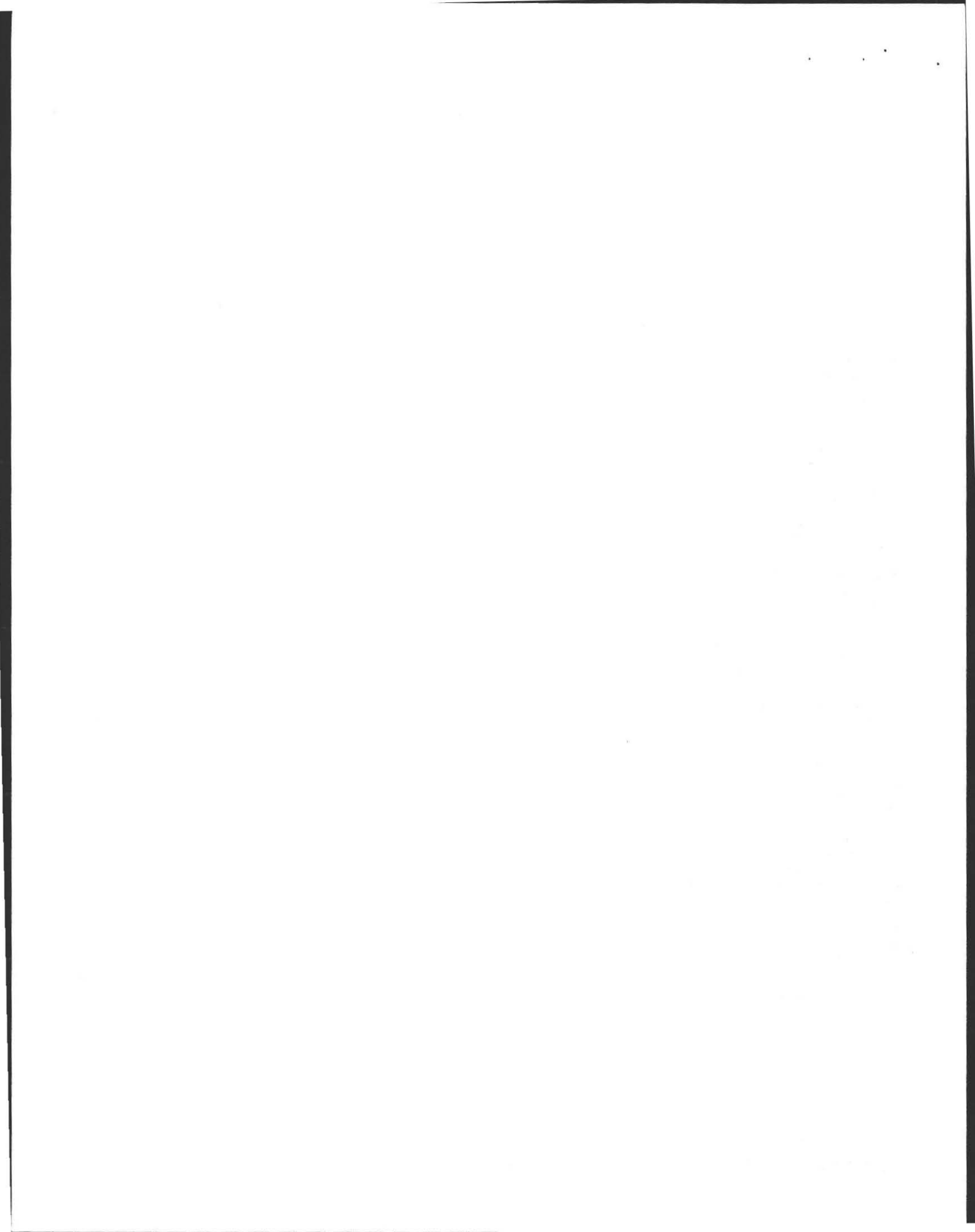

SUBSURFACE SEWAGE DISPOSAL SYSTEM INSPECTION FORM

PART C

SYSTEM INFORMATION (continued)

Property Address: 7 Indian Pipe Lane, Amberst
Owner: Summer
Date of inspection: 3/13/97

BUILDING SEWER:

(Locate on site plan)

Depth below grade: 1'
Material of construction: cast iron 40 PVC other (explain)

Distance from private water supply well or suction line: N/A
Diameter: 4"

Comments: (condition of joints, venting, evidence of leakage, etc.)

No signs of leakage

SEPTIC TANK: Present

(locate on site plan)

Depth below grade: 6"
Material of construction: concrete metal Fiberglass Polyethylene other(explain)

If tank is metal, list age ___ Is age confirmed by Certificate of Compliance ___ (Yes/No)

Dimensions: 8 x 5 x 6

Sludge depth: 5"
Distance from top of sludge to bottom of outlet tee or baffle: 39"

Scum thickness: 4"
Distance from top of scum to top of outlet tee or baffle: 16"

Distance from bottom of scum to bottom of outlet tee or baffle: 14"

How dimensions were determined: Sludge Judgel Tape

Comments:

(recommendation for pumping, condition of inlet and outlet tees or baffles, depth of liquid level in relation to outlet invert, structural integrity, evidence of leakage, etc.)

Tank appears sound. Baffles intact. Appropriate sludge / scum layers

GREASE TRAP:

(locate on site plan)

Depth below grade: ___
Material of construction: concrete metal Fiberglass Polyethylene other(explain)

Dimensions: ___
Scum thickness: ___
Distance from top of scum to top of outlet tee or baffle: ___
Distance from bottom of scum to bottom of outlet tee or baffle: ___
Date of last pumping: ___

Comments:

(recommendation for pumping, condition of inlet and outlet tees or baffles, depth of liquid level in relation to outlet invert, structural integrity, evidence of leakage, etc.)

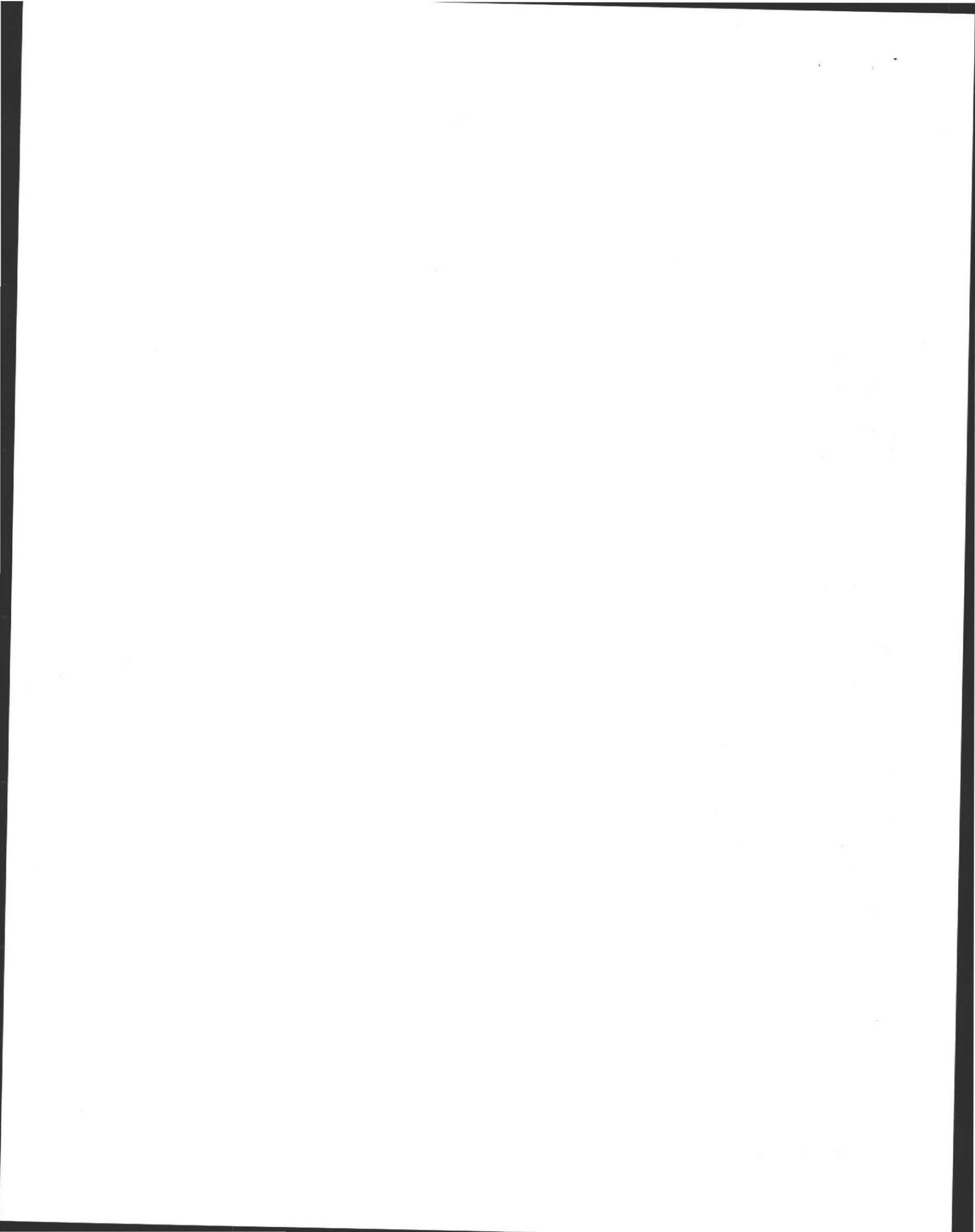

SUBSURFACE SEWAGE DISPOSAL SYSTEM INSPECTION FORM
PART C
SYSTEM INFORMATION (continued)

Property Address: 7 Indian Pipe Lane, Amherst
Owner: Zimmer
Date of Inspection: 3/13/99

TIGHT OR HOLDING TANK: _____ (Tank must be pumped prior to, or at time of, inspection)
(locate on site plan)

Depth below grade: _____
Material of construction: concrete metal Fiberglass Polyethylene other(explain)

Dimensions: _____
Capacity: _____ gallons
Design flow: _____ gallons/day
Alarm present: _____
Alarm level: _____ Alarm in working order: Yes No
Date of previous pumping: _____
Comments:
(condition of inlet tee, condition of alarm and float switches, etc.)

DISTRIBUTION BOX: _____
(locate on site plan)

Depth of liquid level above outlet invert: _____

Comments:
(note if level and distribution is equal, evidence of solids carryover, evidence of leakage into or out of box, etc.) _____

PUMP CHAMBER: _____
(locate on site plan)

Pumps in working order: (Yes or No) _____
Alarms in working order (Yes or No) _____
Comments:
(note condition of pump chamber, condition of pumps and appurtenances, etc.) _____

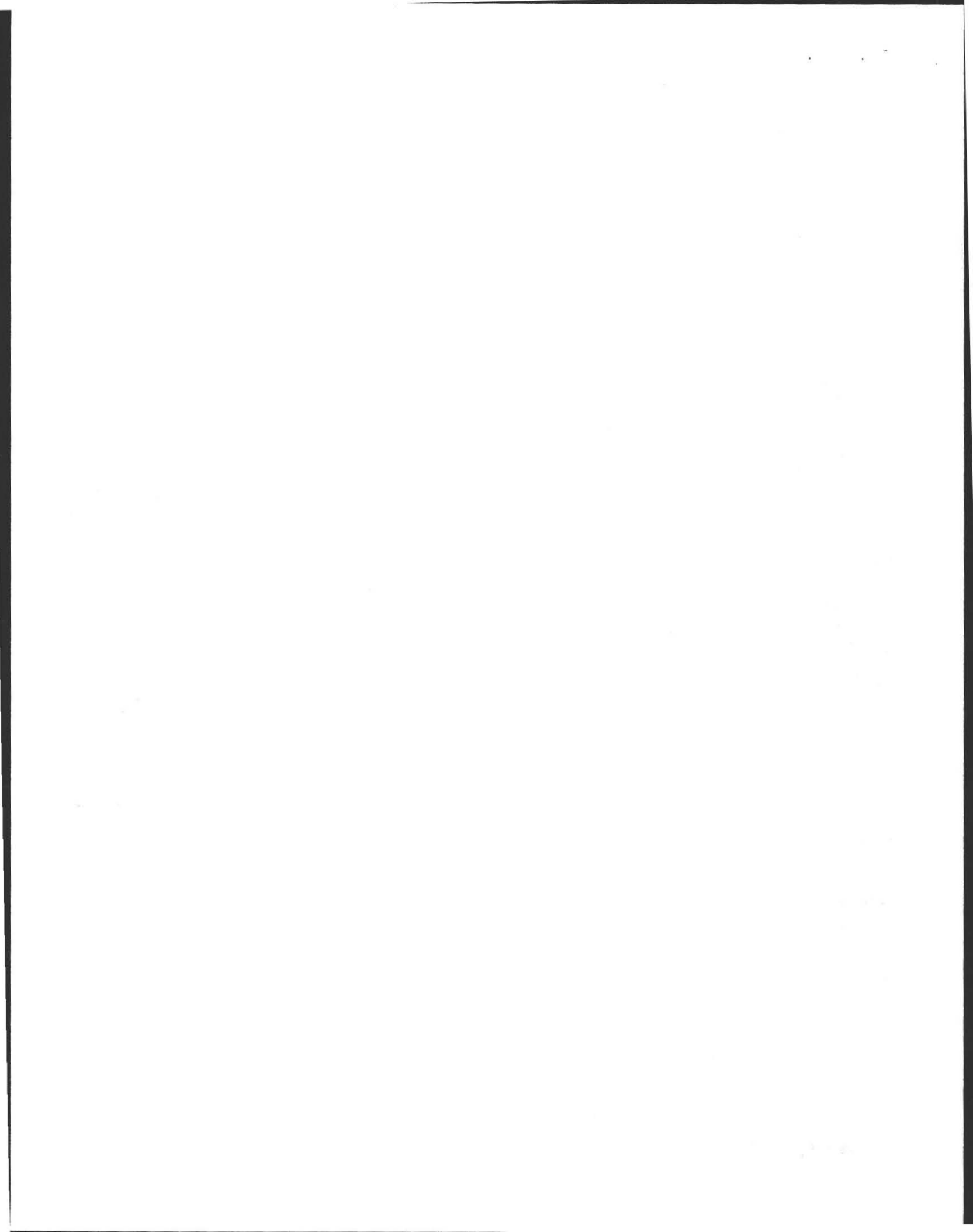

SUBSURFACE SEWAGE DISPOSAL SYSTEM INSPECTION FORM
PART C

SYSTEM INFORMATION (continued)

Property Address: 7 Indian Pipe Lane, Wm.hurst
Owner: Jimenez
Date of Inspection: 3/13/99

SOIL ABSORPTION SYSTEM (SAS):

(locate on site plan, if possible; excavation not required, location may be approximated by non-intrusive methods)

If not located, explain:

Type:

leaching pits, number: (1)
leaching chambers, number: _____
leaching galleries, number: _____
leaching trenches, number, length: _____
leaching fields, number, dimensions: _____
overflow cesspool, number: _____
Alternative system: _____
Name of Technology: _____

Comments:

(note condition of soil, signs of hydraulic failure, level of ponding, damp soil, condition of vegetation, etc.)

(1) Round Pit. No ascertainable observation cover. Excavated 2.5' next to pit. No effluent visible. It was clean & dry.

CESSPOOLS:

(locate on site plan)

Number and configuration: _____
Depth-top of liquid to inlet invert: _____
Depth of solids layer: _____
Depth of scum layer: _____
Dimensions of cesspool: _____
Materials of construction: _____
Indication of groundwater: _____
inflow (cesspool must be pumped as part of inspection) _____

Comments:

(note condition of soil, signs of hydraulic failure, level of ponding, condition of vegetation, etc.)

PRIVY:

(locate on site plan)

Materials of construction: _____ Dimensions: _____

Depth of solids: _____

Comments:

(note condition of soil, signs of hydraulic failure, level of ponding, condition of vegetation, etc.)

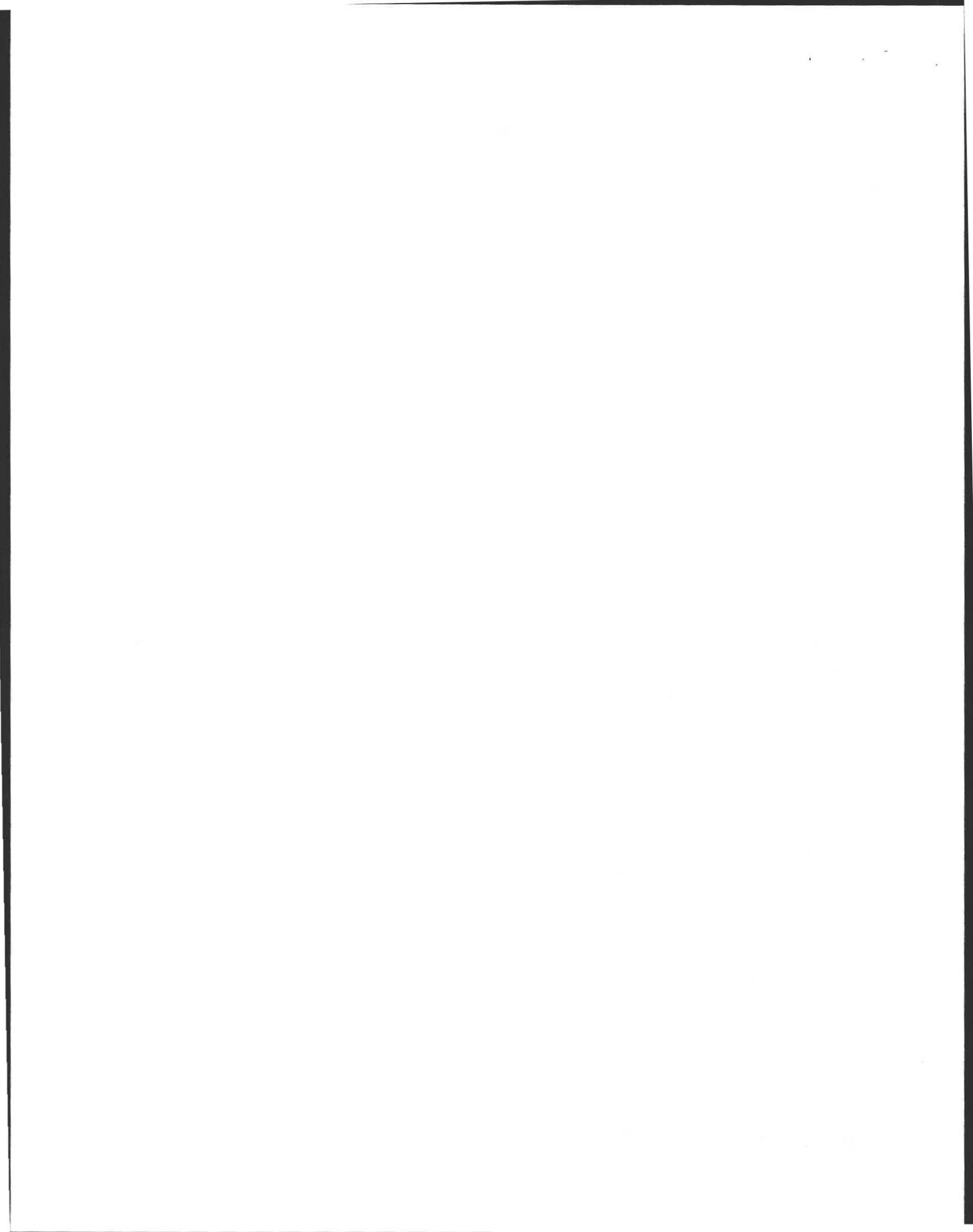

SUBSURFACE SEWAGE DISPOSAL SYSTEM INSPECTION FORM
PART C
SYSTEM INFORMATION (continued)

Property Address: 7 Indian Pipe Lane, Amherst
Owner: Zimmer
Date of Inspection: 3/13/99

SKETCH OF SEWAGE DISPOSAL SYSTEM:

include ties to at least two permanent reference landmarks or benchmarks
locate all wells within 100' (Locate where public water supply comes into house)

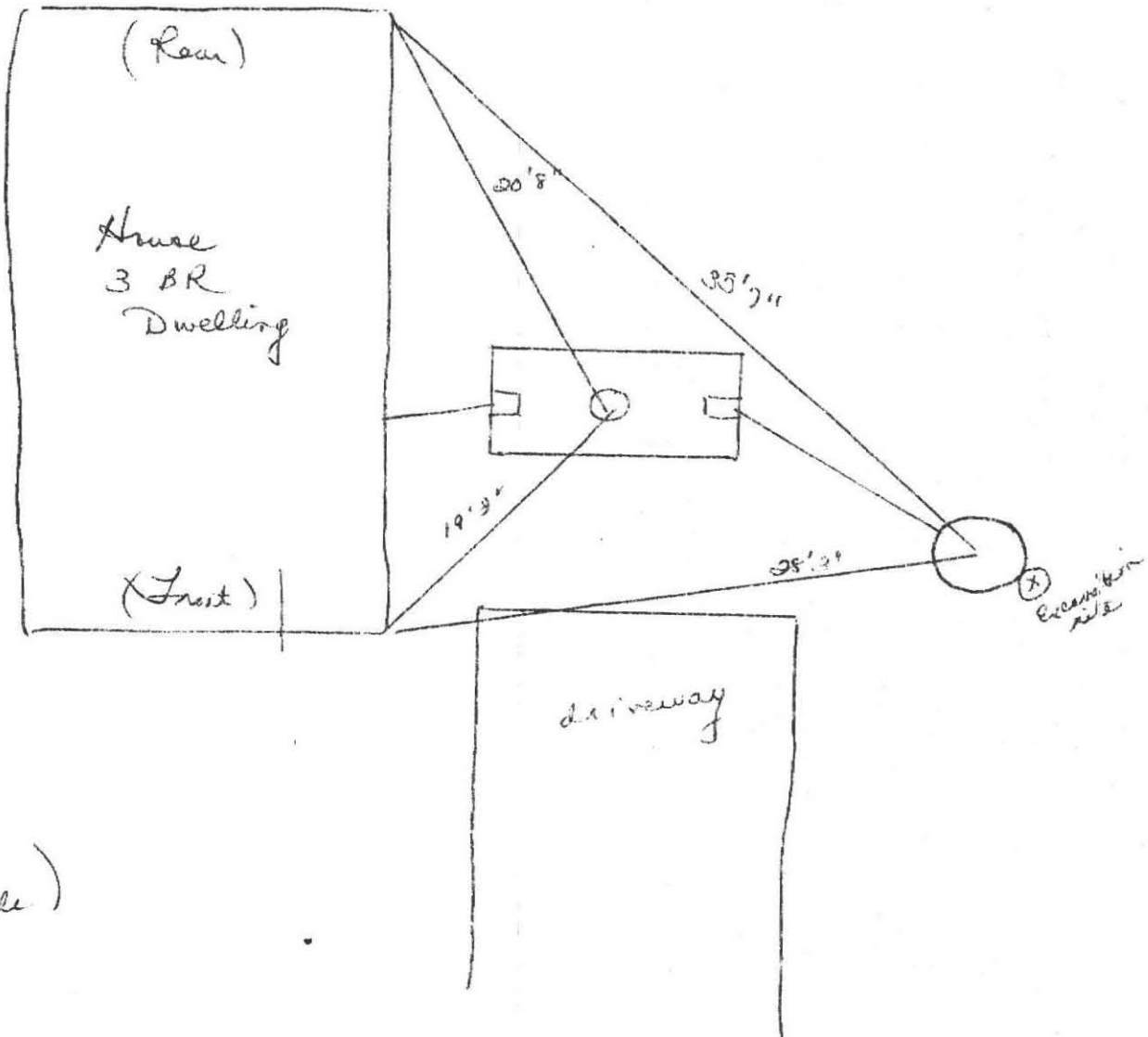

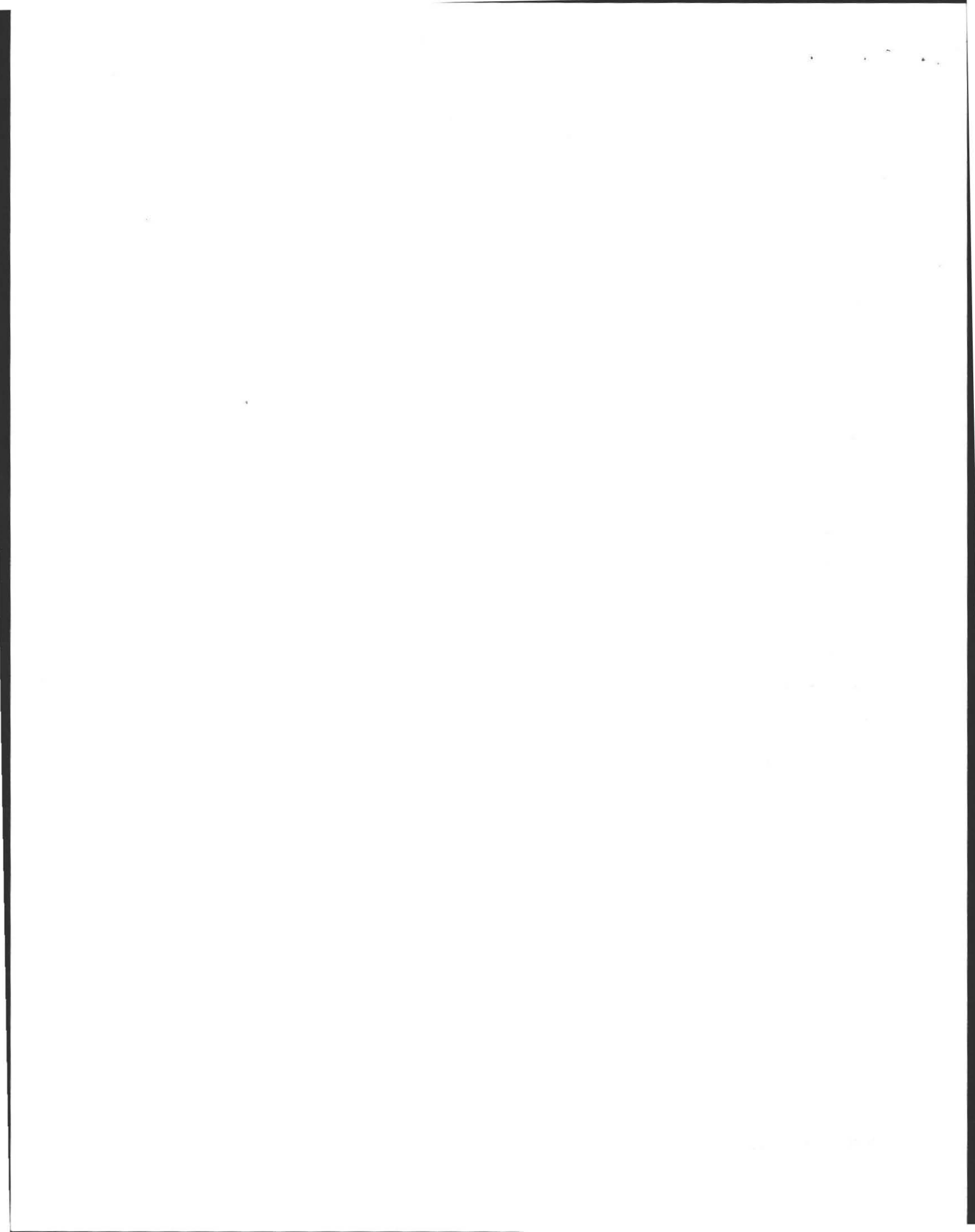

SUBSURFACE SEWAGE DISPOSAL SYSTEM INSPECTION FORM
PART C

SYSTEM INFORMATION (continued)

Property Address: 7 Indian Pipe Lane, Amherst
Owner: Summer
Date of Inspection: 3/13/99

NRCS Report name _____
Soil Type _____
Typical depth to groundwater _____

USGS Date website visited _____
Observation Wells checked _____
Groundwater depth: Shallow _____ Moderate _____ Deep _____

SITE EXAM Slope _____
Surface water _____
Check Cellar _____
Shallow wells _____

Estimated Depth to Groundwater 77' Feet

Please indicate all the methods used to determine High Groundwater Elevation:

- Obtained from Design Plans on record
- Observed Site (Abutting property, observation hole, basement sump etc.)
- Determined from local conditions
- Checked with local Board of health
- Checked FEMA Maps
- Checked pumping records
- Checked local excavators, installers
- Used USGS Data

Describe how you established the High Groundwater Elevation. (Must be completed)

No signs of HGW on site. No ground water when excavated to 6'. No sump pump.

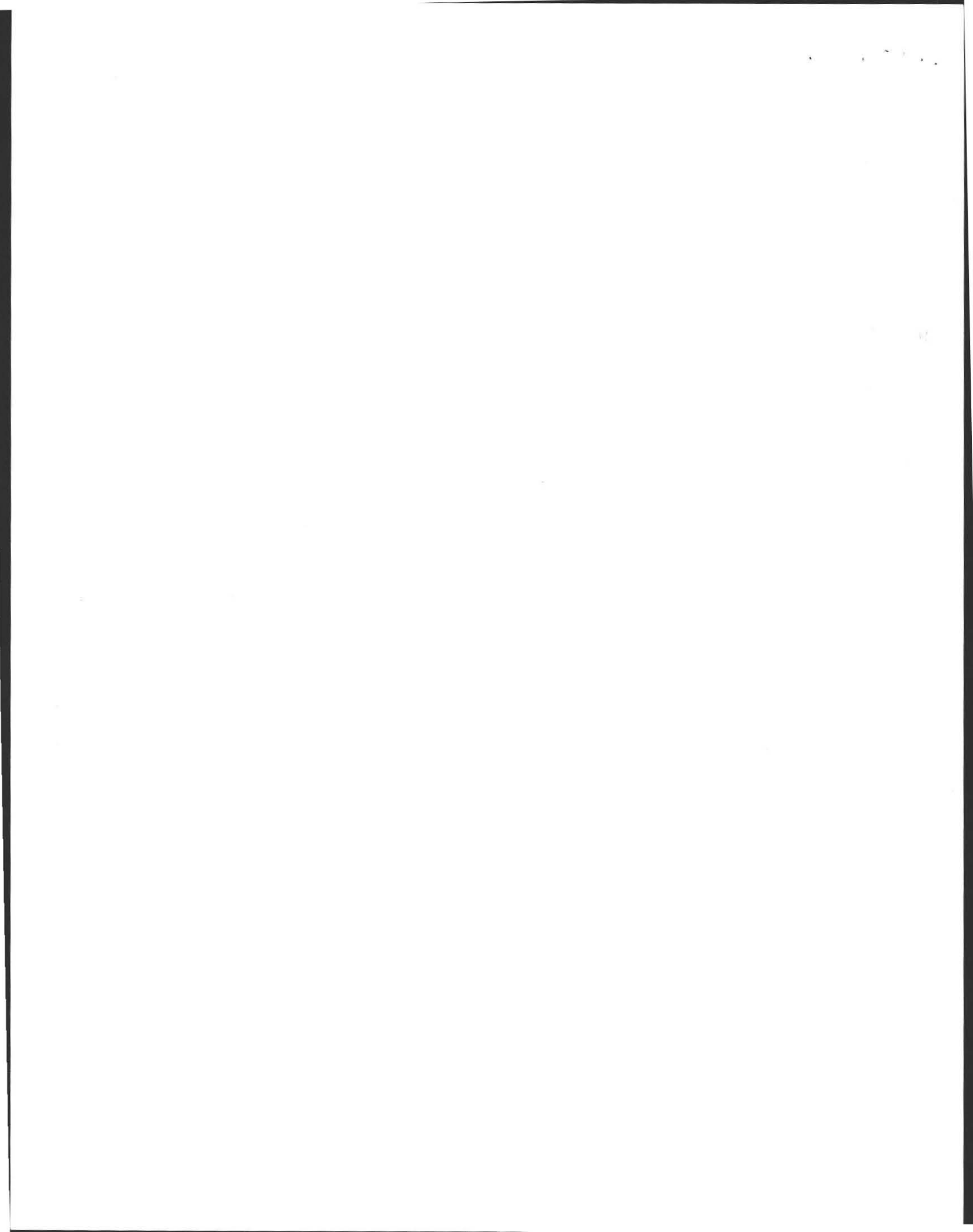

No. 84-17

#7



THE COMMONWEALTH OF MASSACHUSETTS

BOARD OF HEALTH

Town of Amherst

Application for Disposal Works Construction Permit

Application is hereby made for a Permit to Construct (X) or Repair (-) an Individual Sewage Disposal System at:

7 Indian Pipe Amherst Woods Phase II

7 INDIAN PIPE LANE 27

Nancy Clydesdale River Dr. Exc

81 Harlow Drive Amherst Ma River Dr HARLOW

Type of Building Dwelling - No. of Bedrooms 2 Expansion Attic () Garbage Grinder () No Other - Type of Building No. of persons Showers () - Cafeteria () Other fixtures

Design Flow 55 gallons per person per day. Total daily flow 220 gallons. Septic Tank - Liquid capacity 1000 gallons Length Width Diameter Depth Disposal Trench - No. Width Total Length Total leaching area 105 sq. ft. Seepage Pit No. 1 Diameter 10.5 x 7 Depth below inlet 3 Total leaching area 13.5 sq. ft. Other Distribution box () No Dosing tank () Percolation Test Results Performed by Frederick Filios Date Mar 21 1984 Test Pit No. 1 52 minutes per inch Depth of Test Pit 10 Depth to ground water non a Test Pit No. 2 minutes per inch Depth of Test Pit Depth to ground water

Description of Soil enclosed - SAND & GRAVEL

Nature of Repairs or Alterations - Answer when applicable

Agreement:

The undersigned agrees to install the aforescribed Individual Sewage Disposal System in accordance with the provisions of TITLE 5 of the State Sanitary Code - The undersigned further agrees not to place the system in operation until a Certificate of Compliance has been issued by the board of health.

Signed [Signature]

Application Approved By [Signature] Date 5-14-84

Application Disapproved for the following reasons:

Permit No. 84-17 Issued 5-14-84 Date

THE COMMONWEALTH OF MASSACHUSETTS

BOARD OF HEALTH

OF

Certificate of Compliance

THIS IS TO CERTIFY, That the Individual Sewage Disposal System constructed () or Repaired () by

Installer

at has been installed in accordance with the provisions of TITLE 5 of The State Sanitary Code as described in the application for Disposal Works Construction Permit No. dated

THE ISSUANCE OF THIS CERTIFICATE SHALL NOT BE CONSTRUED AS A GUARANTEE THAT THE SYSTEM WILL FUNCTION SATISFACTORY.

DATE Inspector

THE COMMONWEALTH OF MASSACHUSETTS

BOARD OF HEALTH

Town of Amherst

No. 84-17

FEE \$90

Disposal Works Construction Permit

Permission is hereby granted CLYDESDALE - Kellogg - by River Dr Exc. to Construct (X) or Repair () an Individual Sewage Disposal System at No. 27 Amherst Woods Street 7 Indian Pipe Lane

as shown on the application for Disposal Works Construction Permit No. 84-17 Dated 5-14-84

DATE May 14/1984 [Signature] Board of Health

CHECK OR FILL IN WHERE APPLICABLE

1891
1892
1893

1894

1895

1896

1897

1898

1899

1900

1901

1902

1903

1904

1905

1906

1907

1908

1909

1910

1911

1912

1913

1914

1915

1916

No.



THE COMMONWEALTH OF MASSACHUSETTS

BOARD OF HEALTH

Town OF Amherst

Application for Disposal Works Construction Permit

Application is hereby made for a Permit to Construct (X) or Repair () an Individual Sewage Disposal System at:

Amherst Woods Phase II

27

Nancy Clydesdale

81 Harlow Drive Amherst Me

Location - Address

Lot No.

Owner

Address

Installer

Address

Type of Building

Size Lot 36,054 Sq. feet

Dwelling - No. of Bedrooms 2 Expansion Attic () Garbage Grinder () No

Other - Type of Building No. of persons Showers () - Cafeteria ()

Other fixtures

Design Flow 55 gallons per person per day. Total daily flow 220 gallons.

Septic Tank - Liquid capacity 1000 gallons Length Width Diameter Depth

Disposal Trench - No. Width Total Length Total leaching area 125 sq. ft. Sides

Seepage Pit No. 1 Diameter 10 1/2 x 7 Depth below inlet 3 Total leaching area 23.5 sq. ft. Bottom

Other Distribution box () No Dosing tank ()

Percolation Test Results Performed by Frederick Filios Date Mar 21 1984

Test Pit No. 1 52 minutes per inch Depth of Test Pit 10 Depth to ground water none

Test Pit No. 2 minutes per inch Depth of Test Pit Depth to ground water

Description of Soil enclosed

Nature of Repairs or Alterations - Answer when applicable

Agreement:

The undersigned agrees to install the aforescribed Individual Sewage Disposal System in accordance with the provisions of TITLE 5 of the State Sanitary Code - The undersigned further agrees not to place the system in operation until a Certificate of Compliance has been issued by the board of health.

Signed _____ Date _____

Application Approved By _____ Date _____

Application Disapproved for the following reasons: _____ Date _____

Permit No.

Issued _____ Date _____

THE COMMONWEALTH OF MASSACHUSETTS

BOARD OF HEALTH

OF

Certificate of Compliance

THIS IS TO CERTIFY, That the Individual Sewage Disposal System constructed () or Repaired () by _____

Installer

at _____

has been installed in accordance with the provisions of TITLE 5 of The State Sanitary Code as described in the application for Disposal Works Construction Permit No. dated _____

THE ISSUANCE OF THIS CERTIFICATE SHALL NOT BE CONSTRUED AS A GUARANTEE THAT THE SYSTEM WILL FUNCTION SATISFACTORY.

DATE _____

Inspector _____

CHECK OR FILL IN WHERE APPLICABLE

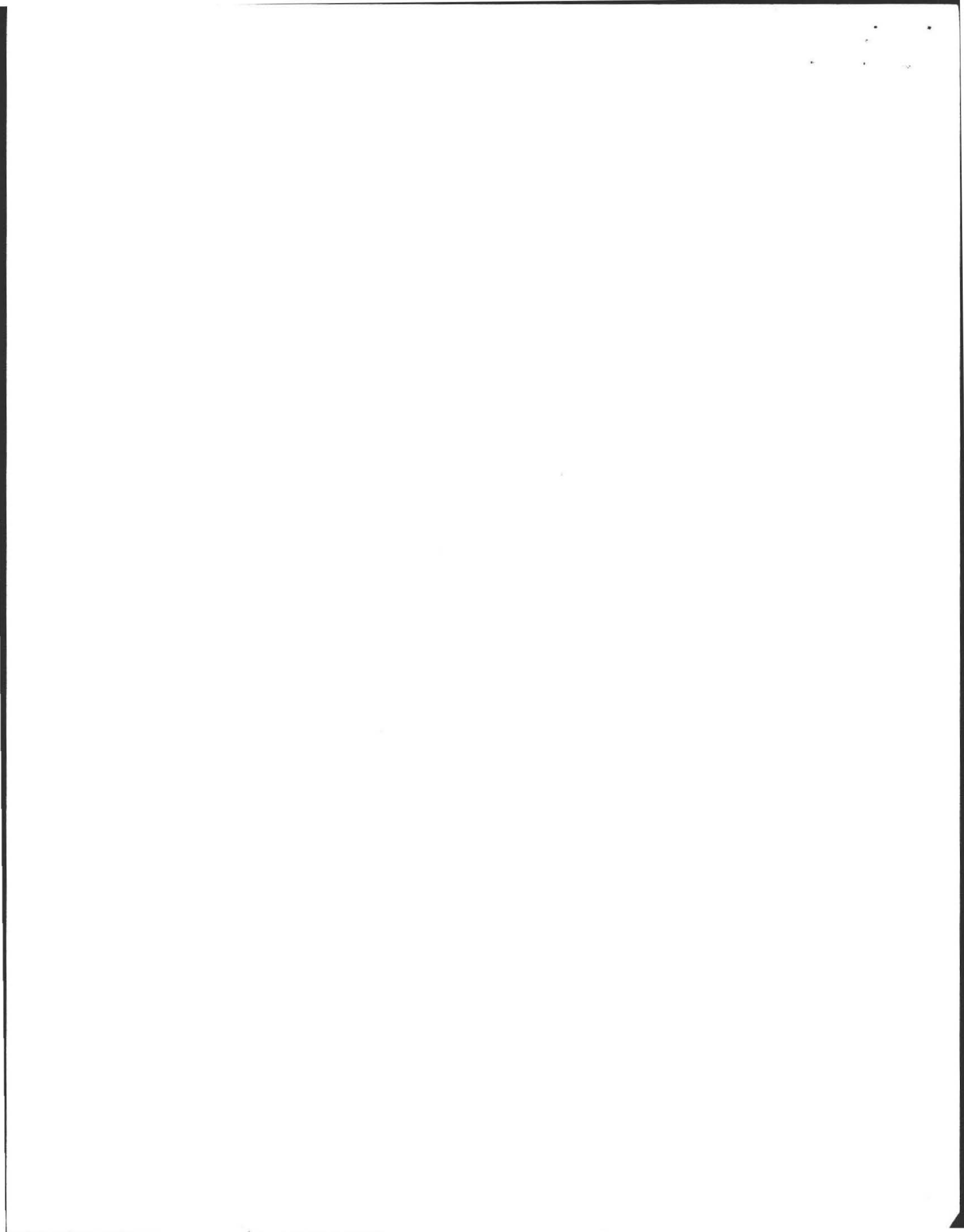

PLAN SHOWING SEWAGE DISPOSAL

For: Nancy Clydesdale
81 Harlow Drive
Amherst Mass.

Scale: 1" = 40'

By: Frederick Filios



INDIAN PIPE LANE

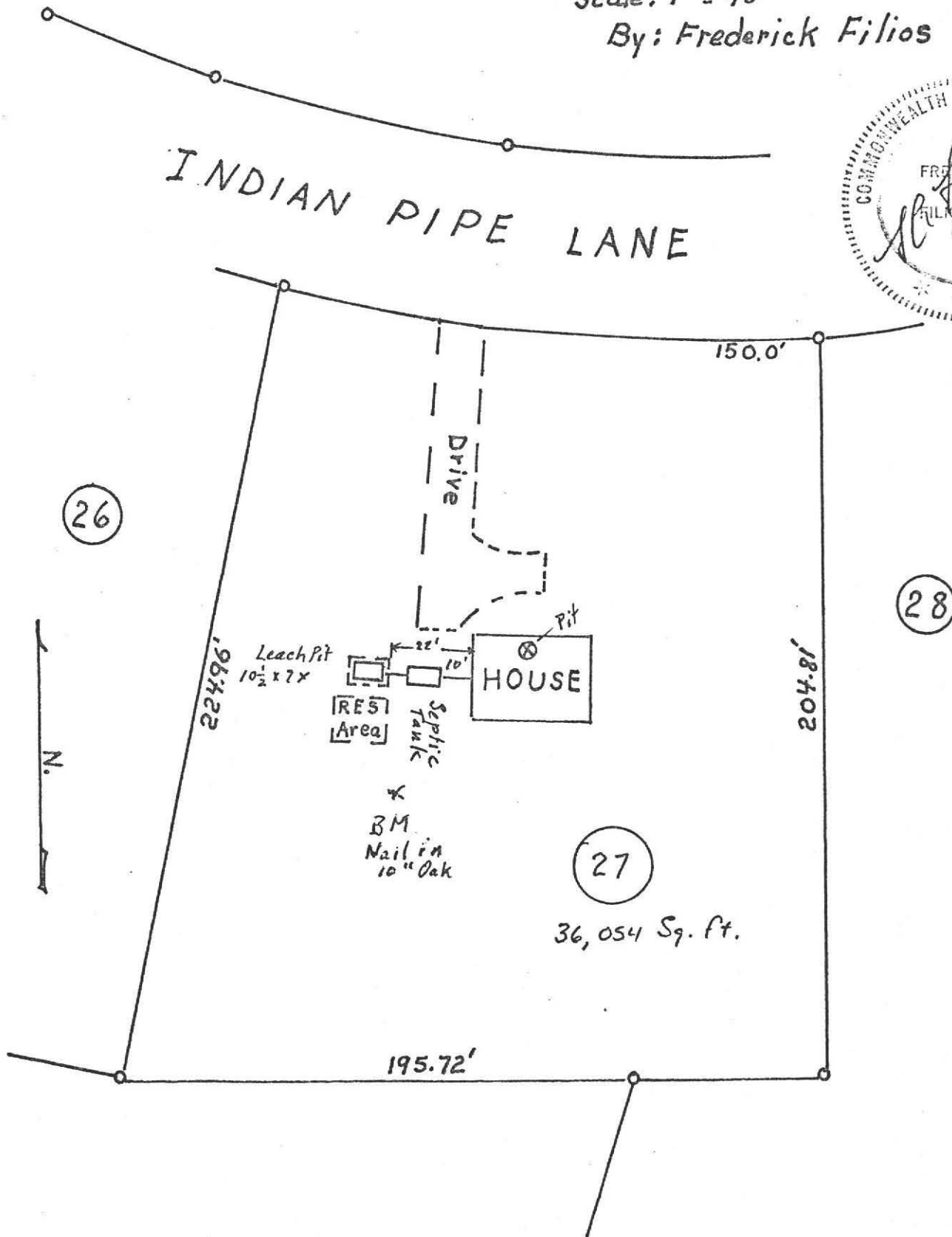

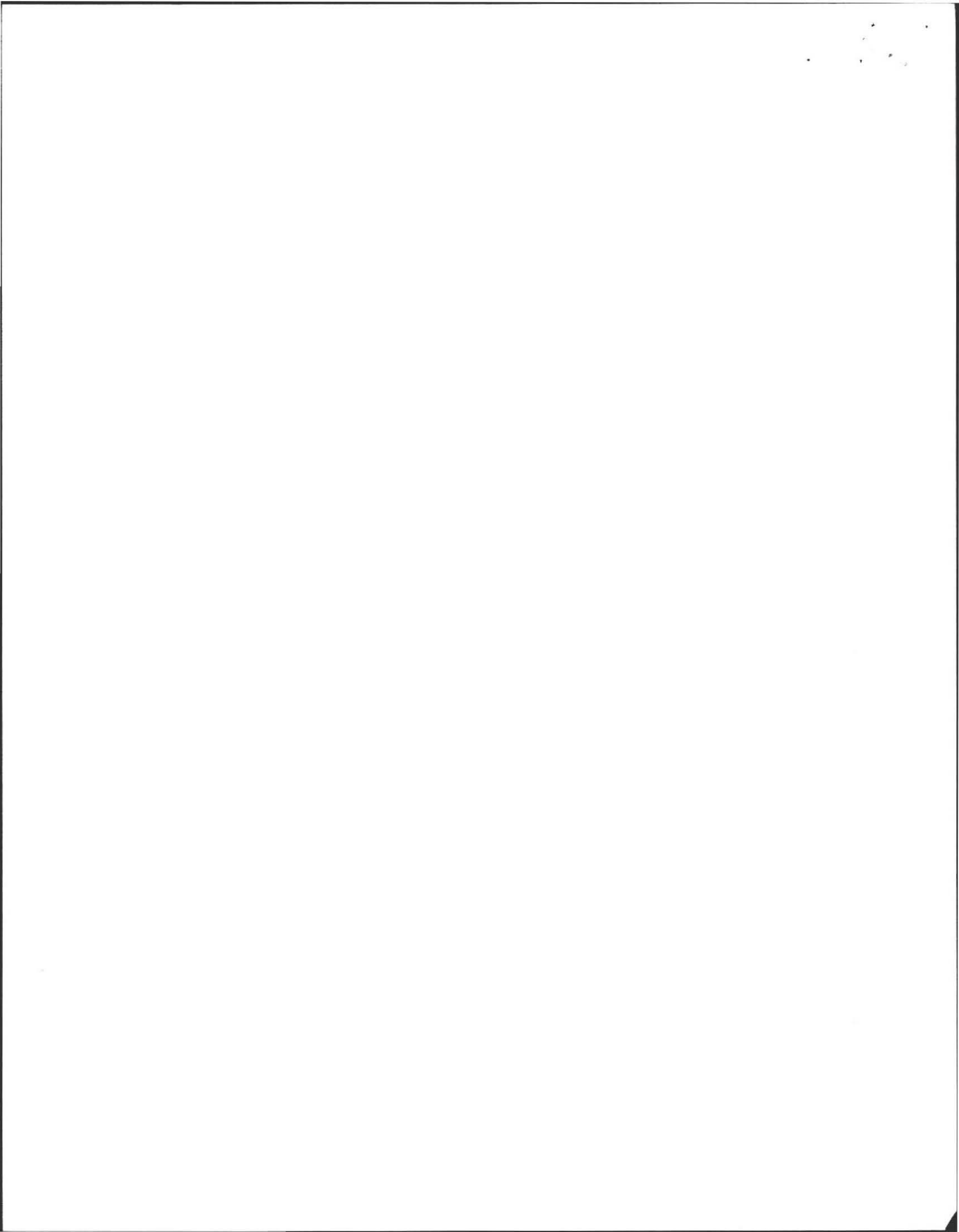

PROFILE OF SEPTIC SYSTEM

Apr. 1984

For: Nancy Clydesdale
81 Harlow Drive
Amherst Mass
At: Amherst Woods Lot 27

Scale: Horizontal, 2"=10'
Vertical, 1"=3'

By: Frederick Filios

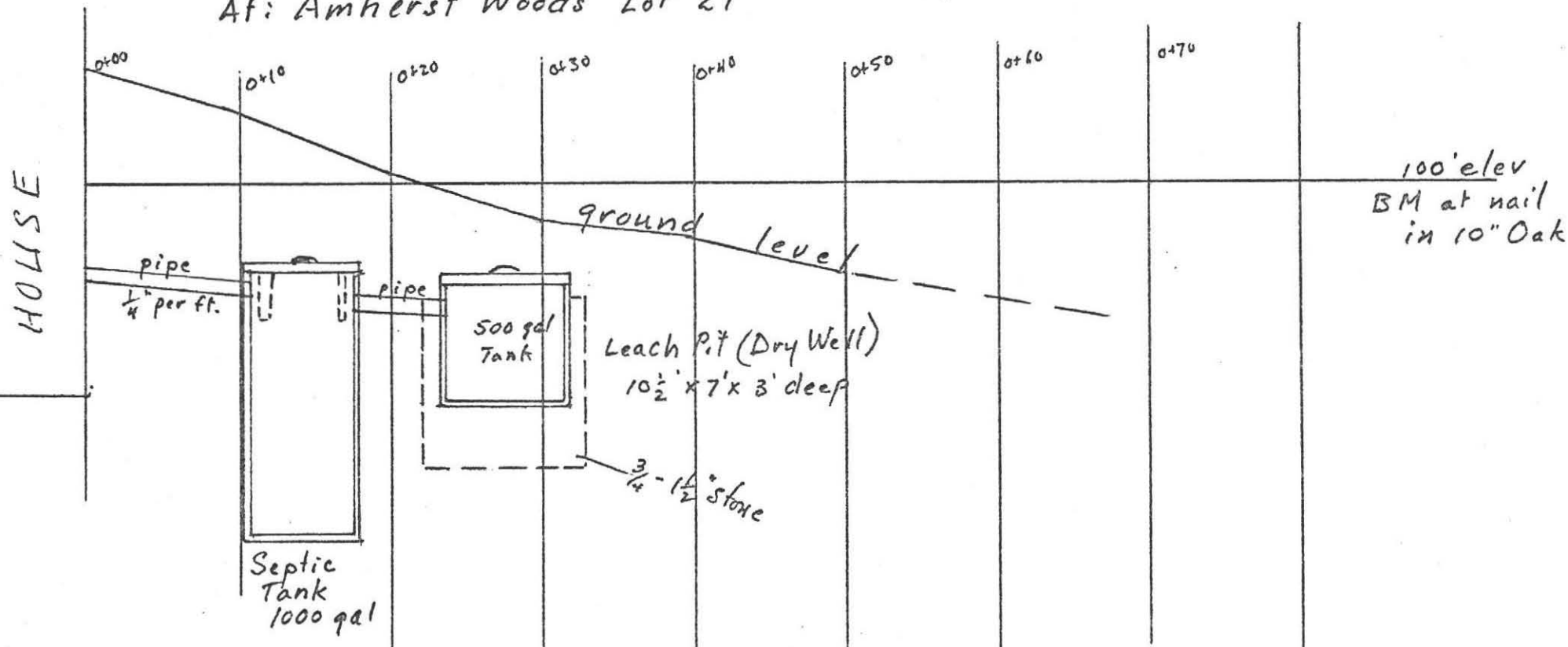

Calculations

2 Bdm. x 110 = 220 gallons flow required

At: 2 minutes/inch

Sides: 2.5 gal per sq. ft

Bottom: 1 gal per sq. ft

Sides: $10\frac{1}{2}' \times 3' \times 2 = 63$ sq. ft.

$7 \times 3 \times 2 = 42$ " "

$\frac{105}{73.5} \times 2.5 = 262.5$ gal.

Bottom $10\frac{1}{2}' \times 7' = 73.5 \times 1 = 73.5$ "

3360 gallons proposed



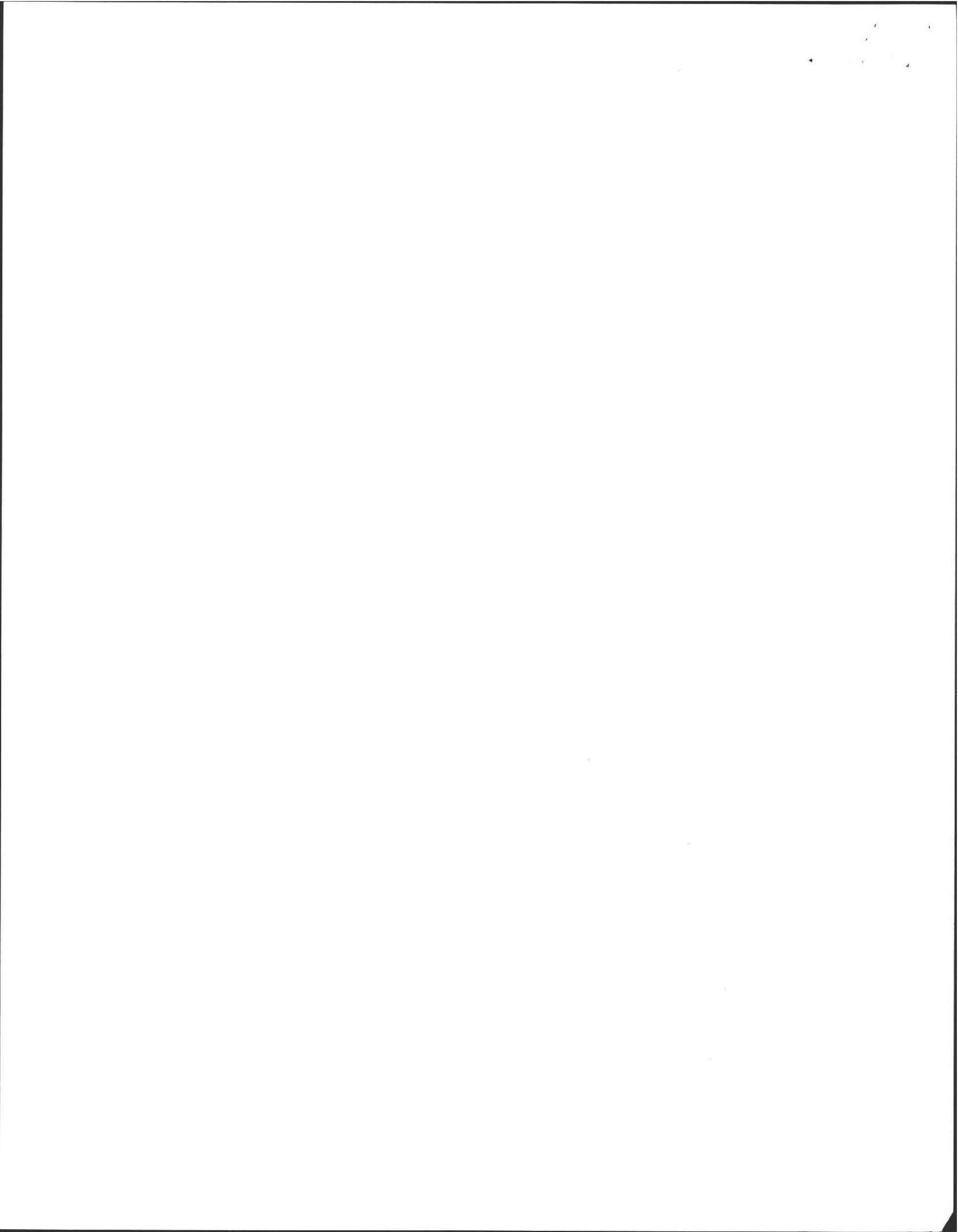

PERCOLATION TEST LOCATION

For: Amherst Woods

Mar. 1980

Scale: 1" = 40'

By: Frederick Filios

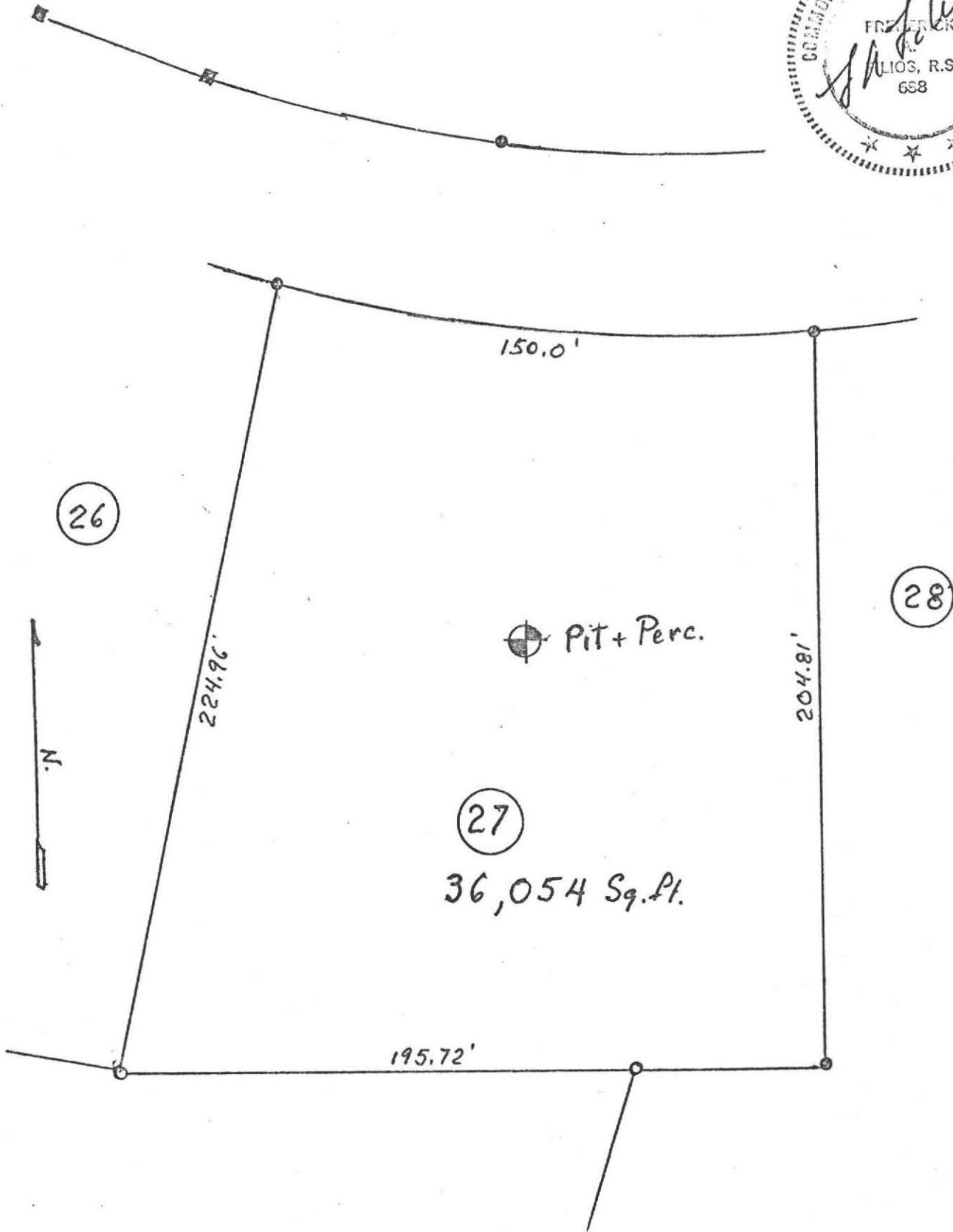

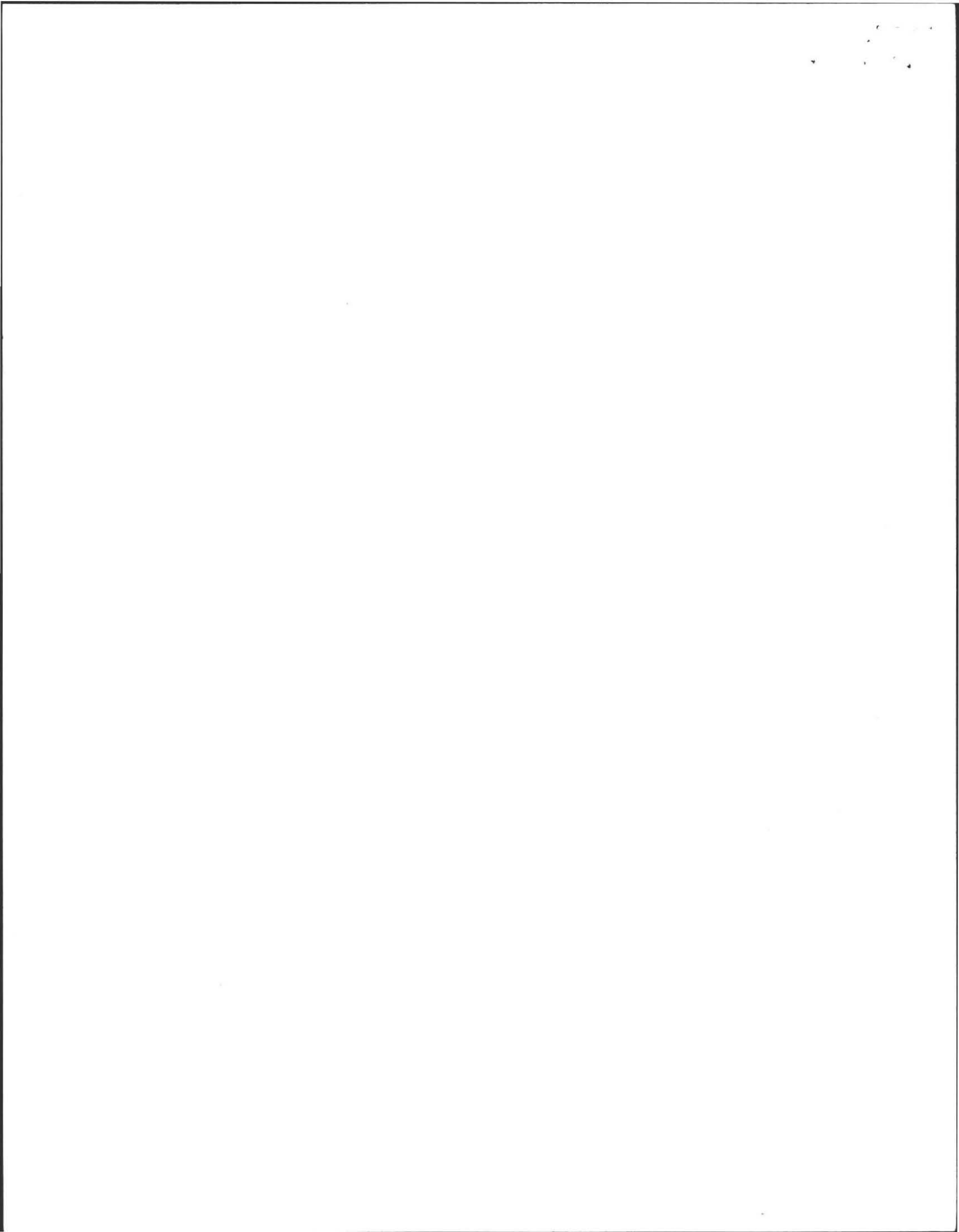

DEEP SOIL LOGS

OWNER Amherst Woods Phase II

Date Mar. 21 1984

LOCATION Amherst Woods Lot. 27

OBSERVER F.A. Filios

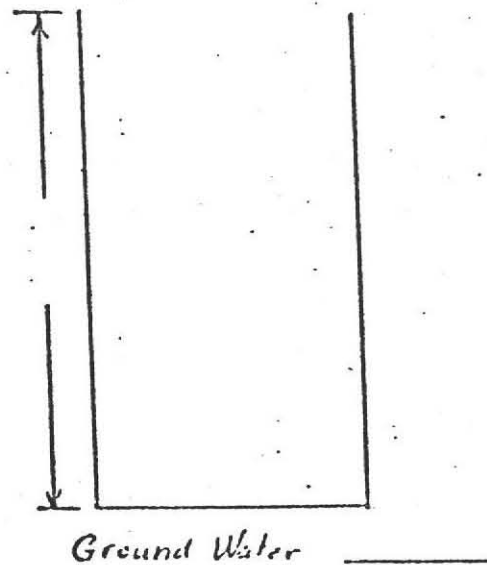
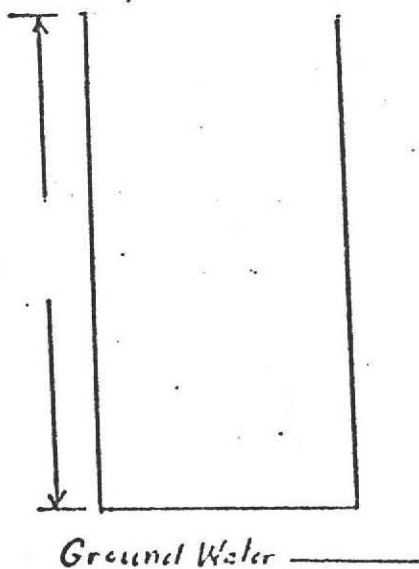
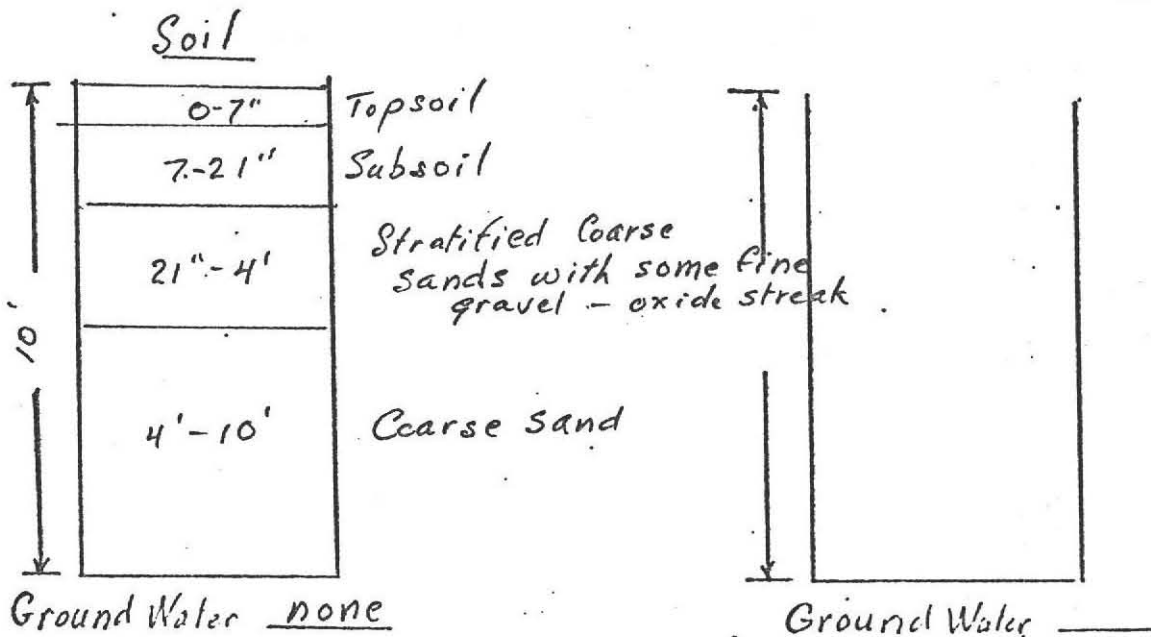

Percolation Rate at 39"

< 2 minutes/inch



10