

34 HUST RD.

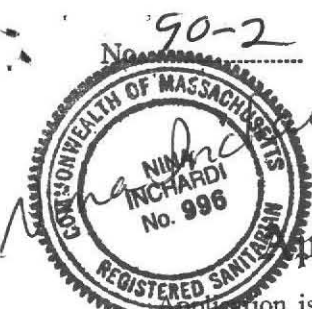

CHECK OR FILL IN WHERE APPLICABLE

1496 CH. 2/28/90
FEE 160.00
Plan + Perc



Revised 5/18/90

THE COMMONWEALTH OF MASSACHUSETTS

BOARD OF HEALTH

Town of Amherst

Application for Disposal Works Construction Permit

Application is hereby made for a Permit to Construct () or Repair (✓) an Individual Sewage Disposal System at:

34 Hulst Rd, Amherst, MA
Carol Wood
Owner

Type of Building: Dwelling — No. of Bedrooms 4 Expansion Attic ()
Other — Type of Building single family No. of persons 8 Showers () — Cafeteria ()

Design Flow 55 gallons per person per day. Total daily flow 440 gallons.
Septic Tank — Liquid capacity 1000 gallons Length 9' Width 5' Diameter 5 1/2' Depth 5 1/2'
Disposal Trench — No. 2 Width 13 x 16' Total Length 3' Total leaching area 764 sq. ft.
Seepage Pit No. 2 Diameter 13 x 16' Depth below inlet 3' Total leaching area 764 sq. ft.
Other Distribution box (✓) Dosing tank ()
Percolation Test Results Performed by R.L. Lavigne / D. Zarazinski Date 2/28/90
Test Pit No. 1 5 minutes per inch Depth of Test Pit 72" Depth to ground water 7 1/2'
Test Pit No. 2 5.2 minutes per inch Depth of Test Pit 48" Depth to ground water 12 1/2'

Description of Soil: For TP#1: 6" organic topsoil, 6" loamy fill, 3' silty sand, 6' outwash sand. H2O @ 7 1/2'
For TP#2: 6" organic topsoil, 5 1/2' fill, 6 1/2' outwash sand. H2O @ 12 1/2'

Agreement: The undersigned agrees to install the aforescribed Individual Sewage Disposal System in accordance with the provisions of TITLE 5 of the State Sanitary Code — The undersigned further agrees not to place the system in operation until a Certificate of Compliance has been issued by the board of health.

Signed Carol Ann Wood April 10, 1990
Application Approved By David Zarazinski for Amherst Board of Health 4/10/90
Application Disapproved for the following reasons:

Permit No. 90-2 Issued Date

THE COMMONWEALTH OF MASSACHUSETTS

BOARD OF HEALTH

Town of Amherst

Certificate of Compliance

THIS IS TO CERTIFY, That the Individual Sewage Disposal System constructed () or Repaired (✓) by Installer

at has been installed in accordance with the provisions of TITLE 5 of The State Sanitary Code as described in the application for Disposal Works Construction Permit No. 90-2 dated

THE ISSUANCE OF THIS CERTIFICATE SHALL NOT BE CONSTRUED AS A GUARANTEE THAT THE SYSTEM WILL FUNCTION SATISFACTORY.

DATE Inspector

THE COMMONWEALTH OF MASSACHUSETTS

BOARD OF HEALTH

Town of Amherst

Disposal Works Construction Permit

Permission is hereby granted to Construct () or Repair (✓) an Individual Sewage Disposal System at No. 34 Hulst Road

as shown on the application for Disposal Works Construction Permit No. 90-2 Dated 4/10/90

DATE 4/10/90 David Zarazinski for Amherst Board of Health

FEB 28, 1990
FEE 160.00
Plan + Perc



1496 CH. 2/28/90

FEE 160.00
Plan + Perc



THE COMMONWEALTH OF MASSACHUSETTS

BOARD OF HEALTH

Town OF Amherst

Application for Disposal Works Construction Permit

Application is hereby made for a Permit to Construct () or Repair (✓) an Individual Sewage Disposal System at:

341 Hulst Rd, Amherst, MA
Location - Address " " or Lot No.
Carol Wood Owner Address
Installer Address

Type of Building Dwelling — No. of Bedrooms 4 Expansion Attic () Garbage Grinder (S) NOTE
Other — Type of Building single family No. of persons 8 Showers () — Cafeteria ()
Other fixtures

Design Flow 55 gallons per person per day. Total daily flow 440 gallons.
Septic Tank — Liquid capacity 1000 gallons Length 8' Width 5' Diameter Depth 5 1/2'
Disposal Trench — No. Width Total Length Total leaching area sq. ft.
Seepage Pit No. 2 Diameter 13' x 16' Depth below inlet 3' Total leaching area 764 sq. ft.

Other Distribution box (✓) Dosing tank ()
Percolation Test Results Performed by R.L. Lavigne / D. Zarozinski Date 2/28/90
Test Pit No. 1 5 minutes per inch Depth of Test Pit 72" Depth to ground water 7 1/2'
Test Pit No. 2 5.2 minutes per inch Depth of Test Pit 48" Depth to ground water 12 1/2'

Description of Soil For TP#1: 6" organic topsoil, 6" loamy fill, 3' silty sand, 6' outwash sand. H2O @ 7 1/2'
For TP#2: 6" organic topsoil, 5 1/2' fill, 6 1/2' outwash sand. H2O @ 12 1/2'

Nature of Repairs or Alterations — Answer when applicable

Agreement: The undersigned agrees to install the aforescribed Individual Sewage Disposal System in accordance with the provisions of TITLE 5 of the State Sanitary Code — The undersigned further agrees not to place the system in operation until a Certificate of Compliance has been issued by the board of health.

Signed Carol Ann Wood April 10, 1990

Application Approved By David Zarozinski 4/10/90
Application Disapproved for the following reasons: Amherst Board of Health

Permit No. 90-2 Issued Date

THE COMMONWEALTH OF MASSACHUSETTS

BOARD OF HEALTH

Town OF Amherst

Certificate of Compliance

THIS IS TO CERTIFY, That the Individual Sewage Disposal System constructed () or Repaired (✓) by Installer

at has been installed in accordance with the provisions of TITLE 5 of The State Sanitary Code as described in the application for Disposal Works Construction Permit No. 90-2 dated

THE ISSUANCE OF THIS CERTIFICATE SHALL NOT BE CONSTRUED AS A GUARANTEE THAT THE SYSTEM WILL FUNCTION SATISFACTORY.

DATE Inspector

THE COMMONWEALTH OF MASSACHUSETTS

BOARD OF HEALTH

Town OF Amherst

Disposal Works Construction Permit

Permission is hereby granted to Construct (✓) or Repair () an Individual Sewage Disposal System at No. 341 Hulst Road

as shown on the application for Disposal Works Construction Permit No. 90-2 Dated 4/10/90

DATE 4/10/90 Board of Health

FEB 28, 1990
FEE 160.00
Plan + Perc

CHECK OR FILL IN WHERE APPLICABLE



U.S. GOVERNMENT PRINTING OFFICE: 1964 O 345-110

90-2 Revised

#34

FEE 30⁰⁰ Revised
Phn
C4 1545

No. _____

THE COMMONWEALTH OF MASSACHUSETTS

BOARD OF HEALTH

Town of Amherst MA



Application for Disposal Works Construction Permit

is hereby made for a Permit to Construct (X) or Repair (X) an Individual Sewage Disposal System

Location - Address: ROSEN/WOOD 39 HULST ROAD Amherst
Owner: B. H. Stevuta
Address: 39 HULST ROAD Amherst

Type of Building: 4 BEDROOM
Size Lot: _____ Sq. feet

Dwelling - No. of Bedrooms: _____ Expansion Attic () Garbage Grinder () NO
Other - Type of Building: Residential No. of persons: 2 Showers () - Cafeteria () NO
Other fixtures: Fuel Burnt with Drains

Design Flow: 110 gallons per person per day. Total daily flow: 440 x 1.25 = 550 gallons

Septic Tank - Liquid capacity: 1000 gallons Length: 8'6" Width: 5' Diameter: _____ Depth: 5'

Disposal Trench - No. 2 Width: 3' Total Length: 52' Total leaching area: _____ sq. ft.

Seepage Pit No. _____ Diameter: _____ Depth below inlet: 2' Total leaching area: _____ sq. ft.

Other Distribution box () Dosing tank ()
Percolation Test Results: Performed by: P. LAVIGNE Date: 3/28/90

Test Pit No. 1: 5.0 minutes per inch Depth of Test Pit: 22" Depth to ground water: _____

Test Pit No. 2: 2.0 minutes per inch Depth of Test Pit: 48" Depth to ground water: _____

Description of Soil: T1-1 0-10 DIS COAR 0-12 LOAMY
T1-2 0-3 DIS COAR 3-74 GRAVEL FILL
WASH SAND H20 90"

Nature of Repairs or Alterations - Answer when applicable: T1-152 OUTWASH SAND H20 152"

Agreement:

The undersigned agrees to install the aforescribed Individual Sewage Disposal System in accordance with the provisions of TITLE 5 of the State Sanitary Code - The undersigned further agrees not to place the system in operation until a Certificate of Compliance has been issued by the board of health.

Signed: Carol Ann Wood May 2, 1990

Application Approved By: Carol Regan for Board of Health Date: May 2, 1990

Application Disapproved for the following reasons: _____

Permit No. 90-2 Revised

Issued: May 2, 1990

THE COMMONWEALTH OF MASSACHUSETTS

BOARD OF HEALTH

Town of Amherst

Certificate of Compliance

THIS IS TO CERTIFY, That the Individual Sewage Disposal System constructed () or Repaired (X)

by: B. H. Stevuta Installer

at: 39 Hulst Road

has been installed in accordance with the provisions of TITLE 5 of The State Sanitary Code as described in the application for Disposal Works Construction Permit No. 90-2 Revised dated May 2, 1990

THE ISSUANCE OF THIS CERTIFICATE SHALL NOT BE CONSTRUED AS A GUARANTEE THAT THE SYSTEM WILL FUNCTION SATISFACTORY.

DATE: 6/7/90 Inspector: Carol Regan for Board of Health

THE COMMONWEALTH OF MASSACHUSETTS

BOARD OF HEALTH

Town of Amherst

No. 90-2 Revised

FEE 30⁰⁰ Revised

Disposal Works Construction Permit

Permission is hereby granted: Carol Ann Wood to Construct () or Repair (X) an Individual Sewage Disposal System

at No. 39 Hulst Road Street

as shown on the application for Disposal Works Construction Permit No. 90-2 Dated: May 2, 1990

DATE: May 2, 1990

Signature: Carol Regan for Board of Health

CHECK OR FILL IN WHERE APPLICABLE

AMHERST HEALTH DEPARTMENT

TITLE V FEES

Owner: CAROL Wood Robert Rosen

Site: 34 HULST ROAD

Percolation Test: Per Lot

100⁰⁰ Pd Date: 2/28/90

_____ Date: _____

_____ Date: _____

_____ Date: _____

_____ Date: _____

Disposal Works Construction Permit

Plan Review 60⁰⁰ Pd. Date _____

Final Inspection Date _____

Subsequent Plan Review

Date _____

Date _____

Date _____

Reinspection of Installation

Date _____

Date _____

Date _____

160⁰⁰ Pd CK # 1496 DATE
EH: 89 15 01 Feb 28, 1990

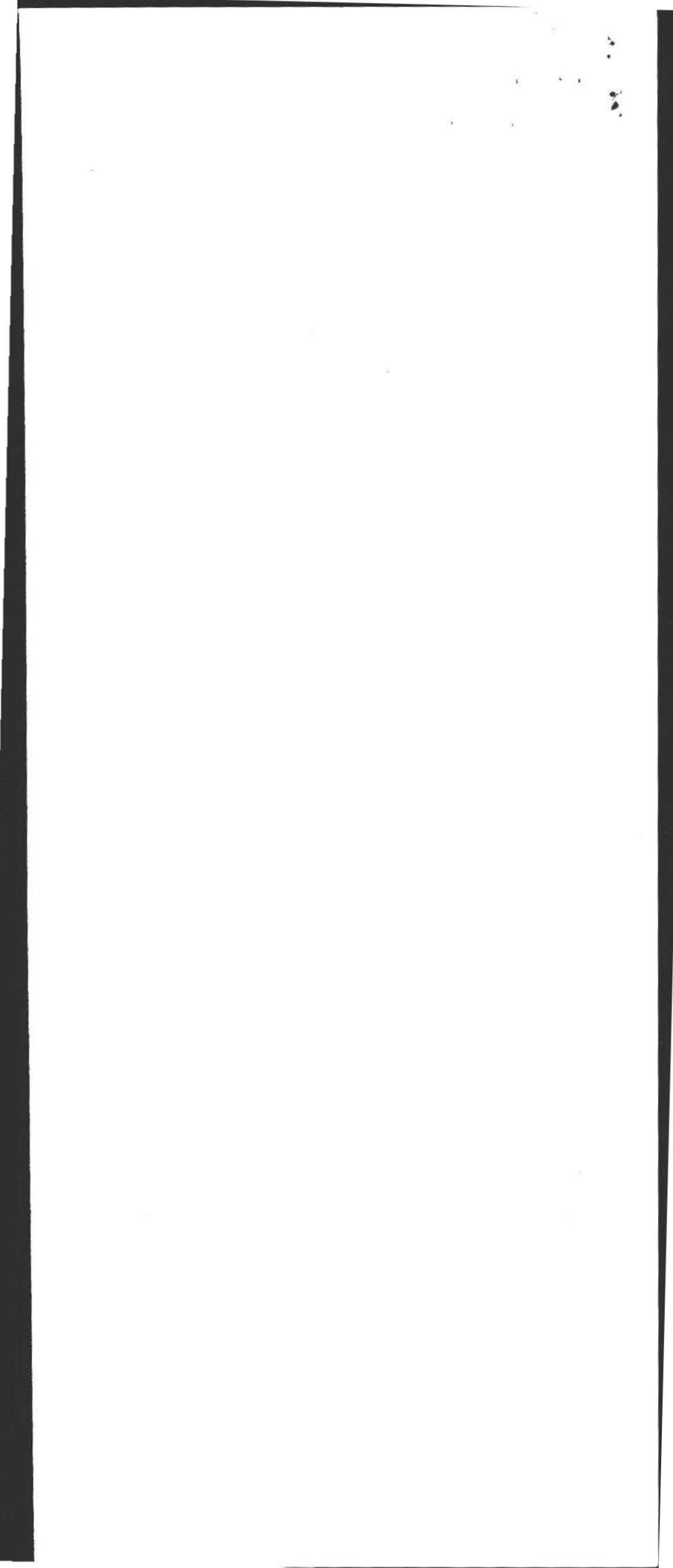

FEB 28, 1990
 CK 160
 100% PERC
 60 PLANS

TOWN OF AMHERST
 PERC TEST DATA SHEET

Repair Perc

DATE 2/28/90 LOCATION 34 Hulst Road LOT SIZE CK # 1496

OWNER ROBERT ROSEN CAROL WOOD ADDRESS 34 Hulst Road TELE # 253-9762

P.E./RS RONALD LAVIGNE FIRM _____ OBSERVED BY DAVID TAROZINSKI

BACK HOE OPERATOR Karl's BENCH MARK _____

PERC DEPTH _____ PRE SOAK TIME 9:20-9:35 PERC DEPTH 42' PRE SOAK TIME CANT

TEST 9:35 10 1/2 9:52 15" _____ Hold

9:42 12" 10:00 16 1/2 _____

9:47 13 3/4 10:05 17 1/2 _____

RATE (6) RATE (2)

#1

TOP 6"
SUB 2"
SILTY SAND 48"
OUTWASH SAND 10'

#2

TOP 2"
NO SUB
FILL 6'
OUTWASH SAND 12'
WATER AT 12 1/2'

TOP
SUB

TOP
SUB

TOP
SUB

TOP
SUB

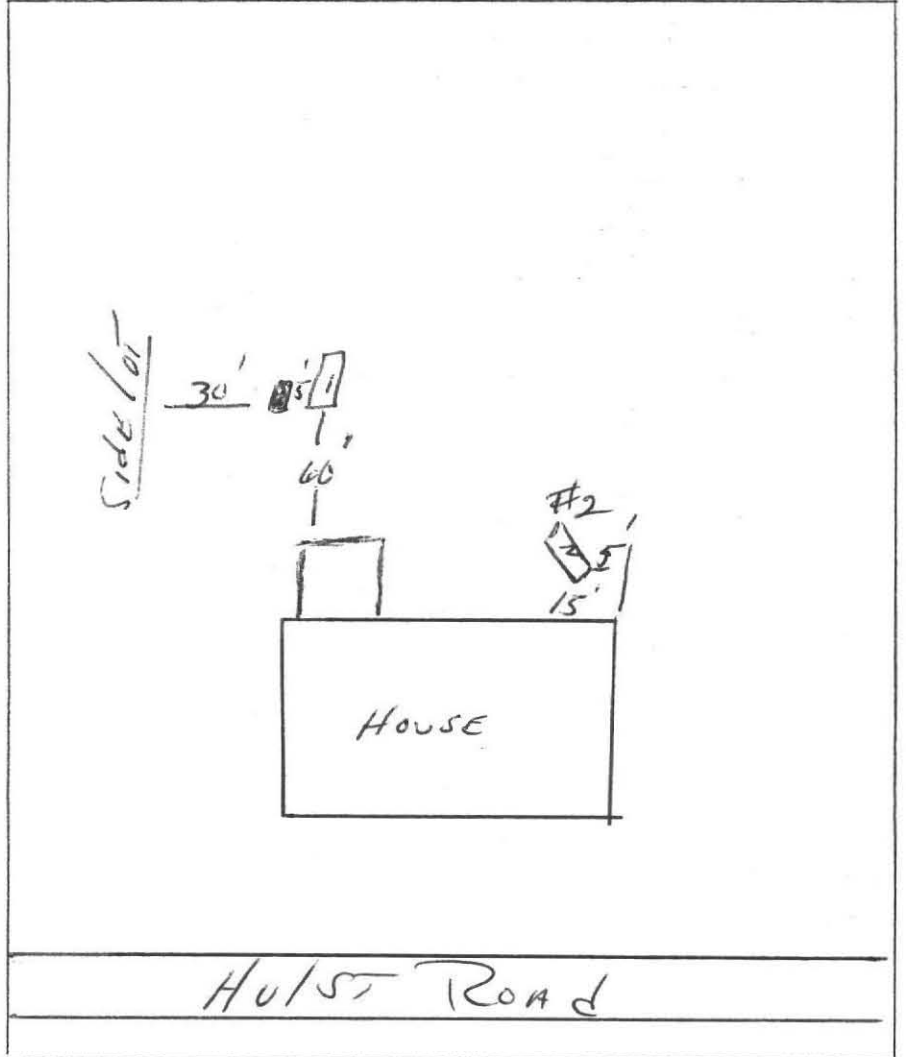

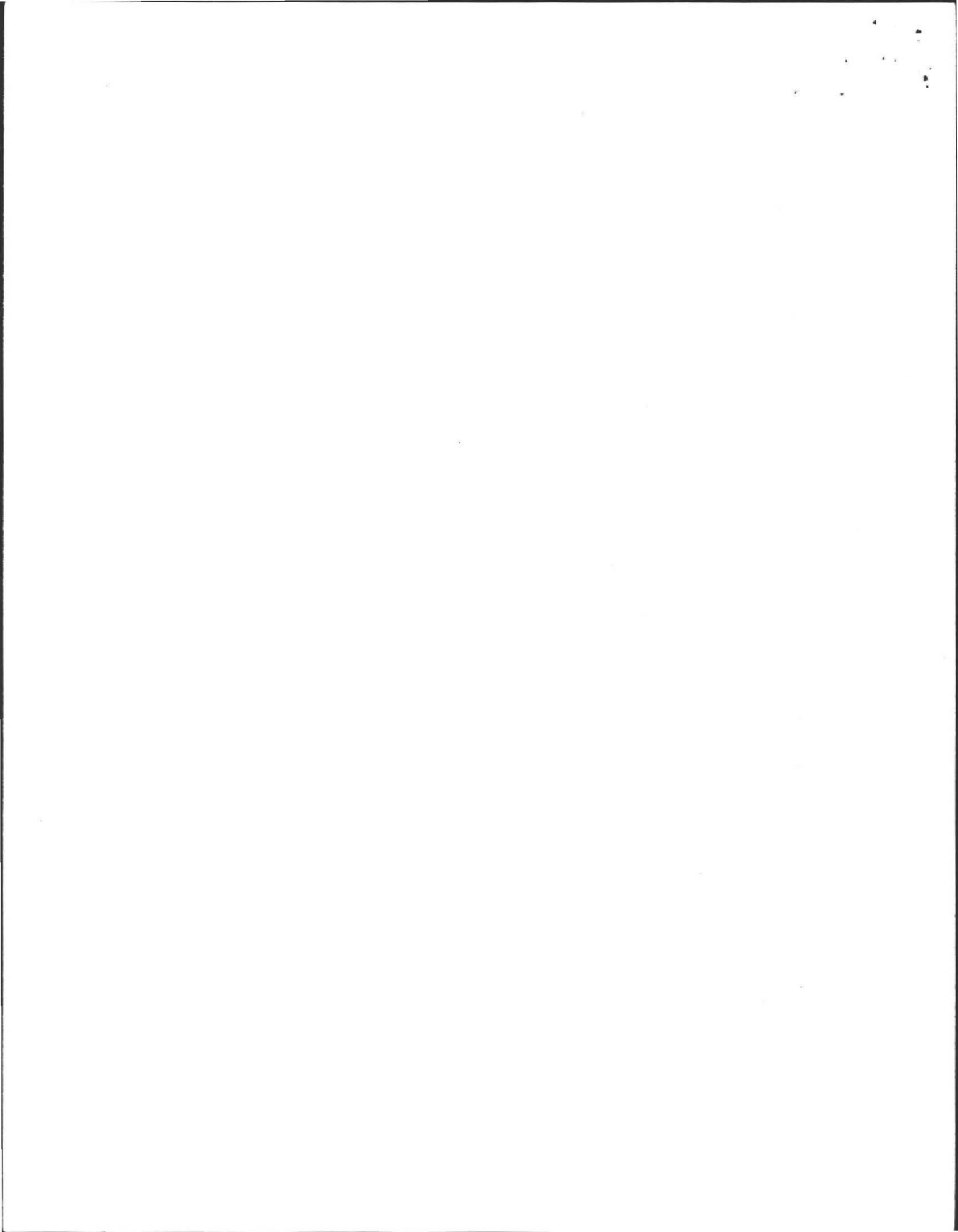

REPAIR
**PERCOLATION REPORT
 AND SITE EVALUATION**

DATE: 2/28/90 WITNESS: Zarojinski
 DAVE

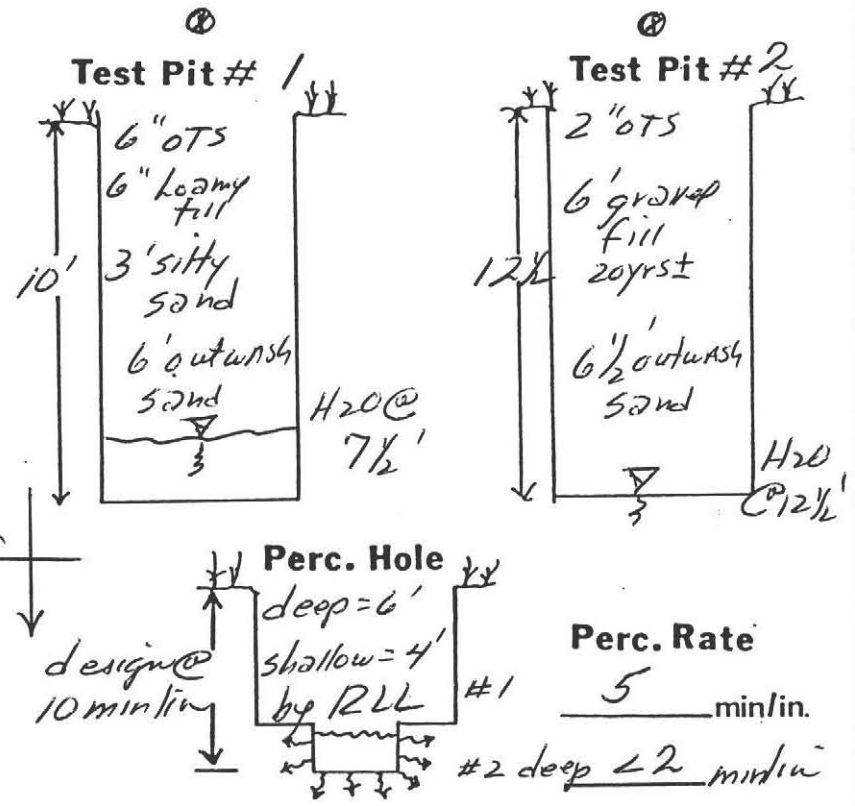
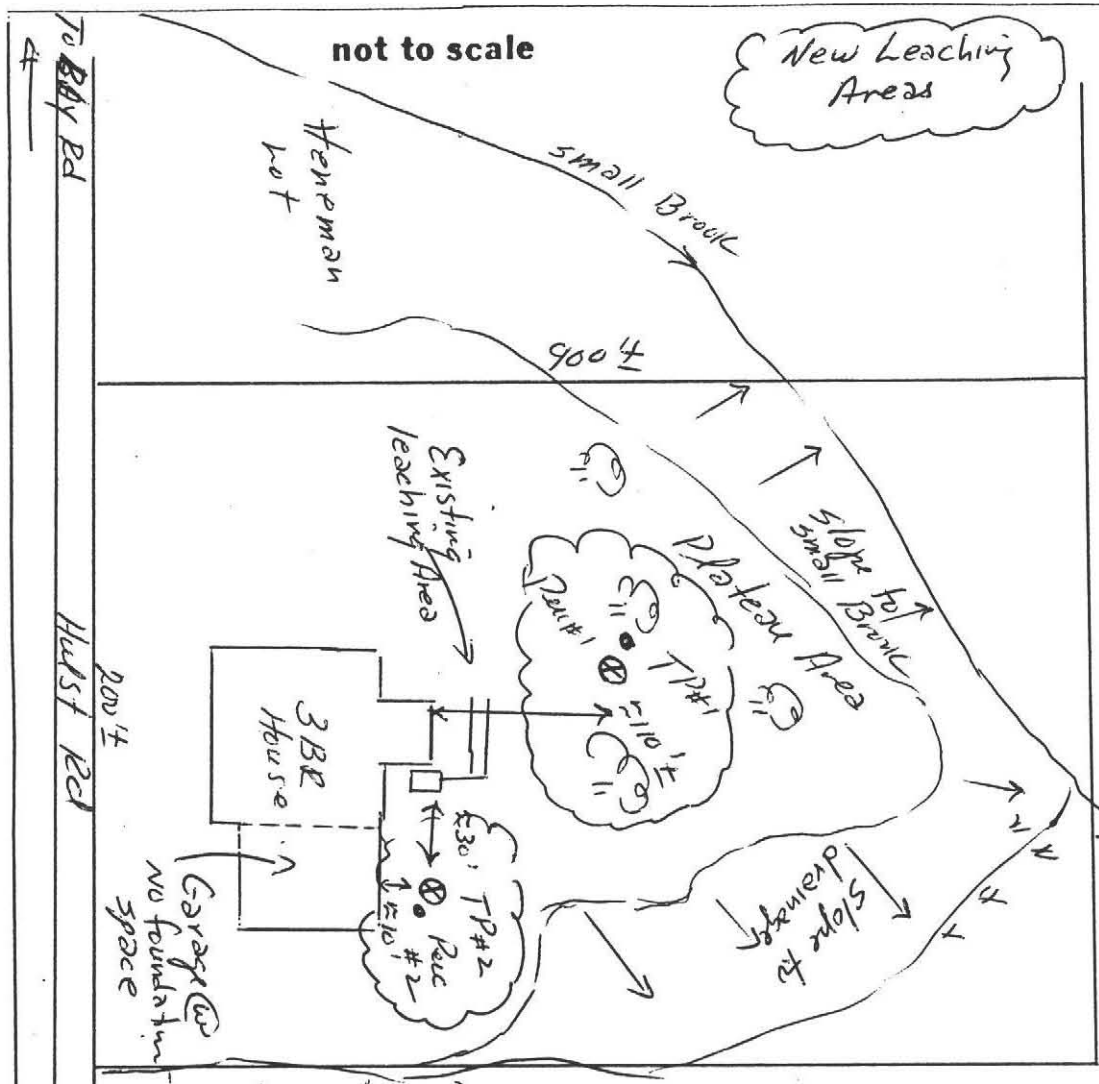

- NOTES!**
- 1) Remove garbage grinder
 - 2) 6' to gw. in Amherst
 - 3) Raise D-Box and slope existing leach lines

**ENVIRONMENTAL SANITATION
 AND ENGINEERING ASSOCIATES INC.**

LOT LOCATION & NO. 34 Hulst Rd
 Existing Res.

OWNER: Carol Wood
 34 Hulst Rd
 Amherst MA 01002

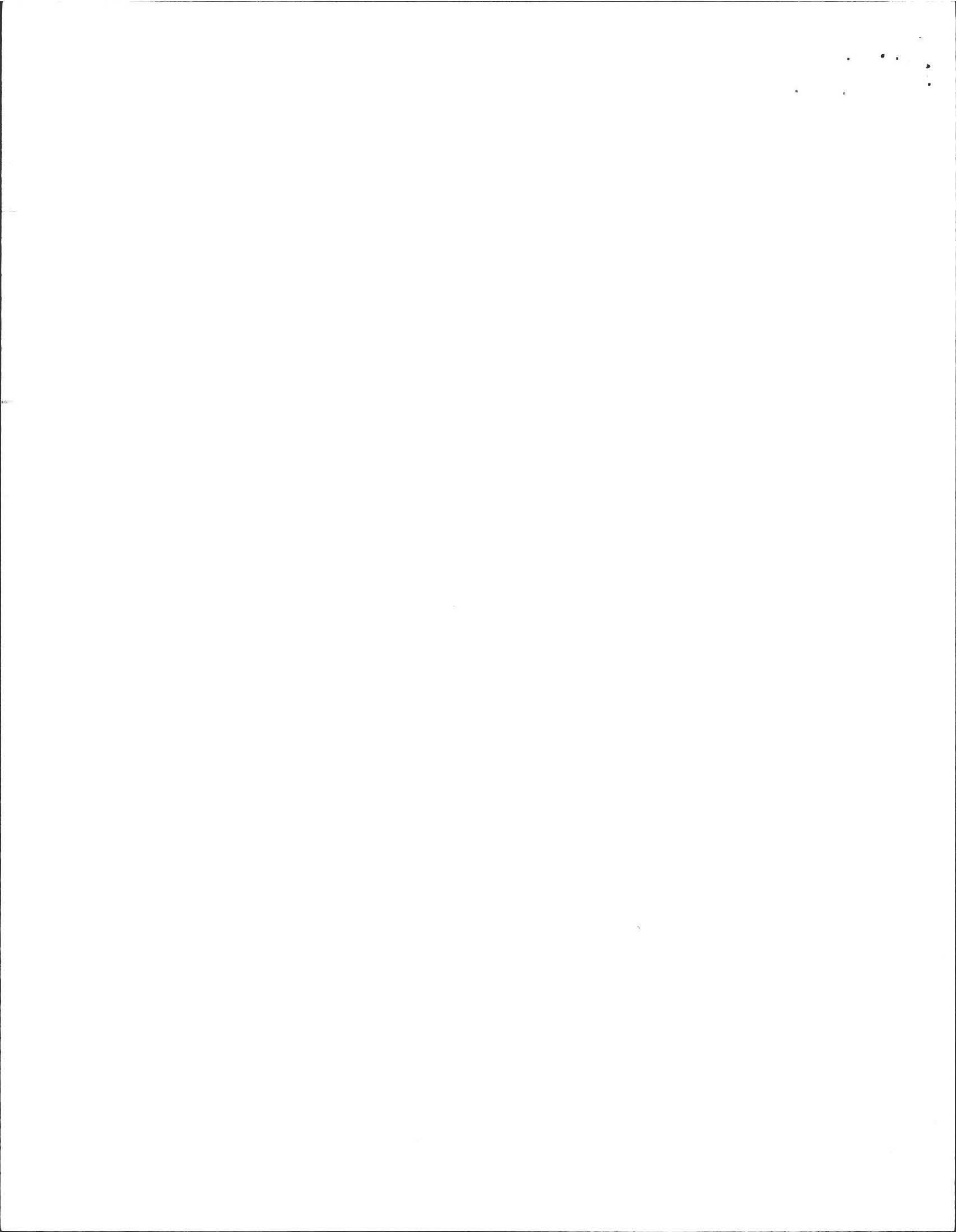

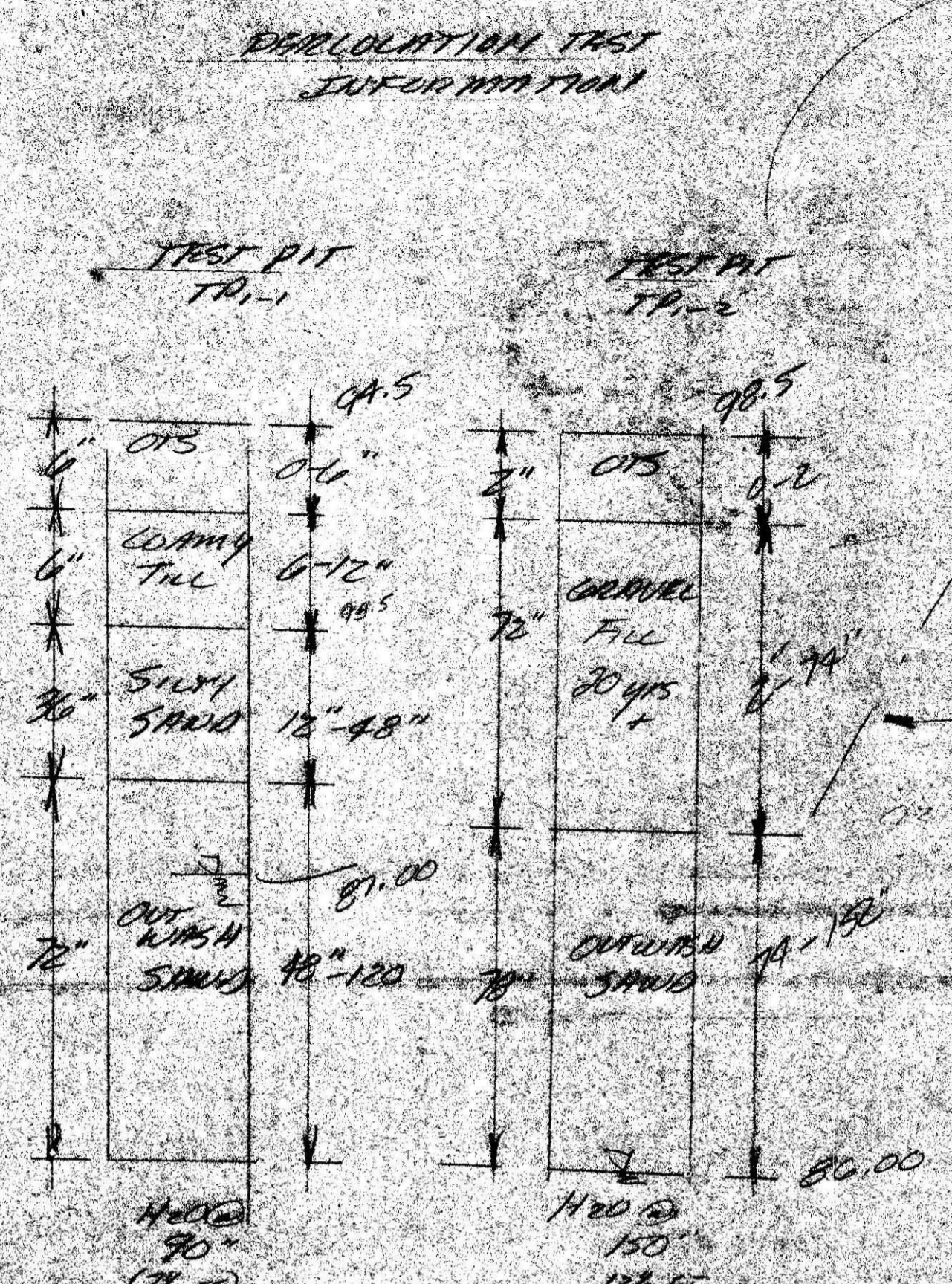

DATE 2/20/90
 ENVIRONMENTAL SANITATION
 AND ENGINEERING ASSOCIATES INC.
 WITNESS D. ZADENISEL BO OF N. SMITH
 PERCOLATION TEST B. LAUIGNE
 TEST 1 72" 5 min/inch BY TP1
 2 48" 2 min/inch BY TP2

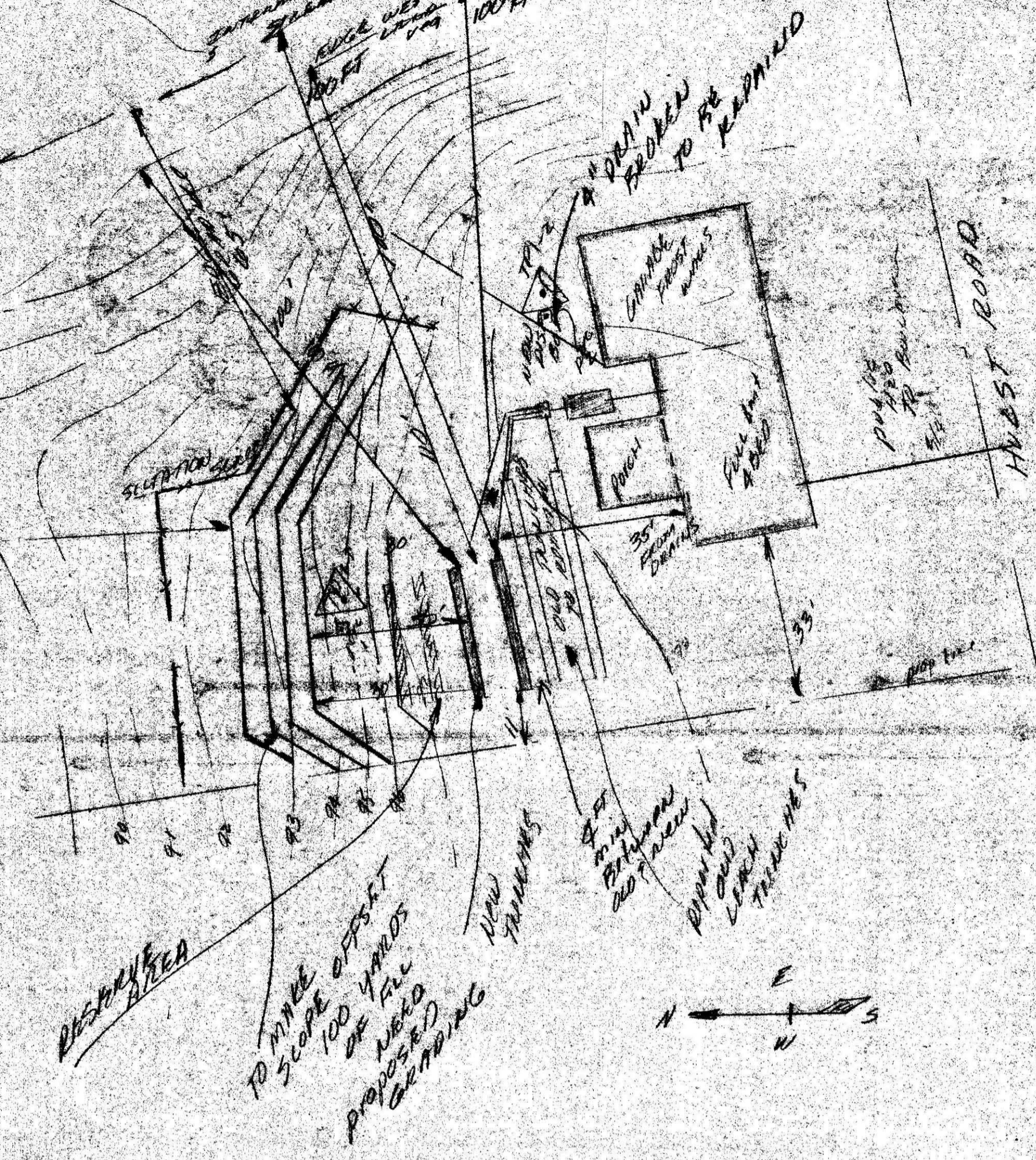

PLAN VIEW SCALE 1" = 20 FT

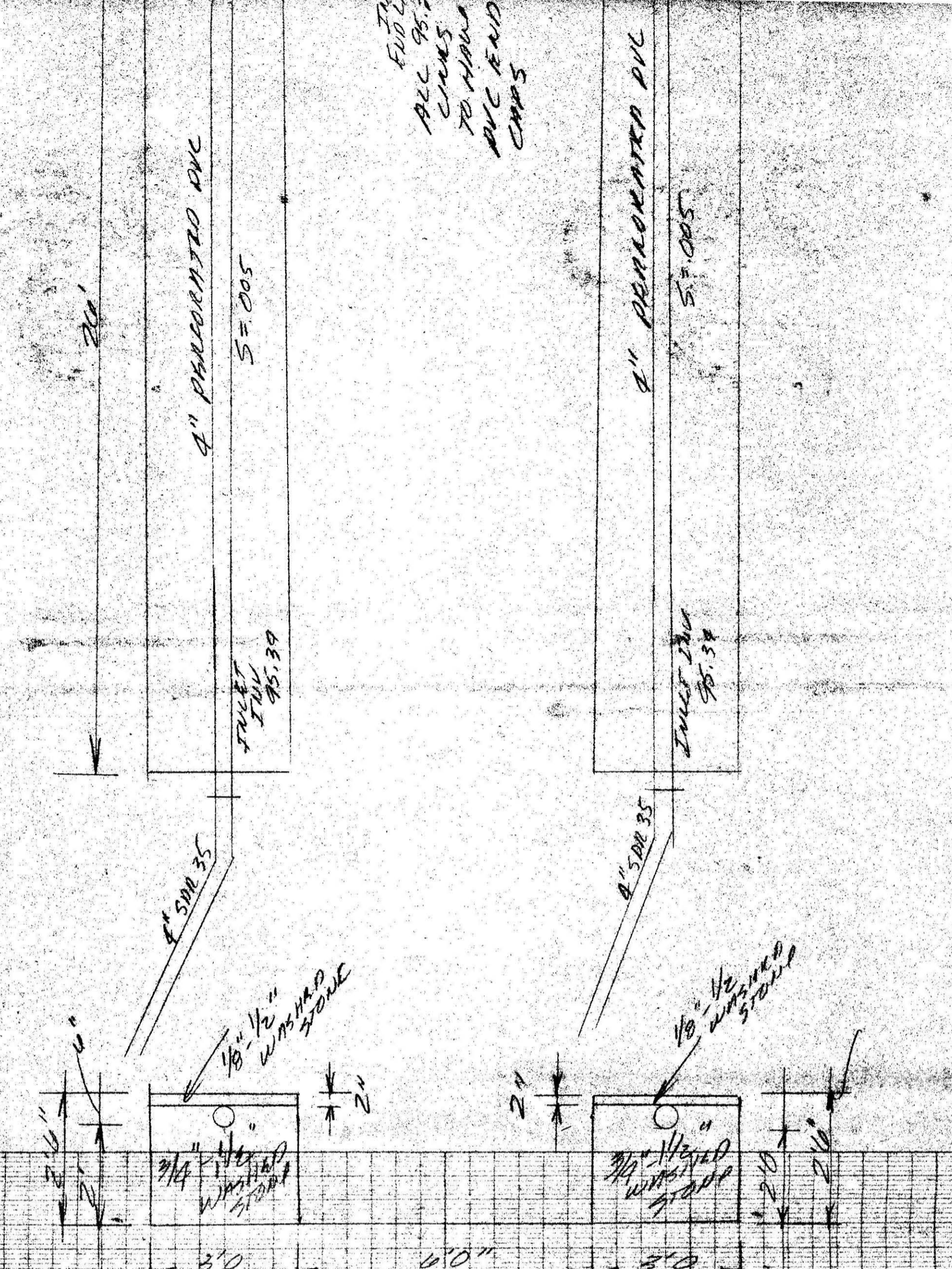

LEACHING SYSTEM DETAIL SCALE 1" = 2'

DESIGN INFORMATION
 ALL CONSTRUCTION TO BE IN ACCORDANCE WITH 810 CMR 15.0 TITLES 5
 PERMITS GRADING IS TO BE AS SHOWN ON PLANS VIEW. ALL DISTURBED AREAS TO BE COMBED AND SEED.
 USE 1 EXISTING SINGLE FAMILY RESIDENTIAL STRUCTURE 4 BEDROOMS
 FULL BATH WITH FOUNDATION DRAIN DISPOSAL TO BE REMOVED 8/11/90
 DESIGN PLAN: 310 CMR 15.02
 NO GAR. 4 BEDROOMS x 4 = 440 GALS
 BATH 120 GALS
 SEPTIC TANK 310 CMR 15.04 550 GALS x 150% = 825 GALS
 USE EXISTING TANK 1000 GALS TANK IS OK FOR RE-USE THIS AND IN PLACE
 LEACHING SYSTEM 310 CMR 15.14
 DUE TO SOIL CONDITIONS DEPTH OF NO. AND LEACHING LEACHING TRENCHES ARE TO BE USED 310 CMR 15.03
 USE 2 TRENCHES 6 FT BETWEEN DESIGN RATE
 EFFECTIVE WIDTH 3 FT
 EFFECTIVE DEPTH 2 FT
 EFFECTIVE LENGTH 26 FT
 BOTTOM AREA 2' x 26' x 2 = 104 FT²
 SIDE WALL 100 FT
 SIDE WALL 100 FT
 TOTAL PERM. FABRIC 174 FT²
 280 FT² x 1.66 + 100 x 1.71 = 574 GALS/DAY FLOW
 TBM SET AT OUTLET IN EXISTING

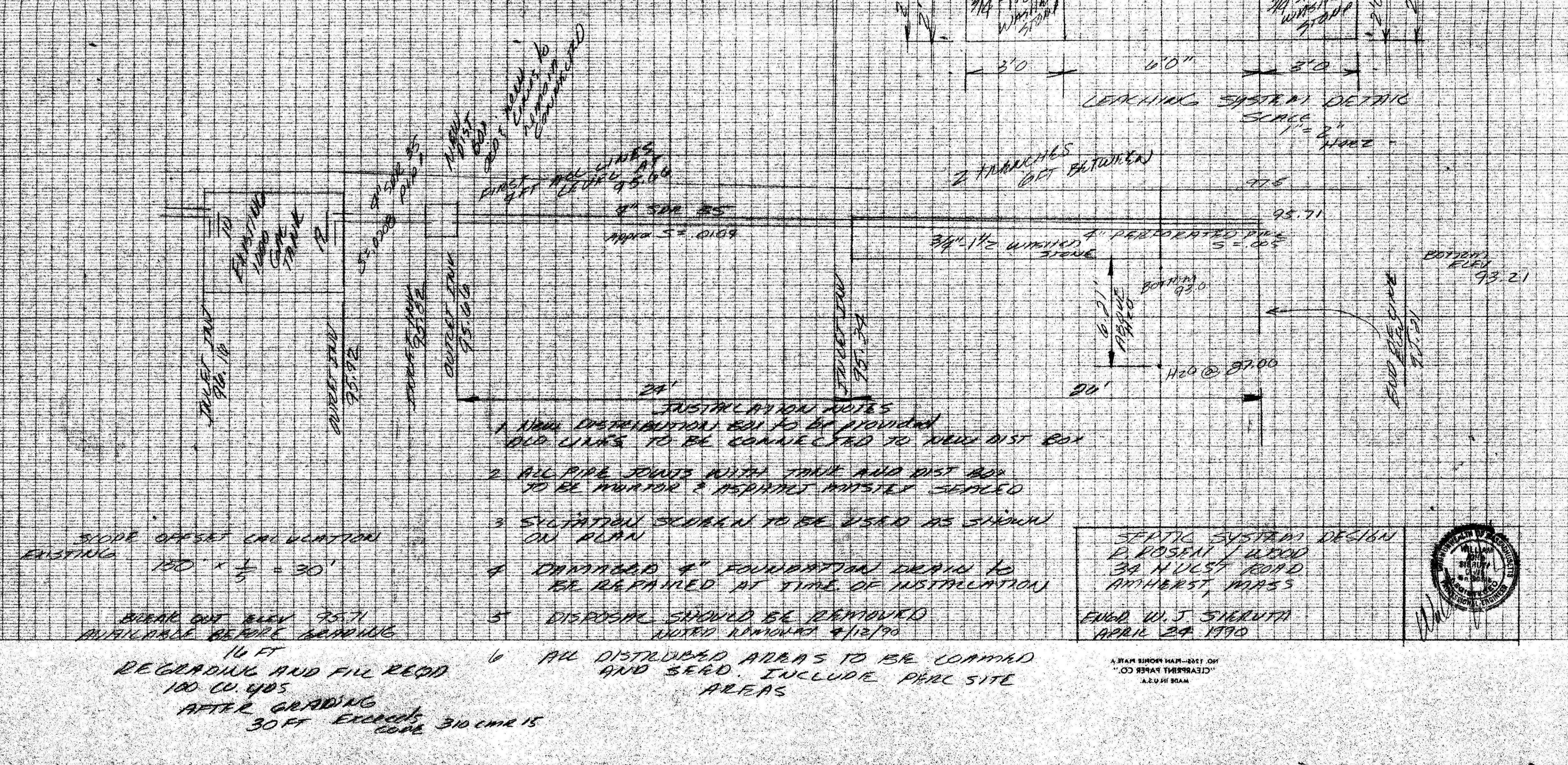

- INSTALLATION NOTES
1. ALL DISTRIBUTION BOX TO BE PROVIDED OLD LINES TO BE CONNECTED TO NEW DIST BOX
 2. ALL PIPE JOINTS WITH TANK AND DIST BOX TO BE HURTOR & REPAIRS MUST BE SEALED
 3. CYLINDRICAL SCREEN TO BE USED AS SHOWN ON PLAN
 4. DAMAGED 4" FOUNDATION DRAIN TO BE REPAIRED AT TIME OF INSTALLATION
 5. DISPOSAL SHOULD BE REMOVED AND REPAIRED 4/12/90
 6. ALL DISTURBED AREAS TO BE COMBED AND SEED. INCLUDE PERC SITE AREAS

SEPTIC SYSTEM DESIGN
 D. ROSEN / WOOD
 39 N. VULST ROAD
 AMHERST, MASS
 ENG'D W.J. SHERATA
 APRIL 24, 1990

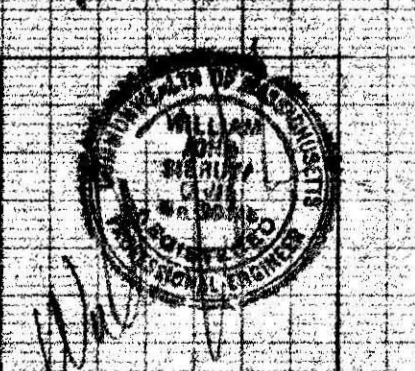

GRADE OFFSET CALCULATION
 EXISTING 100' x 1/5 = 30'
 BREAK OUT BARR 95.71
 AVAILABLE BEFORE GRADING 10 FT
 REGRADING AND FILL REQD 100 CU YDS
 AFTER GRADING 30 FT ELEVATION 310 CMR 15

TYPICAL SEEPAGE PIT SECTION (NOT TO SCALE)

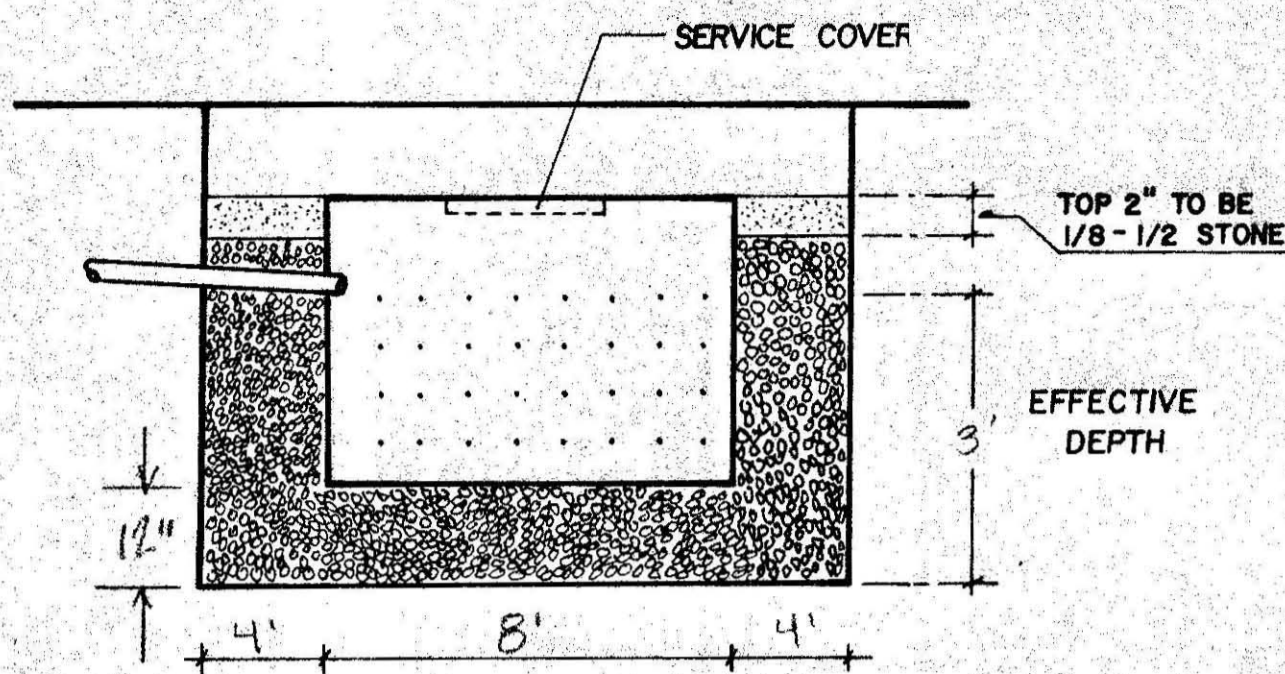

TYPICAL SYSTEM PROFILE (NOT TO SCALE)

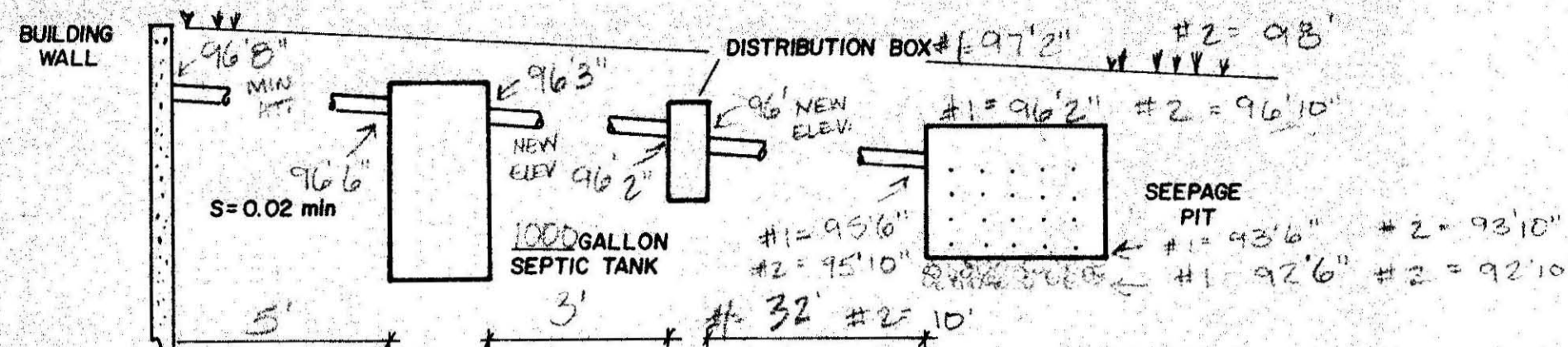

BOTTOM AREA | PIT = 13' x 16' = 208 FT²
 SIDEWALL AREA | PIT = 13' x 3' x 2 = 78 FT²
 16' x 3' x 2 = 96 FT²
 TOTAL BA = 208 FT² (2) = 416 FT²
 TOTAL SWA = 174 FT² (2) = 348 FT²
 TOTAL 2 PIT AREA = 764 FT²

CONSTRUCTION NOTES

- 2 RECTANGULAR SEEPAGE PITS.
EFFECTIVE DEPTH = 3'
EFFECTIVE SIZE = 13' x 16'
- MINIMUM OF 12" OF 3/4 - 1 1/2" STONE TO BE PLACED AROUND AND BENEATH PRECAST LINER.
- TOP 2" TO BE 1/8 TO 1/2" STONE.
- MINIMUM ON CENTER DISTANCE BETWEEN PITS SHALL BE 45'.
- BACKFILL DEPTH ABOVE PIT SERVICE COVER SHALL BE A MINIMUM OF 12".
- ALL CONSTRUCTION TO BE IN ACCORDANCE WITH TITLE V STATE ENVIRONMENTAL CODE.

PERCOLATION TEST RESULTS

PERCOLATION TEST NO.	DEPTH (INCHES)	RATE (MIN/INCH)	DATE
1	72"	5 MIN/IN	2/28/90
2	48"	< 2 MIN/IN	2/28/90

DESIGN @ 10 MIN/IN

SOIL LOGS

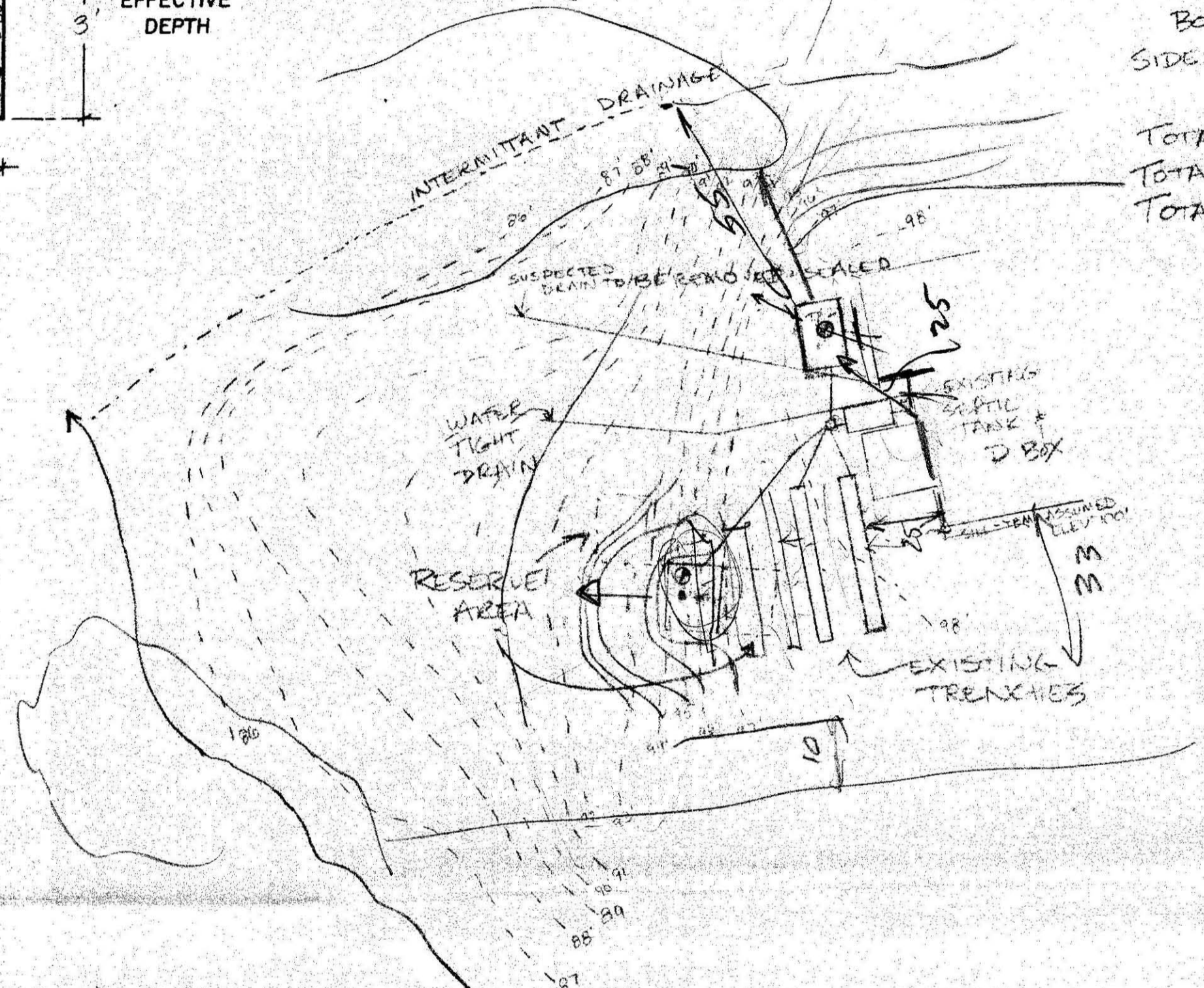
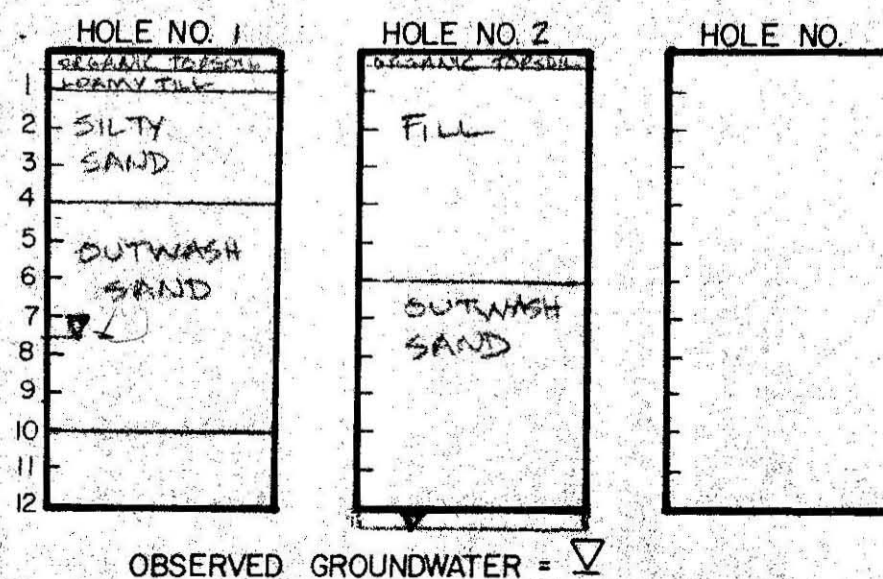

NOTES:

- LEACHING AREA TO BE 100' MIN. TO ANY WETLANDS AND WELLS.
- EXISTING SEPTIC TANK, D BOX, AND TRENCHES TO BE MAINTAINED, ~~SEPTIC TANK~~ & D BOX INLETS TO BE RAISED TO ACCOMMODATE NEW LEACHING PITS.
- NEW LEACHING PITS CAPABLE OF HANDLING 700% OF TOTAL POSSIBLE LOADINGS.
- INSTALLATION OF D BOX TO INCLUDE 4" CONCRETE TEE CEMENTED TO INLET TO PREVENT SHORT CIRCUITING OF EFFLUENT.
- RESERVE AREA AS SHOWN.
- MIN. SLOPE OF BLDG SEWER = 3/10'.
- REMOVE ALL ORGANIC MATERIAL FOR A DISTANCE OF 25' IN ALL DIRECTIONS FROM LEACHING AREA. SET PIT TOPS AT INDICATED ELEVATIONS, AND BACKFILL TO PROVIDE A MIN. OF 12" COVER, MOUNDING TO DIVERT SURFACE WATER RUNOFF.
- GARBAGE GRINDER TO BE REMOVED.
- SUSPECTED DRAIN MUST BE MOVED FROM AREA INDICATED AND REPLACED W/ WATER TIGHT PIPE W/ CEMENTED JOINTS.

SITE PLAN

SCALE: 1" = 30'

- EXISTING COUNTOUR
- PROPOSED COUNTOUR
- GROUNDWATER OBSERVATION
- PERCOLATION TEST

APPROVALS AND REVISIONS

REVISED 4/9/90

ENVIRONMENTAL SANITATION ENGINEERING ASSOCIATES
 NORWICH LAKE
 HUNTINGTON, MASS. 01050
 1-(413)-667-3180
 586-700

TITLE

SEWAGE DISPOSAL SYSTEM

FOR
 ROSEN/WOOD
 341 HULST RD.
 AMHERST, MA
 01002

FIELD 2/28/90
 DRAWN 3/1/90
 CALC.
 CHECK

DATE
 PLAN NO.

DATA REFERENCES

TYPICAL SEEPAGE PIT SECTION (NOT TO SCALE)

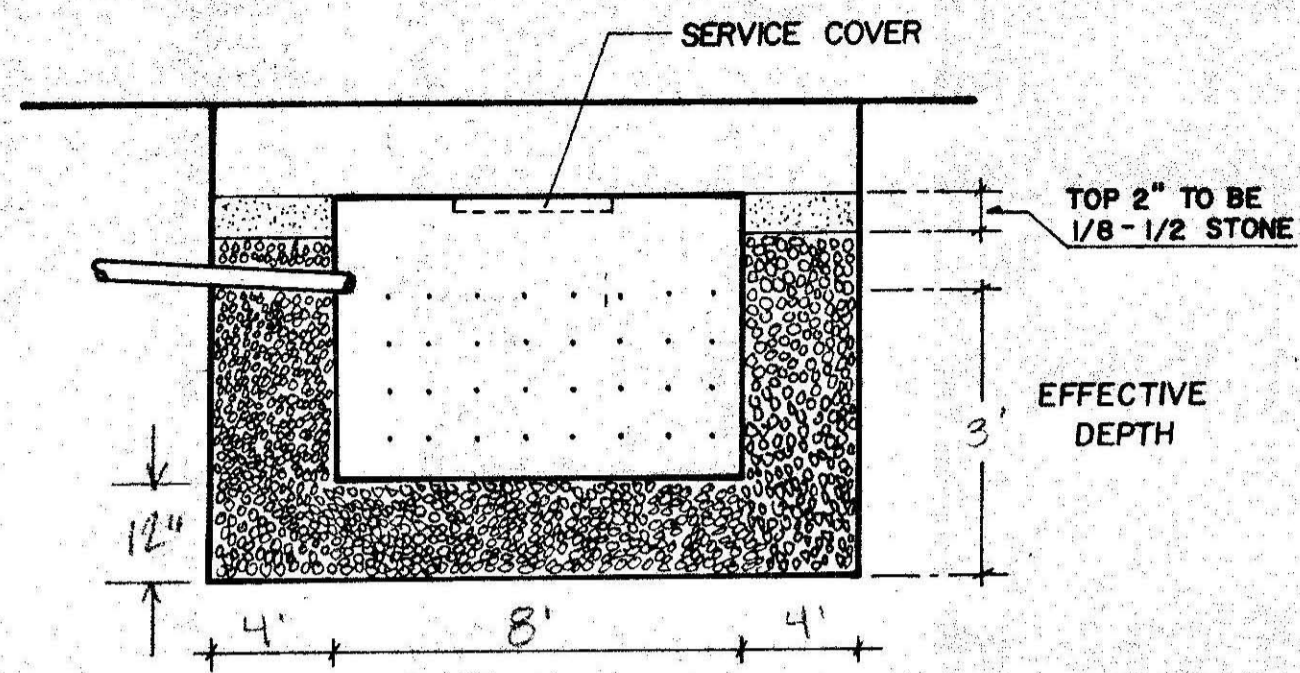

TYPICAL SYSTEM PROFILE (NOT TO SCALE)

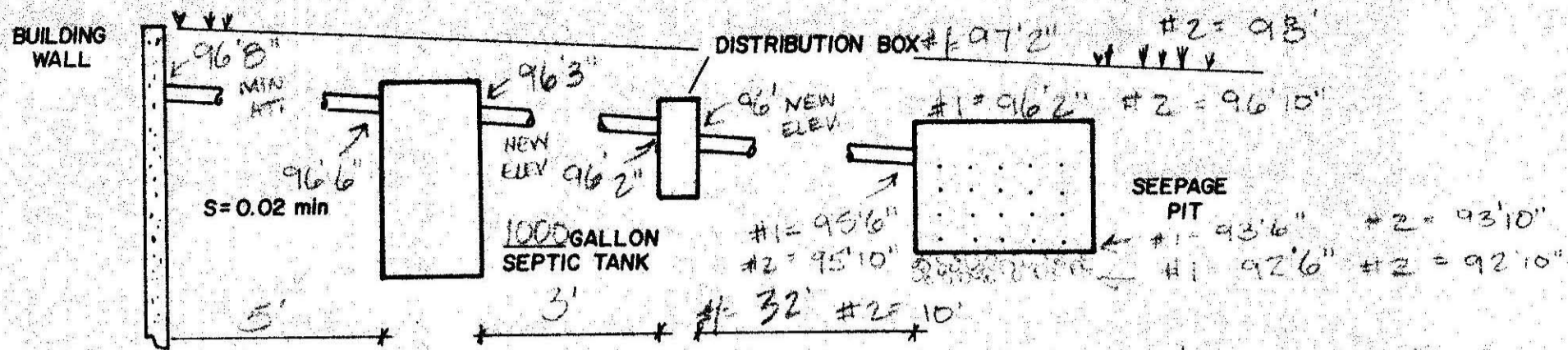

BOTTOM AREA | PIT = 13' x 16' = 208 FT²
 SIDE WALL AREA | PIT = 13' x 3' x 2' = 78 FT²
 16' x 3' x 2' = 96 FT²
 TOTAL BA = 208 FT² (2) = 416 FT²
 TOTAL SWA = 174 FT² (2) = 348 FT²
 TOTAL 2 PIT AREA = 764 FT²

CONSTRUCTION NOTES

- 2 RECTANGULAR SEEPAGE PITS.
EFFECTIVE DEPTH = 3'
EFFECTIVE SIZE = 13' x 16'
- MINIMUM OF 12" OF 3/4 - 1 1/2" STONE TO BE PLACED AROUND AND BENEATH PRECAST LINER.
- TOP 2" TO BE 1/8 TO 1/2" STONE.
- MINIMUM ON CENTER DISTANCE BETWEEN PITS SHALL BE 45'.
- BACKFILL DEPTH ABOVE PIT SERVICE COVER SHALL BE A MINIMUM OF 12".
- ALL CONSTRUCTION TO BE IN ACCORDANCE WITH TITLE V STATE ENVIRONMENTAL CODE.

PERCOLATION TEST RESULTS

PERCOLATION TEST NO.	DEPTH (INCHES)	RATE (MIN/INCH)	DATE
1	72"	5 MIN/IN	2/28/90
2	48"	< 2 MIN/IN	2/28/90

DESIGN @ 10 MIN/IN

SOIL LOGS

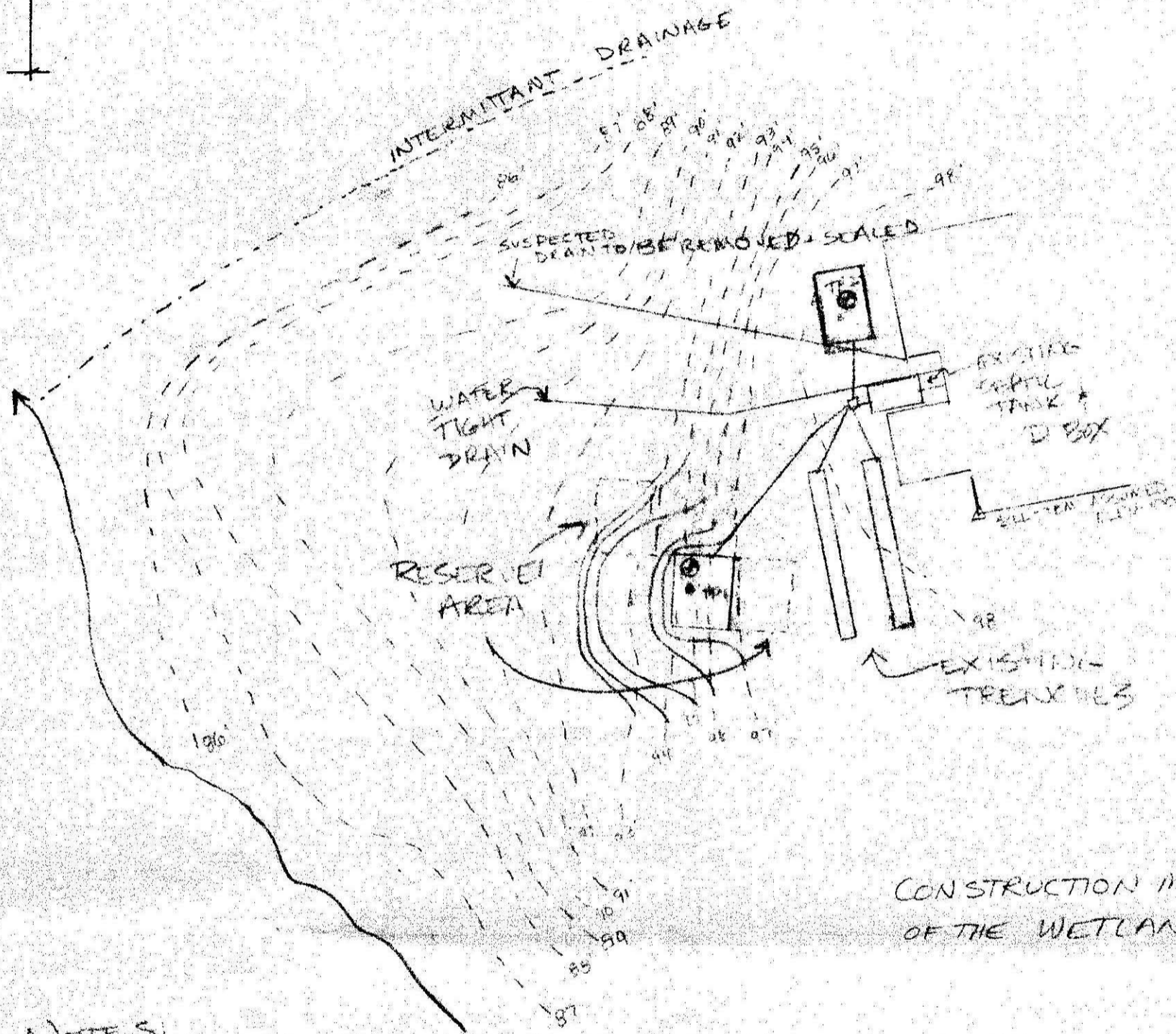
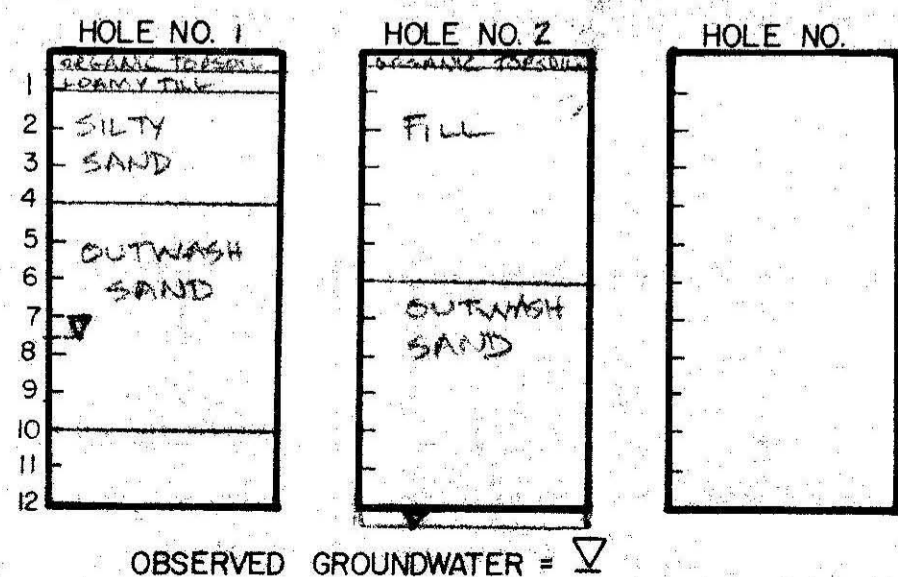

NOTES:

- LEACHING AREA TO BE 50' MIN. TO ANY WETLANDS, HULST RD SERVED BY TOWN H₂O. : NOWELLS
- EXISTING SEPTIC TANK, D BOX, AND TRENCHES TO BE MAINTAINED, IT IS NECESSARY D BOX INLET, TO BE RAISED TO ACCOMMODATE NEW LEACHING PITS
- NEW LEACHING PITS CAPABLE OF HANDLING 700% OF TOTAL POSSIBLE LOADING
- INSTALLATION OF D BOX TO INCLUDE 4" PLASTIC TEE CEMENTED TO INLET TO PREVENT SHORT CIRCUITING OF EFFLUENT
- RESERVE AREA AS SHOWN.
- MIN. SLOPE OF BLDG SEWER = 3'/10'
- REMOVE ALL ORGANIC MATERIAL FOR A DISTANCE OF 25' IN ALL DIRECTIONS FROM LEACHING AREA. SET PIT TOPS AT INDICATED ELEVATIONS, AND BACKFILL TO PROVIDE A MIN. OF 12" COVER, MOUNDING TO DIVERT SURFACE WATER RUNOFF
- GARBAGE GRINDER TO BE REMOVED
- SUSPECTED DRAIN MUST BE MOVED FROM AREA INDICATED AND REPLACED W/ WATER TIGHT PIPE W/ CEMENTED JOINTS.

SITE PLAN

SCALE: 1" = 30'

- EXISTING COUNTOUR
- PROPOSED COUNTOUR
- GROUNDWATER OBSERVATION
- PERCOLATION TEST

APPROVALS AND REVISIONS

REVISED	4/9/90
	5/7/90
	5/15/90

ENVIRONMENTAL SANITATION
ENGINEERING ASSOCIATES

NORWICH LAKE
HUNTINGTON, MASS. 01050
1-(413)-667-3180
586700

TITLE

SEWAGE DISPOSAL
SYSTEM

FOR

ROSEN/WOOD
34 HULST RD.
AMHERST, MA
01002

FIELD 2/28/90
DRAWN 3/1/90
CALC.
CHECK

DATE
PLAN NO.

DATA REFERENCES

Revised
Revised
5/15/90
5/7/90
5/15/90