

OCT 3 1990

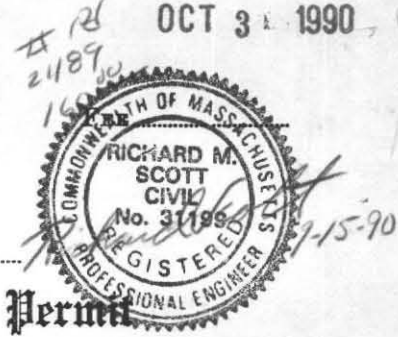

#599

No. 90-12

THE COMMONWEALTH OF MASSACHUSETTS
BOARD OF HEALTH

Inspected on TOWN OF AMHERST

Application for Disposal Works Construction Permit

Application is hereby made for a Permit to Construct () or Repair (✓) an Individual Sewage Disposal System at:

599 EAST LEVERETT ROAD
Location - Address
MARVIN SPENCE
Owner
P.O. Box 506 AMHERST, MA. 01004
or Lot No. Address

Type of Building _____ Size Lot ~150,000 Sq. feet
Dwelling (✓) No. of Bedrooms 7 Expansion Attic (✓) Garbage Grinder (✓)
Other — Type of Building _____ No. of persons _____ Showers () — Cafeteria ()
Other fixtures _____

Design Flow 110 gallons per person per day. Total daily flow 770 gallons.
Septic Tank (✓) Liquid capacity 1500 gallons Length 126 Width 60 Diameter — Depth 67
Disposal Trench — No. _____ Width _____ Total Length _____ Total leaching area _____ sq. ft.
Seepage Pit No. _____ Diameter _____ Depth below inlet _____ Total leaching area _____ sq. ft.

Other Distribution box () Dosing tank ()
Percolation Test Results Performed by F. F. W. R. S. WITNESS D. ZAROZINSKI B.S.H. Date 9-7-90
Test Pit No. 1 2 minutes per inch Depth of Test Pit 138 Depth to ground water DRY
Test Pit No. 2 _____ minutes per inch Depth of Test Pit _____ Depth to ground water _____

Description of Soil TO 12" TOPSOIL; TO 30" SUBSOIL; TO 44" COARSE SAND GRAVEL; TO 138" DEPTH SILT.

Nature of Repairs or Alterations — Answer when applicable REPLACE WITH NEW SEWER LINE, SEPTIC TANK AND LEACH FACILITY.

Agreement:
The undersigned agrees to install the aforescribed Individual Sewage Disposal System in accordance with the provisions of TITLE 5 of the State Environmental Code — The undersigned further agrees not to place the system in operation until a Certificate of Compliance has been issued by the board of health.

Signed Marvin Spence 10/3/90
Application Approved By Carol Zagorin for A.H.D. 10/3/90
Application Disapproved for the following reasons: _____

Permit No. 90-12 Issued 10/3/90 Date

THE COMMONWEALTH OF MASSACHUSETTS
BOARD OF HEALTH

TOWN OF AMHERST
Certificate of Compliance

THIS IS TO CERTIFY, That the Individual Sewage Disposal System constructed () or Repaired (✓) by _____ at 599 EAST LEVERETT ROAD has been installed in accordance with the provisions of TITLE 5 of The State Environmental Code as described in the application for Disposal Works Construction Permit No. 90-12 dated 10/3/90

THE ISSUANCE OF THIS CERTIFICATE SHALL NOT BE CONSTRUED AS A GUARANTEE THAT THE SYSTEM WILL FUNCTION SATISFACTORY.

DATE Nov 21, 1990 Inspector Carol Zagorin

THE COMMONWEALTH OF MASSACHUSETTS
BOARD OF HEALTH

No. 90-12 TOWN OF AMHERST FEE 160.00

Disposal Works Construction Permit

Permission is hereby granted MARVIN SPENCE to Construct () or Repair (✓) an Individual Sewage Disposal System at No. 599 EAST LEVERETT ROAD

as shown on the application for Disposal Works Construction Permit No. 90-12 Dated 10/3/90

DATE 10/3/90 Carol Zagorin for A.H.D. Board of Health

CHECK OR FILL IN WHERE APPLICABLE

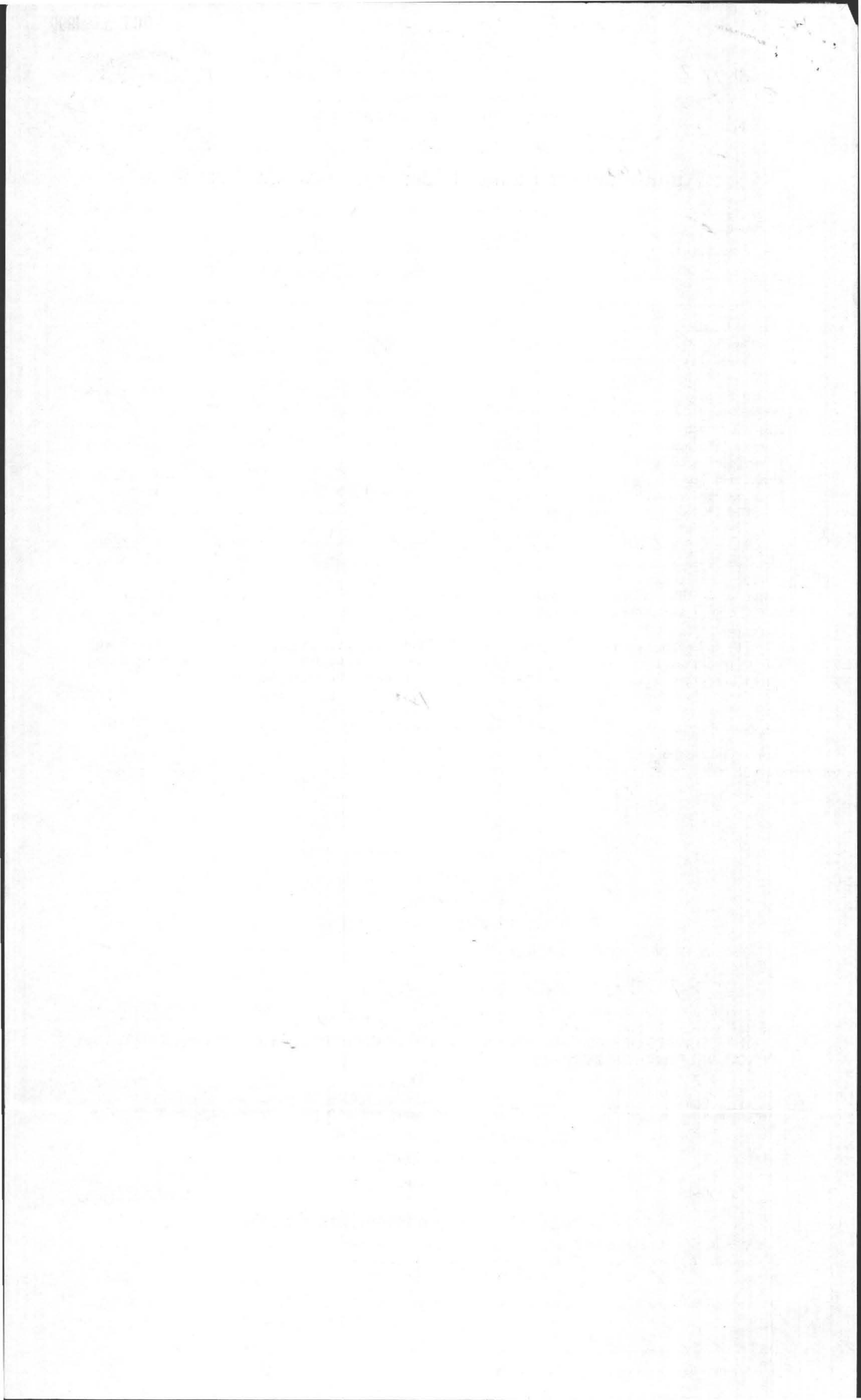

160.00
pd.

90-12

TOWN OF AMHERST

PERC TEST DATA SHEET

Repair: 7 Bedrooms

DATE 9/7/90 LOCATION 599 E Leverett Road LOT SIZE 3 1/2 +- A

OWNER MARVIN SPENCE ADDRESS P.O. Box 506 TELE # 253 5384

P.E./RS Fred Filios FIRM Filios Eng. 01004 OBSERVED BY David Zampini

BACK HOE OPERATOR _____ BENCH MARK _____

PERC DEPTH 40" PRE SOAK TIME _____ PERC DEPTH _____ PRE SOAK TIME _____

TEST _____
_____ CAN'T HOLD _____
_____ _____
_____ _____

RATE (2) RATE _____

①

TOP 12	TOP
SUB 30	SUB
Coarse sand gravel 9/2	
Silt 11/2	

TOP	TOP
SUB	SUB

TOP	TOP
SUB	SUB

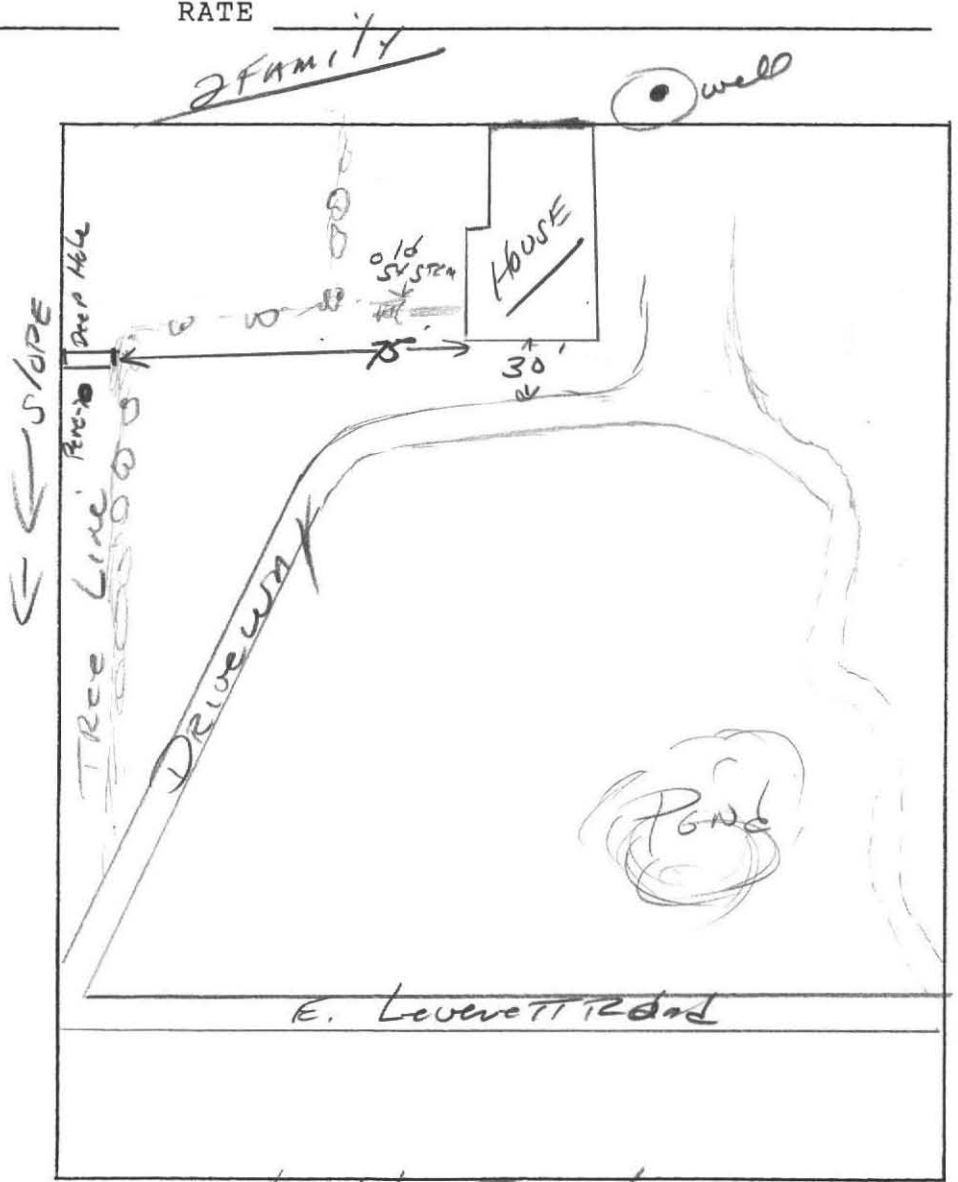

NOTE → Should Replace Tank

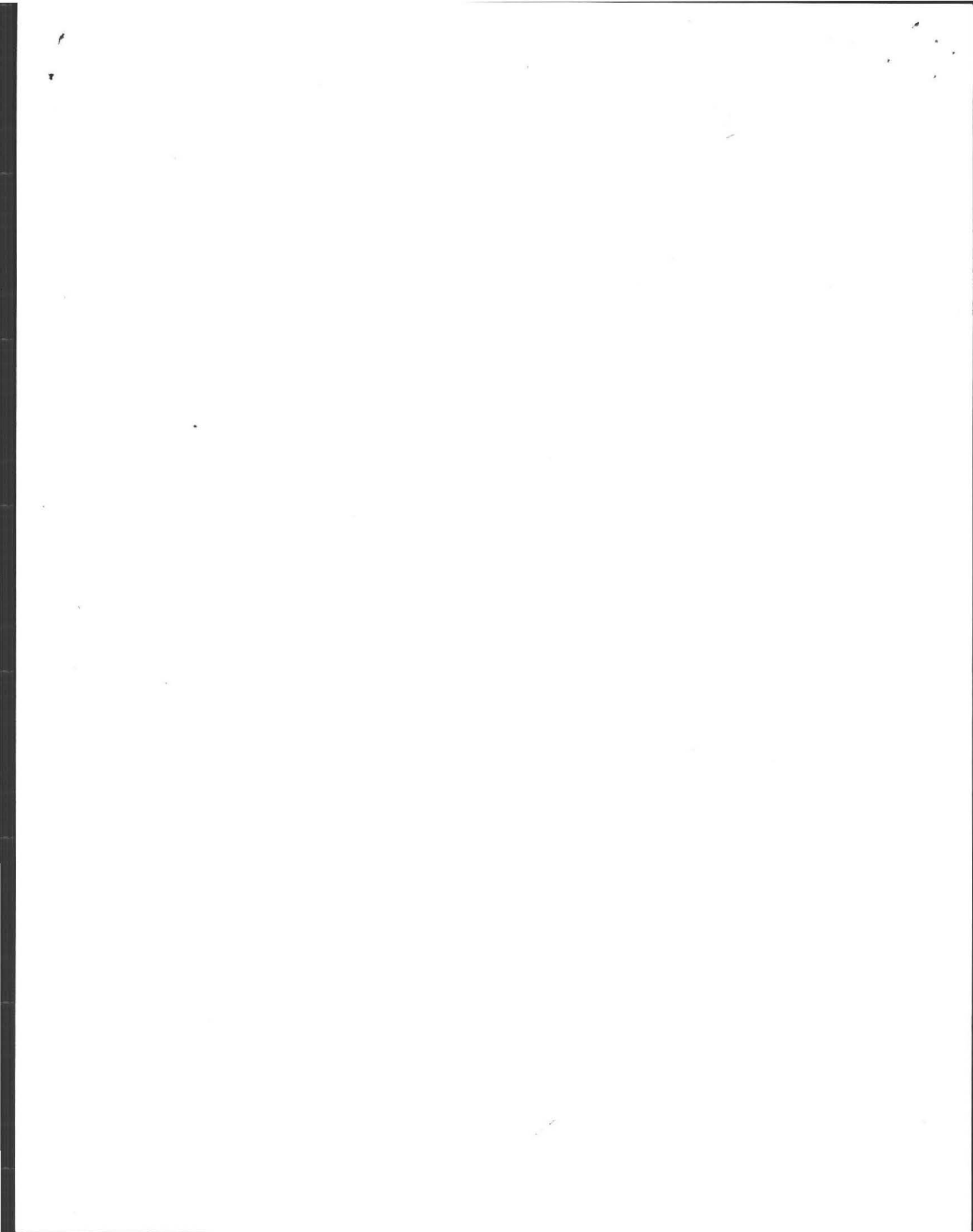

OCT 01 1990

WELL SERVING THIS PROPERTY
MAINTAIN 150' MIN. WELL TO LEACH PITS

FINISH CONTOURS APPROXIMATE EXISTING

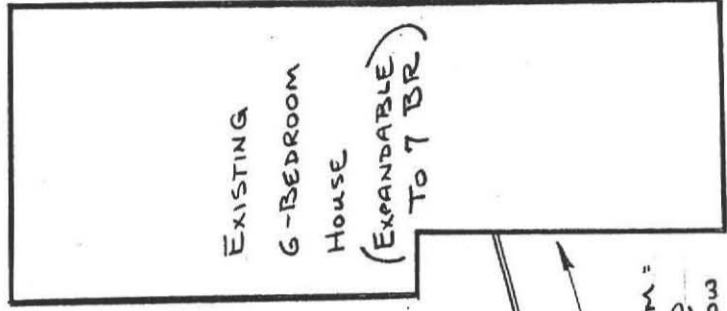

NEW 1500-GAL SEPTIC TANK

100.00' DATUM = TOP OF WELL @ CELLAR WINDOW

EXISTING SEPTIC TANK TO BE DISCONTINUED CRUSHED & BURIED IN PLACE.

EXISTING FARM POND ~190' FROM LEACH PIT LOCATION.

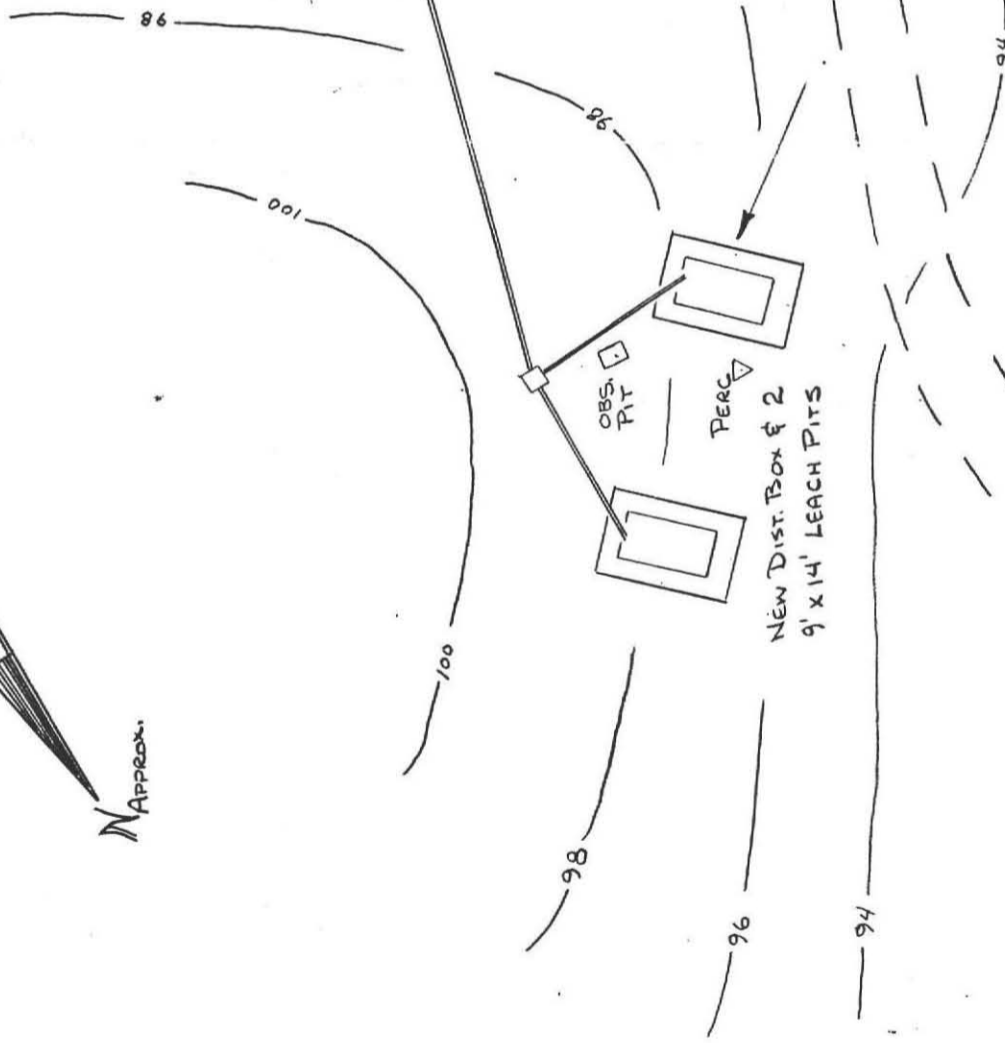

NEW DIST. BOX & 2 9' x 14' LEACH PITS

OBS. PIT

PERC



SEPTIC SYSTEM DESIGN

AT 599 EAST LEVERETT RD. AMHERST

APPROVED BY:

SCALE: 1"=20'

DATE: 9-22-90

DRAWN BY RMS

REVISOR ADDED DATUM NOTE 9-26-90

FOR: MARVIN SPENCE
BY: RICHARD SCOTT, P.E.

DRAWING NUMBER

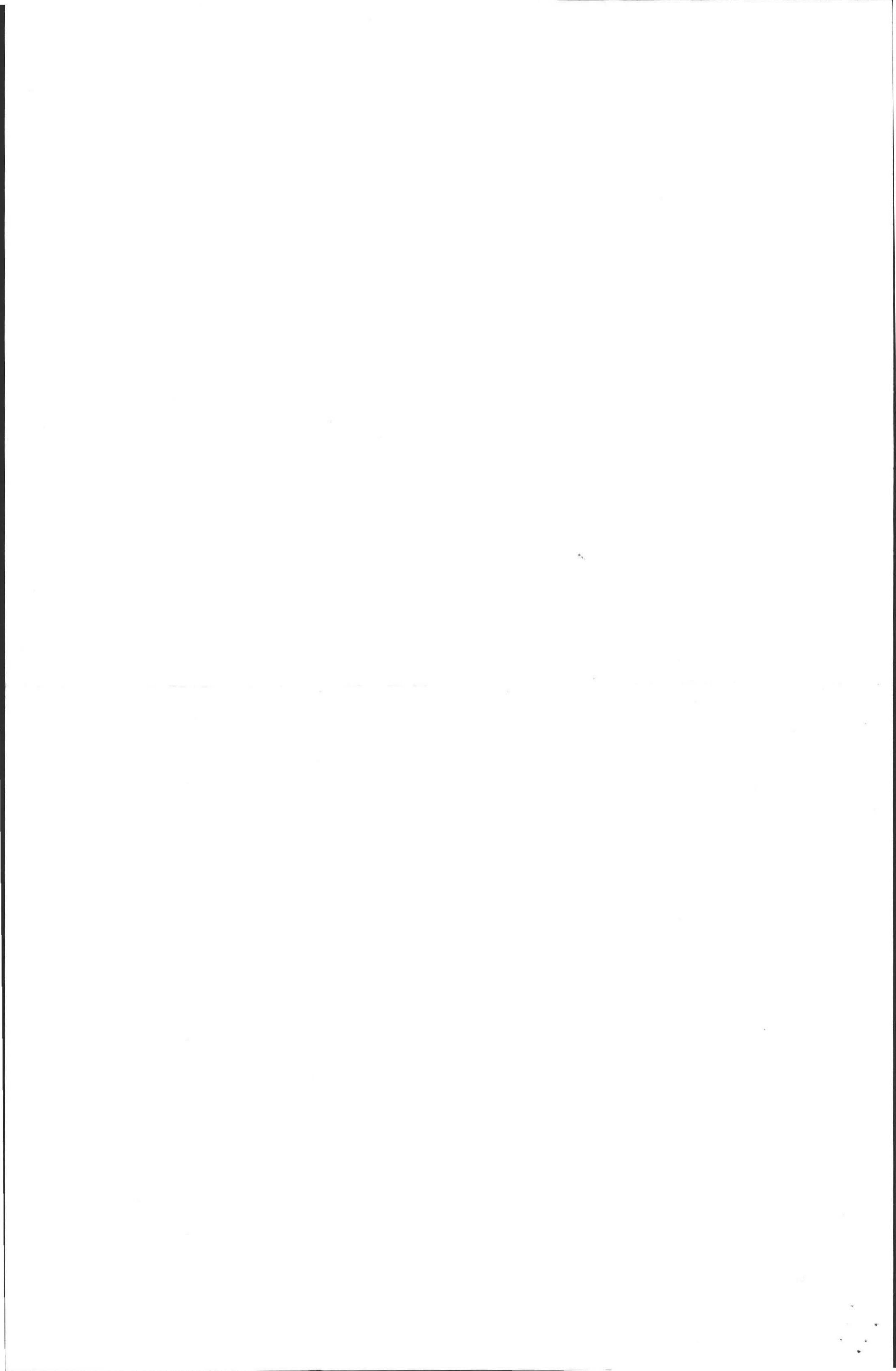

SYSTEM DESIGN CALCULATIONS

7 BEDROOM x 110 GAL. PER BR PER DAY =
= 770 GAL. PER DAY DESIGN FLOW.

MINIMUM EFFECTIVE SEPTIC TANK VOLUME = 1.5 x 770 = 1155 GAL.

SPECIFIED TANK VOLUME FOR THIS INSTALLATION = 1500 GAL.

PERCOLATION RATE = 2 MINUTES PER INCH →

DESIGN LOADING = 2.50 GPD PER SQ. FT. OF EFFECTIVE
SIDEWALL & 100 GPD PER SQ. FT. OF BOTTOM AREA.

SPECIFIED 2 LEACH PITS ARE 9.0 FT. WIDE x 14.0 FT. LONG
x 3.5 FT. EFFECTIVE DEPTH

CONCRETE DRYWELL TANKS ARE 5 FT. WIDE x 10 FT. LONG
x 2 FT. DEPTH BELOW INLET.

ALLOWABLE LOADING = $[2(9+14) \times 3.5 \times 2.50 + 9 \times 14 \times 1.00] \times 2$ PITS
= 1,057 GALLONS PER DAY

MINIMUM FOR AMHERST = 1.25 x TITLE 5 = 1.25 x 770 = 962 GPD

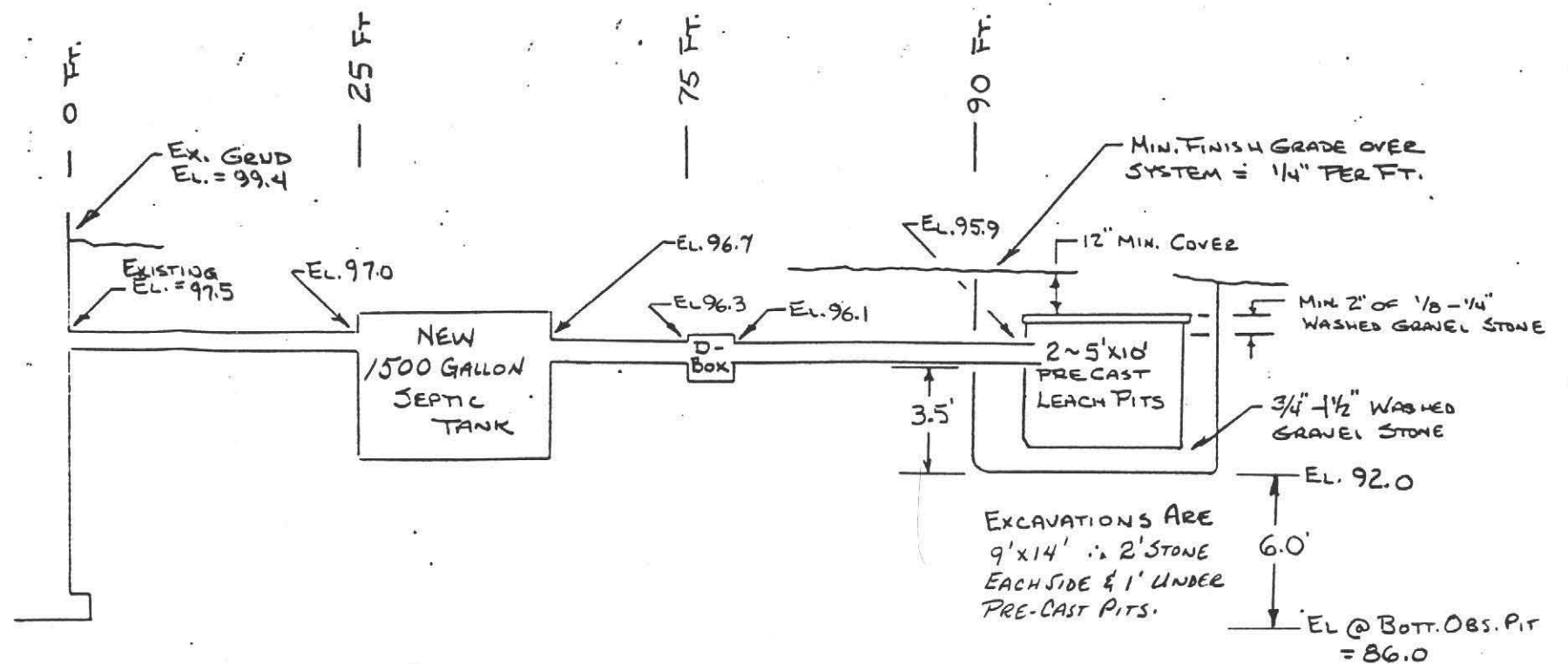

SYSTEM PROFILE - SECTION PARALLEL TO FLOW
(NOT TO SCALE)

Richard M. Scott
9-22-90
RICHARD M. SCOTT
CIVIL
No. 31199
REGISTERED
PROFESSIONAL ENGINEER
1-508-544-2511

SEPTIC SYSTEM DESIGN		
AT 599 EAST LEVERETT ROAD		
SCALE: N.T.S.	APPROVED BY:	DRAWN BY RMS
DATE: 9-22-90		REVISED
FOR: MARVIN SPENCE		
BY: RICHARD SCOTT, P.E.		
		DRAWING NUMBER

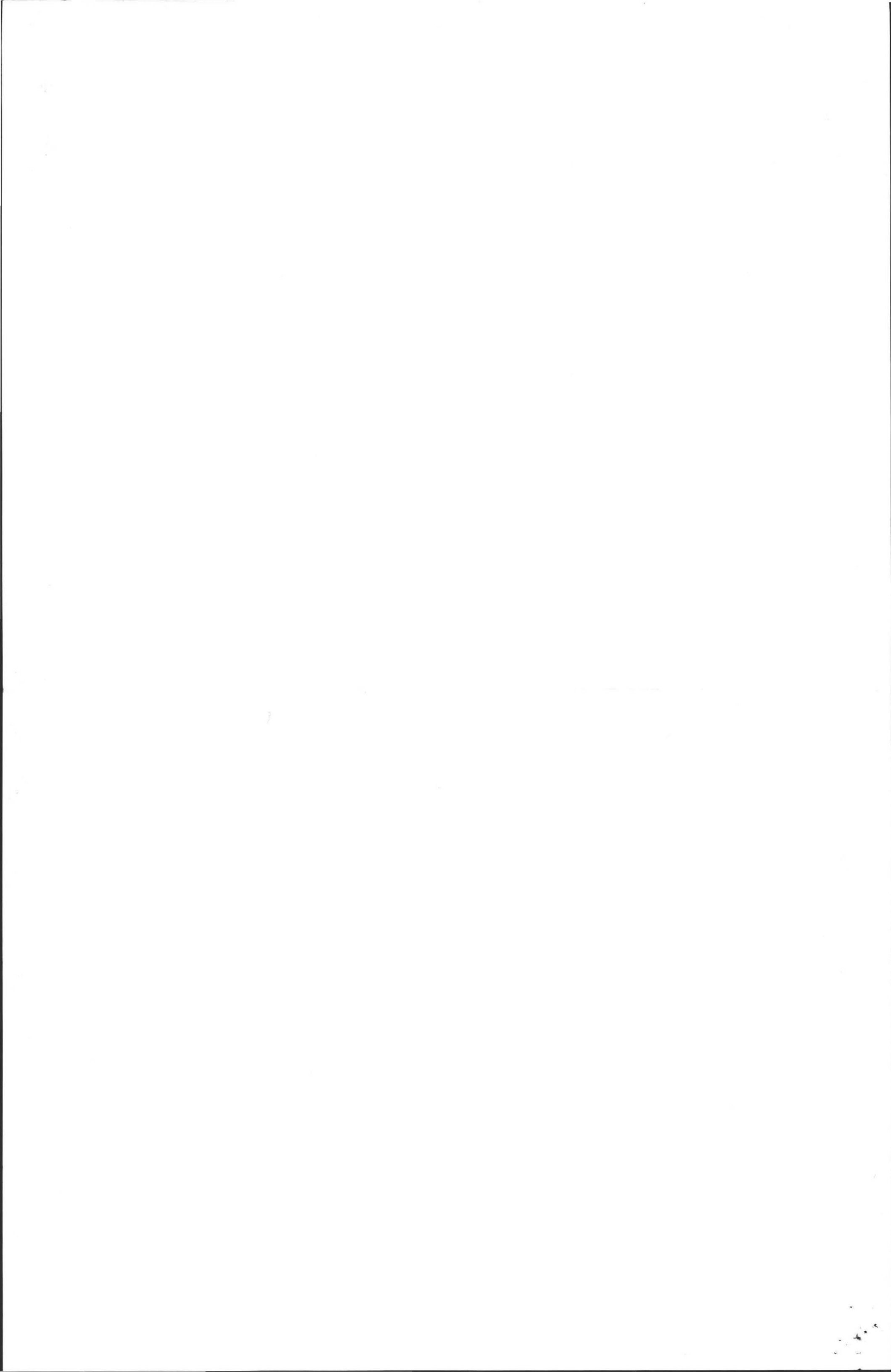

REPAIR SEPTIC SYSTEM
599 EAST LEVETT RD

INSPECTED ON
wed NOV 21, 1990
David Pagulka

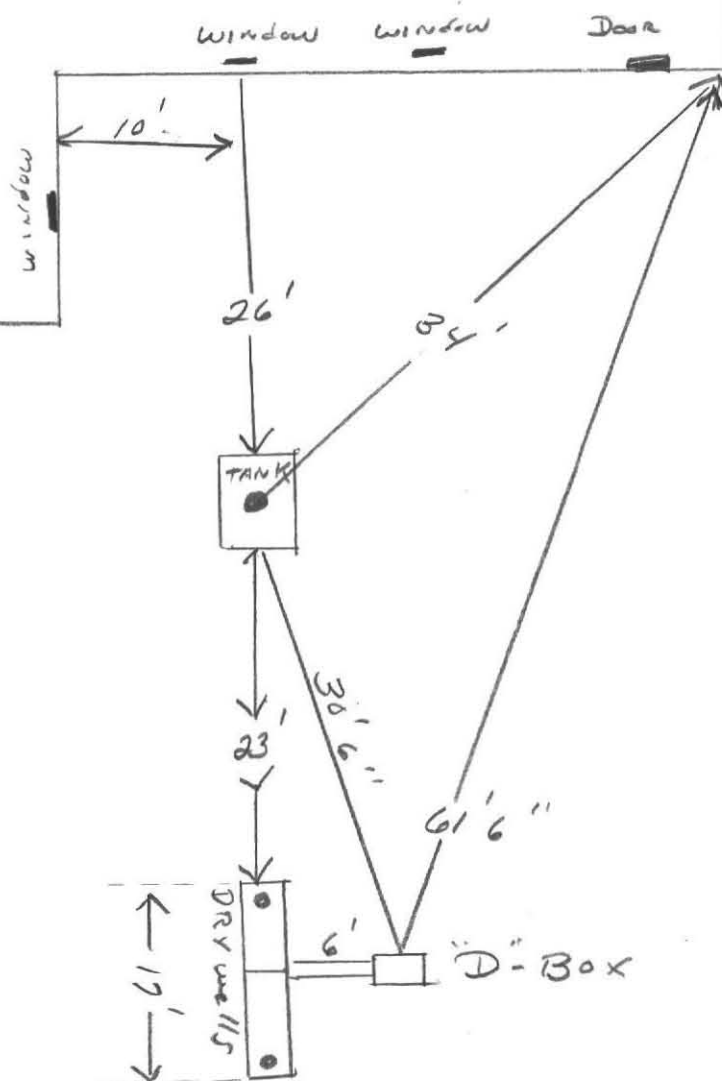

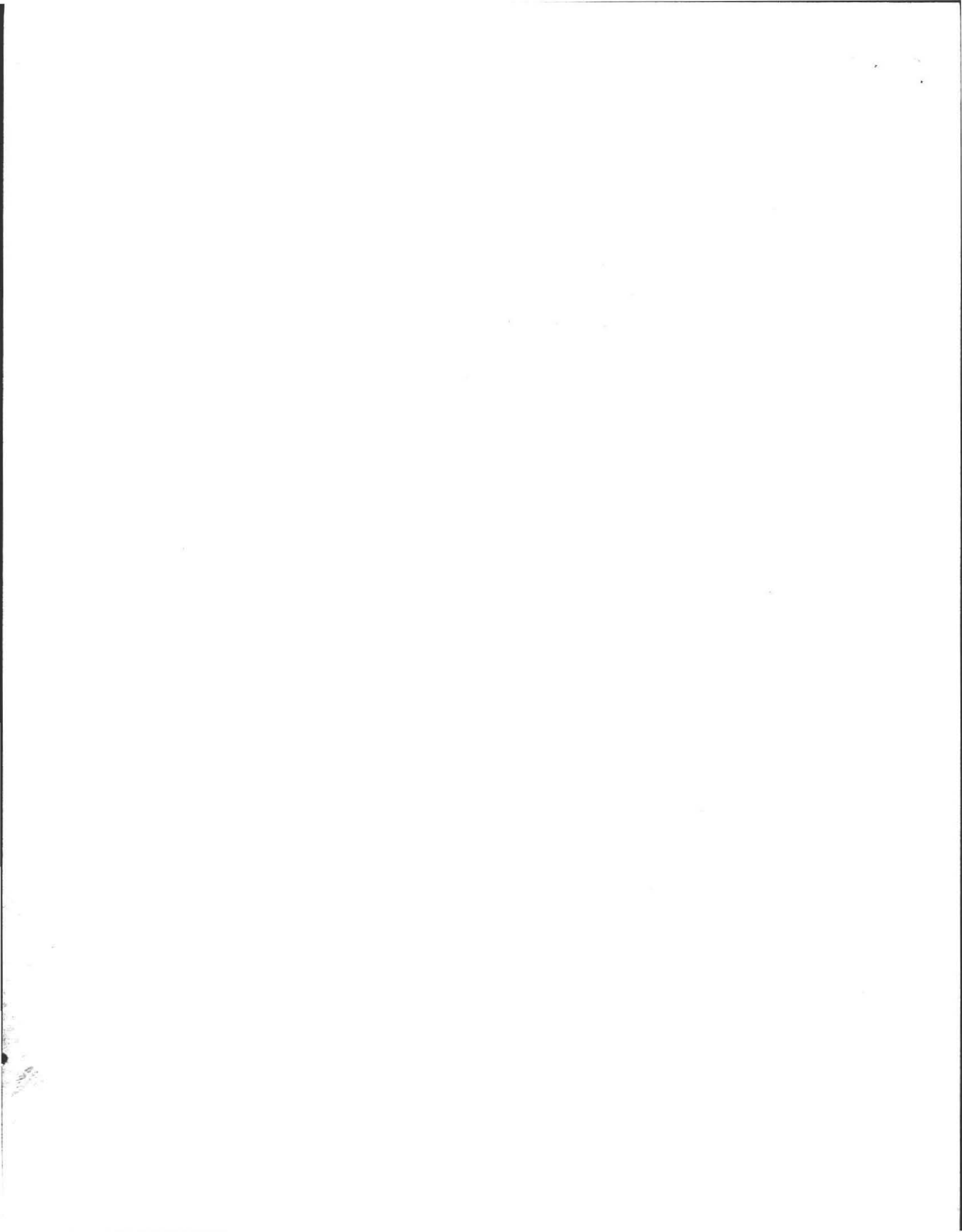

NOV 21 1990

Richard Scott, P.E.
31 Shutesbury Road
Pelham, Ma. 01002

November 19, 1990

David Zarozinski
Amherst Board of Health
Bangs Community Center
Amherst, Ma. 01002

Subject: Septic System Design for Marvin Spence

Dear David:

On November 17, 1990, after notification by John Stanley of C & J Excavating, I completed an as-built inspection of the subject septic system. Enclosed for your records is a marked up copy of the original plan showing those areas where actual differs from plan.

The following items need to be completed for your final review before C & J covers the system:

1. Connect SDR-35 pipe from the distribution box to the southerly of the two leach pit tanks.
2. Complete final setting of the northerly leach pit tank and connect SDR-35 pipe from the distribution box so that elevations match the southerly tank.
3. Finish filling the leach pit around the tanks with 3/4 - 1 1/2" stone and cover with 2" of 1/8"-1/4" stone.

In total the construction appears to be in compliance with Massachusetts Title 5 and Amherst supplemental regulations. After satisfactory completion of the above items, I recommend your acceptance of the installation. If you have further questions regarding this design or the inspection please call me.

Sincerely,



Richard Scott, P.E.

cc Marvin Spence
John Stanley, C & J Excav.

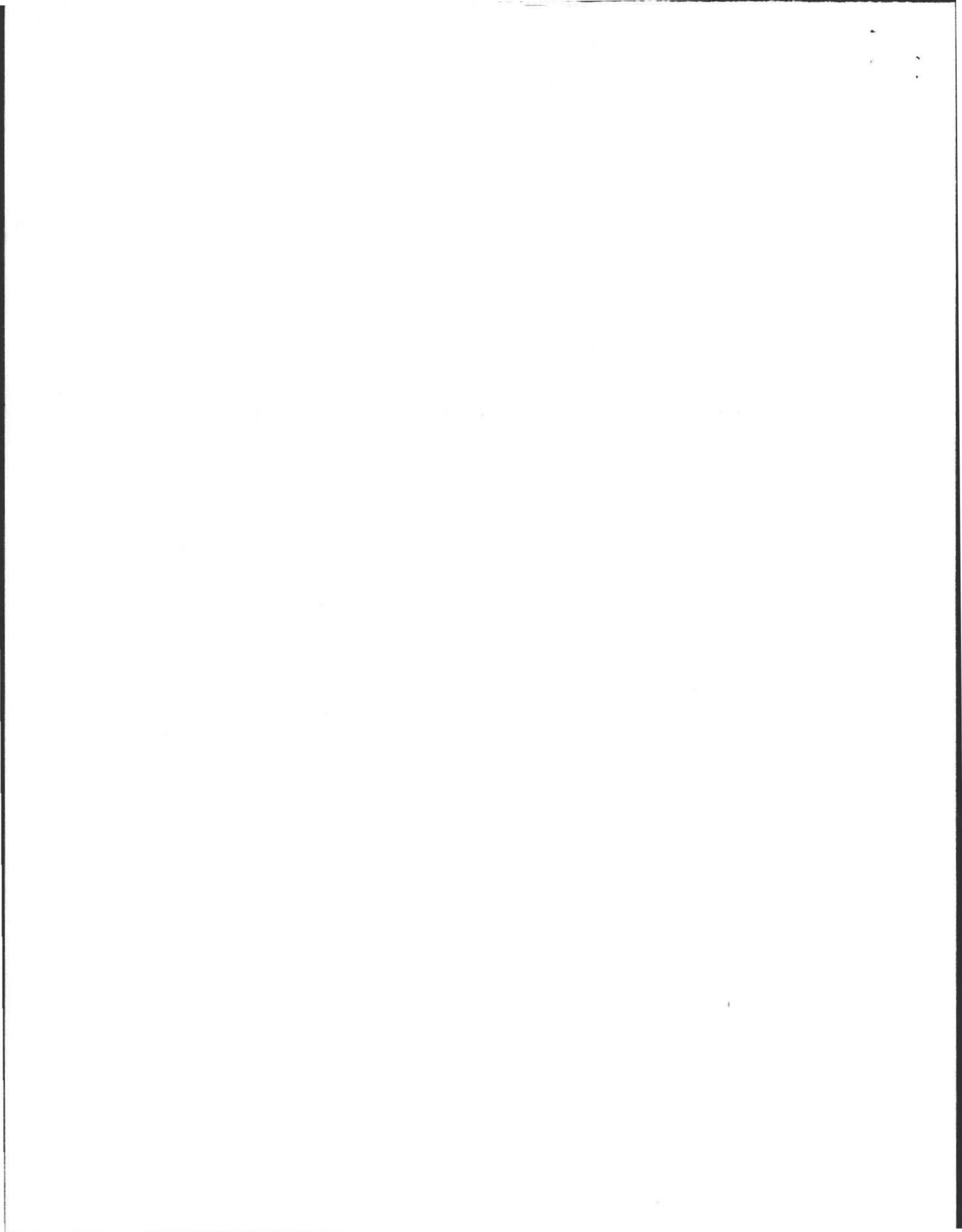

No.

THE COMMONWEALTH OF MASSACHUSETTS

BOARD OF HEALTH

TOWN OF AMHERST



Application for Disposal Works Construction Permit

Application is hereby made for a Permit to Construct () or Repair (✓) an Individual Sewage Disposal System at:

599 EAST LEVERETT ROAD

Location - Address

MARVIN SPENCE

Owner

P.O. Box 506 AMHERST MA, 01004

or Lot No.

Address

Installer

Address

Type of Building

Size Lot ~ 150,000 Sq. feet

Dwelling ✓ No. of Bedrooms 7 Expansion Attic (No)

Garbage Grinder (No)

Other - Type of Building No. of persons Showers () - Cafeteria ()

Other fixtures

Design Flow 110 gallons per person per day. Total daily flow 770 gallons.

NEW Septic Tank ✓ Liquid capacity 1500 gallons Length 126" Width 68" Diameter - Depth 67"

Disposal Trench - No. Width Total Length Total leaching area sq. ft.

Seepage Pit No. Diameter Depth below inlet Total leaching area sq. ft.

Other Distribution box () Dosing tank ()

Percolation Test Results Performed by F. Filios, R.S. Witness: D. Zarozinsky, B.A.H. Date 9-7-90

Test Pit No. 1 2 minutes per inch Depth of Test Pit 138" Depth to ground water DRY

Test Pit No. 2 minutes per inch Depth of Test Pit Depth to ground water

Description of Soil TO 12" TOPSOIL; TO 30" SUBSOIL; TO 114" COARSE SAND GRAVEL; TO 138" DEPTH SILT.

Nature of Repairs or Alterations - Answer when applicable. REPLACE WITH NEW SEWER LINE, SEPTIC TANK AND LEACH FACILITY

Agreement:

The undersigned agrees to install the aforescribed Individual Sewage Disposal System in accordance with the provisions of TITLE 5 of the State Environmental Code - The undersigned further agrees not to place the system in operation until a Certificate of Compliance has been issued by the board of health.

Signed _____ Date _____

Application Approved By _____ Date _____

Application Disapproved for the following reasons: _____ Date _____

Permit No. _____ Issued _____ Date _____

THE COMMONWEALTH OF MASSACHUSETTS

BOARD OF HEALTH

OF

Certificate of Compliance

THIS IS TO CERTIFY, That the Individual Sewage Disposal System constructed () or Repaired () by _____ Installer _____

at _____ has been installed in accordance with the provisions of TITLE 5 of The State Environmental Code as described in the application for Disposal Works Construction Permit No. _____ dated _____

THE ISSUANCE OF THIS CERTIFICATE SHALL NOT BE CONSTRUED AS A GUARANTEE THAT THE SYSTEM WILL FUNCTION SATISFACTORY.

DATE _____ Inspector _____

CHECK OR FILL IN WHERE APPLICABLE

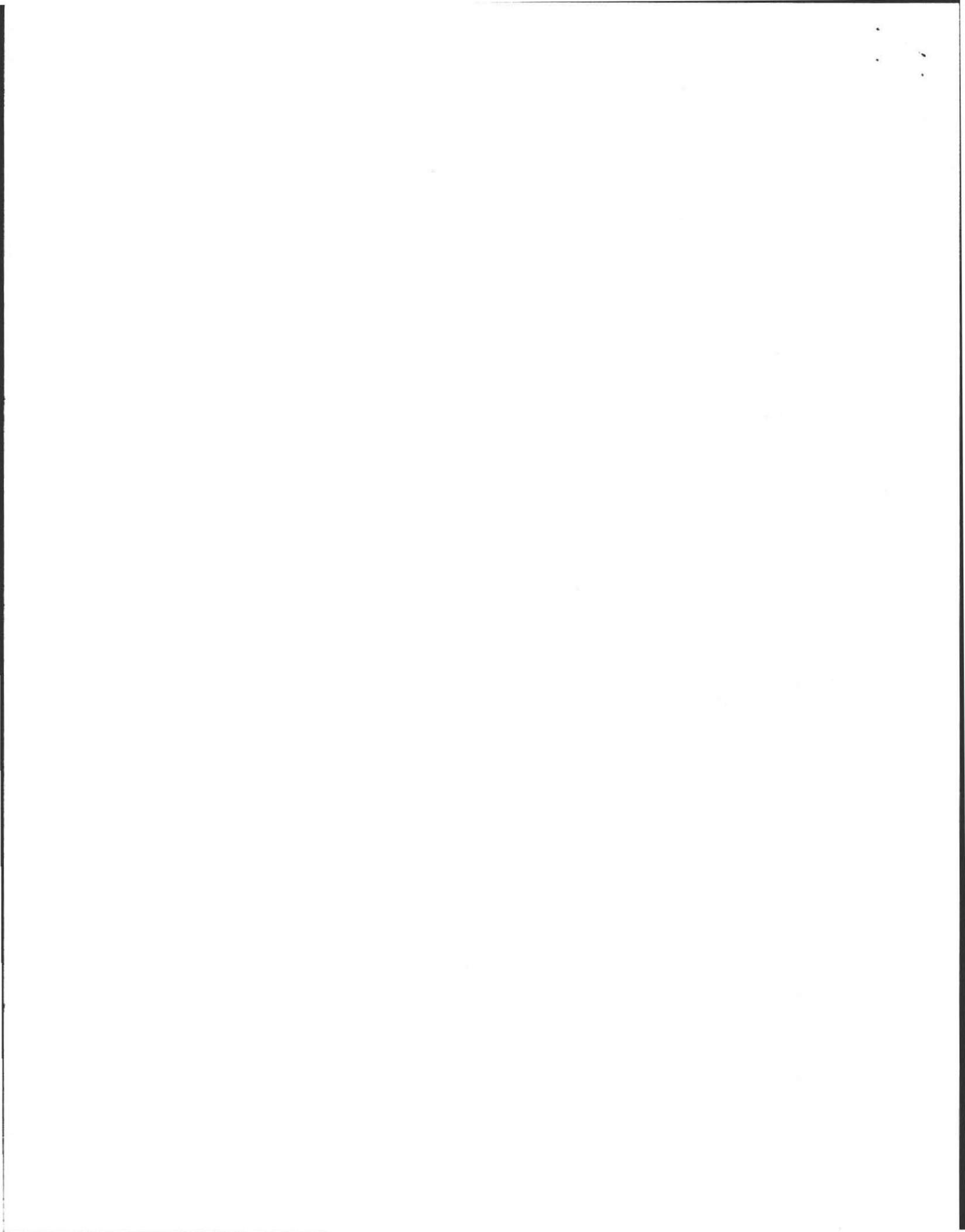

SYSTEM DESIGN CALCULATIONS

7 BEDROOM X 110 GAL. PER BR PER DAY = 770 GAL. PER DAY DESIGN FLOW.
 MINIMUM EFFECTIVE SEPTIC TANK VOLUME = $15 \times 770 = 1155$ GAL.
 SPECIFIED TANK VOLUME FOR THIS INSTALLATION = 1500 GAL.
 PERCOLATION RATE = 2 MINUTES PER INCH →
 DESIGN LOADING = 2.50 GPD PER SQ. FT. OF EFFECTIVE SIDEWALL & 100 GPD PER SQ. FT. OF BOTTOM AREA.
 SPECIFIED 2 LEACH PITS ARE 9.0 FT. WIDE X 14.0 FT. LONG X 3.5 FT. EFFECTIVE DEPTH
 CONCRETE DRYWELL TANKS ARE 5 FT. WIDE X 10 FT. LONG X 2 FT. DEPTH BELOW INLET.
 ALLOWABLE LOADING = $[2(9+14) \times 3.5 \times 2.50 + 9 \times 14 \times 1.00] \times 2$ PITS
 = 1057 GALLONS PER DAY

Minimum For Amherst = $1.25 \times \text{TITLE 5} = 1.25 \times 770 = 962$ GPD

ACTUAL PIT CONSTRUCTION IS ONE EXCAVATION 12' X 26' w/ 2- CONCRETE TANKS EACH 5' X 10'.

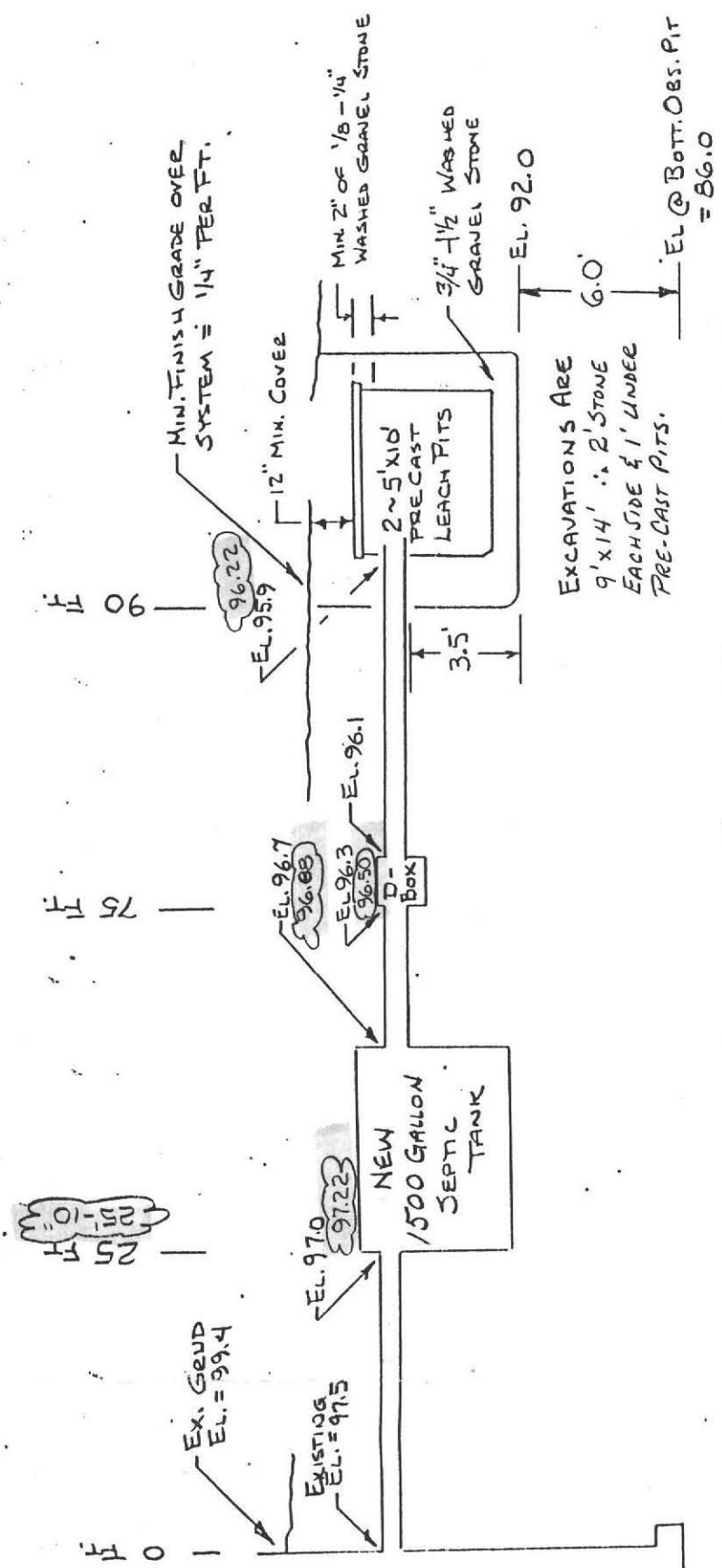

SYSTEM PROFILE ~ SECTION PARALLEL TO FLOW
 (NOT TO SCALE)

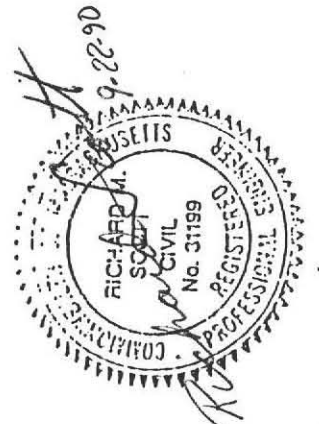

SEPTIC SYSTEM DESIGN	
AT 599 EAST LEVERETT ROAD	
SCALE: N.T.S.	APPROVED BY:
DATE: 9-22-90	
DRAWN BY RMS	
REVISED 11-17-90	
ADDED 11-17-90	
FOR: MARVIN SPENCE	
BY: RICHARD SCOTT, P.E.	
DRAWING NUMBER	



WELL SERVING THIS PROPERTY

MAINTAIN 150' MIN. WELL TO LEACH PITS

AS-BUILT 2135' IS IN ACCORDANCE W/ CURRENT REGULATIONS

FINISH CONTOURS APPROXIMATE EXISTING

AS-BUILT CONDITIONS SHOWN IN "CLOUDS" ARE PER INSPECTION ON 11-17-90

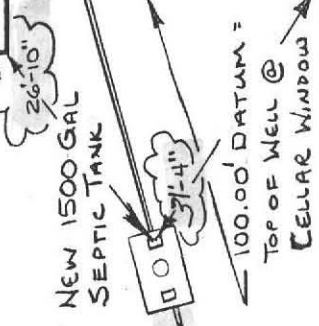

EXISTING SEPTIC TANK TO BE DISCONTINUED CRUSHED & BURIED IN PLACE.

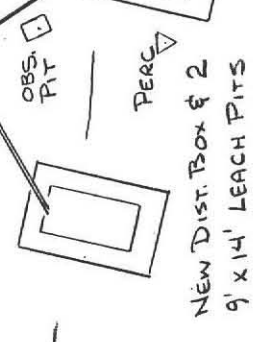
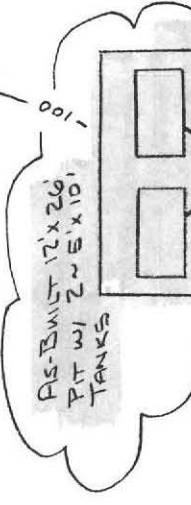

EXISTING FARM POND ~190' FROM LEACH PIT LOCATION.

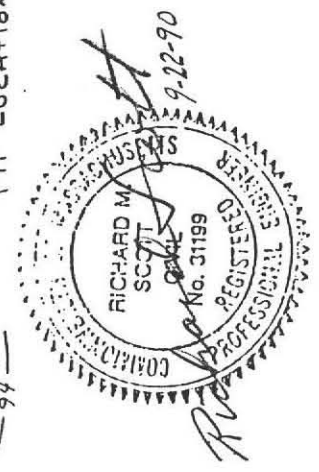

SEPTIC SYSTEM DESIGN

AT 599 EAST LEVERETT RD. AMHERST

SCALE: 1" = 20'

DATE: 9-22-90

DRAWN BY RMS

REVISED 9-26-90 ADDED DATUM NOTE

11-17-90 ADDED AS-BUILTS

APPROVED BY:
FOR: MARVIN SPENCE
BY: RICHARD SCOTT, P.E.

DRAWING NUMBER

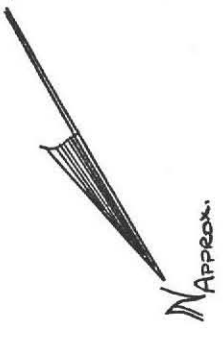

DRIVEWAY ACCESS

