

**BOARD OF HEALTH, AMHERST, MASSACHUSETTS  
APPLICATION FOR DISPOSAL WORKS CONSTRUCTION PERMIT**

No. 73-17 Date 4/26/73 Fee \$3.00 Date Rec'd. 4/26/73 By DGF

Application is hereby made for a permit to Construct (X) or Repair ( ) an Individual Sewage Disposal System at:

Location—Address 52 Chapel Road or Lot No. 7  
 Owner Saunders & Roberge Address Bay Rd. Amherst MA  
 Contractor \_\_\_\_\_ Address \_\_\_\_\_  
 Type of Building Dwelling Dimensions 32x57' Size Lot 30,058 sq  
 Dwelling—No. of Bedrooms 3 Expansion Attic (✓) Garbage Grinder (yes)  
 Other \_\_\_\_\_ No. of persons 1 Showers (1)

Other fixtures \_\_\_\_\_  
 Town Water? yes Type of Well \_\_\_\_\_

Design Flow 50 gallons per person per day. Total daily flow 300 gallons  
 Septic Tank—Liquid capacity 1000 gallons Dimensions: L 8 W 4 D 4 1/2  
 Disposal Trench—No. \_\_\_\_\_ Width \_\_\_\_\_ Total Length \_\_\_\_\_ Total leaching area \_\_\_\_\_ sq. ft.  
 Disposal Bed—No. \_\_\_\_\_ Diameter \_\_\_\_\_ Depth below inlet \_\_\_\_\_ Total leaching area \_\_\_\_\_ sq. ft.  
 Dry Well—No. 1 Diameter 10x10 Depth below inlet 2 1/2 Dimensions: \_\_\_\_\_ x \_\_\_\_\_ x area 500 sq. ft.

Other: Distribution box ( ) No. \_\_\_\_\_ Dosing tank ( ) \_\_\_\_\_  
 (Depth of Soil Line Below finished grade at foundation \_\_\_\_\_)

Percolation Test Results Performed by Mrs. J. Huter PE Date 3-11-73  
 Test Pit No. 1 2 minutes per inch Depth of Test Pit 36"  
 Test Pit No. 2 \_\_\_\_\_ minutes per inch Depth of Test Pit \_\_\_\_\_

Description of Soil loose clean sand SW Depth to Ground Water DNOC  
 Will disposal area be filled? No Cut down? No  
 (On reverse side or separate sheet, show plot plan with building. Include dimensions, distances from all boundaries. Show location of wells, streams, ledge, large trees, etc.)

AGREEMENT: The undersigned agrees to construct the afordescribed individual sewage disposal system in accordance with the provisions of Article XI of the Sanitary Code and regulations of the Amherst Board of Health. The undersigned further agrees not to place the system in operation until a Certificate of Compliance has been issued by this board of health.

Application Approved by [Signature] Owner or builder [Signature] Date Apr. 26, 1973  
 Date Apr. 26, 1973

Application Disapproved for the following reasons:

**BOARD OF HEALTH, AMHERST, MASSACHUSETTS  
CERTIFICATE OF COMPLIANCE**

THIS IS TO CERTIFY, That the individual Sewage Disposal System installed (✓) or repaired ( ) by [Signature] at Chapel Rd has been constructed in accordance with the provisions of Article XI of the State Sanitary Code as described in the application for Disposal Works Construction Permit No. \_\_\_\_\_ dated \_\_\_\_\_

The issuance of this certificate shall not be construed as a guarantee that the system will function satisfactorily.  
 DATE 8/14/73 Inspector Karl Wisniewski

**BOARD OF HEALTH, AMHERST, MASSACHUSETTS  
DISPOSAL WORKS CONSTRUCTION PERMIT**

No. 73-17  
 Permission is hereby granted Saunders & Roberge to construct (X) or repair ( ) an Individual Sewage Disposal System at Lot # 7 Chapel Rd as shown on the application for Disposal Works Construction Permit No. 73-17

This permit is issued with the understanding that future alterations or additions will be made if necessary. This permit shall not be construed as permission to create or maintain any sewage nuisance and in the issuance of this permit the Board of Health assumes no responsibility for the future operation or maintenance of the system.  
 DATE Apr. 26, 1973 Board of Health [Signature]

Handwritten notes at the top left, including the number '1' and some illegible text.

Handwritten notes at the top right, including the number '1000' and some illegible text.

Handwritten notes in the middle left section, including the number '1000'.

Handwritten notes in the middle center section, including the number '1000'.

Handwritten notes in the middle right section, including the number '1000'.

Small handwritten number '1000' in the lower middle left.

Handwritten notes in the lower middle right section, including the number '1000'.

Small handwritten number '1000' in the lower left section.

Handwritten notes at the bottom right, including the number '1000'.

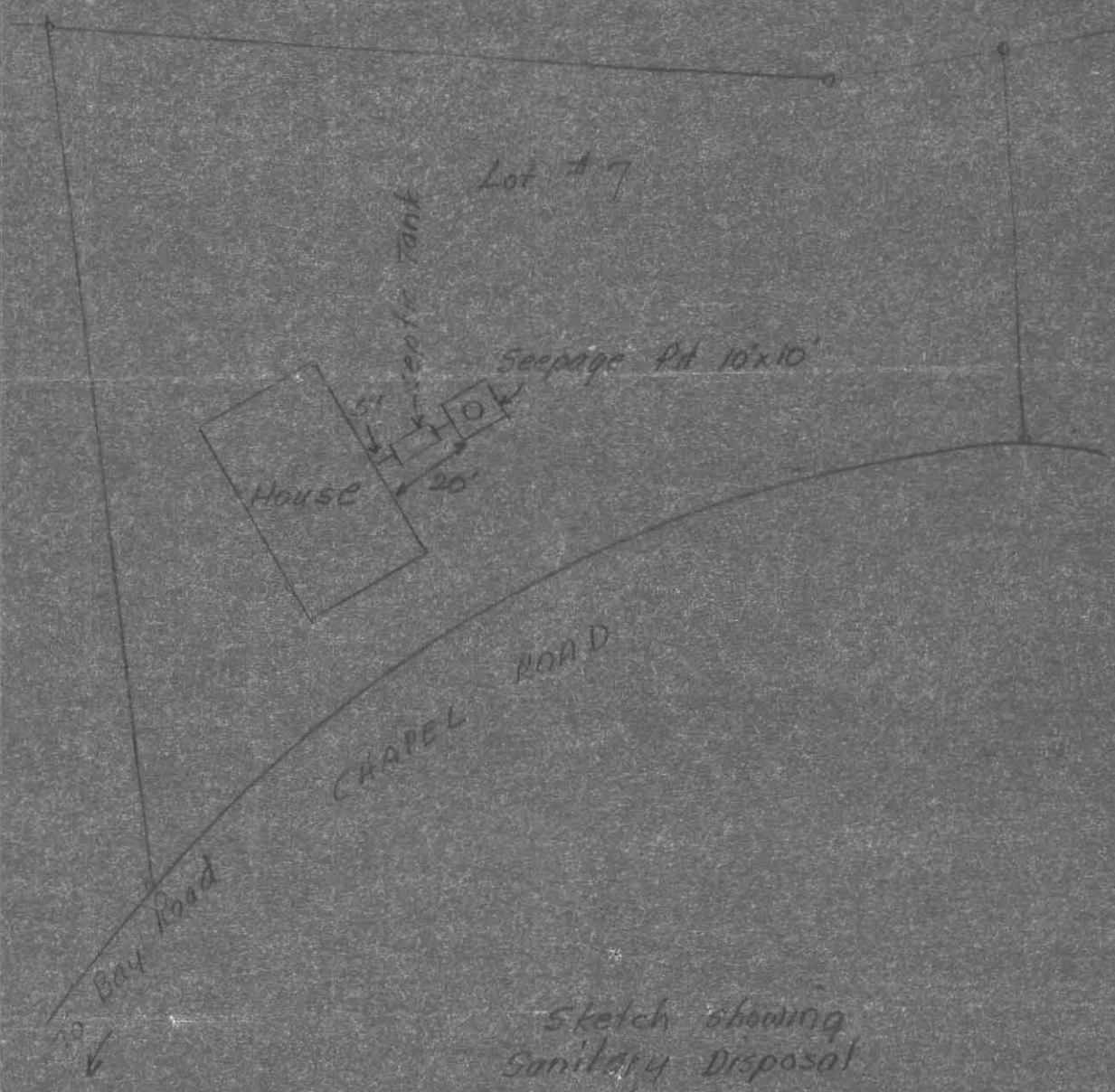

Sketch showing  
 Sanitary Disposal  
 for  
 Lot #7 Chapel Road.  
 3-14-73 m.g.A. 1"=40'

1910

1910

1910

1910

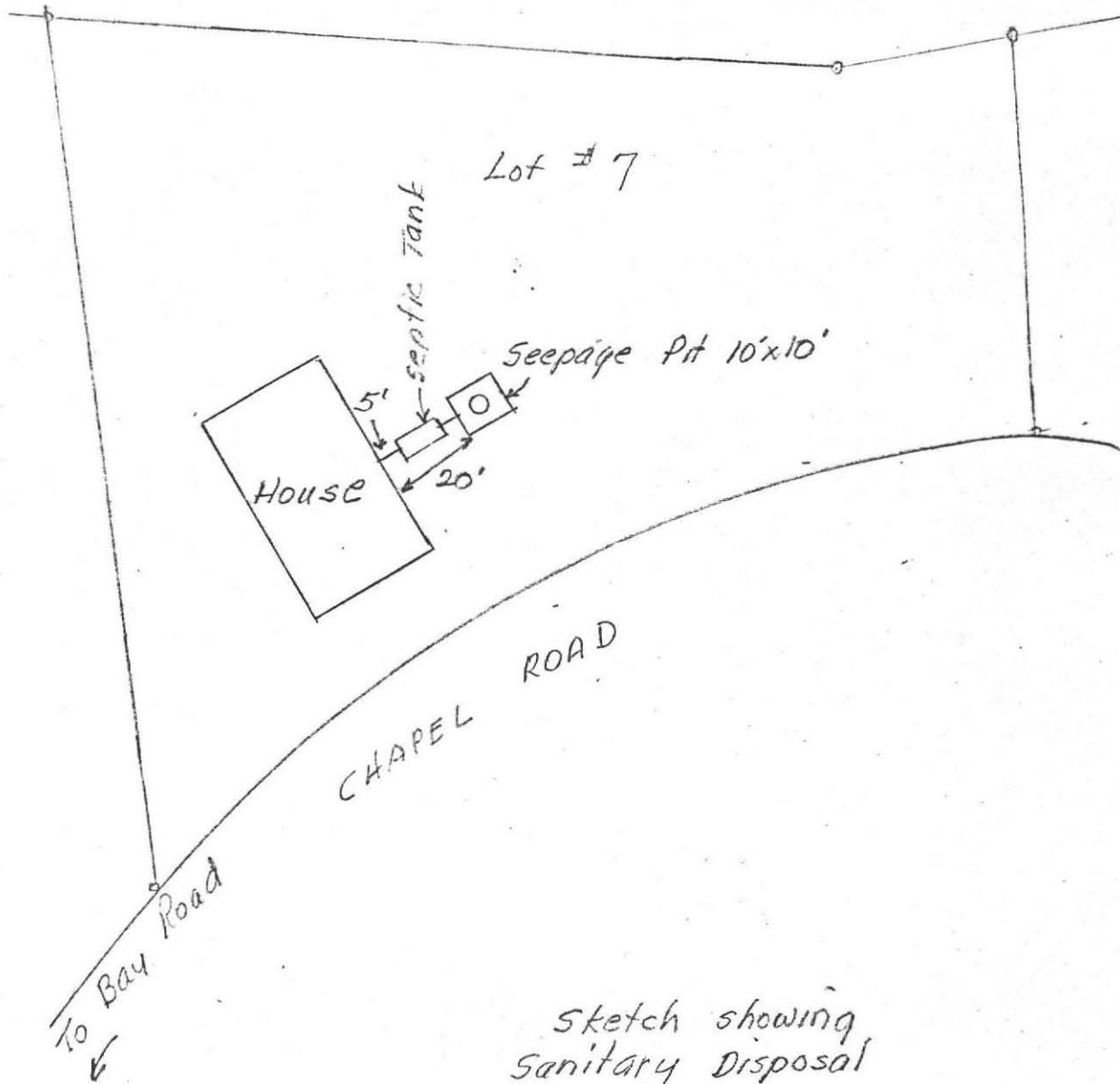

Sketch showing  
Sanitary Disposal  
for  
Lot #7 Chapel Road.  
3-14-73 m.g.H. 1"=40'

