

Handwritten marks at the top left corner, possibly a signature or initials.

Vertical handwritten text on the left margin, possibly a page number or reference.

Handwritten mark or signature on the left side of the page.

Handwritten mark or signature at the bottom left corner.

~~PHASE HOUSE~~

BOARD OF HEALTH
TOWN OF AMHERST, MASSACHUSETTS

Important Information Regarding Your Private Sewage Disposal System

DISPLAY THIS DOCUMENT IN A PROMINENT PLACE

Owner MARY MAZOA Address 165 Bay Rd
Installer KARLS ETC. Address RIVER DR. HADLEY
Date Installation Inspected and Approved 11-8-82
Description of System: Tank Capacity: 1000.

Leach Field () Bed () Seepage Pit Square Feet: 340^{sq}
Garbage Grinder Yes () No No. Bedrooms: 3 No. People 6

AS - BUILT PLAN:

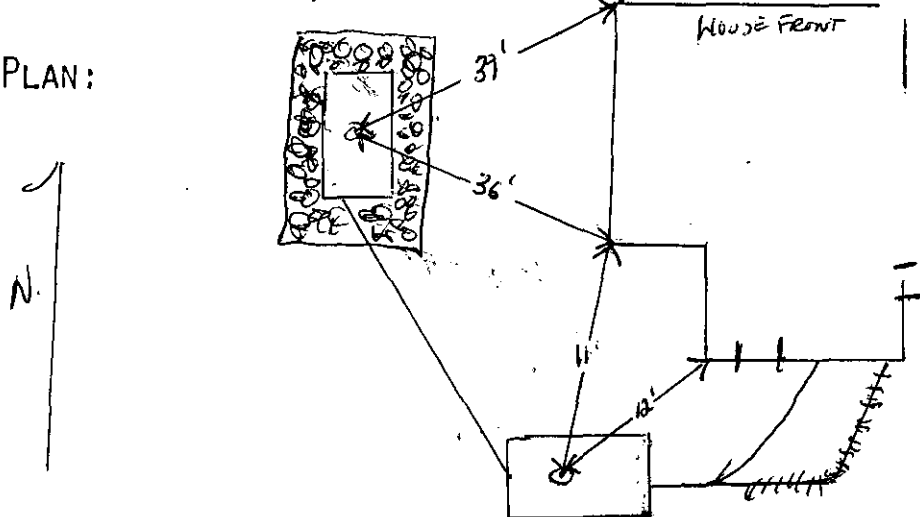
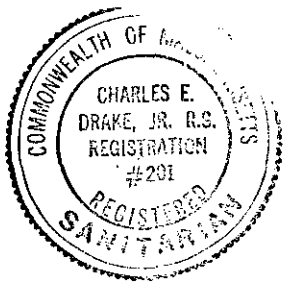

PROPER MAINTENANCE OF YOUR PRIVATE SEWAGE DISPOSAL SYSTEM

1. This system must be inspected periodically and the tank pumped out at an interval not to exceed 3 years.
2. For your protection sanitary pumpers are licensed by the Amherst Board of Health.
3. Regular pumping is crucial to avoid early failure and costly repairs of the system.
4. DO NOT dispose into the system such items as rags, string, sanitary napkins, coffee grounds as they can cause it to clog and fail.
5. Further information can be obtained by contacting your Health Department at 253-7077.

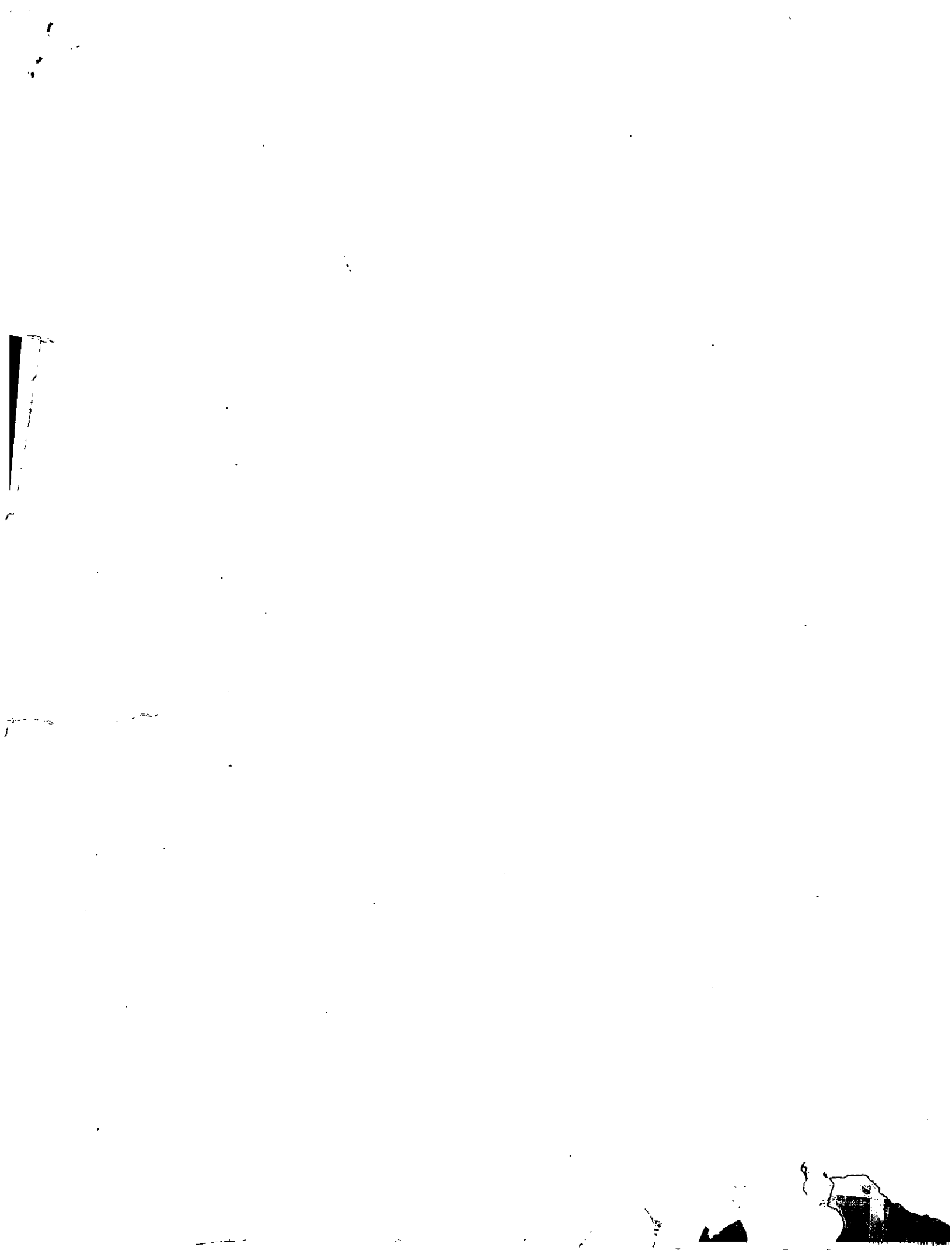

BOARD OF HEALTH
TOWN OF AMHERST, MASSACHUSETTS

Important Information Regarding Your Private Sewage Disposal System

DISPLAY THIS DOCUMENT IN A PROMINENT PLACE

Owner MARY MAZOA Address 165 Bay Rd.
Installer KARLS ETC. Address RIVER DE NAHOY
Date Installation Inspected and Approved 11-8-82

Description of System: Tank Capacity: 1000

Leach Field () Bed () Seepage Pit Square Feet: 340^{sq}

Garbage Grinder Yes () No No. Bedrooms: 3 No. People 6

AS - BUILT PLAN:

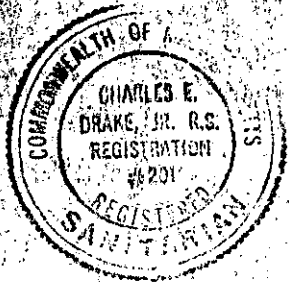
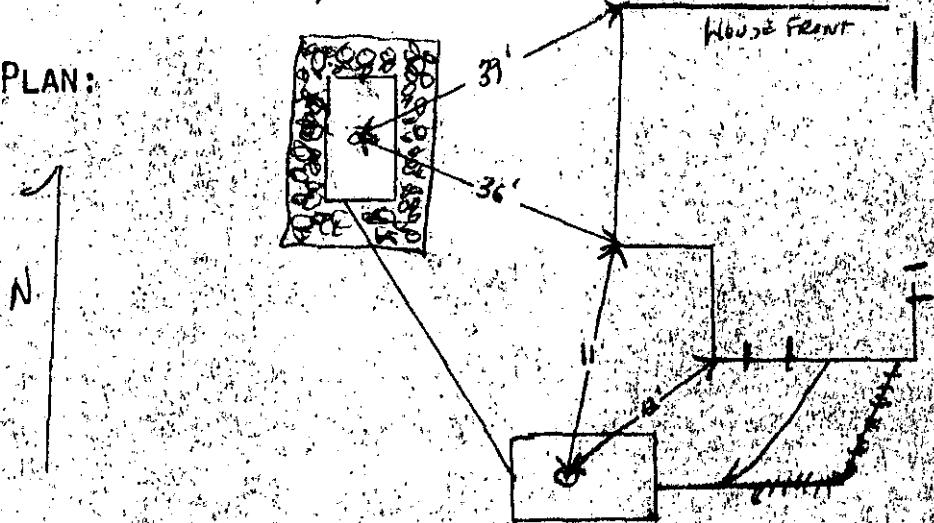

PROPER MAINTENANCE OF YOUR PRIVATE SEWAGE DISPOSAL SYSTEM

1. This system must be inspected periodically and the tank pumped out at an interval not to exceed 3 years.
2. For your protection sanitary pumpers are licensed by the Amherst Board of Health.
3. Regular pumping is crucial to avoid early failure and costly repairs of the system.
4. DO NOT dispose into the system such items as rags, string, sanitary napkins, coffee grounds as they can cause it to clog and fail.
5. Further information can be obtained by contacting your Health Department at 253-7077.

